

Commercial / Residential Node & Open Space Plan 03

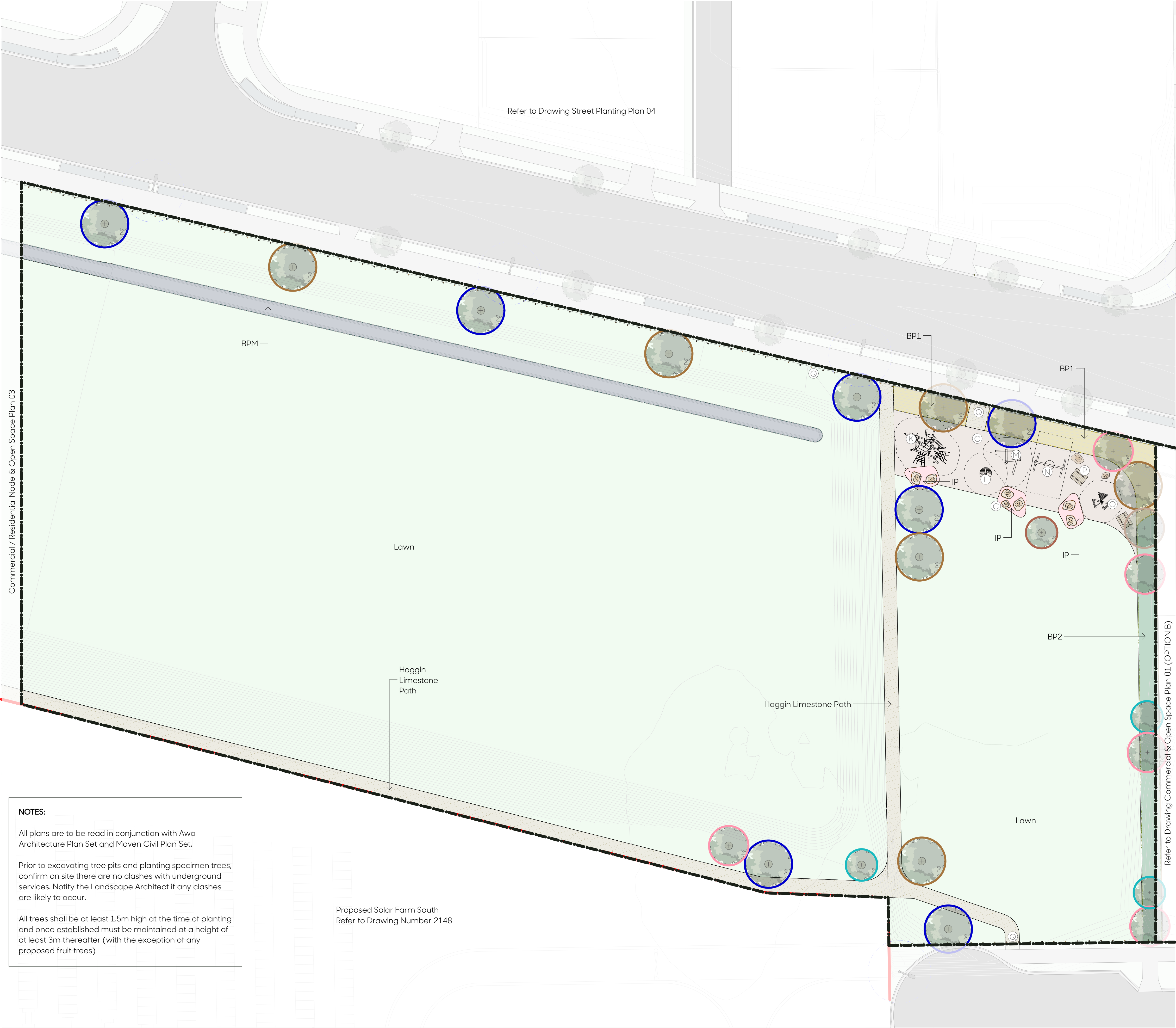











NOTES:

All plans are to be read in conjunction with Awa Architecture Plan Set and Maven Civil Plan Set.

Prior to excavating tree pits and planting specimen trees, confirm on site there are no clashes with underground services. Notify the Landscape Architect if any clashes are likely to occur.

All trees shall be at least 1.5m high at the time of planting and once established must be maintained at a height of at least 3m thereafter (with the exception of any proposed fruit trees)

Proposed Solar Farm South
Refer to Drawing Number 2148

Code	Botanical Name	Common Name	Grade	Spacing
Specimen Trees – Streets				
	<i>Alectryon excelsus</i>	titoki	100L	Marked
	<i>Knightia excelsa</i>	rewarewa	100L	Marked
	<i>Podocarpus totara 'Aurea'</i>	golden totara	100L	Marked
	<i>Quercus rubra</i>	red oak	80L	Marked
	<i>Sophora microphylla</i>	kōwhiri	80L	Marked
	<i>Vitex lucens</i>	pūriri	80L	Marked
IP	Island Planting Mix			
	<i>Carex comans 'Frosted Curly'</i>	frosted curl grass	2L	1m
	<i>Muehlenbeckia axillaris</i>	pohuehue	2L	1m
BP1	Buffer Planting Mix 1			
	<i>Blechnum novae-zelandiae</i>	kiokio	2L	0.75m
	<i>Machaerina sinclairii</i>	pepepe	2L	0.75m
	<i>Melcytus crassifolius</i>	thick-leaved Mahoe	2L	0.75m
	<i>Pimelea prostrata</i>	New Zealand daphne	2L	0.75m
BP2	Buffer Planting Mix 2			
	<i>Anemantele lessoniana</i>	pepepe	2L	0.75m
	<i>Arthropodium cirratum</i>	rengarenga lily	2L	0.75m
	<i>Coprosma 'Hawera'</i>	groundcover Coprosma	2L	0.75m
	<i>Coprosma 'Poor Knights'</i>	taupata	2L	0.75m
BPM	Basin Planting Mix			
	<i>Apodasmia similis</i>	oloi	2L	0.75m
	<i>Blechnum novae-zelandiae</i>	kiokio	2L	0.75m
	<i>Carex secta</i>	pūrei	2L	0.75m
	<i>Coprosma acerosa</i>	sand Coprosma	2L	0.75m
	<i>Corakia cotoneaster</i>	korakio	2L	0.75m
	<i>Dicksania squarrosa</i>	wheki	10L	1m
	<i>Muehlenbeckia complexa</i>	pohuehue	2L	0.75m
	<i>Phormium cookianum</i>	wharariki	2L	0.75m
	<i>Pseudopanax crassifolius</i>	horoea	10L	1m
Name		Specification		
Hardscape Surfaces & Elements				
A. Commercial Signage		By Others		
B. Timber platform (custom)		450mm High, Hardwood timber slats with black powder coated luster cut		
C. Hinuera Stone features		Varied sizes (750mm min. diameter)		
D. Pou whenua (by others)		TBC, Indicative locations only		
E. & F. Exposed aggregate concrete selections		1. Standard concrete with Firth 'Mountain Burst' aggregate, exposed aggregate finish AND		
- Pedestrian		2. Standard concrete with Firth 'Manorfield' aggregate, exposed aggregate finish		
G. Hinuera pavers (or etched pattern)		Hinuera Stone paving, various sizes		
H. Standard concrete - Pedestrian & Vehicular		Standard concrete, 4kg black oxide per m3, broom finish		
J. Asphalt		By others		
K. Wobbly Wood Ema Climbing Tree		By Playground Centre		
L. Wobbly Wood Family Carousel		By Playground Centre		
M. Twig Stack350		By Playground Centre		
N. Flying Saucer – Wobbly Wood Single Frame		By Playground Centre		
O. Wobbly Wood Teepee		By Playground Centre		
P. Parkvale Pedestal Table Setting		By Urban Effects or similar		
Q. Timber bollards		125 x 125mm, 900mm length, angle top with black collar		
Lawn		PGG Wrightson DuraVeg® Berm Mix		
Hoggin Limestone		Hoggin Limestone Gap 6		
Bark mulch		Cambium bark mulch		
Playground mulch		Engineered wood fibre mulch compliant with NZS 5828:2015		

SPECIMEN TREES







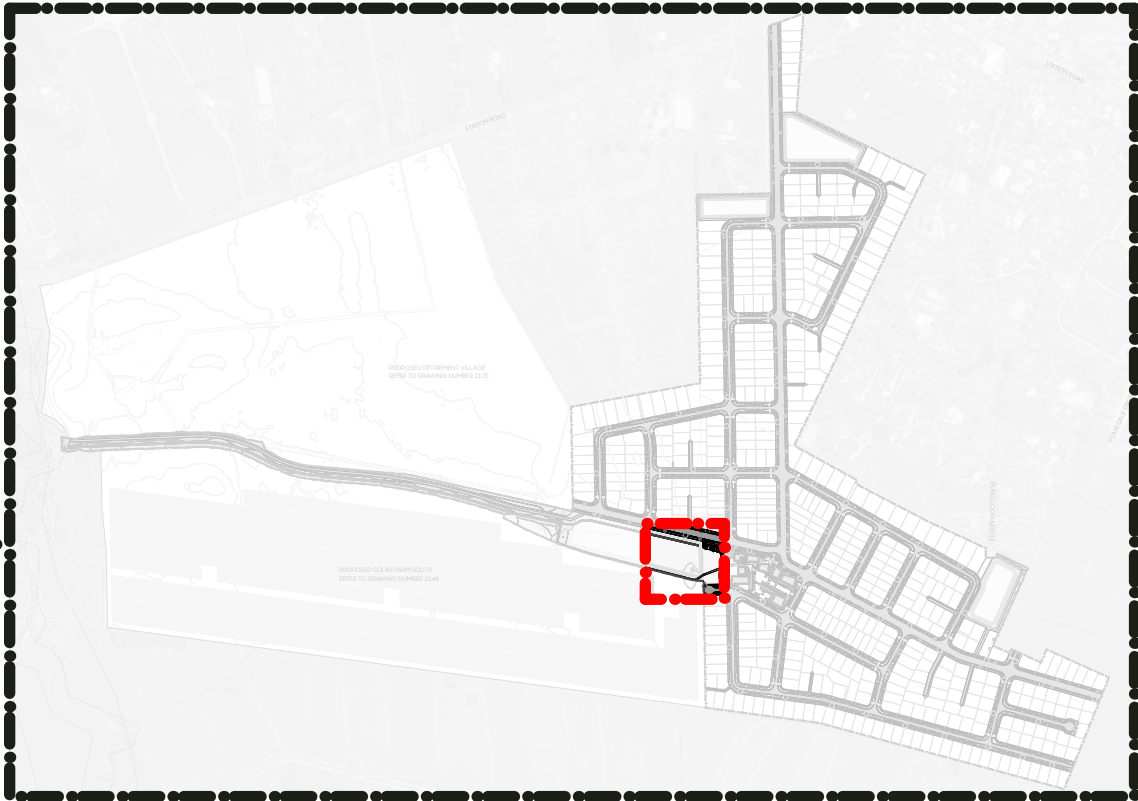

LEGEND

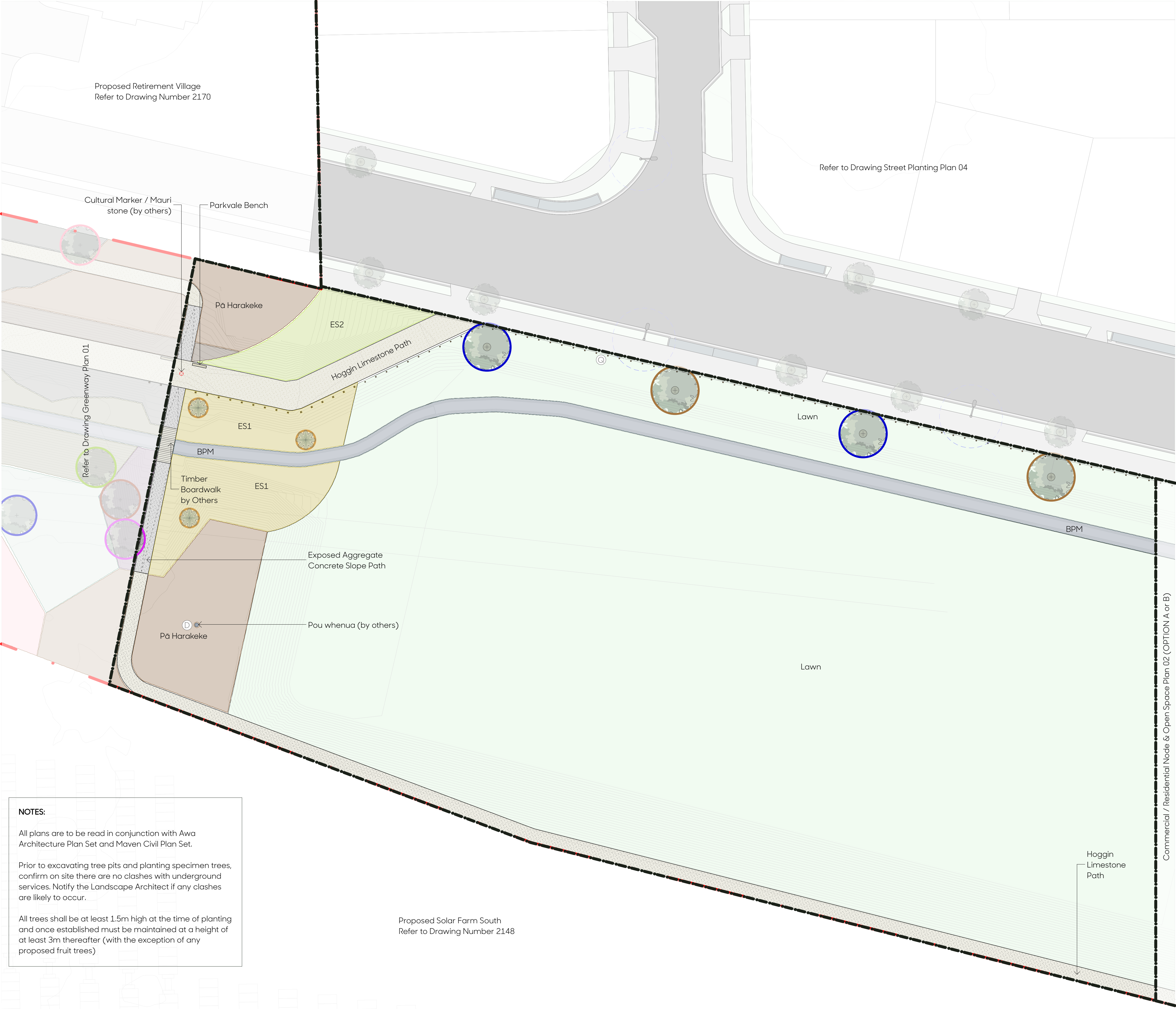
- SpecimenTrees w/ Bark Mulch
- Lawn
- Hoggin Limestone
- Playground Bark
- Timber Bollards



SHEET LOCATION PLAN - NTS



Code	Botanical Name	Common Name	Grade	Spacing
Specimen Trees – Streets				
    	<i>Alectryon excelsus</i>	titoki	100L	Marked
	<i>Knightia excelsa</i>	rewarewa	100L	Marked
	<i>Podocarpus totara 'Aurea'</i>	golden totara	100L	Marked
	<i>Quercus rubra</i>	red oak	80L	Marked
	<i>Sophora microphylla</i>	kōwhai	80L	Marked
	<i>Vitex lucens</i>	pūriri	80L	Marked
BPM	Basin Planting Mix			
	<i>Apodasmia similis</i>	oi oi	2L	0.75m
	<i>Blechnum novae-zelandiae</i>	kiokio	2L	0.75m
	<i>Carex secta</i>	pūrei	2L	0.75m
	<i>Caprosma acerosa</i>	sand Coprosma	2L	0.75m
	<i>Corokia cotoneaster</i>	korokio	2L	0.75m
	<i>Dicksonia squarrosa</i>	whēki	10L	1m
	<i>Muehlenbeckia complexa</i>	pohuehue	2L	0.75m
	<i>Phormium cookianum</i>	wharariki	2L	0.75m
	<i>Pseudopanax crassifolius</i>	horoeka	10L	1m
EP1	Edge Planting Mix 1			
	<i>Carex comans 'Frosted Curl'</i>	frosted curl grass	2L	1m
	<i>Caprosma repens 'Talka'</i>	pohuehue	2L	1m
	<i>Hebe 'Wiri Mist'</i>	shrubby Veronica	2L	1m
	<i>Rhopalostylis sapida</i>	nikau pal	45L	Marked
EP2	Edge Planting Mix 2			
	<i>Arthropodium cirratum</i>	rengarenga lily	2L	1m
	<i>Caprosma 'Poor Knights'</i>	taupata	2L	1m
	<i>Machaerina sinclairii</i>	pepepe	2L	1m
	Pā Harakeke			
5%	<i>Arthropodium cirratum</i>	rengarenga lily	1L	1m
5%	<i>Carex virgata</i>	pukio	1L	1m
5%	<i>Caprosma 'Poor Knights'</i>	taupata	1L	1m
5%	<i>Muehlenbeckia complexa</i>	pohuehue	1L	1m
35%	<i>Phormium cookianum</i>	wharariki	1L	1m
40%	<i>Phormium tenax</i>	harakeke	1L	1.25m
10%	<i>Phormium tenax 'Rātāroa'</i>	kōrari	1L	1m
Name		Specification		
Hardscape Surfaces & Elements				
D. Pou whenua (by others)		TBC, Indicative locations only		
Q. Timber bollards		125 x 125mm, 900mm length, angle top with black collar		
Lawn		PGG Wrightson DuraVeg® Berm Mix		
Hoggin Limestone		Hoggin Limestone Gap 6		
Bark mulch		Cambium bark mulch		
Exposed aggregate concrete selections		1. Standard concrete with Firth 'Mountain Burst' aggregate, exposed aggregate finish		
- Pedestrian				

SPECIMEN TREES



NOTES:

All plans are to be read in conjunction with Awa Architecture Plan Set and Maven Civil Plan Set.

Prior to excavating tree pits and planting specimen trees, confirm on site there are no clashes with underground services. Notify the Landscape Architect if any clashes are likely to occur.

All trees shall be at least 1.5m high at the time of planting and once established must be maintained at a height of at least 3m thereafter (with the exception of any proposed fruit trees)

LEGEND

- SpecimenTrees w/ Bark Mulch
- Lawn
- Timber Bollards
- Hoggin Limestone
- Concrete Firth 'Mountain Burst'

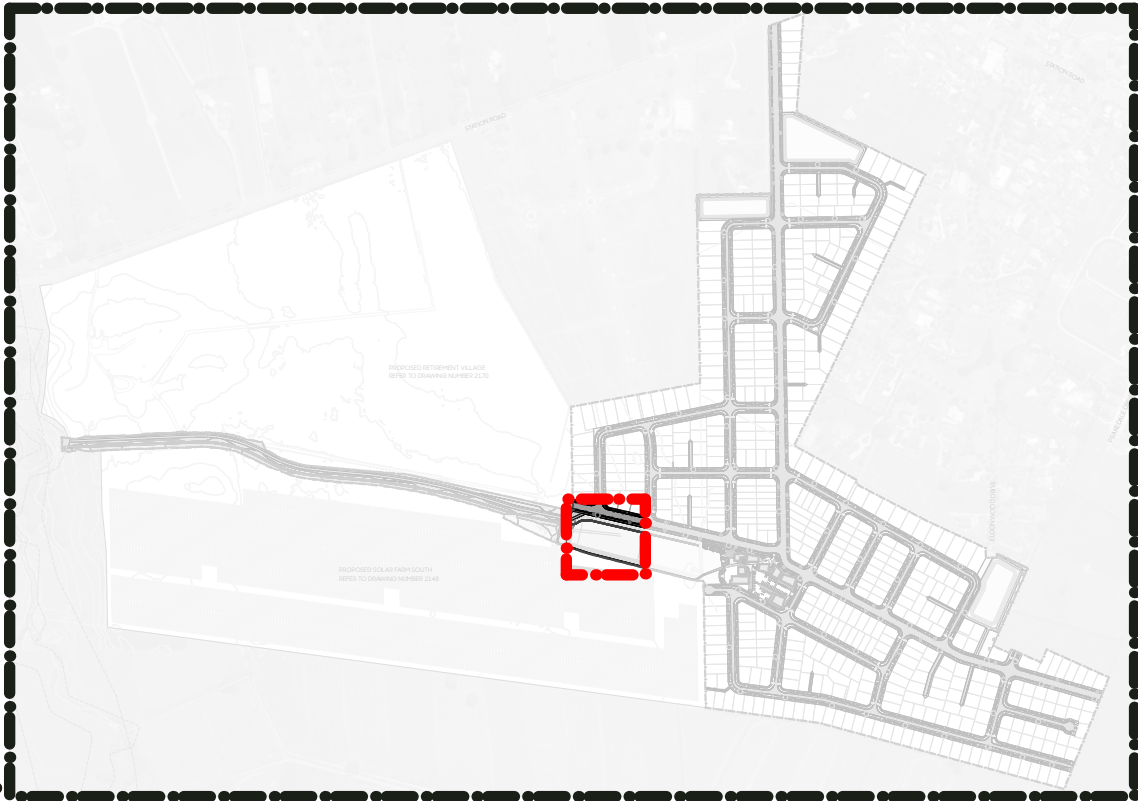

SHEET LOCATION PLAN - NTS

SPECIMEN TREES



Alectryon excelsus *Knightia excelsa* *Podocarpus totara 'Aurea'* *Quercus rubra* *Sophora microphylla* *Vitex lucens*

AMENITY PLANTING MIX 1



Coprosma 'Hawera' *Dianella nigra* *Hebe 'Wiri Mist'* *Phormium 'Dwarf Green'* *Rhopalostylis sapida*

EDGE PLANTING MIX 1



Carex comans 'Frosted Curls' *Coprosma repens 'Taiko'* *Hebe 'Wiri Mist'* *Rhopalostylis sapida*

BUFFER PLANTING MIX 1



Blechnum novae-zelandiae *Machaerina sinclairii* *Melicytus crassifolius* *Pimelea prostrata*

AMENITY PLANTING MIX 2



Coprosma 'Black cloud' *Dianella nigra* *Muehlenbeckia axillaris* *Phormium cookianum*

ISLAND PLANTING MIX



Carex comans 'Frosted Curls' *Muehlenbeckia axillaris*

EDGE PLANTING MIX 2



Arthropodium cirratum *Coprosma 'Poor Knights'* *Machaerina sinclairii*

BUFFER PLANTING MIX 2



Anemanthele lessoniana *Arthropodium cirratum* *Coprosma 'Hawera'* *Coprosma 'Poor Knights'*