

SECTION A - 20m ROAD - TYPICAL CROSS SECTION (ROAD 1 & 7)
SCALE: 1:75 @ A3

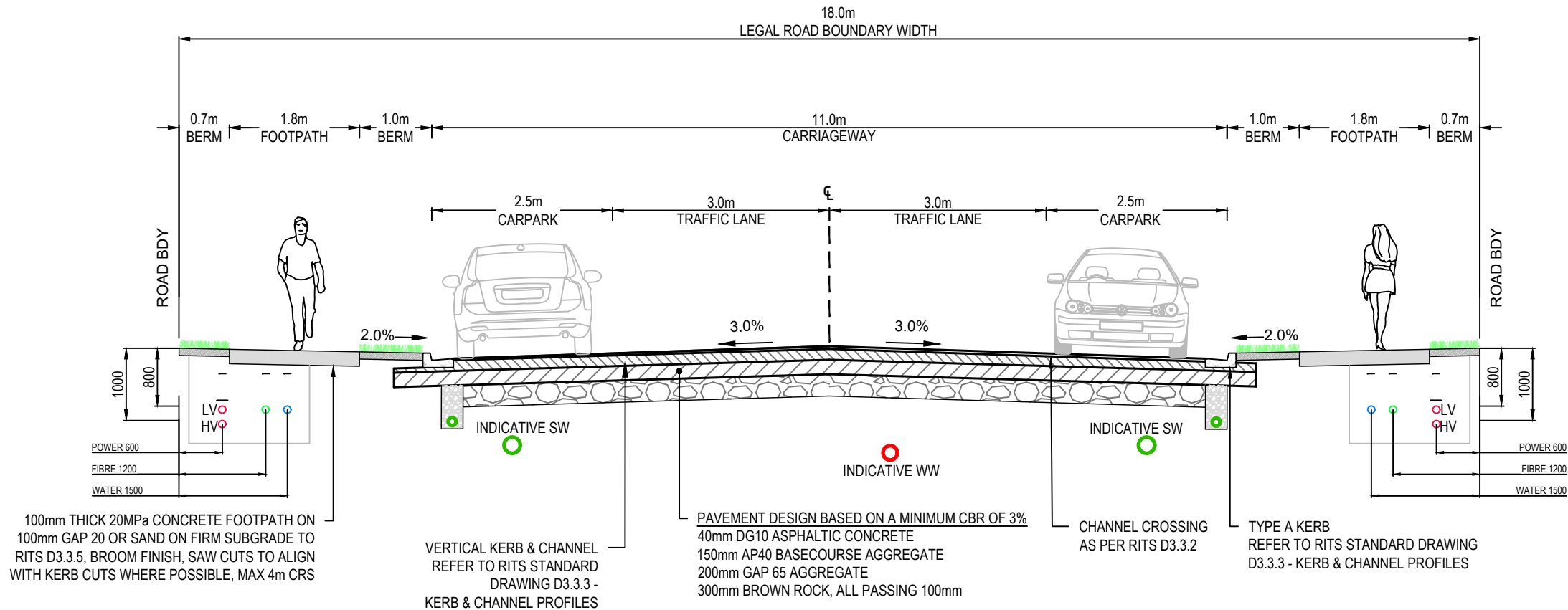

SECTION B - 18m ROAD - TYPICAL CROSS SECTION (NO SW DEVICES)
SCALE: 1:75 @ A3

- Notes
1. All works to be in accordance with local council standards.
 2. Co-ordinates in terms of Mount Eden 2000
 3. Reduced levels in terms of NZVD 2016.
 4. Benchmark: IT I DPS 29877 RL: 65.19
 5. The Contractors shall obtain all necessary approval from utility operators before commencing work under or near their services.
 6. Final pavement design subject to CBR/Beam tests on subgrade material.
 7. Setout schedule with co-ordinates of chainage points along road centerline to be supplied to the Contractors prior to construction.
 8. Refer to long section for finished centerline levels. Refer to typical cross sections to obtain levels for other locations.
 9. Vehicle crossing to be constructed by others unless otherwise stated.
 10. The Contractor may, with the agreement of the Engineer, adopt the alternative pavement design as specified on typical cross section, provided that the subgrade can achieve a minimum of CBR 3.
 11. Subgrade testing required, contractor shall notify engineer of any results below CBR of 3%. Engineer to advise on the additional pavement requirements or Subgrade remediation.

C	FAST TRACK APP	RJM	05/2025
B	FAST TRACK APP	RJM	04/2025
A	FAST TRACK APP	TCH	04/2025
Rev	Description	By	Date
		By	Date
Survey	MAVEN		03/2024
Design	MKS		10/2024
Drawn	MKS		10/2024
Checked	DJM		05/2025



Project
**ASHBOURNE
RESIDENTIAL
FOR
MATAMATA
DEVELOPMENTS**

Title
**TYPICAL ROAD
CROSS SECTION
SHEET 1 OF 7**

Project no.	289001
Scale	AS SHOWN
Cad file	C340-TYP RD SECTION.DWG
Drawing no.	C340-1
Rev	C

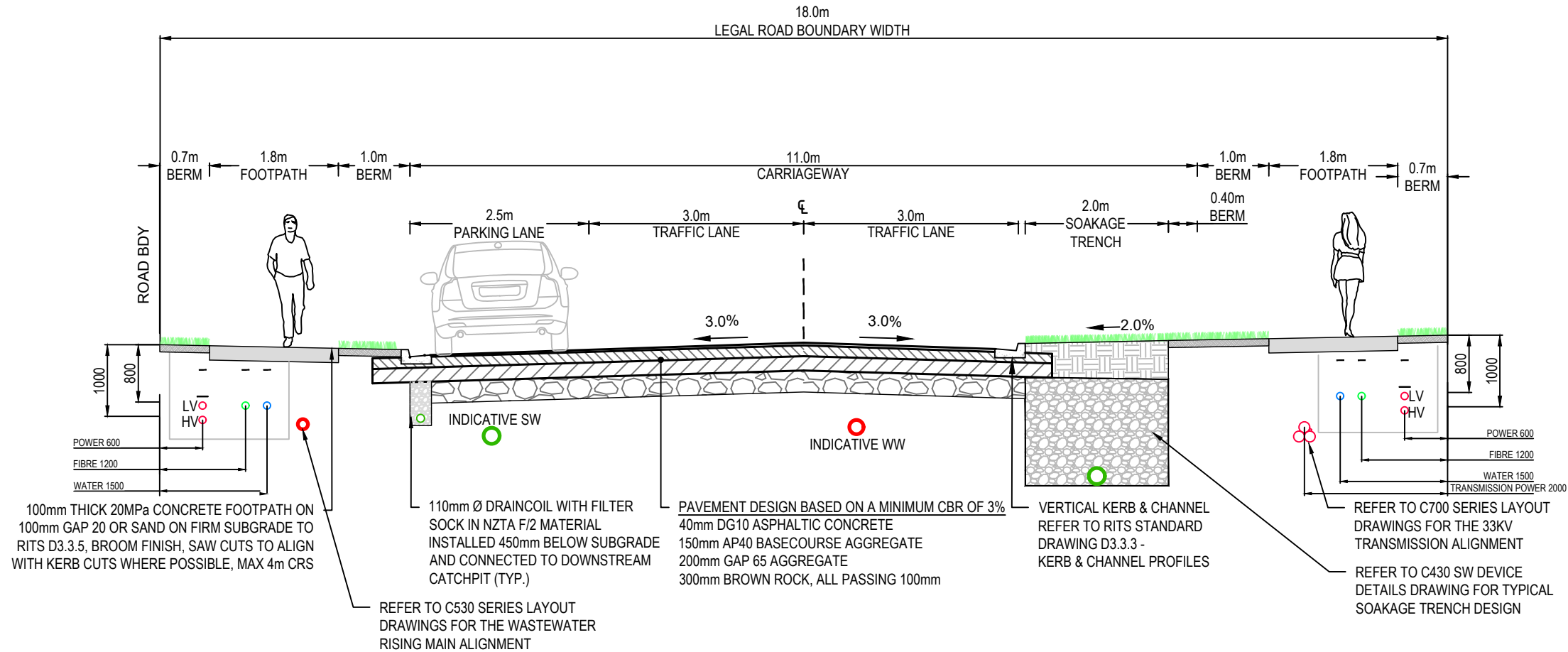

SECTION C - 18m ROAD - TYPICAL CROSS SECTION
SCALE: 1:75 @ A3

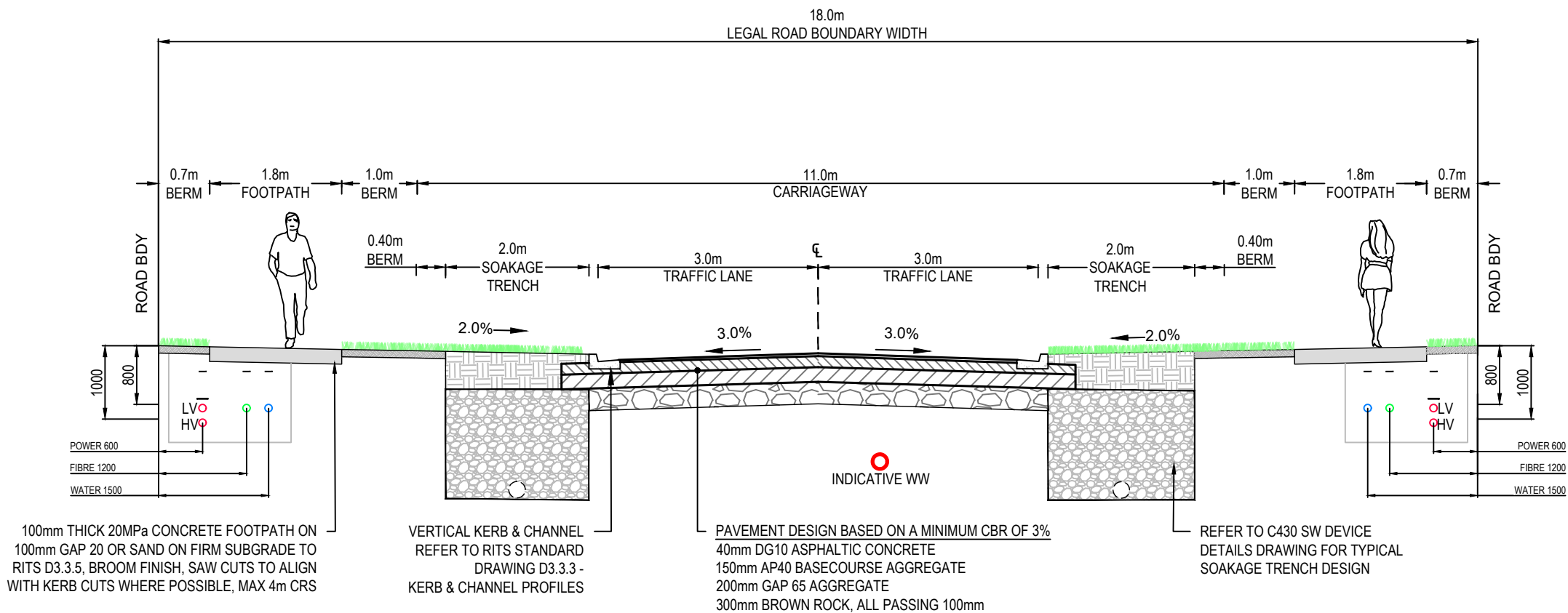

SECTION D - 18m ROAD - TYPICAL CROSS SECTION
SCALE: 1:75 @ A3

Notes

1. All works to be in accordance with local council standards.
2. Co-ordinates in terms of Mount Eden 2000
3. Reduced levels in terms of NZVD 2016.
4. Benchmark: IT I DPS 29877 RL: 65.19
5. The Contractors shall obtain all necessary approval from utility operators before commencing work under or near their services.
6. Final pavement design subject to CBR/Beam tests on subgrade material.
7. Setout schedule with co-ordinates of chainage points along road centerline to be supplied to the Contractors prior to construction.
8. Refer to long section for finished centerline levels. Refer to typical cross sections to obtain levels for other locations.
9. Vehicle crossing to be constructed by others unless otherwise stated.
10. The Contractor may, with the agreement of the Engineer, adopt the alternative pavement design as specified on typical cross section, provided that the subgrade can achieve a minimum of CBR 3.
11. Subgrade testing required, contractor shall notify engineer of any results below CBR of 3%. Engineer to advise on the additional pavement requirements or Subgrade remediation.

C	FAST TRACK APP	RJM	05/2025
B	FAST TRACK APP	RJM	04/2025
A	FAST TRACK APP	TCH	04/2025
Rev	Description	By	Date
		By	Date
Survey	MAVEN		03/2024
Design	MKS		10/2024
Drawn	MKS		10/2024
Checked	DJM		05/2025



Project
**ASHBOURNE
RESIDENTIAL
FOR
MATAMATA
DEVELOPMENTS**

Title
**TYPICAL ROAD
CROSS SECTION
SHEET 2 OF 7**

Project no.	289001
Scale	AS SHOWN
Cad file	C340-TYP RD SECTION.DWG
Drawing no.	C340-2
Rev	C

RESOURCE CONSENT

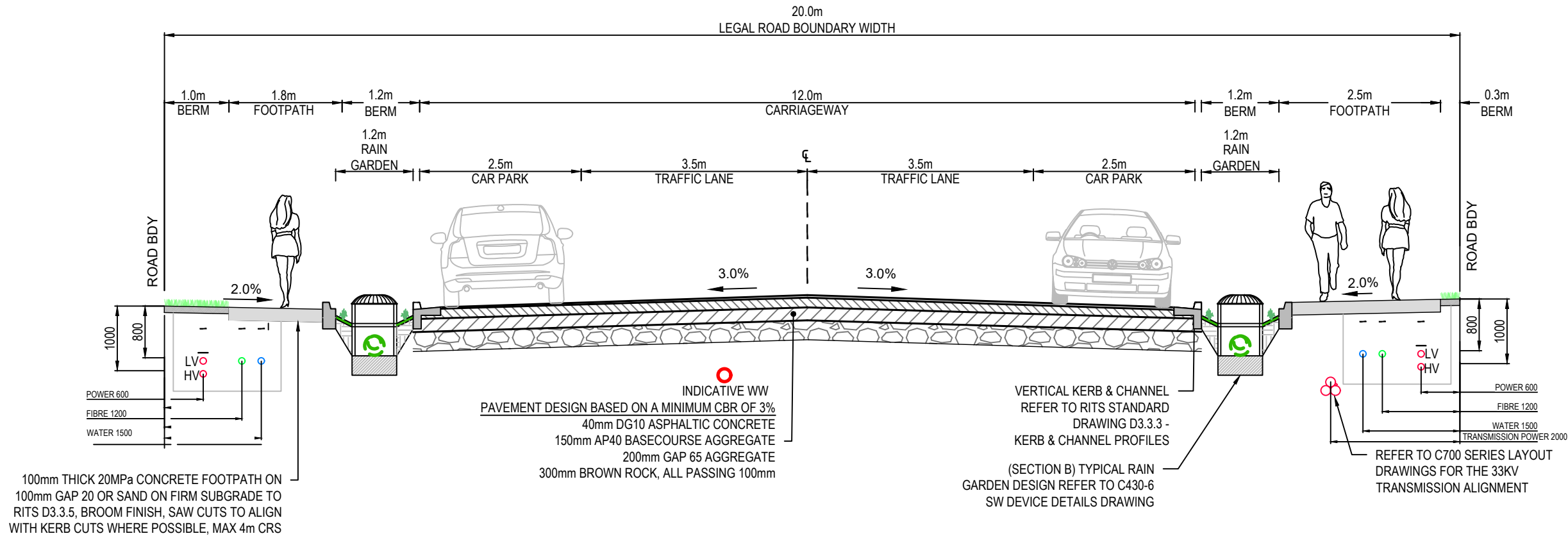

SECTION E - 20m ROAD - TYPICAL CROSS SECTION (ROAD 1 & 7)
SCALE: 1:75 @ A3

- Notes
1. All works to be in accordance with local council standards.
 2. Co-ordinates in terms of Mount Eden 2000
 3. Reduced levels in terms of NZVD 2016.
 4. Benchmark: IT I DPS 29877 RL: 65.19
 5. The Contractors shall obtain all necessary approval from utility operators before commencing work under or near their services.
 6. Final pavement design subject to CBR/Beam tests on subgrade material.
 7. Setout schedule with co-ordinates of chainage points along road centerline to be supplied to the Contractors prior to construction.
 8. Refer to long section for finished centerline levels. Refer to typical cross sections to obtain levels for other locations.
 9. Vehicle crossing to be constructed by others unless otherwise stated.
 10. The Contractor may, with the agreement of the Engineer, adopt the alternative pavement design as specified on typical cross section, provided that the subgrade can achieve a minimum of CBR 3.
 11. Subgrade testing required, contractor shall notify engineer of any results below CBR of 3%. Engineer to advise on the additional pavement requirements or Subgrade remediation.

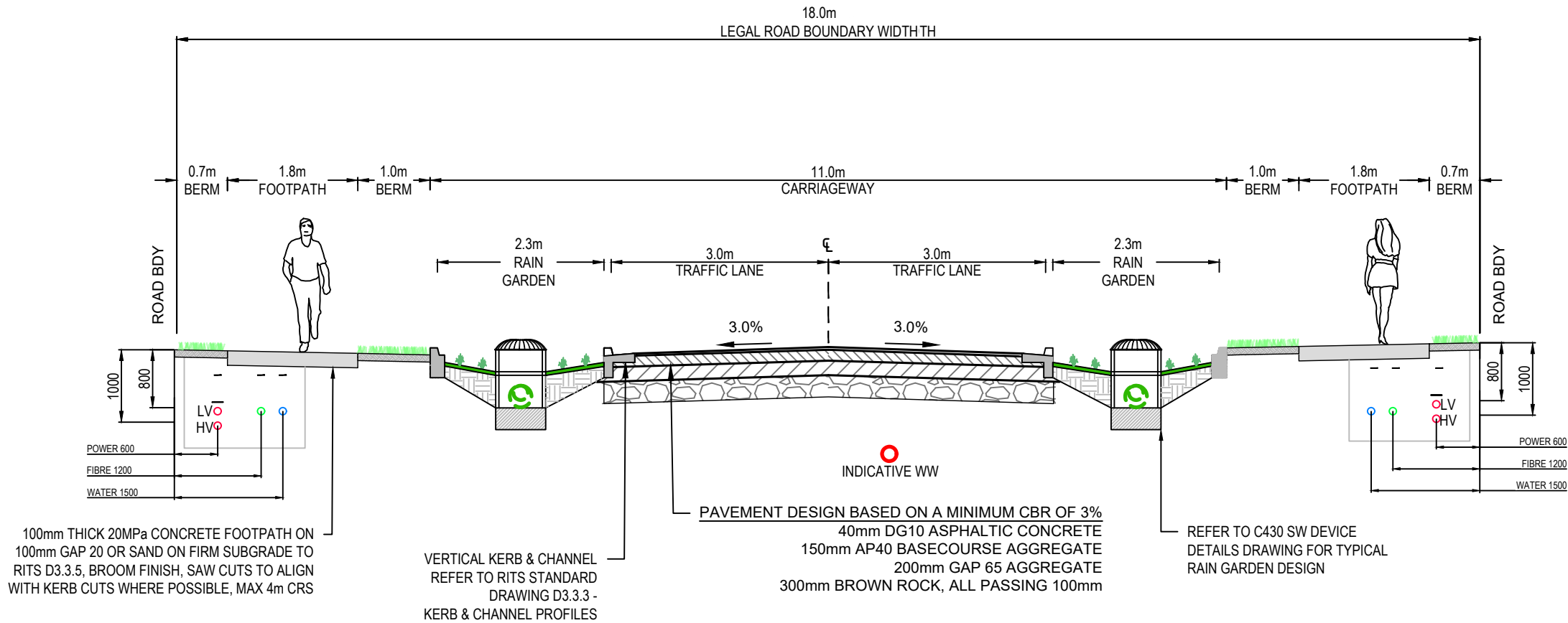

SECTION F - 18m ROAD - TYPICAL CROSS SECTION
SCALE: 1:75 @ A3

C	FAST TRACK APP	RJM	05/2025
B	FAST TRACK APP	RJM	04/2025
A	FAST TRACK APP	TCH	04/2025
Rev	Description	By	Date
		By	Date
Survey	MAVEN		03/2024
Design	MKS		10/2024
Drawn	MKS		10/2024
Checked	DJM		05/2025

M

MAVEN

Maven Associates

09 571 0050

info@maven.co.nz

www.maven.co.nz

5 Owens Road, Epsom

Auckland 1023

Project
**ASHBOURNE
RESIDENTIAL
FOR
MATAMATA
DEVELOPMENTS**

Title
**TYPICAL ROAD
CROSS SECTION
SHEET 3 OF 7**

Project no.	289001		
Scale	AS SHOWN		
Cad file	C340-TYP RD SECTION.DWG		
Drawing no.	C340-3	Rev	C

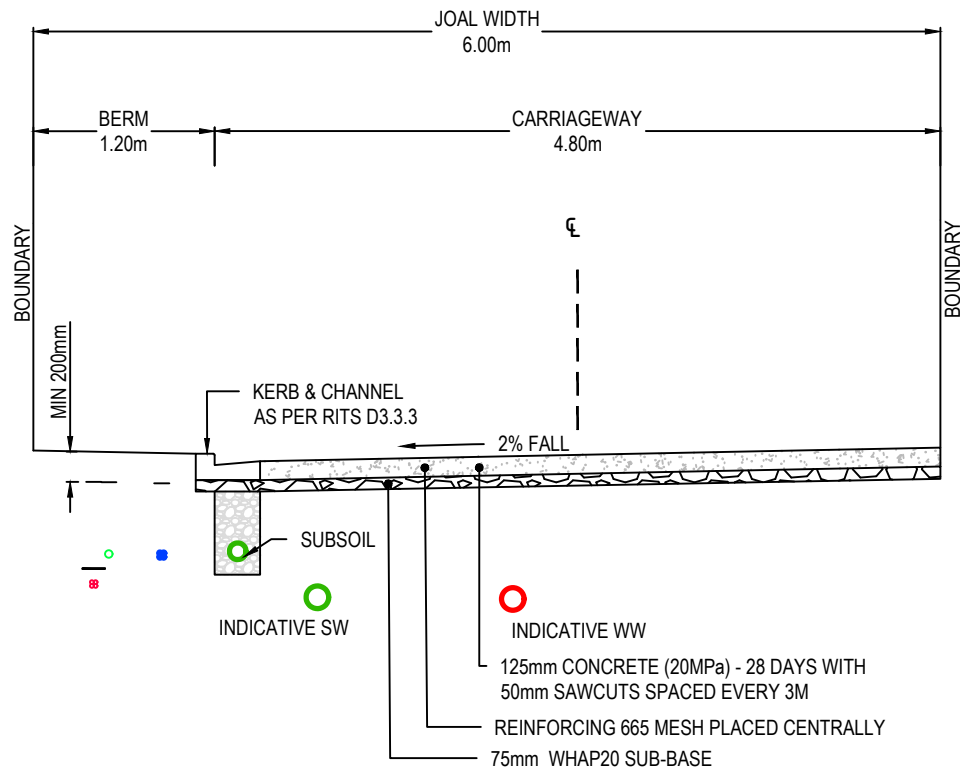

6m JOAL TYPICAL CROSS SECTION
(TYPE 1)
SCALE @ A3 1:50

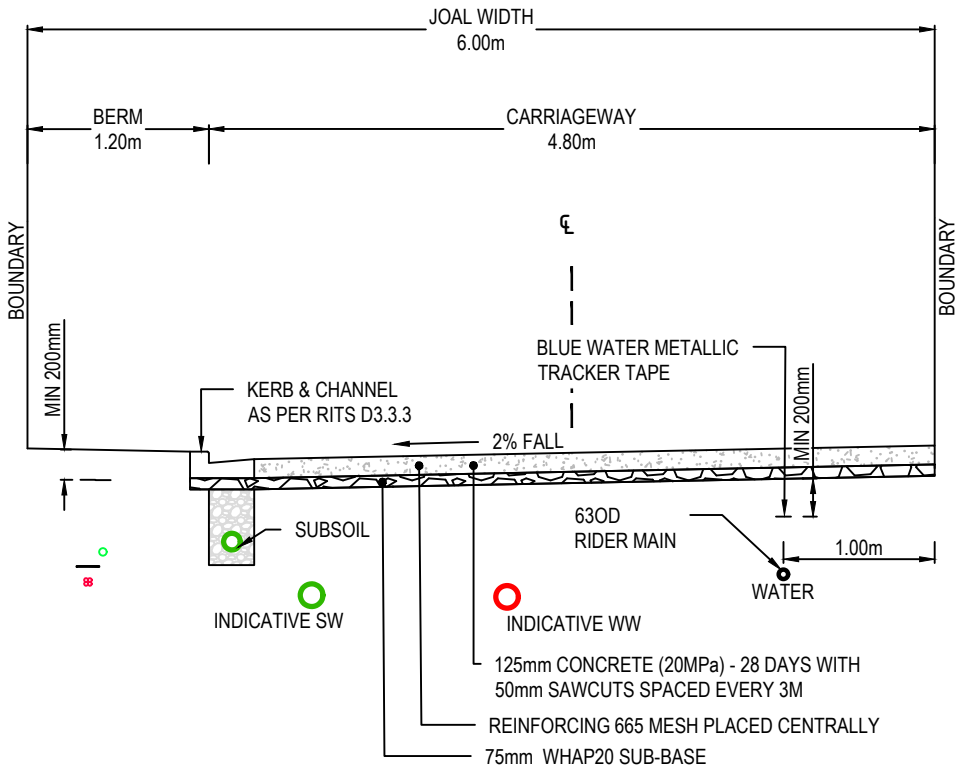

6m JOAL TYPICAL CROSS SECTION
(TYPE 2)
SCALE @ A3 1:50

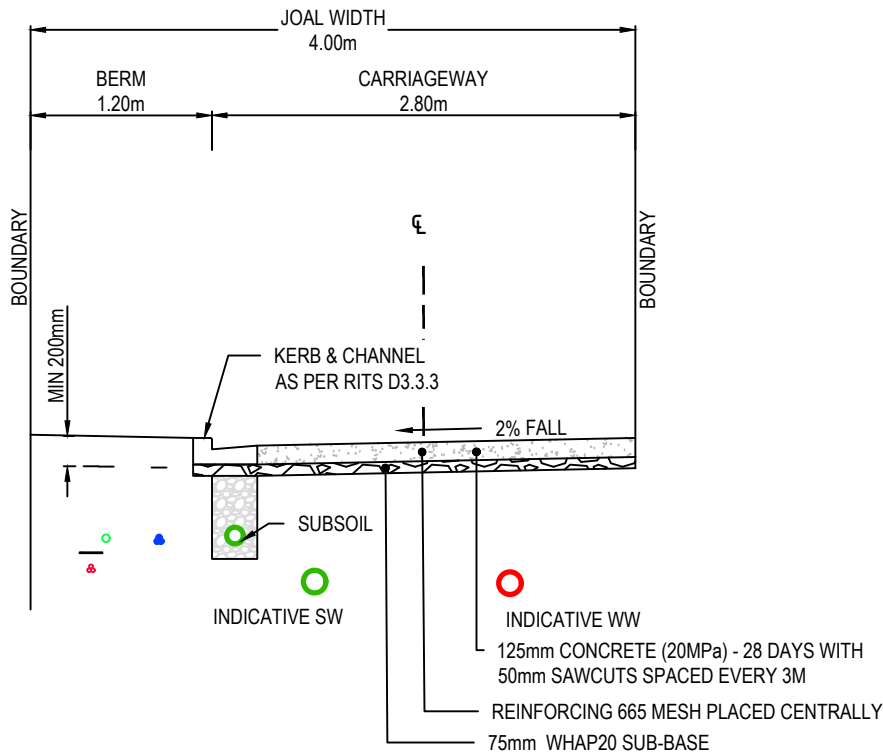

4m JOAL - TYPICAL CROSS SECTION
(TYPE 3)
SCALE 1:50 @ A3

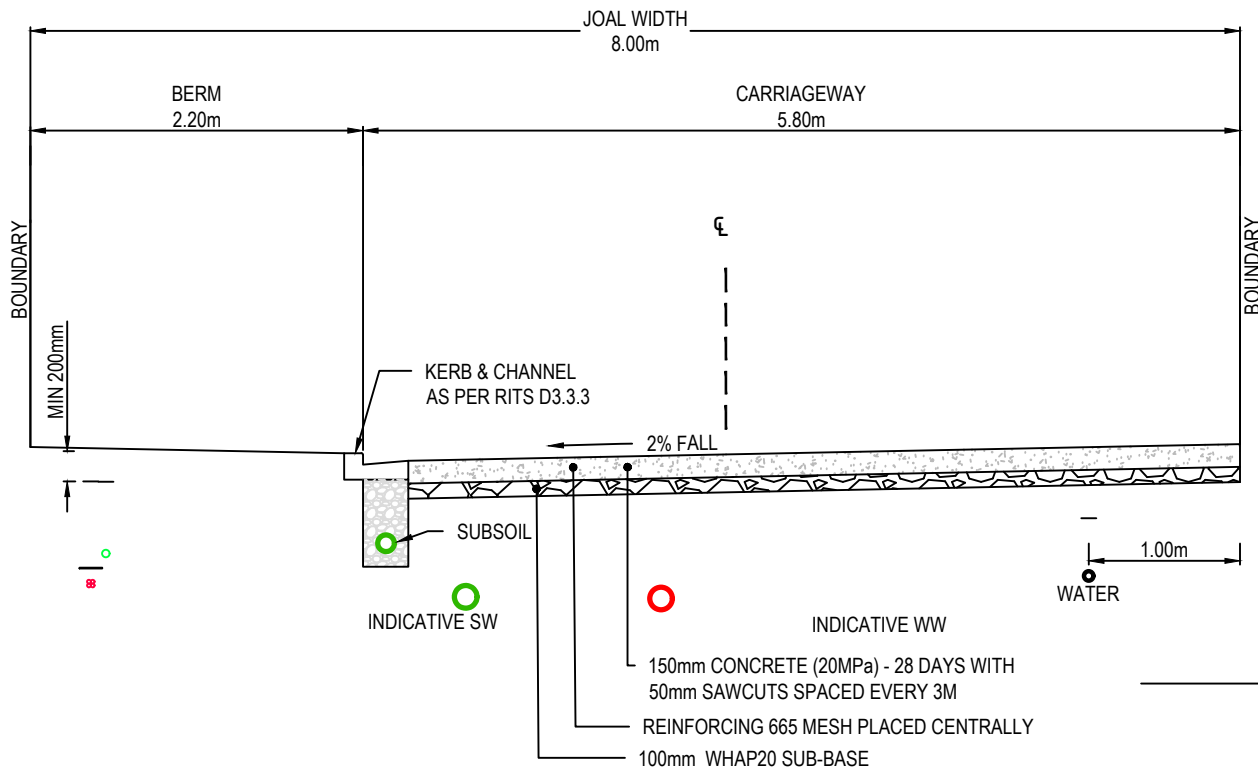

8m JOAL TYPICAL CROSS SECTION
(TYPE 1)
SCALE @ A3 1:50

- Notes
1. All works to be in accordance with local council standards.
 2. Co-ordinates in terms of Mount Eden 2000
 3. Reduced levels in terms of NZVD 2016.
 4. Benchmark: IT I DPS 29877 RL: 65.19
 5. The Contractors shall obtain all necessary approval from utility operators before commencing work under or near their services.
 6. Final pavement design subject to CBR/Beam tests on subgrade material.
 7. Setout schedule with co-ordinates of chainage points along road centerline to be supplied to the Contractors prior to construction.
 8. Refer to long section for finished centerline levels. Refer to typical cross sections to obtain levels for other locations.
 9. Vehicle crossing to be constructed by others unless otherwise stated.
 10. The Contractor may, with the agreement of the Engineer, adopt the alternative pavement design as specified on typical cross section, provided that the subgrade can achieve a minimum of CBR 3.
 11. Subgrade testing required, contractor shall notify engineer of any results below CBR of 3%. Engineer to advise on the additional pavement requirements or Subgrade remediation.

C	FAST TRACK APP	RJM	05/2025
B	FAST TRACK APP	RJM	04/2025
A	FAST TRACK APP	TCH	04/2025
Rev	Description	By	Date
		By	Date
Survey	MAVEN		03/2024
Design	AP		03/2024
Drawn	AP		03/2024
Checked	DJM		05/2025

M Maven Associates
09 571 0050
info@maven.co.nz
www.maven.co.nz
5 Owens Road, Epsom
Auckland 1023

Project
**ASHBOURNE
RESIDENTIAL
FOR
MATAMATA
DEVELOPMENTS**

Title
**TYPICAL ROAD
CROSS SECTION
SHEET 5 OF 7**

Project no.	289001		
Scale	AS SHOWN		
Cad file	C340-TYP RD SECTION.DWG		
Drawing no.	C340-5	Rev	C

RESOURCE CONSENT

DATE: 5/20/25 FILE PATH: F:\Maven\Hamilton\6. PROJECTS\88001 - STATION ROAD\7. DRAWING\11. ASHBORNE RESIDENTIAL\C340-TYP RD SECTION.DWG

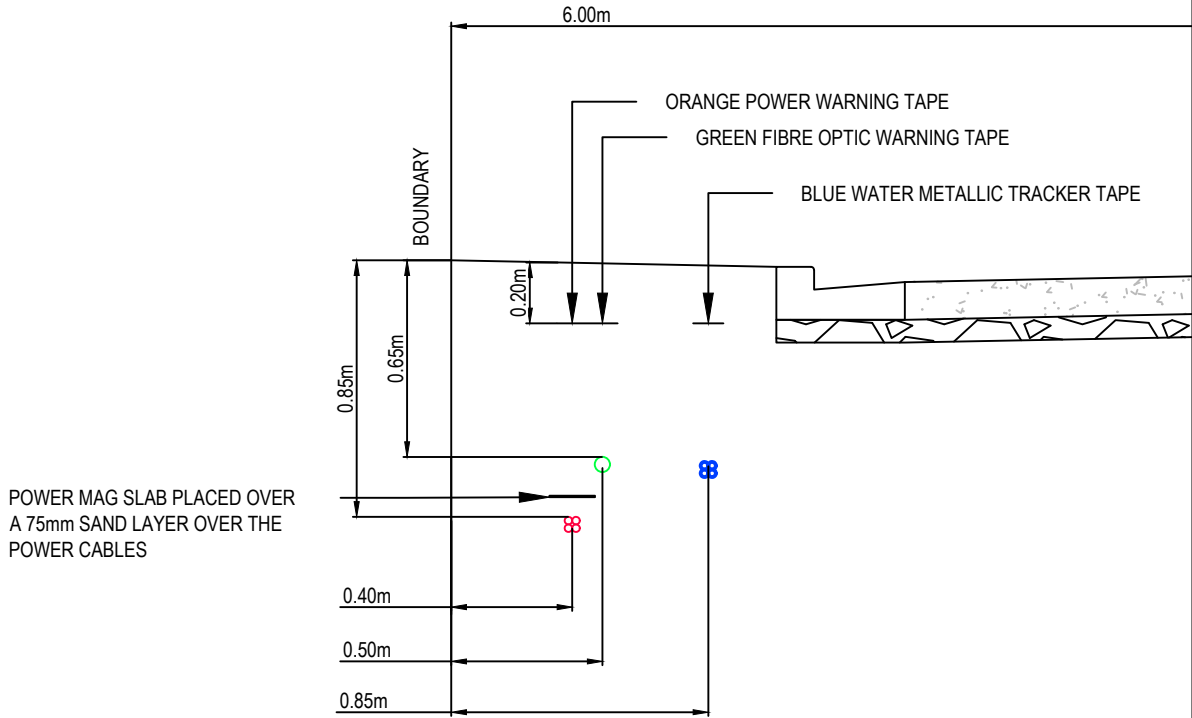

6m JOAL TYPICAL SERVICE TRENCH (SERVING 4 LOTS)
(TYPE 1)
SCALE @ A3 1:25

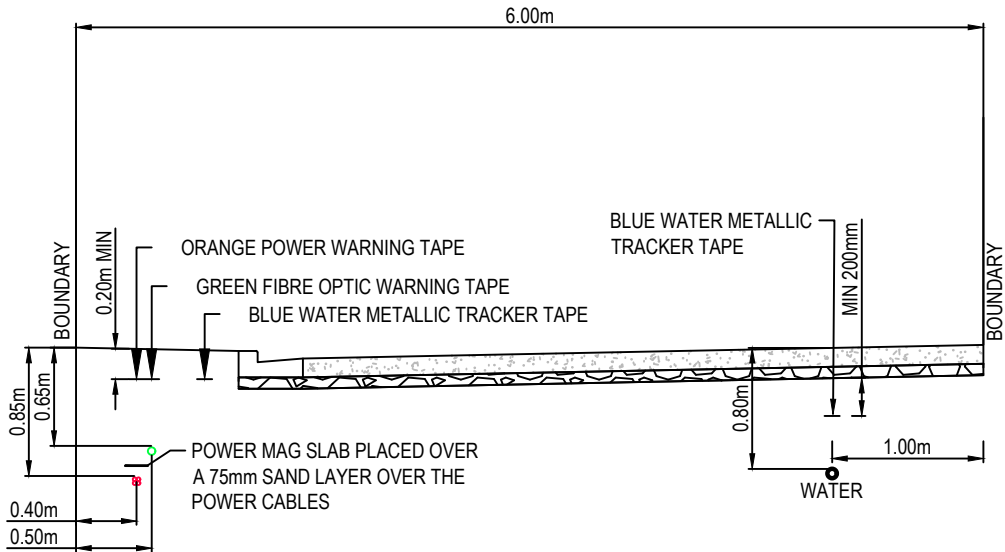

6m JOAL TYPICAL SERVICE TRENCH (SERVING 5+ LOTS)
(TYPE 2)
SCALE @ A3 1:50

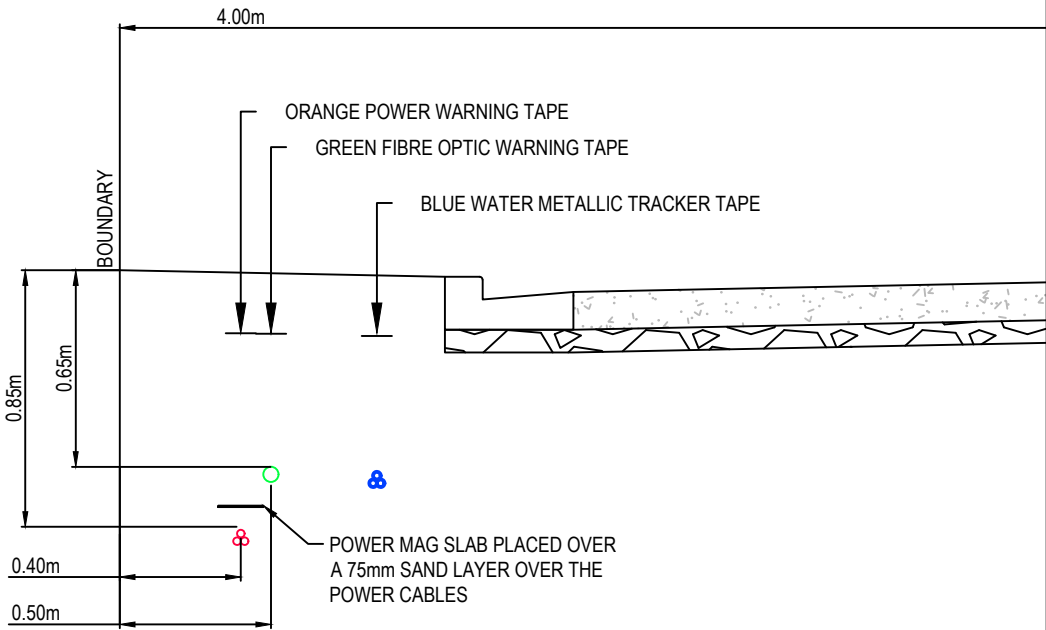

4m JOAL - TYPICAL SERVICE TRENCH (SERVING 3 LOTS)
(TYPE 3)
SCALE 1:25 @ A3

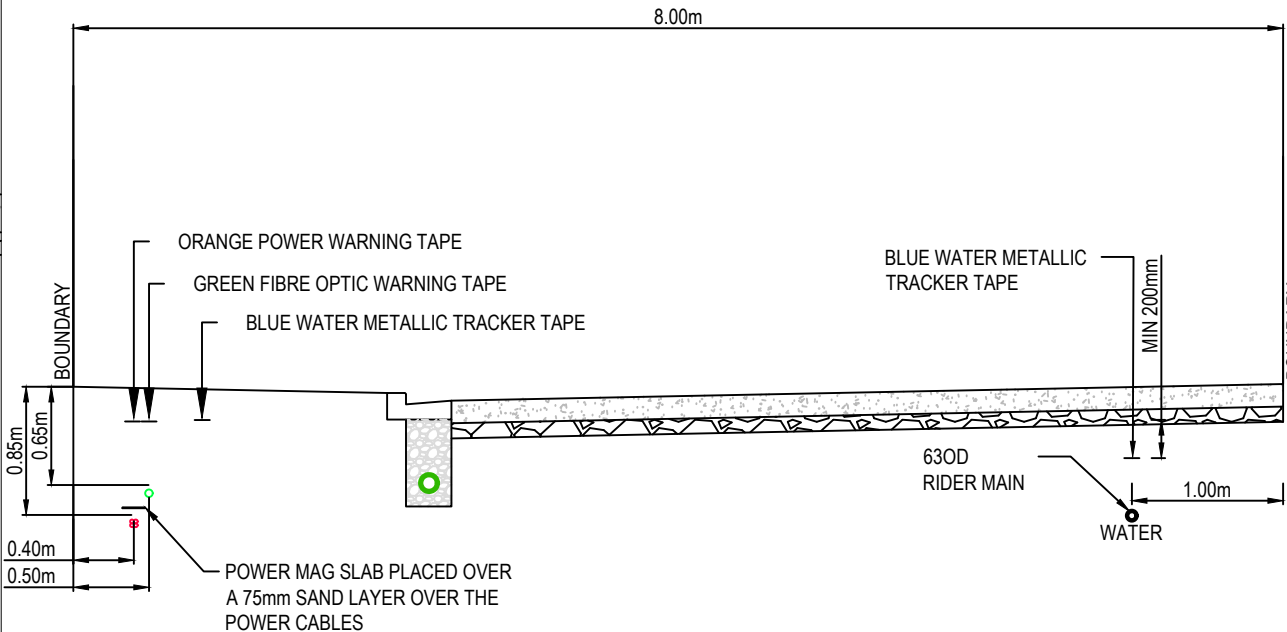

8m JOAL TYPICAL SERVICE TRENCH (SERVING 5+ LOTS)
(TYPE 1)
SCALE @ A3 1:50

- Notes
1. All works to be in accordance with local council standards.
 2. Co-ordinates in terms of Mount Eden 2000
 3. Reduced levels in terms of NZVD 2016.
 4. Benchmark: IT I DPS 29877 RL: 65.19
 5. The Contractors shall obtain all necessary approval from utility operators before commencing work under or near their services.
 6. Final pavement design subject to CBR/Beam tests on subgrade material.
 7. Setout schedule with co-ordinates of chainage points along road centerline to be supplied to the Contractors prior to construction.
 8. Refer to long section for finished centerline levels. Refer to typical cross sections to obtain levels for other locations.
 9. Vehicle crossing to be constructed by others unless otherwise stated.
 10. The Contractor may, with the agreement of the Engineer, adopt the alternative pavement design as specified on typical cross section, provided that the subgrade can achieve a minimum of CBR 3.
 11. Subgrade testing required, contractor shall notify engineer of any results below CBR of 3%. Engineer to advise on the additional pavement requirements or Subgrade remediation.

C	FAST TRACK APP	RJM	05/2025
B	FAST TRACK APP	RJM	04/2025
A	FAST TRACK APP	TCH	04/2025
Rev	Description	By	Date
		By	Date
Survey	MAVEN		03/2024
Design	AP		03/2024
Drawn	AP		03/2024
Checked	DJM		05/2025

M **Maven Associates**
09 571 0050
info@maven.co.nz
www.maven.co.nz
5 Owens Road, Epsom
Auckland 1023

Project
**ASHBOURNE
RESIDENTIAL
FOR
MATAMATA
DEVELOPMENTS**

Title
**TYPICAL ROAD
CROSS SECTION
SHEET 6 OF 7**

Project no.	289001		
Scale	AS SHOWN		
Cad file	C340-TYP RD SECTION.DWG		
Drawing no.	C340-6	Rev	C

RESOURCE CONSENT

DATE: 5/2/25 FILEPATH: F:\MAVEN\HAMITON6 - PROJECTS\88001 - STATION ROAD.TYP DRAWING:11 ASHBOURNE RESIDENTIAL\C340-TYP RD SECTION.DWG

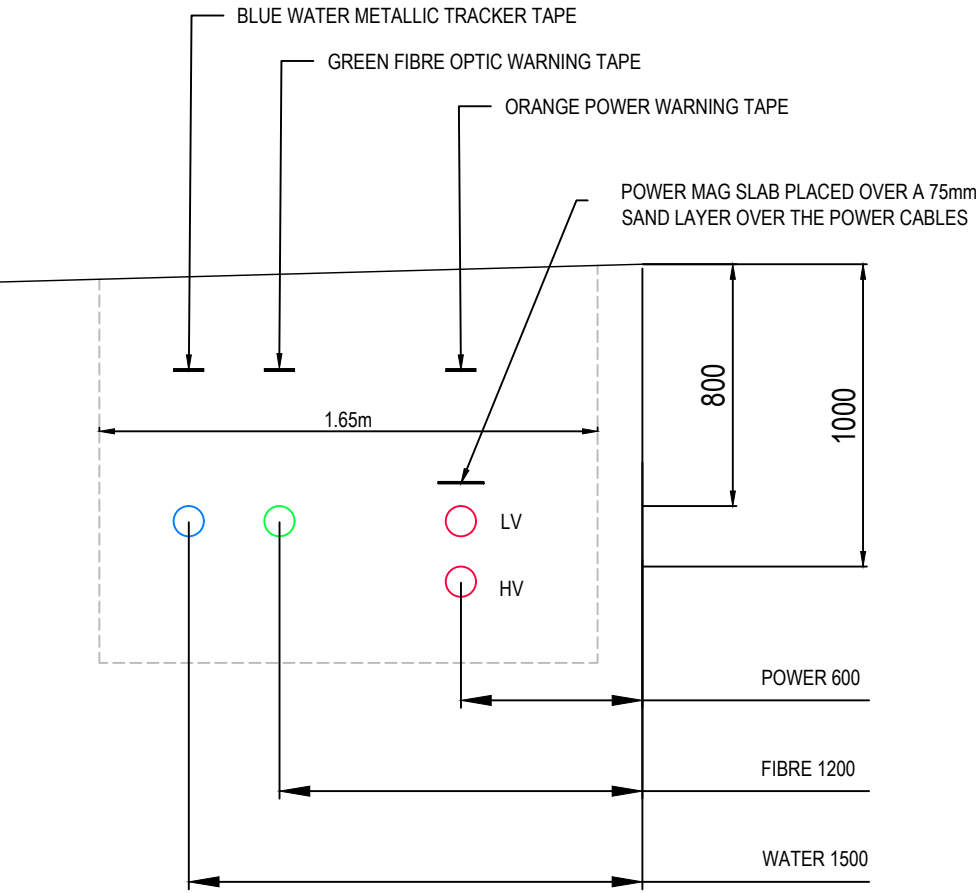

TYPICAL SERVICE TRENCH CROSS SECTION (PUBLIC ROAD)
(TYPE 1)
SCALE 1:25@ A3

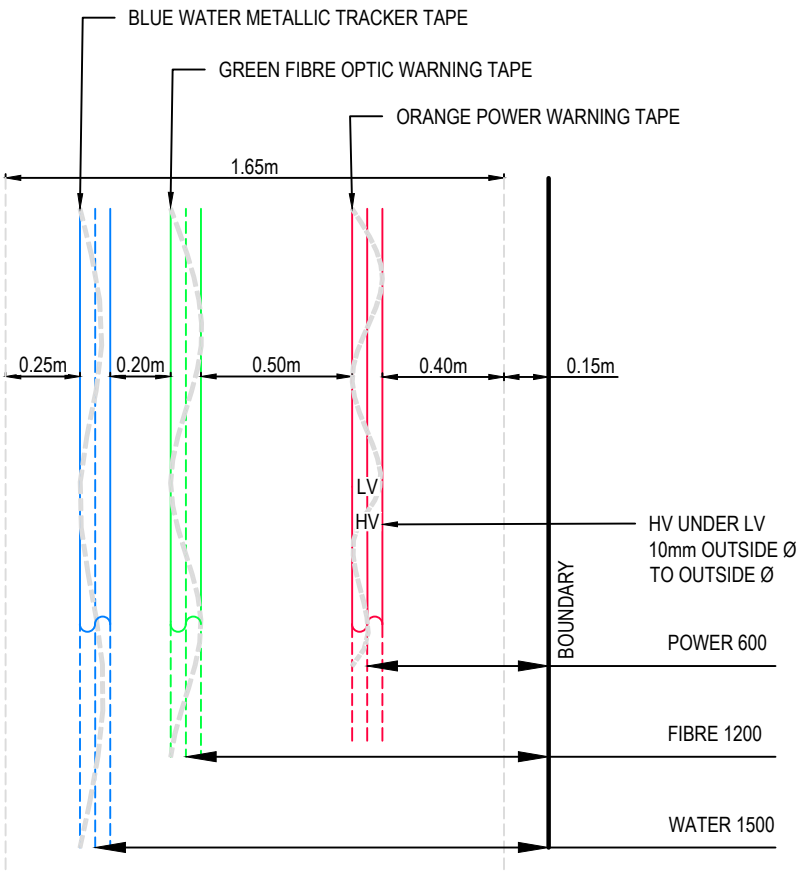

TYPICAL SERVICE TRENCH PLAN VIEW (PUBLIC ROAD)
(TYPE 1)
SCALE 1:25@ A3

RESOURCE CONSENT

- Notes
1. All works to be in accordance with local council standards.
 2. Co-ordinates in terms of Mount Eden 2000
 3. Reduced levels in terms of NZVD 2016.
 4. Benchmark: IT I DPS 29877 RL: 65.19
 5. The Contractors shall obtain all necessary approval from utility operators before commencing work under or near their services.
 6. Final pavement design subject to CBR/Beam tests on subgrade material.
 7. Setout schedule with co-ordinates of chainage points along road centerline to be supplied to the Contractors prior to construction.
 8. Refer to long section for finished centerline levels. Refer to typical cross sections to obtain levels for other locations.
 9. Vehicle crossing to be constructed by others unless otherwise stated.
 10. The Contractor may, with the agreement of the Engineer, adopt the alternative pavement design as specified on typical cross section, provided that the subgrade can achieve a minimum of CBR 3.
 11. Subgrade testing required, contractor shall notify engineer of any results below CBR of 3%. Engineer to advise on the additional pavement requirements or Subgrade remediation.

C	FAST TRACK APP	RJM	05/2025
B	FAST TRACK APP	RJM	04/2025
A	FAST TRACK APP	TCH	04/2025
Rev	Description	By	Date
	By	Date	
Survey	MAVEN	03/2024	
Design	AP	03/2024	
Drawn	AP	03/2024	
Checked	DJM	05/2025	

M

MAVEN

Maven Associates

09 571 0050

info@maven.co.nz

www.maven.co.nz

5 Owens Road, Epsom

Auckland 1023

Project
**ASHBOURNE
RESIDENTIAL
FOR
MATAMATA
DEVELOPMENTS**

Title
**TYPICAL ROAD
CROSS SECTION
SHEET 6 OF 7**

Project no.	289001		
Scale	AS SHOWN		
Cad file	C340-TYP RD SECTION.DWG		
Drawing no.	C340-7	Rev	C