



PROPOSED
NORTHERN SOLAR FARM

STATION ROAD

STATION ROAD

BALANCE LOT

PROPOSED
RETIREMENT VILLAGE

PROPOSED GREENWAY

PROPOSED
SOUTHERN SOLAR FARM

LOT 3 DP 463448

LOT 1 DP 463448

RESOURCE CONSENT

Notes

1. All works to be in accordance with Waikato Regional Infrastructure Technical Specifications.
2. Co-ordinates in terms of NZ Geodetic Datum Mount Eden 2000.
3. Levels in terms of the New Zealand Vertical Datum 2016.
4. It is the contractors responsibility to locate all services that may be affected by his operations.
5. Approved hardfill is to be used in backfilling of all stormwater lines within the road reserve.
6. All catchpit leads shall be laid at 1% unless otherwise specified.
7. All lines to be abandoned shall be sealed at each end. Timing of all sealing to be coordinated with council staff.

Legend

- EX BOUNDARY
- PROP LOT BOUNDARY
- PROP SWMH 1050mmØ
- PROP SCRUFFY DOME
- SOAKAGE TRENCH - 1.2m WIDE
- SOAKAGE TRENCH - 2m WIDE
- RAINGARDEN - 1.2m / 2.3m WIDE

C	FAST TACK APP	NDL	05/2025
B	FAST TRACK APP	NDL	04/2025
A	FAST TRACK APPLICATION	NDL	04/2025
Rev	Description	By	Date
Survey	MAVEN		05/2024
Design	MKS		04/2025
Drawn	NDL		04/2025
Checked	DJM		05/2025

M Maven Associates
09 571 0050
info@maven.co.nz
www.maven.co.nz
5 Owens Road, Epsom
Auckland 1023

Project
**ASHBOURNE
RESIDENTIAL
FOR
MATAMATA
DEVELOPMENTS LTD**

Title
**PROPOSED
STORMWATER
OVERVIEW PLAN**

Project no.	289001		
Scale	1:6000 @ A3		
Cad file	C400-STORMWATER.DWG		
Drawing no.	C400	Rev	C

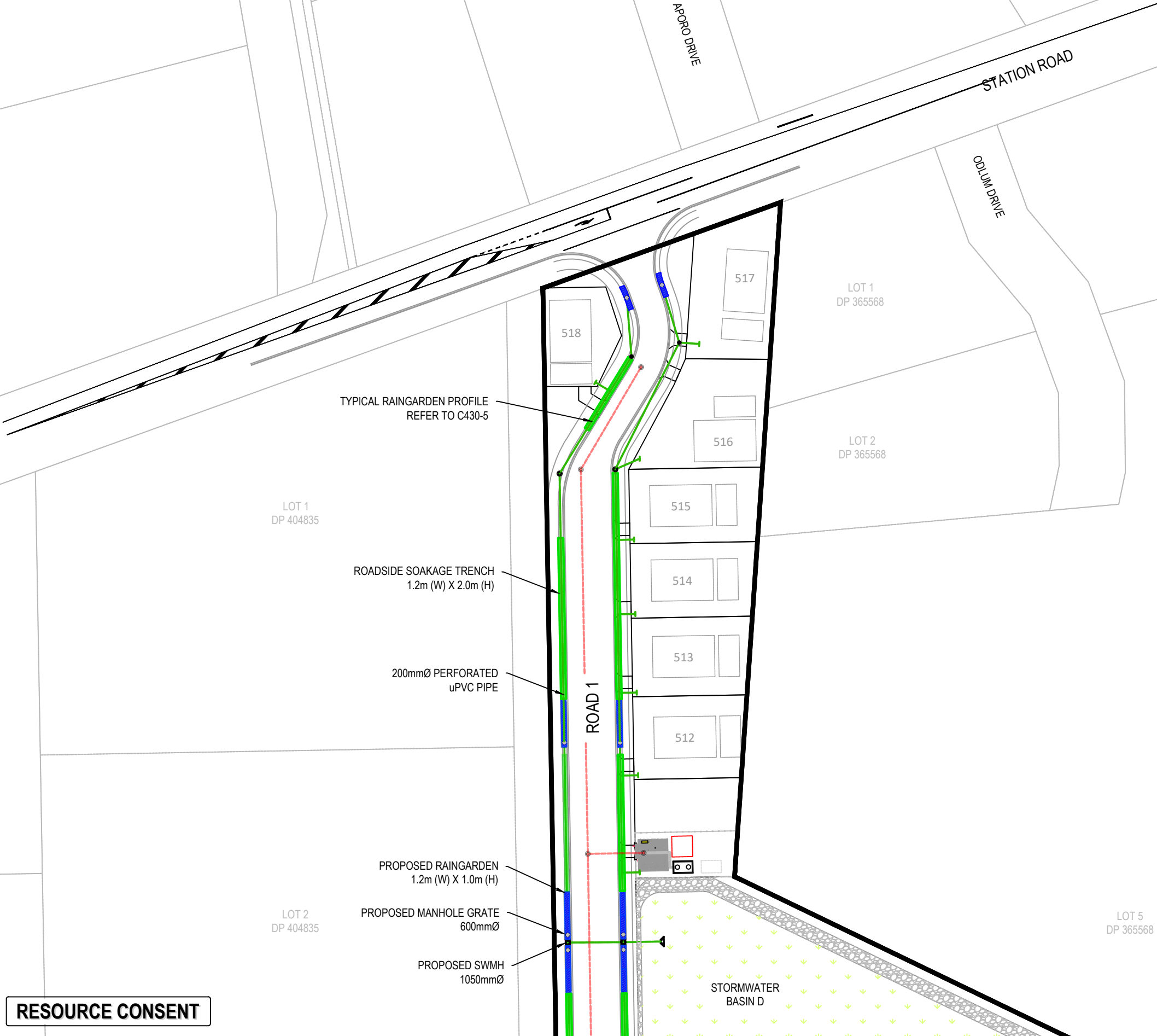

- Notes
1. All works to be in accordance with Waikato Regional Infrastructure Technical Specifications.
 2. Co-ordinates in terms of NZ Geodetic Datum Mount Eden 2000.
 3. Levels in terms of the New Zealand Vertical Datum 2016.
 4. It is the contractors responsibility to locate all services that may be affected by his operations.
 5. Approved hardfill is to be used in backfilling of all stormwater lines within the road reserve.
 6. All catchpit leads shall be laid at 1% unless otherwise specified.
 7. All lines to be abandoned shall be sealed at each end. Timing of all sealing to be coordinated with council staff.

Legend	
	EX BOUNDARY
	PROP LOT BOUNDARY
	PROP SWMH 1050mmØ
	PROP MANHOLE GRATE
	SOAKAGE TRENCH - 1.2m WIDE
	SOAKAGE TRENCH - 2m WIDE
	RAINGARDEN - 1.2m / 2.3m WIDE

Rev	Description	By	Date
C	FAST TRACK APP	NDL	05/2025
B	FAST TRACK APP	NDL	04/2025
A	FAST TRACK APP	NDL	04/2025
Survey			05/2024
Design	MKS		04/2025
Drawn	NDL		04/2025
Checked	DJM		05/2025

M **Maven Associates**
09 571 0050
info@maven.co.nz
www.maven.co.nz
5 Owens Road, Epsom
Auckland 1023

Project
**ASHBOURNE
RESIDENTIAL
FOR
MATAMATA
DEVELOPMENTS LTD**

Title
**PROPOSED
STORMWATER
PLAN**

Project no.	289001		
Scale	1:1000 @ A3		
Cad file	C400-STORMWATER.DWG		
Drawing no.	C400-1	Rev	C

RESOURCE CONSENT



OLIVE PLACE

LOT 9
DP 562902

LOT 13
DP 562902

LOT 14
DP 562902

LOT 3
DP 404835

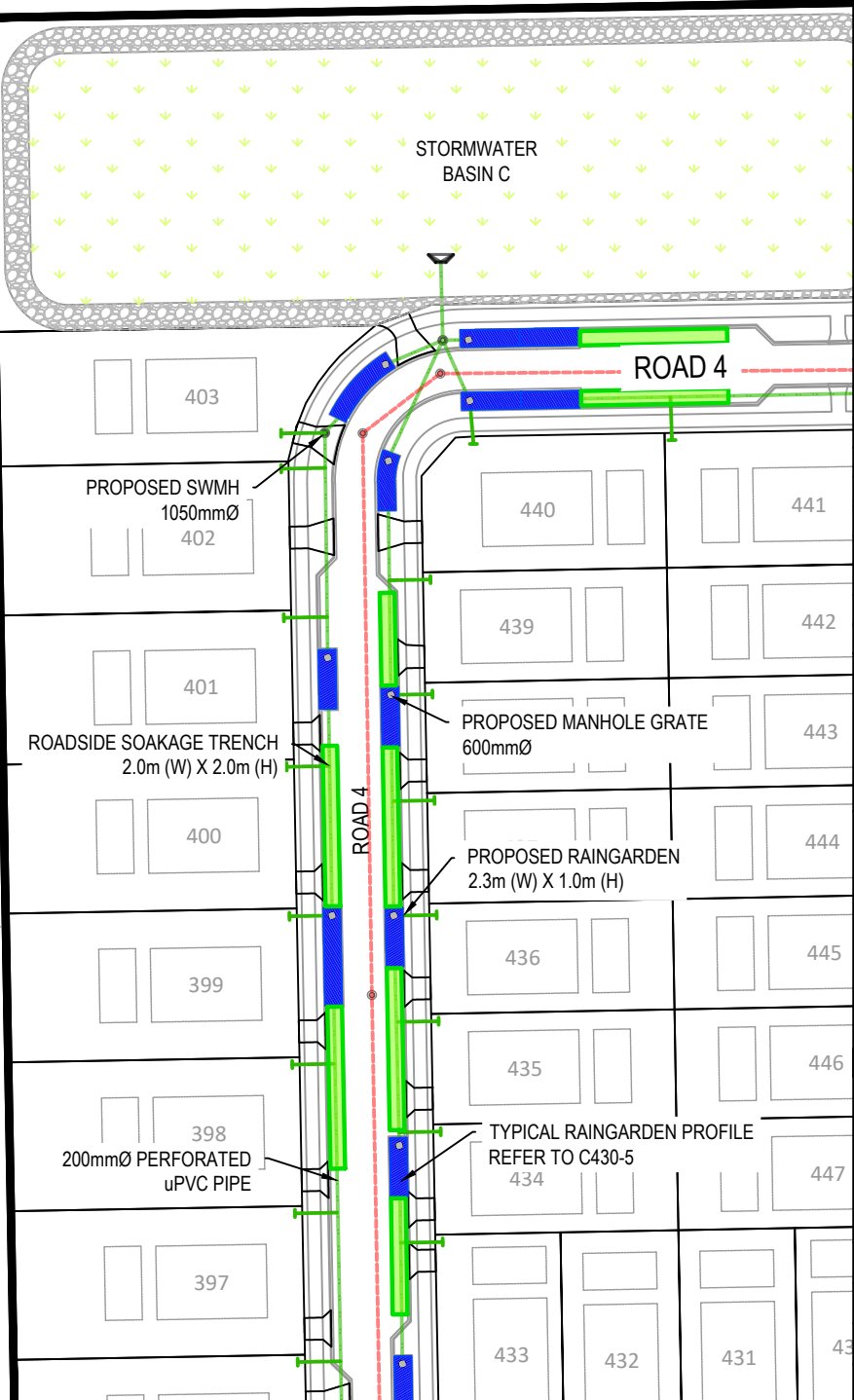

- Notes
1. All works to be in accordance with Waikato Regional Infrastructure Technical Specifications.
 2. Co-ordinates in terms of NZ Geodetic Datum Mount Eden 2000.
 3. Levels in terms of the New Zealand Vertical Datum 2016.
 4. It is the contractors responsibility to locate all services that may be affected by his operations.
 5. Approved hardfill is to be used in backfilling of all stormwater lines within the road reserve.
 6. All catchpit leads shall be laid at 1% unless otherwise specified.
 7. All lines to be abandoned shall be sealed at each end. Timing of all sealing to be coordinated with council staff.

Legend

- EX BOUNDARY
- PROP LOT BOUNDARY
- PROP SWMH 1050mmØ
- PROP MANHOLE GRATE
- SOAKAGE TRENCH - 1.2m WIDE
- SOAKAGE TRENCH - 2m WIDE
- RAINGARDEN - 1.2m / 2.3m WIDE

C	FAST TRACK APP	NDL	05/2025
B	FAST TRACK APP	NDL	04/2025
A	FAST TRACK APP	NDL	04/2025
Rev	Description	By	Date
	Survey	MAVEN	05/2024
	Design	MKS	04/2025
	Drawn	NDL	04/2025
	Checked	DJM	05/2025

M **Maven Associates**
09 571 0050
info@maven.co.nz
www.maven.co.nz
5 Owens Road, Epsom
Auckland 1023

Project
**ASHBOURNE
RESIDENTIAL
FOR
MATAMATA
DEVELOPMENTS LTD**

Title
**PROPOSED
STORMWATER
PLAN**

Project no.	289001		
Scale	1:1000 @ A3		
Cad file	C400-STORMWATER.DWG		
Drawing no.	C400-2	Rev	C

RESOURCE CONSENT

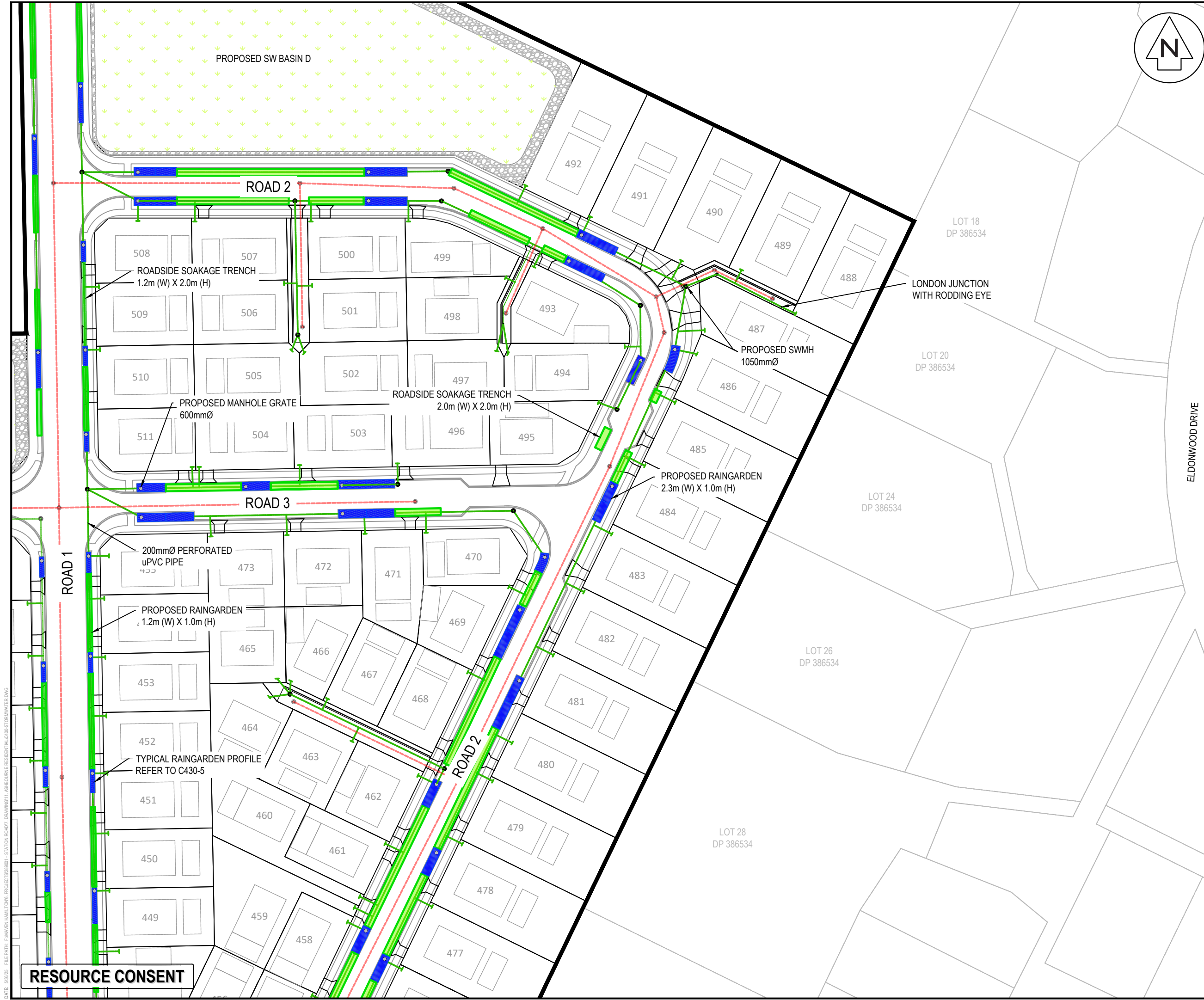

- Notes
1. All works to be in accordance with Waikato Regional Infrastructure Technical Specifications.
 2. Co-ordinates in terms of NZ Geodetic Datum Mount Eden 2000.
 3. Levels in terms of the New Zealand Vertical Datum 2016.
 4. It is the contractors responsibility to locate all services that may be affected by his operations.
 5. Approved hardfill is to be used in backfilling of all stormwater lines within the road reserve.
 6. All catchpit leads shall be laid at 1% unless otherwise specified.
 7. All lines to be abandoned shall be sealed at each end. Timing of all sealing to be coordinated with council staff.

Legend	
---	EX BOUNDARY
---	PROP LOT BOUNDARY
●	PROP SWMH 1050mmØ
●	PROP MANHOLE GRATE
█	SOAKAGE TRENCH - 1.2m WIDE
█	SOAKAGE TRENCH - 2m WIDE
█	RAINGARDEN - 1.2m / 2.3m WIDE

Rev	Description	By	Date
C	FAST TRACK APP	NDL	05/2025
B	FAST TRACK APP	NDL	04/2025
A	FAST TRACK APP	NDL	04/2025

Rev	Description	By	Date
Survey	MAVEN		05/2024
Design	MKS		04/2025
Drawn	RJM		04/2025
Checked	DJM		05/2025

M Maven Associates
09 571 0050
info@maven.co.nz
www.maven.co.nz
5 Owens Road, Epsom
Auckland 1023

Project
**ASHBOURNE
RESIDENTIAL
FOR
MATAMATA
DEVELOPMENTS LTD**

Title
**PROPOSED
STORMWATER
PLAN**

Project no.	289001		
Scale	1:1000 @ A3		
Cad file	C400-STORMWATER.DWG		
Drawing no.	C400-3	Rev	C



DATE: 5/20/25 FILEPATH: F:\MVEN\HAMITON6 PROJECTS\88001 - STATION ROAD\ DRAWING\01 - ASHBORNE RESIDENTIAL\0400-01\0400-01.DWG

RESOURCE CONSENT

HIGHGROVE AVENUE

LOT 16
DP 562902

LOT 17
DP 562902

LOT 18
DP 562902

LOT 2
DP 21055

TYPICAL RAINGARDEN PROFILE
REFER TO C430-5

PROPOSED SWMH
1050mmØ

ROADSIDE SOAKAGE TRENCH
2.0m (W) X 2.0m (H)

PROPOSED RAINGARDEN
2.3m (W) X 1.0m (H)

200mmØ PERFORATED
uPVC PIPE

PROPOSED MANHOLE GRATE
600mmØ

Notes

1. All works to be in accordance with Waikato Regional Infrastructure Technical Specifications.
2. Co-ordinates in terms of NZ Geodetic Datum Mount Eden 2000.
3. Levels in terms of the New Zealand Vertical Datum 2016.
4. It is the contractors responsibility to locate all services that may be affected by his operations.
5. Approved hardfill is to be used in backfilling of all stormwater lines within the road reserve.
6. All catchpit leads shall be laid at 1% unless otherwise specified.
7. All lines to be abandoned shall be sealed at each end. Timing of all sealing to be coordinated with council staff.

Legend

- EX BOUNDARY
- PROP LOT BOUNDARY
- PROP SWMH 1050mmØ
- PROP MANHOLE GRATE
- SOAKAGE TRENCH - 1.2m WIDE
- SOAKAGE TRENCH - 2m WIDE
- RAINGARDEN - 1.2m / 2.3m WIDE

Rev	Description	By	Date
C	FAST TRACK APP	NDL	05/2025
B	FAST TRACK APP	NDL	04/2025
A	FAST TRACK APPLICATION	NDL	04/2025
Rev	Description	By	Date
Survey	MAVEN		05/2024
Design	MKS		04/2025
Drawn	NDL		04/2025
Checked	DJM		05/2025



Project
**ASHBOURNE
RESIDENTIAL
FOR
MATAMATA
DEVELOPMENTS LTD**

Title
**PROPOSED
STORMWATER
PLAN**

Project no.	289001
Scale	1:1000 @ A3
Cad file	C400-STORMWATER.DWG
Drawing no.	C400-4
Rev	C

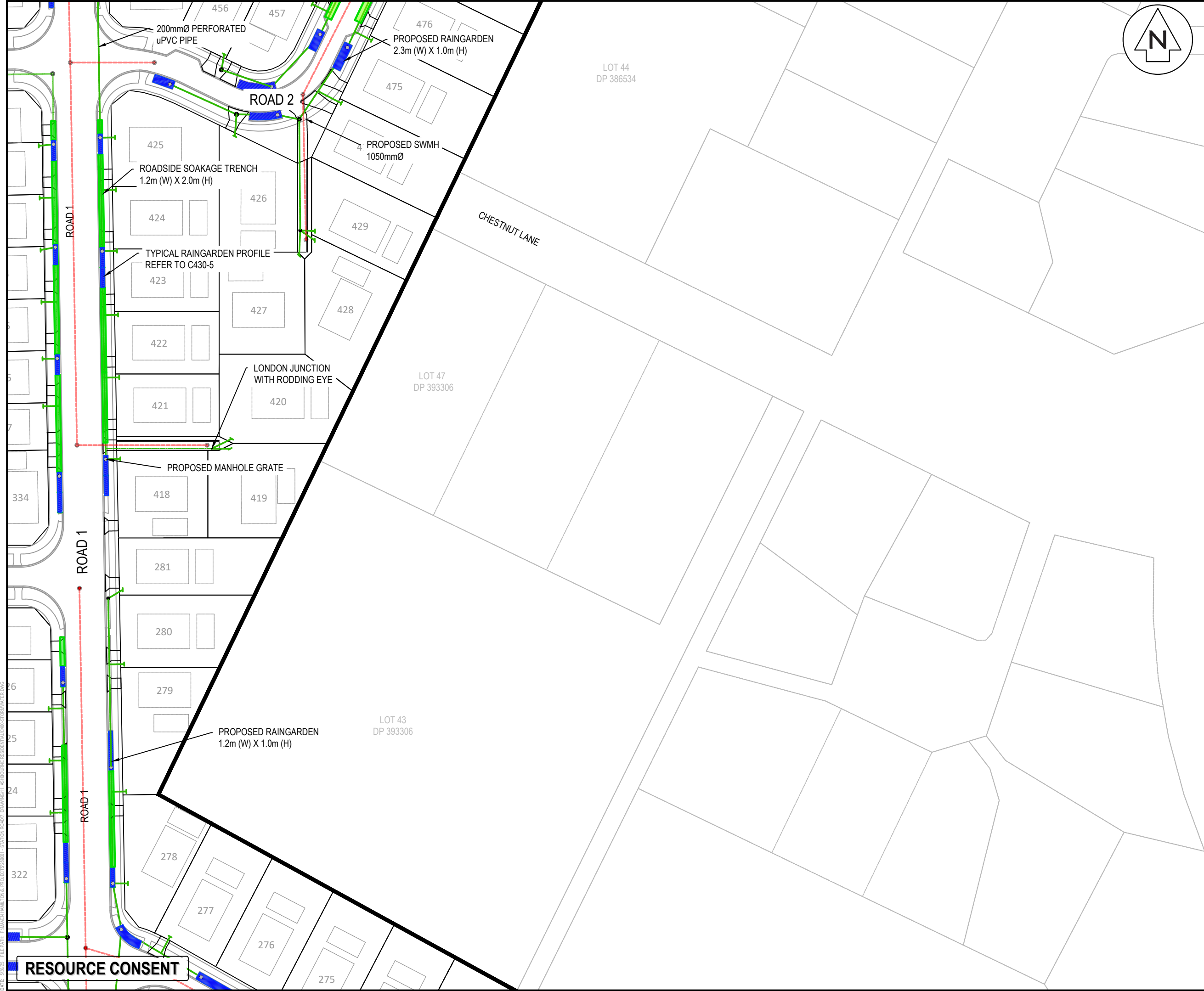

- Notes
1. All works to be in accordance with Waikato Regional Infrastructure Technical Specifications.
 2. Co-ordinates in terms of NZ Geodetic Datum Mount Eden 2000.
 3. Levels in terms of the New Zealand Vertical Datum 2016.
 4. It is the contractors responsibility to locate all services that may be affected by his operations.
 5. Approved hardfill is to be used in backfilling of all stormwater lines within the road reserve.
 6. All catchpit leads shall be laid at 1% unless otherwise specified.
 7. All lines to be abandoned shall be sealed at each end. Timing of all sealing to be coordinated with council staff.

Legend	
	EX BOUNDARY
	PROP LOT BOUNDARY
	PROP SWMH 1050mmØ
	PROP MANHOLE GRATE
	SOAKAGE TRENCH - 1.2m WIDE
	SOAKAGE TRENCH - 2m WIDE
	RAINGARDEN - 1.2m / 2.3m WIDE

C	FAST TRACK APP	NDL	05/2025
B	FAST TRACK APP	NDL	04/2025
A	FAST TRACK APP	NDL	04/2025
Rev	Description	By	Date
		By	Date
Survey	MAVEN		05/2024
Design	MKS		04/2025
Drawn	NDL		04/2025
Checked	DJM		05/2025



Maven Associates
09 571 0050
info@maven.co.nz
www.maven.co.nz
5 Owens Road, Epsom
Auckland 1023

Project

**ASHBOURNE
RESIDENTIAL
FOR
MATAMATA
DEVELOPMENTS LTD**

Title

**PROPOSED
STORMWATER
PLAN**

Project no.	289001		
Scale	1:1000 @ A3		
Cad file	C400-STORMWATER.DWG		
Drawing no.	C400-5	Rev	C

RESOURCE CONSENT

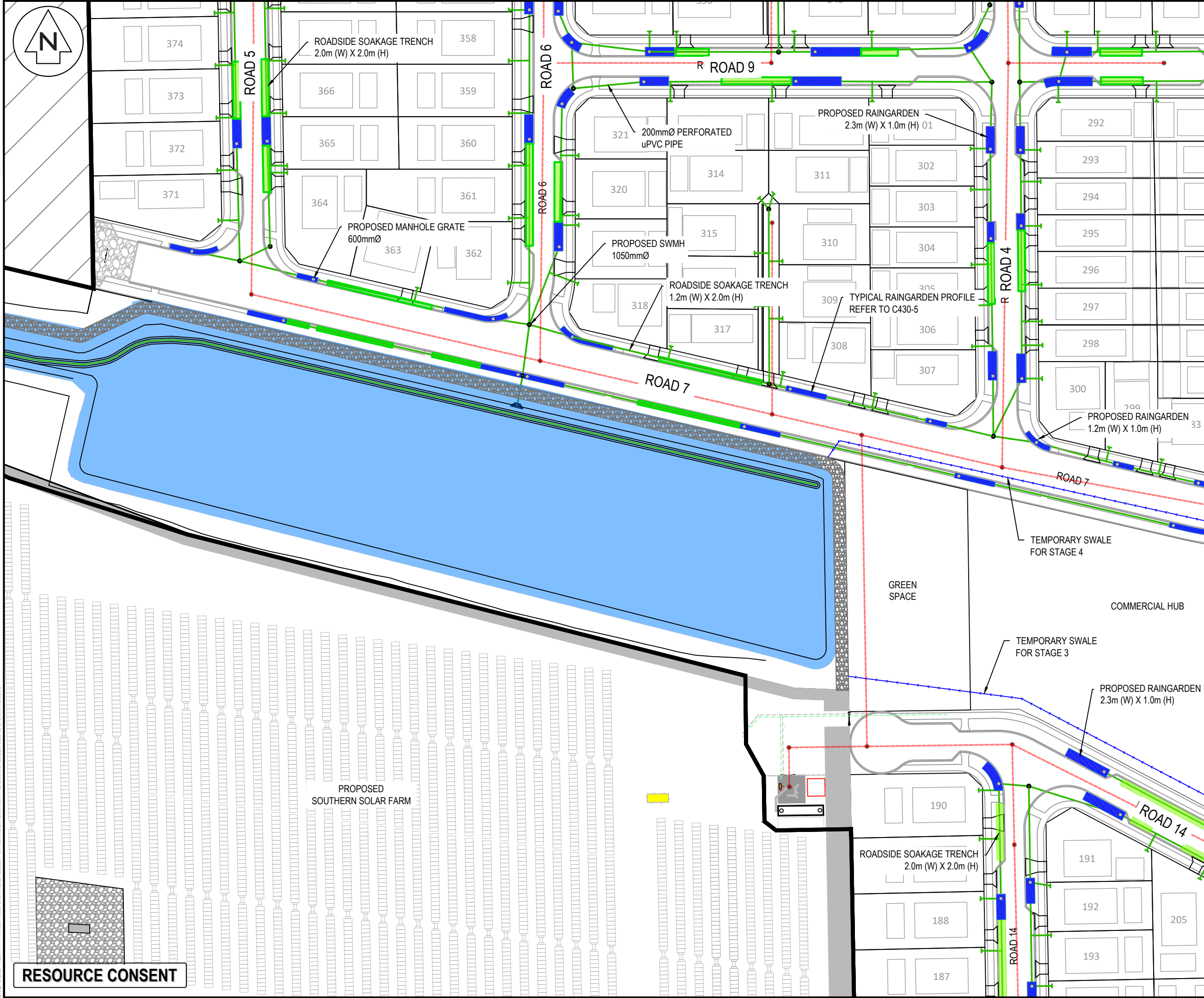

- Notes
1. All works to be in accordance with Waikato Regional Infrastructure Technical Specifications.
 2. Co-ordinates in terms of NZ Geodetic Datum Mount Eden 2000.
 3. Levels in terms of the New Zealand Vertical Datum 2016.
 4. It is the contractors responsibility to locate all services that may be affected by his operations.
 5. Approved hardfill is to be used in backfilling of all stormwater lines within the road reserve.
 6. All catchpit leads shall be laid at 1% unless otherwise specified.
 7. All lines to be abandoned shall be sealed at each end. Timing of all sealing to be coordinated with council staff.

Legend

- EX BOUNDARY
- PROP LOT BOUNDARY
- PROP SWMH 1050mmØ
- PROP MANHOLE GRATE
- SOAKAGE TRENCH - 1.2m WIDE
- SOAKAGE TRENCH - 2m WIDE
- RAINGARDEN - 1.2m / 2.3m WIDE

C	FAST TRACK APP	NDL	05/2025
B	FAST TRACK APP	NDL	04/2025
A	FAST TRACK APP	NDL	04/2025
Rev	Description	By	Date
		By	Date
Survey	MAVEN		05/2024
Design	MKS		04/2025
Drawn	NDL		04/2025
Checked	DJM		05/2025

M **Maven Associates**
09 571 0050
info@maven.co.nz
www.maven.co.nz
5 Owens Road, Epsom
Auckland 1023

Project
**ASHBOURNE
RESIDENTIAL
FOR
MATAMATA
DEVELOPMENTS LTD**

Title
**PROPOSED
STORMWATER
PLAN**

Project no.	289001
Scale	1:1000 @ A3
Cad file	C400-STORMWATER.DWG
Drawing no.	C400-6
Rev	C

DATE: 5/3/25 FILE PATH: F:\MAVEN\HAMITON6 PROJECTS\88001 - STATION ROAD.DWG DRAWING: 01 ASHBORNE RESIDENTIAL\0400-STORMWATER.DWG

RESOURCE CONSENT

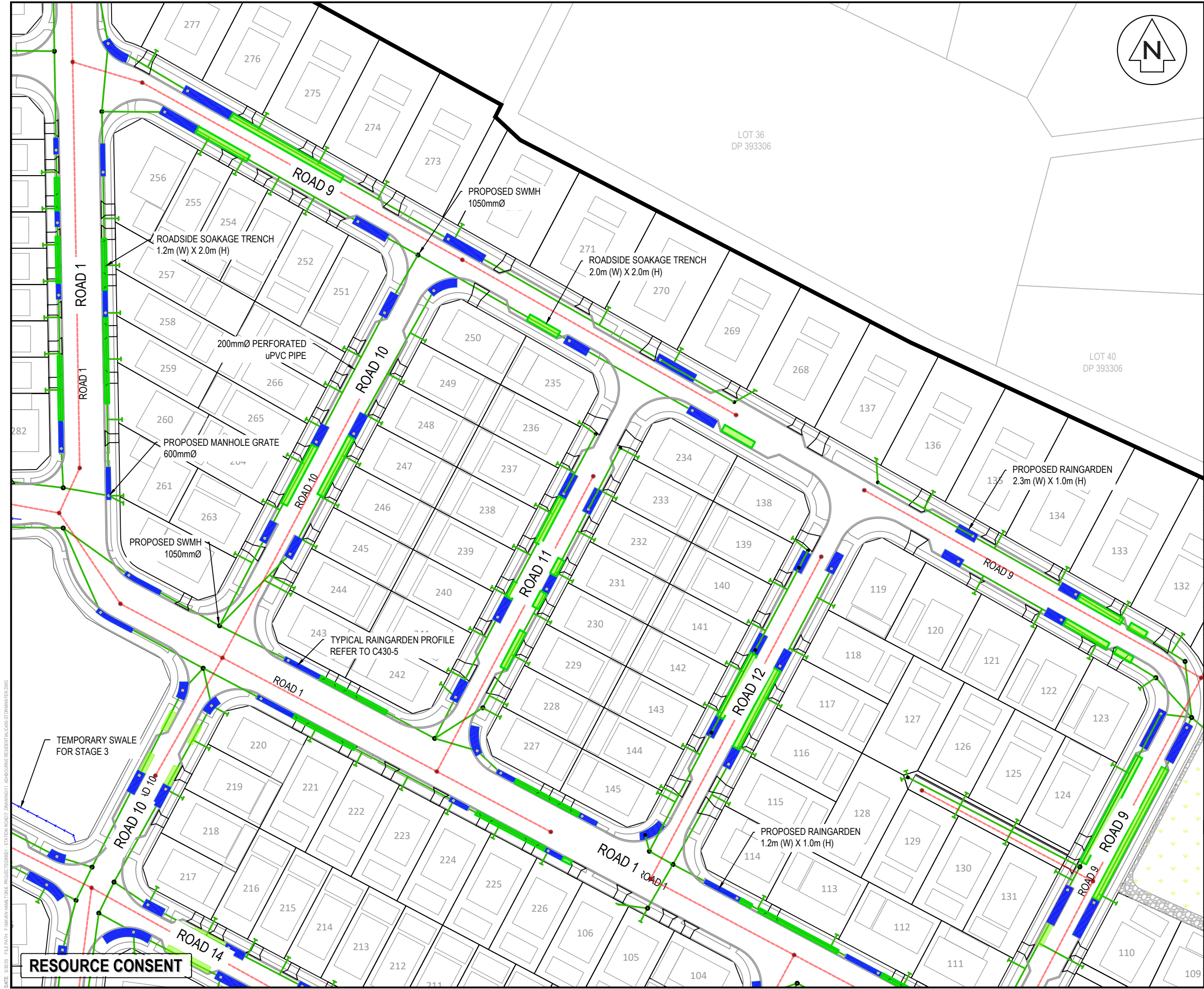

- Notes
1. All works to be in accordance with Waikato Regional Infrastructure Technical Specifications.
 2. Co-ordinates in terms of NZ Geodetic Datum Mount Eden 2000.
 3. Levels in terms of the New Zealand Vertical Datum 2016.
 4. It is the contractors responsibility to locate all services that may be affected by his operations.
 5. Approved hardfill is to be used in backfilling of all stormwater lines within the road reserve.
 6. All catchpit leads shall be laid at 1% unless otherwise specified.
 7. All lines to be abandoned shall be sealed at each end. Timing of all sealing to be coordinated with council staff.

Legend	
	EX BOUNDARY
	PROP LOT BOUNDARY
	PROP SWMH 1050mmØ
	PROP MANHOLE GRATE
	SOAKAGE TRENCH - 1.2m WIDE
	SOAKAGE TRENCH - 2m WIDE
	RAINGARDEN - 1.2m / 2.3m WIDE

C	FAST TRACK APP	MKS	05/2025
B	FAST TRACK APP	NDL	04/2025
A	FAST TRACK APP	NDL	04/2025
Rev	Description	By	Date
		By	Date
Survey	MAVEN		05/2024
Design	MKS		04/2025
Drawn	NDL		04/2025
Checked	DJM		05/2025



Maven Associates
09 571 0050
info@maven.co.nz
www.maven.co.nz
5 Owens Road, Epsom
Auckland 1023

Project
**ASHBOURNE
RESIDENTIAL
FOR
MATAMATA
DEVELOPMENTS LTD**

Title
**PROPOSED
STORMWATER
PLAN**

Project no.	289001
Scale	1:1000 @ A3
Cad file	C400-STORMWATER.DWG
Drawing no.	C400-7
Rev	C

DATE: 5/3/25 FILEPATH: F:\MVEN\HAMTON6 PROJECTS\88001 - STATION ROAD.DWG DRAWING:11 ASHBORNE RESIDENTIAL C400 STORMWATER.DWG

RESOURCE CONSENT

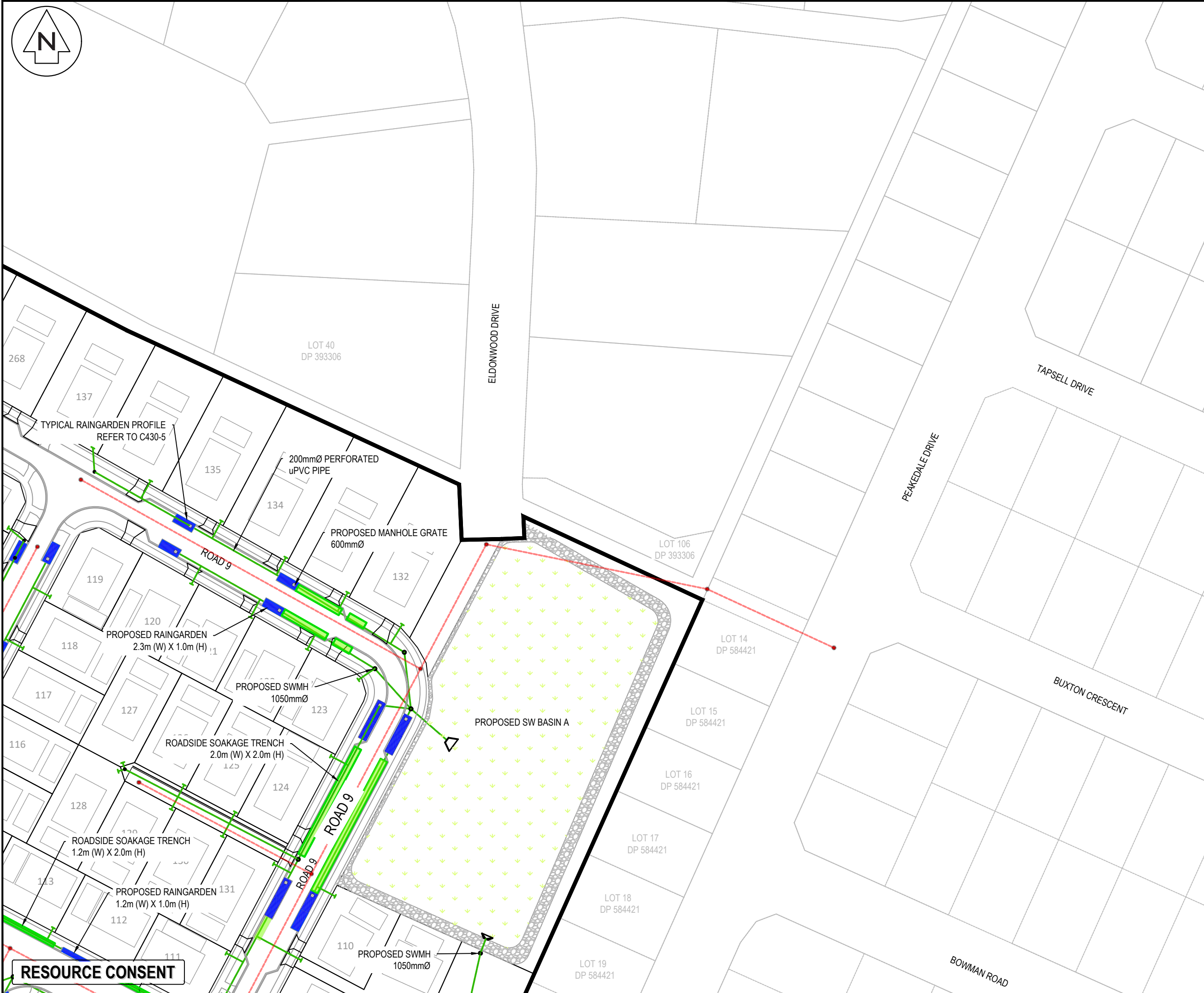

- Notes
1. All works to be in accordance with Waikato Regional Infrastructure Technical Specifications.
 2. Co-ordinates in terms of NZ Geodetic Datum Mount Eden 2000.
 3. Levels in terms of the New Zealand Vertical Datum 2016.
 4. It is the contractors responsibility to locate all services that may be affected by his operations.
 5. Approved hardfill is to be used in backfilling of all stormwater lines within the road reserve.
 6. All catchpit leads shall be laid at 1% unless otherwise specified.
 7. All lines to be abandoned shall be sealed at each end. Timing of all sealing to be coordinated with council staff.

Legend	
	EX BOUNDARY
	PROP LOT BOUNDARY
	PROP SWMH 1050mmØ
	PROP MANHOLE GRATE
	SOAKAGE TRENCH - 1.2m WIDE
	SOAKAGE TRENCH - 2m WIDE
	RAINGARDEN - 1.2m / 2.3m WIDE

C	FAST TRACK APP	NDL	05/2025
B	FAST TRACK APP	NDL	04/2025
A	FAST TRACK APP	NDL	04/2025
Rev	Description	By	Date
Survey	MAVEN		05/2024
Design	MKS		04/2025
Drawn	NDL		04/2025
Checked	DJM		05/2025



Maven Associates
09 571 0050
info@maven.co.nz
www.maven.co.nz
5 Owens Road, Epsom
Auckland 1023

Project
**ASHBOURNE
RESIDENTIAL
FOR
MATAMATA
DEVELOPMENTS LTD**

Title
**PROPOSED
STORMWATER
PLAN**

Project no.	289001		
Scale	1:1000 @ A3		
Cad file	C400-STORMWATER.DWG		
Drawing no.	C400-8	Rev	C

DATE: 5/3/25 FILEPATH: F:\Maven\HAMTON6 - PROJECTS\88001 - STATION ROAD.DWG DRAWING: 11 ASHBORNE RESIDENTIAL C400-STORMWATER.DWG

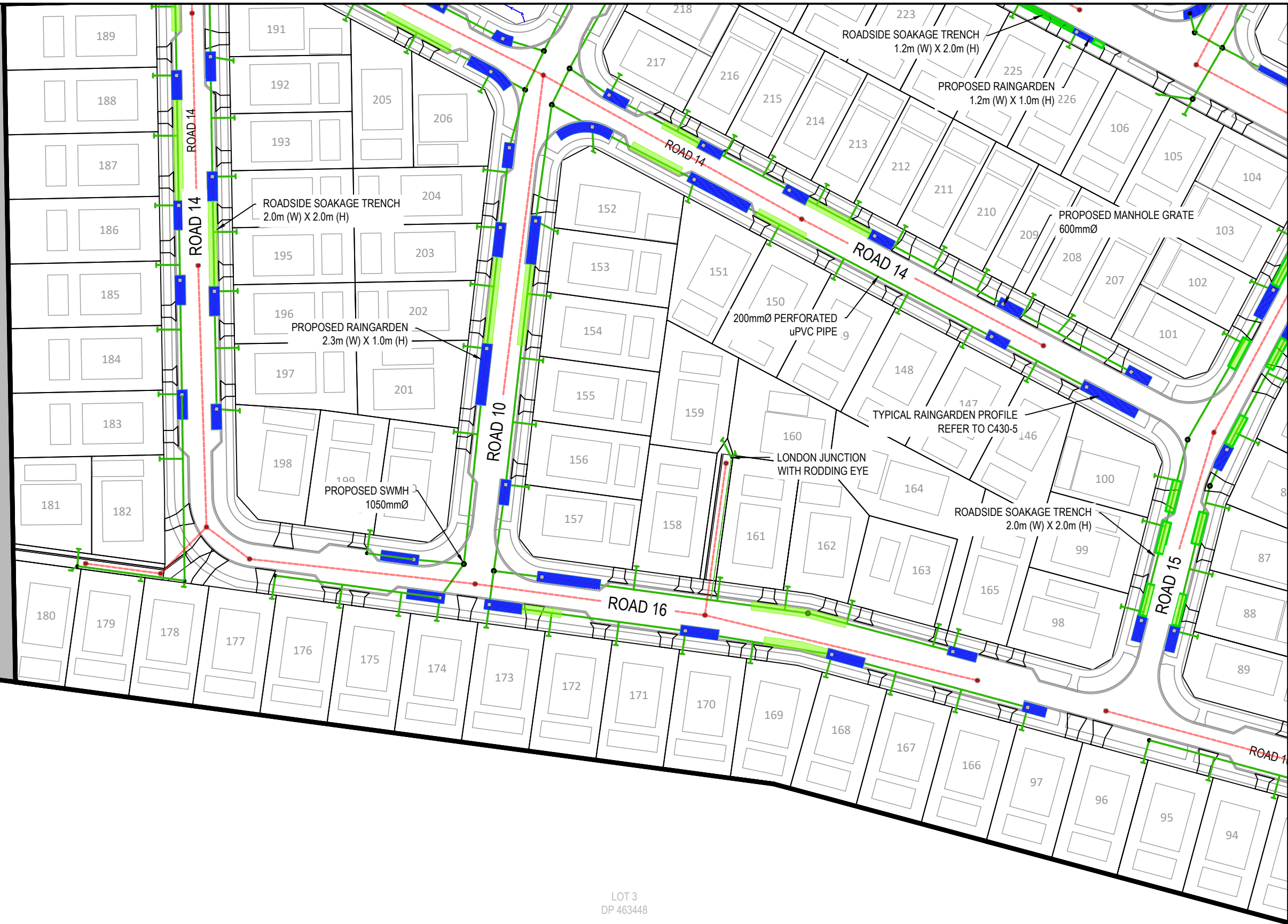
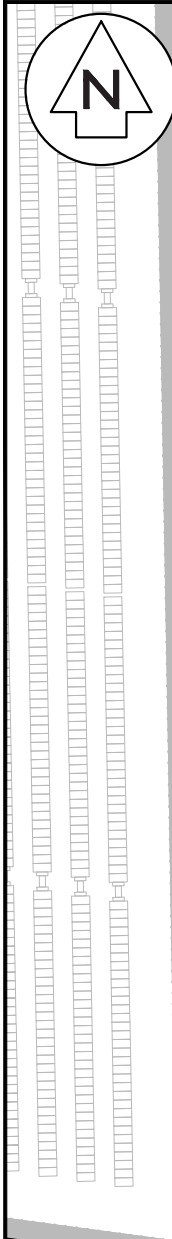

- Notes
1. All works to be in accordance with Waikato Regional Infrastructure Technical Specifications.
 2. Co-ordinates in terms of NZ Geodetic Datum Mount Eden 2000.
 3. Levels in terms of the New Zealand Vertical Datum 2016.
 4. It is the contractors responsibility to locate all services that may be affected by his operations.
 5. Approved hardfill is to be used in backfilling of all stormwater lines within the road reserve.
 6. All catchpit leads shall be laid at 1% unless otherwise specified.
 7. All lines to be abandoned shall be sealed at each end. Timing of all sealing to be coordinated with council staff.

Legend

	EX BOUNDARY
	PROP LOT BOUNDARY
	PROP SWMH 1050mmØ
	PROP MANHOLE GRATE
	SOAKAGE TRENCH - 1.2m WIDE
	SOAKAGE TRENCH - 2m WIDE
	RAINGARDEN - 1.2m / 2.3m WIDE

C	FAST TRACK APP	NDL	05/2025
B	FAST TRACK APP	NDL	04/2025
A	FAST TRACK APP	NDL	04/2025
Rev	Description	By	Date
		By	Date
Survey	MAVEN		05/2024
Design	MKS		04/2025
Drawn	NDL		04/2025
Checked	DJM		05/2025

Maven Associates
09 571 0050
info@maven.co.nz
www.maven.co.nz
5 Owens Road, Epsom
Auckland 1023

Project
**ASHBOURNE
RESIDENTIAL
FOR
MATAMATA
DEVELOPMENTS LTD**

Title
**PROPOSED
STORMWATER
PLAN**

Project no.	289001		
Scale	1:1000 @ A3		
Cad file	C400-STORMWATER.DWG		
Drawing no.	C400-9	Rev	C

RESOURCE CONSENT

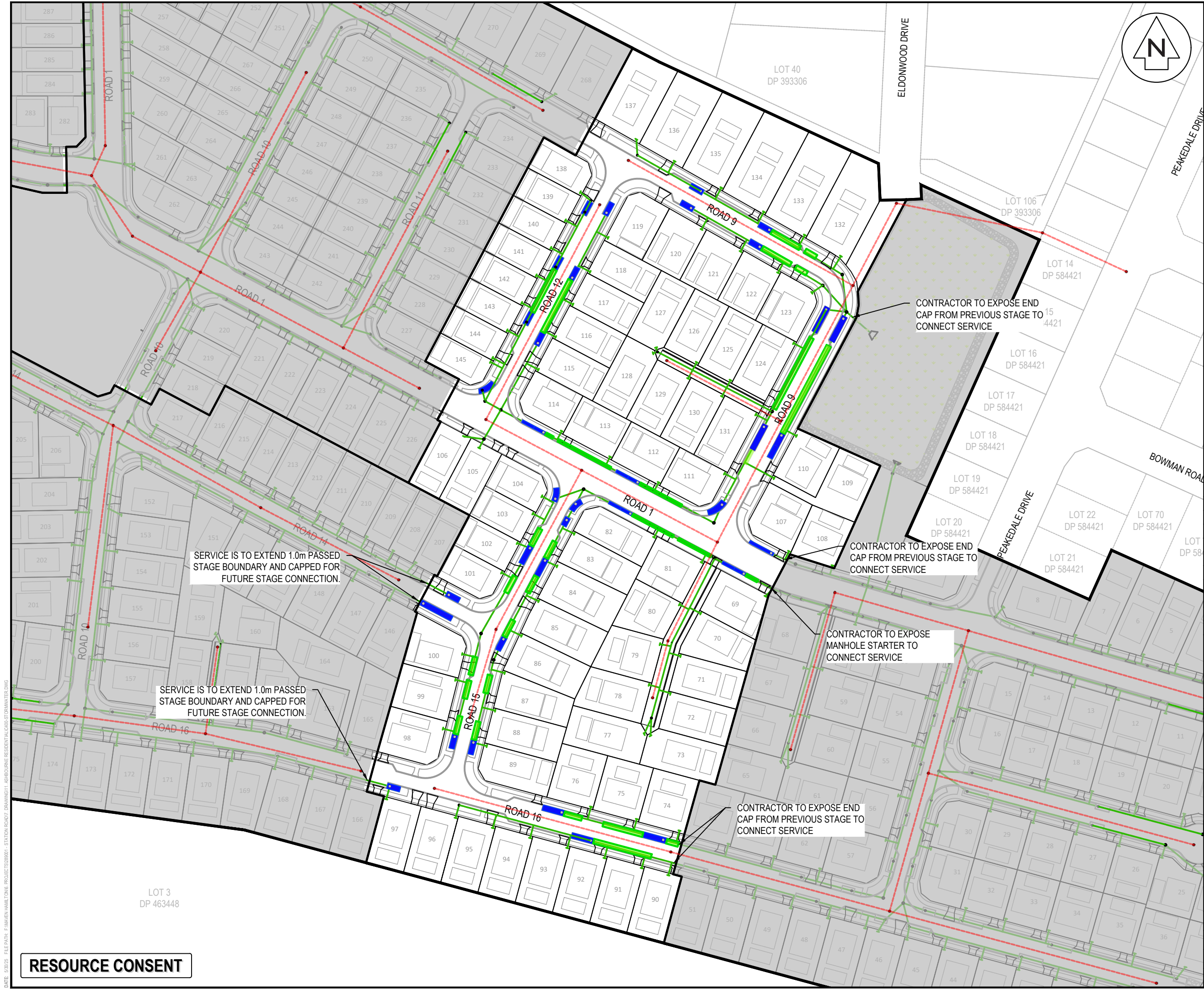

- Notes
1. All works to be in accordance with Waikato Regional Infrastructure Technical Specifications.
 2. Co-ordinates in terms of NZ Geodetic Datum Mount Eden 2000.
 3. Levels in terms of the New Zealand Vertical Datum 2016.
 4. It is the contractors responsibility to locate all services that may be affected by his operations.
 5. Approved hardfill is to be used in backfilling of all stormwater lines within the road reserve.
 6. All catchpit leads shall be laid at 1% unless otherwise specified.
 7. All lines to be abandoned shall be sealed at each end. Timing of all sealing to be coordinated with council staff.

Legend	
	PR BOUNDARY
	EX BDY
	PR SITE BOUNDARY
	PR STAGE BOUNDARY
	PROP SWMH 1050mmØ
	PROP MANHOLE GRATE
	SOAKAGE TRENCH - 1.2m WIDE
	SOAKAGE TRENCH - 2m WIDE
	RAINGARDEN - 1.2m / 2.3m WIDE

A	FAST TRACK APP	GNT	05/2025
Rev	Description	By	Date
Survey	MAVEN		05/2024
Design	MKS		05/2025
Drawn	GNT		05/2025
Checked	DJM		05/2025



Maven Associates
09 571 0050
info@maven.co.nz
www.maven.co.nz
5 Owens Road, Epsom
Auckland 1023

Project
**ASHBOURNE
RESIDENTIAL
FOR
MATAMATA
DEVELOPMENTS LTD**

Title
**PROPOSED
STORMWATER
PLAN STAGE 2**

Project no.	289001
Scale	1:1500 @ A3
Cad file	C400-STORMWATER.DWG
Drawing no.	C400-12
Rev	A

RESOURCE CONSENT



STORMWATER
BASIN B

SERVICE IS TO EXTEND 1.0m PASSED
STAGE BOUNDARY AND CAPPED FOR
FUTURE STAGE CONNECTION.

CONTRACTOR TO EXPOSE END
CAP FROM PREVIOUS STAGE TO
CONNECT SERVICE

CONTRACTOR TO EXPOSE END
CAP FROM PREVIOUS STAGE TO
CONNECT SERVICE

Notes

1. All works to be in accordance with Waikato Regional Infrastructure Technical Specifications.
2. Co-ordinates in terms of NZ Geodetic Datum Mount Eden 2000.
3. Levels in terms of the New Zealand Vertical Datum 2016.
4. It is the contractors responsibility to locate all services that may be affected by his operations.
5. Approved hardfill is to be used in backfilling of all stormwater lines within the road reserve.
6. All catchpit leads shall be laid at 1% unless otherwise specified.
7. All lines to be abandoned shall be sealed at each end. Timing of all sealing to be coordinated with council staff.

Legend

- PR BOUNDARY
- EX BDY
- PR SITE BOUNDARY
- PR STAGE BOUNDARY
- PROP SWMH 1050mmØ
- PROP MANHOLE GRATE
- SOAKAGE TRENCH - 1.2m WIDE
- SOAKAGE TRENCH - 2m WIDE
- RAINGARDEN - 1.2m / 2.3m WIDE

A	FAST TRACK APP	GNT	05/2025
Rev	Description	By	Date
Survey	MAVEN		05/2024
Design	MKS		05/2025
Drawn	GNT		05/2025
Checked	DJM		05/2025



Maven Associates
09 571 0050
info@maven.co.nz
www.maven.co.nz
5 Owens Road, Epsom
Auckland 1023

Project
**ASHBOURNE
RESIDENTIAL
FOR
MATAMATA
DEVELOPMENTS LTD**

Title
**PROPOSED
STORMWATER
PLAN STAGE 3**

Project no.	289001
Scale	1:1500 @ A3
Cad file	C400-STORMWATER.DWG
Drawing no.	C400-13
Rev	A

RESOURCE CONSENT

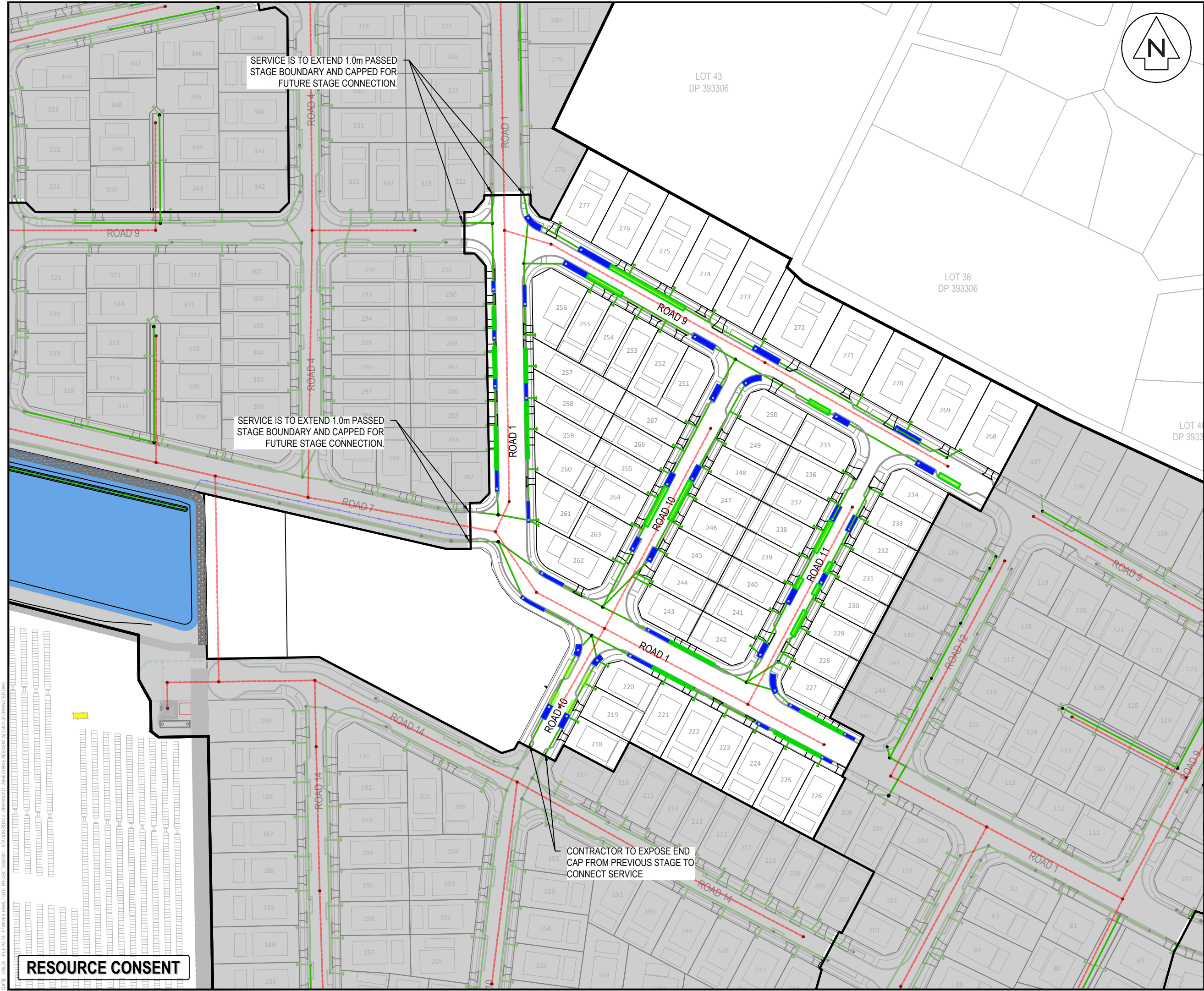

- Notes
1. All works to be in accordance with Waikato Regional Infrastructure Technical Specifications.
 2. Co-ordinates in terms of NZ Geodetic Datum Mount Eden 2000.
 3. Levels in terms of the New Zealand Vertical Datum 2016.
 4. It is the contractors responsibility to locate all services that may be affected by his operations.
 5. Approved hardfill is to be used in backfilling of all stormwater lines within the road reserve.
 6. All catchpit leads shall be laid at 1% unless otherwise specified.
 7. All lines to be abandoned shall be sealed at each end. Timing of all sealing to be coordinated with council staff.

- Legend
- PR BOUNDARY
 - EX BDY
 - PR SITE BOUNDARY
 - PR STAGE BOUNDARY
 - PROP SWMH 1050mmØ
 - PROP MANHOLE GRATE
 - SOAKAGE TRENCH - 1.2m WIDE
 - SOAKAGE TRENCH - 2m WIDE
 - RAINGARDEN - 1.2m / 2.3m WIDE

A	FAST TRACK APP	GNT	05/2025
Rev	Description	By	Date
Survey	MAVEN		05/2024
Design	MKS		05/2025
Drawn	GNT		05/2025
Checked	DJM		05/2025

M Maven Associates
09 571 0050
info@maven.co.nz
www.maven.co.nz
5 Owens Road, Epsom
Auckland 1023

Project
**ASHBOURNE
RESIDENTIAL
FOR
MATAMATA
DEVELOPMENTS LTD**

Title
**PROPOSED
STORMWATER
PLAN STAGE 4**

Project no.	289001
Scale	1:1500 @ A3
Cad file	C400-STORMWATER.DWG
Drawing no.	C400-14
Rev	A

RESOURCE CONSENT



HIGHGROVE AVENUE

LOT 16
DP 562902

LOT 17
DP 562902

LOT 18
DP 562902

LOT 47
DP 393306

CHESTNUT LANE

LOT 43
DP 393306

SERVICE IS TO EXTEND 1.0m PASSED
STAGE BOUNDARY AND CAPPED FOR
FUTURE STAGE CONNECTION.

CONTRACTOR TO EXPOSE END
CAP FROM PREVIOUS STAGE TO
CONNECT SERVICE

SERVICE IS TO EXTEND 1.0m PASSED
STAGE BOUNDARY AND CAPPED FOR
FUTURE STAGE CONNECTION.

CONTRACTOR TO EXPOSE END
CAP FROM PREVIOUS STAGE TO
CONNECT SERVICE

RESOURCE CONSENT

Notes

1. All works to be in accordance with Waikato Regional Infrastructure Technical Specifications.
2. Co-ordinates in terms of NZ Geodetic Datum Mount Eden 2000.
3. Levels in terms of the New Zealand Vertical Datum 2016.
4. It is the contractors responsibility to locate all services that may be affected by his operations.
5. Approved hardfill is to be used in backfilling of all stormwater lines within the road reserve.
6. All catchpit leads shall be laid at 1% unless otherwise specified.
7. All lines to be abandoned shall be sealed at each end. Timing of all sealing to be coordinated with council staff.

Legend

- PR BOUNDARY
- EX BDY
- PR SITE BOUNDARY
- PR STAGE BOUNDARY
- PROP SWMH 1050mmØ
- PROP MANHOLE GRATE
- SOAKAGE TRENCH - 1.2m WIDE
- SOAKAGE TRENCH - 2m WIDE
- RAINGARDEN - 1.2m / 2.3m WIDE

A	FAST TRACK APP	GNT	05/2025
Rev	Description	By	Date
Survey	MAVEN		05/2024
Design	MKS		05/2025
Drawn	GNT		05/2025
Checked	DJM		05/2025



Project
**ASHBOURNE
RESIDENTIAL
FOR
MATAMATA
DEVELOPMENTS LTD**

Title
**PROPOSED
STORMWATER
PLAN STAGE 5**

Project no.	289001
Scale	1:1500 @ A3
Cad file	C400-STORMWATER.DWG
Drawing no.	C400-15
Rev	A



HIGHGROVE AVENUE

LOT 16
DP 562902

LOT 17
DP 562902

LOT 18
DP 562902

LOT 2
DP 21055

ROAD 5

ROAD 6

ROAD 4

ROAD 5

ROAD 1

ROAD 9

ROAD 7

CONTRACTOR TO EXPOSE END
CAP FROM PREVIOUS STAGE TO
CONNECT SERVICE

- Notes
1. All works to be in accordance with Waikato Regional Infrastructure Technical Specifications.
 2. Co-ordinates in terms of NZ Geodetic Datum Mount Eden 2000.
 3. Levels in terms of the New Zealand Vertical Datum 2016.
 4. It is the contractors responsibility to locate all services that may be affected by his operations.
 5. Approved hardfill is to be used in backfilling of all stormwater lines within the road reserve.
 6. All catchpit leads shall be laid at 1% unless otherwise specified.
 7. All lines to be abandoned shall be sealed at each end. Timing of all sealing to be coordinated with council staff.

Legend

- PR BOUNDARY
- EX BDY
- PR SITE BOUNDARY
- PR STAGE BOUNDARY
- PROP SWMH 1050mmØ
- PROP SCRUFFY DOME
- SOAKAGE TRENCH - 1.2m WIDE
- SOAKAGE TRENCH - 2m WIDE
- RAINGARDEN - 1.2m / 2.3m WIDE

A	FAST TRACK APP	GNT	05/2025
Rev	Description	By	Date
Survey	MAVEN		05/2024
Design	MKS		05/2025
Drawn	GNT		05/2025
Checked	DJM		05/2025

M Maven Associates
09 571 0050
info@maven.co.nz
www.maven.co.nz
5 Owens Road, Epsom
Auckland 1023

Project
**ASHBOURNE
RESIDENTIAL
FOR
MATAMATA
DEVELOPMENTS LTD**

Title
**PROPOSED
STORMWATER
PLAN STAGE 6**

Project no.	289001
Scale	1:1500 @ A3
Cad file	C400-STORMWATER.DWG
Drawing no.	C400-16
Rev	A

RESOURCE CONSENT

DATE: 5/3/25 FILEPATH: F:\Maven\Hamilton\6. PROJECTS\289001 - STATION ROAD\ DRAWING\11. ASHBORNE RESIDENTIAL\ C400-STORMWATER.DWG



OLIVE PLACE

LOT 9
DP 562902

LOT 13
DP 562902

LOT 14
DP 562902

LOT 16
DP 562902

LOT 17
DP 562902

LOT 18
DP 562902

LOT 3
DP 404835

PROPOSED SW BASIN C

ROAD 4

ROAD 2

ROAD 5

ROAD 1

ROAD 1

SERVICE IS TO EXTEND 1.0m PASSED
STAGE BOUNDARY AND CAPPED FOR
FUTURE STAGE CONNECTION.

LOT 28
DP 386534

LOT 44
DP 386534

LOT 47
DP 393306

CHESTNUT LANE

HIGHGROVE AVENUE

RESOURCE CONSENT

Notes

1. All works to be in accordance with Waikato Regional Infrastructure Technical Specifications.
2. Co-ordinates in terms of NZ Geodetic Datum Mount Eden 2000.
3. Levels in terms of the New Zealand Vertical Datum 2016.
4. It is the contractors responsibility to locate all services that may be affected by his operations.
5. Approved hardfill is to be used in backfilling of all stormwater lines within the road reserve.
6. All catchpit leads shall be laid at 1% unless otherwise specified.
7. All lines to be abandoned shall be sealed at each end. Timing of all sealing to be coordinated with council staff.

Legend

	PR BOUNDARY
	EX BDY
	PR SITE BOUNDARY
	PR STAGE BOUNDARY
	PROP SWMH 1050mmØ
	PROP MANHOLE GRATE
	SOAKAGE TRENCH - 1.2m WIDE
	SOAKAGE TRENCH - 2m WIDE
	RAINGARDEN - 1.2m / 2.3m WIDE

A	FAST TRACK APP	GNT	05/2025
Rev	Description	By	Date
		By	Date
Survey	MAVEN		05/2024
Design	MKS		05/2025
Drawn	GNT		05/2025
Checked	DJM		05/2025



Maven Associates
09 571 0050
info@maven.co.nz
www.maven.co.nz
5 Owens Road, Epsom
Auckland 1023

Project
**ASHBOURNE
RESIDENTIAL
FOR
MATAMATA
DEVELOPMENTS LTD**

Title
**PROPOSED
STORMWATER
PLAN STAGE 7**

Project no.	289001
Scale	1:1500 @ A3
Cad file	C400-STORMWATER.DWG
Drawing no.	C400-17
Rev	A



- Notes
1. All works to be in accordance with Waikato Regional Infrastructure Technical Specifications.
 2. Co-ordinates in terms of NZ Geodetic Datum Mount Eden 2000.
 3. Levels in terms of the New Zealand Vertical Datum 2016.
 4. It is the contractors responsibility to locate all services that may be affected by his operations.
 5. Approved hardfill is to be used in backfilling of all stormwater lines within the road reserve.
 6. All catchpit leads shall be laid at 1% unless otherwise specified.
 7. All lines to be abandoned shall be sealed at each end. Timing of all sealing to be coordinated with council staff.

Legend			
	PR BOUNDARY		
	EX BDY		
	PR SITE BOUNDARY		
	PR STAGE BOUNDARY		
	PROP SWMH 1050mmØ		
	PROP MANHOLE GRATE		
	SOAKAGE TRENCH - 1.2m WIDE		
	SOAKAGE TRENCH - 2m WIDE		
	RAINGARDEN - 1.2m / 2.3m WIDE		

A	FAST TRACK APP	GNT	05/2025
Rev	Description	By	Date
Survey	MAVEN		05/2024
Design	MKS		05/2025
Drawn	GNT		05/2025
Checked	DJM		05/2025



Maven Associates
09 571 0050
info@maven.co.nz
www.maven.co.nz
5 Owens Road, Epsom
Auckland 1023

Project
**ASHBOURNE
RESIDENTIAL
FOR
MATAMATA
DEVELOPMENTS LTD**

Title
**PROPOSED
STORMWATER
PLAN STAGE 8**

Project no.	289001		
Scale	1:2500 @ A3		
Cad file	C400-STORMWATER.DWG		
Drawing no.	C400-18	Rev	A

RESOURCE CONSENT