

- NOTES:
- 1. ALL DIMENSIONS ARE SHOWN IN METERS UNLESS NOTED OTHERWISE.
  - 2. ALL AREAS AND DIMENSIONS ARE SUBJECT TO RESOURCE CONSENT AND LINZ APPROVAL.
  - 3. LOCAL AUTHORITY: AUCKLAND COUNCIL
  - 4. COMPRISED IN CT: NA91C/409 (LOT 1 DP 153477), NA91C/410 (LOT 2 DP 153477), 472117 (LOT 2 DP 418770), SECTIONS 2 & 3 SO XXXXXX, LOTS 5006 & 5007 DP XXXXXX (STAGE 1B-1) AND LOT 5009 DP XXXXXX (STAGE 1B-3).

F SEC 92								DC	JK	JK	02/07/25	<div></div>	CLIENT: VINEWAY LTD	PROJECT: DELMORE 53A, 53B & 55 RUSSELL ROAD OREWA, AUCKLAND STAGE 2 OVERALL	TITLE: SCHEME PLAN OF PROPOSED SUBDIVISION OF LOT 2 DP 418770, LOTS 1&2 DP 153477, LOT 5009 DP XXXXXX (STG1B-3), LOTS 5006 & 5007 DP XXXXXX (STG 1B-1) & SECS 2&3 SO XXXXXX	PURPOSE OF ISSUE: FOR RESOURCE CONSENT
E SEC 92								DC	JK	JK	27/06/25					
D SEC 92								ZW	JK	JK	18/06/25					
C STAGE UPDATED								JX	PC	JK	11/02/25					
B BOUNDARY REVISED								JX	PC	JK	31/01/25					
A FIRST ISSUE								JX	PC	JK	20/12/25					
REV	DESCRIPTION							DRN BY	CHK BY	APP BY	DATE					

SCALE:  
1:5000  
DO NOT SCALE

DRAWING NO: 3725-2-142

REV: F

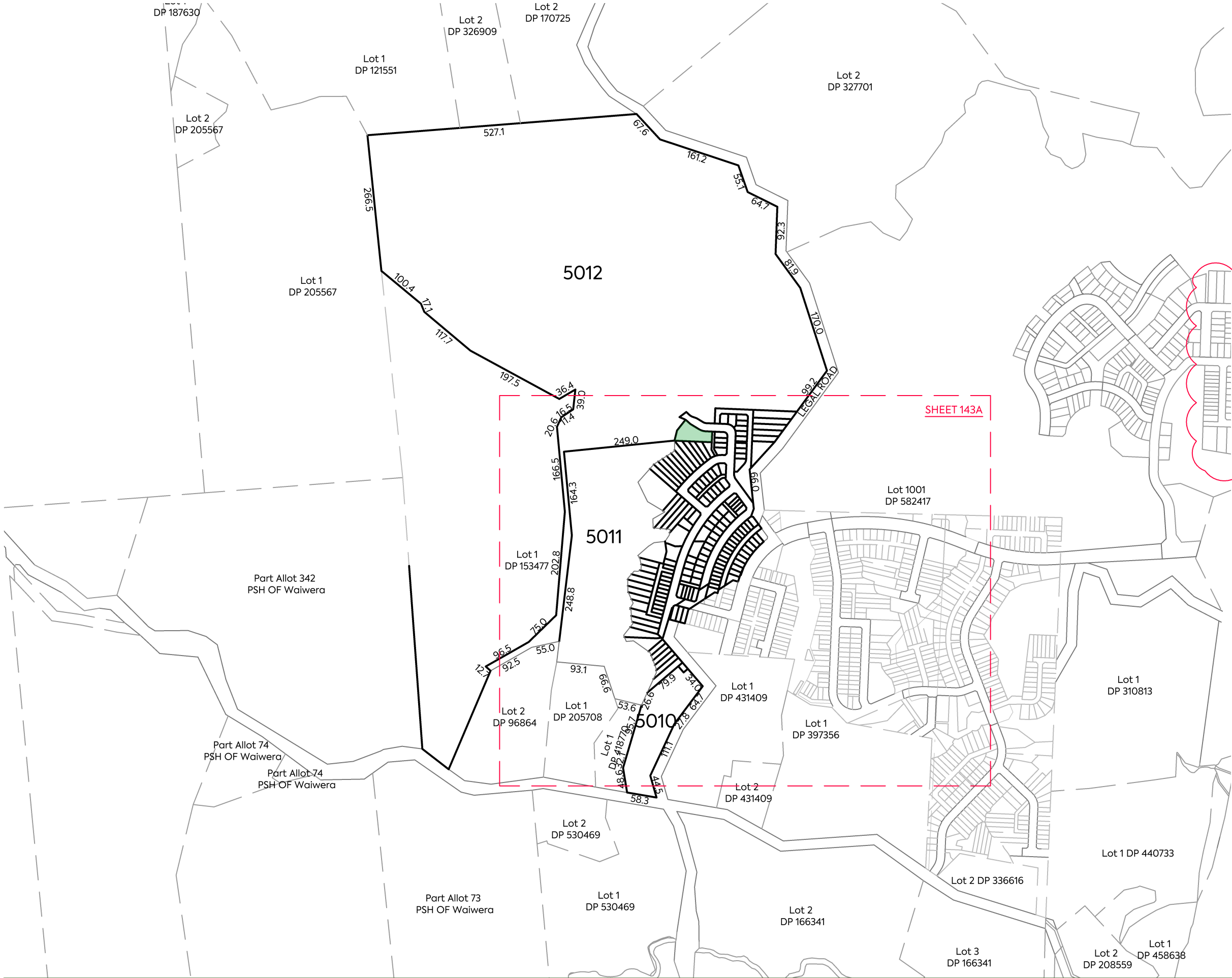

NOTES:

- 1. ALL DIMENSIONS ARE SHOWN IN METERS UNLESS NOTED OTHERWISE.
- 2. ALL AREAS AND DIMENSIONS ARE SUBJECT TO RESOURCE CONSENT AND LINZ APPROVAL.
- 3. LOCAL AUTHORITY: AUCKLAND COUNCIL
- 4. COMPRISED IN CT: NA91C/410 (LOT 2 DP 153477), 472117 (LOT 2 DP 418770), SECTIONS 2 & 3 SO XXXXXX, LOTS 5006 & 5007 DP XXXXXX (STAGE 1B-1) AND LOT 5009 DP XXXXXX (STAGE 1B-3)

LEGEND:

LAND IN LIEU OF RESERVE – FOR DRAINAGE PURPOSES

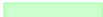

					CLIENT:			PROJECT:			TITLE:	PURPOSE OF ISSUE:	
F	SEC 92	DC	JK	JK	02/07/25	<div><div></div><div></div></div> <div><div></div><div></div></div> <div><div></div><div></div></div> <div><div></div><div></div></div> <div><div></div><div></div></div> <div><div></div><div></div></div> <div><div></div><div></div></div> <div><div></div><div></div></div> <div><div></div><div></div></div> <div><div></div><div></div></div> <div><div></div><div></div></div> <div><div></div><div></div></div> <div><div></div><div></div></div> <div><div></div><div></div></div> <div><div></div><div></div></div> <div><div></div><div></div></div> <div><div></div><div></div></div> <div><div></div><div></div></div> <div><div></div><div></div></div> <div><div></div><div></div></div> <div><div></div><div></div></div> <div><div></div><div></div></div> <div><div></div><div></div></div> <div><div></div><div></div></div> <div><div></div><div></div></div> <div><div></div><div></div></div> <div><div></div><div></div></div> <div><div></div><div></div></div> <div><div></div><div></div></div> <div><div></div><div></div></div> <div><div></div><div></div></div> <div><div></div><div></div></div> <div><div></div><div></div></div> <div><div></div><div></div></div> <div><div></div><div></div></div> <div><div></div><div></div></div> <div><div></div><div></div></div> <div><div></div><div></div></div> <div><div></div><div></div></div> <div><div></div><div></div></div> <div><div></div><div></div></div> <div><div></div><div></div></div> <div><div></div><div></div></div> <div><div></div><div></div></div> <div><div></div><div></div></div> <div><div></div><div></div></div> <div><div></div><div></div></div> <div><div></div><div></div></div> <div><div></div><div></div></div> <div><div></div><div></div></div> <div><div></div><div></div></div> <div><div></div><div></div></div> <div><div></div><div></div></div> <div><div></div><div></div></div> <div><div></div><div></div></div> <div><div></div><div></div></div> <div><div></div><div></div></div> <div><div></div><div></div></div> <div><div></div><div></div></div> <div><div></div><div></div></div> <div><div></div><div></div></div> <div><div></div><div></div></div> <div><div></div><div></div></div> <div><div></div><div></div></div> <div><div></div><div></div></div> <div><div></div><div></div></div> <div><div></div><div></div></div> <div><div></div><div></div></div> <div><div></div><div></div></div> <div><div></div><div></div></div> <div><div></div><div></div></div> <div><div></div><div></div></div> <div><div></div><div></div></div> <div><div></div><div></div></div> <div><div></div><div></div></div> <div><div></div><div></div></div> <div><div></div><div></div></div> <div><div></div><div></div></div> <div><div></div><div></div></div> <div><div></div><div></div></div> <div><div></div><div></div></div> <div><div></div><div></div></div> <div><div></div><div></div></div> <div><div></div><div></div></div> <div><div></div><div></div></div> <div><div></div><div></div></div> <div><div></div><div></div></div> <div><div></div><div></div></div> <div><div></div><div></div></div> <div><div></div><div></div></div> <div><div></div><div></div></div> <div><div></div><div></div></div> <div><div></div><div></div></div> <div><div></div><div></div></div> <div><div></div><div></div></div> <div><div></div><div></div></div> <div><div></div><div></div></div> <div><div></div><div></div></div> <div><div></div><div></div></div> <div><div></div><div></div></div> <div><div></div><div></div></div> <div><div></div><div></div></div> <div><div></div><div></div></div> <div><div></div><div></div></div> <div><div></div><div></div></div> <div><div></div><div></div></div> <div><div></div><div></div></div> <div><div></div><div></div></div> <div><div></div><div></div></div> <div><div></div><div></div></div> <div><div></div><div></div></div> <div><div></div><div></div></div> <div><div></div><div></div></div> <div><div></div><div></div></div> <div><div></div><div></div></div> <div><div></div><div></div></div> <div><div></div><div></div></div> <div><div></div><div></div></div> <div><div></div><div></div></div> <div><div></div><div></div></div> <div><div></div><div></div></div> <div><div></div><div></div></div> <div><div></div><div></div></div> <div><div></div><div></div></div> <div><div></div><div></div></div> <div><div></div><div></div></div> <div><div></div><div></div></div> <div><div></div><div></div></div> <div><div></div><div></div></div> <div><div></div><div></div></div> <div><div></div><div></div></div> <div><div></div><div></div></div> <div><div></div><div></div></div> <div><div></div><div></div></div> <div><div></div><div></div></div> <div><div></div><div></div></div> <div><div></div><div></div></div> <div><div></div><div></div></div> <div><div></div><div></div></div> <div><div></div><div></div></div> <div><div></div><div></div></div> <div><div></div><div></div></div> <div><div></div><div></div></div> <div><div></div><div></div></div> <div><div></div><div></div></div> <div><div></div><div></div></div> <div><div></div><div></div></div> <div><div></div><div></div></div> <div><div></div><div></div></div> <div><div></div><div></div></div> <div><div></div><div></div></div> <div><div></div><div></div></div> <div><div></div><div></div></div> <div><div></div><div></div></div> <div><div></div><div></div></div> <div><div></div><div></div></div> <div><div></div><div></div></div> <div><div></div><div></div></div> <div><div></div><div></div></div> <div><div></div><div></div></div> <div><div></div><div></div></div> <div><div></div><div></div></div> <div><div></div><div></div></div> <div><div></div><div></div></div> <div><div></div><div></div></div> <div><div></div><div></div></div> <div><div></div><div></div></div> <div><div></div><div></div></div> <div><div></div><div></div></div> <div><div></div><div></div></div> <div><div></div><div></div></div> <div><div></div><div></div></div> <div><div></div><div></div></div> <div><div></div><div></div></div> <div><div></div><div></div></div> <div><div></div><div></div></div> <div><div></div><div></div></div> <div><div></div><div></div></div> <div><div></div><div></div></div> <div><div></div><div></div></div> <div><div></div><div></div></div> <div><div></div><div></div></div> <div><div></div><div></div></div> <div><div></div><div></div></div> <div><div></div><div></div></div> <div><div></div><div></div></div> <div><div></div><div></div></div> <div><div></div><div></div></div> <div><div></div><div></div></div> <div><div></div><div></div></div> <div><div></div><div></div></div> <div><div></div><div></div></div> <div><div></div><div></div></div> <div><div></div><div></div></div> <div><div></div><div></div></div> <div><div></div><div></div></div> <div><div></div><div></div></div> <div><div></div><div></div></div> <div><div></div><div></div></div> <div><div></div><div></div></div> <div><div></div><div></div></div> <div><div></div><div></div></div> <div><div></div><div></div></div> <div><div></div><div></div></div> <div><div></div><div></div></div> <div><div></div><div></div></div> <div><div></div><div></div></div> <div><div></div><div></div></div> <div><div></div><div></div></div> <div><div></div><div></div></div> <div><div></div><div></div></div> <div><div></div><div></div></div> <div><div></div><div></div></div> <div><div></div><div></div></div> <div><div></div><div></div></div> <div><div></div><div></div></div> <div><div></div><div></div></div> <div><div></div><div></div></div> <div><div></div><div></div></div> <div><div></div><div></div></div> <div><div></div><div></div></div> <div><div></div><div></div></div> <div><div></div><div></div></div> <div><div></div><div></div></div> <div><div></div><div></div></div> <div><div></div><div></div></div> <div><div></div><div></div></div> <div><div></div><div></div></div> <div><div></div><div></div></div> <div><div></div><div></div></div> <div><div></div><div></div></div> <div><div></div><div></div></div> <div><div></div><div></div></div> <div><div></div><div></div></div> <div><div></div><div></div></div> <div><div></div><div></div></div> <div><div></div><div></div></div> <div><div></div><div></div></div> <div><div></div><div></div></div> <div><div></div><div></div></div> <div><div></div><div></div></div> <div><div></div><div></div></div> <div><div></div><div></div></div> <div><div></div><div></div></div> <div><div></div><div></div></div> <div><div></div><div></div></div> <div><div></div><div></div></div> <div><div></div><div></div></div> <div><div></div><div></div></div> <div><div></div><div></div></div> <div><div></div><div></div></div> <div><div></div><div></div></div> <div><div></div><div></div></div> <div><div></div><div></div></div> <div><div></div><div></div></div> <div><div></div><div></div></div> <div><div></div><div></div></div> <div><div></div><div></div></div> <div><div></div><div></div></div> <div><div></div><div></div></div> <div><div></div><div></div></div> <div><div></div><div></div></div> <div><div></div><div></div></div> <div><div></div><div></div></div> <div><div></div><div></div></div> <div><div></div><div></div></div> <div><div></div><div></div></div> <div><div></div><div></div></div> <div><div></div><div></div></div> <div><div></div><div></div></div> <div><div></div><div></div></div> <div><div></div><div></div></div> <div><div></div><div></div></div> <div><div></div><div></div></div> <div><div></div><div></div></div> <div><div></div><div></div></div> <div><div></div><div></div></div> <div><div></div><div></div></div> <div><div></div><div></div></div> <div><div></div><div></div></div> <div><div></div><div></div></div> <div><div></div><div></div></div> <div><div></div><div></div></div> <div><div></div><div></div></div> <div><div></div><div></div></div> <div><div></div><div></div></div> <div><div></div><div></div></div> <div><div></div><div></div></div> <div><div></div><div></div></div> <div><div></div><div></div></div> <div><div></div><div></div></div> <div><div></div><div></div></div> <div><div></div><div></div></div> <div><div></div><div></div></div> <div><div></div><div></div></div> <div><div></div><div></div></div> <div><div></div><div></div></div> <div><div></div><div></div></div> <div><div></div><div></div></div> <div><div></div><div></div></div> <div><div></div><div></div></div> <div><div></div><div></div></div> <div><div></div><div></div></div> <div><div></div><div></div></div> <div><div></div><div></div></div> <div><div></div><div></div></div> <div><div></div><div></div></div> <div><div></div><div></div></div> <div><div></div><div></div></div> <div><div></div><div></div></div> <div><div></div><div></div></div> <div><div></div><div></div></div> <div><div></div><div></div></div> <div><div></div><div></div></div> <div><div></div><div></div></div> <div><div></div><div></div></div> <div><div></div><div></div></div> <div><div></div><div></div></div> <div><div></div><div></div></div> <div><div></div><div></div></div> <div><div></div><div></div></div> <div><div></div><div></div></div> <div><div></div><div></div></div> <div><div></div><div></div></div> <div><div></div><div></div></div> <div><div></div><div></div></div> <div><div></div><div></div></div> <div><div></div><div></div></div> <div><div></div><div></div></div> <div><div></div><div></div></div> <div><div></div><div></div></div> <div><div></div><div></div></div> <div><div></div><div></div></div> <div><div></div><div></div></div> <div><div></div><div></div></div> <div><div></div><div></div></div> <div><div></div><div></div></div> <div><div></div><div></div></div> <div><div></div><div></div></div> <div><div></div><div></div></div> <div><div></div><div></div></div> <div><div></div><div></div></div> <div><div></div><div></div></div> <div><div></div><div></div></div> <div><div></div><div></div></div> <div><div></div><div></div></div> <div><div></div><div></div></div> <div><div></div><div></div></div> <div><div></div><div></div></div> <div><div></div><div></div></div> <div><div></div><div></div></div> <div><div></div><div></div></div> <div><div></div><div></div></div> <div><div></div><div></div></div> <div><div></div><div></div></div> <div><div></div><div></div></div> <div><div></div><div></div></div> <div><div></div><div></div></div> <div><div></div><div></div></div> <div><div></div><div></div></div> <div><div></div><div></div></div> <div><div></div><div></div></div> <div><div></div><div></div></div> <div><div></div><div></div></div> <div><div></div><div></div></div> <div><div></div><div></div></div> <div><div></div><div></div></div> <div><div></div><div></div></div> <div><div></div><div></div></div> <div><div></div><div></div></div> <div><div></div><div></div></div> <div><div></div><div></div></div> <div><div></div><div></div></div> <div><div></div><div></div></div> <div><div></div><div></div></div> <div><div></div><div></div></div> <div><div></div><div></div></div> <div><div></div><div></div></div> <div><div></div><div></div></div> <div><div></div><div></div></div> <div><div></div><div></div></div> <div><div></div><div></div></div> <div><div></div><div></div></div> <div><div></div><div></div></div> <div><div></div><div></div></div> <div><div></div><div></div></div> <div><div></div><div></div></div> <div><div></div><div></div></div> <div><div></div><div></div></div> <div><div></div><div></div></div> <div><div></div><div></div></div> <div><div></div><div></div></div> <div><div></div><div></div></div> <div><div></div><div></div></div> <div><div></div><div></div></div> <div><div></div><div></div></div> <div><div></div><div></div></div> <div><div></div><div></div></div> <div><div></div><div></div></div> <div><div></div><div></div></div> <div><div></div><div></div></div> <div><div></div><div></div></div> <div><div></div><div></div></div> <div><div></div><div></div></div> <div><div></div><div></div></div> <div><div></div><div></div></div> <div><div></div><div></div></div> <div><div></div><div></div></div> <div><div></div><div></div></div> <div><div></div><div></div></div> <div><div></div><div></div></div> <div><div></div><div></div></div> <div><div></div><div></div></div> <div><div></div><div></div></div>							



MCKENZIE & CO.





1. ALL DIMENSIONS ARE SHOWN IN METERS UNLESS NOTED OTHERWISE.
2. ALL AREAS AND DIMENSIONS ARE SUBJECT TO RESOURCE CONSENT AND LINZ APPROVAL.
3. LOCAL AUTHORITY: AUCKLAND COUNCIL
4. COMPRISED IN CT: NA91C/410 (LOT 2 DP 153477), 472117 (LOT 2 DP 418770), SECTIONS 2 & 3 SO XXXXXX, LOTS 5006 & 5007 DP XXXXXX (STAGE 1B-1) AND LOT 5009 DP XXXXXX (STAGE 1B-3)

LEGEND:

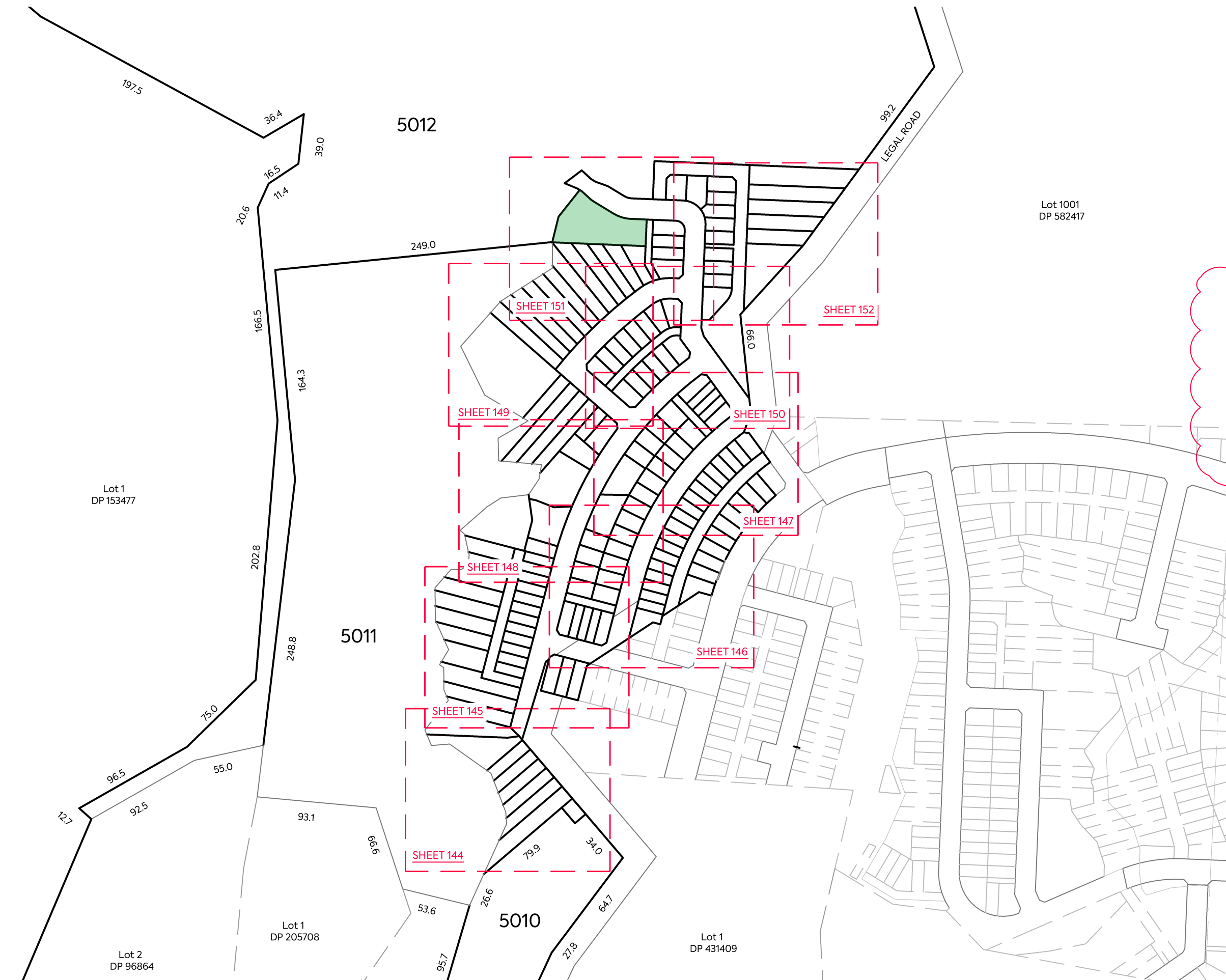
LAND IN LIEU OF RESERVE – FOR  
DRAINAGE PURPOSES

F	SEC 92	DC	JK	JK	02/07/25
E	SEC 92	DC	JK	JK	27/06/25
D	SEC 92	ZW	JK	JK	18/06/25
C	STAGE UPDATED	JX	PC	JK	11/02/25
B	BOUNDARY REVISED	JX	PC	JK	31/01/25
A	FIRST ISSUE	JX	PC	JK	20/12/25
REV	DESCRIPTION	DRN BY	CHK BY	APP BY	DATE



**MCKENZIE & CO.**

CLIENT:

VINEWAY LTD

PROJECT:

DELMORE  
53A, 53B & 55 RUSSELL ROAD  
OREWA, AUCKLAND  
STAGE 2A-1

TITLE:

LOTS 600-765, 1520-1526, 1628, 2100, 2101 & 3725-2-143 FOR RESOURCE CONSENT  
5010-5012 BEING A SUBDIVISION OF LOT 2  
DP 418770, LOTS 1&2 DP 153477, LOTS 5006  
&5007 DP XXXXXX (STG1B-1), LOT 5009 DP  
XXXXXX (STG1B-3) & SECTS 2&3 SO XXXXXX

REV-

**F**

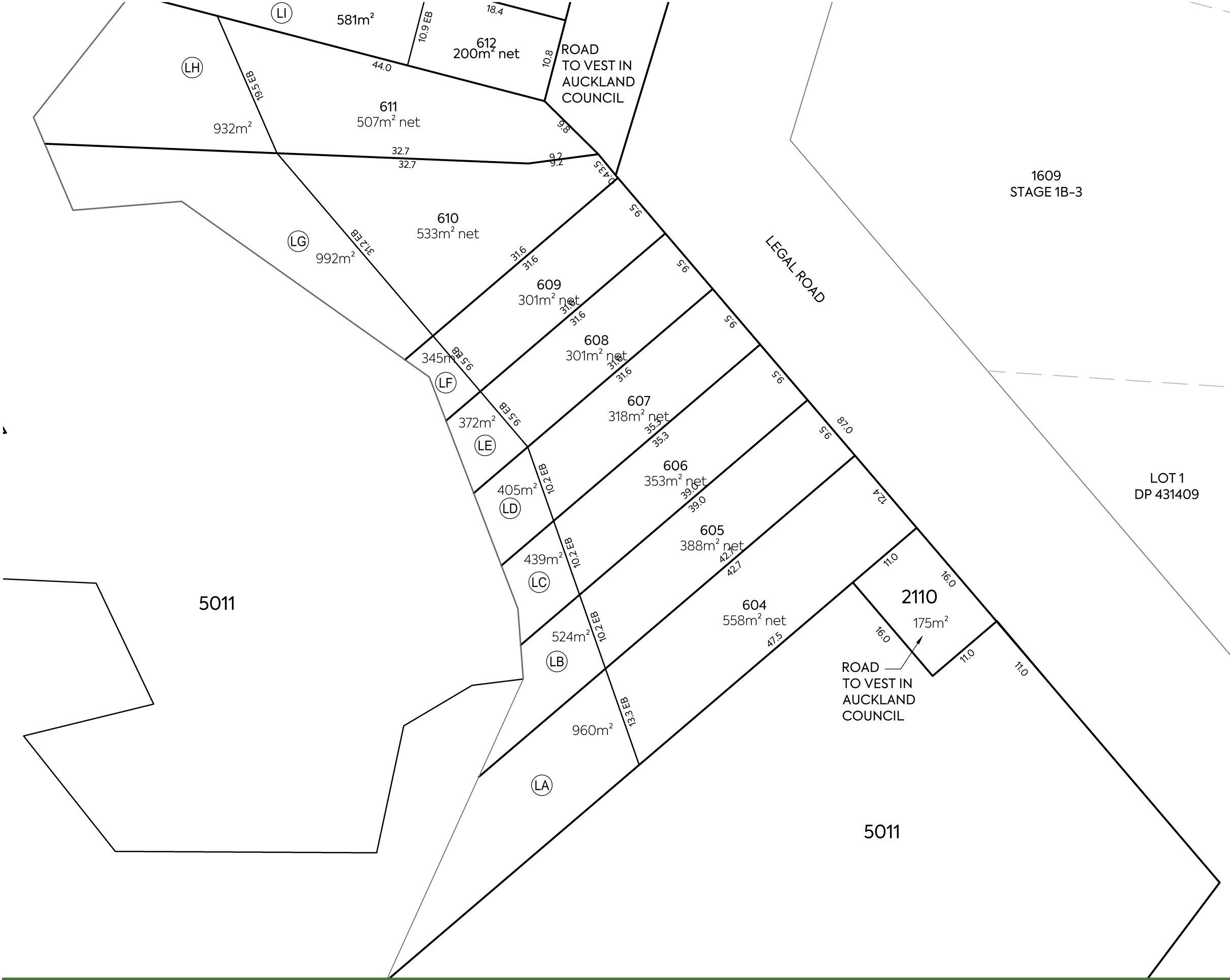

NOTES:

- 1. ALL DIMENSIONS ARE SHOWN IN METERS UNLESS NOTED OTHERWISE.
- 2. ALL AREAS AND DIMENSIONS ARE SUBJECT TO RESOURCE CONSENT AND LINZ APPROVAL.
- 3. LOCAL AUTHORITY: AUCKLAND COUNCIL
- 4. COMPRISED IN CT: NA91C/410 (LOT 2 DP 153477), 472117 (LOT 2 DP 418770), SECTIONS 1 & 2 SO XXXXXX, LOTS 5006 & 5007 DP XXXXXX (STAGE 1B-1) AND LOT 5009 DP XXXXXX (STAGE 1B-3).

MEMORANDUM OF PROPOSED COVENANTS		
PURPOSE	SHOWN	BURDENED LAND
BUSH COVENANT	LA	LOT 604 HEREON
	LB	LOT 605 HEREON
	LC	LOT 606 HEREON
	LD	LOT 607 HEREON
	LE	LOT 608 HEREON
	LF	LOT 609 HEREON
	LG	LOT 610 HEREON
	LH	LOT 611 HEREON

F	SEC 92	DC	JK	JK	02/07/25
E	SEC 92	DC	JK	JK	27/06/25
D	SEC 92	ZW	JK	JK	18/06/25
C	STAGE UPDATED	JX	PC	JK	11/02/25
B	BOUNDARY REVISED	JX	PC	JK	31/01/25
A	FIRST ISSUE	JX	PC	JK	20/12/25
REV	DESCRIPTION	DRN BY	CHK BY	APP BY	DATE



MCKENZIE & CO.

CLIENT: VINEWAY LTD

PROJECT: DELMORE  
53A, 53B & 55 RUSSELL ROAD  
OREWA, AUCKLAND  
STAGE 2A-1

TITLE: LOTS 600-765, 1520-1526, 1628, 2100, 2101 & 2102 BEING A SUBDIVISION OF LOT 2 DP 418770, LOTS 1&2 DP 153477, LOTS 5006 & 5007 DP XXXXXX (STG1B-1), LOT 5009 DP XXXXXX (STG1B-3) & SECTS 2&3 SO XXXXXX  
PURPOSE OF ISSUE: FOR RESOURCE CONSENT  
SCALE: 1:500  
DO NOT SCALE  
DRAWING NO: 3725-2-144  
REV: F



- NOTES:**
1. ALL DIMENSIONS ARE SHOWN IN METERS UNLESS NOTED OTHERWISE.
  2. ALL AREAS AND DIMENSIONS ARE SUBJECT TO RESOURCE CONSENT AND LINZ APPROVAL.
  3. LOCAL AUTHORITY: AUCKLAND COUNCIL
  4. COMPRISED IN CT: NA91C/410 (LOT 2 DP 153477), 472117 (LOT 2 DP 418770), SECTIONS 1 & 2 SO XXXXXX, LOTS 5006 & 5007 DP XXXXXX (STAGE 1B-1) AND LOT 5009 DP XXXXXX (STAGE 1B-3).

**AMALGAMATION CONDITIONS:**

THAT LOT 1520 HEREON (LEGAL ACCESS) BE HELD AS TO FIVE UNDIVIDED ONE-FIFTH SHARES BY THE OWNERS OF LOTS 637 TO 641 HEREON AS TENANTS IN THE COMMON IN THE SAID SHARES AND THAT INDIVIDUAL RECORDS OF TITLE BE ISSUED IN ACCORDANCE THEREWITH.

THAT LOT 1521 HEREON (LEGAL ACCESS) BE HELD AS TO NINE UNDIVIDED ONE-NINTH SHARES BY THE OWNERS OF LOTS 615 TO 623 HEREON AS TENANTS IN THE COMMON IN THE SAID SHARES AND THAT INDIVIDUAL RECORDS OF TITLE BE ISSUED IN ACCORDANCE THEREWITH.

SCHEDULE OF PROPOSED COVENANTS		
PURPOSE	SHOWN	BURDENED LAND
BUSH COVENANT	(LH)	LOT 611 HEREON
	(LI)	LOT 612 HEREON
	(LJ)	LOT 613 HEREON
	(LK)	LOT 614 HEREON
	(LL)	LOT 615 HEREON
	(LM)	LOT 616 HEREON
	(LN)	LOT 617 HEREON
	(LO)	LOT 618 HEREON
	(LP)	LOT 619 HEREON
	(LQ)	LOT 620 HEREON

MEMORANDUM OF PROPOSED EASEMENTS			
PURPOSE	SHOWN	BURDENED LAND	BENEFITED LAND
MAINTENANCE	(HA)	LOT 641 HEREON	LOT 640 HEREON
	(HB)	LOT 640 HEREON	LOT 639 HEREON
	(HC)	LOT 639 HEREON	LOT 638 HEREON
	(HN)	LOT 624 HEREON	LOT 625 HEREON
	(HO)	LOT 626 HEREON	LOT 627 HEREON
	(HP)	LOT 628 HEREON	LOT 629 HEREON
	(HQ)	LOT 630 HEREON	LOT 631 HEREON
	(HR)	LOT 632 HEREON	LOT 633 HEREON

SCHEDULE OF PROPOSED EASEMENTS IN GROSS			
PURPOSE	SHOWN	BURDENED LAND	GRANTEE
RIGHT OF WAY, RIGHT TO CONVEY WATER, GAS, ELECTRICITY & TELECOMMUNICATIONS, RIGHT TO DRAIN WATER & SEWAGE AND MAINTENANCE	(YA)	LOT 1520 HEREON	RESIDENTIAL SOCIETY MANAGEMENT COMPANY (NAME TBC)
	(YB)	LOT 1521 HEREON	

F	SEC 92	DC	JK	JK	02/07/25
E	SEC 92	DC	JK	JK	27/06/25
D	SEC 92	ZW	JK	JK	18/06/25
C	STAGE UPDATED	JX	PC	JK	11/02/25
B	BOUNDARY REVISED	JX	PC	JK	31/01/25
A	FIRST ISSUE	JX	PC	JK	20/12/25
REV	DESCRIPTION	DRN BY	CHK BY	APP BY	DATE



CLIENT: VINEWAY LTD

PROJECT: DELMORE  
53A, 53B & 55 RUSSELL ROAD  
OREWA, AUCKLAND  
STAGE 2A-1

TITLE: LOTS 600-765, 1520-1526, 1628, 2100, 2101 & 5010-5012 BEING A SUBDIVISION OF LOT 2 DP 418770, LOTS 1&2 DP 153477, LOTS 5006 & 5007 DP XXXXXX (STG1B-1), LOT 5009 DP XXXXXX (STG1B-3) & SECTS 2&3 SO XXXXXX

PURPOSE OF ISSUE: FOR RESOURCE CONSENT

SCALE: 1:500  
DO NOT SCALE

DRAWING NO: 3725-2-145

REV: F



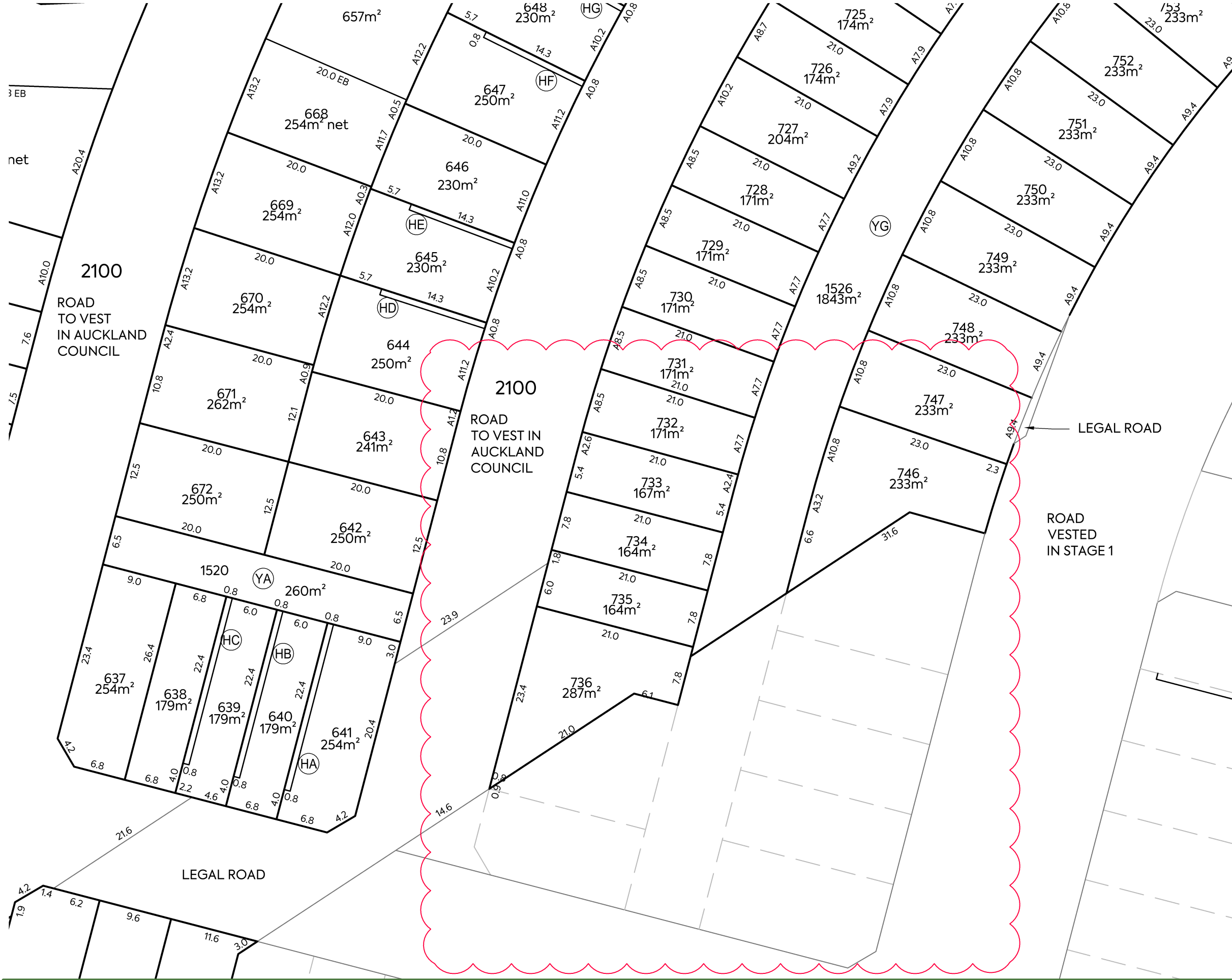

NOTES:

- 1. ALL DIMENSIONS ARE SHOWN IN METERS UNLESS NOTED OTHERWISE.
- 2. ALL AREAS AND DIMENSIONS ARE SUBJECT TO RESOURCE CONSENT AND LINZ APPROVAL.
- 3. LOCAL AUTHORITY: AUCKLAND COUNCIL
- 4. COMPRISED IN CT: NA91C/410 (LOT 2 DP 153477), 472117 (LOT 2 DP 418770), SECTIONS 1 & 2 SO XXXXXX, LOTS 5006 & 5007 DP XXXXXX (STAGE 1B-1) AND LOT 5009 DP XXXXXX (STAGE 1B-3).

AMALGAMATION CONDITIONS:

THAT LOT 1520 HEREON (LEGAL ACCESS) BE HELD AS TO FIVE UNDIVIDED ONE-FIFTH SHARES BY THE OWNERS OF LOTS 637 TO 641 HEREON AS TENANTS IN THE COMMON IN THE SAID SHARES AND THAT INDIVIDUAL RECORDS OF TITLE BE ISSUED IN ACCORDANCE THEREWITH.

THAT LOT 1526 HEREON (LEGAL ACCESS) BE HELD AS TO FORTY UNDIVIDED ONE-FORTIETH SHARES BY THE OWNERS OF LOTS 717 TO 756 HEREON AS TENANTS IN THE COMMON IN THE SAID SHARES AND THAT INDIVIDUAL RECORDS OF TITLE BE ISSUED IN ACCORDANCE THEREWITH.

MEMORANDUM OF PROPOSED EASEMENTS			
PURPOSE	SHOWN	BURDENED LAND	BENEFITED LAND
MAINTENANCE	HA	LOT 641 HEREON	LOT 640 HEREON
	HB	LOT 640 HEREON	LOT 639 HEREON
	HC	LOT 639 HEREON	LOT 638 HEREON
	HD	LOT 644 HEREON	LOT 645 HEREON
	HE	LOT 645 HEREON	LOT 646 HEREON
	HF	LOT 647 HEREON	LOT 648 HEREON
	HG	LOT 648 HEREON	LOT 649 HEREON
SCHEDULE OF PROPOSED EASEMENTS IN GROSS			
PURPOSE	SHOWN	BURDENED LAND	GRANTEE
RIGHT OF WAY, RIGHT TO CONVEY WATER, GAS, ELECTRICITY & TELECOMMUNICATIONS, RIGHT TO DRAIN WATER & SEWAGE AND MAINTENANCE	YA	LOT 1520 HEREON	RESIDENTIAL SOCIETY MANAGEMENT COMPANY (NAME TBC)
	YG	LOT 1526 HEREON	

F	SEC 92	DC	JK	JK	02/07/25
E	SEC 92	DC	JK	JK	27/06/25
D	SEC 92	ZW	JK	JK	18/06/25
C	STAGE UPDATED	JX	PC	JK	11/02/25
B	BOUNDARY REVISED	JX	PC	JK	31/01/25
A	FIRST ISSUE	JX	PC	JK	20/12/25
REV	DESCRIPTION	DRN BY	CHK BY	APP BY	DATE



MCKENZIE & CO.

CLIENT: VINEWAY LTD

PROJECT: DELMORE  
53A, 53B & 55 RUSSELL ROAD  
OREWA, AUCKLAND  
STAGE 2A-1

TITLE: LOTS 600-765, 1520-1526, 1628, 2100, 2101 & 5010-5012 BEING A SUBDIVISION OF LOT 2 DP 418770, LOTS 1&2 DP 153477, LOTS 5006 & 5007 DP XXXXXX (STG1B-1), LOT 5009 DP XXXXXX (STG1B-3) & SECTS 2&3 SO XXXXXX  
PURPOSE OF ISSUE: FOR RESOURCE CONSENT  
SCALE: 1:500  
DO NOT SCALE  
DRAWING NO: 3725-2-146  
REV: F



NOTES:

- 1. ALL DIMENSIONS ARE SHOWN IN METERS UNLESS NOTED OTHERWISE.
- 2. ALL AREAS AND DIMENSIONS ARE SUBJECT TO RESOURCE CONSENT AND LINZ APPROVAL.
- 3. LOCAL AUTHORITY: AUCKLAND COUNCIL
- 4. COMPRISED IN CT: NA91C/410 (LOT 2 DP 153477), 472117 (LOT 2 DP 418770), SECTIONS 2 & 3 SO XXXXXX, LOTS 5006 & 5007 DP XXXXXX (STAGE 1B-1) AND LOT 5009 DP XXXXXX (STAGE 1B-3).

AMALGAMATION CONDITIONS:

THAT LOT 1522 HEREON (LEGAL ACCESS) BE HELD AS TO FIVE UNDIVIDED ONE-FIFTH SHARES BY THE OWNERS OF LOTS 655 TO 659 HEREON AS TENANTS IN THE COMMON IN THE SAID SHARES AND THAT INDIVIDUAL RECORDS OF TITLE BE ISSUED IN ACCORDANCE THEREWITH.

THAT LOT 1526 HEREON (LEGAL ACCESS) BE HELD AS TO FORTY UNDIVIDED ONE-FORTIETH SHARES BY THE OWNERS OF LOTS 717 TO 756 HEREON AS TENANTS IN THE COMMON IN THE SAID SHARES AND THAT INDIVIDUAL RECORDS OF TITLE BE ISSUED IN ACCORDANCE THEREWITH.

SCHEDULE OF PROPOSED COVENANTS		
PURPOSE	SHOWN	BURDENED LAND
BUSH COVENANT	QX	LOT 664 HEREON
	RY	LOT 665 HEREON

MEMORANDUM OF PROPOSED EASEMENTS			
PURPOSE	SHOWN	BURDENED LAND	BENEFITED LAND
MAINTENANCE	HF	LOT 647 HEREON	LOT 648 HEREON
	HG	LOT 648 HEREON	LOT 649 HEREON
	HH	LOT 650 HEREON	LOT 651 HEREON
	HI	LOT 651 HEREON	LOT 652 HEREON
	HJ	LOT 652 HEREON	LOT 653 HEREON
	HL	LOT 655 HEREON	LOT 656 HEREON
	HK	LOT 656 HEREON	LOT 657 HEREON
	HM	LOT 657 HEREON	LOT 658 HEREON

SCHEDULE OF PROPOSED EASEMENTS IN GROSS			
PURPOSE	SHOWN	BURDENED LAND	GRANTEE
RIGHT OF WAY, RIGHT TO CONVEY WATER, GAS, ELECTRICITY & TELECOMMUNICATIONS, RIGHT TO DRAIN WATER & SEWAGE AND MAINTENANCE	YC	LOT 1522 HEREON	RESIDENTIAL SOCIETY MANAGEMENT COMPANY (NAME TBC)
	YG	LOT 1526 HEREON	

F	SEC 92	DC	JK	JK	02/07/25
E	SEC 92	DC	JK	JK	27/06/25
D	SEC 92	ZW	JK	JK	18/06/25
C	STAGE UPDATED	JX	PC	JK	11/02/25
B	BOUNDARY REVISED	JX	PC	JK	31/01/25
A	FIRST ISSUE	JX	PC	JK	20/12/25

REV	DESCRIPTION	DRN BY	CHK BY	APP BY	DATE
-----	-------------	--------	--------	--------	------



MCKENZIE & CO.

CLIENT: VINEWAY LTD

PROJECT: DELMORE  
53A, 53B & 55 RUSSELL ROAD  
OREWA, AUCKLAND  
STAGE 2A-1

TITLE: LOTS 600-765, 1520-1526, 1628, 2100, 2101 & 5010-5012 BEING A SUBDIVISION OF LOT 2 DP 418770, LOTS 1&2 DP 153477, LOTS 5006 & 5007 DP XXXXXX (STG1B-1), LOT 5009 DP XXXXXX (STG1B-3) & SECTS 2&3 SO XXXXXX

PURPOSE OF ISSUE: FOR RESOURCE CONSENT  
SCALE: 1:500  
DO NOT SCALE  
DRAWING NO: 3725-2-147  
REV: F



NOTES:

1. ALL DIMENSIONS ARE SHOWN IN METERS UNLESS NOTED OTHERWISE.
2. ALL AREAS AND DIMENSIONS ARE SUBJECT TO RESOURCE CONSENT AND LINZ APPROVAL.
3. LOCAL AUTHORITY: AUCKLAND COUNCIL
4. COMPRISED IN CT: NA91C/410 (LOT 2 DP 153477), 472117 (LOT 2 DP 418770), SECTIONS 2 & 3 SO XXXXXX, LOTS 5006 & 5007 DP XXXXXX (STAGE 1B-1) AND LOT 5009 DP XXXXXX (STAGE 1B-3).

SCHEDULE OF PROPOSED COVENANTS		
PURPOSE	SHOWN	BURDENED LAND
BUSH COVENANT	LO	LOT 620 HEREON
	LR	LOT 621 HEREON
	LS	LOT 622 HEREON
	LT	LOT 623 HEREON
	LU	LOT 636 HEREON
	LV	LOT 673 HEREON
	LW	LOT 677 HEREON
	LX	LOT 678 HEREON
	LY	LOT 679 HEREON
	QX	LOT 664 HEREON
	RY	LOT 668 HEREON

MEMORANDUM OF PROPOSED EASEMENTS			
PURPOSE	SHOWN	BURDENED LAND	BENEFITED LAND
MAINTENANCE	HD	LOT 644 HEREON	LOT 645 HEREON
	HE	LOT 645 HEREON	LOT 646 HEREON
	HF	LOT 647 HEREON	LOT 648 HEREON
	HG	LOT 648 HEREON	LOT 649 HEREON
	HH	LOT 650 HEREON	LOT 651 HEREON
	HI	LOT 651 HEREON	LOT 652 HEREON
	HJ	LOT 652 HEREON	LOT 653 HEREON

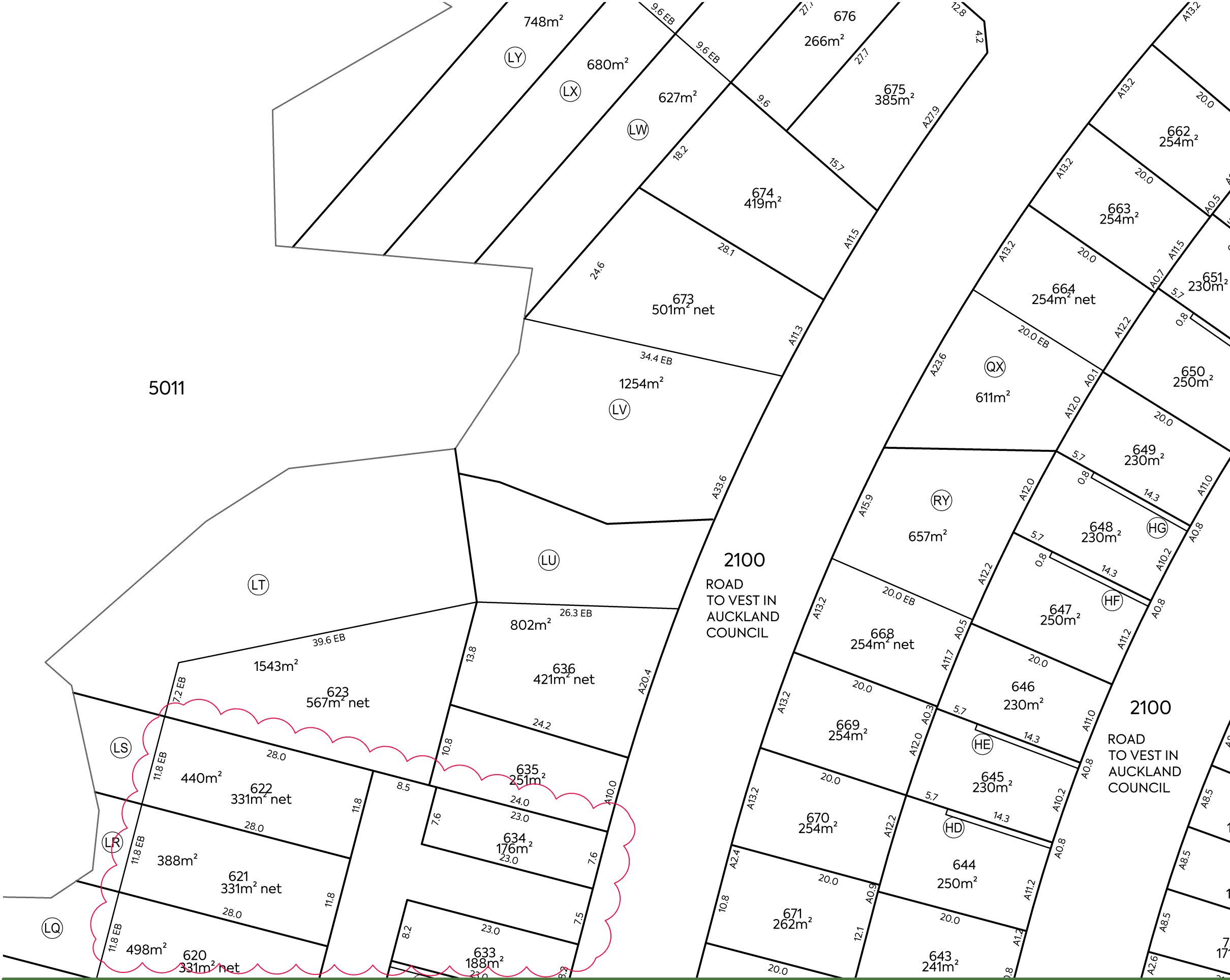

F	SEC 92	DC	JK	JK	02/07/25
E	SEC 92	DC	JK	JK	27/06/25
D	SEC 92	ZW	JK	JK	18/06/25
C	STAGE UPDATED	JX	PC	JK	11/02/25
B	BOUNDARY REVISED	JX	PC	JK	31/01/25
A	FIRST ISSUE	JX	PC	JK	20/12/25
REV	DESCRIPTION	DRN BY	CHK BY	APP BY	DATE



MCKENZIE & CO.

CLIENT: VINEWAY LTD

PROJECT: DELMORE  
53A, 53B & 55 RUSSELL ROAD  
OREWA, AUCKLAND  
STAGE 2A-1

TITLE: LOTS 600-765, 1520-1526, 1628, 2100, 2101 & 5010-5012 BEING A SUBDIVISION OF LOT 2 DP 418770, LOTS 1&2 DP 153477, LOTS 5006 & 5007 DP XXXXXX (STG1B-1), LOT 5009 DP XXXXXX (STG1B-3) & SECTS 2&3 SO XXXXXX  
PURPOSE OF ISSUE: FOR RESOURCE CONSENT  
SCALE: 1:500  
DO NOT SCALE  
DRAWING NO: 3725-2-148  
REV: F





NOTES:

- 1. ALL DIMENSIONS ARE SHOWN IN METERS UNLESS NOTED OTHERWISE.
- 2. ALL AREAS AND DIMENSIONS ARE SUBJECT TO RESOURCE CONSENT AND LINZ APPROVAL.
- 3. LOCAL AUTHORITY: AUCKLAND COUNCIL
- 4. COMPRISED IN CT: NA91C/410 (LOT 2 DP 153477), 472117 (LOT 2 DP 418770), SECTIONS 2 & 3 SO XXXXXX, LOTS 5006 & 5007 DP XXXXXX (STAGE 1B-1) AND LOT 5009 DP XXXXXX (STAGE 1B-3).

SCHEDULE OF PROPOSED COVENANTS		
PURPOSE	SHOWN	BURDENED LAND
BUSH COVENANT	LO	LOT 620 HEREON
	LR	LOT 621 HEREON
	LS	LOT 622 HEREON
	LT	LOT 623 HEREON
	LU	LOT 636 HEREON
	LV	LOT 673 HEREON
	LW	LOT 677 HEREON
	LX	LOT 678 HEREON
	LY	LOT 679 HEREON
	QX	LOT 664 HEREON
	RY	LOT 668 HEREON

MEMORANDUM OF PROPOSED EASEMENTS			
PURPOSE	SHOWN	BURDENED LAND	BENEFITED LAND
MAINTENANCE	HD	LOT 644 HEREON	LOT 645 HEREON
	HE	LOT 645 HEREON	LOT 646 HEREON
	HF	LOT 647 HEREON	LOT 648 HEREON
	HG	LOT 648 HEREON	LOT 649 HEREON
	HH	LOT 650 HEREON	LOT 651 HEREON
	HI	LOT 651 HEREON	LOT 652 HEREON
	HJ	LOT 652 HEREON	LOT 653 HEREON

F	SEC 92	DC	JK	JK	02/07/25
E	SEC 92	DC	JK	JK	27/06/25
D	SEC 92	ZW	JK	JK	18/06/25
C	STAGE UPDATED	JX	PC	JK	11/02/25

A	FIRST ISSUE	MO	PC	JK	20/12/25
REV	DESCRIPTION	DRN BY	CHK BY	APP BY	DATE



MCKENZIE & CO.

CLIENT: VINEWAY LTD

PROJECT: DELMORE  
53A, 53B & 55 RUSSELL ROAD  
OREWA, AUCKLAND  
STAGE 2A-1

TITLE: LOTS 600-765, 1520-1526, 1628, 2100, 2101 & 2102  
PURPOSE OF ISSUE: FOR RESOURCE CONSENT

5010-5012 BEING A SUBDIVISION OF LOT 2 DP 418770, LOTS 1&2 DP 153477, LOTS 5006 & 5007 DP XXXXXX (STG1B-1), LOT 5009 DP XXXXXX (STG1B-3) & SECTS 2&3 SO XXXXXX  
SCALE: 1:500  
DO NOT SCALE  
DRAWING NO: 3725-2-148A  
REV: F



NOTES:

1. ALL DIMENSIONS ARE SHOWN IN METERS UNLESS NOTED OTHERWISE.
2. ALL AREAS AND DIMENSIONS ARE SUBJECT TO RESOURCE CONSENT AND LINZ APPROVAL.
3. LOCAL AUTHORITY: AUCKLAND COUNCIL
4. COMPRISED IN CT: NA91C/410 (LOT 2 DP 153477), 472117 (LOT 2 DP 418770), SECTIONS 2 & 3 SO XXXXXX, LOTS 5006 & 5007 DP XXXXXX (STAGE 1B-1) AND LOT 5009 DP XXXXXX (STAGE 1B-3).

AMALGAMATION CONDITIONS:

THAT LOT 1522 HEREON (LEGAL ACCESS) BE HELD AS TO FIVE UNDIVIDED ONE-FIFTH SHARES BY THE OWNERS OF LOTS 655 TO 659 HEREON AS TENANTS IN THE COMMON IN THE SAID SHARES AND THAT INDIVIDUAL RECORDS OF TITLE BE ISSUED IN ACCORDANCE THEREWITH.

THAT LOT 1523 HEREON (LEGAL ACCESS) BE HELD AS TO EIGHT UNDIVIDED ONE-EIGHTH SHARES BY THE OWNERS OF LOTS 703 TO 710 HEREON AS TENANTS IN THE COMMON IN THE SAID SHARES AND THAT INDIVIDUAL RECORDS OF TITLE BE ISSUED IN ACCORDANCE THEREWITH.

MEMORANDUM OF PROPOSED COVENANTS		
PURPOSE	SHOWN	BURDENED LAND
BUSH COVENANT	(LW)	LOT 677 HEREON
	(LX)	LOT 678 HEREON
	(LY)	LOT 679 HEREON
	(LZ)	LOT 680 HEREON
	(MA)	LOT 681 HEREON
	(MB)	LOT 682 HEREON
	(MC)	LOT 683 HEREON
	(MD)	LOT 684 HEREON
	(ME)	LOT 685 HEREON
	(MF)	LOT 686 HEREON
	(MG)	LOT 687 HEREON

SCHEDULE OF PROPOSED EASEMENTS IN GROSS			
PURPOSE	SHOWN	BURDENED LAND	GRANTEE
RIGHT OF WAY, RIGHT TO CONVEY WATER, GAS, ELECTRICITY & TELECOMMUNICATIONS, RIGHT TO DRAIN WATER & SEWAGE AND MAINTENANCE	(YC)	LOT 1522 HEREON	RESIDENTIAL SOCIETY MANAGEMENT COMPANY (NAME TBC)
	(YD)	LOT 1523 HEREON	

F	SEC 92	DC	JK	JK	02/07/25
E	SEC 92	DC	JK	JK	27/06/25
D	SEC 92	ZW	JK	JK	18/06/25
C	STAGE UPDATED	JX	PC	JK	11/02/25
B	BOUNDARY REVISED	JX	PC	JK	31/01/25
A	FIRST ISSUE	JX	PC	JK	20/12/25
REV	DESCRIPTION	DRN BY	CHK BY	APP BY	DATE



MCKENZIE & CO.

CLIENT: VINEWAY LTD

PROJECT: DELMORE  
53A, 53B & 55 RUSSELL ROAD  
OREWA, AUCKLAND  
STAGE 2A-1

TITLE: LOTS 600-765, 1520-1526, 1628, 2100, 2101 & FOR RESOURCE CONSENT

5010-5012 BEING A SUBDIVISION OF LOT 2 DP 418770, LOTS 1&2 DP 153477, LOTS 5006 & 5007 DP XXXXXX (STG1B-1), LOT 5009 DP XXXXXX (STG1B-3) & SECTS 2&3 SO XXXXXX  
SCALE: 1:500  
DO NOT SCALE  
DRAWING NO: 3725-2-149  
REV: F



NOTES:

- 1. ALL DIMENSIONS ARE SHOWN IN METERS UNLESS NOTED OTHERWISE.
- 2. ALL AREAS AND DIMENSIONS ARE SUBJECT TO RESOURCE CONSENT AND LINZ APPROVAL.
- 3. LOCAL AUTHORITY: AUCKLAND COUNCIL
- 4. COMPRISED IN CT: NA91C/410 (LOT 2 DP 153477), 472117 (LOT 2 DP 418770), SECTIONS 2 & 3 SO XXXXXX, LOTS 5006 & 5007 DP XXXXXX (STAGE 1B-1) AND LOT 5009 DP XXXXXX (STAGE 1B-3).

AMALGAMATION CONDITIONS:

THAT LOT 1525 HEREON (LEGAL ACCESS) BE HELD AS TO SEVENTEEN UNDIVIDED ONE-SEVENTEENTH SHARES BY THE OWNERS OF LOTS 699 TO 702 AND 757 TO 769 HEREON AS TENANTS IN THE COMMON IN THE SAID SHARES AND THAT INDIVIDUAL RECORDS OF TITLE BE ISSUED IN ACCORDANCE THEREWITH.

MEMORANDUM OF PROPOSED EASEMENTS			
PURPOSE	SHOWN	BURDENED LAND	BENEFITED LAND
MAINTENANCE		LOT 655 HEREON	LOT 656 HEREON
		LOT 656 HEREON	LOT 657 HEREON
		LOT 657 HEREON	LOT 658 HEREON
SCHEDULE OF PROPOSED EASEMENTS IN GROSS			
PURPOSE	SHOWN	BURDENED LAND	GRANTEE
RIGHT OF WAY, RIGHT TO CONVEY WATER, GAS, ELECTRICITY & TELECOMMUNICATIONS, RIGHT TO DRAIN WATER & SEWAGE AND MAINTENANCE		LOT 1525 HEREON	RESIDENTIAL SOCIETY MANAGEMENT COMPANY (NAME TBC)
		LOT 1522 HEREON	
		LOT 1523 HEREON	

F	SEC 92	DC	JK	JK	02/07/25
E	SEC 92	DC	JK	JK	27/06/25
D	SEC 92	ZW	JK	JK	18/06/25
C	STAGE UPDATED	JX	PC	JK	11/02/25
B	BOUNDARY REVISED	JX	PC	JK	31/01/25
A	FIRST ISSUE	JX	PC	JK	20/12/25
REV	DESCRIPTION	DRN BY	CHK BY	APP BY	DATE



MCKENZIE & CO.

CLIENT: VINEWAY LTD

PROJECT: DELMORE  
53A, 53B & 55 RUSSELL ROAD  
OREWA, AUCKLAND  
STAGE 2A-1

TITLE: LOTS 600-765, 1520-1526, 1628, 2100, 2101 & 5010-5012 BEING A SUBDIVISION OF LOT 2 DP 418770, LOTS 1&2 DP 153477, LOTS 5006 & 5007 DP XXXXXX (STG1B-1), LOT 5009 DP XXXXXX (STG1B-3) & SECTS 2&3 SO XXXXXX  
PURPOSE OF ISSUE: FOR RESOURCE CONSENT  
SCALE: 1:500  
DO NOT SCALE  
DRAWING NO: 3725-2-150  
REV: F





5012

NOTES:

- ALL DIMENSIONS ARE SHOWN IN METERS UNLESS NOTED OTHERWISE.
- ALL AREAS AND DIMENSIONS ARE SUBJECT TO RESOURCE CONSENT AND LINZ APPROVAL.
- LOCAL AUTHORITY: AUCKLAND COUNCIL
- COMPRISED IN CT: NA91C/410 (LOT 2 DP 153477), 472117 (LOT 2 DP 418770), SECTIONS 2 & 3 SO XXXXXX, LOTS 5006 & 5007 DP XXXXXX (STAGE 1B-1) AND LOT 5009 DP XXXXXX (STAGE 1B-3).

AMALGAMATION CONDITIONS:

THAT LOT 1524 HEREON (LEGAL ACCESS) BE HELD AS TO FOUR UNDIVIDED ONE-FOURTH SHARES BY THE OWNERS OF LOTS 691 TO 694 HEREON AS TENANTS IN THE COMMON IN THE SAID SHARES AND THAT INDIVIDUAL RECORDS OF TITLE BE ISSUED IN ACCORDANCE THEREWITH.

THAT LOT 1525 HEREON (LEGAL ACCESS) BE HELD AS TO SEVENTEEN UNDIVIDED ONE-SEVENTEENTH SHARES BY THE OWNERS OF LOTS 695 TO 702 AND 757 TO 765 HEREON AS TENANTS IN THE COMMON IN THE SAID SHARES AND THAT INDIVIDUAL RECORDS OF TITLE BE ISSUED IN ACCORDANCE THEREWITH.

LEGEND:

LAND IN LIEU OF RESERVE – FOR DRAINAGE PURPOSES



SCHEDULE OF PROPOSED COVENANTS		
PURPOSE	SHOWN	BURDENED LAND
BUSH COVENANT	MC	LOT 683 HEREON
	MD	LOT 684 HEREON
	ME	LOT 685 HEREON
	MF	LOT 686 HEREON
	MG	LOT 687 HEREON
	MH	LOT 688 HEREON
	MI	LOT 689 HEREON
	MJ	LOT 690 HEREON

SCHEDULE OF PROPOSED EASEMENTS IN GROSS			
PURPOSE	SHOWN	BURDENED LAND	GRANTEE
RIGHT OF WAY, RIGHT TO CONVEY WATER, GAS, ELECTRICITY & TELECOMMUNICATIONS, RIGHT TO DRAIN WATER & SEWAGE AND MAINTENANCE	YE	LOT 1524 HEREON	RESIDENTIAL SOCIETY MANAGEMENT COMPANY (NAME TBC)



F	SEC 92	DC	JK	JK	02/07/25
E	SEC 92	DC	JK	JK	27/06/25
D	SEC 92	ZW	JK	JK	18/06/25
C	STAGE UPDATED	JX	PC	JK	11/02/25
B	BOUNDARY REVISED	JX	PC	JK	31/01/25
A	FIRST ISSUE	JX	PC	JK	20/12/25
REV	DESCRIPTION	DRN BY	CHK BY	APP BY	DATE



MCKENZIE & CO.

CLIENT:

VINEWAY LTD

PROJECT:

DELMORE  
53A, 53B & 55 RUSSELL ROAD  
OREWA, AUCKLAND  
STAGE 2A-1

TITLE:

LOTS 600–765, 1520–1526, 1628, 2100, 2101 & FOR RESOURCE CONSENT

5010–5012 BEING A SUBDIVISION OF LOT 2  
DP 418770, LOTS 1&2 DP 153477, LOTS 5006  
&5007 DP XXXXXX (STG1B-1), LOT 5009 DP  
XXXXXX (STG1B-3) & SECTS 2&3 SO XXXXXX

SCALE:  
1:500  
DO NOT SCALE

DRAWING NO:

3725–2–151

REV:

F



- AMALGAMATION CONDITIONS:

SCHEDULE OF PROPOSED EASEMENTS IN GROSS			
PURPOSE	SHOWN	BURDENED LAND	GRANTEE
RIGHT OF WAY, RIGHT TO CONVEY WATER, GAS, ELECTRICITY & TELECOMMUNI- CATIONS, RIGHT TO DRAIN WATER & SEWAGE AND MAINTENANCE	YF	LOT 1525 HEREON	RESIDENTIAL SOCIETY MANAGEMENT COMPANY (NAME TBC)

SCHEDULE OF PROPOSED EASEMENTS IN GROSS			
PURPOSE	SHOWN	BURDENED LAND	GRANTEE
RIGHT OF WAY, RIGHT TO CONVEY WATER, GAS, ELECTRICITY & TELECOMMUNI- CATIONS, RIGHT TO DRAIN WATER & SEWAGE AND MAINTENANCE	YF	LOT 1525 HEREON	RESIDENTIAL SOCIETY MANAGEMENT COMPANY (NAME TBC)

REV	DESCRIPTION	BRN BY	CHK BY	APP BY	DATE
PAGE THREE	0896 OF 0000	10	MARINA COMPTON	ND	000007 JUL95

PLOT DATE 2025-07-02 23:24:10 WWW.MCKENZIEANDCO.CO.NZ THIS DRAWING IS SOLELY FOR USE BY THE CLIENT ON THIS PROJECT ONLY. NO LIABILITY IS ACCEPTED IN ITS USE BY ANY OTHER ENTITY OR FOR ANY OTHER PURPOSE.

TITLE:	PURPOSE OF ISSUE:
LOTS 600-765, 1520-1526, 1628, 2100, 2101 & 5010-5012 BEING A SUBDIVISION OF LOT 2 DP 418770, LOTS 1&2 DP 153477, LOTS 5006 & 5007 DP XXXXXX (STG1B-1), LOT 5009 DP XXXXXX (STG1B-3) & SECTS 2&3 SO XXXXXX	FOR RESOURCE CONSENT
SCALE: 1:500	
DO NOT SCALE	
DRAWING NO:	REV:
3725-2-152	F

REV:  
F

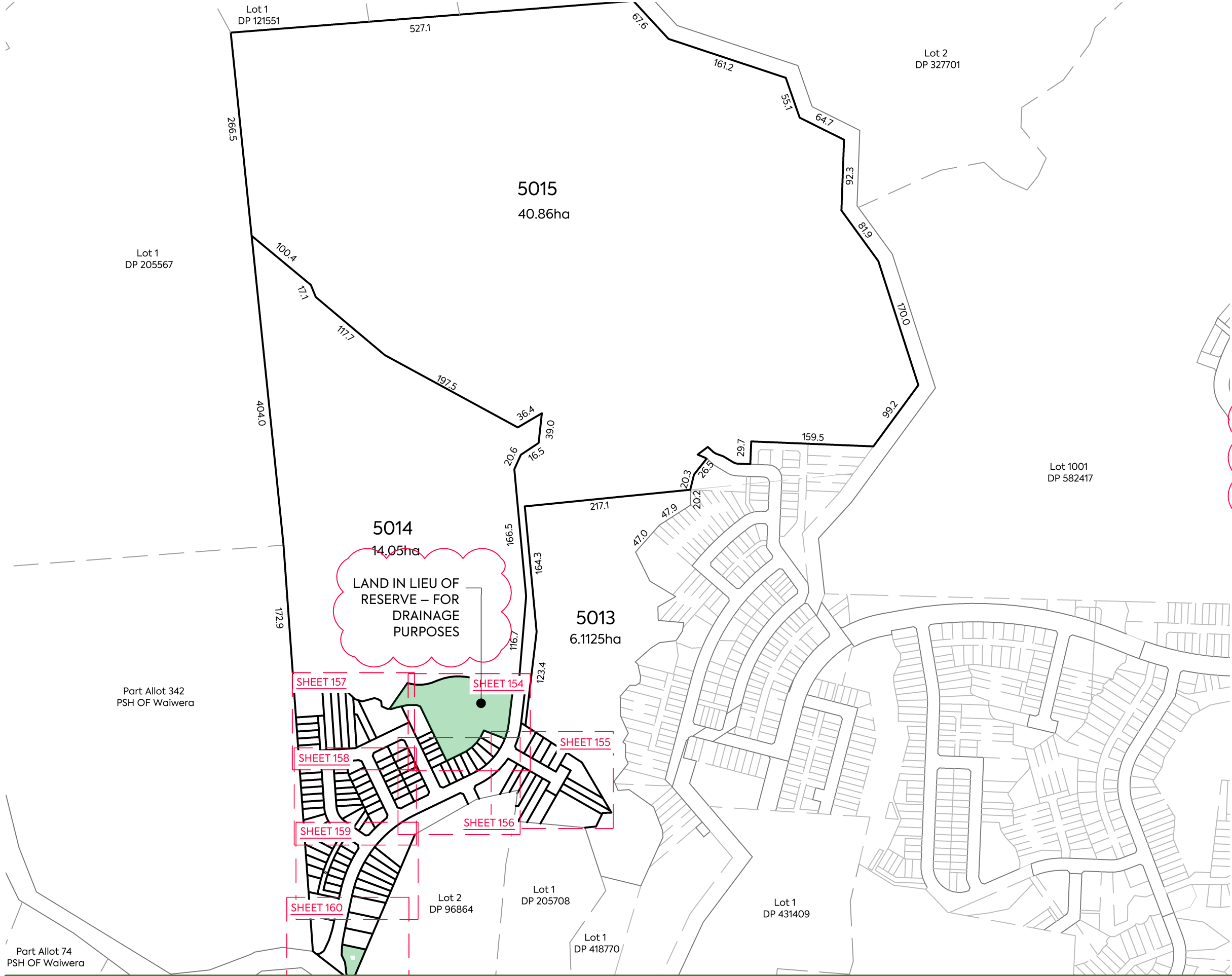

NOTES:

- 1. ALL DIMENSIONS ARE SHOWN IN METERS UNLESS NOTED OTHERWISE.
- 2. ALL AREAS AND DIMENSIONS ARE SUBJECT TO RESOURCE CONSENT AND LINZ APPROVAL.
- 3. LOCAL AUTHORITY: AUCKLAND COUNCIL
- 4. COMPRISED IN CT: RTs OF LOTS 5011 & 5012 DP XXXXXX (STG 2A-1) AND NA91C/409 (LOT 1 DP 153477).

NOTES:

THAT LOTS 1922 AND 1920 STAGE 2B-2, 1910 STAGE 2A-2 WILL BE HELD BY RESIDENTIAL SOCIETY MANAGEMENT COMPANY (NAME TBC).

LEGEND:

LAND IN LIEU OF RESERVE – FOR DRAINAGE PURPOSES

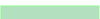

F	SEC 92	DC	JK	JK	02/07/25
E	SEC 92	DC	JK	JK	27/06/25
D	SEC 92	ZW	JK	JK	18/06/25
C	STAGE UPDATED	JX	PC	JK	11/02/25
B	BOUNDARY REVISED	JX	PC	JK	31/01/25
A	FIRST ISSUE	JX	PC	JK	20/12/25
REV	DESCRIPTION	DRN BY	CHK BY	APP BY	DATE



MCKENZIE & CO.

CLIENT:

VINEWAY LTD

PROJECT:

DELMORE  
53A, 53B & 55 RUSSELL ROAD  
OREWA, AUCKLAND  
STAGE 2C

TITLE:

LOTS 1239 - 1353, 1543 - 1544,  
1626 - 1627, 2106 AND 5013 - 5015 BEING A  
SUBDIVISION OF LOT 1 DP 153477 AND  
LOTS 5011 & 5012 DP XXXXXX (STG 2A-1)

PURPOSE OF ISSUE:

FOR RESOURCE CONSENT

SCALE:

1:500

DO NOT SCALE

DRAWING NO:

3725-2-153

REV:

F



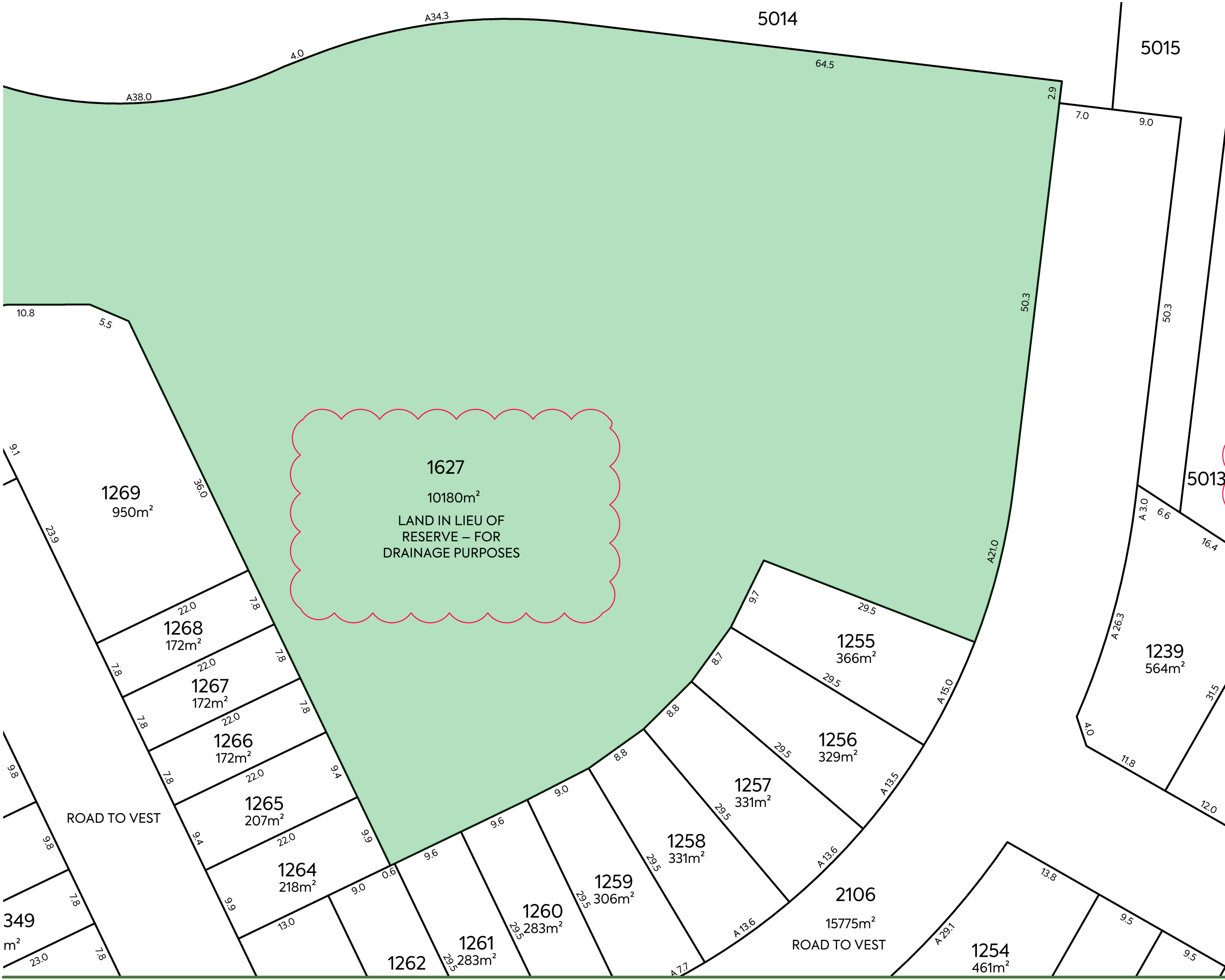

NOTES:

- 1. ALL DIMENSIONS ARE SHOWN IN METERS UNLESS NOTED OTHERWISE.
- 2. ALL AREAS AND DIMENSIONS ARE SUBJECT TO RESOURCE CONSENT AND LINZ APPROVAL.
- 3. LOCAL AUTHORITY: AUCKLAND COUNCIL
- 4. COMPRISED IN CT: RTs OF LOTS 5011 & 5012 DP XXXXXX (STG 2A-1) AND NA91C/409 (LOT 1 DP 153477).

NOTES:

THAT LOTS 1922 AND 1920 STAGE 2B-2, 1910 STAGE 2A-2 WILL BE HELD BY RESIDENTIAL SOCIETY MANAGEMENT COMPANY (NAME TBC).

LEGEND:

LAND IN LIEU OF RESERVE – FOR DRAINAGE PURPOSES



F SEC 92				DC	JK	JK	02/07/25
E SEC 92				DC	JK	JK	27/06/25
D SEC 92				ZW	JK	JK	18/06/25
C STAGE UPDATED				JX	PC	JK	11/02/25
B BOUNDARY REVISED				JX	PC	JK	31/01/25
A FIRST ISSUE				JX	PC	JK	20/12/25
REV	DESCRIPTION			DRN BY	CHK BY	APP BY	DATE

VINEWAY LTD

PROJECT:

DELMORE  
53A, 53B & 55 RUSSELL ROAD  
OREWA, AUCKLAND  
STAGE 2C

TITLE:

LOTS 1239 - 1353, 1543 - 1544,  
1626 - 1627, 2106 AND 5013 - 5015 BEING A  
SUBDIVISION OF LOT 1 DP 153477 AND  
LOTS 5011 & 5012 DP XXXXXX (STG 2A-1)

PURPOSE OF ISSUE:

FOR RESOURCE CONSENT

SCALE:

1:500

DO NOT SCALE

DRAWING NO:

3725-2-154

REV:

F



NOTES:

- 1. ALL DIMENSIONS ARE SHOWN IN METERS UNLESS NOTED OTHERWISE.
- 2. ALL AREAS AND DIMENSIONS ARE SUBJECT TO RESOURCE CONSENT AND LINZ APPROVAL.
- 3. LOCAL AUTHORITY: AUCKLAND COUNCIL
- 4. COMPRISED IN CT: RTs OF LOTS 5011 & 5012 DP XXXXXX (STG 2A-1) AND NA91C/409 (LOT 1 DP 153477).

LEGEND:

LAND IN LIEU OF RESERVE – FOR DRAINAGE PURPOSES



SCHEDULE OF PROPOSED COVENANTS		
PURPOSE	SHOWN	BURDENED LAND
BUSH COVENANT	Q2	LOT 1250 HEREON
	RA	LOT 1249 HEREON
	RB	LOT 1248 HEREON
	RC	LOT 1247 HEREON
	RD	LOT 1246 HEREON
	RE	LOT 1245 HEREON
	RF	LOT 1244 HEREON

F	SEC 92	DC	JK	JK	02/07/25
E	SEC 92	DC	JK	JK	27/06/25
D	SEC 92	ZW	JK	JK	18/06/25
C	STAGE UPDATED	JX	PC	JK	11/02/25
B	BOUNDARY REVISED	JX	PC	JK	31/01/25
A	FIRST ISSUE	JX	PC	JK	20/12/25
REV	DESCRIPTION	DRN BY	CHK BY	APP BY	DATE



MCKENZIE & CO.

CLIENT:

VINEWAY LTD

PROJECT:

DELMORE  
53A, 53B & 55 RUSSELL ROAD  
OREWA, AUCKLAND  
STAGE 2C

TITLE:

LOTS 1239 - 1353, 1543 - 1544,  
1626 - 1627, 2106 AND 5013 - 5015 BEING A  
SUBDIVISION OF LOT 1 DP 153477 AND  
LOTS 5011 & 5012 DP XXXXXX (STG 2A-1)

PURPOSE OF ISSUE:

FOR RESOURCE CONSENT

SCALE:  
1:500

DO NOT SCALE

DRAWING NO:

3725-2-155

REV:

F

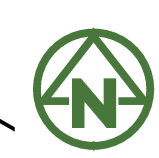

1. ALL DIMENSIONS ARE SHOWN IN METERS UNLESS NOTED OTHERWISE.
2. ALL AREAS AND DIMENSIONS ARE SUBJECT TO RESOURCE CONSENT AND LINZ APPROVAL.
3. LOCAL AUTHORITY: AUCKLAND COUNCIL
4. COMPRISED IN CT: RTs OF LOTS 5011 & 5012 DP XXXXXX (STG 2A-1) AND NA91C/409 (LOT 1 DP 153477).

LAND IN LIEU OF RESERVE – FOR  
DRAINAGE PURPOSES

F	SEC 92	DC	JK	JK	02/07/25
E	SEC 92	DC	JK	JK	27/06/25
D	SEC 92	ZW	JK	JK	18/06/25
C	STAGE UPDATED	JX	PC	JK	11/02/25
B	BOUNDARY REVISED	JX	PC	JK	31/01/25
A	FIRST ISSUE	JX	PC	JK	20/12/25

REV	DESCRIPTION	DRN BY	CHK BY	APP BY	DATE
-----	-------------	--------	--------	--------	------



MCKENZIE & CO.

CLIENT:

VINEWAY LTD

PROJECT:

DELMORE  
53A, 53B & 55 RUSSELL ROAD  
OREWA, AUCKLAND  
STAGE 2C

TITLE:

LOTS 1239 – 1353, 1543 – 1544,  
1626 – 1627, 2106 AND 5013 – 5015 BEING A  
SUBDIVISION OF LOT 1 DP 153477 AND  
LOTS 5011 & 5012 DP XXXXXX (STG 2A-1)

PURPOSE OF ISSUE:

FOR RESOURCE CONSENT

SCALE:

1:500

DO NOT SCALE

DRAWING NO:

3725-2-156

REV:

F



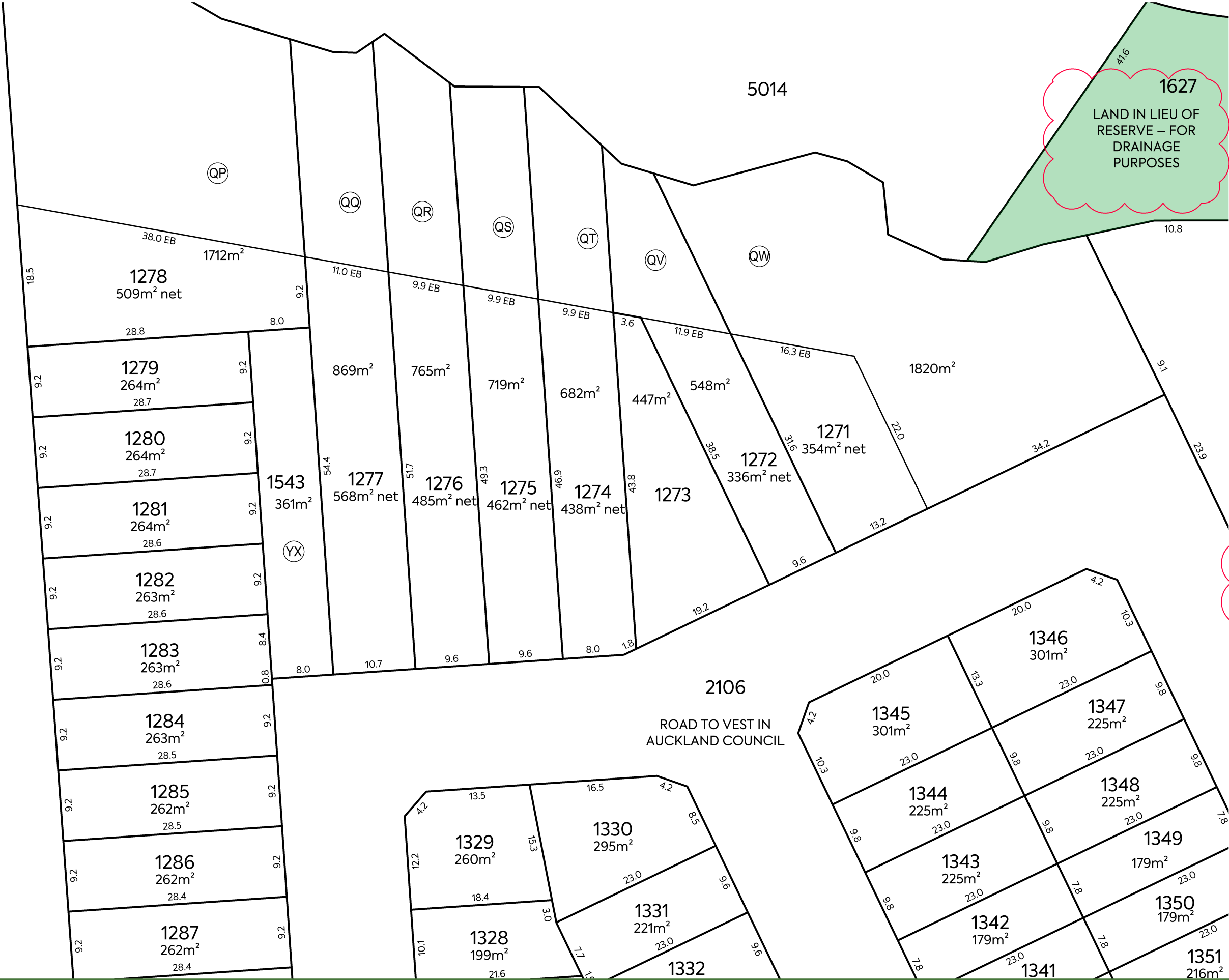

NOTES:

- 1. ALL DIMENSIONS ARE SHOWN IN METERS UNLESS NOTED OTHERWISE.
- 2. ALL AREAS AND DIMENSIONS ARE SUBJECT TO RESOURCE CONSENT AND LINZ APPROVAL.
- 3. LOCAL AUTHORITY: AUCKLAND COUNCIL
- 4. COMPRISED IN CT: RTs OF LOTS 5011 & 5012 DP XXXXXX (STG 2A-1) AND NA91C/409 (LOT 1 DP 153477).

AMALGAMATION CONDITIONS:

THAT LOT 1543 HEREON (LEGAL ACCESS) BE HELD AS TO SIX UNDIVIDED ONE-SIXTH SHARES BY THE OWNERS OF LOTS 1278 TO 1283 HEREON AS TENANTS IN THE COMMON IN THE SAID SHARES AND THAT INDIVIDUAL RECORDS OF TITLE BE ISSUED IN ACCORDANCE THEREWITH.

LEGEND:

LAND IN LIEU OF RESERVE – FOR DRAINAGE PURPOSES

SCHEDULE OF PROPOSED EASEMENTS IN GROSS			
PURPOSE	SHOWN	BURDENED LAND	GRANTEE
RIGHT OF WAY, RIGHT TO CONVEY WATER, GAS, ELECTRICITY & TELECOMMUNICATIONS, RIGHT TO DRAIN WATER & SEWAGE AND MAINTENANCE	YX	LOT 1543 HEREON	RESIDENTIAL SOCIETY MANAGEMENT COMPANY (NAME TBC)

SCHEDULE OF PROPOSED COVENANTS		
PURPOSE	SHOWN	BURDENED LAND
BUSH COVENANT	QP	LOT 1278 HEREON
	QQ	LOT 1277 HEREON
	QR	LOT 1276 HEREON
	QS	LOT 1275 HEREON
	QT	LOT 1274 HEREON
	QV	LOT 1272 HEREON
	QW	LOT 1271 HEREON
	QX	LOT 1270 HEREON

F	SEC 92	DC	JK	JK	02/07/25
E	SEC 92	DC	JK	JK	27/06/25
D	SEC 92	ZW	JK	JK	18/06/25
C	STAGE UPDATED	JK	PC	JK	11/02/25
B	BOUNDARY REVISED	JK	PC	JK	31/01/25
A	FIRST ISSUE	JK	PC	JK	20/12/25
REV	DESCRIPTION	DRN BY	CHK BY	APP BY	DATE



MCKENZIE & CO.

VINEWAY LTD

DELMORE  
53A, 53B & 55 RUSSELL ROAD  
OREWA, AUCKLAND  
STAGE 2C

LOTS 1239 - 1353, 1543 - 1544,  
1626 - 1627, 2106 AND 5013 - 5015 BEING A  
SUBDIVISION OF LOT 1 DP 153477 AND  
LOTS 5011 & 5012 DP XXXXXX (STG 2A-1)

PURPOSE OF ISSUE:	FOR RESOURCE CONSENT
SCALE:	1:500
DO NOT SCALE	
DRAWING NO:	3725-2-157
REV:	F

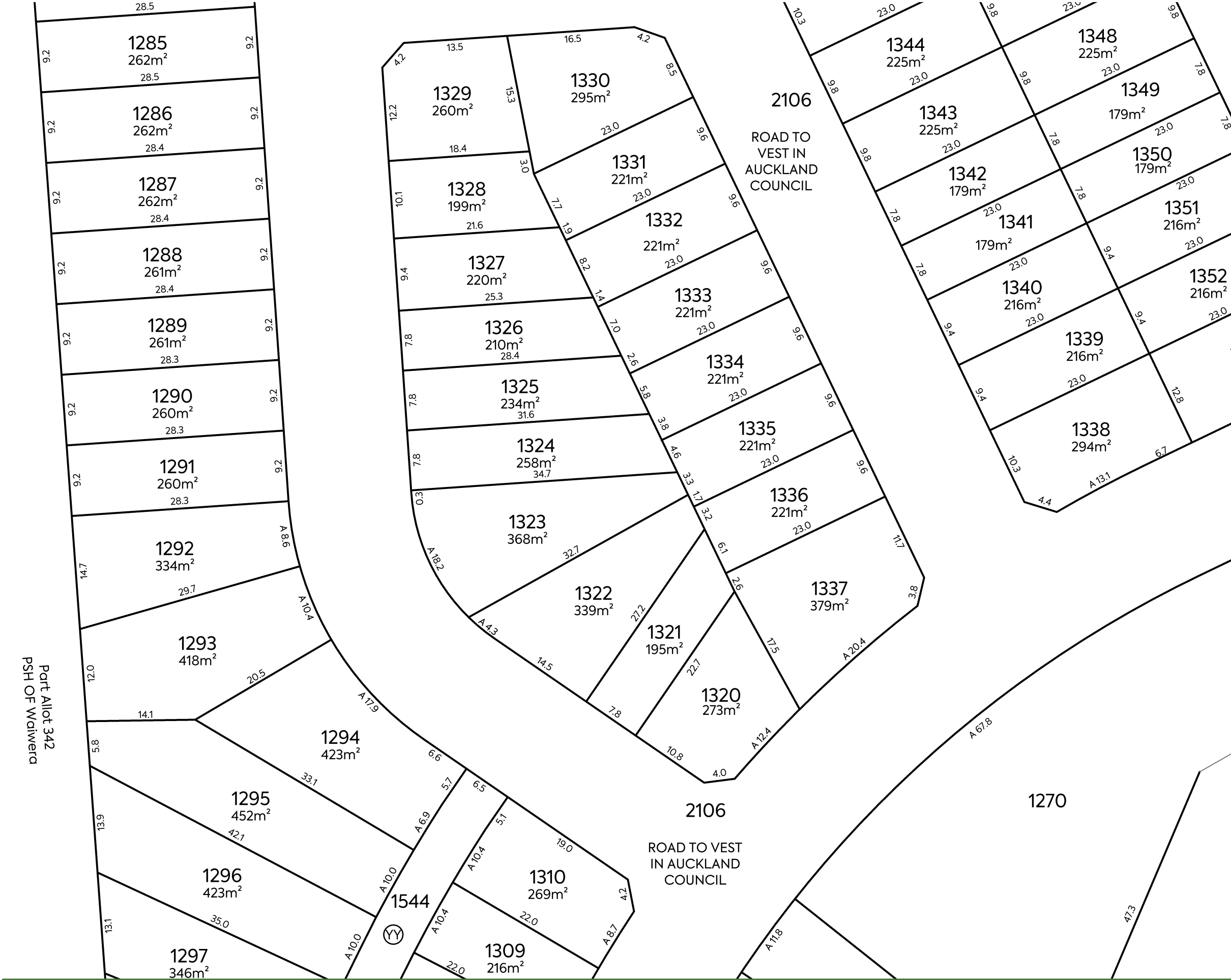

NOTES:

- 1. ALL DIMENSIONS ARE SHOWN IN METERS UNLESS NOTED OTHERWISE.
- 2. ALL AREAS AND DIMENSIONS ARE SUBJECT TO RESOURCE CONSENT AND LINZ APPROVAL.
- 3. LOCAL AUTHORITY: AUCKLAND COUNCIL
- 4. COMPRISED IN CT: RTs OF LOTS 5011 & 5012 DP XXXXXX (STG 2A-1) AND NA91C/409 (LOT 1 DP 153477).

AMALGAMATION CONDITIONS:

THAT LOT 1544 HEREON (LEGAL ACCESS) BE HELD AS TO FOURTEEN UNDIVIDED ONE-FOURTEENTH SHARES BY THE OWNERS OF LOTS 1294 TO 1300 & 1304 TO 1310 HEREON AS TENANTS IN THE COMMON IN THE SAID SHARES AND THAT INDIVIDUAL RECORDS OF TITLE BE ISSUED IN ACCORDANCE THEREWITH.

SCHEDULE OF PROPOSED EASEMENTS IN GROSS			
PURPOSE	SHOWN	BURDENED LAND	GRANTEE
RIGHT OF WAY, RIGHT TO CONVEY WATER, GAS, ELECTRICITY & TELECOMMUNICATIONS, RIGHT TO DRAIN WATER & SEWAGE AND MAINTENANCE	YY	LOT 1544 HEREON	RESIDENTIAL SOCIETY MANAGEMENT COMPANY (NAME TBC)

F	SEC 92	DC	JK	JK	02/07/25
E	SEC 92	DC	JK	JK	27/06/25
D	SEC 92	ZW	JK	JK	18/06/25
C	STAGE UPDATED	JX	PC	JK	11/02/25
B	BOUNDARY REVISED	JX	PC	JK	31/01/25
A	FIRST ISSUE	JX	PC	JK	20/12/25
REV	DESCRIPTION	DRN BY	CHK BY	APP BY	DATE



MCKENZIE & CO.

CLIENT:

VINEWAY LTD

PROJECT:

DELMORE  
53A, 53B & 55 RUSSELL ROAD  
OREWA, AUCKLAND  
STAGE 2C

TITLE:

LOTS 1239 - 1353, 1543 - 1544,  
1626 - 1627, 2106 AND 5013 - 5015 BEING A  
SUBDIVISION OF LOT 1 DP 153477 AND  
LOTS 5011 & 5012 DP XXXXXX (STG 2A-1)

PURPOSE OF ISSUE:

FOR RESOURCE CONSENT

SCALE:  
1:500

DO NOT SCALE

DRAWING NO:

3725-2-158

REV:

F



NOTES:

- 1. ALL DIMENSIONS ARE SHOWN IN METERS UNLESS NOTED OTHERWISE.
- 2. ALL AREAS AND DIMENSIONS ARE SUBJECT TO RESOURCE CONSENT AND LINZ APPROVAL.
- 3. LOCAL AUTHORITY: AUCKLAND COUNCIL
- 4. COMPRISED IN CT: RTs OF LOTS 5011 & 5012 DP XXXXXX (STG 2A-1) AND NA91C/409 (LOT 1 DP 153477).

AMALGAMATION CONDITIONS:

THAT LOT 1544 HEREON (LEGAL ACCESS) BE HELD AS TO FOURTEEN UNDIVIDED ONE-FOURTEENTH SHARES BY THE OWNERS OF LOTS 1294 TO 1300 & 1304 TO 1310 HEREON AS TENANTS IN THE COMMON IN THE SAID SHARES AND THAT INDIVIDUAL RECORDS OF TITLE BE ISSUED IN ACCORDANCE THEREWITH.

SCHEDULE OF PROPOSED EASEMENTS IN GROSS			
PURPOSE	SHOWN	BURDENED LAND	GRANTEE
RIGHT OF WAY, RIGHT TO CONVEY WATER, GAS, ELECTRICITY & TELECOMMUNICATIONS, RIGHT TO DRAIN WATER & SEWAGE AND MAINTENANCE	YY	LOT 1544 HEREON	RESIDENTIAL SOCIETY MANAGEMENT COMPANY (NAME TBC)

F	SEC 92	DC	JK	JK	02/07/25
E	SEC 92	DC	JK	JK	27/06/25
D	SEC 92	ZW	JK	JK	18/06/25
C	STAGE UPDATED	JX	PC	JK	11/02/25
B	BOUNDARY REVISED	JX	PC	JK	31/01/25
A	FIRST ISSUE	JX	PC	JK	20/12/25



MCKENZIE & CO.

CLIENT: VINEWAY LTD

PROJECT: DELMORE  
53A, 53B & 55 RUSSELL ROAD  
OREWA, AUCKLAND  
STAGE 2C

TITLE: LOTS 1239 - 1353, 1543 - 1544,  
1626 - 1627, 2106 AND 5013 - 5015 BEING A  
SUBDIVISION OF LOT 1 DP 153477 AND  
LOTS 5011 & 5012 DP XXXXXX (STG 2A-1)

PURPOSE OF ISSUE: FOR RESOURCE CONSENT

SCALE: 1:500  
DO NOT SCALE

DRAWING NO: 3725-2-159  
REV: F





NOTES:

- 1. ALL DIMENSIONS ARE SHOWN IN METERS UNLESS NOTED OTHERWISE.
- 2. ALL AREAS AND DIMENSIONS ARE SUBJECT TO RESOURCE CONSENT AND LINZ APPROVAL.
- 3. LOCAL AUTHORITY: AUCKLAND COUNCIL
- 4. COMPRISED IN CT: RTs OF LOTS 5011 & 5012 DP XXXXXX (STG 2A-1) AND NA91C/409 (LOT 1 DP 153477).

LEGEND:

LAND IN LIEU OF RESERVE – FOR DRAINAGE PURPOSES



Lot 2  
DP 96864

<div><div><div>F</div><div>SEC 92</div><div>DC</div><div>JK</div><div>JK</div><div>02/07/25</div></div><div><div>E</div><div>SEC 92</div><div>DC</div><div>JK</div><div>JK</div><div>27/06/25</div></div><div><div>D</div><div>SEC 92</div><div>ZW</div><div>JK</div><div>JK</div><div>18/06/25</div></div><div><div>C</div><div>STAGE UPDATED</div><div>JX</div><div>PC</div><div>JK</div><div>11/02/25</div></div><div><div>B</div><div>BOUNDARY REVISED</div><div>JX</div><div>PC</div><div>JK</div><div>31/01/25</div></div><div><div>A</div><div>FIRST ISSUE</div><div>JX</div><div>PC</div><div>JK</div><div>20/12/25</div></div></div> <div><div><div><div></div><div></div><div></div><div></div><div></div><div></div><div></div><div></div><div></div><div></div><div></div><div></div><div></div><div></div><div></div><div></div><div></div><div></div><div></div><div></div><div></div><div></div><div></div><div></div><div></div><div></div><div></div><div></div><div></div><div></div><div></div><div></div><div></div><div></div><div></div><div></div><div></div><div></div><div></div><div></div><div></div><div></div><div></div><div></div><div></div><div></div><div></div><div></div><div></div><div></div><div></div><div></div><div></div><div></div><div></div><div></div><div></div><div></div><div></div><div></div><div></div><div></div><div></div><div></div><div></div><div></div><div></div><div></div><div></div><div></div><div></div><div></div><div></div><div></div><div></div><div></div><div></div><div></div><div></div><div></div><div></div><div></div><div></div><div></div><div></div><div></div><div></div><div></div><div></div><div></div><div></div><div></div><div></div><div></div><div></div><div></div><div></div><div></div><div></div><div></div><div></div><div></div><div></div><div></div><div></div><div></div><div></div><div></div><div></div><div></div><div></div><div></div><div></div><div></div><div></div><div></div><div></div><div></div><div></div><div></div><div></div><div></div><div></div><div></div><div></div><div></div><div></div><div></div><div></div><div></div><div></div><div></div><div></div><div></div><div></div><div></div><div></div><div></div><div></div><div></div><div></div><div></div><div></div><div></div><div></div><div></div><div></div><div></div><div></div><div></div><div></div><div></div><div></div><div></div><div></div><div></div><div></div><div></div><div></div><div></div><div></div><div></div><div></div><div></div><div></div><div></div><div></div><div></div><div></div><div></div><div></div><div></div><div></div><div></div><div></div><div></div><div></div><div></div><div></div><div></div><div></div><div></div><div></div><div></div><div></div><div></div><div></div><div></div><div></div><div></div><div></div><div></div><div></div><div></div><div></div><div></div><div></div><div></div><div></div><div></div><div></div><div></div><div></div><div></div><div></div><div></div><div></div><div></div><div></div><div></div><div></div><div></div><div></div><div></div><div></div><div></div><div></div><div></div><div></div><div></div><div></div><div></div><div></div><div></div><div></div><div></div><div></div><div></div><div></div><div></div><div></div><div></div><div></div><div></div><div></div><div></div><div></div><div></div><div></div><div></div><div></div><div></div><div></div><div></div><div></div><div></div><div></div><div></div><div></div><div></div><div></div><div></div><div></div><div></div><div></div><div></div><div></div><div></div><div></div><div></div><div></div><div></div><div></div><div></div><div></div><div></div><div></div><div></div><div></div><div></div><div></div><div></div><div></div><div></div><div></div><div></div><div></div><div></div><div></div><div></div><div></div><div></div><div></div><div></div><div></div><div></div><div></div><div></div><div></div><div></div><div></div><div></div><div></div><div></div><div></div><div></div><div></div><div></div><div></div><div></div><div></div><div></div><div></div><div></div><div></div><div></div><div></div><div></div><div></div><div></div><div></div><div></div><div></div><div></div><div></div><div></div><div></div><div></div><div></div><div></div><div></div><div></div><div></div><div></div><div></div><div></div><div></div><div></div><div></div><div></div><div></div><div></div><div></div><div></div><div></div><div></div><div></div><div></div><div></div><div></div><div></div><div></div><div></div><div></div><div></div><div></div><div></div><div></div><div></div><div></div><div></div><div></div><div></div><div></div><div></div><div></div><div></div><div></div><div></div><div></div><div></div><div></div><div></div><div></div><div></div><div></div><div></div><div></div><div></div><div></div><div></div><div></div><div></div><div></div><div></div><div></div><div></div><div></div><div></div><div></div><div></div><div></div><div></div><div></div><div></div><div></div><div></div><div></div><div></div><div></div><div></div><div></div><div></div><div></div><div></div><div></div><div></div><div></div><div></div><div></div><div></div><div></div><div></div><div></div><div></div><div></div><div></div><div></div><div></div><div></div><div></div><div></div><div></div><div></div><div></div><div></div><div></div><div></div><div></div><div></div><div></div><div></div><div></div><div></div><div></div><div></div><div></div><div></div><div></div><div></div><div></div><div></div><div></div><div></div><div></div><div></div><div></div><div></div><div></div><div></div><div></div><div></div><div></div><div></div><div></div><div></div><div></div><div></div><div></div><div></div><div></div><div></div><div></div><div></div><div></div><div></div><div></div><div></div><div></div><div></div><div></div><div></div><div></div><div></div><div></div><div></div><div></div><div></div><div></div><div></div><div></div><div></div><div></div><div></div><div></div><div></div><div></div><div></div><div></div><div></div><div></div><div></div><div></div><div></div><div></div><div></div><div></div><div></div><div></div><div></div><div></div><div></div><div></div><div></div><div></div><div></div><div></div><div></div><div></div><div></div><div></div><div></div><div></div><div></div><div></div><div></div><div></div><div></div><div></div><div></div><div></div><div></div><div></div><div></div><div></div><div></div><div></div><div></div><div></div><div></div><div></div><div></div><div></div><div></div><div></div><div></div><div></div><div></div><div></div><div></div><div></div><div></div><div></div><div></div><div></div><div></div><div></div><div></div><div></div><div></div><div></div><div></div><div></div><div></div><div></div><div></div><div></div><div></div><div></div><div></div><div></div><div></div><div></div><div></div><div></div><div></div><div></div><div></div><div></div><div></div><div></div><div></div><div></div><div></div><div></div><div></div><div></div><div></div><div></div><div></div><div></div><div></div><div></div><div></div><div></div><div></div><div></div><div></div><div></div><div></div><div></div><div></div><div></div><div></div><div></div><div></div><div></div><div></div><div></div><div></div><div></div><div></div><div></div><div></div><div></div><div></div><div></div><div></div><div></div><div></div><div></div><div></div><div></div><div></div><div></div><div></div><div></div><div></div><div></div><div></div><div></div><div></div><div></div><div></div><div></div><div></div><div></div><div></div><div></div><div></div><div></div><div></div><div></div><div></div><div></div><div></div><div></div><div></div><div></div><div></div><div></div><div></div><div></div><div></div><div></div><div></div><div></div><div></div><div></div><div></div><div></div><div></div><div></div><div></div><div></div><div></div><div></div><div></div><div></div><div></div><div></div><div></div><div></div><div></div><div></div><div></div><div></div><div></div><div></div><div></div><div></div><div></div><div></div><div></div><div></div><div></div><div></div><div></div><div></div><div></div><div></div><div></div><div></div><div></div><div></div><div></div><div></div><div></div><div></div><div></div><div></div><div></div><div></div><div></div><div></div><div></div><div></div><div></div><div></div><div></div><div></div><div></div><div></div><div></div><div></div><div></div><div></div><div></div><div></div><div></div><div></div><div></div><div></div><div></div><div></div><div></div><div></div><div></div><div></div><div></div><div></div><div></div><div></div><div></div><div></div><div></div><div></div><div></div><div></div><div></div><div></div><div></div><div></div><div></div><div></div><div></div><div></div><div></div><div></div><div></div><div></div><div></div><div></div><div></div><div></div><div></div><div></div><div></div><div></div><div></div><div></div><div></div><div></div><div></div><div></div><div></div><div></div><div></div><div></div><div></div><div></div><div></div><div></div><div></div><div></div><div></div><div></div><div></div><div></div><div></div><div></div><div></div><div></div><div></div><div></div><div></div><div></div><div></div><div></div><div></div><div></div><div></div><div></div><div></div><div></div><div></div><div></div><div></div><div></div><div></div><div></div><div></div><div></div><div></div><div></div><div></div><div></div><div></div><div></div><div></div><div></div><div></div><div></div><div></div><div></div><div></div><div></div><div></div><div></div><div></div><div></div><div></div><div></div><div></div><div></div><div></div><div></div><div></div><div></div><div></div><div></div><div></div><div></div><div></div><div></div><div></div><div></div><div></div><div></div><div></div><div></div><div></div><div></div><div></div><div></div><div></div><div></div><div></div><div></div><div></div><div></div><div></div><div></div><div></div><div></div><div></div><div></div><div></div><div></div><div></div><div></div><div></div><div></div><div></div><div></div><div></div><div></div><div></div><div></div><div></div><div></div><div></div><div></div><div></div><div></div><div></div><div></div><div></div><div></div><div></div><div></div><div></div><div></div><div></div><div></div><div></div><div></div><div></div><div></div><div></div><div></div><div></div><div></div><div></div><div></div><div></div><div></div><div></div><div></div><div></div><div></div><div></div><div></div><div></div><div></div><div></div><div></div><div></div><div></div><div></div><div></div><div></div><div></div><div></div><div></div><div></div><div></div><div></div><div></div><div></div><div></div><div></div><div></div><div></div><div></div><div></div><div></div><div></div><div></div><div></div><div></div><div></div><div></div><div></div><div></div><div></div><div></div><div></div><div></div><div></div><div></div><div></div><div></div><div></div><div></div><div></div><div></div><div></div><div></div><div></div><div></div><div></div><div></div><div></div><div></div><div></div><div></div><div></div><div></div><div></div><div></div><div></div><div></div><div></div><div></div><div></div><div></div><div></div><div></div><div></div><div></div><div></div><div></div><div></div><div></div><div></div><div></div><div></div><div></div><div></div><div></div><div></div><div></div><div></div><div></div><div></div><div></div><div></div><div></div><div></div><div></div><div></div><div></div><div></div><div></div><div></div><div></div><div></div><div></div><div></div><div></div><div></div><div></div><div></div><div></div><div></div><div></div><div></div><div></div><div></div><div></div><div></div><div></div><div></div><div></div><div></div><div></div><div></div><div></div><div></div><div></div><div></div><div></div><div></div><div></div><div></div><div></div><div></div><div></div><div></div><div></div><div></div><div></div><div></div><div></div><div></div><div></div><div></div><div></div><div></div><div></div><div></div><div></div><div></div><div></div><div></div><div></div><div></div><div></div><div></div><div></div><div></div><div></div><div></div><div></div><div></div><div></div><div></div><div></div><div></div><div></div><div></div><div></div><div></div><div></div><div></div><div></div><div></div><div></div><div></div><div></div><div></div><div></div><div></div><div></div><div></div><div></div><div></div><div></div><div></div><div></div><div></div><div></div><div></div><div></div><div></div><div></div><div></div><div></div><div></div><div></div><div></div><div></div><div></div><div></div><div></div><div></div><div></div><div></div><div></div><div></div><div></div><div></div><div></div><div></div><div></div><div></div><div></div><div></div><div></div><div></div><div></div><div></div><div></div><div></div>&lt;</div></div></div>							
--	--	--	--	--	--	--	--



MCKENZIE & CO.

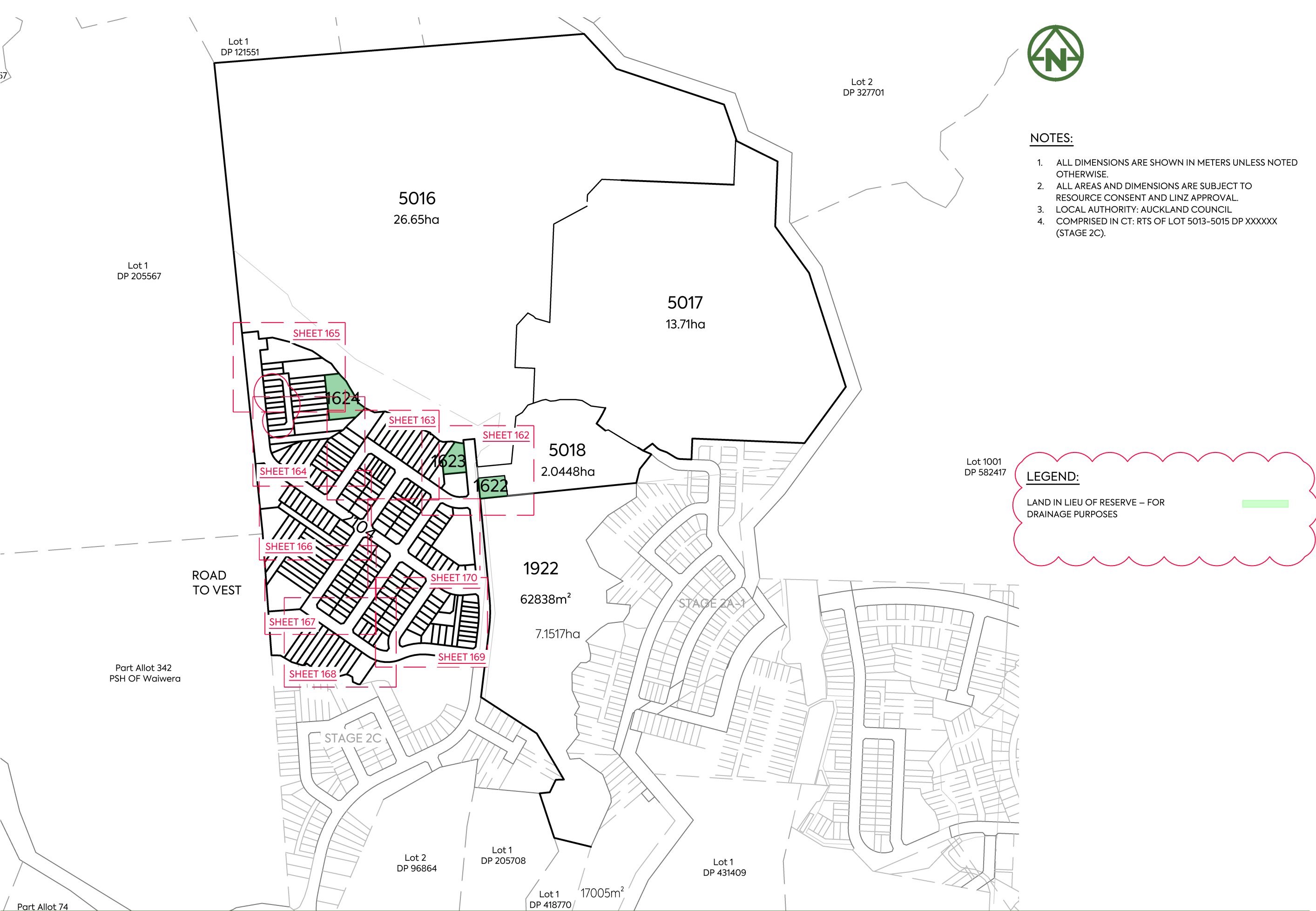

NOTES:

1. ALL DIMENSIONS ARE SHOWN IN METERS UNLESS NOTED OTHERWISE.
2. ALL AREAS AND DIMENSIONS ARE SUBJECT TO RESOURCE CONSENT AND LINZ APPROVAL.
3. LOCAL AUTHORITY: AUCKLAND COUNCIL
4. COMPRISED IN CT: RTS OF LOT 5013-5015 DP XXXXXX (STAGE 2C).

LEGEND:

LAND IN LIEU OF RESERVE – FOR DRAINAGE PURPOSES



DC	JK	JK	02/07/25
DC	JK	JK	27/06/25
ZW	JK	JK	18/06/25
JX	PC	JK	11/02/25
JX	PC	JK	31/01/25
JX	PC	JK	20/12/25

DRN BY CHK BY APP BY DATE



MCKENZIE & CO.

CLIENT:

VINEWAY LTD

PROJECT:

DELMORE  
53A, 53B & 55 RUSSELL ROAD  
OREWA, AUCKLAND  
STAGE 2B-3

TITLE:

LOTS 1024-1238, 1536-1542, 1622-1624,  
1922, 2104, 5016-5018 AND 5020 BEING A  
SUBDIVISION OF LOTS 5013-5015  
DP XXXXXX (STAGE 2C)

PURPOSE OF ISSUE:

FOR RESOURCE CONSENT

SCALE:  
1:500

DO NOT SCALE

DRAWING NO:

3725-2-161

REV:

F



1. ALL DIMENSIONS ARE SHOWN IN METERS UNLESS NOTED OTHERWISE.
2. ALL AREAS AND DIMENSIONS ARE SUBJECT TO RESOURCE CONSENT AND LINZ APPROVAL.
3. LOCAL AUTHORITY: AUCKLAND COUNCIL.
4. COMPRISED IN CT: RTS OF LOT 5013-5015 DP XXXXXX (STAGE 2C).

THAT LOT 1536 HEREON (LEGAL ACCESS) BE HELD AS TO THREE UNDIVIDED ONE-THIRD SHARES BY THE OWNERS OF LOTS 1024 TO 1026 HEREON AS TENANTS IN THE COMMON IN THE SAID SHARES AND THAT INDIVIDUAL RECORDS OF TITLE BE ISSUED IN ACCORDANCE THEREWITH.

## LAND IN LIEU OF RESERVE – FOR DRAINAGE PURPOSES

SCHEDULE OF PROPOSED COVENANTS		
PURPOSE	SHOWN	BURDENED LAND
BUSH COVENANT	(PK)	LOT 1031 HEREON
	(PL)	LOT 1030 HEREON
	(PM)	LOT 1029 HEREON
	(PN)	LOT 1028 HEREON

F	SEC 92	DC	JK	JK	02/07/25
E	SEC 92	DC	JK	JK	27/06/25
D	SEC 92	ZW	JK	JK	18/06/25
C	STAGE UPDATED	JX	PC	JK	11/02/25
B	BOUNDARY REVISED	JX	PC	JK	31/01/25
A	FIRST ISSUE	JX	PC	JK	20/12/25
REV	DESCRIPTION	DRN BY	CHK BY	APP BY	DATE



**MCKENZIE & CO.**

PROJECT:

DELMORE  
53A, 53B & 55 RUSSELL ROAD  
OREWA, AUCKLAND  
STAGE 2B-3

TITLE:

LOTS 1024-1238, 1536-1542, 1622-1624,  
1922, 2104, 5016-5018 AND 5020 BEING A  
SUBDIVISION OF LOTS 5013-5015  
DP XXXXXX (STAGE 2C)

PURPOSE OF ISSUE:

---

FOR RESOURCE CONSENT

---

SCALE:

1:500

DO NOT SCALE

---

DRAWING NO.: 3725-2-162

REV.: F





1. ALL DIMENSIONS ARE SHOWN IN METERS UNLESS NOTED OTHERWISE.
2. ALL AREAS AND DIMENSIONS ARE SUBJECT TO RESOURCE CONSENT AND LINZ APPROVAL.
3. LOCAL AUTHORITY: AUCKLAND COUNCIL.
4. COMPRISED IN CT: RTS OF LOT 5013-5015 DP XXXXXX (STAGE 2C).

THAT LOT 1538 HEREON (LEGAL ACCESS) BE HELD AS TO SIX  
UNDIVIDED ONE-SIXTH SHARES BY THE OWNERS OF LOTS 1081  
TO 1086 HEREON AS TENANTS IN THE COMMON IN THE SAID  
SHARES AND THAT INDIVIDUAL RECORDS OF TITLE BE ISSUED  
IN ACCORDANCE THEREWITH.

THAT LOT 1539 HEREON (LEGAL ACCESS) BE HELD AS TO SIX UNDIVIDED ONE-SIXTH SHARES BY THE OWNERS OF LOTS 1097 TO 1102 HEREON AS TENANTS IN THE COMMON IN THE SAID SHARES AND THAT INDIVIDUAL RECORDS OF TITLE BE ISSUED IN ACCORDANCE THEREWITH.

MEMORANDUM OF PROPOSED EASEMENTS			
PURPOSE	SHOWN	BURDENED LAND	BENEFITED LAND
MAINTENANCE	(M)	LOT 1046 HEREON	LOT 1047 HEREON
	(P)	LOT 1083 HEREON	LOT 1082 HEREON
	(Q)	LOT 1084 HEREON	LOT 1083 HEREON
	(R)	LOT 1085 HEREON	LOT 1084 HEREON
	(S)	LOT 1086 HEREON	LOT 1085 HEREON
	(T)	LOT 1099 HEREON	LOT 1098 HEREON
	(U)	LOT 1100 HEREON	LOT 1099 HEREON
	(V)	LOT 1101 HEREON	LOT 1100 HEREON
	(W)	LOT 1102 HEREON	LOT 1101 HEREON

F	SEC 92	DC	JK	JK	02/07/25
E	SEC 92	DC	JK	JK	27/06/25
D	SEC 92	ZW	JK	JK	18/06/25
C	STAGE UPDATED	JX	PC	JK	11/02/25
B	BOUNDARY REVISED	JX	PC	JK	31/01/25
A	FIRST ISSUE	JX	PC	JK	20/12/25
REV	DESCRIPTION	DRN BY	CHK BY	APP BY	DATE

# MCKENZIE & CO.

DELMORE  
53A, 53B & 55 RUSSELL ROAD  
OREWA, AUCKLAND  
STAGE 2B-3

LOTS 1024-1238, 1536-1542, 1622-1624,  
1922, 2104, 5016-5018 AND 5020 BEING A  
SUBDIVISION OF LOTS 5013-5015  
DP XXXXXX (STAGE 2C)

3725-2-163



NOTES:

1. ALL DIMENSIONS ARE SHOWN IN METERS UNLESS OTHERWISE.
2. ALL AREAS AND DIMENSIONS ARE SUBJECT TO RESOURCE CONSENT AND LINZ APPROVAL.
3. LOCAL AUTHORITY: AUCKLAND COUNCIL.
4. COMPRISED IN CT: RTS OF LOT 5013-5015 DP XXX (STAGE 2C).

AMALGAMATION CONDITIONS:

THAT LOT 1537 HEREON (LEGAL ACCESS) BE HELD AS UNDIVIDED ONE-TENTH SHARES BY THE OWNERS OF 1060 TO 1069 HEREON AS TENANTS IN THE COMMON SAID SHARES AND THAT INDIVIDUAL RECORDS OF TIT ISSUED IN ACCORDANCE THEREWITH.

LEGEND:

LAND IN LIEU OF RESERVE – FOR DRAINAGE PURPOSES

SCHEDULE OF PROPOSED CO		
PURPOSE	SHOWN	BURDENED
BUSH COVENANT	YR	LOT 10
	OZ	LOT 10
	PA	LOT 10
	PB	LOT 10
	ON	LOT 10
	OO	LOT 10
	OP	LOT 10
	OR	LOT 10
	OS	LOT 10
	OT	LOT 10
	OU	LOT 10
	OV	LOT 10

MEMORANDUM OF PROPOSED EASEMENTS			
PURPOSE	SHOWN	BURDENED LAND	BENE
MAINTENANCE	IM	LOT 1046 HEREON	LOT 10
	IN	LOT 1078 HEREON	LOT 10
	IO	LOT 1077 HEREON	LOT 10
SCHEDULE OF PROPOSED EASEMENTS IN			
PURPOSE	SHOWN	BURDENED LAND	GRA
RIGHT OF WAY, RIGHT TO CONVEY WATER, GAS, ELECTRICITY & TELECOMMUNICATIONS, RIGHT TO DRAIN WATER & SEWAGE AND MAINTENANCE	YR	LOT 1537 HEREON	RE S MAI C (N

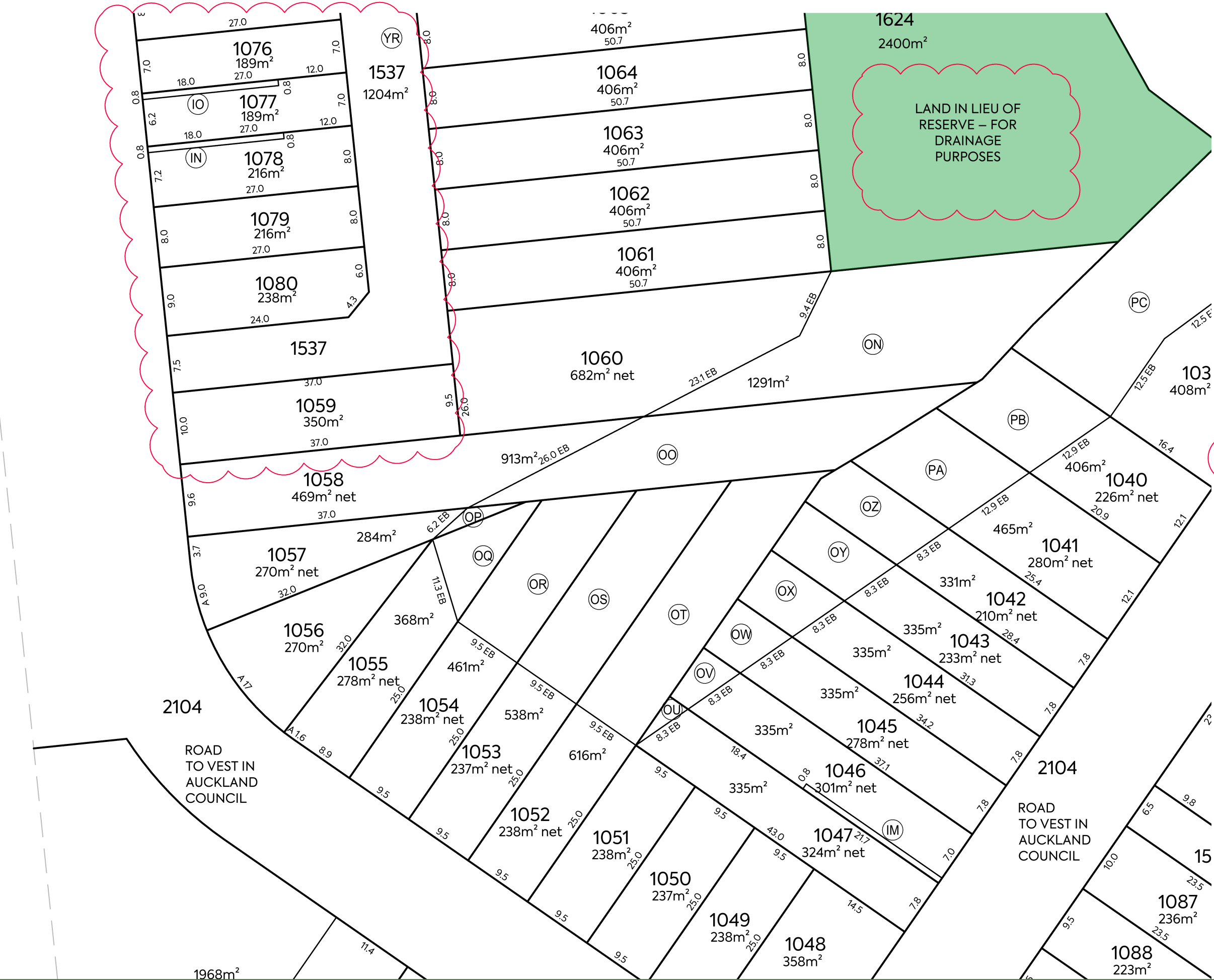

F	SEC 92	DC	JK	JK	02/07/25
E	SEC 92	DC	JK	JK	27/06/25
D	SEC 92	ZW	JK	JK	18/06/25
C	STAGE UPDATED	JX	PC	JK	11/02/25
B	BOUNDARY REVISED	JX	PC	JK	31/01/25
A	FIRST ISSUE	JX	PC	JK	20/12/25
REV	DESCRIPTION	DRN BY	CHK BY	APP BY	DATE



MCKENZIE & CO.

VINEWAY LTD

DELMORE  
53A, 53B & 55 RUSSELL ROAD  
OREWA, AUCKLAND  
STAGE 2B-3

LOTS 1024-1238, 1536-1542, 1622-1624,  
1922, 2104, 5016-5018 AND 5020 BEING A  
SUBDIVISION OF LOTS 5013-5015  
DP XXXXXX (STAGE 2C)

PURPOSE OF ISSUE:  
FOR RESOURCE CO  
SCALE:  
1:500  
DO NOT SCALE  
DRAWING NO:  
3725-2-164



NOTES:

- 1. ALL DIMENSIONS ARE SHOWN IN METERS UNLESS NOTED OTHERWISE.
- 2. ALL AREAS AND DIMENSIONS ARE SUBJECT TO RESOURCE CONSENT AND LINZ APPROVAL.
- 3. LOCAL AUTHORITY: AUCKLAND COUNCIL
- 4. COMPRISED IN CT: RTS OF LOT 5013-5015 DP XXXXXX (STAGE 2C).

AMALGAMATION CONDITIONS:

THAT LOT 1537 HEREON (LEGAL ACCESS) BE HELD AS TO TEN UNDIVIDED ONE-TENTH SHARES BY THE OWNERS OF LOTS 1060 TO 1069 HEREON AS TENANTS IN THE COMMON IN THE SAID SHARES AND THAT INDIVIDUAL RECORDS OF TITLE BE ISSUED IN ACCORDANCE THEREWITH.

LEGEND:

LAND IN LIEU OF RESERVE – FOR DRAINAGE PURPOSES

SCHEDULE OF PROPOSED COVENANTS		
PURPOSE	SHOWN	BURDENED LAND
BUSH COVENANT	OK	LOT 1070 HEREON
	OL	LOT 1069 HEREON

SCHEDULE OF PROPOSED EASEMENTS			
PURPOSE	SHOWN	BURDENED LAND	BENEFITED LAND
MAINTENANCE	IN	LOT 1078 HEREON	LOT 1077 HEREON
	IO	LOT 1077 HEREON	LOT 1076 HEREON

SCHEDULE OF PROPOSED EASEMENTS IN GROSS			
PURPOSE	SHOWN	BURDENED LAND	GRANTEE
RIGHT OF WAY, RIGHT TO CONVEY WATER, GAS, ELECTRICITY & TELECOMMUNICATIONS, RIGHT TO DRAIN WATER & SEWAGE AND MAINTENANCE	YR	LOT 1537 HEREON	RESIDENTIAL SOCIETY MANAGEMENT COMPANY (NAME TBC)

MEMORANDUM OF PROPOSED EASEMENTS IN GROSS			
PURPOSE	SHOWN	BURDENED LAND	GRANTEE
RIGHT OF WAY	RH	LOT 1070 HEREON	AUCKLAND COUNCIL
	YZ	LOT 1069 HEREON	

PURPOSE OF ISSUE:

FOR RESOURCE CONSENT

SCALE:  
1:500

DO NOT SCALE

DRAWING NO:

3725-2-165

REV:

F

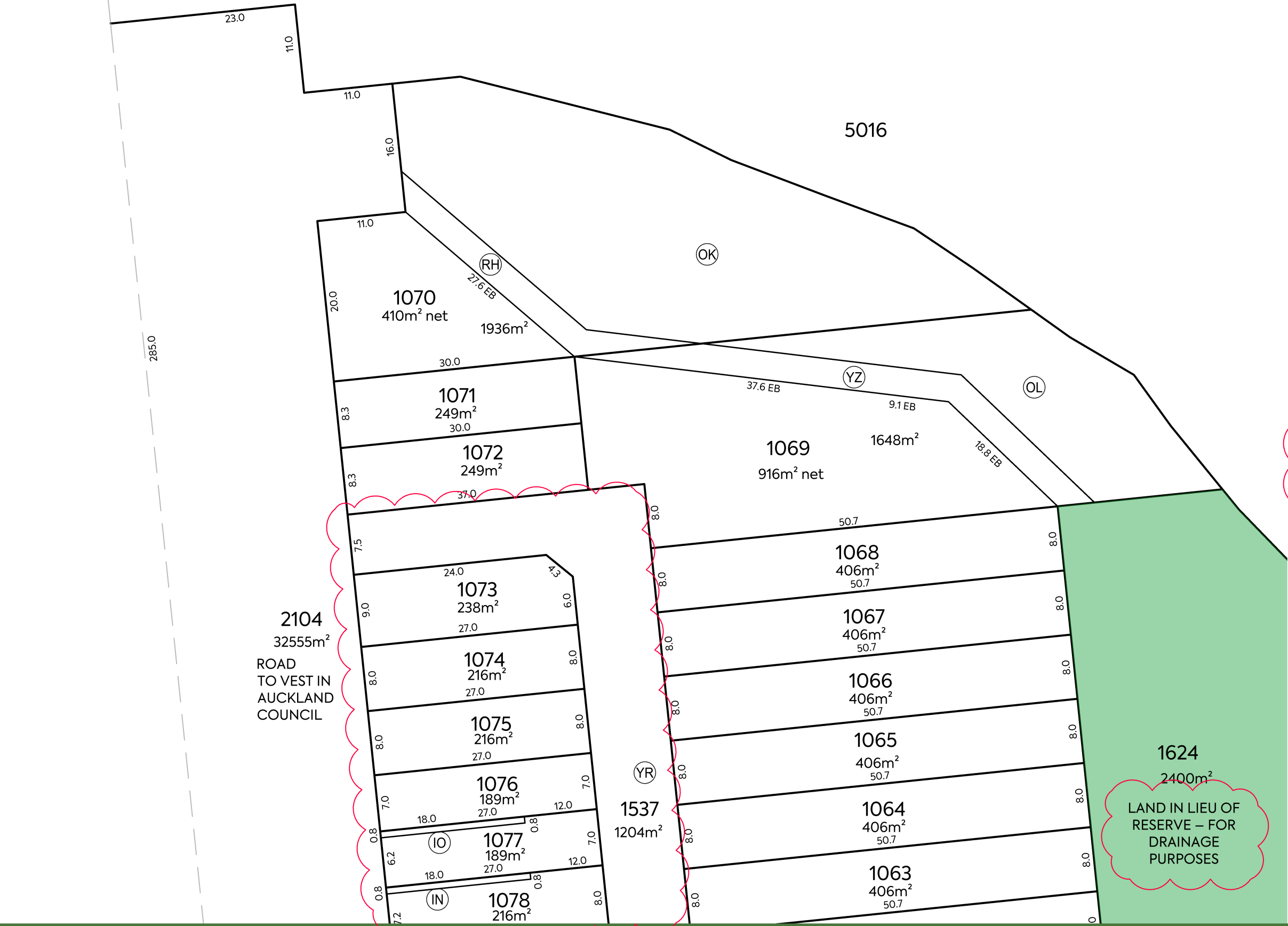

F	SEC 92	DC	JK	JK	02/07/25
E	SEC 92	DC	JK	JK	27/06/25
D	SEC 92	ZW	JK	JK	18/06/25
C	STAGE UPDATED	JX	PC	JK	11/02/25
B	BOUNDARY REVISED	JX	PC	JK	31/01/25
A	FIRST ISSUE	JX	PC	JK	20/12/25
REV	DESCRIPTION	DRN BY	CHK BY	APP BY	DATE



MCKENZIE & CO.

VINEWAY LTD

DELMORE  
53A, 53B & 55 RUSSELL ROAD  
OREWA, AUCKLAND  
STAGE 2B-3

LOTS 1024-1238, 1536-1542, 1622-1624,  
1922, 2104, 5016-5018 AND 5020 BEING A  
SUBDIVISION OF LOTS 5013-5015  
DP XXXXXX (STAGE 2C)