



PROPOSED  
NORTHERN SOLAR FARM

STATION ROAD

STATION ROAD

C300-1

C300-2

C300-3

C300-4

C300-5

C300-6

C300-7

C300-8

C300-9

C300-10

BALANCE LOT

PROPOSED  
RETIREMENT VILLAGE

PROPOSED GREENWAY

PROPOSED  
SOUTHERN SOLAR FARM

LOT 3 DP 463448

SITE BOUNDARY

LOT 77  
DP 07627

LOT 1 DP 463448

RESOURCE CONSENT

#### NOTES

1. All works to be in accordance with Matamata-Piako District Council standards.
2. Co-ordinates in terms of NZ Geodetic Datum MT Eden 2000.
3. Levels in terms of the New Zealand Vertical Datum 2016.
4. Benchmark: IT I DPS 29877 RL: 65.51.
5. Boundaries are subject to final survey.

#### Legend

- PR BOUNDARY
- EX BDY
- PROP LOT BDY
- ROAD CENTRELINE
- PROP STORMWATER
- EX/PROP SWMH
- PROP STREET LIGHT
- SWCP SINGLE
- PROP INDICATIVE VC CROSSING
- SOAKAGE TRENCH - 1.2m WIDE
- SOAKAGE TRENCH - 2m WIDE
- RAINGARDEN - 1.2m / 2.3m WIDE

D	FAST TRACK APP	RJM	06/2025
C	FAST TRACK APP	RJM	05/2025
B	FAST TRACK APP	RJM	04/2025
A	FAST TRACK APP	RJM	04/2025
Rev	Description	By	Date
Survey	MAVEN		05/2024
Design	AP		03/2024
Drawn	AP		03/2024
Checked	DJM		06/2025



Project  
**ASHBOURNE  
RESIDENTIAL  
FOR  
MATAMATA  
DEVELOPMENTS LTD**

Title  
**PROPOSED  
ROADING  
OVERVIEW PLAN**

Project no.	289001		
Scale	1:6000 @ A3		
Cad file	C300-ROADING.DWG		
Drawing no.	C300	Rev	D



NEW INTERSECTION WITH  
STATION ROAD TO BE DESIGNED  
DURING DETAILED DESIGN

NEW LINE MARKINGS AND STATION ROAD  
WIDENING AS PER COMMUTE TRANSPORTATION  
CONSULTANTS DESIGN DATED DECEMBER 2024

APORO DRIVE

ODLUM DRIVE

LOT 1  
DP 365568

LOT 2  
DP 365568

LOT 1  
DP 404835

LOT 2  
DP 404835

LOT 5  
DP 365568

STORMWATER  
BASIN D

RESOURCE CONSENT

- Notes
1. All works to be in accordance with Matamata-Piako District Council Standards.
  2. Co-ordinates in terms of NZ Geodetic Datum Mt Eden 2000
  3. Levels in terms of the NZ Vertical Datum 2016.
  4. Benchmark: IT I DPS 29877 RL:65.51.
  5. Boundaries are subject to final survey.
  6. It is the Contractors responsibility to locate all services that may be affected by his operations.
  7. The Contractors shall obtain all necessary approval from utility operators before commencing work under or near their services.
  8. Final pavement design subject to CBR/Beam tests on subgrade material.
  9. Setout schedule with co-ordinates of chainage points along road centerline to be supplied to the Contractors prior to construction.
  10. Refer to long section for finished centerline levels. Refer to typical cross sections to obtain levels for other locations.
  11. Vehicle crossing to be constructed by others unless otherwise stated.
  12. The Contractor may, with the agreement of the Engineer, adopt the alternative pavement design as specified on typical cross section, provided that the subgrade can achieve a minimum of CBR 3

Legend	
	PR BOUNDARY
	EX BDY
	PROP LOT BDY
	ROAD CENTRELINE
	PROP STORMWATER
	EX/PROP SWMH
	PROP STREET LIGHT
	SWCP SINGLE
	PROP INDICATIVE
	VC CROSSING
	SOAKAGE TRENCH - 1.2m WIDE
	SOAKAGE TRENCH - 2m WIDE
	RAINGARDEN - 1.2m / 2.3m WIDE

D	FAST TRACK APP	RJM	06/2025
C	FAST TRACK APP	RJM	05/2025
B	FAST TRACK APP	RJM	04/2025
A	FAST TRACK APP	RJM	04/2025
Rev	Description	By	Date
		MAVEN	05/2024
Survey	AP		03/2024
Design	AP		03/2024
Drawn	DJM		06/2025
Checked			



**Maven Associates**  
09 571 0050  
info@maven.co.nz  
www.maven.co.nz  
5 Owens Road, Epsom  
Auckland 1023

Project  
**ASHBOURNE  
RESIDENTIAL  
FOR  
MATAMATA  
DEVELOPMENTS LTD**

Title  
**PROPOSED  
ROADING  
PLAN**

Project no.	289001		
Scale	1:1000 @ A3		
Cad file	C300-ROADING.DWG		
Drawing no.	C300-1	Rev	D





OLIVE PLACE

LOT 3  
DP 404835

LOT 9  
DP 562902

LOT 13  
DP 562902

LOT 14  
DP 562902

RESOURCE CONSENT

- Notes
1. All works to be in accordance with Matamata-Piako District Council Standards.
  2. Co-ordinates in terms of NZ Geodetic Datum Mt Eden 2000
  3. Levels in terms of the NZ Vertical Datum 2016.
  4. Benchmark: IT I DPS 29877 RL:65.51.
  5. Boundaries are subject to final survey.
  6. It is the Contractors responsibility to locate all services that may be affected by his operations.
  7. The Contractors shall obtain all necessary approval from utility operators before commencing work under or near their services.
  8. Final pavement design subject to CBR/Beam tests on subgrade material.
  9. Setout schedule with co-ordinates of chainage points along road centerline to be supplied to the Contractors prior to construction.
  10. Refer to long section for finished centerline levels. Refer to typical cross sections to obtain levels for other locations.
  11. Vehicle crossing to be constructed by others unless otherwise stated.
  12. The Contractor may, with the agreement of the Engineer, adopt the alternative pavement design as specified on typical cross section, provided that the subgrade can achieve a minimum of CBR 3

Legend

- PR BOUNDARY
- EX BDY
- PROP LOT BDY
- ROAD CENTRELINE
- PROP STORMWATER
- EX/PROP SWMH
- PROP STREET LIGHT
- SWCP SINGLE
- PROP INDICATIVE VC CROSSING
- SOAKAGE TRENCH - 1.2m WIDE
- SOAKAGE TRENCH - 2m WIDE
- RAINGARDEN - 1.2m / 2.3m WIDE

D	FAST TRACK APP	RJM	06/2025
C	FAST TRACK APP	RJM	05/2025
B	FAST TRACK APP	RJM	04/2025
A	FAST TRACK APP	RJM	04/2025
Rev	Description	By	Date
	Survey	MAVEN	05/2024
	Design	AP	03/2024
	Drawn	AP	03/2024
	Checked	DJM	06/2025

**M** **Maven Associates**  
09 571 0050  
info@maven.co.nz  
www.maven.co.nz  
5 Owens Road, Epsom  
Auckland 1023

Project  
**ASHBOURNE  
RESIDENTIAL  
FOR  
MATAMATA  
DEVELOPMENTS LTD**

Title  
**PROPOSED  
ROADING  
PLAN**

Project no.	289001		
Scale	1:1000 @ A3		
Cad file	C300-ROADING.DWG		
Drawing no.	C300-2	Rev	D

DATE: 6/07/25 FILEPATH: F:\MVEN\HAMITON6 PROJECTS\289001 - STATION ROAD7 DRAWING\11 ASHBOURNE RESIDENTIAL\C300-ROADING.DWG

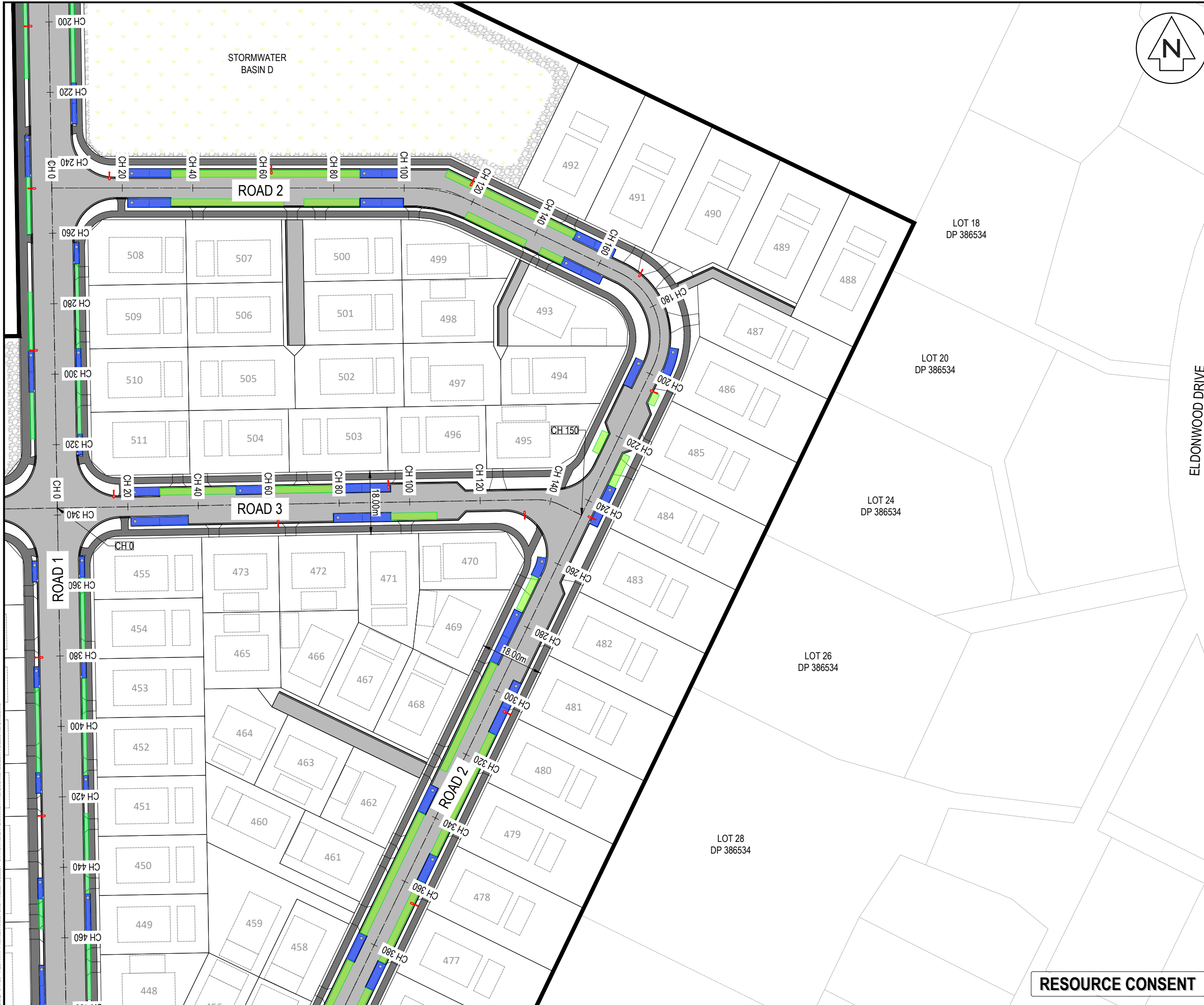

- Notes
1. All works to be in accordance with Matamata-Piako District Council Standards.
  2. Co-ordinates in terms of NZ Geodetic Datum Mt Eden 2000
  3. Levels in terms of the NZ Vertical Datum 2016.
  4. Benchmark: IT I DPS 29877 RL:65.51.
  5. Boundaries are subject to final survey.
  6. It is the Contractors responsibility to locate all services that may be affected by his operations.
  7. The Contractors shall obtain all necessary approval from utility operators before commencing work under or near their services.
  8. Final pavement design subject to CBR/Beam tests on subgrade material.
  9. Setout schedule with co-ordinates of chainage points along road centerline to be supplied to the Contractors prior to construction.
  10. Refer to long section for finished centerline levels. Refer to typical cross sections to obtain levels for other locations.
  11. Vehicle crossing to be constructed by others unless otherwise stated.
  12. The Contractor may, with the agreement of the Engineer, adopt the alternative pavement design as specified on typical cross section, provided that the subgrade can achieve a minimum of CBR 3

- Legend
- PR BOUNDARY
  - EX BDY
  - PROP LOT BDY
  - ROAD CENTRELINE
  - PROP STORMWATER
  - EX/PROP SWMH
  - PROP STREET LIGHT
  - SWCP SINGLE
  - PROP INDICATIVE VC CROSSING
  - SOAKAGE TRENCH - 1.2m WIDE
  - SOAKAGE TRENCH - 2m WIDE
  - RAINGARDEN - 1.2m / 2.3m WIDE

D	FAST TRACK APP	RJM	06/2025
C	FAST TRACK APP	RJM	05/2025
B	FAST TRACK APP	RJM	04/2025
A	FAST TRACK APP	RJM	04/2025
Rev	Description	By	Date
Survey	MAVEN		05/2024
Design	AP		03/2024
Drawn	AP		03/2024
Checked	DJM		06/2025

**M** **Maven Associates**  
09 571 0050  
info@maven.co.nz  
www.maven.co.nz  
5 Owens Road, Epsom  
Auckland 1023

Project  
**ASHBOURNE  
RESIDENTIAL  
FOR  
MATAMATA  
DEVELOPMENTS LTD**

Title  
**PROPOSED  
ROADING  
PLAN**

Project no.	289001		
Scale	1:1000 @ A3		
Cad file	C300-ROADING.DWG		
Drawing no.	C300-3	Rev	D

**RESOURCE CONSENT**





DATE: 6/1/25 FILEPATH: F:\Maven\Hamilton\6. PROJECTS\89001 - STATION ROAD\DRAWING\1. ASHBOURNE RESIDENTIAL\C300-ROADING.DWG

RESOURCE CONSENT

LOT 2  
DP 21055

LOT 18  
DP 562902

HIGHGROVE AVENUE

LOT 16  
DP 562902

LOT 17  
DP 562902

ROAD 5

ROAD 9

ROAD 4

ROAD 2

ROAD 5

- Notes
1. All works to be in accordance with Matamata-Piako District Council Standards.
  2. Co-ordinates in terms of NZ Geodetic Datum Mt Eden 2000
  3. Levels in terms of the NZ Vertical Datum 2016.
  4. Benchmark: IT I DPS 29877 RL:65.51.
  5. Boundaries are subject to final survey.
  6. It is the Contractors responsibility to locate all services that may be affected by his operations.
  7. The Contractors shall obtain all necessary approval from utility operators before commencing work under or near their services.
  8. Final pavement design subject to CBR/Beam tests on subgrade material.
  9. Setout schedule with co-ordinates of chainage points along road centerline to be supplied to the Contractors prior to construction.
  10. Refer to long section for finished centerline levels. Refer to typical cross sections to obtain levels for other locations.
  11. Vehicle crossing to be constructed by others unless otherwise stated.
  12. The Contractor may, with the agreement of the Engineer, adopt the alternative pavement design as specified on typical cross section, provided that the subgrade can achieve a minimum of CBR 3

Legend

- PR BOUNDARY
- EX BDY
- PROP LOT BDY
- ROAD CENTRELINE
- PROP STORMWATER
- EX/PROP SWMH
- PROP STREET LIGHT
- SWCP SINGLE
- PROP INDICATIVE VC CROSSING
- SOAKAGE TRENCH - 1.2m WIDE
- SOAKAGE TRENCH - 2m WIDE
- RAINGARDEN - 1.2m / 2.3m WIDE

D	FAST TRACK APP	RJM	06/2025
C	FAST TRACK APP	RJM	05/2025
B	FAST TRACK APP	RJM	04/2025
A	FAST TRACK APP	RJM	04/2025
Rev	Description	By	Date
Survey	MAVEN		05/2024
Design	AP		03/2024
Drawn	AP		03/2024
Checked	DJM		06/2025

**M** Maven Associates  
09 571 0050  
info@maven.co.nz  
www.maven.co.nz  
5 Owens Road, Epsom  
Auckland 1023

Project  
**ASHBOURNE  
RESIDENTIAL  
FOR  
MATAMATA  
DEVELOPMENTS LTD**

Title  
**PROPOSED  
ROADING  
PLAN**

Project no.	289001
Scale	1:1000 @ A3
Cad file	C300-ROADING.DWG
Drawing no.	C300-4
Rev	D

DATE: 6/1/25 FILEPATH: F:\Maven\Hamilton\6. PROJECTS\88001 - STATION ROAD\ DRAWING\11. ASHBOURNE RESIDENTIAL\C300-ROADING.DWG



RESOURCE CONSENT

- Notes
1. All works to be in accordance with Matamata-Piako District Council Standards.
  2. Co-ordinates in terms of NZ Geodetic Datum Mt Eden 2000
  3. Levels in terms of the NZ Vertical Datum 2016.
  4. Benchmark: IT I DPS 29877 RL:65.51.
  5. Boundaries are subject to final survey.
  6. It is the Contractors responsibility to locate all services that may be affected by his operations.
  7. The Contractors shall obtain all necessary approval from utility operators before commencing work under or near their services.
  8. Final pavement design subject to CBR/Beam tests on subgrade material.
  9. Setout schedule with co-ordinates of chainage points along road centerline to be supplied to the Contractors prior to construction.
  10. Refer to long section for finished centerline levels. Refer to typical cross sections to obtain levels for other locations.
  11. Vehicle crossing to be constructed by others unless otherwise stated.
  12. The Contractor may, with the agreement of the Engineer, adopt the alternative pavement design as specified on typical cross section, provided that the subgrade can achieve a minimum of CBR 3

Legend

- PR BOUNDARY
- EX BDY
- PROP LOT BDY
- ROAD CENTRELINE
- PROP STORMWATER
- EX/PROP SWMH
- PROP STREET LIGHT
- SWCP SINGLE
- PROP INDICATIVE VC CROSSING
- SOAKAGE TRENCH - 1.2m WIDE
- SOAKAGE TRENCH - 2m WIDE
- RAINGARDEN - 1.2m / 2.3m WIDE

D	FAST TRACK APP	RJM	06/2025
C	FAST TRACK APP	RJM	05/2025
B	FAST TRACK APP	RJM	04/2025
A	FAST TRACK APP	RJM	04/2025
Rev	Description	By	Date
		By	Date
Survey	MAVEN		05/2024
Design	AP		03/2024
Drawn	AP		03/2024
Checked	DJM		06/2025

**M** Maven Associates  
09 571 0050  
info@maven.co.nz  
www.maven.co.nz  
5 Owens Road, Epsom  
Auckland 1023

Project  
**ASHBOURNE  
RESIDENTIAL  
FOR  
MATAMATA  
DEVELOPMENTS LTD**

Title  
**PROPOSED  
ROADING  
PLAN**

Project no.	289001		
Scale	1:1000 @ A3		
Cad file	C300-ROADING.DWG		
Drawing no.	C300-5	Rev	D



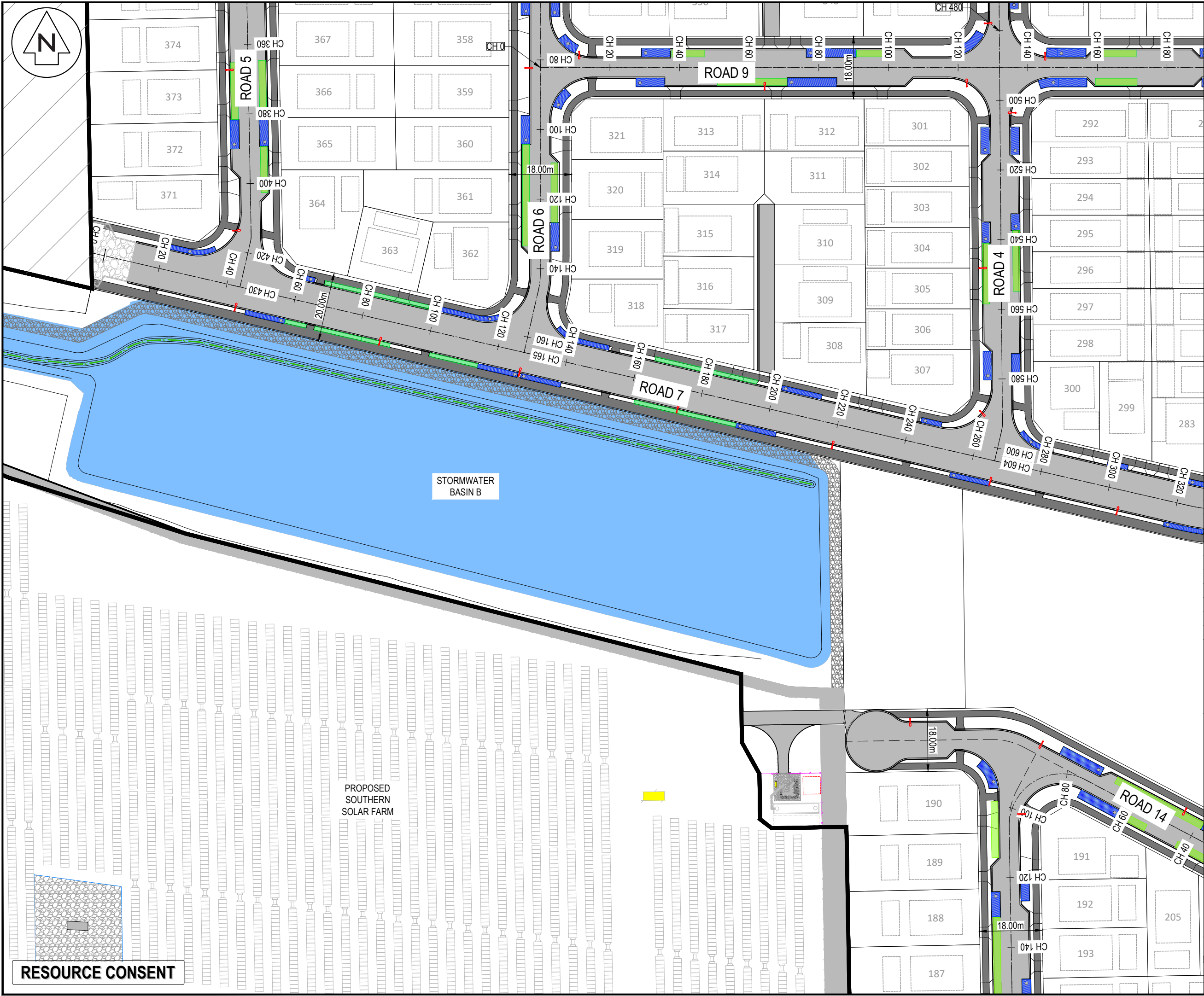

NOTES

- All works to be in accordance with Matamata-Piako District Council standards.
- Co-ordinates in terms of NZ Geodetic Datum MT Eden 2000.
- Levels in terms of the New Zealand Vertical Datum 2016.
- Benchmark: IT I DPS 29877 RL: 65.51.
- Boundaries are subject to final survey.

Legend

- PR BOUNDARY
- EX BDY
- PROP LOT BDY
- ROAD CENTRELINE
- PROP STORMWATER
- EX/PROP SWMH
- PROP STREET LIGHT
- SWCP SINGLE
- PROP INDICATIVE VC CROSSING
- SOAKAGE TRENCH - 1.2m WIDE
- SOAKAGE TRENCH - 2m WIDE
- RAINGARDEN - 1.2m / 2.3m WIDE

D	FAST TRACK APP	RJM	06/2025
C	FAST TRACK APP	RJM	05/2025
B	FAST TRACK APP	RJM	04/2025
A	FAST TRACK APP	RJM	04/2025
Rev	Description	By	Date
		By	Date
Survey	MAVEN		05/2024
Design	AP		03/2024
Drawn	AP		03/2024
Checked	DJM		06/2025

**Maven Associates**  
09 571 0050  
info@maven.co.nz  
www.maven.co.nz  
5 Owens Road, Epsom  
Auckland 1023

Project

**ASHBOURNE  
RESIDENTIAL  
FOR  
MATAMATA  
DEVELOPMENTS LTD**

Title

**PROPOSED  
ROADING  
PLAN**

Project no.	289001		
Scale	1:1000 @ A3		
Cad file	C300-ROADING.DWG		
Drawing no.	C300-6	Rev	D





NOTES

- All works to be in accordance with Matamata-Piako District Council standards.
- Co-ordinates in terms of NZ Geodetic Datum MT Eden 2000.
- Levels in terms of the New Zealand Vertical Datum 2016.
- Benchmark: IT I DPS 29877 RL: 65.51.
- Boundaries are subject to final survey.

Legend

- PR BOUNDARY
- EX BDY
- PROP LOT BDY
- ROAD CENTRELINE
- PROP STORMWATER
- EX/PROP SWMH
- PROP STREET LIGHT
- SWCP SINGLE
- PROP INDICATIVE VC CROSSING
- SOAKAGE TRENCH - 1.2m WIDE
- SOAKAGE TRENCH - 2m WIDE
- RAINGARDEN - 1.2m / 2.3m WIDE

D	FAST TRACK APP	RJM	06/2025
C	FAST TRACK APP	RJM	05/2025
B	FAST TRACK APP	RJM	04/2025
A	FAST TRACK APP	RJM	04/2025
Rev	Description	By	Date
		By	Date
Survey	MAVEN		05/2024
Design	AP		03/2024
Drawn	AP		03/2024
Checked	DJM		06/2025

**Maven Associates**  
09 571 0050  
info@maven.co.nz  
www.maven.co.nz  
5 Owens Road, Epsom  
Auckland 1023

Project  
**ASHBOURNE  
RESIDENTIAL  
FOR  
MATAMATA  
DEVELOPMENTS LTD**

Title  
**PROPOSED  
ROADING  
PLAN**

Project no.	289001		
Scale	1:1000 @ A3		
Cad file	C300-ROADING.DWG		
Drawing no.	C300-7	Rev	<b>D</b>

DATE: 6/1/25 FILEPATH: F:\MVEN\HAMITON\6. PROJECTS\289001 - STATION ROAD\DRAWING\1. ASHBORNE RESIDENTIAL\C300-ROADING.DWG

RESOURCE CONSENT





NOTES

1. All works to be in accordance with Matamata-Piako District Council standards.
2. Co-ordinates in terms of NZ Geodetic Datum MT Eden 2000.
3. Levels in terms of the New Zealand Vertical Datum 2016.
4. Benchmark: IT I DPS 29877 RL: 65.51.
5. Boundaries are subject to final survey.

Legend

	PR BOUNDARY
	EX BDY
	PROP LOT BDY
	ROAD CENTRELINE
	PROP STORMWATER
	EX/PROP SWMH
	PROP STREET LIGHT
	SWCP SINGLE
	PROP INDICATIVE VC CROSSING
	SOAKAGE TRENCH - 1.2m WIDE
	SOAKAGE TRENCH - 2m WIDE
	RAINGARDEN - 1.2m / 2.3m WIDE

D	FAST TRACK APP	RJM	06/2025
C	FAST TRACK APP	RJM	05/2025
B	FAST TRACK APP	RJM	04/2025
A	FAST TRACK APP	RJM	04/2025
Rev	Description	By	Date
		By	Date
Survey	MAVEN		05/2024
Design	AP		03/2024
Drawn	AP		03/2024
Checked	DJM		06/2025

**Maven Associates**  
09 571 0050  
info@maven.co.nz  
www.maven.co.nz  
5 Owens Road, Epsom  
Auckland 1023

Project

**ASHBOURNE  
RESIDENTIAL  
FOR  
MATAMATA  
DEVELOPMENTS LTD**

Title

**PROPOSED  
ROADING  
PLAN**

Project no.	289001		
Scale	1:1000 @ A3		
Cad file	C300-ROADING.DWG		
Drawing no.	C300-8	Rev	D

**RESOURCE CONSENT**



LOT 3  
DP 463448

- NOTES
1. All works to be in accordance with Matamata-Piako District Council standards.
  2. Co-ordinates in terms of NZ Geodetic Datum MT Eden 2000.
  3. Levels in terms of the New Zealand Vertical Datum 2016.
  4. Benchmark: IT I DPS 29877 RL: 65.51.
  5. Boundaries are subject to final survey.

Legend

- PR BOUNDARY
- EX BDY
- PROP LOT BDY
- ROAD CENTRELINE
- PROP STORMWATER
- EX/PROP SWMH
- PROP STREET LIGHT
- SWCP SINGLE
- PROP INDICATIVE VC CROSSING
- SOAKAGE TRENCH - 1.2m WIDE
- SOAKAGE TRENCH - 2m WIDE
- RAINGARDEN - 1.2m / 2.3m WIDE

D	FAST TRACK APP	RJM	06/2025
C	FAST TRACK APP	RJM	05/2025
B	FAST TRACK APP	RJM	04/2025
A	FAST TRACK APP	RJM	04/2025
Rev	Description	By	Date
Survey	MAVEN		05/2024
Design	AP		03/2024
Drawn	AP		03/2024
Checked	DJM		06/2025

**M** **MAVEN** Associates  
09 571 0050  
info@maven.co.nz  
www.maven.co.nz  
5 Owens Road, Epsom  
Auckland 1023

Project  
**ASHBOURNE  
RESIDENTIAL  
FOR  
MATAMATA  
DEVELOPMENTS LTD**

Title  
**PROPOSED  
ROADING  
PLAN**

Project no.	289001		
Scale	1:1000 @ A3		
Cad file	C300-ROADING.DWG		
Drawing no.	C300-9	Rev	<b>D</b>

RESOURCE CONSENT





NOTES

- All works to be in accordance with Matamata-Piako District Council standards.
- Co-ordinates in terms of NZ Geodetic Datum MT Eden 2000.
- Levels in terms of the New Zealand Vertical Datum 2016.
- Benchmark: IT 1 DPS 29877 RL: 65.51.
- Boundaries are subject to final survey.

Legend

- PR BOUNDARY
- EX BDY
- PROP LOT BDY
- ROAD CENTRELINE
- PROP STORMWATER
- EX/PROP SWMH
- PROP STREET LIGHT
- SWCP SINGLE
- PROP INDICATIVE VC CROSSING
- SOAKAGE TRENCH - 1.2m WIDE
- SOAKAGE TRENCH - 2m WIDE
- RAINGARDEN - 1.2m / 2.3m WIDE

D	FAST TRACK APP	RJM	06/2025
C	FAST TRACK APP	RJM	05/2025
B	FAST TRACK APP	RJM	04/2025
A	FAST TRACK APP	RJM	04/2025
Rev	Description	By	Date
		By	Date
Survey	MAVEN		05/2024
Design	AP		03/2024
Drawn	AP		03/2024
Checked	DJM		06/2025

**Maven Associates**  
09 571 0050  
info@maven.co.nz  
www.maven.co.nz  
5 Owens Road, Epsom  
Auckland 1023

Project

**ASHBOURNE  
RESIDENTIAL  
FOR  
MATAMATA  
DEVELOPMENTS LTD**

Title

**PROPOSED  
ROADING  
PLAN**

Project no.	289001		
Scale	1:1000 @ A3		
Cad file	C300-ROADING.DWG		
Drawing no.	C300-10	Rev	D

DATE: 6/07/25 FILEPATH: F:\MVEN\HAMTON6 PROJECTS\289001 - STATION ROAD7 DRAWING\11 ASHBOURNE RESIDENTIAL\C300-ROADING.DWG

RESOURCE CONSENT





PROPOSED  
NORTHERN SOLAR FARM

MATAMATA TOWNSHIP

STATION ROAD

STATION ROAD

C300-23

C300-22

STAGE 8

C300-20

C300-21

STAGE 7

C300-19

STAGE 6

C300-17

STAGE 5

C300-16

STAGE 4

C300-14

STAGE 3

C300-15

C300-13

STAGE 2

C300-12

STAGE 1

PROPOSED GREENWAY

PROPOSED  
SOUTHERN SOLAR FARM

LOT 3 DP 463448

LOT 77  
DP 07627

LOT 1 DP 463448

RESOURCE CONSENT

NOTES

1. All works to be in accordance with Matamata-Piako District Council standards.
2. Co-ordinates in terms of NZ Geodetic Datum MT Eden 2000.
3. Levels in terms of the New Zealand Vertical Datum 2016.
4. Benchmark: IT I DPS 29877 RL: 65.51.
5. Boundaries are subject to final survey.

Legend

- PR BOUNDARY
- EX BDY
- PROP LOT BDY
- ROAD CENTRELINE
- PROP STORMWATER
- EX/PROP SWMH
- PROP STREET LIGHT
- SWCP SINGLE
- PROP INDICATIVE VC CROSSING
- SOAKAGE TRENCH - 1.2m WIDE
- SOAKAGE TRENCH - 2m WIDE
- RAINGARDEN - 1.2m / 2.3m WIDE

D	FAST TRACK APP	RJM	06/2025
C	FAST TRACK APP	RJM	05/2025
B	FAST TRACK APP	RJM	04/2025
A	FAST TRACK APP	RJM	04/2025
Rev	Description	By	Date
		By	Date
Survey	MAVEN		05/2024
Design	AP		03/2024
Drawn	AP		03/2024
Checked	DJM		06/2025



Project  
**ASHBOURNE  
RESIDENTIAL  
FOR  
MATAMATA  
DEVELOPMENTS LTD**

Title  
**PROPOSED  
ROADING  
OVERVIEW PLAN**

Project no.	289001
Scale	1:6000 @ A3
Cad file	C300-ROADING.DWG
Drawing no.	C300-11
Rev	D





- NOTES
1. All works to be in accordance with Matamata-Piako District Council standards.
  2. Co-ordinates in terms of NZ Geodetic Datum MT Eden 2000.
  3. Levels in terms of the New Zealand Vertical Datum 2016.
  4. Benchmark: IT 1 DPS 29877 RL: 65.51.
  5. Boundaries are subject to final survey.

Legend

- PR BOUNDARY
- EX BDY
- PROP LOT BDY
- ROAD CENTRELINE
- PROP STORMWATER
- EX/PROP SWMH
- PROP STREET LIGHT
- SWCP SINGLE
- PROP INDICATIVE VC CROSSING
- SOAKAGE TRENCH - 1.2m WIDE
- SOAKAGE TRENCH - 2m WIDE
- RAINGARDEN - 1.2m / 2.3m WIDE

D	FAST TRACK APP	RJM	06/2025
C	FAST TRACK APP	RJM	05/2025
B	FAST TRACK APP	RJM	04/2025
A	FAST TRACK APP	RJM	04/2025
Rev	Description	By	Date

Survey	MAVEN	Date	05/2024
Design	AP		03/2024
Drawn	AP		03/2024
Checked	DJM		06/2025

**M** Maven Associates  
09 571 0050  
info@maven.co.nz  
www.maven.co.nz  
5 Owens Road, Epsom  
Auckland 1023

Project  
**ASHBOURNE  
RESIDENTIAL  
FOR  
MATAMATA  
DEVELOPMENTS LTD**

Title  
**PROPOSED  
STAGE 1 ROADING  
PLAN**

Project no.	289001		
Scale	1:1000 @ A3		
Cad file	C300-ROADING.DWG		
Drawing no.	C300-12	Rev	D

FUTURE  
STAGE 2

RESOURCE CONSENT





FUTURE  
STAGE 4

FUTURE  
STAGE 3

PREVIOUS  
STAGE 1

LOT 3  
DP 463448

RESOURCE CONSENT

- NOTES
1. All works to be in accordance with Matamata-Piako District Council standards.
  2. Co-ordinates in terms of NZ Geodetic Datum MT Eden 2000.
  3. Levels in terms of the New Zealand Vertical Datum 2016.
  4. Benchmark: IT I DPS 29877 RL: 65.51.
  5. Boundaries are subject to final survey.

Legend

- PR BOUNDARY
- EX BDY
- PROP LOT BDY
- ROAD CENTRELINE
- PROP STORMWATER
- EX/PROP SWMH
- PROP STREET LIGHT
- SWCP SINGLE
- PROP INDICATIVE VC CROSSING
- SOAKAGE TRENCH - 1.2m WIDE
- SOAKAGE TRENCH - 2m WIDE
- RAINGARDEN - 1.2m / 2.3m WIDE

D	FAST TRACK APP	RJM	06/2025
C	FAST TRACK APP	RJM	05/2025
B	FAST TRACK APP	RJM	04/2025
A	FAST TRACK APP	RJM	04/2025
Rev	Description	By	Date
		By	Date
Survey	MAVEN		05/2024
Design	AP		03/2024
Drawn	AP		03/2024
Checked	DJM		06/2025

**M** Maven Associates  
09 571 0050  
info@maven.co.nz  
www.maven.co.nz  
5 Owens Road, Epsom  
Auckland 1023

Project  
**ASHBOURNE  
RESIDENTIAL  
FOR  
MATAMATA  
DEVELOPMENTS LTD**

Title  
**PROPOSED  
STAGE 2 ROADING  
PLAN 1-2**

Project no.	289001		
Scale	1:1000 @ A3		
Cad file	C300-ROADING.DWG		
Drawing no.	C300-13	Rev	<b>D</b>





FUTURE  
STAGE 4

FUTURE  
STAGE 3

RESOURCE CONSENT

LOT 40  
DP 393306

ELDONWOOD DRIVE

LOT 106  
DP 393306

LOT 14  
DP 5844

LOT 15  
DP 584421

LOT 16  
DP 584421

LOT 17  
DP 584421

LOT 18  
DP 584421

LOT 19  
DP 584421

LOT 20  
DP 584421

LOT 2  
DP 584

PEAKEDALE DRIVE

PREVIOUS  
STAGE 1

- NOTES
1. All works to be in accordance with Matamata-Piako District Council standards.
  2. Co-ordinates in terms of NZ Geodetic Datum MT Eden 2000.
  3. Levels in terms of the New Zealand Vertical Datum 2016.
  4. Benchmark: IT I DPS 29877 RL: 65.51.
  5. Boundaries are subject to final survey.

Legend	
	PR BOUNDARY
	EX BDY
	PROP LOT BDY
	ROAD CENTRELINE
	PROP STORMWATER
	EX/PROP SWMH
	PROP STREET LIGHT
	SWCP SINGLE
	PROP INDICATIVE VC CROSSING
	SOAKAGE TRENCH - 1.2m WIDE
	SOAKAGE TRENCH - 2m WIDE
	RAINGARDEN - 1.2m / 2.3m WIDE

D	FAST TRACK APP	RJM	06/2025
C	FAST TRACK APP	RJM	05/2025
B	FAST TRACK APP	RJM	04/2025
A	FAST TRACK APP	RJM	04/2025
Rev	Description	By	Date
Survey	MAVEN		05/2024
Design	AP		03/2024
Drawn	AP		03/2024
Checked	DJM		06/2025



Project  
**ASHBOURNE  
RESIDENTIAL  
FOR  
MATAMATA  
DEVELOPMENTS LTD**

Title  
**PROPOSED  
STAGE 2 ROADING  
PLAN 2-2**

Project no.	289001		
Scale	1:1000 @ A3		
Cad file	C300-ROADING.DWG		
Drawing no.	C300-14	Rev	D



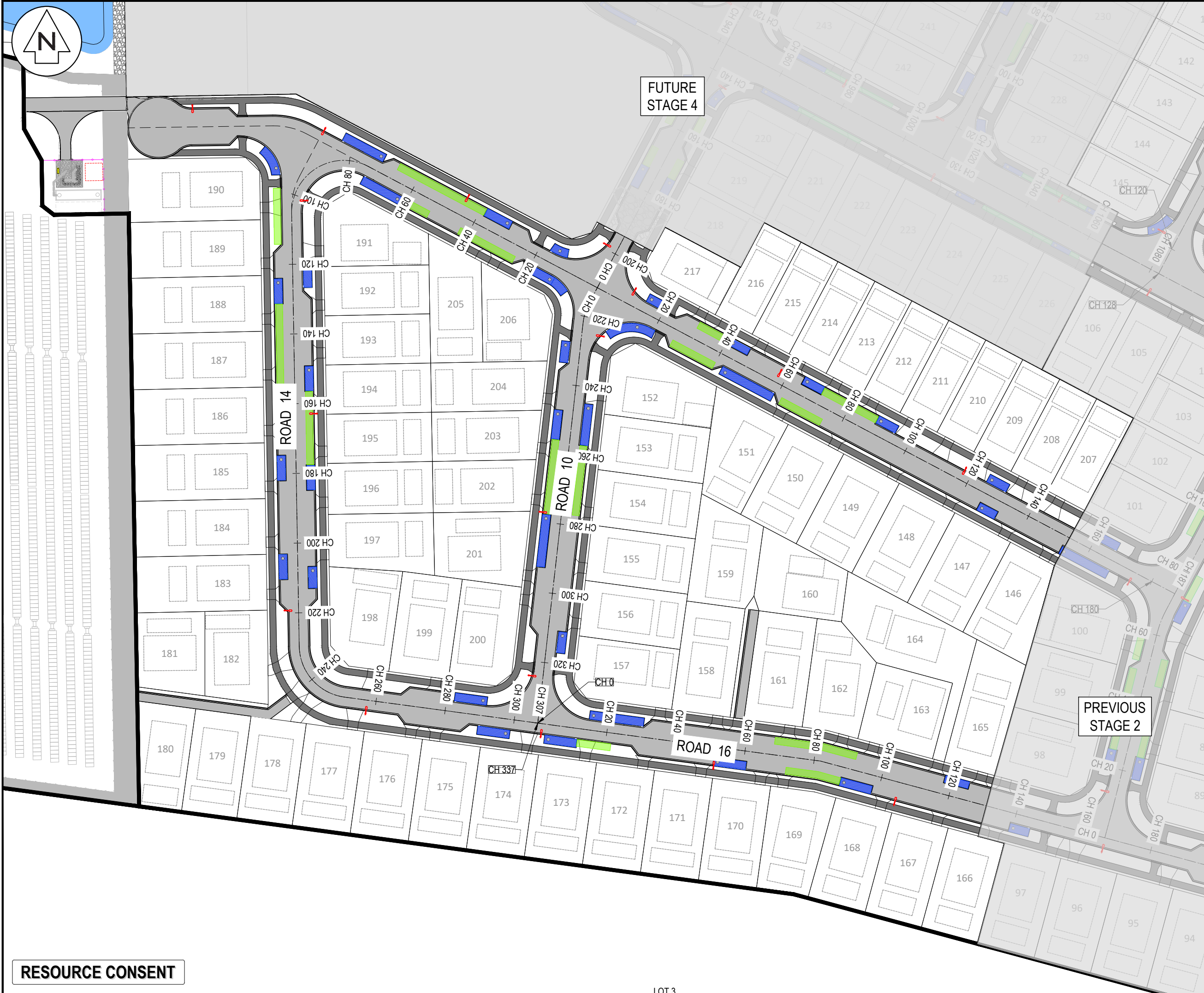

FUTURE  
STAGE 4

PREVIOUS  
STAGE 2

ROAD 16

ROAD 14

ROAD 10



NOTES

- All works to be in accordance with Matamata-Piako District Council standards.
- Co-ordinates in terms of NZ Geodetic Datum MT Eden 2000.
- Levels in terms of the New Zealand Vertical Datum 2016.
- Benchmark: IT I DPS 29877 RL: 65.51.
- Boundaries are subject to final survey.

Legend

- PR BOUNDARY
- EX BDY
- PROP LOT BDY
- ROAD CENTRELINE
- PROP STORMWATER
- EX/PROP SWMH
- PROP STREET LIGHT
- SWCP SINGLE
- PROP INDICATIVE VC CROSSING
- SOAKAGE TRENCH - 1.2m WIDE
- SOAKAGE TRENCH - 2m WIDE
- RAINGARDEN - 1.2m / 2.3m WIDE

D	FAST TRACK APP	RJM	06/2025
C	FAST TRACK APP	RJM	05/2025
B	FAST TRACK APP	RJM	04/2025
A	FAST TRACK APP	RJM	04/2025
Rev	Description	By	Date
		By	Date
Survey	MAVEN		05/2024
Design	AP		03/2024
Drawn	AP		03/2024
Checked	DJM		06/2025

**Maven Associates**  
09 571 0050  
info@maven.co.nz  
www.maven.co.nz  
5 Owens Road, Epsom  
Auckland 1023

Project  
**ASHBOURNE  
RESIDENTIAL  
FOR  
MATAMATA  
DEVELOPMENTS LTD**

Title  
**PROPOSED  
STAGE 3 ROADING  
PLAN**

Project no.	289001		
Scale	1:1000 @ A3		
Cad file	C300-ROADING.DWG		
Drawing no.	C300-15	Rev	D

RESOURCE CONSENT



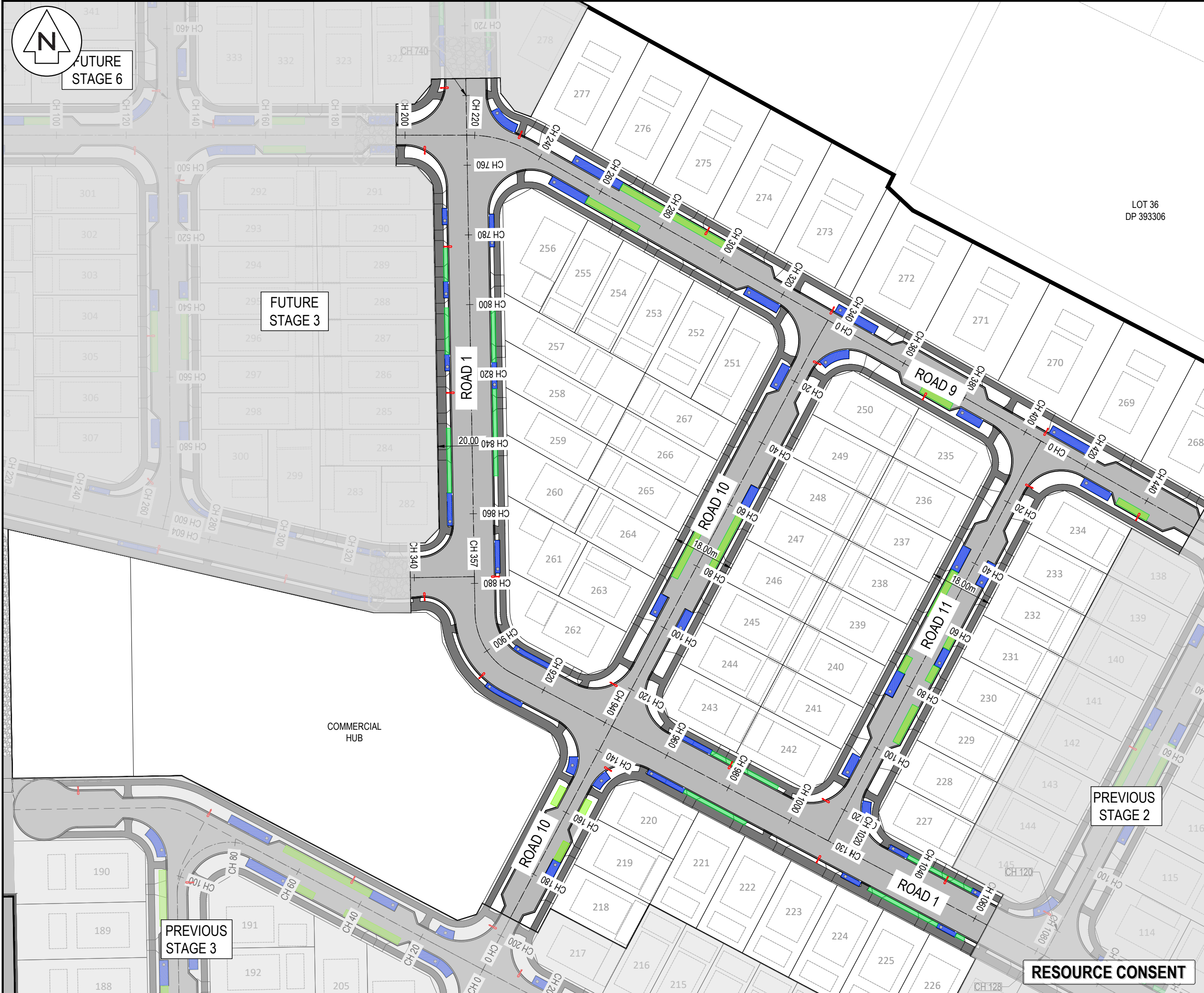

NOTES

- All works to be in accordance with Matamata-Piako District Council standards.
- Co-ordinates in terms of NZ Geodetic Datum MT Eden 2000.
- Levels in terms of the New Zealand Vertical Datum 2016.
- Benchmark: IT I DPS 29877 RL: 65.51.
- Boundaries are subject to final survey.

Legend

- PR BOUNDARY
- EX BDY
- PROP LOT BDY
- ROAD CENTRELINE
- PROP STORMWATER
- EX/PROP SWMH
- PROP STREET LIGHT
- SWCP SINGLE
- PROP INDICATIVE VC CROSSING
- SOAKAGE TRENCH - 1.2m WIDE
- SOAKAGE TRENCH - 2m WIDE
- RAINGARDEN - 1.2m / 2.3m WIDE

D	FAST TRACK APP	RJM	06/2025
C	FAST TRACK APP	RJM	05/2025
B	FAST TRACK APP	RJM	04/2025
A	FAST TRACK APP	RJM	04/2025
Rev	Description	By	Date
Survey	MAVEN		05/2024
Design	AP		03/2024
Drawn	AP		03/2024
Checked	DJM		06/2025

**Maven Associates**  
09 571 0050  
info@maven.co.nz  
www.maven.co.nz  
5 Owens Road, Epsom  
Auckland 1023

Project

**ASHBOURNE  
RESIDENTIAL  
FOR  
MATAMATA  
DEVELOPMENTS LTD**

Title

**PROPOSED  
STAGE 4 ROADING  
PLAN**

Project no.	289001		
Scale	1:1000 @ A3		
Cad file	C300-ROADING.DWG		
Drawing no.	C300-16	Rev	D

RESOURCE CONSENT



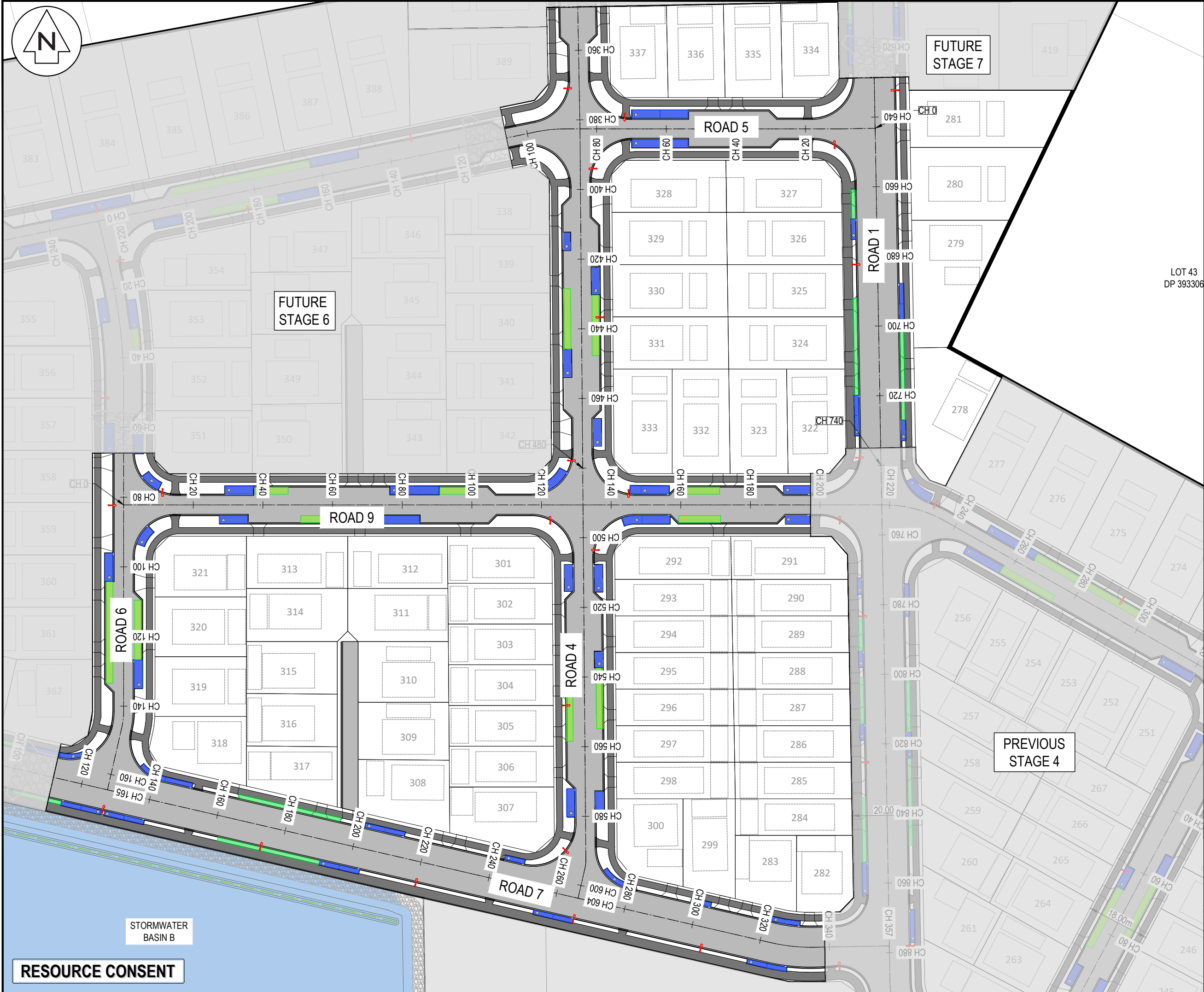

NOTES

- All works to be in accordance with Matamata-Piako District Council standards.
- Co-ordinates in terms of NZ Geodetic Datum MT Eden 2000.
- Levels in terms of the New Zealand Vertical Datum 2016.
- Benchmark: IT I DPS 29877 RL: 65.51.
- Boundaries are subject to final survey.

Legend

- PR BOUNDARY
- EX BDY
- PROP LOT BDY
- ROAD CENTRELINE
- PROP STORMWATER
- EX/PROP SWMH
- PROP STREET LIGHT
- SWCP SINGLE
- PROP INDICATIVE VC CROSSING
- SOAKAGE TRENCH - 1.2m WIDE
- SOAKAGE TRENCH - 2m WIDE
- RAINGARDEN - 1.2m / 2.3m WIDE

D	FAST TRACK APP	RJM	06/2025
C	FAST TRACK APP	RJM	05/2025
B	FAST TRACK APP	RJM	04/2025
A	FAST TRACK APP	RJM	04/2025
Rev	Description	By	Date
		By	Date
Survey	MAVEN		05/2024
Design	AP		03/2024
Drawn	AP		03/2024
Checked	DJM		06/2025

**Maven Associates**  
09 571 0050  
info@maven.co.nz  
www.maven.co.nz  
5 Owens Road, Epsom  
Auckland 1023

Project

**ASHBOURNE  
RESIDENTIAL  
FOR  
MATAMATA  
DEVELOPMENTS LTD**

Title

**PROPOSED  
STAGE 5 ROADING  
PLAN**

Project no.	289001		
Scale	1:1000 @ A3		
Cad file	C300-ROADING.DWG		
Drawing no.	C300-17	Rev	D





LOT 18  
DP 562902

LOT 17  
DP 562902

LOT 2  
DP 21055

FUTURE  
STAGE 7

ROAD 5

ROAD 6

ROAD 5

ROAD 7

PREVIOUS  
STAGE 5

STAGE 3

RESOURCE CONSENT

- NOTES
1. All works to be in accordance with Matamata-Piako District Council standards.
  2. Co-ordinates in terms of NZ Geodetic Datum MT Eden 2000.
  3. Levels in terms of the New Zealand Vertical Datum 2016.
  4. Benchmark: IT I DPS 29877 RL: 65.51.
  5. Boundaries are subject to final survey.

Legend

- PR BOUNDARY
- EX BDY
- PROP LOT BDY
- ROAD CENTRELINE
- PROP STORMWATER
- EX/PROP SWMH
- PROP STREET LIGHT
- SWCP SINGLE
- PROP INDICATIVE VC CROSSING
- SOAKAGE TRENCH - 1.2m WIDE
- SOAKAGE TRENCH - 2m WIDE
- RAINGARDEN - 1.2m / 2.3m WIDE

Rev	Description	By	Date
D	FAST TRACK APP	RJM	06/2025
C	FAST TRACK APP	RJM	05/2025
B	FAST TRACK APP	RJM	04/2025
A	FAST TRACK APP	RJM	04/2025
Survey	MAVEN		05/2024
Design	AP		03/2024
Drawn	AP		03/2024
Checked	DJM		06/2025

**M** Maven Associates  
09 571 0050  
info@maven.co.nz  
www.maven.co.nz  
5 Owens Road, Epsom  
Auckland 1023

Project  
**ASHBOURNE  
RESIDENTIAL  
FOR  
MATAMATA  
DEVELOPMENTS LTD**

Title  
**PROPOSED  
STAGE 6 ROADING  
PLAN**

Project no.	289001
Scale	1:1000 @ A3
Cad file	C300-ROADING.DWG
Drawing no.	C300-18
Rev	D



LOT 14  
DP 562902

LOT 16  
DP 562902

LOT 17  
DP 562902

LOT 47  
DP 393306

LOT 43  
DP 393306

ROAD 2

ROAD 4

ROAD 1

FUTURE  
STAGE 8

PREVIOUS  
STAGE 4

PREVIOUS  
STAGE 5

RESOURCE CONSENT

#### NOTES

1. All works to be in accordance with Matamata-Piako District Council standards.
2. Co-ordinates in terms of NZ Geodetic Datum MT Eden 2000.
3. Levels in terms of the New Zealand Vertical Datum 2016.
4. Benchmark: IT 1 DPS 29877 RL: 65.51.
5. Boundaries are subject to final survey.

#### Legend

- PR BOUNDARY
- EX BDY
- PROP LOT BDY
- ROAD CENTRELINE
- PROP STORMWATER
- EX/PROP SWMH
- PROP STREET LIGHT
- SWCP SINGLE
- PROP INDICATIVE VC CROSSING
- SOAKAGE TRENCH - 1.2m WIDE
- SOAKAGE TRENCH - 2m WIDE
- RAINGARDEN - 1.2m / 2.3m WIDE

D	FAST TRACK APP	RJM	06/2025
C	FAST TRACK APP	RJM	05/2025
B	FAST TRACK APP	RJM	04/2025
A	FAST TRACK APP	RJM	04/2025
Rev	Description	By	Date
		By	Date
Survey	MAVEN		05/2024
Design	AP		03/2024
Drawn	AP		03/2024
Checked	DJM		06/2025



Project  
**ASHBOURNE  
RESIDENTIAL  
FOR  
MATAMATA  
DEVELOPMENTS LTD**

Title  
**PROPOSED  
STAGE 7 ROADING  
PLAN 1-2**

Project no.	289001		
Scale	1:1000 @ A3		
Cad file	C300-ROADING.DWG		
Drawing no.	C300-19	Rev	<b>D</b>





LOT 9  
DP 562902

LOT 13  
DP 562902

LOT 14  
DP 562902

LOT 16  
DP 562902

STORMWATER  
BASIN C

ROAD 4

FUTURE  
STAGE 8

ROAD 4

ROAD 1

CHESTNUT LANE

RESOURCE CONSENT

- NOTES
1. All works to be in accordance with Matamata-Piako District Council standards.
  2. Co-ordinates in terms of NZ Geodetic Datum MT Eden 2000.
  3. Levels in terms of the New Zealand Vertical Datum 2016.
  4. Benchmark: IT 1 DPS 29877 RL: 65.51.
  5. Boundaries are subject to final survey.

Legend

- PR BOUNDARY
- EX BDY
- PROP LOT BDY
- ROAD CENTRELINE
- PROP STORMWATER
- EX/PROP SWMH
- PROP STREET LIGHT
- SWCP SINGLE
- PROP INDICATIVE VC CROSSING
- SOAKAGE TRENCH - 1.2m WIDE
- SOAKAGE TRENCH - 2m WIDE
- RAINGARDEN - 1.2m / 2.3m WIDE

D	FAST TRACK APP	RJM	06/2025
C	FAST TRACK APP	RJM	05/2025
B	FAST TRACK APP	RJM	04/2025
A	FAST TRACK APP	RJM	04/2025
Rev	Description	By	Date
		By	Date
Survey	MAVEN		05/2024
Design	AP		03/2024
Drawn	AP		03/2024
Checked	DJM		06/2025

**M** Maven Associates  
09 571 0050  
info@maven.co.nz  
www.maven.co.nz  
5 Owens Road, Epsom  
Auckland 1023

Project  
**ASHBOURNE  
RESIDENTIAL  
FOR  
MATAMATA  
DEVELOPMENTS LTD**

Title  
**PROPOSED  
STAGE 7 ROADING  
PLAN 2-2**

Project no.	
Scale	1:1000 @ A3
Cad file	C300-ROADING.DWG
Drawing no.	C300-20
Rev	D

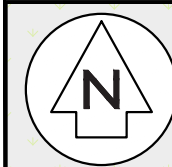

NOTES

- All works to be in accordance with Matamata-Piako District Council standards.
- Co-ordinates in terms of NZ Geodetic Datum MT Eden 2000.
- Levels in terms of the New Zealand Vertical Datum 2016.
- Benchmark: IT I DPS 29877 RL: 65.51.
- Boundaries are subject to final survey.

Legend

- PR BOUNDARY
- EX BDY
- PROP LOT BDY
- ROAD CENTRELINE
- PROP STORMWATER
- EX/PROP SWMH
- PROP STREET LIGHT
- SWCP SINGLE
- PROP INDICATIVE VC CROSSING
- SOAKAGE TRENCH - 1.2m WIDE
- SOAKAGE TRENCH - 2m WIDE
- RAINGARDEN - 1.2m / 2.3m WIDE

D	FAST TRACK APP	RJM	06/2025
C	FAST TRACK APP	RJM	05/2025
B	FAST TRACK APP	RJM	04/2025
A	FAST TRACK APP	RJM	04/2025
Rev	Description	By	Date
		By	Date
Survey	MAVEN		05/2024
Design	AP		03/2024
Drawn	AP		03/2024
Checked	DJM		06/2025

**Maven Associates**  
09 571 0050  
info@maven.co.nz  
www.maven.co.nz  
5 Owens Road, Epsom  
Auckland 1023

Project

**ASHBOURNE  
RESIDENTIAL  
FOR  
MATAMATA  
DEVELOPMENTS LTD**

Title

**PROPOSED  
STAGE 8 ROADING  
PLAN 1-3**

Project no.	289001		
Scale	1:1000 @ A3		
Cad file	C300-ROADING.DWG		
Drawing no.	C300-21	Rev	D





LOT 5  
DP 365568

STORMWATER  
BASIN D

ROAD 1

ROAD 3

ROAD 2

LOT 18  
DP 386534

LOT 20  
DP 386534

LOT 24  
DP 386534

LOT 26  
DP 386534

LOT 28  
DP 386534

NOTES

- All works to be in accordance with Matamata-Piako District Council standards.
- Co-ordinates in terms of NZ Geodetic Datum MT Eden 2000.
- Levels in terms of the New Zealand Vertical Datum 2016.
- Benchmark: IT I DPS 29877 RL: 65.51.
- Boundaries are subject to final survey.

Legend

- PR BOUNDARY
- EX BDY
- PROP LOT BDY
- ROAD CENTRELINE
- PROP STORMWATER
- EX/PROP SWMH
- PROP STREET LIGHT
- SWCP SINGLE
- PROP INDICATIVE VC CROSSING
- SOAKAGE TRENCH - 1.2m WIDE
- SOAKAGE TRENCH - 2m WIDE
- RAINGARDEN - 1.2m / 2.3m WIDE

D	FAST TRACK APP	RJM	06/2025
C	FAST TRACK APP	RJM	05/2025
B	FAST TRACK APP	RJM	04/2025
A	FAST TRACK APP	RJM	04/2025
Rev	Description	By	Date
		By	Date
Survey	MAVEN		05/2024
Design	AP		03/2024
Drawn	AP		03/2024
Checked	DJM		06/2025

**M** Maven Associates  
09 571 0050  
info@maven.co.nz  
www.maven.co.nz  
5 Owens Road, Epsom  
Auckland 1023

Project  
**ASHBOURNE  
RESIDENTIAL  
FOR  
MATAMATA  
DEVELOPMENTS LTD**

Title  
**PROPOSED  
STAGE 8 ROADING  
PLAN 2-3**

Project no.	289001		
Scale	1:1000 @ A3		
Cad file	C300-ROADING.DWG		
Drawing no.	C300-22	Rev	D

DATE: 6/1/25 FILEPATH: F:\MAVEN\HAMITON6 PROJECTS\289001 - STATION ROAD.DWG\11 ASHBORNE RESIDENTIAL\C300-ROADING.DWG

PREVIOUS  
STAGE 7

RESOURCE CONSENT



APORO DRIVE

ODLUM DRIVE

LOT 1  
DP 365568

LOT 2  
DP 365568

LOT 1  
DP 404835

LOT 2  
DP 404835

LOT 5  
DP 365568

ROAD 1

517

516

515

514

513

512

518

CH 60

CH 80

CH 100

CH 120

CH 140

CH 160

CH 180

CH 200

CH 20

CH 40

STORMWATER  
BASIN D

RESOURCE CONSENT

- NOTES
1. All works to be in accordance with Matamata-Piako District Council standards.
  2. Co-ordinates in terms of NZ Geodetic Datum MT Eden 2000.
  3. Levels in terms of the New Zealand Vertical Datum 2016.
  4. Benchmark: IT I DPS 29877 RL: 65.51.
  5. Boundaries are subject to final survey.

Legend

- PR BOUNDARY
- EX BDY
- PROP LOT BDY
- ROAD CENTRELINE
- PROP STORMWATER
- EX/PROP SWMH
- PROP STREET LIGHT
- SWCP SINGLE
- PROP INDICATIVE VC CROSSING
- SOAKAGE TRENCH - 1.2m WIDE
- SOAKAGE TRENCH - 2m WIDE
- RAINGARDEN - 1.2m / 2.3m WIDE

D	FAST TRACK APP	RJM	06/2025
C	FAST TRACK APP	RJM	05/2025
B	FAST TRACK APP	RJM	04/2025
A	FAST TRACK APP	RJM	04/2025
Rev	Description	By	Date
		By	Date
Survey	MAVEN		05/2024
Design	AP		03/2024
Drawn	AP		03/2024
Checked	DJM		06/2025

**M** Maven Associates  
09 571 0050  
info@maven.co.nz  
www.maven.co.nz  
5 Owens Road, Epsom  
Auckland 1023

Project  
**ASHBOURNE  
RESIDENTIAL  
FOR  
MATAMATA  
DEVELOPMENTS LTD**

Title  
**PROPOSED  
STAGE 8 ROADING  
PLAN 3-3**

Project no.	289001		
Scale	1:1000 @ A3		
Cad file	C300-ROADING.DWG		
Drawing no.	C300-23	Rev	D