



- Notes
1. All works to be in accordance with local council standards.
 2. Co-ordinates in terms of Mount Eden 2000.
 3. Road shown are legal.
 4. Areas, Boundaries and Measurements are approximate only and subject to final survey.
 5. This document shall be used only for the purpose for which it is supplied. No reproduction, copying, reuse, sale, hire, loan, and or gift of this document directly or indirectly is permitted without the prior written consent of MAVEN BOP LTD.
 6. This document is subject to copyright.

Legend

	PR BDY
	EX ABUTALS
	EASEMENTS

B	RESOURCE CONSENT	YZ	11/ 25
Rev	Description	By	Date
		By	Date
Survey			
Design			
Drawn	MS		06/25
Checked	JG		06/25



Project
**ASHBOURNE
RETIREMENT VILLAGE
MATAMATA
FOR
UNITY DEVELOPMENT LTD**

Title
**STAGE 2 RV
SUBDIVISION LOTS 1-3
SCHEME PLAN**

Project no.	J00606		
Scale	1:2500 @ A3		
Cad file	C8000 - SCHEME PLAN.DWG		
Drawing no.	C1000 SCHEME	Rev	B



Notes

- All works to be in accordance with local council standards.
- Co-ordinates in terms of Mount Eden 2000.
- Road shown are legal.
- Areas, Boundaries and Measurements are approximate only and subject to final survey.
- This document shall be used only for the purpose for which it is supplied. No reproduction, copying, reuse, sale, hire, loan, and or gift of this document directly or indirectly is permitted without the prior written consent of MAVEN BOP LTD.
- This document is subject to copyright.

Legend

- PR BDY
- EX ABBUTALS
- EASEMENTS
- PR WATER SUPPLY
- PR
- TELECOMMUNICATIONS
- PR ELECTRICITY

B	RESOURCE CONSENT	YZ	11/ 25
Rev	Description	By	Date
		By	Date
Survey			
Design			
Drawn	MS		06/25
Checked			

Maven Matamata
matamatainfo@maven.co.nz
www.maven.co.nz
8 Tainui Street, Matamata
New Zealand

Project

**ASHBOURNE
RETIREMENT VILLAGE
MATAMATA
FOR
UNITY DEVELOPMENT LTD**

Title

**SCHEME PLAN - POWER,
TELECOMMUNICATIONS &
WATER EASEMENTS**

SHEET 2

Project no.	J00606
Scale	1:2500 @ A3
Cad file	C8000 - SCHEME PLAN.DWG
Drawing no.	C1001 COMBINED
Rev	B

RESOURCE CONSENT

ORIGINAL SIZE: A3

150m
100
80
60
40
30
20
10
0

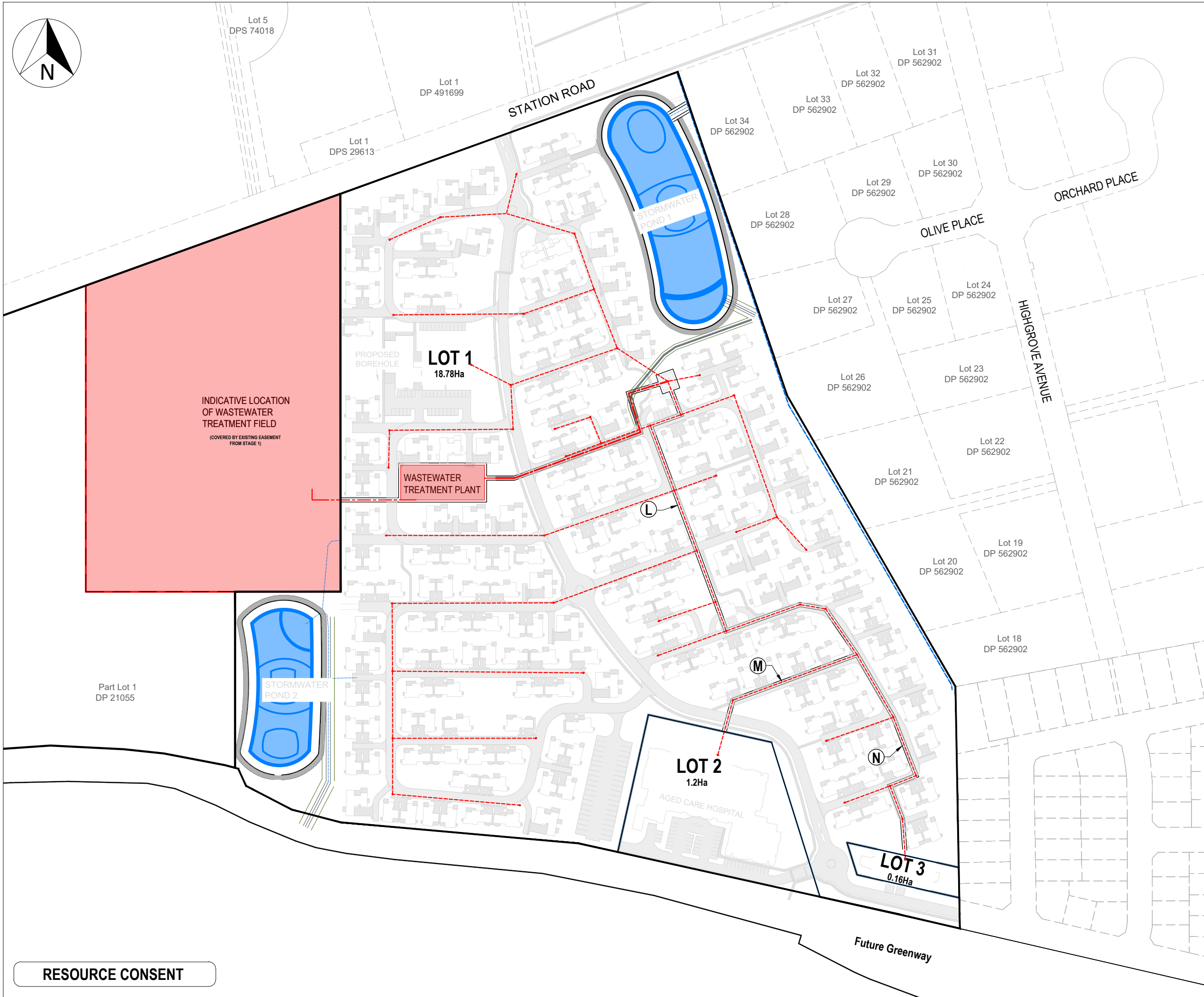
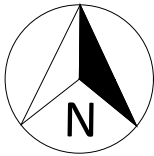

- Notes
1. All works to be in accordance with local council standards.
 2. Co-ordinates in terms of Mount Eden 2000.
 3. Road shown are legal.
 4. Areas, Boundaries and Measurements are approximate only and subject to final survey.
 5. This document shall be used only for the purpose for which it is supplied. No reproduction, copying, reuse, sale, hire, loan, and or gift of this document directly or indirectly is permitted without the prior written consent of MAVEN BOP LTD.
 6. This document is subject to copyright.

Legend

	PR BDY
	EX ABBUTALS
	EASEMENTS
	PR WASTEWATER LINE

B	RESOURCE CONSENT	YZ	11/ 25
Rev	Description	By	Date
		By	Date
Survey			
Design			
Drawn	RP		06/25
Checked	JG		06/25



Maven Matamata
matamatainfo@maven.co.nz
www.maven.co.nz
8 Tainui Street, Matamata
New Zealand

Project
**ASHBOURNE
RETIREMENT VILLAGE
SUBDIVISION
FOR
UNITY DEVELOPMENT LTD**

Title
**SCHEME PLAN -
PROPOSED WASTEWATER
EASEMENTS**

Project no.	J00606
Scale	1:2500 @ A3
Cad file	C8000 - SCHEME PLAN.DWG
Drawing no.	C1002 WW
Rev	B

RESOURCE CONSENT

DATE: 11/7/25

FILE PATH: F:\MAVEN\PROJECTS\289001 - STATION ROAD - RV DRAINAGE\DWG\C8000 - SCHEME PLAN.DWG

ORIGINAL SIZE: A3
DATE: 11/7/25
FILE PATH: F:\MAVEN\PROJECTS\289001 - STATION ROAD - RV DRAINAGE\DWG\CB000 - SCHEME PLAN.DWG

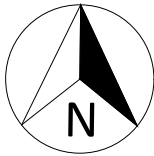

- Notes
1. All works to be in accordance with local council standards.
 2. Co-ordinates in terms of Mount Eden 2000.
 3. Road shown are legal.
 4. Areas, Boundaries and Measurements are approximate only and subject to final survey.
 5. This document shall be used only for the purpose for which it is supplied. No reproduction, copying, reuse, sale, hire, loan, and or gift of this document directly or indirectly is permitted without the prior written consent of MAVEN BOP LTD.
 6. This document is subject to copyright.

Legend	
	PR BDY
	EX ABBUTALS
	EASEMENTS

B	RESOURCE CONSENT	YZ	11/ 25
Rev	Description	By	Date
		By	Date
Survey			
Design			
Drawn	MS		06/25
Checked			



Project
**ASHBOURNE
RETIREMENT VILLAGE
MATAMATA
FOR
UNITY DEVELOPMENT LTD**

Title
**SCHEME PLAN -
PROPOSED STORMWATER
EASEMENT**

Project no.	J00606
Scale	1:2500 @ A3
Cad file	CB000 - SCHEME PLAN.DWG
Drawing no.	C1003 SW
Rev	A

ASHBOURNE - STATION ROAD - RETIREMENT VILLAGE

SCHEDULE OF PROPOSED EASEMENTS			
PURPOSE	SHOWN	BURDENED LAND (SERVIENT TENEMENT)	BENEFITED LAND (DOMINANT TENEMENT)
RIGHT OF WAY	A	LOT 1	LOT 2 & 3
RIGHT TO CONVEY WATER	B, E, F G		LOT 2 & 3
	H		LOT 2
	I, J & K		LOT 3
RIGHT TO CONVEY TELECOMMUNICATIONS & ELECTRICITY	C & J		LOT 2 & 3
	D, E, F, G, H & I		LOT 2
	K		LOT 3
RIGHT TO DRAIN SEWAGE	L		LOT 2 & 3
	M		LOT 2
	N		LOT 3
RIGHT TO DRAIN STORMWATER	O		LOTS 2 & 3

SCHEDULE OF PROPOSED EASEMENTS IN GROSS			
PURPOSE	SHOWN	BURDENED LAND	GRANTEE
RIGHT TO CONVEY TELECOMMUNICATIONS	C, D, E, F, G, H, I, J & K	LOT 1	TUATAHI FIRST FIBRE LTD
RIGHT TO CONVEY ELECTRICITY			POWERCO LIMITED