



Appendix

15

Powerhouse Fast-track Application

Doppelmayr Garaventa Aerial Ropeway Capability & Plans



Prepared by Doppelmayr NZ Ltd

Garreth Hayman
Chief Executive Officer

15 December 2025

Doppelmayr New Zealand Ltd, PO Box 16192, Christchurch 8441, New Zealand

Guy Hingston
Bowen Peak Ltd

Doppelmayr New Zealand Ltd

Garreth Hayman
Our reference: 241-2
T +64 3 318 2725

Via email:

Christchurch, 27 November 2025

Capability Statement – Ropeway Technology for Bowen Peak Cable Car Project

Dear Guy,

We are pleased to present this capability statement in support of the proposed cable car development on Bowen Peak. Doppelmayr New Zealand, in collaboration with our group offers a world-class solution tailored to the unique environmental and operational demands of this project.

Recommended System: Funifor (FUF)

A desktop review of the project's requirements has been completed, and based on the information provided, we recommend installing a series of Funifor cable cars. The Funifor system, developed by Doppelmayr, is particularly well-suited for alpine terrain and locations with strong winds. Its compact station design and independent track operation make it an excellent option for projects needing minimal visual impact and dependable performance. Furthermore, this would be the first Funifor installation in the southern hemisphere.



Key advantages include:

- **Wind resilience:** Operates safely in wind speeds exceeding 100 km/h.
- **Minimal footprint:** Requires fewer towers and shorter hangers, reducing environmental disruption.
- **Compact station design:** Enables integration into sensitive landscapes, such as the western slope of Bowen Peak.
- **Operational flexibility:** Independent track operation allows maintenance on one line while the other remains active.
- **Barrier-free access:** Supports inclusive design for all users.

The project consists of three sections

- **Section 1** - One Mile Powerhouse Reserve (326m) to Proposed Fernhill Heights suburb (624m)
- **Section 2** - Proposed Fernhill Heights suburb (624m) to Saddle station (1309)
- **Section 3** - Saddle station (1309m) to the Bowen Peak Station at 1625m

All sections would act independently of each other, and guests would need to transfer between ropeways

Alternative system: Mono-cable Detachable Gondola (MGD)

The Mono-cable Detachable Gondola (MGD) from Doppelmayr is a state-of-the-art ropeway system engineered for efficient, comfortable, and reliable transportation in alpine and urban environments. Featuring detachable cabins that allow for easy boarding and disembarking, the MGD system ensures a smooth passenger experience and operational flexibility. Its design enables high capacity and frequent service intervals, making it an ideal solution for a reliable connection while minimising environmental impact. With advanced safety features and the ability to integrate seamlessly into sensitive landscapes, the Doppelmayr D-Line exemplifies innovative technology that supports sustainable mobility and accessibility for all users.

For the Bowen Peak project, an MGD would be ideal section 1 to provide a high-capacity service between the town centre and proposed Fernhill development



Figure 1 - Indicative FUF concept

Environmental Sustainability Commitment

Doppelmayr is deeply committed to sustainable development. Our ropeway systems are designed to:

- **Minimise land disturbance** through reduced infrastructure.
- **Blend into natural landscapes** using low-profile architecture and terrain-sensitive placement.
- **Support low-emission transport** by replacing or supplementing road-based access.
- **Enable long-term conservation** by reducing visitor impact on fragile alpine ecosystems.

We work closely with our project stakeholders to ensure our installations respect cultural and environmental values.

Delivery Capability in New Zealand

Doppelmayr New Zealand, in collaboration with our global group companies, offers full-spectrum delivery capability:

- **Local Expertise:** Operating in New Zealand since 1975, Doppelmayr has delivered over 100 ropeway systems across 25+ locations nationwide
- **Trusted Partnerships:** We are a proven partner to many operators throughout the region and country, with installations such as:
 - Skyline Queenstown 10-MGD
 - McDougall's 6/8-CGD
 - Sugar Bowl Express
 - Wellington Cable Car
- **Turnkey Project Delivery: From** feasibility studies and terrain surveys to commissioning and long-term support
- **Global Manufacturing and Technical Expertise:** Supported by Doppelmayr's international network, ensuring access to world-leading innovation and quality

The Funifor system and the alternative gondola system offers a technically advanced, environmentally aligned solution for the Bowen Peak cable car. Doppelmayr New Zealand is ready to deliver this project with precision, care, and a deep understanding of New Zealand's alpine and cultural landscape.

We welcome the opportunity to discuss this proposal further and provide any additional technical or environmental documentation required.

Yours sincerely

On behalf of Doppelmayr New Zealand Ltd

Garreth Hayman

Disclaimer: The information contained in this statement is provided for informational purposes only and does not constitute a binding offer or contract. While every effort has been made to ensure accuracy, Doppelmayr New Zealand Ltd reserves the right to amend specifications, details, or terms at any time without prior notice. Final project delivery is subject to further technical review, regulatory approvals, and contractual agreement.

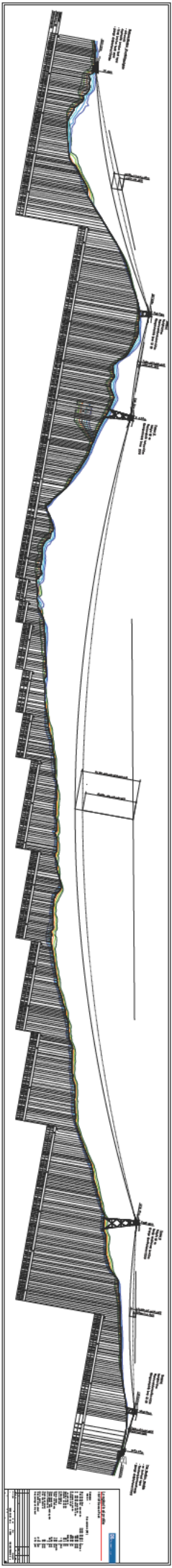

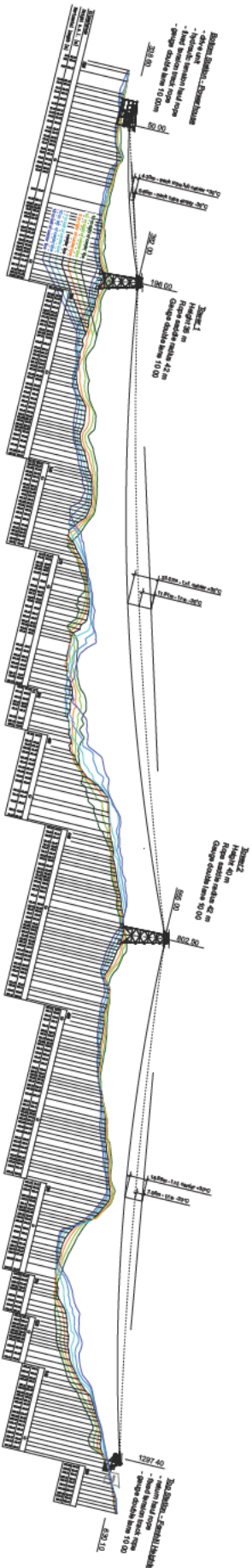

Longitudinal profile
Tabelle 1: Höhenwerte

Station	Height (m)	Notes
100.00	104.00	Bühnenkante - Dimensionierung
102.00	102.00	Bühnenkante - Dimensionierung
104.00	102.00	Bühnenkante - Dimensionierung
106.00	102.00	Bühnenkante - Dimensionierung
108.00	102.00	Bühnenkante - Dimensionierung
110.00	102.00	Bühnenkante - Dimensionierung
112.00	102.00	Bühnenkante - Dimensionierung
114.00	102.00	Bühnenkante - Dimensionierung
116.00	102.00	Bühnenkante - Dimensionierung
118.00	102.00	Bühnenkante - Dimensionierung
120.00	102.00	Bühnenkante - Dimensionierung
122.00	102.00	Bühnenkante - Dimensionierung
124.00	102.00	Bühnenkante - Dimensionierung
126.00	102.00	Bühnenkante - Dimensionierung
128.00	102.00	Bühnenkante - Dimensionierung
130.00	102.00	Bühnenkante - Dimensionierung
132.00	102.00	Bühnenkante - Dimensionierung
134.00	102.00	Bühnenkante - Dimensionierung
136.00	102.00	Bühnenkante - Dimensionierung
138.00	102.00	Bühnenkante - Dimensionierung
140.00	102.00	Bühnenkante - Dimensionierung
142.00	102.00	Bühnenkante - Dimensionierung
144.00	102.00	Bühnenkante - Dimensionierung
146.00	102.00	Bühnenkante - Dimensionierung
148.00	102.00	Bühnenkante - Dimensionierung
150.00	102.00	Bühnenkante - Dimensionierung
152.00	102.00	Bühnenkante - Dimensionierung
154.00	102.00	Bühnenkante - Dimensionierung
156.00	102.00	Bühnenkante - Dimensionierung
158.00	102.00	Bühnenkante - Dimensionierung
160.00	102.00	Bühnenkante - Dimensionierung
162.00	102.00	Bühnenkante - Dimensionierung
164.00	102.00	Bühnenkante - Dimensionierung
166.00	102.00	Bühnenkante - Dimensionierung
168.00	102.00	Bühnenkante - Dimensionierung
170.00	102.00	Bühnenkante - Dimensionierung
172.00	102.00	Bühnenkante - Dimensionierung
174.00	102.00	Bühnenkante - Dimensionierung
176.00	102.00	Bühnenkante - Dimensionierung
178.00	102.00	Bühnenkante - Dimensionierung
180.00	102.00	Bühnenkante - Dimensionierung
182.00	102.00	Bühnenkante - Dimensionierung
184.00	102.00	Bühnenkante - Dimensionierung
186.00	102.00	Bühnenkante - Dimensionierung
188.00	102.00	Bühnenkante - Dimensionierung
190.00	102.00	Bühnenkante - Dimensionierung
192.00	102.00	Bühnenkante - Dimensionierung
194.00	102.00	Bühnenkante - Dimensionierung
196.00	102.00	Bühnenkante - Dimensionierung
198.00	102.00	Bühnenkante - Dimensionierung
200.00	102.00	Bühnenkante - Dimensionierung

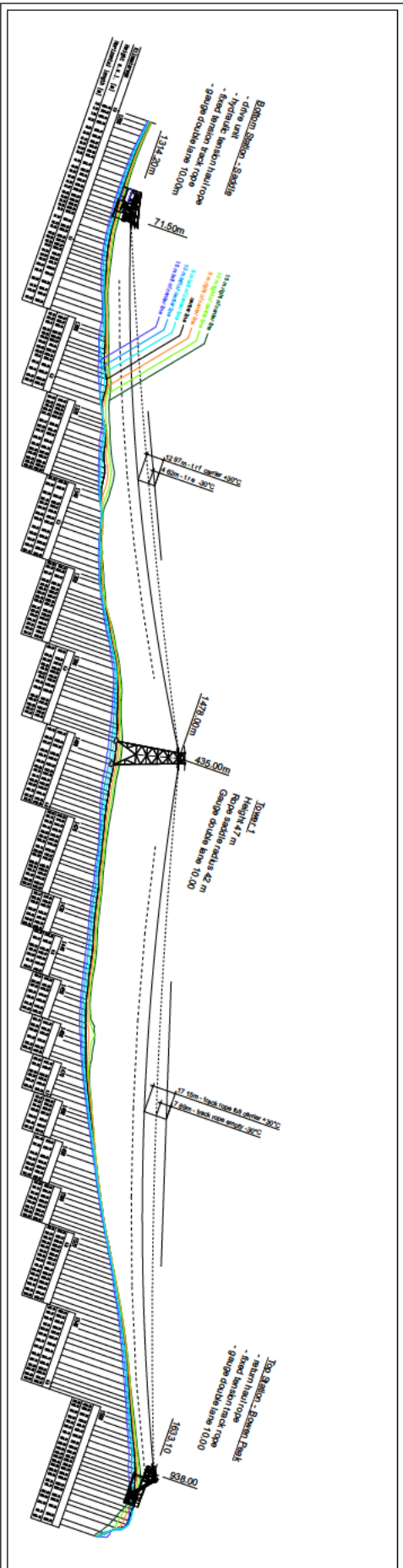

Longitudinal profile
 1101 UF Bowen Peak
 Customer: .
 Location: Orlowtown (NZ)

Profile Data

Profile ID	Profile Name	Profile Type	Profile Length (m)	Profile Start (m)	Profile End (m)
1101 UF Bowen Peak	1101 UF Bowen Peak	1101 UF Bowen Peak	1101	0	1101

Profile Data

Profile ID	Profile Name	Profile Type	Profile Length (m)	Profile Start (m)	Profile End (m)
1101 UF Bowen Peak	1101 UF Bowen Peak	1101 UF Bowen Peak	1101	0	1101

Profile Data

Profile ID	Profile Name	Profile Type	Profile Length (m)	Profile Start (m)	Profile End (m)
1101 UF Bowen Peak	1101 UF Bowen Peak	1101 UF Bowen Peak	1101	0	1101

SECTION A-A
SCALE 1:200

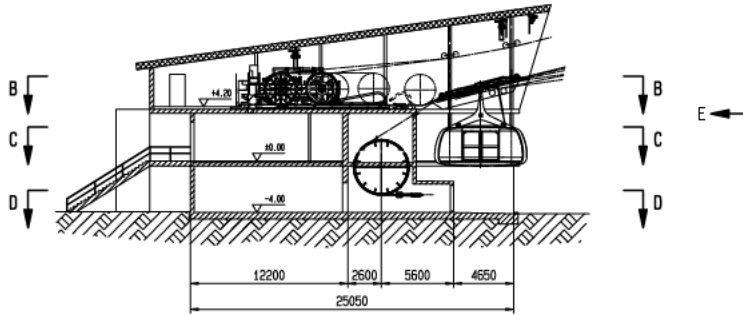

VIEW
SCALE

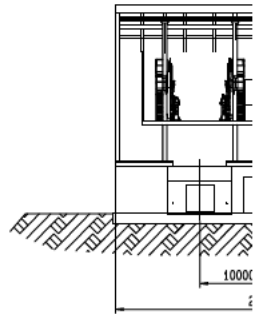

SECTION B-B
SCALE 1:200

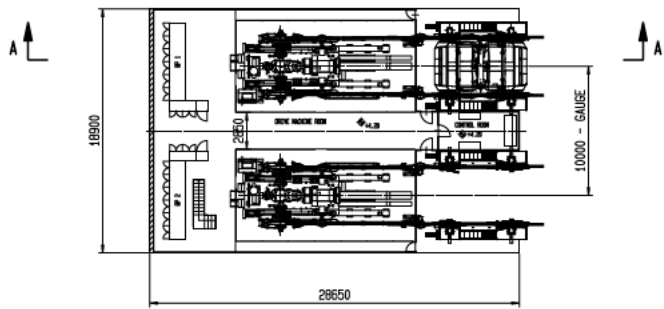

SECTION
SCALE

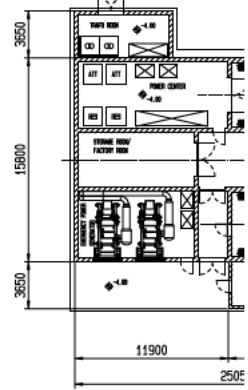

SECTION C-C
SCALE 1:200

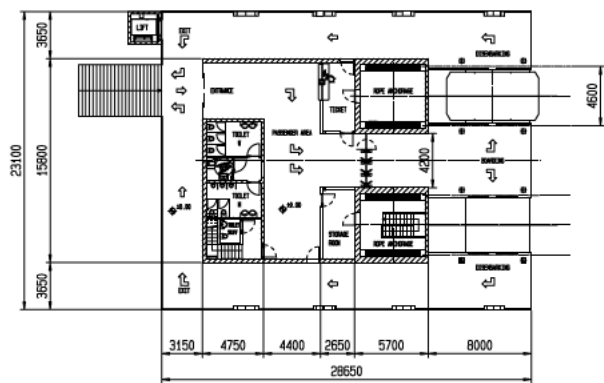

SECTION A-A
SCALE 1:200

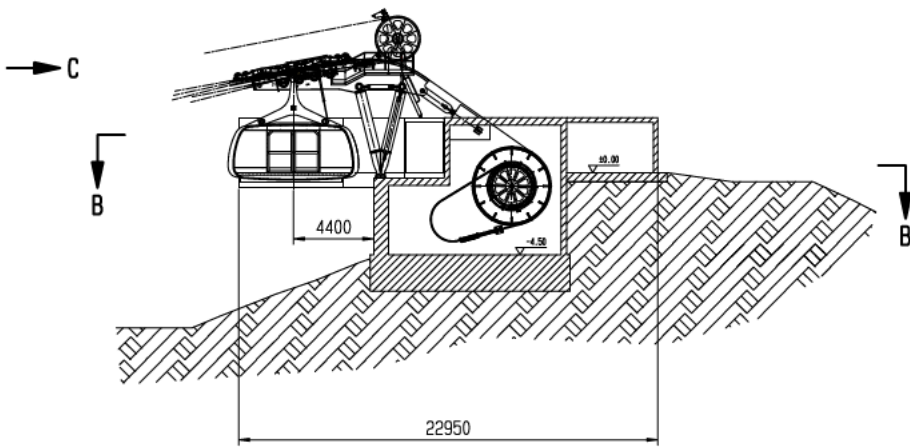

SECTION B-B
SCALE 1:200

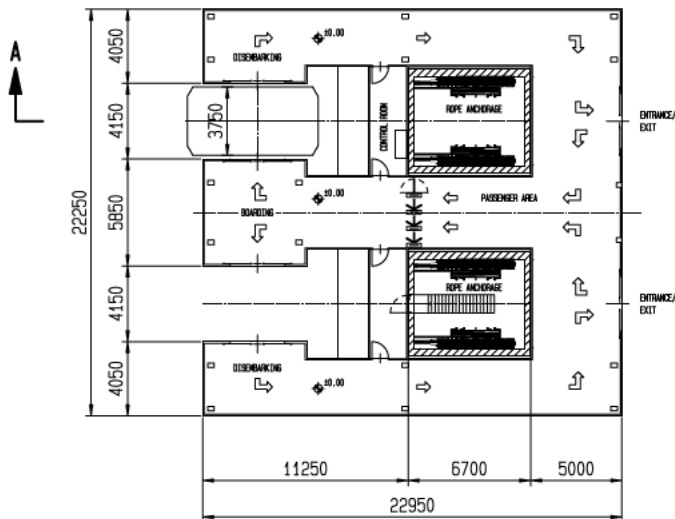

ISSUED FOR CONCEPT
2025-09-12 HGA

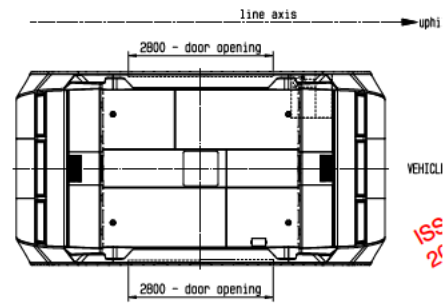
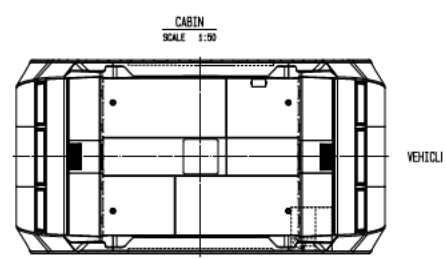
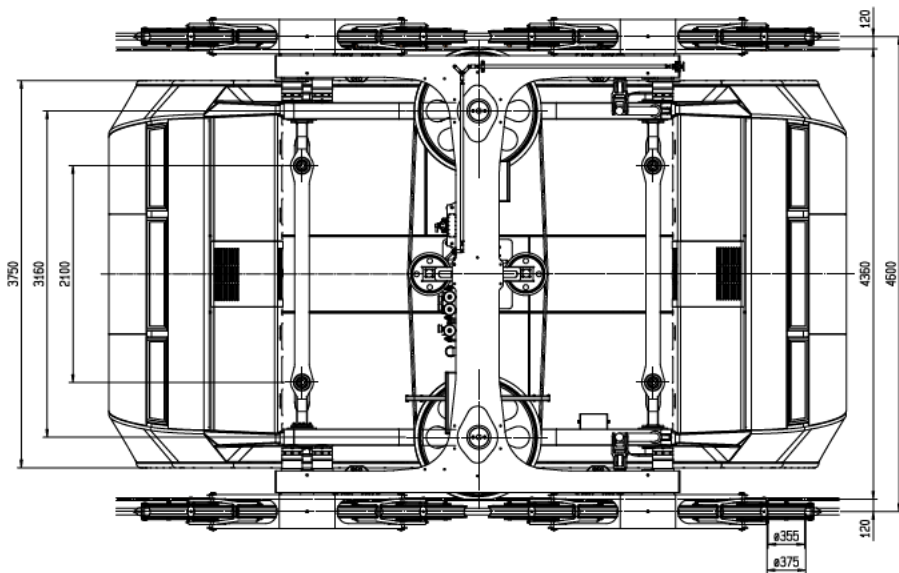
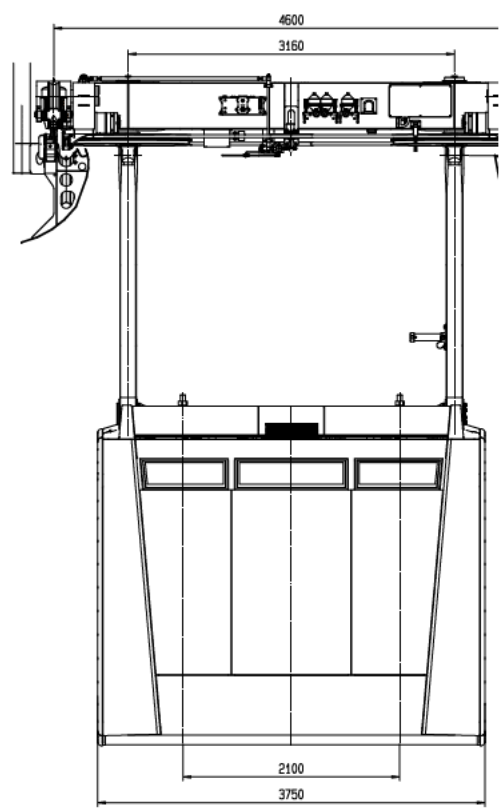
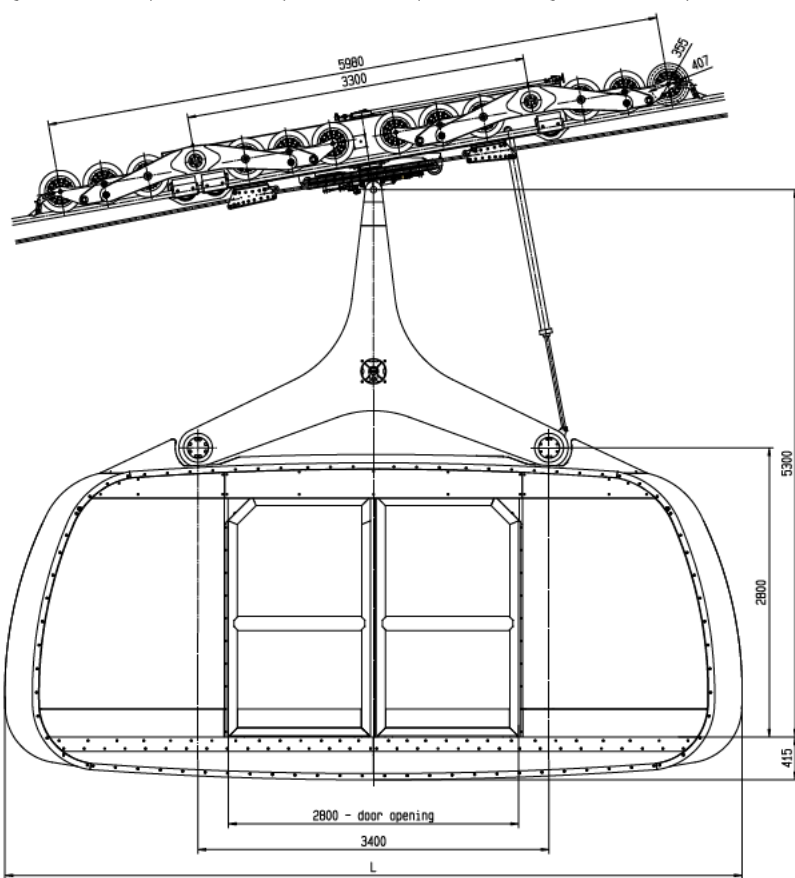

158
22



TOWER TYPE FUJ TWO LANE

Order No.	2018-10-17	Drawn	SPB	Scale	1:100	Drawing No.	51149NIN11001
-----------	------------	-------	-----	-------	-------	-------------	---------------

ISSUED FOR CONCEPT PLANNING ONLY
2025-09-12 HGA

