

**Legend**

- Private Lot
- Joint Owned Access Lot
- Road Reserve
- Recreation Reserve
- Local Purpose Reserve (Utilities)
- Local Purpose Reserve (Stormwater)
- Local Purpose Reserve (Walkway)
- Private Open Space (Ecological)
- Private Open Space (Dune Ridgeline)
- Private Open Space (Wetland Restoration)
- To Vest as Road (Unformed) in Kapiti Coast District Council

- Notes:**
1. Coordinates in NZGD2000 (Wellington Circuit) and NZVD2016.
  2. Boundaries and titles derived from LINZ DCDB and subject to final survey.
  3. KCDC and GWRC planning overlays sourced from operative ArcGIS MapServer layers.
  4. Scheme layout indicative; final design subject to detailed design and servicing requirements.
  5. Easements required for servicing to be created at implementation stage or as otherwise required by Kāpiti Coast District Council.

**Overall Masterplan – Land Use and Layout**

Waikanae North Developments Ltd

Waikanae North  
Peka Peka, Kapiti Coast

© Landlink Limited 2025



1 Ngaio Road, Waikanae 5036 + contactus@Landlink.nz

This drawing contains data from other sources and has been prepared for a specific site and event. Landlink Limited does not accept any liability for its accuracy, content or unauthorised use.

STAGE	ALL	DESIGNED BY	JJH
REVISION	C	DRAWN BY	JJH
REVISION DETAILS	Issued For Consent	APPROVED BY	PT

DATE 2026-03-13

SCALE Refer Scale Bar

2911-ALL-P-1



0 100 200 300 400 500 m

Legend

Stage Boundary (Indicative)

WNDL Staging (Indicative)

- Stage 1A
- Stage 1B
- Stage 2
- Stage 3
- Stage 4
- Stage 5
- Stage 6
- Stage 7
- Stage 8
- Stage 9
- Stage 10
- Stage 11
- Stage 12
- Stage 13
- Stage 14
- Stage 15
- Stage 16
- Stage 17

Notes:

1. Coordinates in NZGD2000 (Wellington Circuit) and NZVD2016.
2. Boundaries and titles derived from LINZ DCDB and subject to final survey.
3. KCDC and GWRC planning overlays sourced from operative ArcGIS MapServer layers.
4. Staging indicative; final sequencing subject to detailed design, consenting requirements, and construction programming.
5. Easements required for servicing to be created at implementation stage or as otherwise required by Kāpiti Coast District Council.

Overall Scheme Plan – Indicative Staging

Waikanae North Developments Ltd

Waikanae North

Peka Peka, Kapiti Coast

© Landlink Limited 2025



1 Ngaio Road, Waikanae 5036 + contactus@Landlink.nz

STAGE	ALL
REVISION	C
REVISION DETAILS	Issued For Consent

DESIGNED BY	JJH
DRAWN BY	JJH
APPROVED BY	PT

This drawing contains data from other sources and has been prepared for a specific site and event. Landlink Limited does not accept any liability for its accuracy, content or unauthorised use.

DATE 2026-03-13

SCALE Refer Scale Bar

2911-ALL-P-2

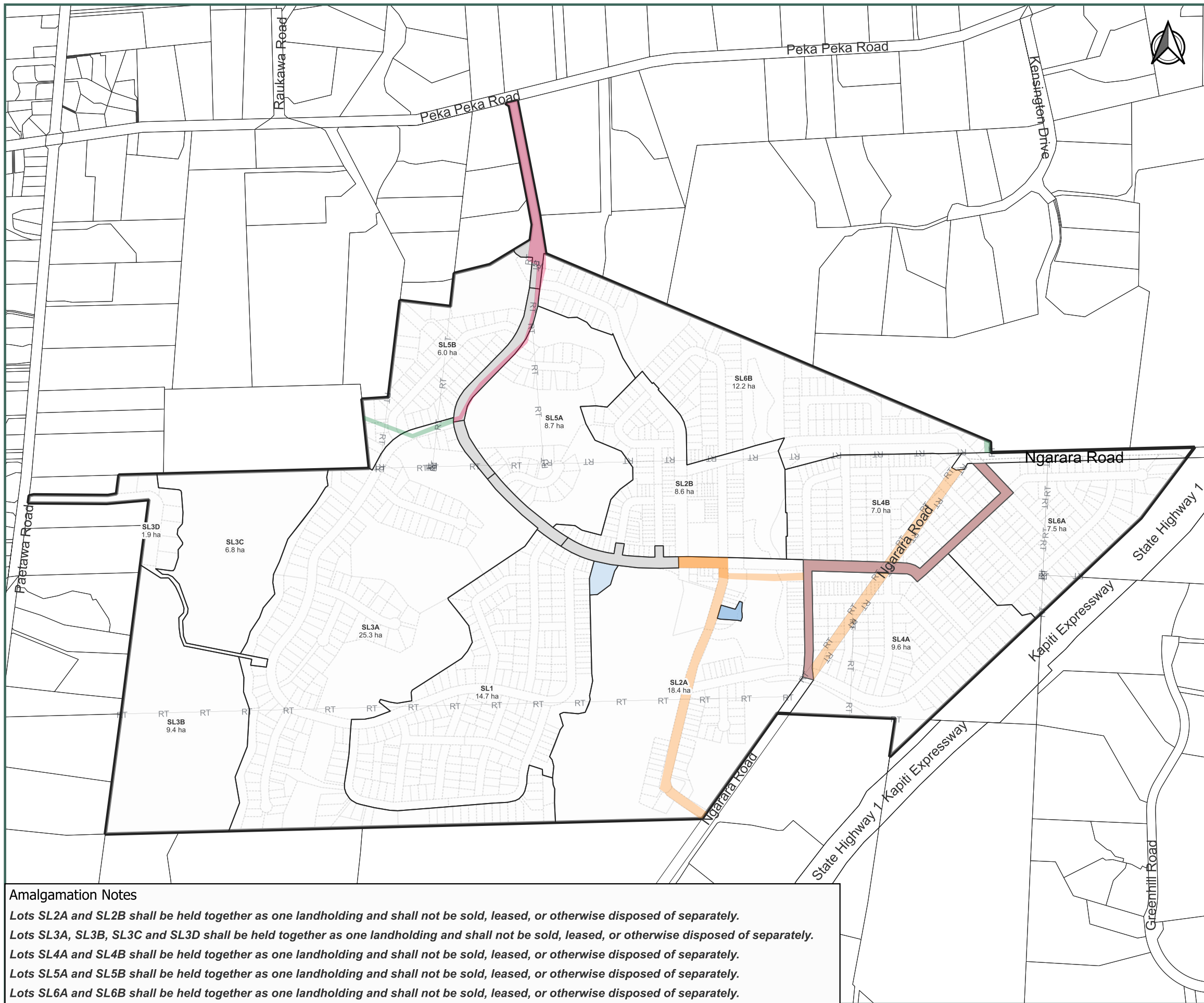

0 100 200 300 400 500 m

Legend

Superlot Scheme

- Private Lot
- Road Reserve
- To vest as Road (Unformed)
- Local Purpose Reserve (Stormwater)
- Local Purpose Reserve (Utilities)

Phase 1 Easements

- Proposed
- Remove
- Retain

Notes:

1. Coordinates in NZGD2000 (Wellington Circuit) and NZVD2016.
2. Boundaries and titles derived from LINZ DCDB and subject to final survey.
3. KCDC and GWRC planning overlays sourced from operative ArcGIS MapServer layers.
4. Easements required for servicing to be created at implementation stage or as otherwise required by Kāpiti Coast District Council.

Amalgamation Notes

*Lots SL2A and SL2B shall be held together as one landholding and shall not be sold, leased, or otherwise disposed of separately.*  
*Lots SL3A, SL3B, SL3C and SL3D shall be held together as one landholding and shall not be sold, leased, or otherwise disposed of separately.*  
*Lots SL4A and SL4B shall be held together as one landholding and shall not be sold, leased, or otherwise disposed of separately.*  
*Lots SL5A and SL5B shall be held together as one landholding and shall not be sold, leased, or otherwise disposed of separately.*  
*Lots SL6A and SL6B shall be held together as one landholding and shall not be sold, leased, or otherwise disposed of separately.*

Overall Phase 1 Scheme Plan

Waikanae North Developments Ltd

Waikanae North

Peka Peka, Kapiti Coast

© Landlink Limited 2025



1 Ngaio Road, Waikanae 5036 + contactus@Landlink.nz

STAGE	PH1
REVISION	C
REVISION DETAILS	Issued For Consent

DESIGNED BY	JJH
DRAWN BY	JJH
APPROVED BY	PT

DATE 2026-03-13

SCALE Refer Scale Bar

2911-PH1-P-3

This drawing contains data from other sources and has been prepared for a specific site and event. Landlink Limited does not accept any liability for its accuracy, content or unauthorised use.