

Notes

1. All works to be in accordance with MPDC and RITS standards.
2. Co-ordinates in terms of NZ Geodetic Datum MT Eden 2000.
3. Reduced Levels are in terms of NZVD 2016.
4. Boundaries are subject to final survey.

Legend

|     |                      |
|-----|----------------------|
| --- | EX BDY               |
| --- | PROP BDY             |
| --- | STAGING BDY          |
| --- | EX UNDERGROUND POWER |
| --- | EX OVERHEAD POWER    |
| --- | EX FIBRE             |
| --- | PROP WATERMAIN       |
| --- | PROP POWER           |
| --- | PROP FIBRE           |
| --- | BULK WATER METER     |
| --- | PROP HYDRANT         |
| --- | PROP METER           |
| --- | PROP SLUICE VALVE    |
| --- | PROP PEAT VALVE      |
| --- | PROP PUMP STATION    |
| --- | PROP STORMWATER      |
| --- | EX/PROP SWMH         |
| --- | EX/PROP SWCP         |
| --- | PROP RISING MAIN     |
| --- | PROP WASTEWATER      |
| --- | EX/PROP WWMH         |

|         |                  |     |         |
|---------|------------------|-----|---------|
| B       | RESOURCE CONSENT | DIJ | 11/25   |
| A       | FOR CONSENT      | KQ  | 05/25   |
| Rev     | Description      | By  | Date    |
| Survey  | MAVEN            |     | 10/2024 |
| Design  | MAVEN            |     | 05/2025 |
| Drawn   | KQ               |     | 05/2025 |
| Checked | SB               |     | 05/2025 |

**M** Maven Matamata  
matamatainfo@maven.co.nz  
www.maven.co.nz  
8 Tainui Street, Matamata  
New Zealand

Project  
**ASHBOURNE  
RETIREMENT VILLAGE  
MATAMATA  
FOR  
UNITY DEVELOPMENT LTD**

Title  
**PROPOSED  
STAGING  
OVERVIEW PLAN**

|             |                     |     |          |
|-------------|---------------------|-----|----------|
| Project no. | J00606              |     |          |
| Scale       | 1:2500@A3           |     |          |
| Cad file    | C8000 - STAGING.DWG |     |          |
| Drawing no. | C8000               | Rev | <b>B</b> |

FOR CONSENT



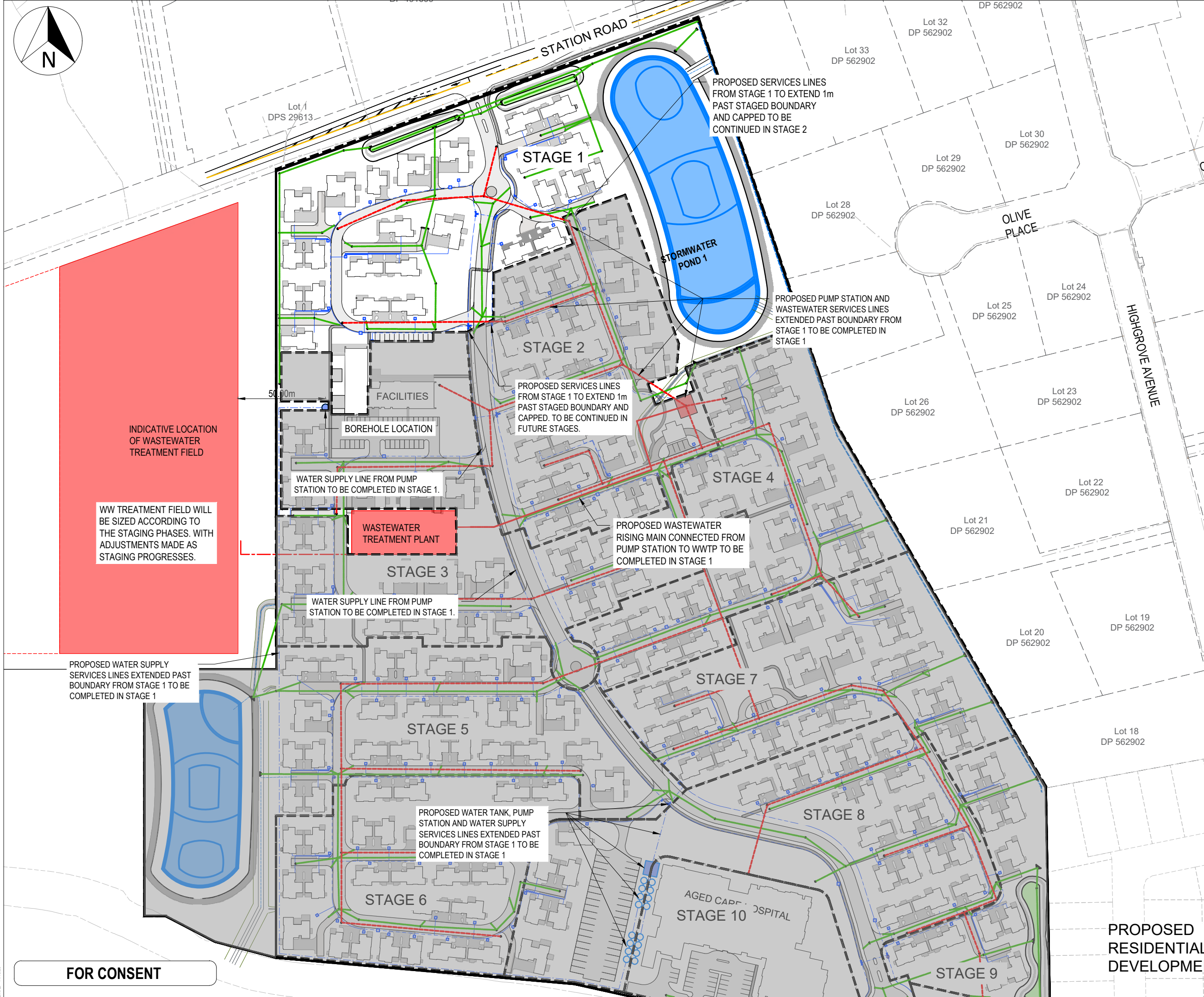
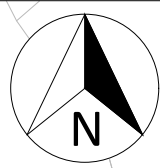

Notes

- All works to be in accordance with MPDC and RITS standards.
- Co-ordinates in terms of NZ Geodetic Datum MT Eden 2000.
- Reduced Levels are in terms of NZVD 2016.
- Boundaries are subject to final survey.

Legend

|  |                      |
|--|----------------------|
|  | EX BDY               |
|  | PROP BDY             |
|  | STAGING BDY          |
|  | EX UNDERGROUND POWER |
|  | EX OVERHEAD POWER    |
|  | EX FIBRE             |
|  | PROP WATERMAIN       |
|  | PROP POWER           |
|  | PROP FIBRE           |
|  | BULK WATER METER     |
|  | PROP HYDRANT         |
|  | PROP METER           |
|  | PROP SLUICE VALVE    |
|  | PROP PEAT VALVE      |
|  | PROP PUMP STATION    |
|  | PROP STORMWATER      |
|  | EX/PROP SWMH         |
|  | EX/PROP SWCP         |
|  | PROP RISING MAIN     |
|  | PROP WASTEWATER      |
|  | EX/PROP WWMH         |

| B       | RESOURCE CONSENT | DIJ | 11/25   |
|---------|------------------|-----|---------|
| A       | FOR CONSENT      | KQ  | 05/25   |
| Rev     | Description      | By  | Date    |
| Survey  | MAVEN            |     | 10/2024 |
| Design  | MAVEN            |     | 05/2025 |
| Drawn   | KQ               |     | 05/2025 |
| Checked | SB               |     | 05/2025 |

**Maven Matamata**  
matamatainfo@maven.co.nz  
www.maven.co.nz  
8 Tainui Street, Matamata  
New Zealand

Project

**ASHBOURNE  
RETIREMENT VILLAGE  
MATAMATA  
FOR  
UNITY DEVELOPMENT LTD**

Title

**PROPOSED  
STAGING PLAN  
STAGE 1**

|             |                     |
|-------------|---------------------|
| Project no. | J00606              |
| Scale       | 1:2000@A3           |
| Cad file    | C8000 - STAGING.DWG |
| Drawing no. | C8001               |
| Rev         | <b>B</b>            |

FOR CONSENT

PROPOSED  
RESIDENTIAL  
DEVELOPMENT



ORIGINAL SIZE: A3  
DATE: 11/10/25  
FILE PATH: \\MAVEN\MAVENCONSULTING\CO NZ\SHARE\CURRENT\MAVEN\PROJECTS\28001 - STATION ROAD - RY DRAINAGE\DWG\C8000 - STAGING.DWG

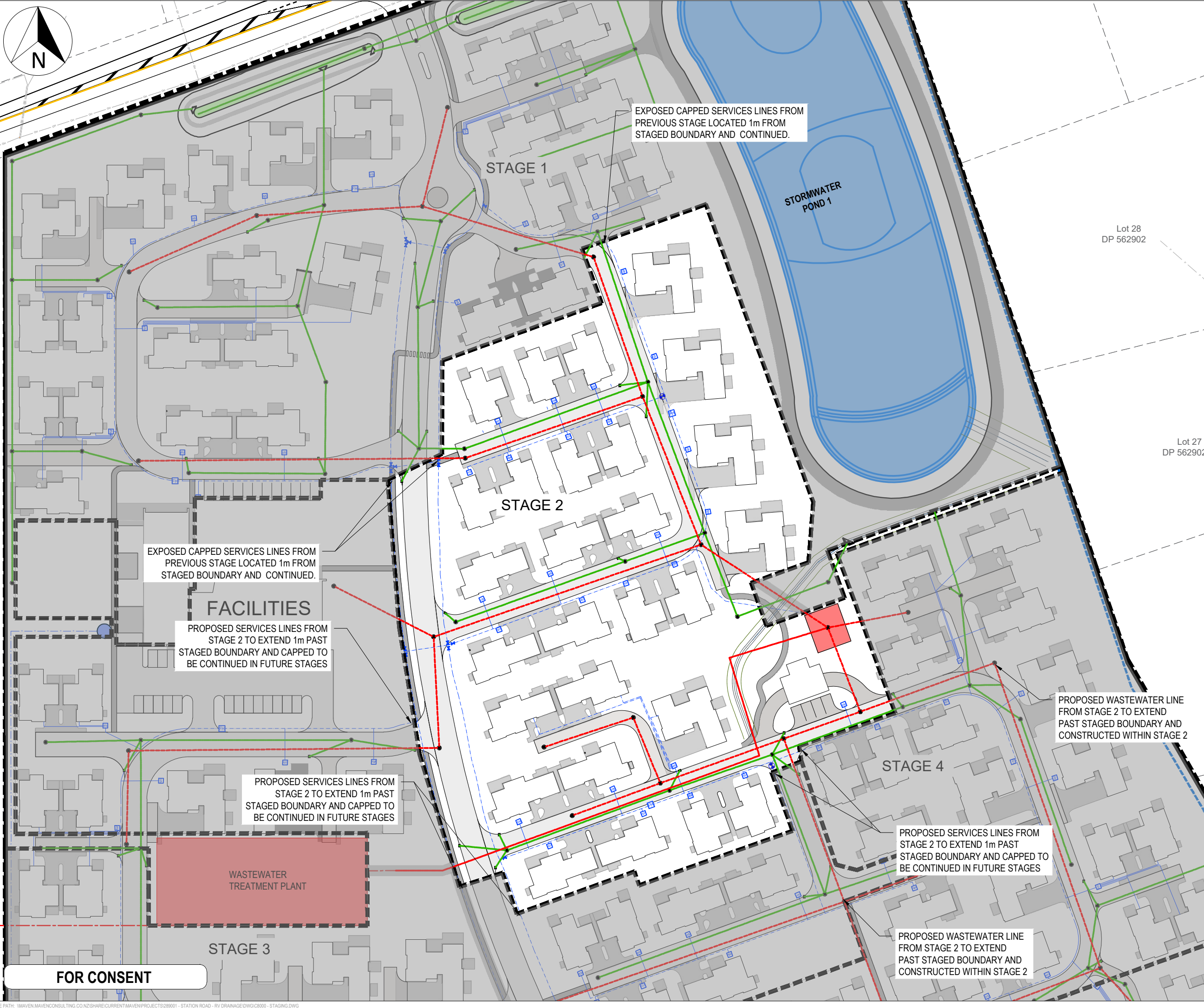
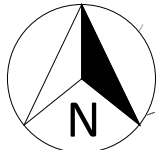

Notes

- All works to be in accordance with MPDC and RITS standards.
- Co-ordinates in terms of NZ Geodetic Datum MT Eden 2000.
- Reduced Levels are in terms of NZVD 2016.
- Boundaries are subject to final survey.

Legend

|     |                      |
|-----|----------------------|
| --- | EX BDY               |
| --- | PROP BDY             |
| --- | STAGING BDY          |
| --- | EX UNDERGROUND POWER |
| --- | EX OVERHEAD POWER    |
| --- | EX FIBRE             |
| --- | PROP WATERMAIN       |
| --- | PROP POWER           |
| --- | PROP FIBRE           |
| --- | BULK WATER METER     |
| --- | PROP HYDRANT         |
| --- | PROP METER           |
| --- | PROP SLUICE VALVE    |
| --- | PROP PEAT VALVE      |
| --- | PROP PUMP STATION    |
| --- | PROP STORMWATER      |
| --- | EX/PROP SWMH         |
| --- | EX/PROP SWCP         |
| --- | PROP RISING MAIN     |
| --- | PROP WASTEWATER      |
| --- | EX/PROP WWMH         |

|         |                  |     |         |
|---------|------------------|-----|---------|
| B       | RESOURCE CONSENT | DIJ | 11/25   |
| A       | FOR CONSENT      | KQ  | 05/25   |
| Rev     | Description      | By  | Date    |
|         |                  | By  | Date    |
| Survey  | MAVEN            |     | 10/2024 |
| Design  | MAVEN            |     | 05/2025 |
| Drawn   | KQ               |     | 05/2025 |
| Checked | SB               |     | 05/2025 |

**M**  
Maven Matamata  
matamatainfo@maven.co.nz  
www.maven.co.nz  
8 Tainui Street, Matamata  
New Zealand

Project  
**ASHBOURNE  
RETIREMENT VILLAGE  
MATAMATA  
FOR  
UNITY DEVELOPMENT LTD**

Title  
**PROPOSED  
STAGING PLAN  
STAGE 2**

|             |                     |     |          |
|-------------|---------------------|-----|----------|
| Project no. | J00606              |     |          |
| Scale       | 1:1000@A3           |     |          |
| Cad file    | C8000 - STAGING.DWG |     |          |
| Drawing no. | C8002               | Rev | <b>B</b> |



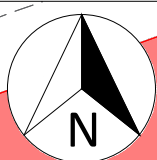

FOR CONSENT

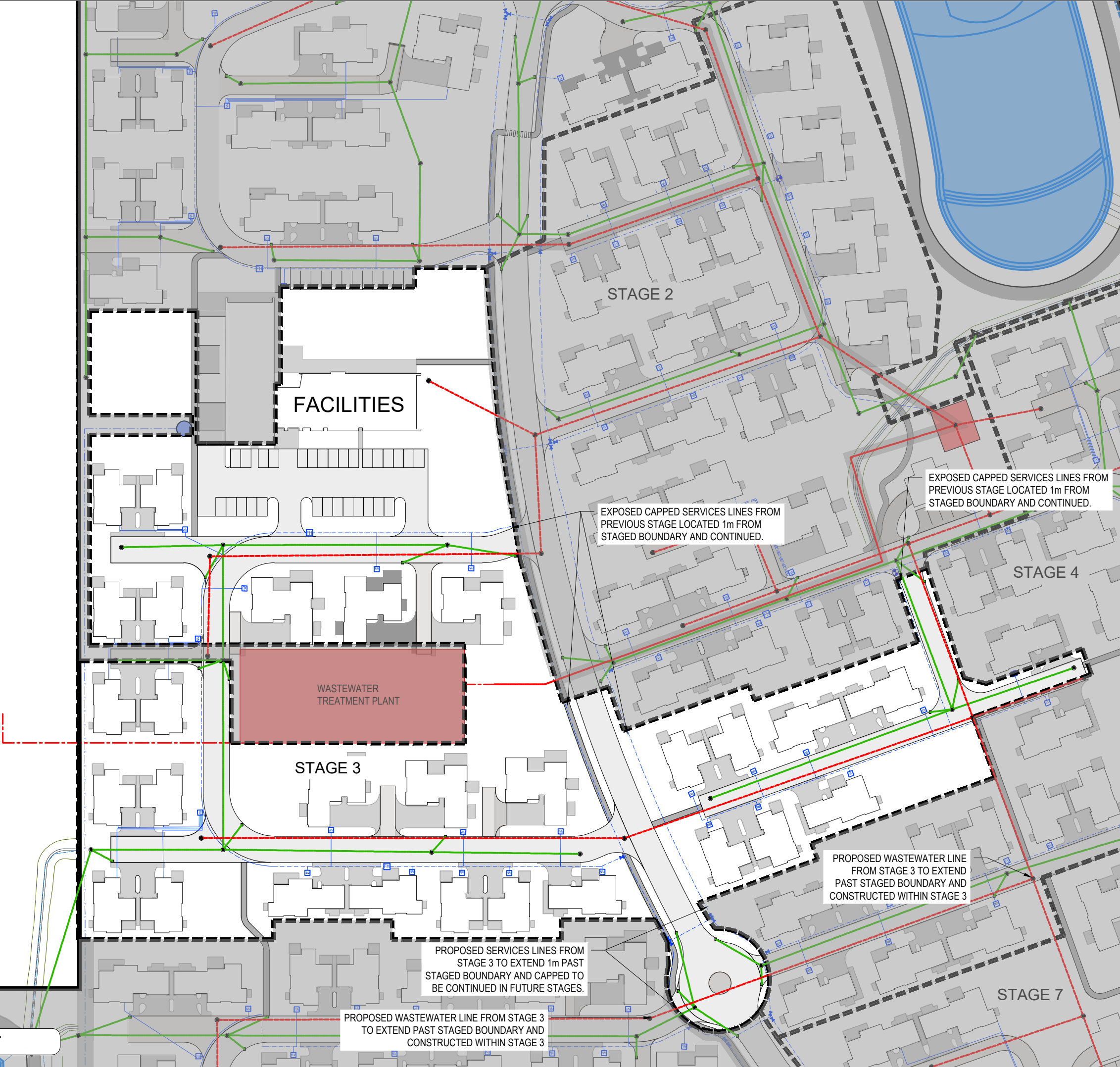

Notes

- All works to be in accordance with MPDC and RITS standards.
- Co-ordinates in terms of NZ Geodetic Datum MT Eden 2000.
- Reduced Levels are in terms of NZVD 2016.
- Boundaries are subject to final survey.

Legend

|     |                      |
|-----|----------------------|
| --- | EX BDY               |
| --- | PROP BDY             |
| --- | STAGING BDY          |
| --- | EX UNDERGROUND POWER |
| --- | EX OVERHEAD POWER    |
| --- | EX FIBRE             |
| --- | PROP WATERMAIN       |
| --- | PROP POWER           |
| --- | PROP FIBRE           |
| --- | BULK WATER METER     |
| --- | PROP HYDRANT         |
| --- | PROP METER           |
| --- | PROP SLUICE VALVE    |
| --- | PROP PEAT VALVE      |
| --- | PROP PUMP STATION    |
| --- | PROP STORMWATER      |
| --- | EX/PROP SWMH         |
| --- | EX/PROP SWCP         |
| --- | PROP RISING MAIN     |
| --- | PROP WASTEWATER      |
| --- | EX/PROP WWMH         |

|         |                  |     |         |
|---------|------------------|-----|---------|
| B       | RESOURCE CONSENT | DIJ | 11/25   |
| A       | FOR CONSENT      | KQ  | 05/25   |
| Rev     | Description      | By  | Date    |
| Survey  | MAVEN            |     | 10/2024 |
| Design  | MAVEN            |     | 05/2025 |
| Drawn   | KQ               |     | 05/2025 |
| Checked | SB               |     | 05/2025 |

**Maven Matamata**  
matamatainfo@maven.co.nz  
www.maven.co.nz  
8 Tainui Street, Matamata  
New Zealand

Project  
**ASHBOURNE  
RETIREMENT VILLAGE  
MATAMATA  
FOR  
UNITY DEVELOPMENT LTD**

Title  
**PROPOSED  
STAGING PLAN  
STAGE 3**

|             |                     |     |          |
|-------------|---------------------|-----|----------|
| Project no. | J00606              |     |          |
| Scale       | 1:1000@A3           |     |          |
| Cad file    | C8000 - STAGING.DWG |     |          |
| Drawing no. | C8003               | Rev | <b>B</b> |



ORIGINAL SIZE: A3  
150mm  
100  
80  
60  
40  
20  
0  
DATE: 11/10/25

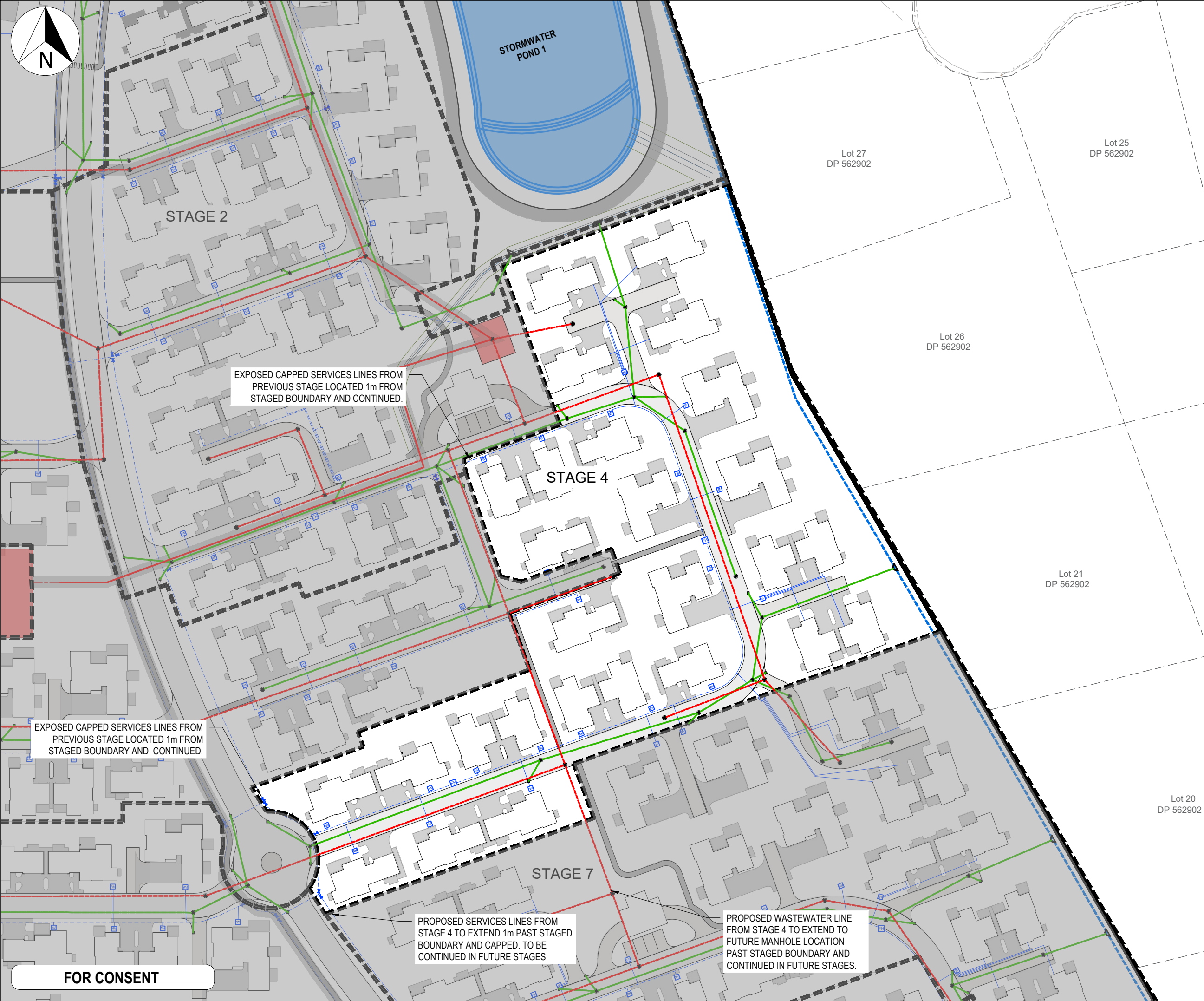

Notes

1. All works to be in accordance with MPDC and RITS standards.
2. Co-ordinates in terms of NZ Geodetic Datum MT Eden 2000.
3. Reduced Levels are in terms of NZVD 2016.
4. Boundaries are subject to final survey.

Legend

|          |                      |
|----------|----------------------|
| ---      | EX BDY               |
| ---      | PROP BDY             |
| ---      | STAGING BDY          |
| ---      | EX UNDERGROUND POWER |
| ---      | EX OVERHEAD POWER    |
| ---      | EX FIBRE             |
| ---      | PROP WATERMAIN       |
| ---      | PROP POWER           |
| ---      | PROP FIBRE           |
| [Symbol] | BULK WATER METER     |
| [Symbol] | PROP HYDRANT         |
| [Symbol] | PROP METER           |
| [Symbol] | PROP SLUICE VALVE    |
| [Symbol] | PROP PEAT VALVE      |
| [Symbol] | PROP PUMP STATION    |
| [Symbol] | PROP STORMWATER      |
| [Symbol] | EX/PROP SWMH         |
| [Symbol] | EX/PROP SWCP         |
| [Symbol] | PROP RISING MAIN     |
| [Symbol] | PROP WASTEWATER      |
| [Symbol] | EX/PROP WWMH         |

|         |                  |     |         |
|---------|------------------|-----|---------|
| B       | RESOURCE CONSENT | DIJ | 11/25   |
| A       | FOR CONSENT      | KQ  | 05/25   |
| Rev     | Description      | By  | Date    |
|         |                  | By  | Date    |
| Survey  | MAVEN            |     | 10/2024 |
| Design  | MAVEN            |     | 05/2025 |
| Drawn   | KQ               |     | 05/2025 |
| Checked | SB               |     | 05/2025 |

**Maven Matamata**  
matamatainfo@maven.co.nz  
www.maven.co.nz  
8 Tainui Street, Matamata  
New Zealand

Project  
**ASHBOURNE  
RETIREMENT VILLAGE  
MATAMATA  
FOR  
UNITY DEVELOPMENT LTD**

Title  
**PROPOSED  
STAGING PLAN  
STAGE 4**

|             |                     |     |          |
|-------------|---------------------|-----|----------|
| Project no. | J00606              |     |          |
| Scale       | 1:1000@A3           |     |          |
| Cad file    | C8000 - STAGING.DWG |     |          |
| Drawing no. | C8004               | Rev | <b>B</b> |

**FOR CONSENT**

PROPOSED SERVICES LINES FROM STAGE 4 TO EXTEND 1m PAST STAGED BOUNDARY AND CAPPED. TO BE CONTINUED IN FUTURE STAGES

PROPOSED WASTEWATER LINE FROM STAGE 4 TO EXTEND TO FUTURE MANHOLE LOCATION PAST STAGED BOUNDARY AND CONTINUED IN FUTURE STAGES.

EXPOSED CAPPED SERVICES LINES FROM PREVIOUS STAGE LOCATED 1m FROM STAGED BOUNDARY AND CONTINUED.

EXPOSED CAPPED SERVICES LINES FROM PREVIOUS STAGE LOCATED 1m FROM STAGED BOUNDARY AND CONTINUED.



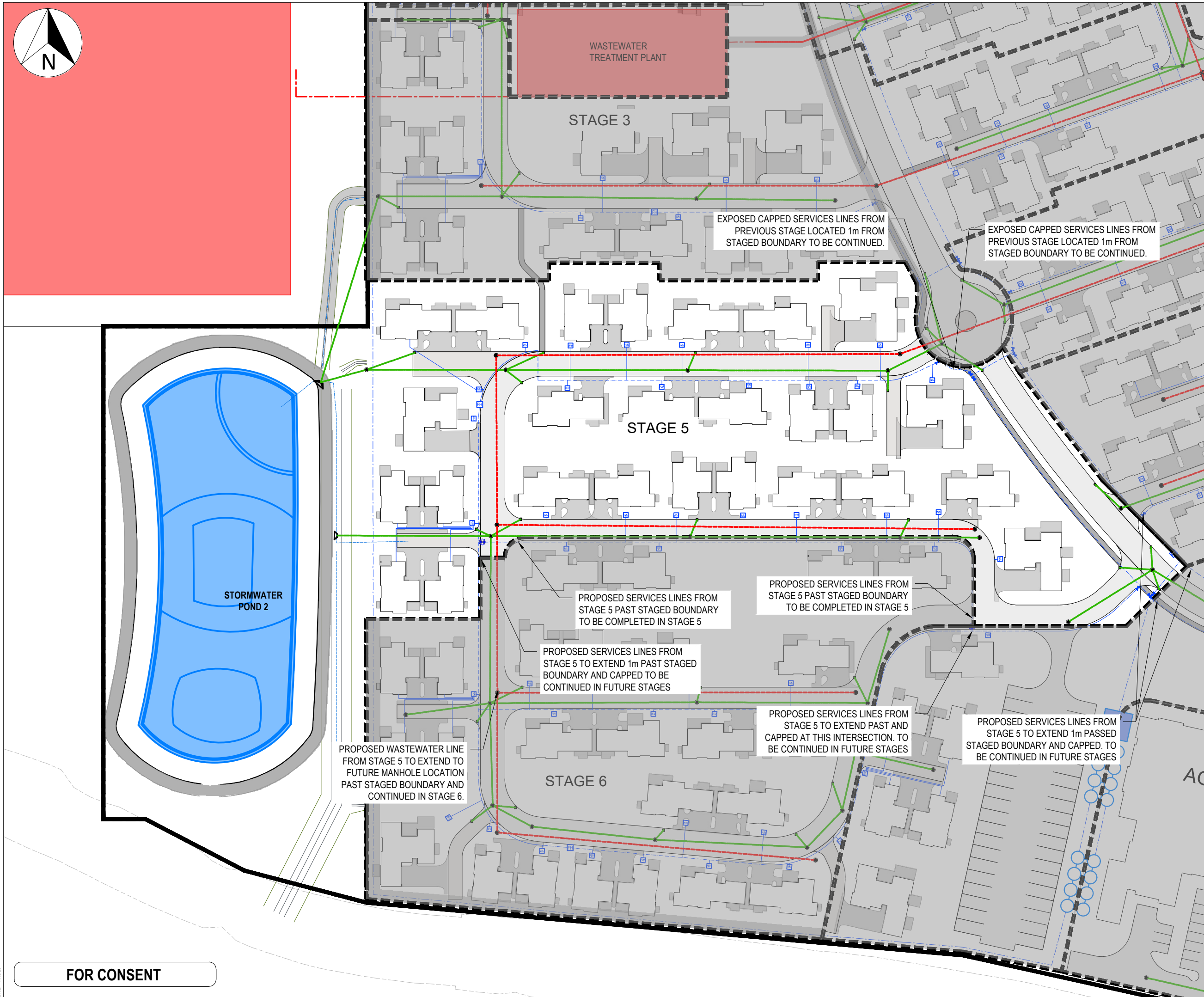
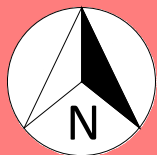

Notes

1. All works to be in accordance with MPDC and RITS standards.
2. Co-ordinates in terms of NZ Geodetic Datum MT Eden 2000.
3. Reduced Levels are in terms of NZVD 2016.
4. Boundaries are subject to final survey.

Legend

|     |                   |
|-----|-------------------|
| --- | EX BDY            |
| --- | PROP BDY          |
| --- | STAGING BDY       |
| --- | EX UNDERGROUND    |
| --- | POWER             |
| --- | EX OVERHEAD POWER |
| --- | EX FIBRE          |
| --- | PROP WATERMAIN    |
| --- | PROP POWER        |
| --- | PROP FIBRE        |
| --- | BULK WATER METER  |
| --- | PROP HYDRANT      |
| --- | PROP METER        |
| --- | PROP SLUICE VALVE |
| --- | PROP PEAT VALVE   |
| --- | PROP PUMP STATION |
| --- | PROP STORMWATER   |
| --- | EX/PROP SWMH      |
| --- | EX/PROP SWCP      |
| --- | PROP RISING MAIN  |
| --- | PROP WASTEWATER   |
| --- | EX/PROP WWMH      |

|         |                  |     |         |
|---------|------------------|-----|---------|
| B       | RESOURCE CONSENT | DIJ | 11/25   |
| A       | FOR CONSENT      | KQ  | 05/25   |
| Rev     | Description      | By  | Date    |
| Survey  | MAVEN            |     | 10/2024 |
| Design  | MAVEN            |     | 05/2025 |
| Drawn   | KQ               |     | 05/2025 |
| Checked | SB               |     | 05/2025 |

**M**  
Maven Matamata  
matamatainfo@maven.co.nz  
www.maven.co.nz  
8 Tainui Street, Matamata  
New Zealand

Project  
**ASHBOURNE  
RETIREMENT VILLAGE  
MATAMATA  
FOR  
UNITY DEVELOPMENT LTD**

Title  
**PROPOSED  
STAGING PLAN  
STAGE 5**

|             |                     |
|-------------|---------------------|
| Project no. | J00606              |
| Scale       | 1:1000@A3           |
| Cad file    | C8000 - STAGING.DWG |
| Drawing no. | C8005               |
| Rev         | <b>B</b>            |

FOR CONSENT



ORIGINAL SIZE: A3  
DATE: 11/10/25  
FILE PATH: \\MAVEN\MAVENCONSULTING.CO.NZ\SHARE\CURRENT\MAVEN\PROJECTS\288001 - STATION ROAD - RV DRAINAGE\DWG\C8000 - STAGING.DWG

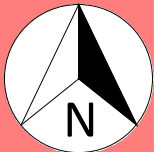

EXPOSED CAPPED SERVICES LINES FROM  
PREVIOUS STAGE LOCATED 1m FROM  
STAGED BOUNDARY AND CONTINUED.

EXPOSED CAPPED SERVICES LINES  
FROM PREVIOUS STAGE LOCATED  
AT INTERSECTION AND CONTINUED.

PROPOSED SERVICES LINES FROM  
STAGE 6 PAST STAGED BOUNDARY  
TO BE COMPLETED IN STAGE 6.

- Notes
1. All works to be in accordance with MPDC and RITS standards.
  2. Co-ordinates in terms of NZ Geodetic Datum MT Eden 2000.
  3. Reduced Levels are in terms of NZVD 2016.
  4. Boundaries are subject to final survey.

| Legend |                      |
|--------|----------------------|
|        | EX BDY               |
|        | PROP BDY             |
|        | STAGING BDY          |
|        | EX UNDERGROUND POWER |
|        | EX OVERHEAD POWER    |
|        | EX FIBRE             |
|        | PROP WATERMAIN       |
|        | PROP POWER           |
|        | PROP FIBRE           |
|        | BULK WATER METER     |
|        | PROP HYDRANT         |
|        | PROP METER           |
|        | PROP SLUICE VALVE    |
|        | PROP PEAT VALVE      |
|        | PROP PUMP STATION    |
|        | PROP STORMWATER      |
|        | EX/PROP SWMH         |
|        | EX/PROP SWCP         |
|        | PROP RISING MAIN     |
|        | PROP WASTEWATER      |
|        | EX/PROP WWMH         |

| Rev     | Description      | By  | Date    |
|---------|------------------|-----|---------|
| B       | RESOURCE CONSENT | DIJ | 11/25   |
| A       | FOR CONSENT      | KQ  | 05/25   |
| Survey  | MAVEN            |     | 10/2024 |
| Design  | MAVEN            |     | 05/2025 |
| Drawn   | KQ               |     | 05/2025 |
| Checked | SB               |     | 05/2025 |

**Maven Matamata**  
matamatainfo@maven.co.nz  
www.maven.co.nz  
8 Tainui Street, Matamata  
New Zealand

Project  
**ASHBOURNE  
RETIREMENT VILLAGE  
MATAMATA  
FOR  
UNITY DEVELOPMENT LTD**

Title  
**PROPOSED  
STAGING PLAN  
STAGE 6**

|             |                     |     |          |
|-------------|---------------------|-----|----------|
| Project no. | J00606              |     |          |
| Scale       | 1:1000@A3           |     |          |
| Cad file    | C8000 - STAGING.DWG |     |          |
| Drawing no. | C8006               | Rev | <b>B</b> |

**FOR CONSENT**



ORIGINAL SIZE: A3  
DATE: 11/10/25  
FILE PATH: \\MAVEN\MAVENCONSULTING.CO.NZ\SHARE\CURRENT\MAVEN\PROJECTS\280001 - STATION ROAD - RV DRAINAGE\DWG\C8000 - STAGING.DWG

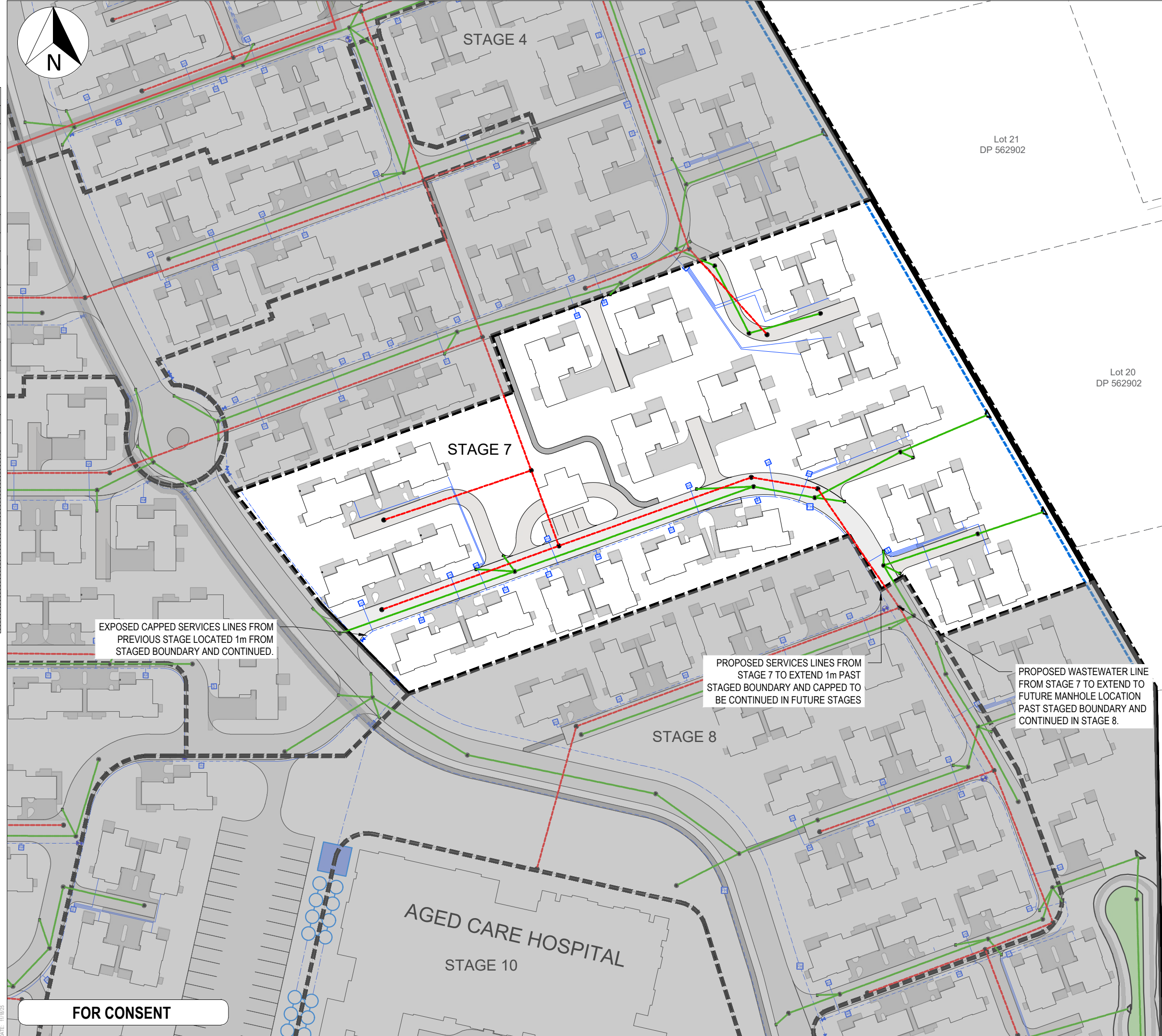

EXPOSED CAPPED SERVICES LINES FROM PREVIOUS STAGE LOCATED 1m FROM STAGED BOUNDARY AND CONTINUED.

PROPOSED SERVICES LINES FROM STAGE 7 TO EXTEND 1m PAST STAGED BOUNDARY AND CAPPED TO BE CONTINUED IN FUTURE STAGES

PROPOSED WASTEWATER LINE FROM STAGE 7 TO EXTEND TO FUTURE MANHOLE LOCATION PAST STAGED BOUNDARY AND CONTINUED IN STAGE 8.

Lot 22  
DP 562902

Lot 21  
DP 562902

Lot 20  
DP 562902

- Notes
1. All works to be in accordance with MPDC and RITS standards.
  2. Co-ordinates in terms of NZ Geodetic Datum MT Eden 2000.
  3. Reduced Levels are in terms of NZVD 2016.
  4. Boundaries are subject to final survey.

| Legend |                      |
|--------|----------------------|
|        | EX BDY               |
|        | PROP BDY             |
|        | STAGING BDY          |
|        | EX UNDERGROUND POWER |
|        | EX OVERHEAD POWER    |
|        | EX FIBRE             |
|        | PROP WATERMAIN       |
|        | PROP POWER           |
|        | PROP FIBRE           |
|        | BULK WATER METER     |
|        | PROP HYDRANT         |
|        | PROP METER           |
|        | PROP SLUICE VALVE    |
|        | PROP PEAT VALVE      |
|        | PROP PUMP STATION    |
|        | PROP STORMWATER      |
|        | EX/PROP SWMH         |
|        | EX/PROP SWCP         |
|        | PROP RISING MAIN     |
|        | PROP WASTEWATER      |
|        | EX/PROP WWMH         |

|         |                  |     |         |
|---------|------------------|-----|---------|
|         |                  |     |         |
| B       | RESOURCE CONSENT | DIJ | 11/25   |
| A       | FOR CONSENT      | KQ  | 05/25   |
| Rev     | Description      | By  | Date    |
|         |                  | By  | Date    |
| Survey  | MAVEN            |     | 10/2024 |
| Design  | MAVEN            |     | 05/2025 |
| Drawn   | KQ               |     | 05/2025 |
| Checked | SB               |     | 05/2025 |



Project  
**ASHBOURNE  
RETIREMENT VILLAGE  
MATAMATA  
FOR  
UNITY DEVELOPMENT LTD**

Title  
**PROPOSED  
STAGING PLAN  
STAGE 7**

|             |                     |
|-------------|---------------------|
| Project no. | J00606              |
| Scale       | 1:1000@A3           |
| Cad file    | C8000 - STAGING.DWG |
| Drawing no. | C8007               |
| Rev         | <b>B</b>            |

**FOR CONSENT**



ORIGINAL SIZE: A3  
DATE: 11/19/25  
FILE PATH: \\MAVEN\MAVENCONSULTING.CO.NZ\SHARE\CURRENT\MAVEN\PROJECTS\288001 - STATION ROAD - RV DRAINAGE\DWG\C8000 - STAGING.DWG

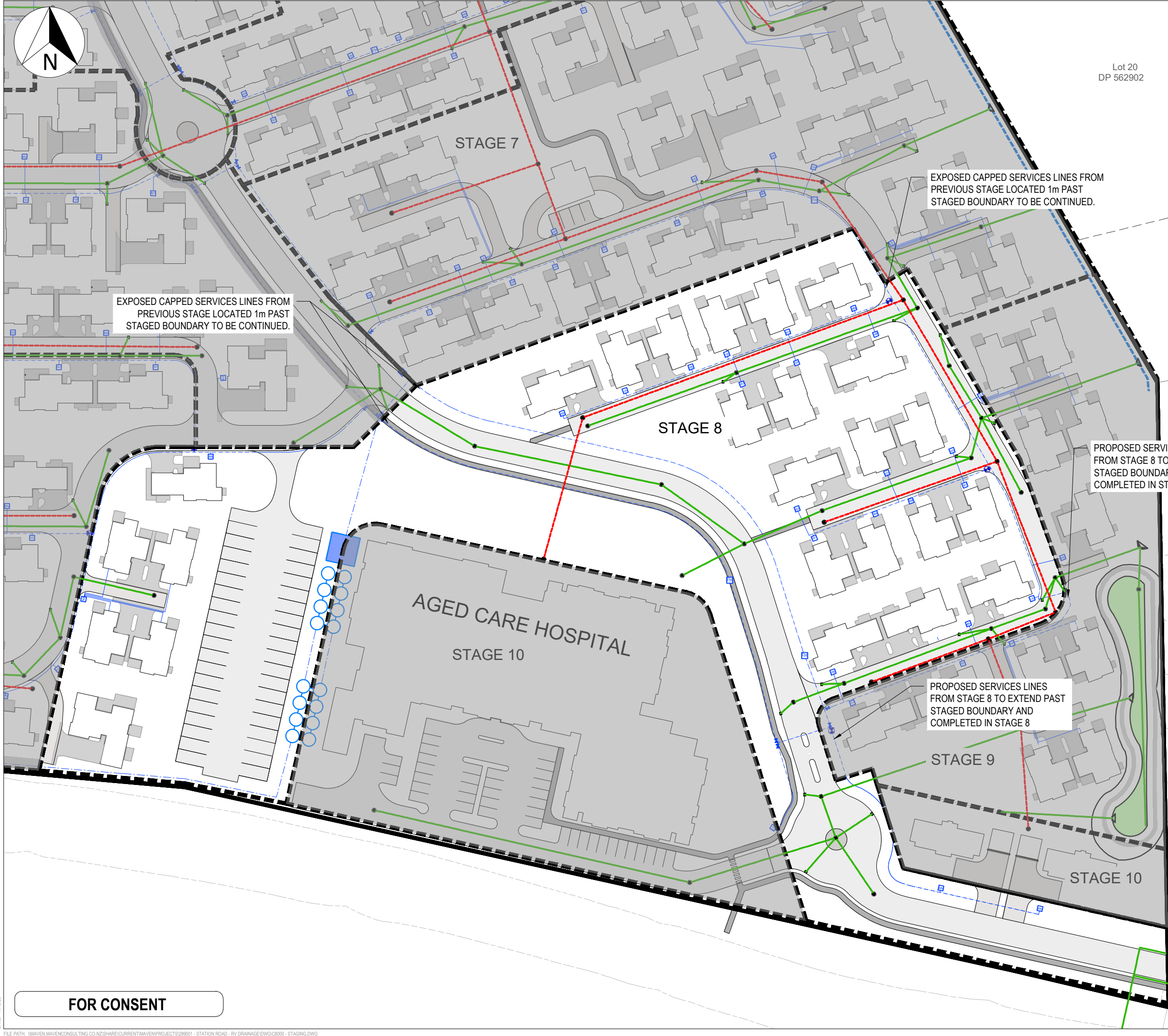
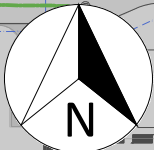

Lot 20  
DP 562902

EXPOSED CAPPED SERVICES LINES FROM  
PREVIOUS STAGE LOCATED 1m PAST  
STAGED BOUNDARY TO BE CONTINUED.

EXPOSED CAPPED SERVICES LINES FROM  
PREVIOUS STAGE LOCATED 1m PAST  
STAGED BOUNDARY TO BE CONTINUED.

PROPOSED SERVICES LINES  
FROM STAGE 8 TO EXTEND PAST  
STAGED BOUNDARY AND  
COMPLETED IN STAGE 8.

PROPOSED SERVICES LINES  
FROM STAGE 8 TO EXTEND PAST  
STAGED BOUNDARY AND  
COMPLETED IN STAGE 8

- Notes
1. All works to be in accordance with MPDC and RITS standards.
  2. Co-ordinates in terms of NZ Geodetic Datum MT Eden 2000.
  3. Reduced Levels are in terms of NZVD 1916.
  4. Boundaries are subject to final survey.

| Legend |                   |
|--------|-------------------|
|        | EX BDY            |
|        | PROP BDY          |
|        | STAGING BDY       |
|        | EX UNDERGROUND    |
|        | POWER             |
|        | EX OVERHEAD POWER |
|        | EX FIBRE          |
|        | PROP WATERMAIN    |
|        | PROP POWER        |
|        | PROP FIBRE        |
|        | BULK WATER METER  |
|        | PROP HYDRANT      |
|        | PROP METER        |
|        | PROP SLUICE VALVE |
|        | PROP PEAT VALVE   |
|        | PROP PUMP STATION |
|        | PROP STORMWATER   |
|        | EX/PROP SWMH      |
|        | EX/PROP SWCP      |
|        | PROP RISING MAIN  |
|        | PROP WASTEWATER   |
|        | EX/PROP WWMH      |

| Rev     | Description      | By  | Date    |
|---------|------------------|-----|---------|
| B       | RESOURCE CONSENT | DIJ | 11/25   |
| A       | FOR CONSENT      | KQ  | 05/25   |
| Survey  | MAVEN            |     | 10/2024 |
| Design  | MAVEN            |     | 05/2025 |
| Drawn   | KQ               |     | 05/2025 |
| Checked | SB               |     | 05/2025 |



Project  
**ASHBOURNE  
RETIREMENT VILLAGE  
MATAMATA  
FOR  
UNITY DEVELOPMENT LTD**

Title  
**PROPOSED  
STAGING PLAN  
STAGE 8**

|             |                     |
|-------------|---------------------|
| Project no. | J00606              |
| Scale       | 1:1000@A3           |
| Cad file    | C8000 - STAGING.DWG |
| Drawing no. | C8008               |
| Rev         | <b>B</b>            |

FOR CONSENT



ORIGINAL SIZE: A3  
DATE: 11/19/25  
FILE PATH: \\MAVEN\MAVENCONSULTING.CO.NZ\SHARE\CURRENT\MAVEN\PROJECTS\288001 - STATION ROAD - RV DRAINAGE\DWG\C8000 - STAGING.DWG

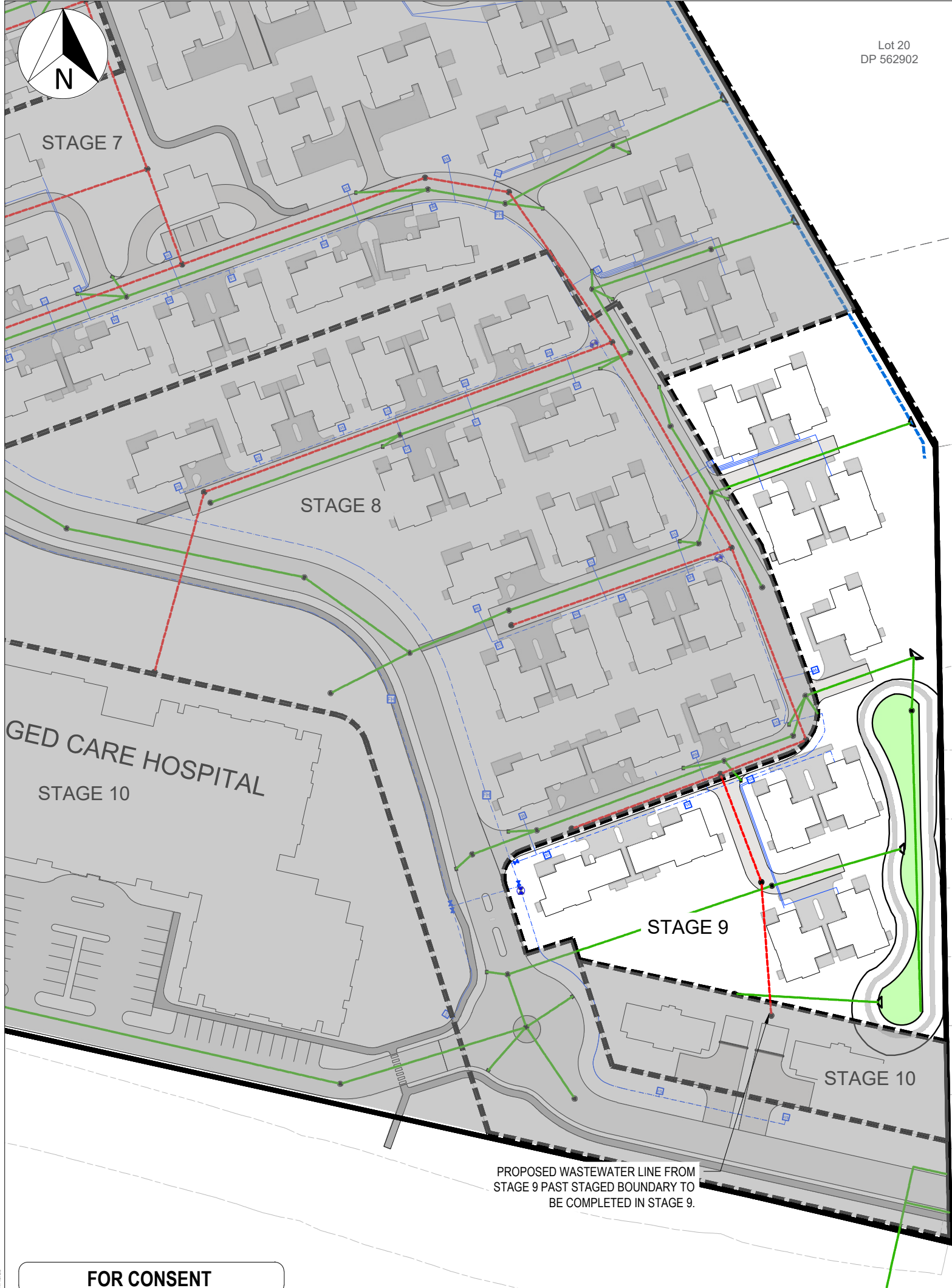

# PROPOSED RESIDENTIAL DEVELOPMENT

- Notes
1. All works to be in accordance with MPDC and RITS standards.
  2. Co-ordinates in terms of NZ Geodetic Datum MT Eden 2000.
  3. Reduced Levels are in terms of NZVD 2016.
  4. Boundaries are subject to final survey.

| Legend |                   |
|--------|-------------------|
| ---    | EX BDY            |
| ---    | PROP BDY          |
| ---    | STAGING BDY       |
| ---    | EX UNDERGROUND    |
| ---    | POWER             |
| ---    | EX OVERHEAD POWER |
| ---    | EX FIBRE          |
| ---    | PROP WATERMAIN    |
| ---    | PROP POWER        |
| ---    | PROP FIBRE        |
| ---    | BULK WATER METER  |
| ---    | PROP HYDRANT      |
| ---    | PROP METER        |
| ---    | PROP SLUICE VALVE |
| ---    | PROP PEAT VALVE   |
| ---    | PROP PUMP STATION |
| ---    | PROP STORMWATER   |
| ---    | EX/PROP SWMH      |
| ---    | EX/PROP SWCP      |
| ---    | PROP RISING MAIN  |
| ---    | PROP WASTEWATER   |
| ---    | EX/PROP WWMH      |

| Rev     | Description      | By  | Date    |
|---------|------------------|-----|---------|
| B       | RESOURCE CONSENT | DIJ | 11/25   |
| A       | FOR CONSENT      | KQ  | 05/25   |
| Survey  | MAVEN            |     | 10/2024 |
| Design  | MAVEN            |     | 05/2025 |
| Drawn   | KQ               |     | 05/2025 |
| Checked | SB               |     | 05/2025 |



Project  
**ASHBOURNE  
RETIREMENT VILLAGE  
MATAMATA  
FOR  
UNITY DEVELOPMENT LTD**

Title  
**PROPOSED  
STAGING PLAN  
STAGE 9**

|             |                     |
|-------------|---------------------|
| Project no. | J00606              |
| Scale       | 1:1000@A3           |
| Cad file    | C8000 - STAGING.DWG |
| Drawing no. | C8009               |
| Rev         | <b>B</b>            |



ORIGINAL SIZE: A3

150m  
100  
80  
60  
40  
20  
0

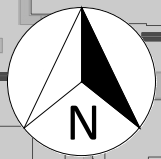

Lot 20  
DP 562902

STAGE 7

STAGE 8

AGED CARE HOSPITAL  
STAGE 10

STAGE 9

STAGE 10

- Notes
1. All works to be in accordance with MPDC and RITS standards.
  2. Co-ordinates in terms of NZ Geodetic Datum MT Eden 2000.
  3. Reduced Levels are in terms of NZVD 2016.
  4. Boundaries are subject to final survey.

Legend

|     |                      |
|-----|----------------------|
| --- | EX BDY               |
| --- | PROP BDY             |
| --- | STAGING BDY          |
| --- | EX UNDERGROUND POWER |
| --- | EX OVERHEAD POWER    |
| --- | EX FIBRE             |
| --- | PROP WATERMAIN       |
| --- | PROP POWER           |
| --- | PROP FIBRE           |
| --- | BULK WATER METER     |
| --- | PROP HYDRANT         |
| --- | PROP METER           |
| --- | PROP SLUICE VALVE    |
| --- | PROP PEAT VALVE      |
| --- | PROP PUMP STATION    |
| --- | PROP STORMWATER      |
| --- | EX/PROP SWMH         |
| --- | EX/PROP SWCP         |
| --- | PROP RISING MAIN     |
| --- | PROP WASTEWATER      |
| --- | EX/PROP WWMH         |

|         |                  |     |         |
|---------|------------------|-----|---------|
|         |                  |     |         |
| B       | RESOURCE CONSENT | DIJ | 11/25   |
| A       | FOR CONSENT      | KQ  | 05/25   |
| Rev     | Description      | By  | Date    |
|         |                  | By  | Date    |
| Survey  | MAVEN            |     | 10/2024 |
| Design  | MAVEN            |     | 05/2025 |
| Drawn   | KQ               |     | 05/2025 |
| Checked | SB               |     | 05/2025 |

**M**  
M A V E N

**Maven Matamata**  
matamatainfo@maven.co.nz  
www.maven.co.nz  
8 Tainui Street, Matamata  
New Zealand

Project  
**ASHBOURNE  
RETIREMENT VILLAGE  
MATAMATA  
FOR  
UNITY DEVELOPMENT LTD**

Title  
**PROPOSED  
STAGING PLAN  
STAGE 10**

|             |                     |
|-------------|---------------------|
| Project no. | J00606              |
| Scale       | 1:1000@A3           |
| Cad file    | C8000 - STAGING.DWG |
| Drawing no. | C8010               |
| Rev         | <b>B</b>            |

**FOR CONSENT**

DATE: 11/19/25

FILE PATH: \\MAVEN\MAVENCONSULTING.CO.NZ\SHARE\CURRENT\MAVEN\PROJECTS\289001 - STATION ROAD - RV DRAINAGE\DWG\C8000 - STAGING.DWG