

# 6 | LANDSCAPE STRATEGY





MATERIALS STRATEGY



**LEGEND**

	EXPOSED AGGREGATE CONCRETE WITH WAIPA PEBBLE
	EXPOSED AGGREGATE CONCRETE WITH WAIPA PEBBLE AND SHELL
	STONE SETTS
	STONE PAVERS
	PERMEABLE PAVING
	EXISTING CONCRETE FOOTPATH
	ARTIFICIAL LAWN

	CONCRETE TERRAZZO PAVERS - ON NATURAL GROUND
	CONCRETE TERRAZZO PAVERS - ON JACKS
	CONCRETE TERRAZZO PAVERS - PRIVATE COURTYARDS
	PEBBLE WITH GROUNDCOVER PLANTING
	CRUSHED LIMECHIP
	AT STANDARD LIGHTLY BROOMED CONCRETE



# LIGHTING STRATEGY



- LEGEND**
- LIGHTING POLE
  - LIGHTING BOLLARD
  - EMBEDDED/SURFACE MOUNTED STRIP LIGHTING
  - FEATURE UPLIGHT/WALL GRAZING LIGHT
  - BUILDING AND PODIUM FACADE LIGHTING

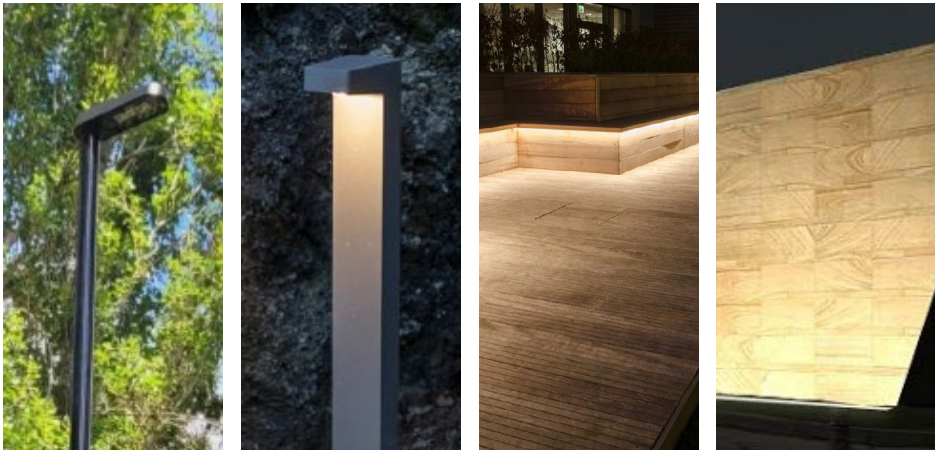



# FURNITURE STRATEGY

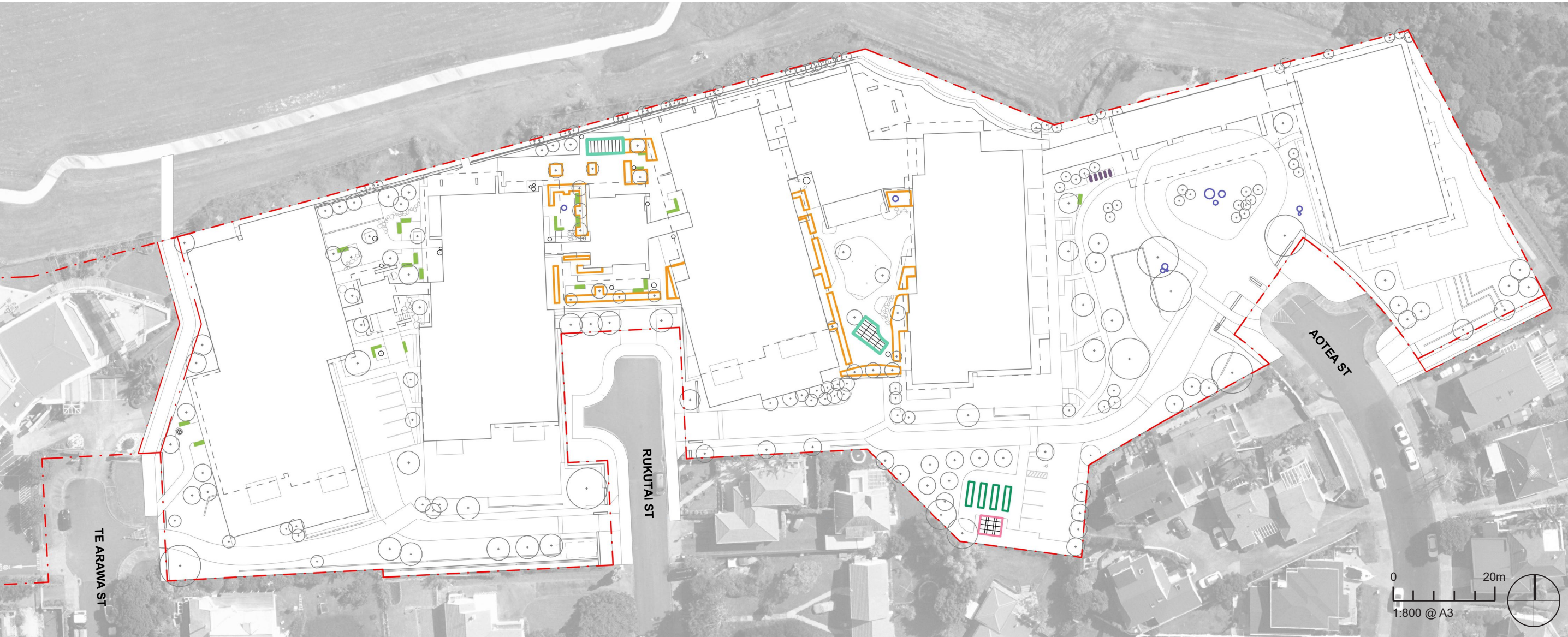

**LEGEND**

- FIXED SEATING
- RAISED PLANTER ON-PODIUM - SHUTTERED CONCRETE
- RAISED PLANTER OFF-PODIUM - TIMBER
- PERGOLA
- GLASSHOUSE OR MAKERS' SHED
- BOULDERS



# FENCING & WALLS STRATEGY



- LEGEND**
- PERMEABLE FENCE - 1.2M ALUMINIUM
  - PERMEABLE FENCE - 1.4M ALUMINIUM
  - SOLID FENCE - 1.8M ALUMINIUM
  - RETAINING WALL (1M OR LOWER)
  - RETAINING WALL (1M - 1.5M)
  - ENTRY WALL - 1.4M



WIND MITIGATION DEVICES



LEGEND





- CANOPY WITH MAXIMUM POROSITY OF 50%
- 2M WIND SCREEN WITH MAXIMUM POROSITY OF 50%





SITE COVERAGE



LEGEND		
	BUILDING COVERAGE	13,508M²
	IMPERVIOUS COVERAGE	3715M²
	PERMEABLE CONCRETE	1347M²
	LANDSCAPED AREA	5771M²
	ON-PODIUM LANDSCAPED AREA (EXCLUDED FROM CALCULATIONS)	2501M²
	<b>TOTAL SITE AREA</b>	<b>24,341M²</b>

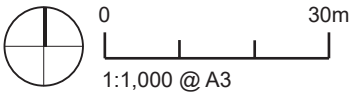



TREE STRATEGY



LEGEND

- |   |  |   |
|---|--|---|
|  ACER SPP. - JAPANESE MAPLE (160-300L)               |  GORDONIA YUNNANENSIS - FRIED EGG TREE (160L)           |  PHYLLOCLADUS TRICHOMANOIDES - TANEKHAH   CELERY PINE (160L) |
|  AGATHIS AUSTRALIS - KAURI (160L)                    |  KNIGHTIA EXCELSA - REWAREWA (160L)                     |  PSEUDOPANAX CRASSIFOLIUS - HOROEKA (45L)                    |
|  ALECTRYON EXCELSA - TĪTOKI (300L)                   |  LIQUIDAMBAR STYRACIFLUA 'WORPLESDON' - SWEETGUM (160L) |  PYRUS CALLERYANA 'ARISTOCRAT' - CALLERY PEAR (160L)         |
|  CERCIS 'FOREST PANSY' - REDBUD (160L)               |  MAGNOLIA DENUDATA - YULAN MAGNOLIA (DECIDUOUS) (300L)  |  PYRUS SALICIFOLIA 'PENDULA' - WEEPING PEAR (160L)           |
|  CERCIS 'HEARTS OF GOLD' - REDBUD (160L)             |  MAGNOLIA 'LITTLE GEM' - EVERGREEN MAGNOLIA (160L)      |  RHOPALOSTYLIS SAPIDA - NĪKAU (160L)                         |
|  CORDYLINE AUSTRALIS - TĪ KŌUKA (45L)                |  METROSIDEROS EXCELSA - PŌHUTUKAWA (300L)               |  SOPHORA CHATHAMICA - CHATHAMS KŌWHAI (80L)                  |
|  CYATHEA DEALBATA - PONGA   SILVER FERN (45L)        |  NERIUM OLEANDER - OLEANDER (80L)                       |  VITEX LUCENS - PŪRIRI (300L)                                |
|  CYATHEA MEDULLARIS - MAMUKU   BLACK TREE FERN (45L) |  OLEA EUROPA 'EL GRECO' - OLIVE (160L)                  |  FRUIT TREES - MIXED (45-80L)                                |
|   |  |  EXISTING TREE TO BE RETAINED                                |

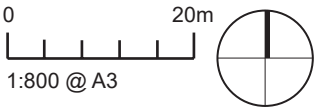



TREE PALETTE

NATIVE TREES



TĪTOKI

*Alectryon excelsus*



PŌHUTUKAWA

*Metrosideros excelsa*



REWAREWA

*Knightia excelsa*



PŪRIRI

*Vitex lucens*



HOROEKA

*Pseudopanax crassifolius*



KAURI

*Agathis australis*



TREE PALETTE

EXOTIC TREES



EVERGREEN MAGNOLIA  
Magnolia ‘Little Gem’



ACER SPP.  
Japanese maples



REDBUD ‘HEARTS OF GOLD’  
Cercis ‘Hearts of Gold’



REDBUD ‘FOREST PANSY’  
Cercis ‘Forest Pansy’



WEeping PEAR  
Pyrus salicifolia pendula



FRIED EGG TREE  
Gordonia yunnanensis



# PLANTING STRATEGY - DEPTHS



**LEGEND**

- NATURAL GROUND
- PODIUM - PAVING LEVEL & GREEN ROOF (250MM DEPTH)
- PODIUM RAISED PLANTER (400MM DEPTH)
- PODIUM RAISED PLANTER (600MM DEPTH)
- PODIUM RAISED PLANTER (1000MM DEPTH)
- PODIUM RAISED PLANTER (1200MM DEPTH)

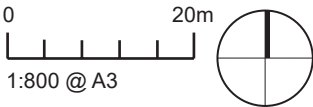



# PLANTING STRATEGY - ZONES



**LEGEND**

- KOROWAI, SOUTHERN DRIVEWAY & WESTERN ENTRANCE - NATIVE PLANTING
- ARRIVAL PORTE COCHÈRE - NATIVE PLANTING
- VILLAGE HEART
- SENSORY & WELLNESS
- THE GARDENS
- PRODUCTIVE GARDEN
- GREEN ROOF
- PUBLIC WALKWAYS
- HEDGING
- BALCONY & PODIUM EDGE MIX

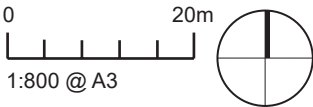



# PLANTING PALETTE

## KOROWA, SOUTHERN DRIVEWAY & WESTERN ENTRANCE - NATIVE PLANTING

A diverse, locally appropriate selection of native species, the Korowai and Western Entrance palette includes several species listed in Ko te Pūkāki 2040, including a number of the taonga species identified.

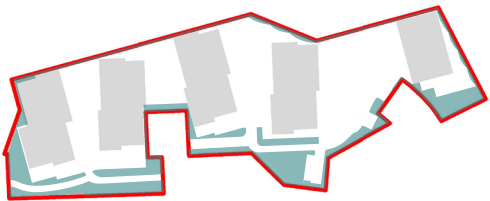



# PLANTING PALETTE

## ARRIVAL PORTE COCHÈRE

Continuous with the Native Korowai planting, the Arrival Porte Cochère palette distils the native plant selection further, emphasising structure and colour that responds to the architecture, while referencing the site’s wider context. Low textural swathe planting of grasses and small shrubs covers the central mound, while more depth, height and variation is present in the surrounding gardens.

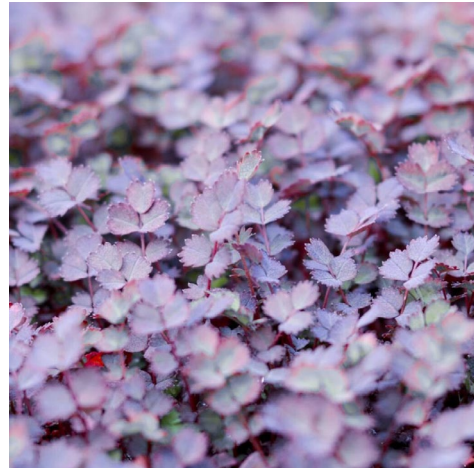
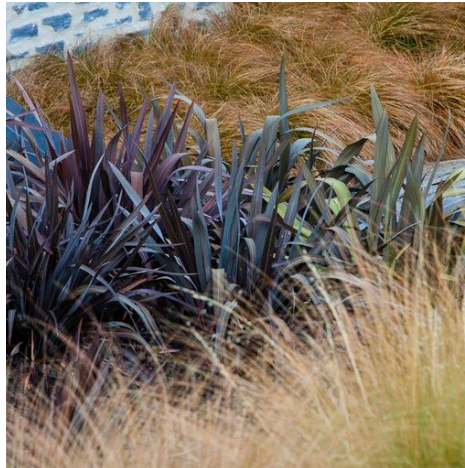
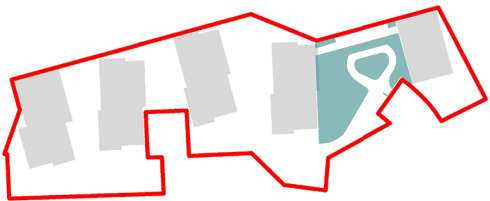



# PLANTING PALETTE

## GREEN ROOF

Small native shrubs, grasses and ground covers form a tapestry of textures and subtle colour variation, with hints of silvery blues and rust amongst the greens. Swathes of grasses give a naturalistic impression, and add movement as sway in the wind.

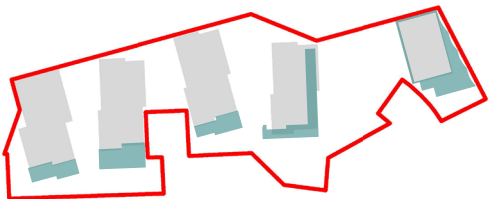



# PLANTING PALETTE

## HEART OF THE VILLAGE

Lush greens are offset by red tones, and a strong focus on foliage provides consistent interest and beauty, and responds to the organic curves of the design. Native and exotic species are represented. Low hedging and taller planting in raised planters provide soft, green screening to adjoining units, while defining the Village heart within.

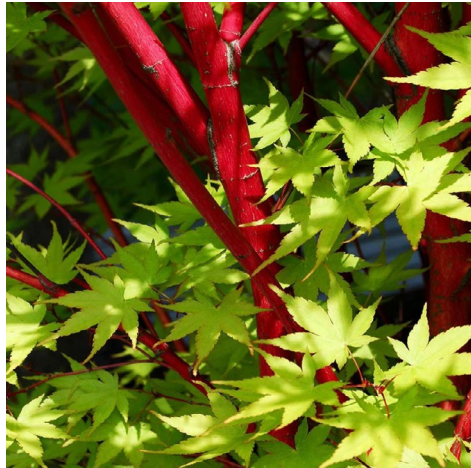
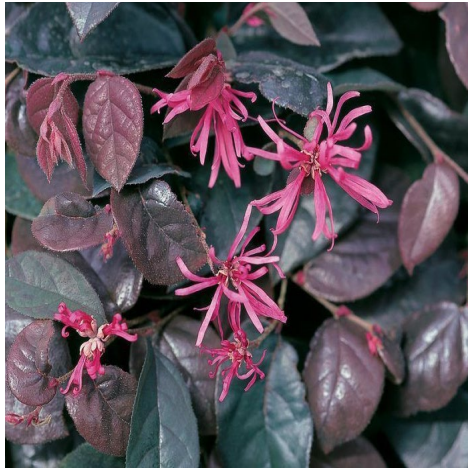
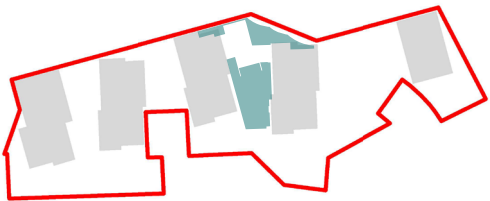



# PLANTING PALETTE

## SENSORY & WELLNESS GARDENS - NORTH

Combining herbs and edible species with bright ornamentals, plants have been selected for the exposed conditions of this northern courtyard. Larger shrubs are located in the deeper raised planters, or in feature pots. Silver, lime and plum coloured foliage accents add interest throughout the year while a soft palette of pink and purple flowers is awakened by vibrant pops of orange.

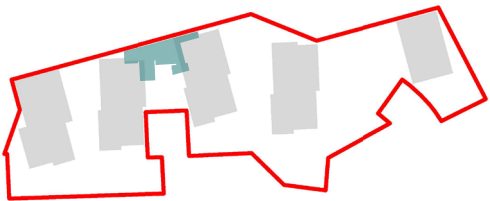



# PLANTING PALETTE

## SENSORY & WELLNESS GARDENS - SOUTH

The southern Sensory and Wellness Garden features a palette that draws on naturally occurring silver and purple hues for lush, striking planting. Scented blooms add seasonal interest.

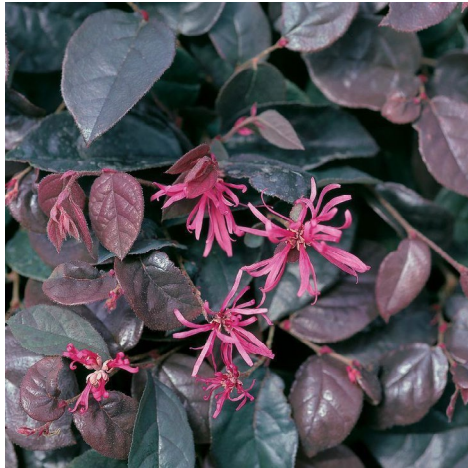
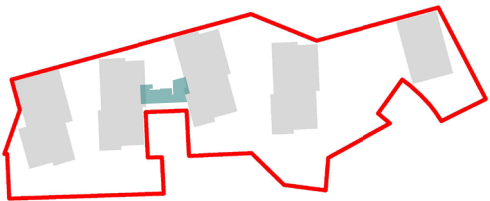



# PLANTING PALETTE

## THE GARDENS - NORTH

In this lush, green garden, plant selection plays with scale, form and texture. Here, on natural ground, larger shrubs give the gardens structure, deep planting beds underplant the trees and groundcovers and grasses soften the edges - plant layering and deep bed depths allows for the establishment of true 'garden' planting. Predominantly a white flowering garden, with blushes of pink and plum, there is continual seasonal interest.

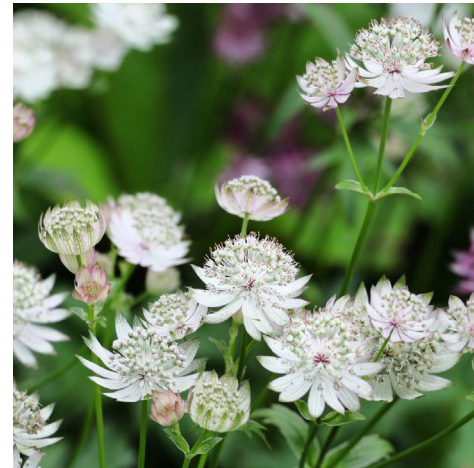
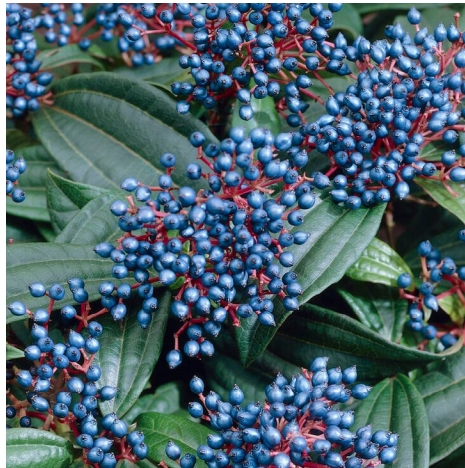
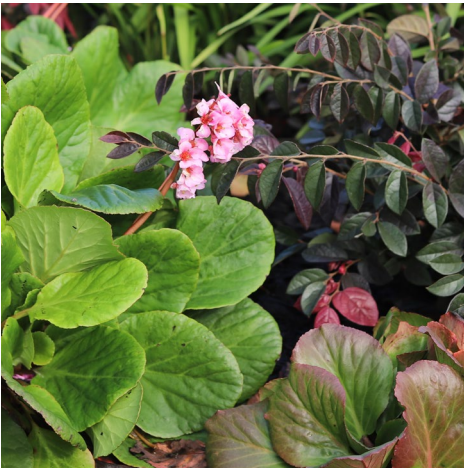
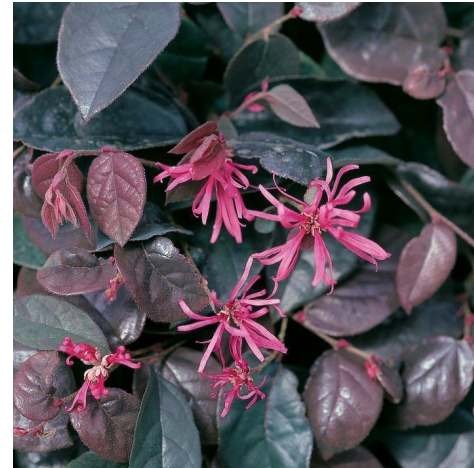
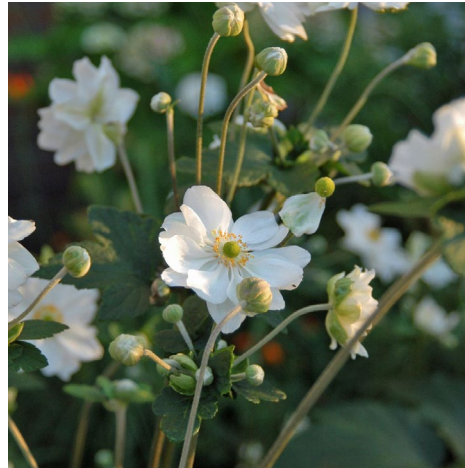
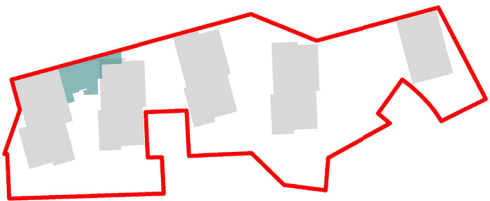



# PLANTING PALETTE

## THE GARDENS - SOUTH

This southern space includes a shaded courtyard and underplanting for specimen trees. Subtropical elements and Japanese gardens are referenced, with a focus on lush deep greens and contrasting forms and texture. Hints of orange and yellow, present in both flowers and foliage, brighten shadier spots and unify the palette.

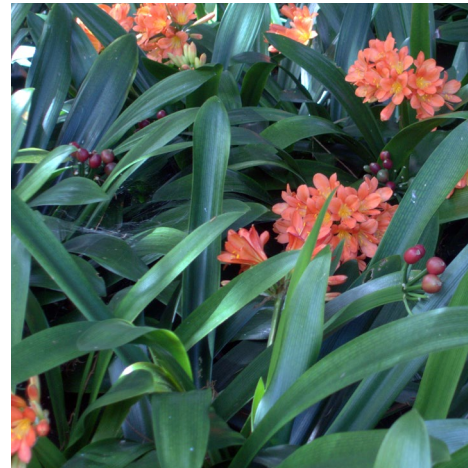
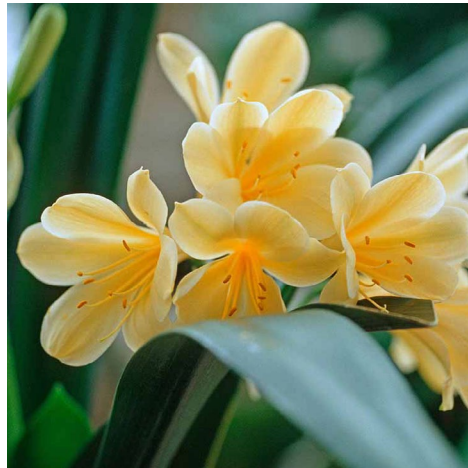
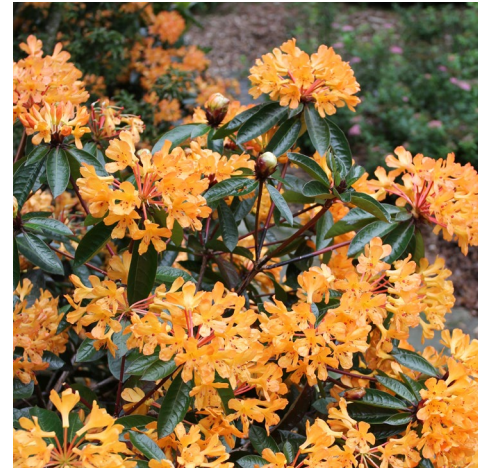
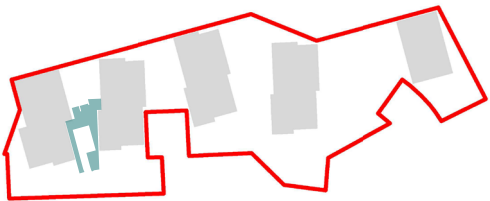



# PLANTING PALETTE

## PRODUCTIVE GARDEN

Raised timber planting beds provide easy-access gardening and harvesting opportunities. There is an emphasis on culinary species and seasonal interest, mixing herbs, vegetables and fruit with bright ornamentals. Planting outside of the beds likewise includes decorative and edible species, against the backdrop of the native korowai boundary planting.

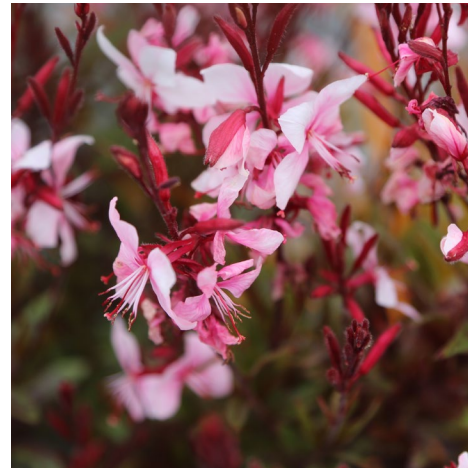
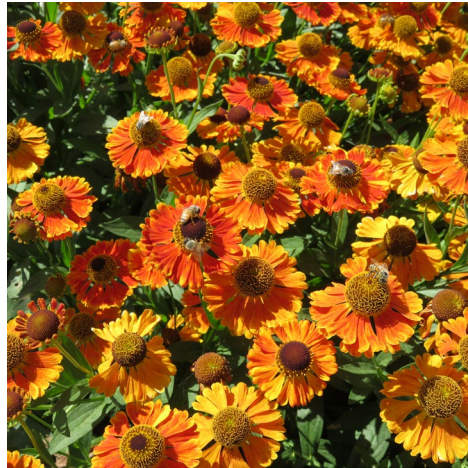
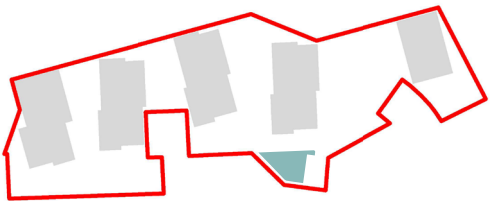



# PLANTING PALETTE

## PUBLIC WALKWAYS

Low growing, low maintenance native species with a variety of textures and colours to border either side of the western and eastern public walkways.

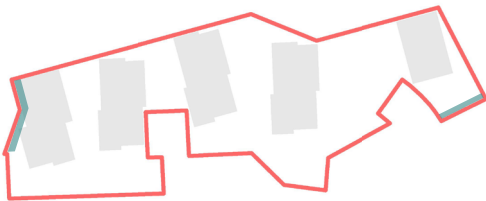



PLANTING LISTS

			Zones												Plant size and spacing					Ko te Pūkāki 2040		
Type	Botanical name	Common name	Deciduous / Winter dormant	Evergreen	Native Korowai	Arrival Porte Cochère	Balcony & Podium Edge Mix	Village Heart - North	Village Heart - South	Sensory & Wellness - North	Sensory & Wellness - South	The Gardens - North	The Gardens - South	Productive Garden	Green Roof	Height at planting (m)	L grade	Spacing (m)	Height (m) at 2-years	Height (m) at 10-years	Included Species	Taonga Species
Ground covers																						
	Acaena purpurea	Piripiri		x						x	x	x	x	x	x	0.1	2	0.5	0.2	0.2		
	Ajuga reptans 'Black Scallop'	Bugle		x					x		x	x				0.1	2	0.5	0.2	0.2		
	Blechnum penna-marina	Alpine hard fern		x	x	x		x		x	x	x	x		x	0.05	2	0.5	0.1	0.2		
	Dichondra 'Emerald Falls'	Green kidney weed		x				x	x			x				0.1	2	0.5	0.1	0.1		
	Dichondra 'Silver Falls'	Silver kidney weed		x				x	x	x	x					0.05	2	0.5	0.1	0.1		
	Disphyma australe	Horokaka													x	0.1	2	0.7	0.2	0.2		
	Geranium Rozanne	Cranesbill	x							x						0.1	2	1	0.4	0.4		
	Leptinella 'Platt's Black'	Brass buttons		x							x		x			0.1	2	0.5	0.1	0.1		
	Lobelia angulata	Panakenake		x	x	x	x	x	x	x	x	x	x	x	x	0.1	2	0.7	0.2	0.2		
	Muehlenbeckia axillaris	Pohuehue		x	x	x		x		x	x	x	x	x	x	0.1	2	0.7	0.2	0.2		
	Ophiopogon planiscapus 'Nigrescens'	Black mondo grass		x				x		x						0.1	2	0.3	0.2	0.2		
	Pimelea prostrata	Pinatoro   NZ Daphne		x	x	x				x	x			x	x	0.1	2	0.8	0.1	0.2		
	Rubus pentalobus	Orangeberry		x				x		x				x		0.1	2	1	0.2	0.2		
	Schizocentron elegans	Spanish shawl		x				x		x						0.1	2	0.7	0.2	0.2		
	Scleranthus biflorus	Nāereere   Cushion plant		x						x						0.1	2	0.5	0.1	0.1		
	Selliera radicans	Remuremu		x	x	x			x		x	x	x		x	0.15	2	0.7	0.15	0.15		
	Thymus serpyllum	Creeping thyme		x				x		x				x		0.1	2	0.8	0.1	0.2		
Prostrate/ sprawling shrubs																						
	Coprosma acerosa 'Red Rocks'	Red Rocks' coprosma			x	x									x	0.2	2	1.2	0.3	0.3		
	Coprosma repens 'Poor Knights'	Taupata   mirror plant		x	x	x	x	x	x						x	0.2	3	0.7	0.4	0.5		
	Grevillea 'Bronze Rambler'	Spider flower		x				x		x				x		0.2	3	1.2	0.3	0.4		
	Grevillea lanigera 'Mt Tamboritha'	Spider flower		x				x		x				x		0.2	3	0.8	0.3	0.5		
	Rosmarinus prostratus	Prostrate rosemary		x				x		x		x		x		0.1	2	0.9	0.2	0.3		
	Sophora prostrata 'Little Twister'	Prostrate kōwhai	x	x				x		x						0.2	3	0.7	0.75	0.75		
Perennials																						
	Achillea spp.	Ornamental yarrow		x						x				x		0.2	3	0.5	0.5	0.5		
	Alchemilla mollis	Lady's mantle		x								x				0.2	3	0.5	0.4	0.4		
	Anemone huphenis	White windflower		x								x				0.3	3	0.6	1	1		
	Anigozanthos spp.	Kangaroo paw		x						x						0.3	3	0.5	0.5	0.5		
	Astrantia major	Great masterwort		x								x				0.2	3	0.5	0.5	0.5		
	Cynara scolymus	Artichoke		x						x				x		0.3	3	1	1.5	1.5		
	Echinecea purpurea	Coneflower		x						x				x		0.2	3	0.5	0.9	0.9		
	Gaura lindheimeri var.	Beeblossom		x				x		x	x	x		x		0.3	3	0.7	1	1		
	Geum 'Rustico Orange'	Avens		x						x						0.2	3	0.3	0.3	0.3		
	Helenium 'Waldstrand Copper'	Sneezeweed		x						x						0.3	3	0.9	1	1		
	Helleborus orientalis spp.	Lenten   winter rose			x						x	x		x		0.3	3	0.4	0.5	0.5		
	Heuchera var.	Coral bells		x					x		x					0.2	3	0.4	0.3	0.3		
	Lavandula angustifolia 'Hidcote'	Hidcote English lavender		x				x		x				x		0.2	3	0.6	0.6	0.6		
	Liriope muscari sp.	Lilyturf		x				x			x	x				0.15	3	0.4	0.4	0.4		
	Salvia spp.	Ornamental sage		x						x				x		var.	3	var.	var.	var.		
	Sedum spectabile 'Autumn Joy'	Stonecrop		x						x						0.3	3	0.5	0.6	0.6		



# PLANTING LISTS

Type	Botanical name	Common name	Deciduous / Winter dormant Evergreen		Zones										Plant size and spacing					Ko te Pūkāki 2040	
					Native Korowai	Arrival Porte Cochère	Balcony & Podium Edge Mix	Village Heart - North	Village Heart - South	Sensory & Wellness - North	Sensory & Wellness - South	The Gardens - North	The Gardens - South	Productive Garden	Green Roof	Height at planting (m)	L grade	Spacing (m)	Height (m) at 2-years	Height (m) at 10-years	Included Species
	Stachys byzantina	Lamb's ear		x					x	x	x		x		0.2	3	0.5	0.5	0.5		
	Verbena bonariensis	Purpletop vervain	x						x				x		0.3	3	0.8	1.2	1.2		
Grasses, reeds, ferns																					
	Apodasmia similis	Oioi		x	x	x		x		x	x		x		0.3	3	0.5	0.8	0.8		
	Asplenium bulbiferum	Hen and chicken fern		x						x		x			0.3	2	0.8	0.8	1		
	Asplenium oblongifolium	Shining spleenwort		x				x		x	x				0.3	2	1	1	1.5		
	Blechnum gibbum 'Silver Lady'	Dwarf tree fern		x						x		x			0.3	2	1	1	1		
	Chionacloa rubra	Red tussock		x	x	x		x					x	x	0.3	2	0.6	0.8	0.8		
	Chionochloa flavicans	Haumata		x		x		x		x	x				0.4	3	0.7	1	1		
	Dianella nigra	Turutu		x	x	x		x		x	x		x		0.3	2	0.5	0.5	0.5		
	Ficnia nodosa	Wiwi		x		x								x	0.4	2	0.6	0.8	0.8		
	Hakonechloa macra	Japanese forest grass	x					x		x		x			0.2	3	0.6	0.6	0.6		
	Libertia grandiflora	Mikoikoi  NZ iris		x		x	x	x					x	x	0.2	2	0.7	0.5	0.7	x	
	Libertia ixioides	Mikoimikoi		x	x	x	x	x						x	0.2	2	0.5	0.4	0.4	x	
	Libertia peregrinans	Mikoimikoi		x										x	0.2	2	0.5	0.3	0.3		
	Lomandra spp.	Lomandra		x		x	x	x	x	x	x				0.2	3	0.5	0.5	0.5		
	Miscanthus sinensis sp.	Maiden grass	x				x	x							var.	3	var.	var.	var.		
	Poa cita	Wī   silver tussock		x		x								x	0.3	3	0.5	0.6	0.6		
Shrubs																					
	* Mixed annual vegetable & herb spp.	Vegetables (eg. lettuce, raddish)	x											x	var.	plug / seed	var.	var.	var.		
	Acacia cognata 'Limelight'	River wattle		x				x	x	x	x	x			0.2	3	1	0.8	0.8		
	Arthropodium cirratum	Rengarenga		x	x	x		x	x	x	x	x	x	x	0.4	3	0.7	0.8	0.8	x	x
	Astelia banksii	Wharawhara		x	x										0.1	3	1	0.8	1.2	x	
	Astelia chathamica 'Silver Spear'	Kakaha		x		x				x	x				0.2	3	1	1	1.5		
	Astelia solandri	Kōwharawhara		x	x										0.2	3	1.5	1	1.5	x	
	Camellia transokoensis	Camellia		x							x	x	x		0.5	8	as per plan	1.2	prune		
	Carpodetus serratus 'Prostrata'	Dwarf putaputawētā		x		x		x		x	x	x			0.2	3	0.8	0.6	1.5		
	Clivia miniata var.	Clivia lily		x								x			0.3	3	0.5	0.6	0.6		
	Convolvulus cneorum	Silver bush		x			x		x	x					0.2	3	0.6	0.6	0.6		
	Coprosma rhamnoides	Mingimingi		x	x	x			x					x	0.3	3	0.8	1	1.5		
	Coprosma viriscens	Mingimingi		x	x	x									0.3	3	1	1	3		
	Corokia 'Frosted chocolate'	Korokio		x					x					x	0.3	3	1	2	2		
	Euphorbia glauca	Waiū-atua		x						x				x	0.2	3	0.5	1	1		
	Euphorbia spp.	Spurge		x			x		x		x		x		var.	3	var.	var.	var.		
	Gardenia radicans	Gardenia		x			x		x	x	x				0.2	3	var.	var.	var.		
	Hydrangea paniculata 'Limelight'	Panicle hydrangea	x					x		x	x				0.4	8	1.3	1.5	1.5		
	Leucospermum spp.	Pincushion bush		x			x		x						var.	8	var.	var.	var.		
	Ligularia renformis	Tractor seat		x				x	x	x	x	x			0.4	3	0.8	0.6	0.6		
	Lorapetalum spp.	Fringe flower		x				x	x	x	x	x	x		var.	3	var.	var.	var.		
	Michelia 'Fairy Blush'	Fairy Magnolia		x							x				1.7	8	2	2	3		
	Muehlenbeckia astonii	Shrubby tororaro		x		x			x					x	0.3	8	1.5	0.8	2		
	Pachystegia insignis	Malborough rock daisy		x		x			x	x					0.2	3	0.8	0.5	0.5		



# PLANTING LISTS

					Zones										Plant size and spacing					Ko te Pūkāki 2040			
Type	Botanical name	Common name	Deciduous / Winter dormant	Evergreen	Native Korowai	Arrival Porte Cochère	Balcony & Podium Edge Mix	Village Heart - North	Village Heart - South	Sensory & Wellness - North	Sensory & Wellness - South	The Gardens - North	The Gardens - South	Productive Garden	Green Roof	Height at planting (m)	L grade	Spacing (m)	Height (m) at 2-years	Height (m) at 10-years	Included Species	Taonga Species	
	Philodendron 'Xanadu'	Winterbourne philodendron	x					x		x		x				0.3	3	0.8	0.8	1			
	Phormium 'Black Magic'	Black Magic' dwarf flax	x			x				x				x		0.1	3	0.3	0.3	0.4			
	Phormium cookianum ‘Emerald Gem’	Mountain flax	x		x	x		x		x	x					0.2	3	1	0.8	1			
	Phormium 'Platt's Black'	'Platt's Black' flax	x			x				x				x		0.3	3	0.7	0.7	1			
	Phormium 'Sweet mist'	'Sweet Mist' dwarf flax	x			x		x		x						0.2	3	0.4	0.4	0.4			
	Phormium tenax	Harakeke	x		x											0.3	3	1.5	1.5	2.5	x	x	
	Pieris 'Temple Bells'	Lily of the valley bush	x									x				0.3	8	1	1	1.5			
	Piper excelsum	Kawakawa	x		x	x								x		0.2	3	1.2	1.2	2	x	x	
	Pittosporum 'Golf Ball'	Kōhūhū   Golf Ball	x						x	x	x	x	x	x		0.2	3	0.7	0.6	1 (clip)			
	Pseudopanax 'Cyril Watson'	Houpara   Cyril Watson	x		x	x										0.2	3	1.5	1.5	3			
	Veronica spp.	Hebe spp.	x		x			x	x	x	x	x	x	x	x	var.	3	var.	var.	var.			
	Viburnum davidii	David viburnum	x						x		x	x	x			0.3	3	1.5	1	2 (clip)			
	Vireya 'Tropic Glow' or 'Golden Charm'	Vireya	x										x			0.3	8	as per plan	1	1.2-1.5			
Hedging					Sited as per plan and clipped to specified heights																		
	Camellia spp.	Camellia	x					x		x	x					1.2	19	0.5	clip	clip			
	Coprosma repens 'Middlemore'	Taupata   mirror plant	x		x	x										1.2	19	0.5	clip	clip			
	Ficus 'Tuffi'	Tuffy fig	x										x			1.2	19	0.5	clip	clip			
	Lonicera nitida	Box honeysuckle	x					x	x	x	x					0.2	3	0.4	clip	clip			
	Pittosporum 'Stephens Island'	Kōhūhū   Stephens Island	x		x	x										1.2	19	0.5	clip	cip			
Climbers																	As per plan						
	Clematis paniculata	Puawanaga			x					x				x		0.2	3	-	clip to support		x	x	
	Trachelospermum jasminoides	Star jasmine							x	x	x	x				0.2	3	-	clip to support				
Trees native					p = potted (smaller grade)												As per plan						
	Agathis australis	Kauri	x		x											3.5	160	-	4.5	7			
	Alectryon excelsa	Tītoki	x		x											3	300	-	4	6			
	Carpodetus serratus	Putaputawētā	x		x											1.2	45	-	2	5	x	x	
	Cordyline australis	Tī kouka	x		x											1	45	-	1.5	6	x	x	
	Cyathea dealbata	Ponta   Silver fern	x		x											var.	45	-	2	6			
	Cyathea medullaris	Mamaku   Black ponga	x		x											var.	45	-	2	6	x		
	Knightia excelsa	Rewarewa	x		x											1.8	160	-	2.5	4			
	Metrosideros excelsa	Pōhutukawa	x		x	x										3	300	-	5	8	x	x	
	Myrsine australis	Māpou / Matipo	x		x											0.5	3	-	2	5	x		
	Phyllocladus trichomanoides	Tanekaha   celery pine	x		x											1.5	160	-	2.5	6	x		
	Pseudopanax crassifolius	Horoeka	x		x	x		p								0.8	45	-	1.2	4	x		
	Pseudopanax lessonii	Houpara	x		x											0.5	3	-	2	6	x		
	Rhopalostylis sapida	Nīkau	x		x								x			1.5	160	-	2.5	5			
	Sophora chathamica	Kōwhai	x	x	x	x		p		p						2	80	-	3	5	x	x	
	Vitex lucens	Pūriri		x	x											3	300	-	4	8			
Trees exotic					p = potted (smaller grade)												As per plan						
	Acer spp.	Japanese maple	x					x	x	x	x	x				var.	160-300	-	var.	var.			
	Cercis 'Forest Pansy'	Redbud 'Forest Pansy'	x					x		x	x					2	160	-	3	5			
	Cercis 'Hearts of Gold'	Redbud 'Hearts of Gold'	x					x	x			x	x			2	160	-	3	5			



# PLANTING LISTS

					Zones										Plant size and spacing					Ko te Pūkāki 2040		
Type	Botanical name	Common name	Deciduous / Winter dormant	Evergreen	Native Korowai	Arrival Porte Cochère	Balcony & Podium Edge Mix	Village Heart - North	Village Heart - South	Sensory & Wellness - North	Sensory & Wellness - South	The Gardens - North	The Gardens - South	Productive Garden	Green Roof	Height at planting (m)	L grade	Spacing (m)	Height (m) at 2-years	Height (m) at 10-years	Included Species	Taonga Species
Trees fruit	Cupressus sempevirens	Pencil pine   Italian cypress		x			p		p							2	45	-	3	5		
	Gordonia yunnanensis	Fried egg tree		x								x				1.5	160	-	3	5		
	Juniperus chinensis 'Kaizuka'	Hollywood juniper		x					p							1.5	80	-	cloud prune	cloud prune		
	Laurus nobilis	Bay laurel		x						p						1.4	45	-	prune	prune		
	Liquidambar styraciflua 'Worplesdon'	Liquidambar	x										x			2.5	160	-	4	7		
	Magnolia denudata var.	Yulan Magnolia	x									x				2.5	300	-	3	5 prune		
	Magnolia 'Little Gem'	Evergreen Magnolia		x					x							2	160	-	3	4		
	Michelia spp.	Michelia		x						p	x	p	x			var.	45	-	var.	var.		
	Nerium oleander	Oleander		x						x						1	80	-	2	3		
	Olea europa 'El Greco'	Olive		x						x/p						2	160	-	3	3		
	Podocarpus macrophyllus	Yew pine		x					p	p						2	85	-	2.5	prune		
	Pyrus calleryana ‘Aristocrat’	Ornamental pear	x										x			3	160	-	4	7		
	Pyrus salicifolia 'Pendula'	Weeping pear	x								x	x	x			2	160	-	2.5	4		
	Trees fruit					p = potted (smaller grade)										As per plan						
	Acca sellowiana 'Apollo'	Feijoa		x										x		1.5	45	-	2	4		
	Citrus spp.	Lemon, Lime, Orange		x						p				x		var.	45	-	var.	var.		
	Ficus carica sp.	Fig	x							p				x		var.	45	-	var.	var.		
	Malus spp.	Apple	x											x		var.	80	-	var.	var.		
	Prunus spp.	Plum	x											x		var.	80	-	var.	var.		



Together. Shaping Better Places.

Boffa Miskell is a leading New Zealand environmental consultancy with nine offices throughout Aotearoa. We work with a wide range of local, international private and public sector clients in the areas of planning, urban design, landscape architecture, landscape planning, ecology, biosecurity, Te Hīhiri (cultural advisory), engagement, transport advisory, climate change, graphics and mapping. Over the past five decades we have built a reputation for creativity, professionalism, innovation and excellence by understanding each project’s interconnections with the wider environmental, social, cultural and economic context.

