

- NOTES**
- 1. ALL WORK AND MATERIALS TO COMPLY WITH AUCKLAND COUNCIL STANDARDS. ANY AMBIGUITY BETWEEN DRAWINGS AND COUNCIL STANDARDS TO BE REPORTED TO THE ENGINEER FOR CLARIFICATION.
 - 2. ALL CESSPITS TO BE AT SEMI-RECESSED CESSPIT AS PER AT TDM DRAWING RD0020 UNLESS SPECIFIED OTHERWISE.
 - 3. FOOTPATHS TO BE CONSTRUCTED AS PER DETAILS ON TYPICAL CROSS SECTION DRAWINGS.
 - 4. PRAM CROSSINGS TO BE CONSTRUCTED AS PER AUCKLAND COUNCIL STANDARD.
 - 5. VEHICLE CROSSINGS WILL BE CONSTRUCTED TO AUCKLAND COUNCIL STANDARDS WITH ONE LAYER OF 665 OR 661 MESH CENTRALLY PLACED IN ALL CASES.
 - 6. ALL LANE MARKING AND ROAD SIGNAGE IS TO BE CONSTRUCTED AS PER NEW ZEALAND TRANSPORT AGENCY MANUAL OF SIGNS AND MARKINGS.
 - 7. PAVING (IF SHOWN) IS TO BE CONSTRUCTED AS PER THE DETAILS INCLUDED IN THIS DRAWING SET.
 - 8. ALL AREAS AND DIMENSIONS ARE SUBJECT TO FINAL SURVEY
 - 9. SCHEME PLAN IS SUBJECT TO COUNCIL APPROVAL
 - 10. ALL ROADS TO VEST IN AUCKLAND COUNCIL
 - 11. ALL ACCESSWAYS TO VEST IN AUCKLAND COUNCIL
 - 12. CONTOURS WITHIN STAGE BOUNDARIES ARE TO FINISHED LEVEL AT PHASE 1. CONTOURS EXTERNAL TO STAGE BOUNDARY ARE EXISTING SURFACE LEVELS.

LEGEND:

- PROPOSED PARCEL BOUNDARY
- STAGE BOUNDARY
- EXISTING/APPROVED PARCEL BOUNDARY
- PROPOSED GROUND FLOOR FOOTPRINT
- EXISTING RAIN GARDEN
- EXISTING RAIN GARDEN TO BE REMOVED
- PROPOSED RAINGARDEN
- PROPOSED CARRIAGEWAY
- FOOTPATH
- JOAL CARRIAGEWAY
- RAISED INTERSECTION
- BERM
- PHASE 2 VEHICLE CROSSING
- PHASE 1 VEHICLE CROSSING
- PROPOSED RETAINING WALL
- WW MANHOLE (PROPOSED & EXISTING)
- SW MANHOLE (PROPOSED & EXISTING)
- PROPOSED SW CATCHPIT
- EXISTING SW CATCHPIT
- EXISTING TREES
- PROPOSED TREES
- PROPOSED STREET & JOAL LIGHTS
- EXISTING STREETLIGHTS

REVISION DETAILS		BY	DATE
1	ISSUED FOR CONSENT	TR	FEB 2025

SURVEYED	WOODS	BUILDING B, LEVEL 1 8 NUGENT ST, GRAFTON, AUCKLAND 1023 +64 9 308 9229 WOODS.CO.NZ
DESIGNED	WOODS	
DRAWN	PK	
CHECKED	JM	
APPROVED	TR	

MILLDALE STAGE 4C

**ROADING PLAN
OVERALL**

STATUS	ISSUED FOR CONSENT	REV
SCALE	1:1500 @ A3	1
COUNCIL	AUCKLAND COUNCIL	
DWG NO	P23-481-4C-0-2000-RD	



1. ALL WORK AND MATERIALS TO COMPLY WITH AUCKLAND COUNCIL STANDARDS. ANY AMBIGUITY BETWEEN DRAWINGS AND COUNCIL STANDARDS TO BE REPORTED TO THE ENGINEER FOR CLARIFICATION.
2. ALL CESSPIPS TO BE AT SEMI-RECESSED CESSPIT AS PER AT TDM DRAWING RD0020 UNLESS SPECIFIED OTHERWISE.
3. FOOTPATHS TO BE CONSTRUCTED AS PER DETAILS ON TYPICAL CROSS SECTION DRAWINGS.
4. PRAM CROSSINGS TO BE CONSTRUCTED AS PER AUCKLAND COUNCIL STANDARD.
5. VEHICLE CROSSINGS WILL BE CONSTRUCTED TO AUCKLAND COUNCIL STANDARDS WITH ONE LAYER OF 665 OR 661 MESH CENTRALLY PLACED IN ALL CASES.
6. ALL LANE MARKING AND ROAD SIGNAGE IS TO BE CONSTRUCTED AS PER NEW ZEALAND TRANSPORT AGENCY MANUAL OF SIGNS AND MARKINGS.
7. PAVING (IF SHOWN) IS TO BE CONSTRUCTED AS PER THE DETAILS INCLUDED IN THIS DRAWING SET.
8. ALL AREAS AND DIMENSIONS ARE SUBJECT TO FINAL SURVEY
9. SCHEME PLAN IS SUBJECT TO COUNCIL APPROVAL
10. ALL ROADS TO VEST IN AUCKLAND COUNCIL
11. ALL ACCESSWAYS TO VEST IN AUCKLAND COUNCIL
12. CONTOURS WITHIN STAGE BOUNDARIES ARE TO FINISHED LEVEL AT PHASE 1. CONTOURS EXTERNAL TO STAGE BOUNDARY ARE EXISTING SURFACE LEVELS.

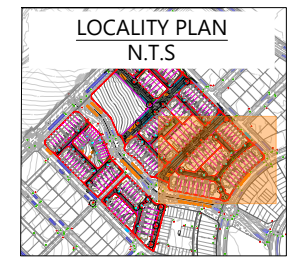

	PROPOSED PARCEL BOUNDARY
	STAGE BOUNDARY
	EXISTING/APPROVED PARCEL BOUNDARY
	PROPOSED GROUND FLOOR FOOTPRINT
	EXISTING RAIN GARDEN
	EXISTING RAIN GARDEN TO BE REMOVED
	PROPOSED RAINGARDEN
	PROPOSED CARRIAGEWAY
	FOOTPATH
	JOAL CARRIAGEWAY
	RAISED INTERSECTION
	BERM
	PHASE 2 VEHICLE CROSSING
	PHASE 1 VEHICLE CROSSING
	PROPOSED RETAINING WALL
	WW MANHOLE (PROPOSED & EXISTING)
	SW MANHOLE (PROPOSED & EXISTING)
	PROPOSED SW CATCHPIT
	EXISTING SW CATCHPIT
	EXISTING TREES
	PROPOSED TREES
	PROPOSED STREET & JOAL LIGHTS
	EXISTING STREETLIGHTS

REVISION DETAILS		BY	DATE
1	ISSUED FOR CONSENT	TR	FEB 2025

SURVEYED	WOODS	BUILDING B, LEVEL 1 8 NUGENT ST, GRAFTON, AUCKLAND 1023 +64 9 308 9229
DESIGNED	WOODS	
DRAWN	PK	
CHECKED	JM	
APPROVED	TR	WOODS.CO.NZ



ROADING PLAN - SHEET 1

STATUS	ISSUED FOR CONSENT	REV
SCALE	1:500 @ A3	1
COUNCIL	AUCKLAND COUNCIL	
DWG NO	P23-481-4C-0-2001-RD	

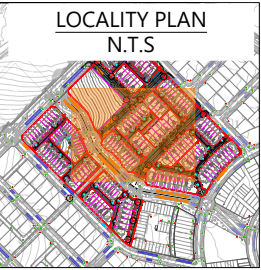
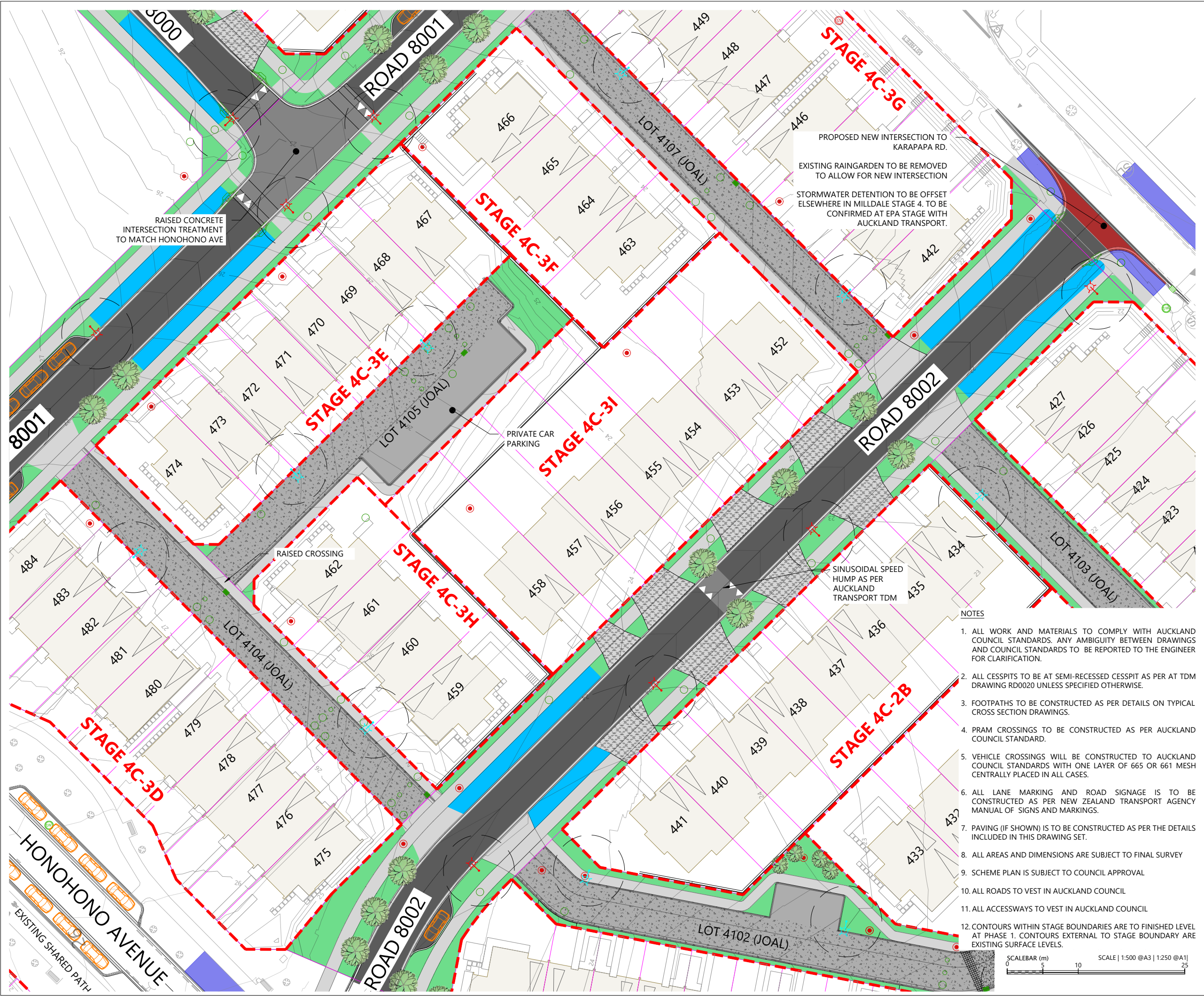

LEGEND:	
	PROPOSED PARCEL BOUNDARY
	STAGE BOUNDARY
	EXISTING/APPROVED PARCEL BOUNDARY
	PROPOSED GROUND FLOOR FOOTPRINT
	EXISTING RAIN GARDEN
	EXISTING RAIN GARDEN TO BE REMOVED
	PROPOSED RAINGARDEN
	PROPOSED CARRIAGEWAY
	FOOTPATH
	JOAL CARRIAGEWAY
	RAISED INTERSECTION
	BERM
	PHASE 2 VEHICLE CROSSING
	PHASE 1 VEHICLE CROSSING
	PROPOSED RETAINING WALL
	WW MANHOLE (PROPOSED & EXISTING)
	SW MANHOLE (PROPOSED & EXISTING)
	PROPOSED SW CATCHPIT
	EXISTING SW CATCHPIT
	EXISTING TREES
	PROPOSED TREES
	PROPOSED STREET & JOAL LIGHTS
	EXISTING STREETLIGHTS

REVISION DETAILS		BY	DATE
1	ISSUED FOR CONSENT	TR	FEB 2025

SURVEYED	WOODS	BUILDING B, LEVEL 1 8 NUGENT ST, GRAFTON, AUCKLAND 1023 +64 9 308 9229
DESIGNED	WOODS	
DRAWN	PK	
CHECKED	JM	
APPROVED	TR	
		WOODS.CO.NZ

MILLDALE STAGE 4C

ROADING PLAN - SHEET 2

STATUS	ISSUED FOR CONSENT	REV
SCALE	1:500 @ A3	1
COUNCIL	AUCKLAND COUNCIL	
DWG NO	P23-481-4C-0-2002-RD	

- NOTES
- ALL WORK AND MATERIALS TO COMPLY WITH AUCKLAND COUNCIL STANDARDS. ANY AMBIGUITY BETWEEN DRAWINGS AND COUNCIL STANDARDS TO BE REPORTED TO THE ENGINEER FOR CLARIFICATION.
 - ALL CESSPITS TO BE AT SEMI-RECESSED CESSPIT AS PER AT TDM DRAWING RD0020 UNLESS SPECIFIED OTHERWISE.
 - FOOTPATHS TO BE CONSTRUCTED AS PER DETAILS ON TYPICAL CROSS SECTION DRAWINGS.
 - PRAM CROSSINGS TO BE CONSTRUCTED AS PER AUCKLAND COUNCIL STANDARD.
 - VEHICLE CROSSINGS WILL BE CONSTRUCTED TO AUCKLAND COUNCIL STANDARDS WITH ONE LAYER OF 665 OR 661 MESH CENTRALLY PLACED IN ALL CASES.
 - ALL LANE MARKING AND ROAD SIGNAGE IS TO BE CONSTRUCTED AS PER NEW ZEALAND TRANSPORT AGENCY MANUAL OF SIGNS AND MARKINGS.
 - PAVING (IF SHOWN) IS TO BE CONSTRUCTED AS PER THE DETAILS INCLUDED IN THIS DRAWING SET.
 - ALL AREAS AND DIMENSIONS ARE SUBJECT TO FINAL SURVEY
 - SCHEME PLAN IS SUBJECT TO COUNCIL APPROVAL
 - ALL ROADS TO VEST IN AUCKLAND COUNCIL
 - ALL ACCESSWAYS TO VEST IN AUCKLAND COUNCIL
 - CONTOURS WITHIN STAGE BOUNDARIES ARE TO FINISHED LEVEL AT PHASE 1. CONTOURS EXTERNAL TO STAGE BOUNDARY ARE EXISTING SURFACE LEVELS.



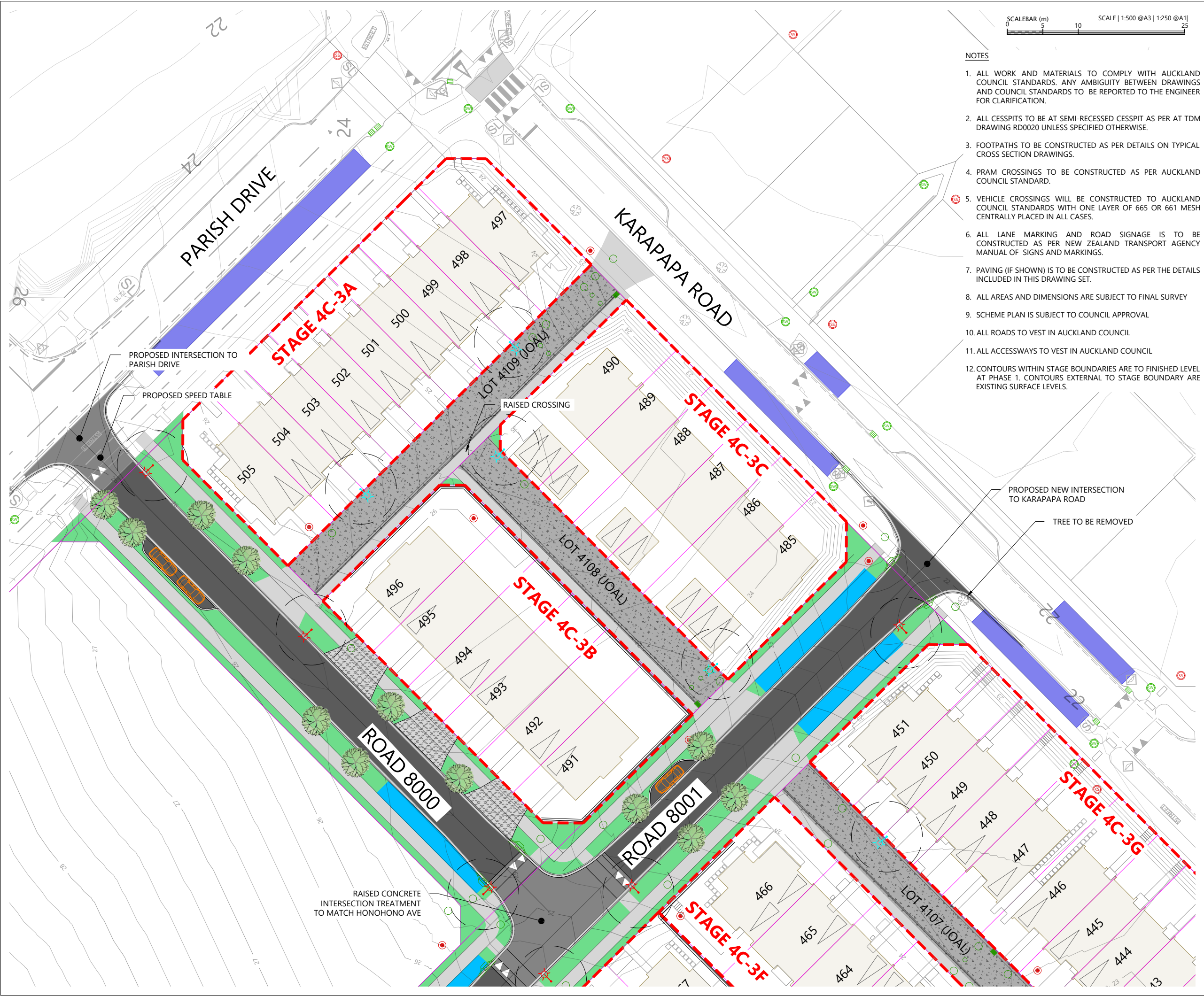

- NOTES
1. ALL WORK AND MATERIALS TO COMPLY WITH AUCKLAND COUNCIL STANDARDS. ANY AMBIGUITY BETWEEN DRAWINGS AND COUNCIL STANDARDS TO BE REPORTED TO THE ENGINEER FOR CLARIFICATION.
 2. ALL CESSPITS TO BE AT SEMI-RECESSED CESSPIT AS PER AT TDM DRAWING RD0020 UNLESS SPECIFIED OTHERWISE.
 3. FOOTPATHS TO BE CONSTRUCTED AS PER DETAILS ON TYPICAL CROSS SECTION DRAWINGS.
 4. PRAM CROSSINGS TO BE CONSTRUCTED AS PER AUCKLAND COUNCIL STANDARD.
 5. VEHICLE CROSSINGS WILL BE CONSTRUCTED TO AUCKLAND COUNCIL STANDARDS WITH ONE LAYER OF 665 OR 661 MESH CENTRALLY PLACED IN ALL CASES.
 6. ALL LANE MARKING AND ROAD SIGNAGE IS TO BE CONSTRUCTED AS PER NEW ZEALAND TRANSPORT AGENCY MANUAL OF SIGNS AND MARKINGS.
 7. PAVING (IF SHOWN) IS TO BE CONSTRUCTED AS PER THE DETAILS INCLUDED IN THIS DRAWING SET.
 8. ALL AREAS AND DIMENSIONS ARE SUBJECT TO FINAL SURVEY
 9. SCHEME PLAN IS SUBJECT TO COUNCIL APPROVAL
 10. ALL ROADS TO VEST IN AUCKLAND COUNCIL
 11. ALL ACCESSWAYS TO VEST IN AUCKLAND COUNCIL
 12. CONTOURS WITHIN STAGE BOUNDARIES ARE TO FINISHED LEVEL AT PHASE 1. CONTOURS EXTERNAL TO STAGE BOUNDARY ARE EXISTING SURFACE LEVELS.

- LEGEND:
- PROPOSED PARCEL BOUNDARY
 - STAGE BOUNDARY
 - EXISTING/APPROVED PARCEL BOUNDARY
 - PROPOSED GROUND FLOOR FOOTPRINT
 - EXISTING RAIN GARDEN
 - EXISTING RAIN GARDEN TO BE REMOVED
 - PROPOSED RAINGARDEN
 - PROPOSED CARRIAGEWAY
 - FOOTPATH
 - JOAL CARRIAGEWAY
 - RAISED INTERSECTION
 - BERM
 - PHASE 2 VEHICLE CROSSING
 - PHASE 1 VEHICLE CROSSING
 - PROPOSED RETAINING WALL
 - WW MANHOLE (PROPOSED & EXISTING)
 - SW MANHOLE (PROPOSED & EXISTING)
 - PROPOSED SW CATCHPIT
 - EXISTING SW CATCHPIT
 - EXISTING TREES
 - PROPOSED TREES
 - PROPOSED STREET & JOAL LIGHTS
 - EXISTING STREETLIGHTS

REVISION DETAILS		BY	DATE
1	ISSUED FOR CONSENT	TR	FEB 2025

SURVEYED	WOODS	BUILDING B, LEVEL 1 8 NUGENT ST, GRAFTON, AUCKLAND 1023 +64 9 308 9229
DESIGNED	WOODS	
DRAWN	PK	
CHECKED	JM	
APPROVED	TR	

Connecting Lifestyles

MILLDALE STAGE 4C

ROADING PLAN - SHEET 3

STATUS	ISSUED FOR CONSENT	REV
SCALE	1:500 @ A3	1
COUNCIL	AUCKLAND COUNCIL	
DWG NO	P23-481-4C-0-2003-RD	

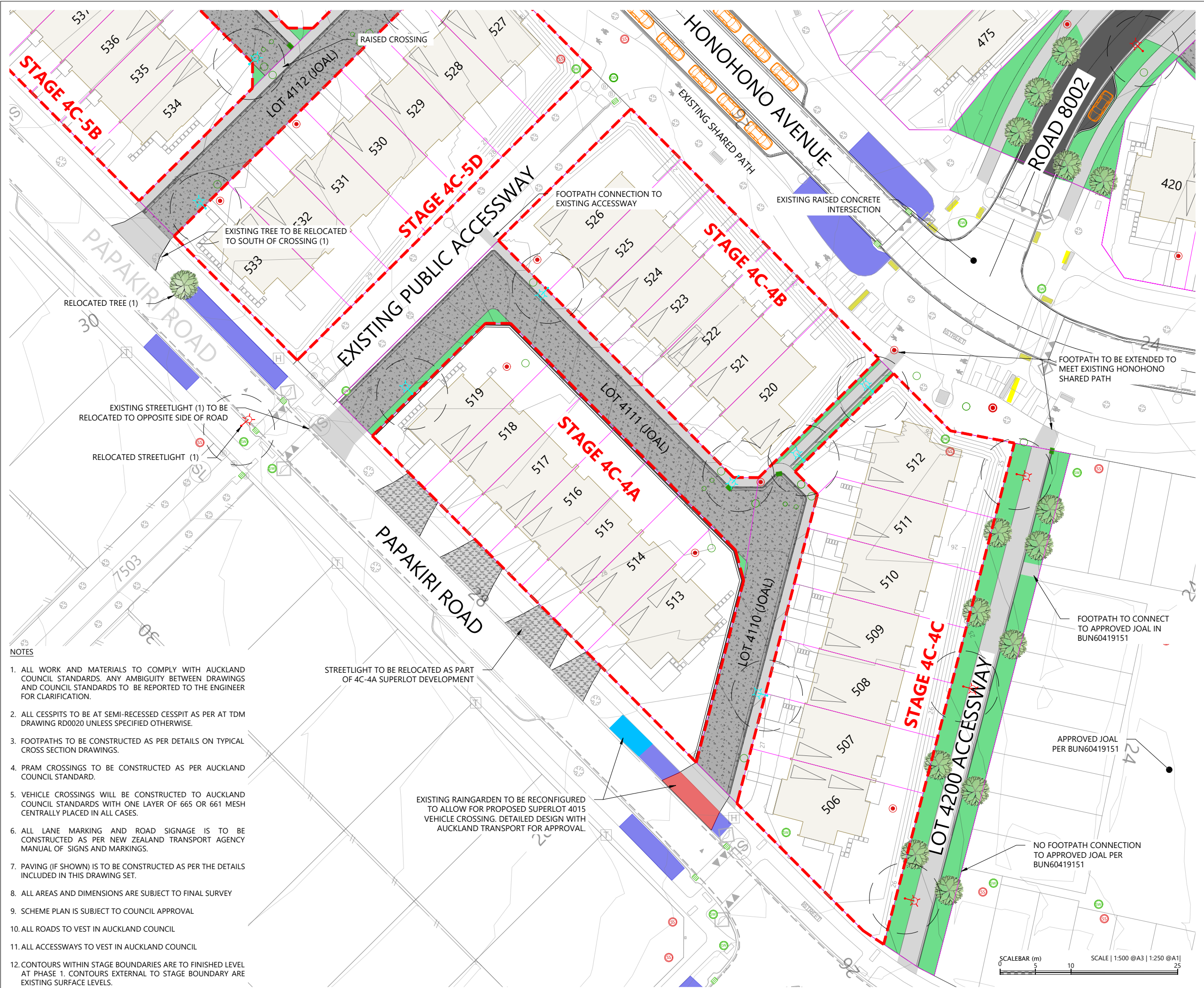

- NOTES
- ALL WORK AND MATERIALS TO COMPLY WITH AUCKLAND COUNCIL STANDARDS. ANY AMBIGUITY BETWEEN DRAWINGS AND COUNCIL STANDARDS TO BE REPORTED TO THE ENGINEER FOR CLARIFICATION.
 - ALL CESSPITS TO BE AT SEMI-RECESSED CESSPIT AS PER AT TDM DRAWING RD0020 UNLESS SPECIFIED OTHERWISE.
 - FOOTPATHS TO BE CONSTRUCTED AS PER DETAILS ON TYPICAL CROSS SECTION DRAWINGS.
 - PRAM CROSSINGS TO BE CONSTRUCTED AS PER AUCKLAND COUNCIL STANDARD.
 - VEHICLE CROSSINGS WILL BE CONSTRUCTED TO AUCKLAND COUNCIL STANDARDS WITH ONE LAYER OF 665 OR 661 MESH CENTRALLY PLACED IN ALL CASES.
 - ALL LANE MARKING AND ROAD SIGNAGE IS TO BE CONSTRUCTED AS PER NEW ZEALAND TRANSPORT AGENCY MANUAL OF SIGNS AND MARKINGS.
 - PAVING (IF SHOWN) IS TO BE CONSTRUCTED AS PER THE DETAILS INCLUDED IN THIS DRAWING SET.
 - ALL AREAS AND DIMENSIONS ARE SUBJECT TO FINAL SURVEY
 - SCHEME PLAN IS SUBJECT TO COUNCIL APPROVAL
 - ALL ROADS TO VEST IN AUCKLAND COUNCIL
 - ALL ACCESSWAYS TO VEST IN AUCKLAND COUNCIL
 - CONTOURS WITHIN STAGE BOUNDARIES ARE TO FINISHED LEVEL AT PHASE 1. CONTOURS EXTERNAL TO STAGE BOUNDARY ARE EXISTING SURFACE LEVELS.



LEGEND:	
	PROPOSED PARCEL BOUNDARY
	STAGE BOUNDARY
	EXISTING/APPROVED PARCEL BOUNDARY
	PROPOSED GROUND FLOOR FOOTPRINT
	EXISTING RAIN GARDEN
	EXISTING RAIN GARDEN TO BE REMOVED
	PROPOSED RAINGARDEN
	PROPOSED CARRIAGEWAY
	FOOTPATH
	JOAL CARRIAGEWAY
	RAISED INTERSECTION
	BERM
	PHASE 2 VEHICLE CROSSING
	PHASE 1 VEHICLE CROSSING
	PROPOSED RETAINING WALL
	WW MANHOLE (PROPOSED & EXISTING)
	SW MANHOLE (PROPOSED & EXISTING)
	PROPOSED SW CATCHPIT
	EXISTING SW CATCHPIT
	EXISTING TREES
	PROPOSED TREES
	PROPOSED STREET & JOAL LIGHTS
	EXISTING STREETLIGHTS

REVISION DETAILS		BY	DATE
1	ISSUED FOR CONSENT	TR	FEB 2025

SURVEYED	WOODS	BUILDING B, LEVEL 1 8 NUGENT ST, GRAFTON, AUCKLAND 1023 +64 9 308 9229
DESIGNED	WOODS	
DRAWN	PK	
CHECKED	JM	
APPROVED	TR	
		WOODS.CO.NZ

MILLDALE STAGE 4C

ROADING PLAN - SHEET 4

STATUS	ISSUED FOR CONSENT	REV
SCALE	1:500 @ A3	1
COUNCIL	AUCKLAND COUNCIL	
DWG NO	P23-481-4C-0-2004-RD	

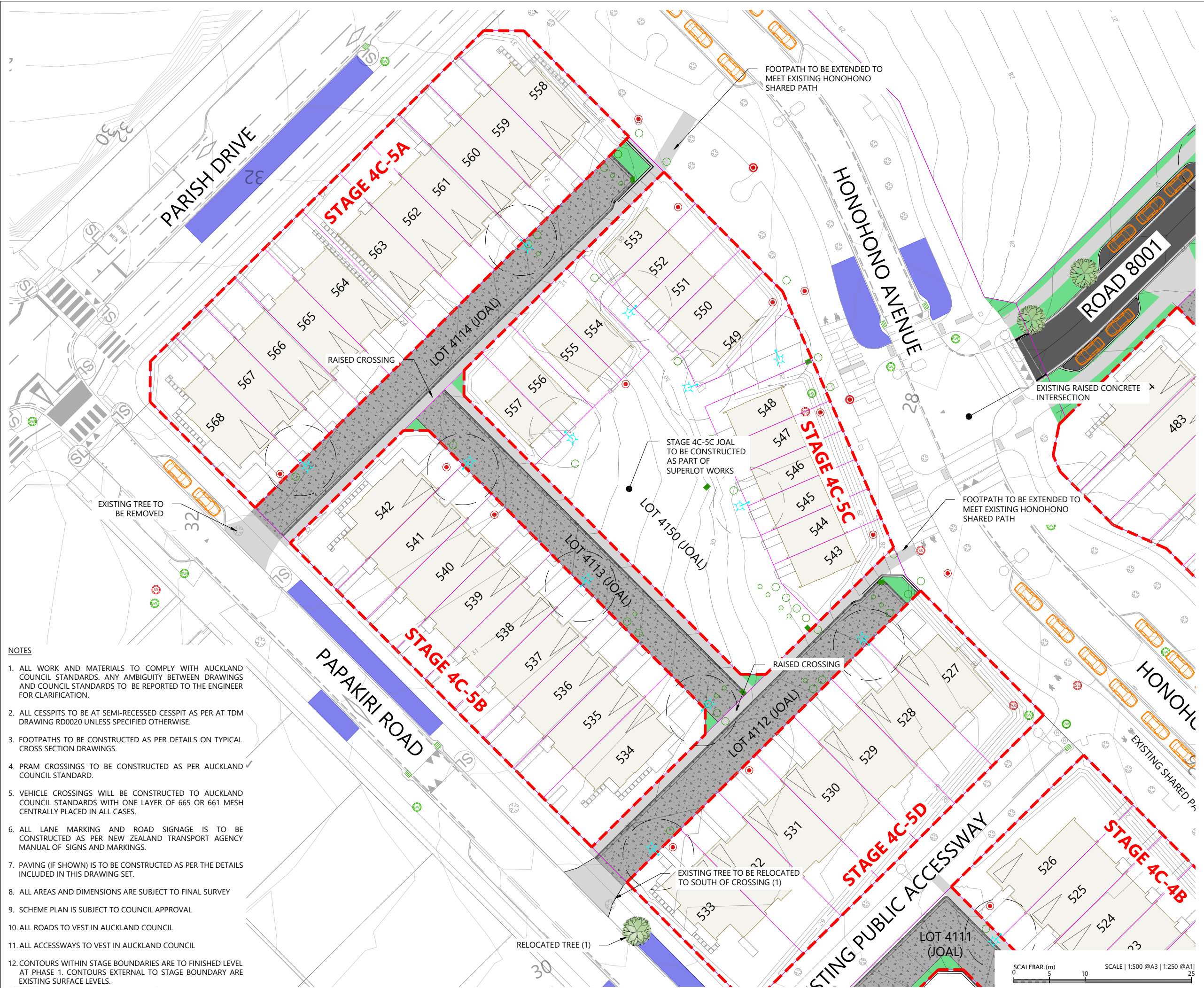

- NOTES**
- ALL WORK AND MATERIALS TO COMPLY WITH AUCKLAND COUNCIL STANDARDS. ANY AMBIGUITY BETWEEN DRAWINGS AND COUNCIL STANDARDS TO BE REPORTED TO THE ENGINEER FOR CLARIFICATION.
 - ALL CESSPITS TO BE AT SEMI-RECESSED CESSPIT AS PER AT TDM DRAWING RD0020 UNLESS SPECIFIED OTHERWISE.
 - FOOTPATHS TO BE CONSTRUCTED AS PER DETAILS ON TYPICAL CROSS SECTION DRAWINGS.
 - PRAM CROSSINGS TO BE CONSTRUCTED AS PER AUCKLAND COUNCIL STANDARD.
 - VEHICLE CROSSINGS WILL BE CONSTRUCTED TO AUCKLAND COUNCIL STANDARDS WITH ONE LAYER OF 665 OR 661 MESH CENTRALLY PLACED IN ALL CASES.
 - ALL LANE MARKING AND ROAD SIGNAGE IS TO BE CONSTRUCTED AS PER NEW ZEALAND TRANSPORT AGENCY MANUAL OF SIGNS AND MARKINGS.
 - PAVING (IF SHOWN) IS TO BE CONSTRUCTED AS PER THE DETAILS INCLUDED IN THIS DRAWING SET.
 - ALL AREAS AND DIMENSIONS ARE SUBJECT TO FINAL SURVEY
 - SCHEME PLAN IS SUBJECT TO COUNCIL APPROVAL
 - ALL ROADS TO VEST IN AUCKLAND COUNCIL
 - ALL ACCESSWAYS TO VEST IN AUCKLAND COUNCIL
 - CONTOURS WITHIN STAGE BOUNDARIES ARE TO FINISHED LEVEL AT PHASE 1. CONTOURS EXTERNAL TO STAGE BOUNDARY ARE EXISTING SURFACE LEVELS.

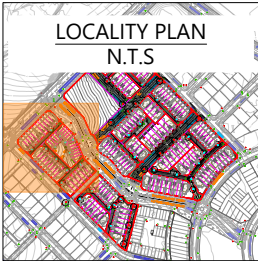

LEGEND:	
	PROPOSED PARCEL BOUNDARY
	STAGE BOUNDARY
	EXISTING/APPROVED PARCEL BOUNDARY
	PROPOSED GROUND FLOOR FOOTPRINT
	EXISTING RAIN GARDEN
	EXISTING RAIN GARDEN TO BE REMOVED
	PROPOSED RAINGARDEN
	PROPOSED CARRIAGEWAY
	FOOTPATH
	JOAL CARRIAGEWAY
	RAISED INTERSECTION
	BERM
	PHASE 2 VEHICLE CROSSING
	PHASE 1 VEHICLE CROSSING
	PROPOSED RETAINING WALL
	WW MANHOLE (PROPOSED & EXISTING)
	SW MANHOLE (PROPOSED & EXISTING)
	PROPOSED SW CATCHPIT
	EXISTING SW CATCHPIT
	EXISTING TREES
	PROPOSED TREES
	PROPOSED STREET & JOAL LIGHTS
	EXISTING STREETLIGHTS

REVISION DETAILS		BY	DATE
1	ISSUED FOR CONSENT	TR	FEB 2025

SURVEYED	WOODS	BUILDING B, LEVEL 1 8 NUGENT ST, GRAFTON, AUCKLAND 1023 +64 9 308 9229 WOODS.CO.NZ
DESIGNED	WOODS	
DRAWN	PK	
CHECKED	JM	
APPROVED	TR	

MILLDALE STAGE 4C

ROADING PLAN - SHEET 5

STATUS	ISSUED FOR CONSENT	REV
SCALE	1:500 @ A3	1
COUNCIL	AUCKLAND COUNCIL	
DWG NO	P23-481-4C-0-2005-RD	

NOTE:

INDICATIVE WASTE MANAGEMENT PLAN. ALL ROUTES, COLLECTION POINTS AND COLLECTION FREQUENCIES TO BE FINALISED AND APPROVED BY AUCKLAND COUNCIL PRIOR TO OCCUPATION OF EACH INDIVIDUAL SUPERLOT DEVELOPMENT.

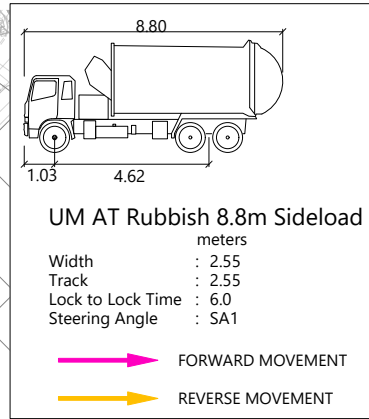

LEGEND:

- PROPOSED PARCEL BOUNDARY
- STAGE BOUNDARY
- EXISTING PARCEL BOUNDARY
- PROPOSED GROUND FLOOR FOOTPRINT
- EXISTING RAIN GARDEN
- EXISTING RAIN GARDEN TO BE REMOVED
- PROPOSED RAINGARDEN
- FOOTPATH
- RAISED INTERSECTION
- BERM
- FUTURE INDICATIVE VEHICLE CROSSINGS
- PROPOSED INDICATIVE VEHICLE CROSSINGS
- PROPOSED RETAINING WALL
- BIN BAYS
- EXISTING TREES
- PROPOSED TREES
- PROPOSED STREET & JOAL LIGHTS
- EXISTING STREETLIGHTS

REVISION DETAILS		BY	DATE
1	ISSUED FOR CONSENT	TR	FEB 2025

SURVEYED	WOODS	BUILDING B, LEVEL 1 8 NUGENT ST, GRAFTON, AUCKLAND 1023 +64 9 308 9229 WOODS.CO.NZ
DESIGNED	WOODS	
DRAWN	PK	
CHECKED	JM	
APPROVED	TR	

Connecting Lifestyles

MILLDALE STAGE 4C

WASTE MANAGEMENT PLAN

STATUS	ISSUED FOR CONSENT	REV
SCALE	1:1500 @ A3	1
COUNCIL	AUCKLAND COUNCIL	
DWG NO	P23-481-4C-0-2050-RD	



LEGEND:

- 4C STAGE BOUNDARY
- SUBURBAN STREET
- JOAL TYPE-1 (9.0m WIDTH)
- JOAL TYPE-2 (7.0m WIDTH)
- PEDESTRIAN WALKWAY
- PRIVATE PEDESTRIAN LINK
- 8m PRIVATE PEDESTRIAN LINK

NOTE:

1. ALL WORKS AND MATERIALS ARE TO COMPLY WITH AUCKLAND TRANSPORT STANDARDS. ANY AMBIGUITY BETWEEN DRAWINGS AND COUNCIL STANDARDS ARE TO BE REPORTED TO THE ENGINEER FOR CLARIFICATION.
2. PRAM CROSSINGS ARE TO BE CONSTRUCTED AS PER AUCKLAND TRANSPORT STANDARDS.
3. JOAL VEHICLE CROSSINGS TO BE CONSTRUCTED IN ACCORDANCE WITH AUCKLAND TRANSPORT COMMERCIAL VEHICLE CROSSING STANDARD VX0203.
4. ALL LANE MARKING AND ROAD SIGNAGE IS TO BE CONSTRUCTED AS PER THE NEW ZEALAND TRANSPORT AGENCY (NZTA) MANUAL OF TRAFFIC SIGNS AND MARKINGS.
5. NO PRIVATE VEHICLE CROSSINGS ONTO HONOHONO AVENUE.

REVISION DETAILS		BY	DATE
1	ISSUED FOR CONSENT	EY	FEB 2025

SURVEYED	WOODS	BUILDING B, LEVEL 1 8 NUGENT ST, GRAFTON, AUCKLAND 1023 +64 9 308 9229
DESIGNED	WOODS	
DRAWN	FA	
CHECKED	JM	
APPROVED	TR	
		WOODS.CO.NZ

N



MILLDALE
Connecting Lifestyles

MILLDALE STAGE 4C

ROAD TYPOLOGY PLAN

STATUS	ISSUED FOR CONSENT	REV
SCALE	1:1500 @ A3	1
COUNCIL	AUCKLAND COUNCIL	
DWG NO	P23-481-4C-0-2200-RD	

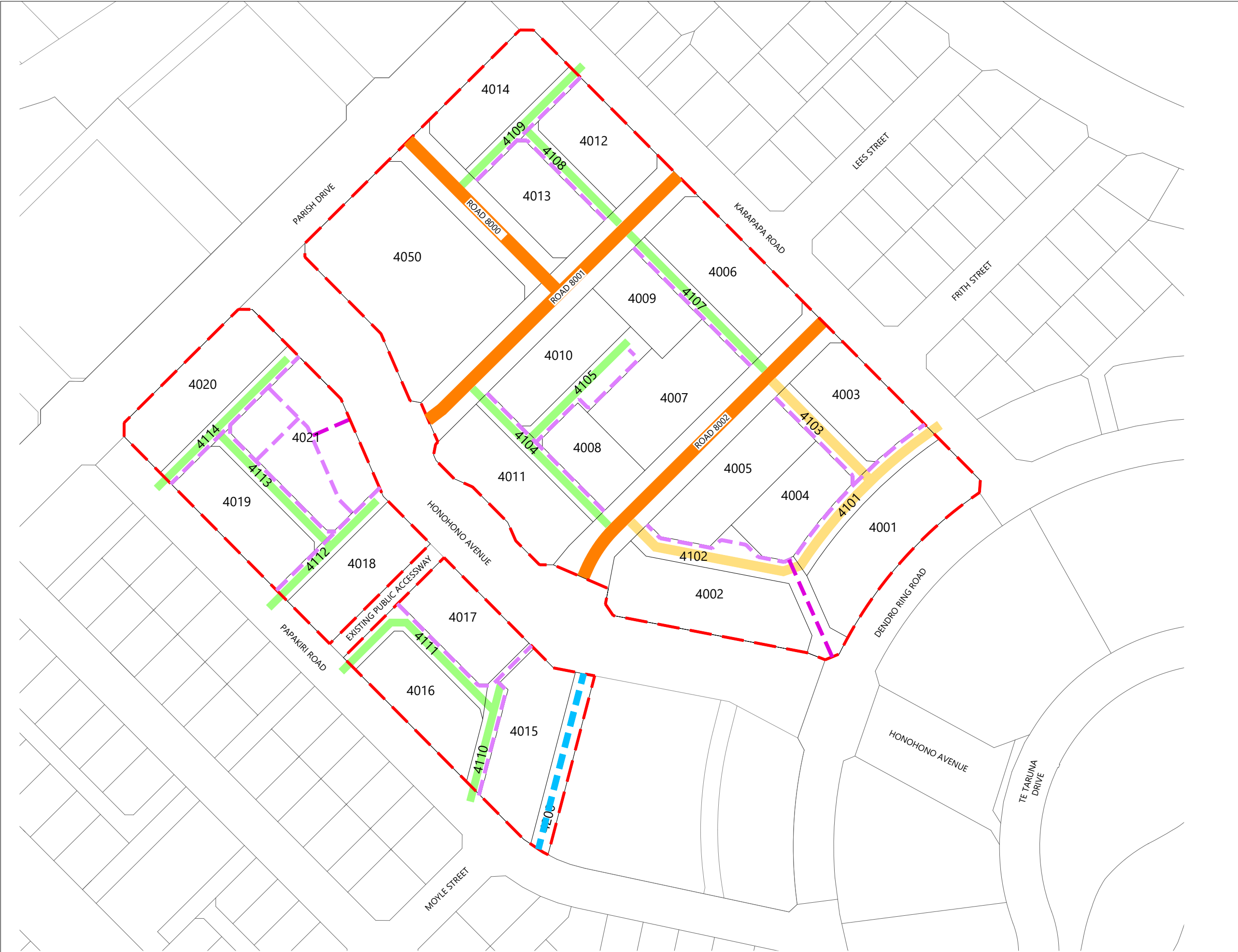

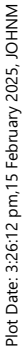

SCALEBAR (m) SCALE | 1:100 @A3 | 1:50 @A1 |

STATUS	ISSUED FOR CONSENT	REV
SCALE	AS SHOWN	1
COUNCIL	AUCKLAND COUNCIL	
DWG NO	P23-481-4C-0-2201-RD	

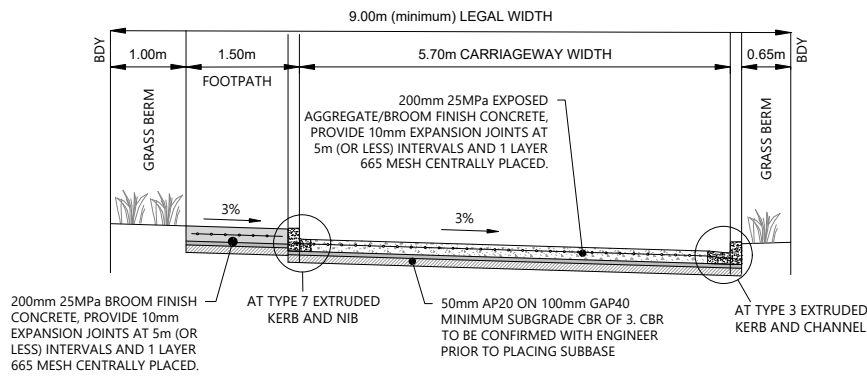

JOAL TYPE-1 TYPICAL SECTION

Scale: 1:100

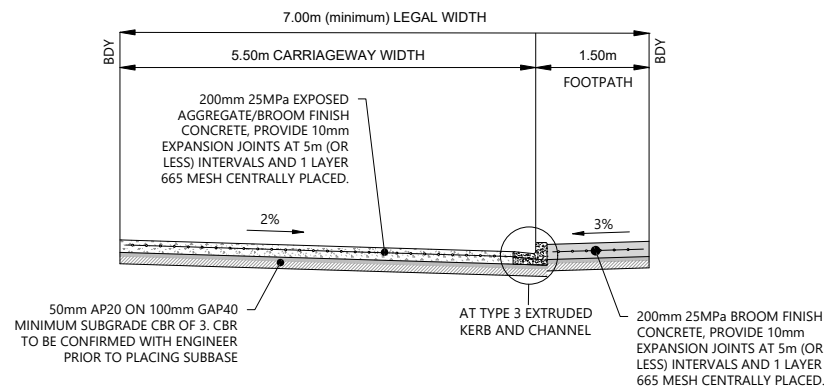

JOAL TYPE-2 TYPICAL SECTION

Scale: 1:100

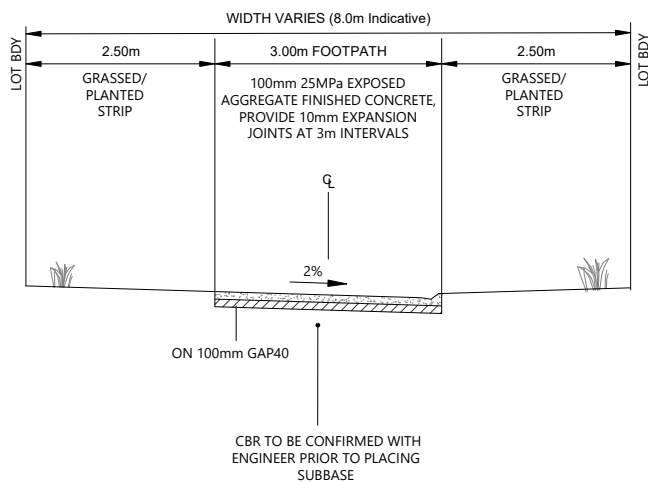

PEDESTRIAN WALKWAY DETAIL

Scale: 1:100

KERB DETAILS

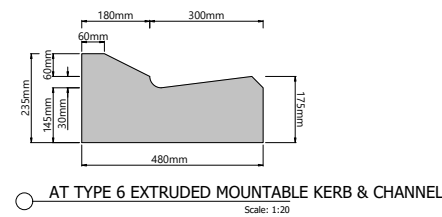

AT TYPE 6 EXTRUDED MOUNTABLE KERB & CHANNEL

Scale: 1:20

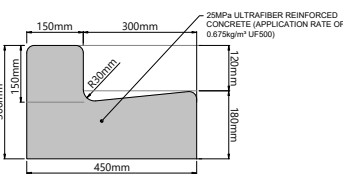

AT TYPE 3 EXTRUDED KERB & CHANNEL

Scale: 1:20

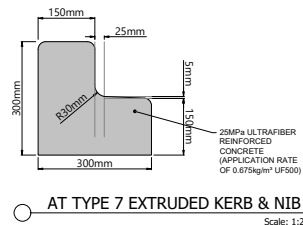

AT TYPE 7 EXTRUDED KERB & NIB

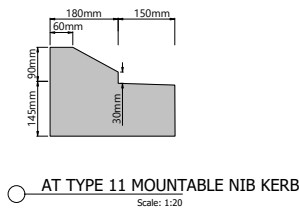

AT TYPE 11 MOUNTABLE NIB KERB

Scale: 1:20

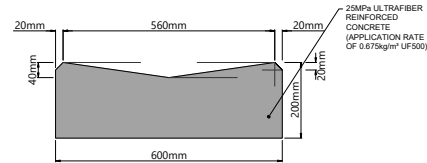

AT TYPE 17 CAST INSITU V DISH CHANNEL

Scale: 1:20

NOTE:

- CONTRACTOR TO CONFIRM TO ENGINEER INSITU SUBGRADE CBR PRIOR TO TRIMMING TO FINAL SUBGRADE LEVEL TO CONFIRM PAVEMENT DEPTHS.
- CONTRACTOR TO USE ONLY AT APPROVED ASPHALT MIXES.
- MAXIMUM DEFLECTION (BB) & CURVATURE (CF) OF ROAD PAVEMENT TO BE:
 - SUBURBAN & STREET EDGE:
 - AT BASECOURSE: 1.2mm (BB)
 - AT ASPHALT SURFACE: 1.17 mm (BB)
- ALL WORKS AND MATERIALS ARE TO COMPLY WITH AUCKLAND TRANSPORT STANDARDS. ANY AMBIGUITY BETWEEN DRAWINGS AND COUNCIL STANDARDS ARE TO BE REPORTED TO THE ENGINEER FOR CLARIFICATION.
- PRAM CROSSINGS ARE TO BE CONSTRUCTED AS PER AUCKLAND TRANSPORT STANDARDS.
- SERVICE TRENCHES SHOWN ARE INDICATIVE ONLY. ALL DUCTS/PIPES ARE TO BE POSITIONED AS PER RELEVANT SERVICE PROVIDER STANDARDS.
- STORMWATER AND WASTEWATER PIPES TO BE LAID WITH MINIMUM 1.00m COVER WITH HARDFILL BACKFILL UNDER ROAD CARRIAGEWAY.
- ALL LANE MARKING AND ROAD SIGNAGE IS TO BE CONSTRUCTED AS PER THE NEW ZEALAND TRANSPORT AGENCY (NZTA) MANUAL OF TRAFFIC SIGNS AND MARKINGS.
- ALL UNDERCHANNELS AND SUBSOIL DRAINS TO COMPLY WITH TNZ/F2 SPEC.
- ALL LANE MARKING AND ROAD SIGNAGE IS TO BE CONSTRUCTED AS PER NZTA MANUAL OF TRAFIC SIGNS AND MARKINGS.
- ALL CONCRETE PARKING BAYS LONGER THAN 14m TO HAVE TWO SEPARATE LENGTHS OF 665 MESH SEPARATED BY CONSTRUCTION JOINT.

REVISION DETAILS		BY	DATE
1	ISSUED FOR CONSENT	EY	FEB 2025

SURVEYED	WOODS	BUILDING B, LEVEL 1 8 NUGENT ST, GRAFTON, AUCKLAND 1023 +64 9 308 9229 WOODS.CO.NZ
DESIGNED	WOODS	
DRAWN	FA	
CHECKED	JM	
APPROVED	TR	

MILLDALE STAGE 4C

TYPICAL ROAD CROSS SECTIONS
JOALS, PEDESTRIAN WALKWAY
& KERB DETAILS

STATUS	ISSUED FOR CONSENT	REV
SCALE	AS SHOWN	1
COUNCIL	AUCKLAND COUNCIL	
DWG NO	P23-481-4C-0-2202-RD	

