



- SOAKAGE DEVICE's
- GRAVEL SOAKAGE UNDER ROAD DEPTH=0.8m
  - VILLA SOAKAGE DEVICE DEPTH=0.44m VOLUME=10.52m<sup>3</sup> COUNT=220
  - FACILITY SOAKAGE DEVICE DEPTH=0.44m VOLUME=18.17m<sup>3</sup> COUNT=2
  - AGE CARE SOAKAGE DEPTH=0.44m VOLUME=75.31m<sup>3</sup> COUNT=2

- Notes
- All works to be in accordance with RITS standards.
  - Co-ordinates in terms of Mount Eden 2000.
  - Reduced Levels are in terms of NZVD 2016.
  - It is the contractors responsibility to locate all services that may be affected by his operations.
  - Pipe bedding: 0 - 10% granular bedding, 10 - 20% weak concrete bedding, greater than 20% weak concrete bedding (7mpa plus anti scour blocks at 6m crs).
  - Approved hardfill is to be used in backfilling of all road crossings and vehicle crossings to council standards.
  - Heavy duty manhole lids and frames to be used in trafficked areas.
  - All cesspit leads shall have min cover 0.9m.
  - All lines to be abandoned shall be sealed at each end, timing of all sealing to be coordinated with council staff.
  - Refer to C4700 for Soakage Trench details.
  - Refer to C4703 for Soakage Device details.
  - Preliminary Soakage design is based on the rate of 100mm/h for a 10 year event.

- Legend
- EX BDY
  - PROP BDY
  - STAGING BDY
  - EX STORMWATER
  - PR STORMWATER
  - EX SW SWALE
  - EX/PROP SWMH
  - PROP SWCP SINGLE
  - RAINGARDENS

B	FOR CONSENT	MS	04/25
A	FOR REVIEW	DP	01/25
Rev	Description	By	Date
Survey	MAVEN		10/2024
Design	DP		12/2024
Drawn	DP		12/2024
Checked	SB		12/2024



Project  
**ASHBOURNE  
RETIREMENT VILLAGE  
MATAMATA  
FOR  
UNITY DEVELOPMENT LTD**

Title  
**PROPOSED  
STORMWATER OVERVIEW  
PLAN**

Project no.	J00606
Scale	1:2500@A3
Cad file	C4000 - SW.DWG
Drawing no.	C4000
Rev	B

FOR CONSENT



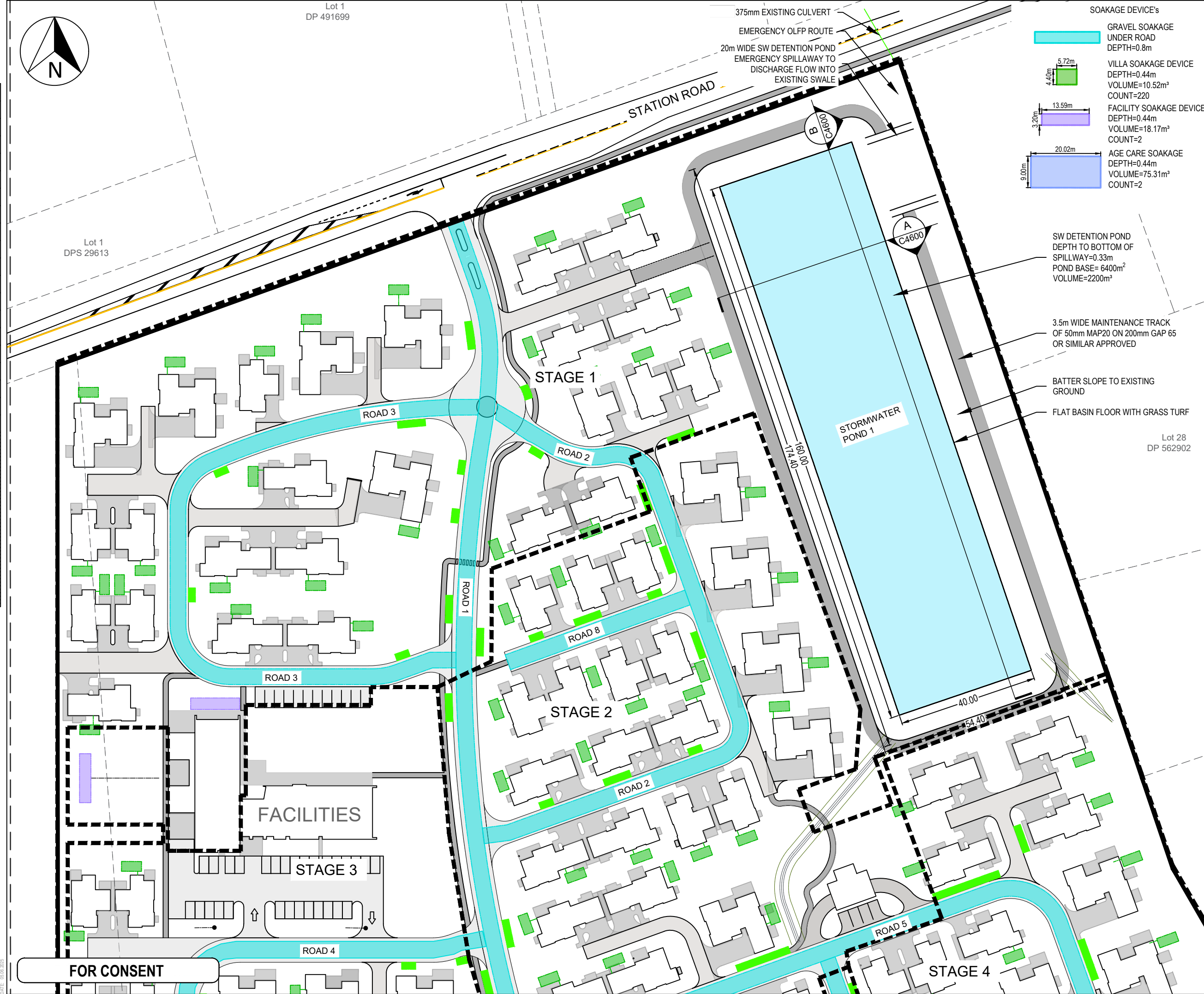

Notes

- All works to be in accordance with RITS standards.
- Co-ordinates in terms of Mount Eden 2000.
- Reduced Levels are in terms of NZVD 2016.
- It is the contractors responsibility to locate all services that may be affected by his operations.
- Pipe bedding: 0 - 10% granular bedding, 10 - 20% weak concrete bedding, greater than 20% weak concrete bedding (7mpa plus anti scour blocks at 6m crs).
- Approved hardfill is to be used in backfilling of all road crossings and vehicle crossings to council standards.
- Heavy duty manhole lids and frames to be used in trafficked areas.
- All cesspit leads shall have min cover 0.9m.
- All lines to be abandoned shall be sealed at each end, timing of all sealing to be coordinated with council staff.
- Refer to C4700 for Soakage Trench details.
- Refer to C4703 for Soakage Device details.
- Preliminary Soakage design is based on the rate of 100mm/h for a 10 year event.

Legend

EX BDY  
PROP BDY  
STAGING BDY  
EX STORMWATER  
PR STORMWATER  
EX SW SWALE  
EX/PROP SWMH  
PROP SWCP SINGLE  
RAINGARDENS

Rev	Description	By	Date
B	FOR CONSENT	MS	04/25
A	FOR REVIEW	DP	01/25

Rev	Description	By	Date
Survey	MAVEN		10/2024
Design	DP		12/2024
Drawn	DP		12/2024
Checked	SB		12/2024

**M**  
Maven Matamata  
matamatainfo@maven.co.nz  
www.maven.co.nz  
8 Tainui Street, Matamata  
New Zealand

Project  
**ASHBOURNE  
RETIREMENT VILLAGE  
MATAMATA  
FOR  
UNITY DEVELOPMENT LTD**

Title  
**PROPOSED  
STORMWATER LAYOUT  
PLAN(1 OF 4)**

Project no.	J00606
Scale	1:1000@A3
Cad file	C4000 - SW.DWG
Drawing no.	C4001
Rev	B



1:500mm ORIGINAL SIZE: A3



0 10 20 30 40 50 60 70 80 90 100 150mm

DATE: 05/06/2025

FILE: F:\MAVEN MATAMATA\1. Projects\J00606 UDL - Hemmings Station Rd\6. Drawing\2. CAD\3. Design\C4000 - SW.dwg

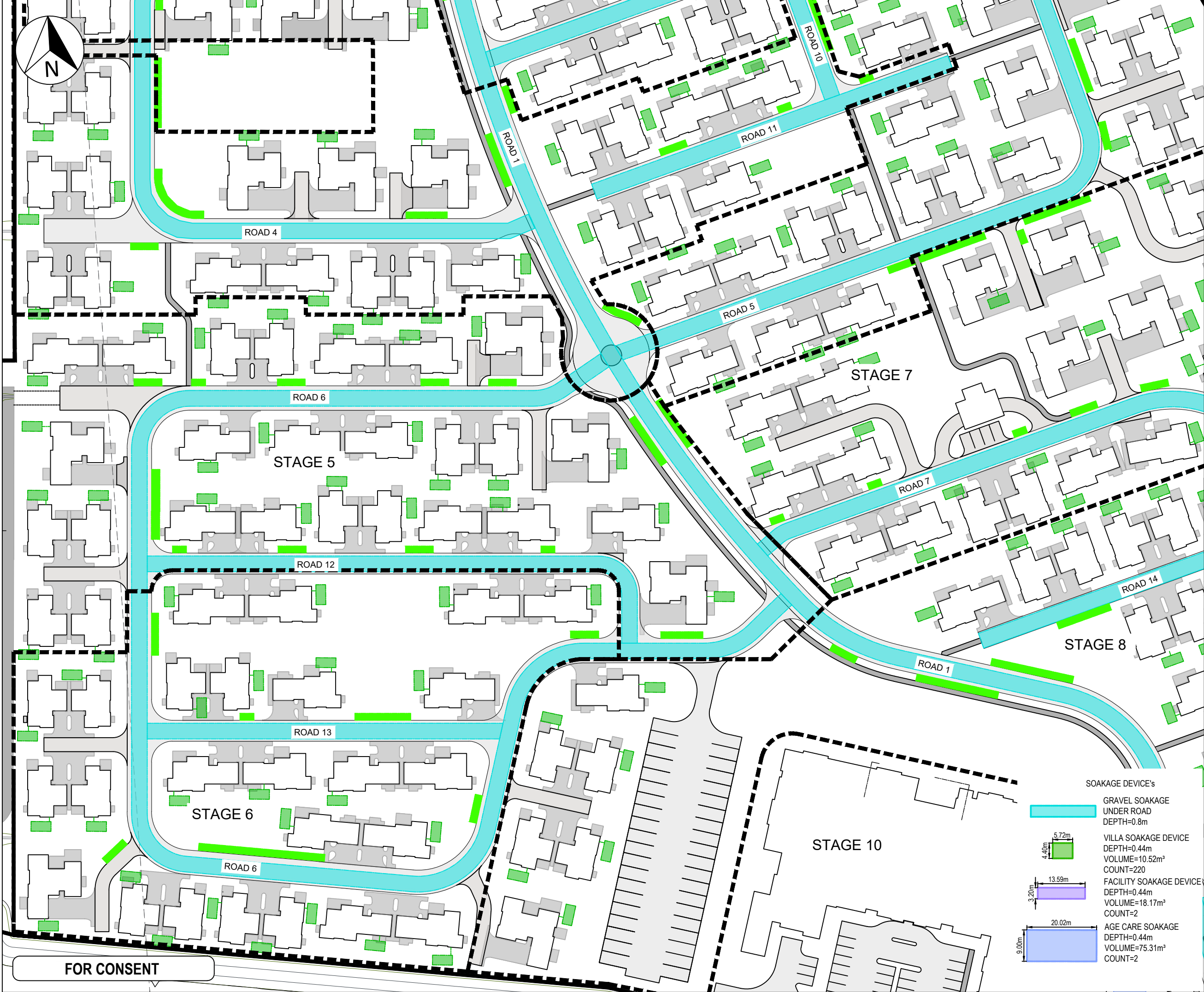

FOR CONSENT

- Notes
1. All works to be in accordance with RITS standards.
  2. Co-ordinates in terms of Mount Eden 2000.
  3. Reduced Levels are in terms of NZVD 2016.
  4. It is the contractors responsibility to locate all services that may be affected by his operations.
  5. Pipe bedding: 0 - 10% granular bedding, 10 - 20% weak concrete bedding, greater than 20% weak concrete bedding (7mpa plus anti scour blocks at 6m crs).
  6. Approved hardfill is to be used in backfilling of all road crossings and vehicle crossings to council standards.
  7. Heavy duty manhole lids and frames to be used in trafficked areas.
  8. All cesspit leads shall have min cover 0.9m.
  9. All lines to be abandoned shall be sealed at each end, timing of all sealing to be coordinated with council staff.
  10. Refer to C4700 for Soakage Trench details.
  10. Refer to C4703 for Soakage Device details.
  11. Preliminary Soakage design is based on the rate of 100mm/h for a 10 year event.

- Legend
- EX BDY
  - PROP BDY
  - STAGING BDY
  - EX STORMWATER
  - PR STORMWATER
  - EX SW SWALE
  - EX/PROP SWMH
  - PROP SWCP SINGLE
  - RAINGARDENS

B	FOR CONSENT	MS	04/25
A	FOR REVIEW	DP	01/25
Rev	Description	By	Date
Survey	MAVEN		10/2024
Design	DP		12/2024
Drawn	DP		12/2024
Checked	SB		12/2024



Project  
**ASHBOURNE  
RETIREMENT VILLAGE  
MATAMATA  
FOR  
UNITY DEVELOPMENT LTD**

Title  
**PROPOSED  
STORMWATER LAYOUT  
PLAN(2 OF 4)**

Project no.	J00606
Scale	1:1000@A3
Cad file	C4000 - SW.DWG
Drawing no.	C4002
Rev	B

SOAKAGE DEVICE's

- GRAVEL SOAKAGE UNDER ROAD DEPTH=0.8m
- VILLA SOAKAGE DEVICE DEPTH=0.44m VOLUME=10.52m<sup>3</sup> COUNT=220
- FACILITY SOAKAGE DEVICE DEPTH=0.44m VOLUME=18.17m<sup>3</sup> COUNT=2
- AGE CARE SOAKAGE DEPTH=0.44m VOLUME=75.31m<sup>3</sup> COUNT=2

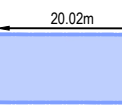
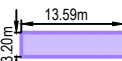
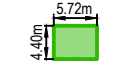



DATE: 05.06.2025  
FILE: F:\MAVEN MATAMATA\1. Projects\J00606 UDL - Hemmings Station Rd8. Drawing\2. CAD\3. Design\C4000 - SW.dwg

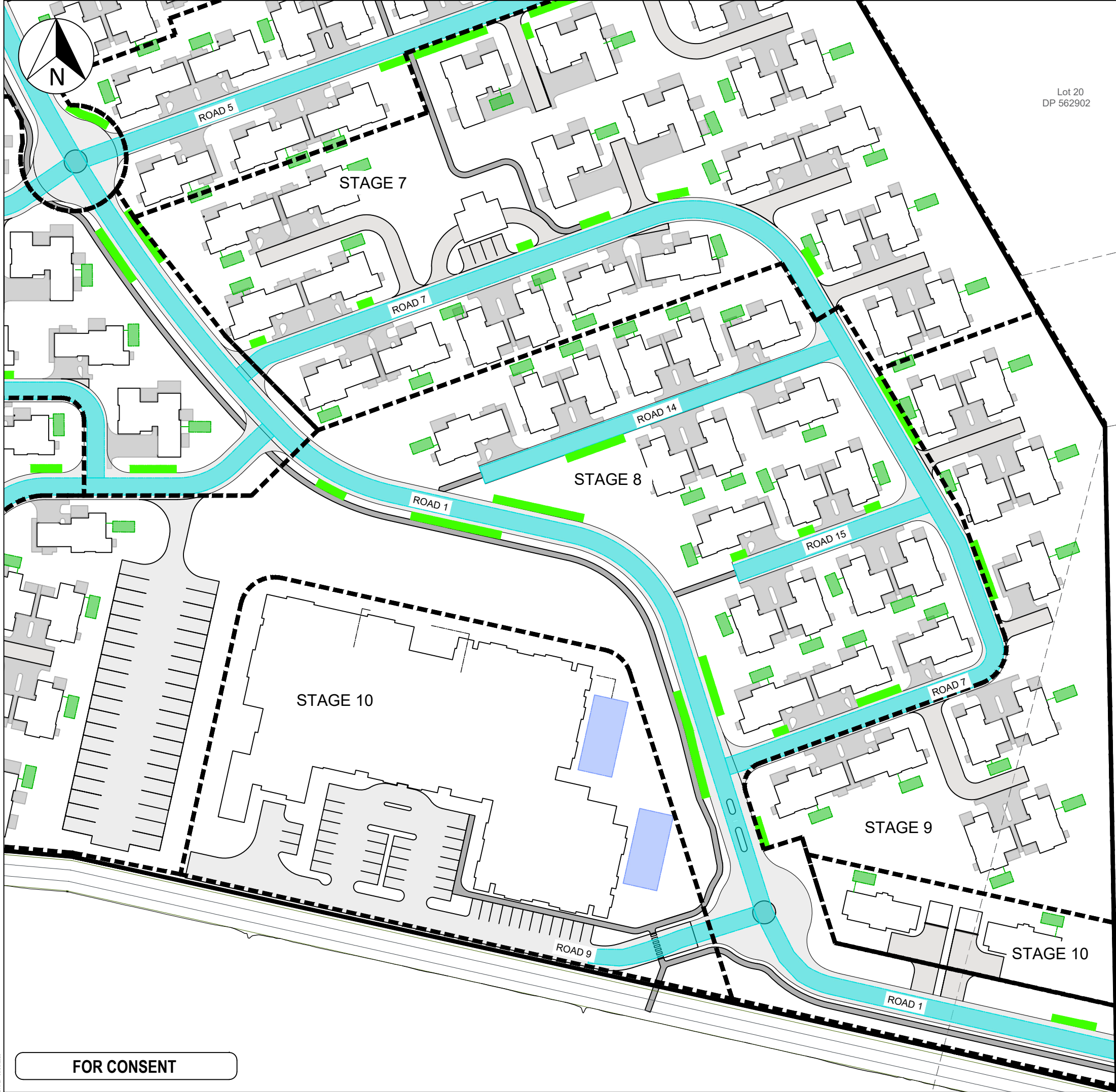

- SOAKAGE DEVICE's
- GRAVEL SOAKAGE UNDER ROAD DEPTH=0.8m
  - VILLA SOAKAGE DEVICE DEPTH=0.44m VOLUME=10.52m<sup>3</sup> COUNT=220
  - FACILITY SOAKAGE DEVICE DEPTH=0.44m VOLUME=18.17m<sup>3</sup> COUNT=2
  - AGE CARE SOAKAGE DEPTH=0.44m VOLUME=75.31m<sup>3</sup> COUNT=2

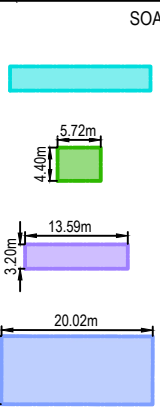

- Notes
- All works to be in accordance with RITS standards.
  - Co-ordinates in terms of Mount Eden 2000.
  - Reduced Levels are in terms of NZVD 2016.
  - It is the contractors responsibility to locate all services that may be affected by his operations.
  - Pipe bedding: 0 - 10% granular bedding, 10 - 20% weak concrete bedding, greater than 20% weak concrete bedding (7mpa plus anti scour blocks at 6m crs).
  - Approved hardfill is to be used in backfilling of all road crossings and vehicle crossings to council standards.
  - Heavy duty manhole lids and frames to be used in trafficked areas.
  - All cesspit leads shall have min cover 0.9m.
  - All lines to be abandoned shall be sealed at each end, timing of all sealing to be coordinated with council staff.
  - Refer to C4700 for Soakage Trench details.
  - Refer to C4703 for Soakage Device details.
  - Preliminary Soakage design is based on the rate of 100mm/h for a 10 year event.

- Legend
- EX BDY
  - PROP BDY
  - STAGING BDY
  - EX STORMWATER
  - PR STORMWATER
  - EX SW SWALE
  - EX/PROP SWMH
  - PROP SWCP SINGLE
  - RAINGARDENS

B	FOR CONSENT	MS	04/25
A	FOR REVIEW	DP	01/25
Rev	Description	By	Date
	By	Date	
Survey	MAVEN	10/2024	
Design	DP	10/2024	
Drawn	DP	11/2024	
Checked	SB	11/2024	



Project  
**ASHBOURNE  
RETIREMENT VILLAGE  
MATAMATA  
FOR  
UNITY DEVELOPMENT LTD**

Title  
**PROPOSED  
STORMWATER LAYOUT  
PLAN(3 OF 4)**

Project no.	J00606		
Scale	1:1000@A3		
Cad file	C4000 - SW.DWG		
Drawing no.	C4003	Rev	B

FOR CONSENT



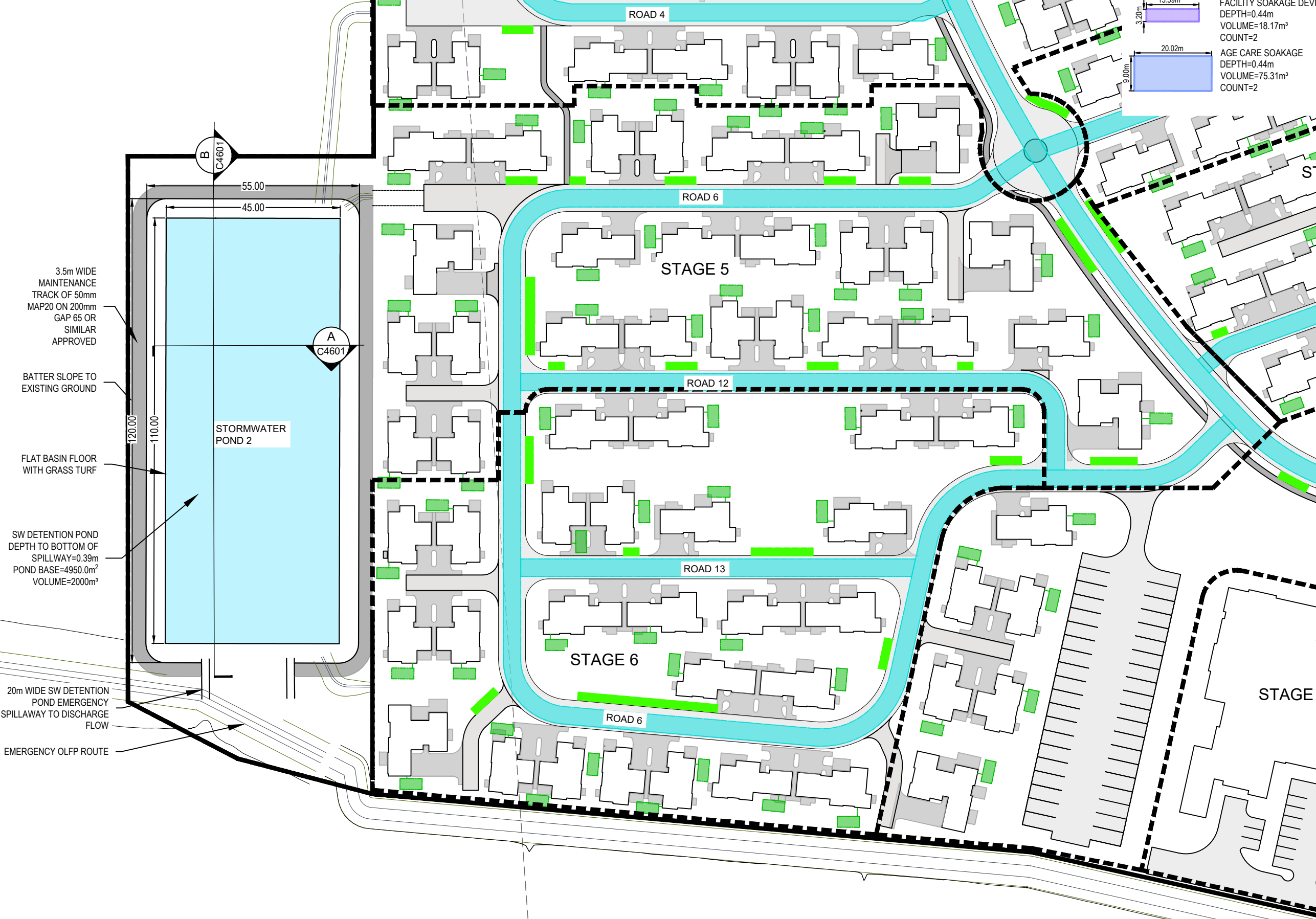

- SOAKAGE DEVICE's
- GRAVEL SOAKAGE UNDER ROAD DEPTH=0.8m
  - VILLA SOAKAGE DEVICE DEPTH=0.44m VOLUME=10.52m<sup>3</sup> COUNT=220
  - FACILITY SOAKAGE DEVICE DEPTH=0.44m VOLUME=18.17m<sup>3</sup> COUNT=2
  - AGE CARE SOAKAGE DEPTH=0.44m VOLUME=75.31m<sup>3</sup> COUNT=2

- Notes
- All works to be in accordance with RITS standards.
  - Co-ordinates in terms of Mount Eden 2000.
  - Reduced Levels are in terms of NZVD 2016.
  - It is the contractors responsibility to locate all services that may be affected by his operations.
  - Pipe bedding: 0 - 10% granular bedding, 10 - 20% weak concrete bedding, greater than 20% weak concrete bedding (7mpa plus anti scour blocks at 6m crs).
  - Approved hardfill is to be used in backfilling of all road crossings and vehicle crossings to council standards.
  - Heavy duty manhole lids and frames to be used in trafficked areas.
  - All cesspit leads shall have min cover 0.9m.
  - All lines to be abandoned shall be sealed at each end, timing of all sealing to be coordinated with council staff.
  - Refer to C4700 for Soakage Trench details.
  - Refer to C4703 for Soakage Device details.
  - Preliminary Soakage design is based on the rate of 100mm/h for a 10 year event.

- Legend
- EX BDY
  - PROP BDY
  - STAGING BDY
  - EX STORMWATER
  - PR STORMWATER
  - EX SW SWALE
  - EX/PROP SWMH
  - PROP SWCP SINGLE
  - RAINGARDENS

B	FOR CONSENT	MS	04/25
A	FOR REVIEW	DP	01/25
Rev	Description	By	Date
Survey	MAVEN		10/2024
Design	DP		10/2024
Drawn	DP		11/2024
Checked	SB		11/2024



Project **ASHBOURNE RETIREMENT VILLAGE MATAMATA FOR UNITY DEVELOPMENT LTD**

Title **PROPOSED STORMWATER LAYOUT PLAN(4 OF 4)**

Project no.	J00606
Scale	1:1000@A3
Cad file	C4000 - SW.DWG
Drawing no.	C4004
Rev	<b>B</b>

FOR CONSENT



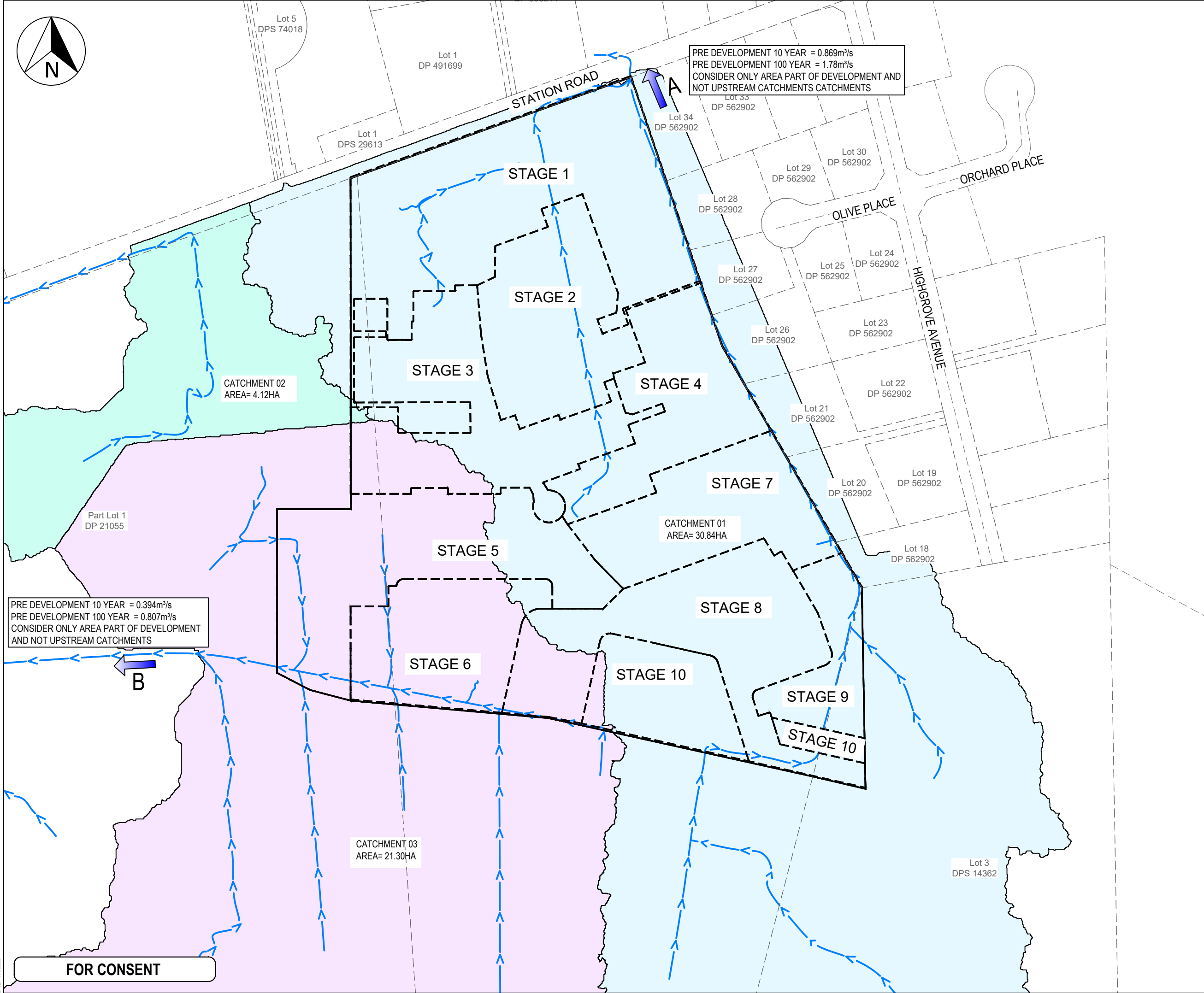

**NOTES**

- All works to be in accordance with Waikato Regional Infrastructure Technical Specifications (RITS)
- Refer to stormwater calculations within infrastructure reporting.

Legend

- EX BDY
- PROP BDY
- OVERLAND FLOW

B	FOR CONSENT	MS	04/25
A	FOR REVIEW	DP	01 /25
Rev	Description	By	Date
	By	Date	
Survey	MAVEN	10/2024	
Design	DP	12/2024	
Drawn	DP	12/2024	
Checked	SB	12/2024	

**M** Maven Matamata  
matamatainfo@maven.co.nz  
www.maven.co.nz  
8 Tainui Street, Matamata  
New Zealand

Project  
**ASHBOURNE  
RETIREMENT VILLAGE  
MATAMATA  
FOR  
UNITY DEVELOPMENT LTD**

Title  
**EXISTING STORMWATER  
CATCHMENT  
PLAN**

Project no.	J00606		
Scale	1:3000@A3		
Cad file	C4050 - SW EX.CATCH.DWG		
Drawing no.	C4050	Rev	<b>B</b>



ORIGINAL SIZE: A3  
DATE: 05/02/2025  
FILE: F:\MAVEN MATAMATA\1. Projects\J00606 UDL - Hemmings Station Rd\6. Drawing\2. CAD\3. Design\C4051 - SW PR.CATCH.dwg

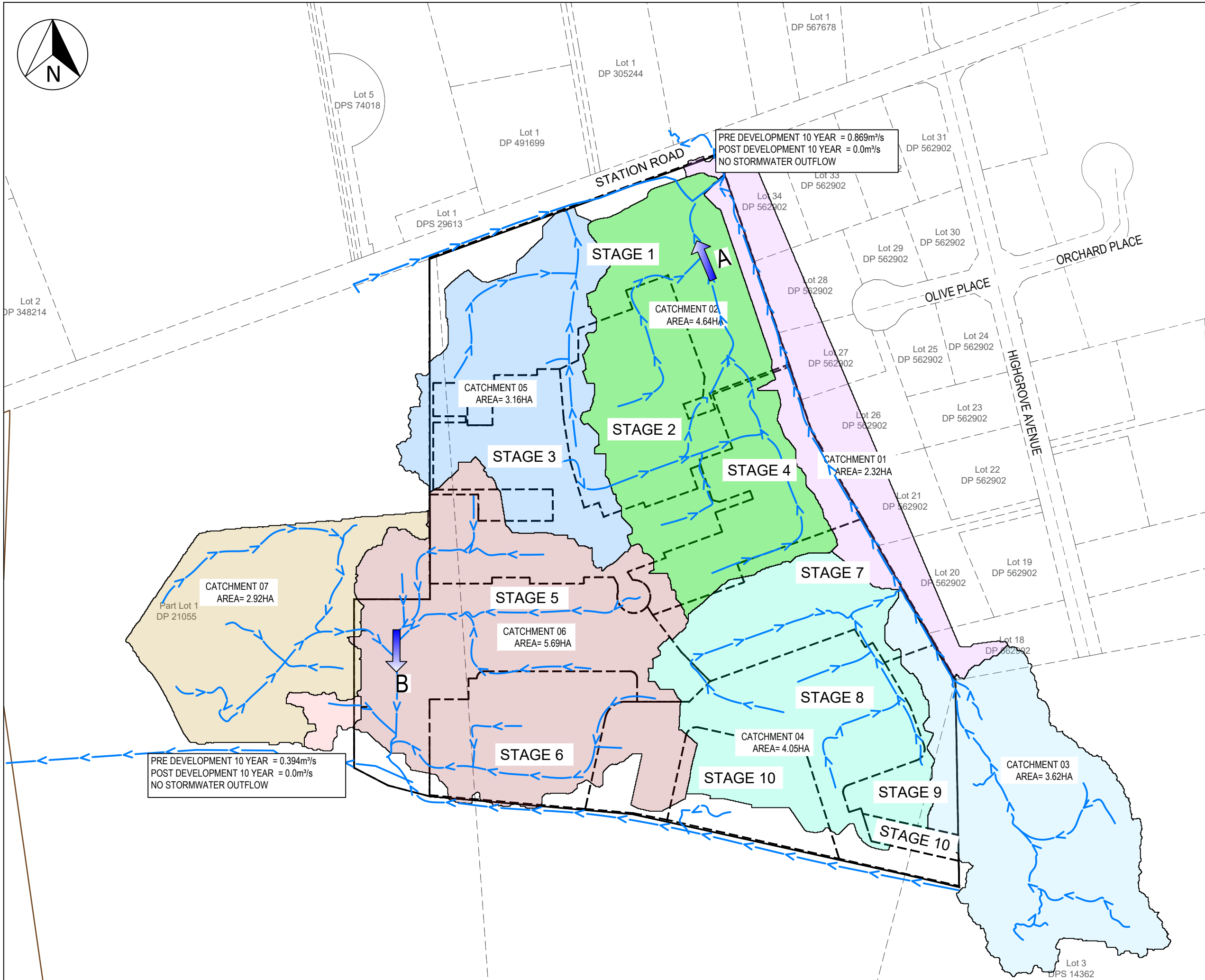
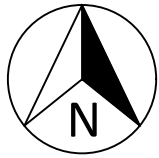

- NOTES
1. All works to be in accordance with Waikato Regional Infrastructure Technical Specifications (RITS)
  2. refer to stormwater calculations within infrastructure reporting.

Legend

---	EX BDY
---	PROP BDY
---	STAGING BDY
---	OVERLAND FLOW

B	FOR CONSENT	MS	04/25
A	FOR REVIEW	DP	01/25
Rev	Description	By	Date
	By	Date	
Survey	MAVEN	10/2024	
Design	DP	12/2024	
Drawn	DP	12/2024	
Checked	SB	12/2024	



Project  
**ASHBOURNE  
RETIREMENT VILLAGE  
MATAMATA  
FOR  
UNITY DEVELOPMENT LTD**

Title  
**PROPOSED 10 YEAR  
STORMWATER  
CATCHMENT PLAN**

Project no.	J00606		
Scale	1:3000@A3		
Cad file	C4051 - SW PR.CATCH.DWG		
Drawing no.	C4051	Rev	<b>B</b>



ORIGINAL SIZE: A3  
DATE: 05/06/2025  
FILE: F:\MAVEN MATAMATA\1. Projects\J00606 UDL - Hemmings Station Rd\6. Drawing\2. CAD\3. Design\C4051 - SW PR.CATCH.dwg

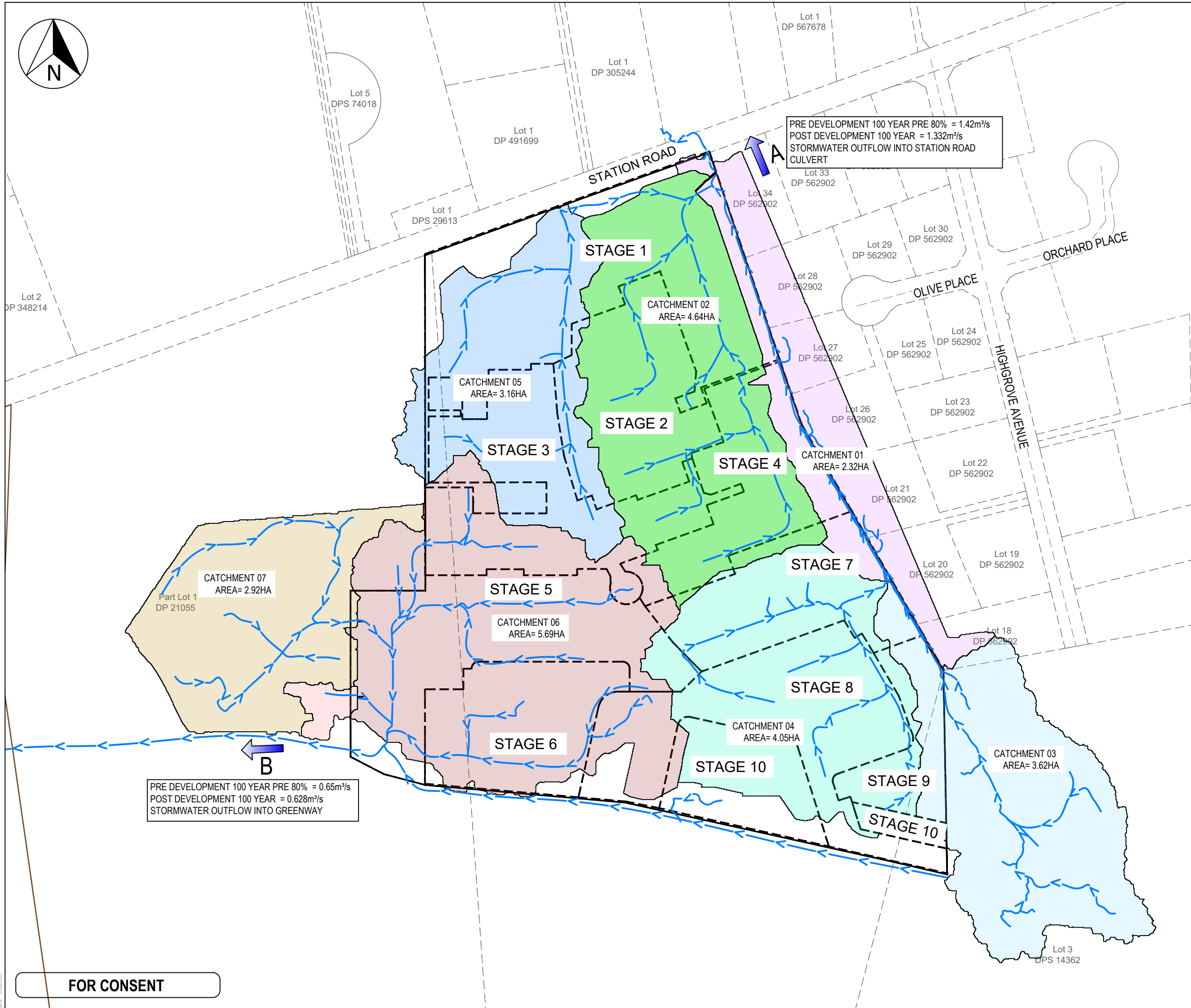
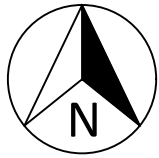

**NOTES**

- All works to be in accordance with Waikato Regional Infrastructure Technical Specifications (RITS)
- refer to stormwater calculations within infrastructure reporting.

**Legend**

- EX BDY
- PROP BDY
- STAGING BDY
- OVERLAND FLOW

B	FOR CONSENT	MS	04/25
A	FOR REVIEW	DP	01/25
Rev	Description	By	Date
Survey	MAVEN		10/2024
Design	DP		12/2024
Drawn	DP		12/2024
Checked	SB		12/2024

**Maven Matamata**  
matamatainfo@maven.co.nz  
www.maven.co.nz  
8 Tainui Street, Matamata  
New Zealand

Project  
**ASHBOURNE  
RETIREMENT VILLAGE  
MATAMATA  
FOR  
UNITY DEVELOPMENT LTD**

Title  
**PROPOSED 100 YEAR  
STORMWATER  
CATCHMENT PLAN**

Project no.	J00606
Scale	1:3000@A3
Cad file	C4051 - SW PR.CATCH.DWG
Drawing no.	C4052
Rev	<b>B</b>



150mm  
100  
80  
60  
40  
30  
20  
10  
0

DATE: 05.06.2025

FILE: F:\MAVEN MATAMATA\1. Projects\J00606 UDL - Hemmings Station Rd\6. Drawing\2. CAD\3. Design\C4600 - SW POND.dwg

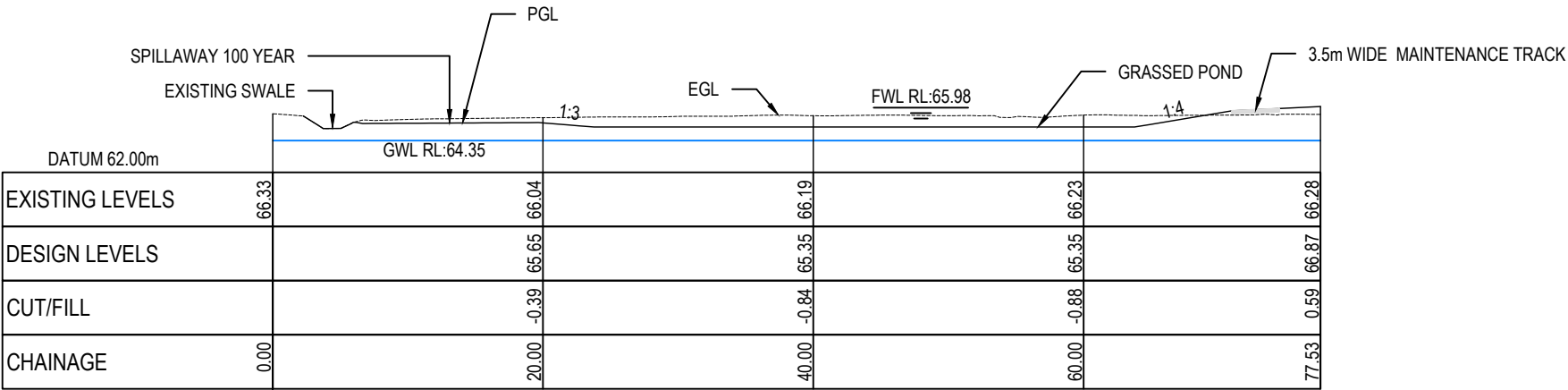

Pond 1 (North East) A-A  
SCALE: HORI 1:100 VERT 1:100

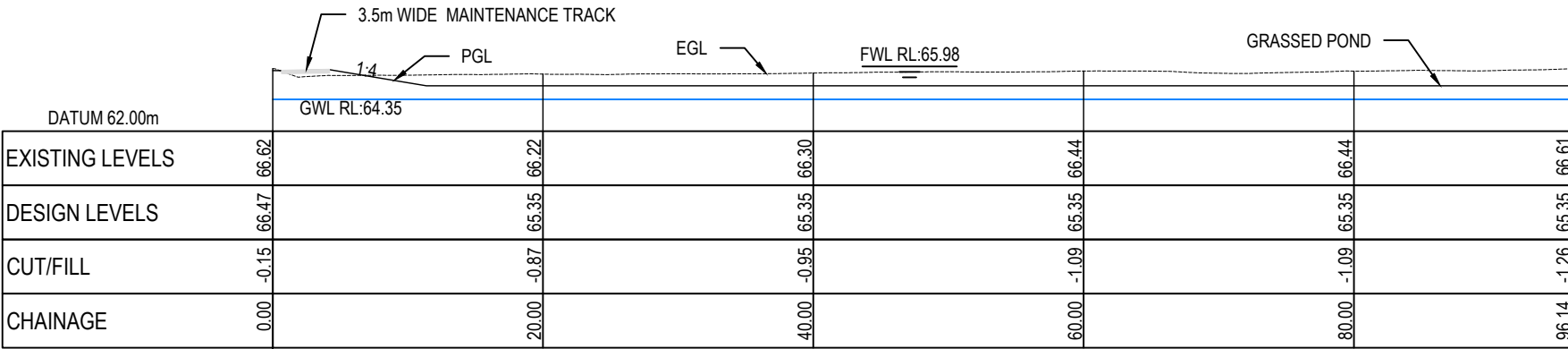

Pond 1 (North East) B-B  
SCALE: HORI 1:100 VERT 1:100

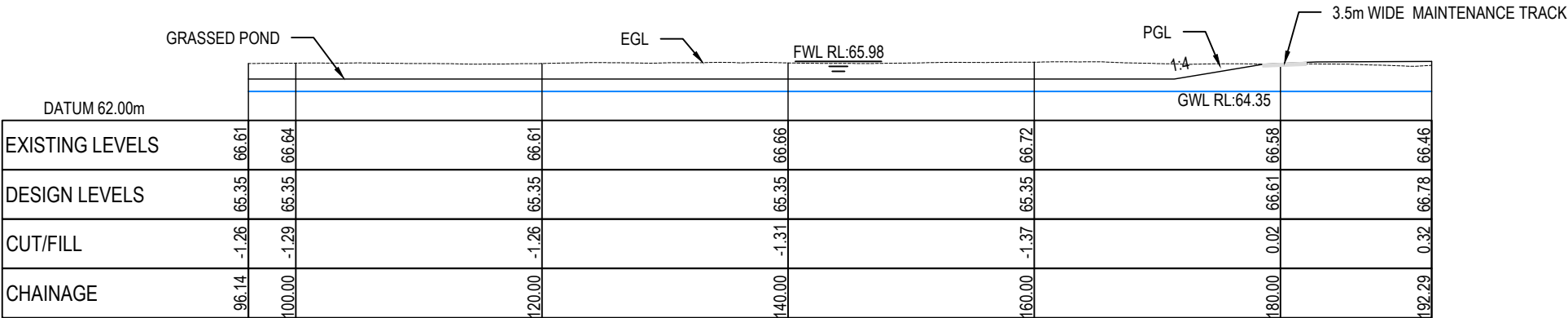

Pond 1 (North East) B-B  
SCALE: HORI 1:100 VERT 1:100

FOR CONSENT

- Notes
1. All works to be in accordance with RITS standards.
  2. Co-ordinates in terms of Mount Eden 2000.
  3. Reduced Levels are in terms of NZVD 2016.
  4. It is the contractors responsibility to locate all services that may be affected by his operations.
  5. Pipe bedding: 0 - 10% granular bedding, 10 - 20% weak concrete bedding, greater than 20% weak concrete bedding (7mpa plus anti scour blocks at 6m crs).
  6. Approved hardfill is to be used in backfilling of all road crossings and vehicle crossings to council standards.
  7. Heavy duty manhole lids and frames to be used in trafficked areas.
  8. All cesspit leads shall have min cover 0.9m.
  9. All lines to be abandoned shall be sealed at each end, timing of all sealing to be coordinated with council staff.
  10. Refer to C4700 for Soakage Tank details.

B	FOR CONSENT	MS	04/25
A	FOR REVIEW	DP	01/25
Rev	Description	By	Date
	By	Date	
Survey	MAVEN	10/2024	
Design	KQ	12/2024	
Drawn	DP	12/2024	
Checked	SB	12/2024	



Project  
**ASHBOURNE  
RETIREMENT VILLAGE  
MATAMATA  
FOR  
UNITY DEVELOPMENT LTD**

Title  
**PROPOSED  
STORMWATER POND 1  
CROSS SECTION PLAN**

Project no.	J00606		
Scale	AS SHOWN		
Cad file	C4600 - SW POND.DWG		
Drawing no.	C4600	Rev	<b>B</b>

ORIGINAL SIZE: A3  
150mm  
100  
80  
60  
40  
30  
20  
10  
0  
DATE: 05.06.2025  
FILE: F:\MAVEN MATAMATA\1. Projects\J00606 UDL - Hemmings Station Rd\6. Drawing\2. CAD\3. Design\C4600 - SW POND.dwg

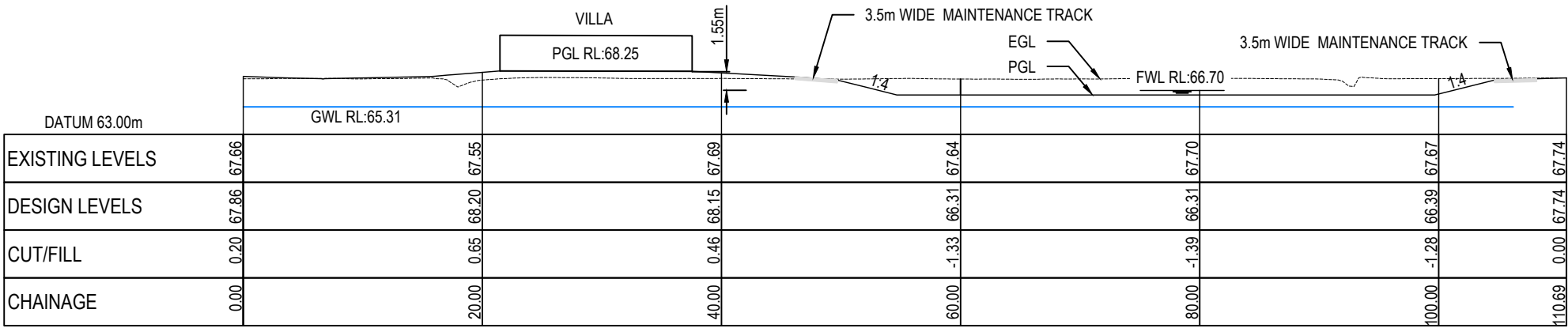

Pond 2 (South West) A-A  
SCALE: HORI 1:100 VERT 1:100

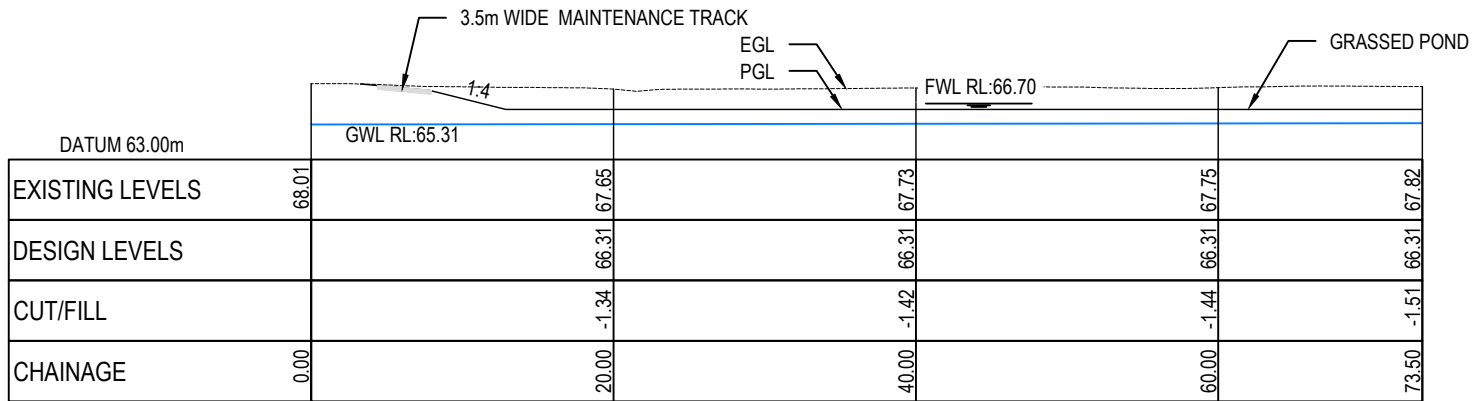

Pond 2 (South West) B-B  
SCALE: HORI 1:100 VERT 1:100

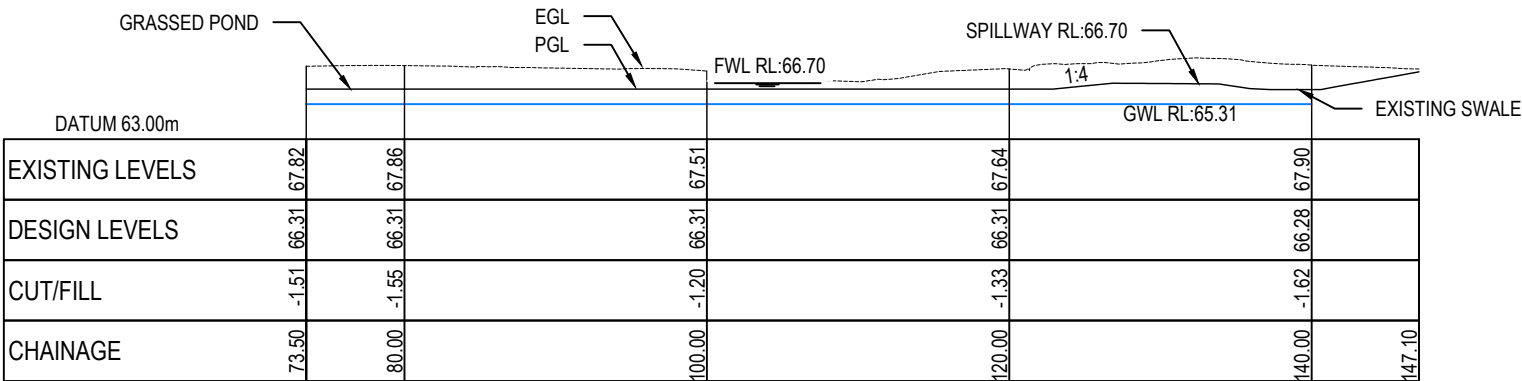

Pond 2 (South West) B-B (1)  
SCALE: HORI 1:100 VERT 1:100

FOR CONSENT

- Notes
1. All works to be in accordance with RITS standards.
  2. Co-ordinates in terms of Mount Eden 2000.
  3. Reduced Levels are in terms of NZVD 2016.
  4. It is the contractors responsibility to locate all services that may be affected by his operations.
  5. Pipe bedding: 0 - 10% granular bedding, 10 - 20% weak concrete bedding, greater than 20% weak concrete bedding (7mpa plus anti scour blocks at 6m crs).
  6. Approved hardfill is to be used in backfilling of all road crossings and vehicle crossings to council standards.
  7. Heavy duty manhole lids and frames to be used in trafficked areas.
  8. All cesspit leads shall have min cover 0.9m.
  9. All lines to be abandoned shall be sealed at each end, timing of all sealing to be coordinated with council staff.
  10. Refer to C4700 for Soakage Tank details.

B	FOR CONSENT	MS	04/25
A	FOR REVIEW	DP	01/25
Rev	Description	By	Date
	By	Date	
Survey	MAVEN	10/2024	
Design	KQ	11/2024	
Drawn	DP	12/2024	
Checked	SB	12/2024	



Project  
**ASHBOURNE  
RETIREMENT VILLAGE  
MATAMATA  
FOR  
UNITY DEVELOPMENT LTD**

Title  
**PROPOSED  
STORMWATER POND 2  
CROSS SECTION PLAN**

Project no.	J00606		
Scale	AS SHOWN		
Cad file	C4600 - SW POND.DWG		
Drawing no.	C4601	Rev	<b>B</b>



ORIGINAL SIZE: A3  
150mm  
100  
80  
60  
40  
20  
0

DATE: 05.06.2025

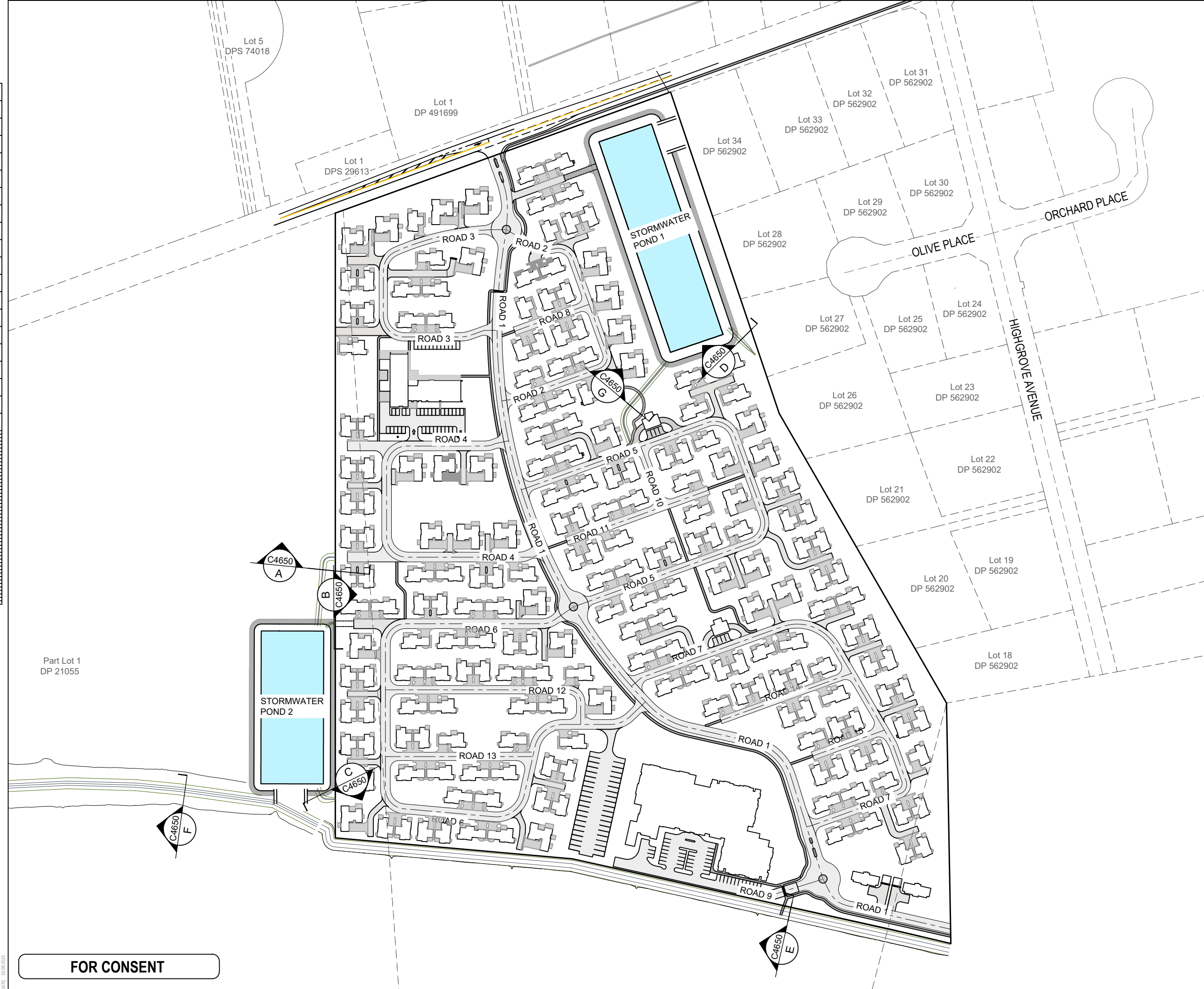

Notes

1. All works to be in accordance with RITS standards.
2. Co-ordinates in terms of Mount Eden 2000.
3. Reduced Levels are in terms of NZVD 2016.
4. It is the contractors responsibility to locate all services that may be affected by his operations.

B	FOR CONSENT	MS	04/25
A	FOR REVIEW	DP	01/25
Rev	Description	By	Date
Survey	MAVEN		10/2024
Design	KQ		12/2024
Drawn	DP		12/2024
Checked	SB		12/2024

**M** **AVEN**  
Maven Matamata  
matamatainfo@maven.co.nz  
www.maven.co.nz  
8 Tainui Street, Matamata  
New Zealand

Project  
**ASHBOURNE  
RETIREMENT VILLAGE  
MATAMATA  
FOR  
UNITY DEVELOPMENT LTD**

Title  
**PROPOSED  
STORMWATER SWALES  
LAYOUT PLAN**

Project no.	J00606		
Scale	1:2500		
Cad file	C4650 - SW SWALES.DWG		
Drawing no.	C4650	Rev	<b>B</b>

**FOR CONSENT**

ORIGINAL SIZE: A3  
150mm  
100  
80  
60  
40  
20  
0  
DATE: 05.06.2025

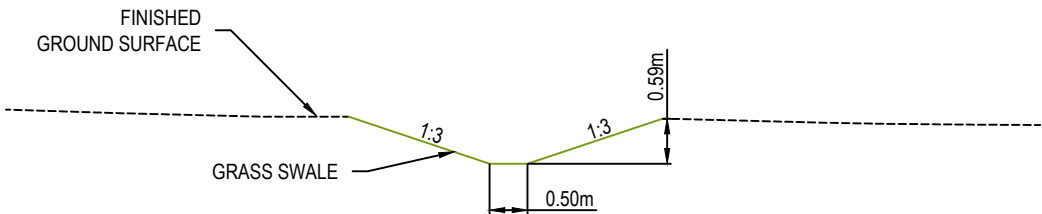

SWALE 1 ROAD 4 TO SW 2  
SECTION A

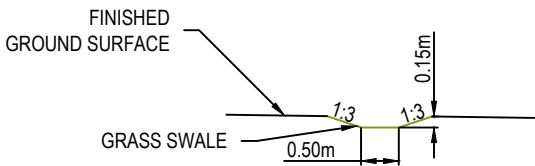

SWALE 2 ROAD 6 TO SW 2  
SECTION B

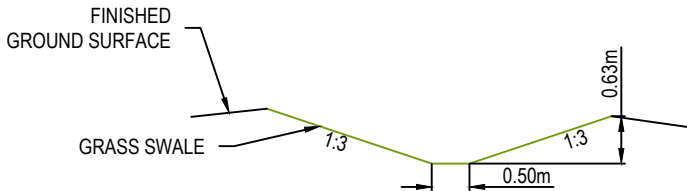

SWALE 3 ROAD 6 TO SW 2  
SECTION C

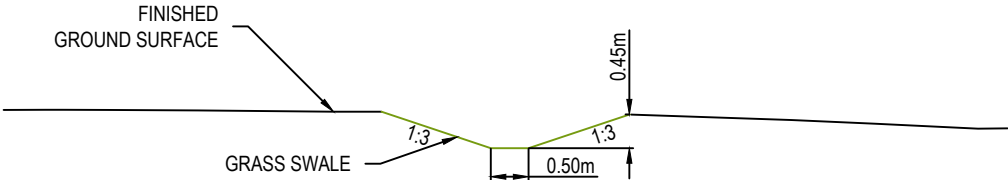

SWALE 4 EX SWALE EASTERN TO SW1  
SECTION D

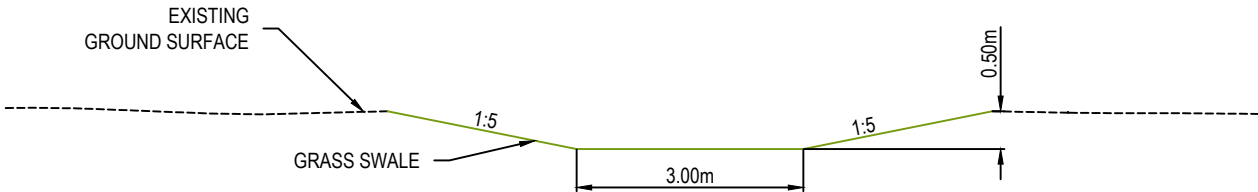

SWALE 5 SOUTHERN CUT OFF DRAIN  
SECTION E

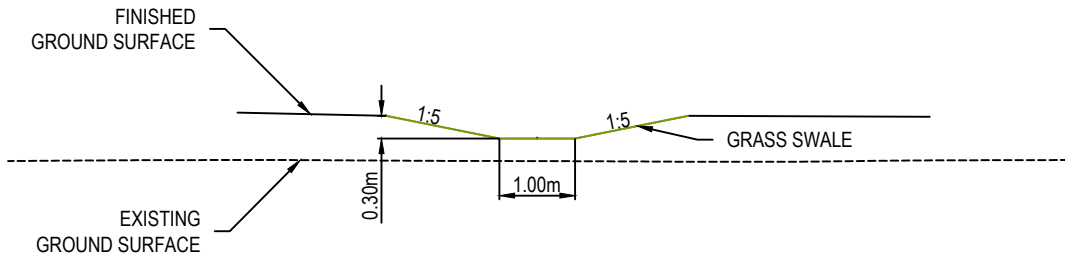

SWALE 7 ROAD 5 TO SW1  
SECTION G

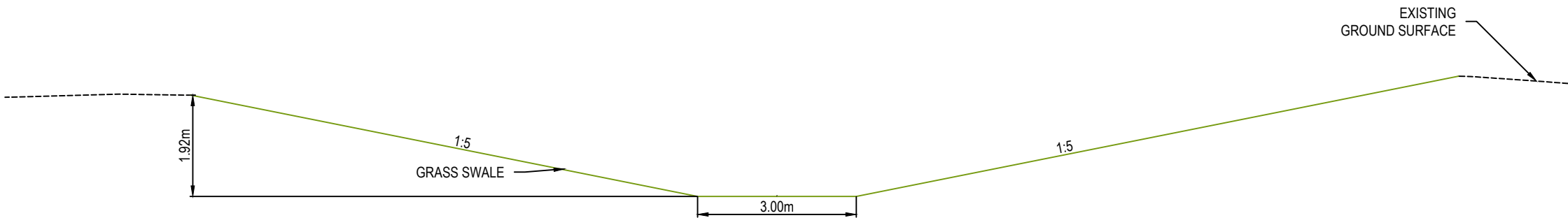

SWALE 6 TO CREEK  
SECTION F

- Notes
1. All works to be in accordance with RITS standards.
  2. Co-ordinates in terms of Mount Eden 2000.
  3. Reduced Levels are in terms of NZVD 2016.
  4. It is the contractors responsibility to locate all services that may be affected by his operations.

B	FOR CONSENT	MS	04/25
A	FOR REVIEW	DP	01/25
Rev	Description	By	Date
	By	Date	
Survey	MAVEN	10/2024	
Design	KQ	12/2024	
Drawn	DP	12/2024	
Checked	SB	12/2024	



Project  
**ASHBOURNE  
RETIREMENT VILLAGE  
MATAMATA  
FOR  
UNITY DEVELOPMENT LTD**

Title  
**PROPOSED  
STORMWATER SWALES  
CROSS SECTIONS**

Project no.	J00606		
Scale	1:100		
Cad file	C4650 - SW SWALES.DWG		
Drawing no.	C4651	Rev	<b>B</b>

FOR CONSENT



ORIGINAL SIZE: A3  
150mm  
100  
80  
60  
40  
20  
0

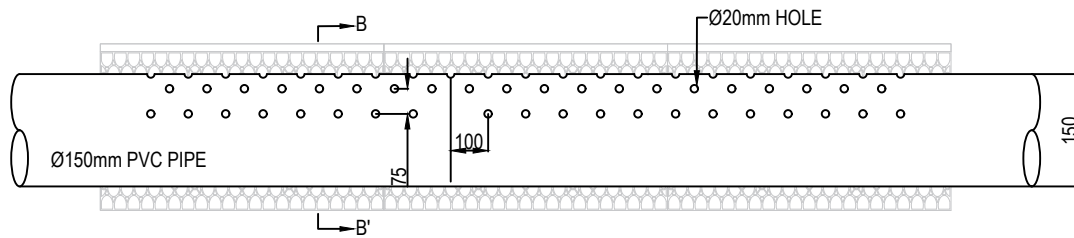
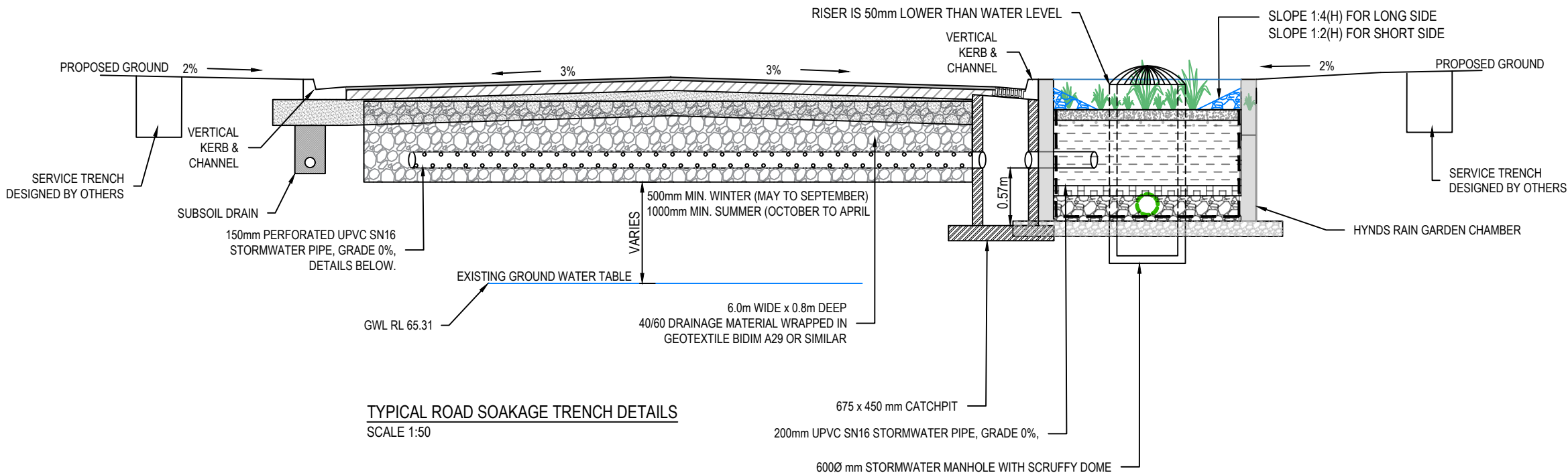

LINEAR ACCESS PIPE (150mm) DETAIL  
NOT TO SCALE

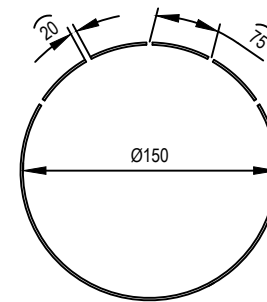

SECTION B-B'  
NOT TO SCALE

#### Notes

1. All works to be constructed in accordance with RITS.
2. Reduced Levels are in terms of NZVD 2016.
3. Site specific testing is required at building consent to determine the soakage rate and optimal soakage trench location.
4. Invert of soakage device must be 1m above the winter groundwater table.
5. Sizing is based on an assumed depth of 1m and or inside the sand layer
6. Soakage trench device is sized to cater for the 10year ARI event including climate change.
7. Soakage trench must maintain minimum 3m clearance from building footprint in accordance with NZBC and MPDC.
8. Soakage device to be either a soakage trench, soak hole or an approved alternative.
9. Soakage device must be constructed in accordance with the MPDC and BC requirements.

B	FOR CONSENT	MS	04/25
A	FOR REVIEW	DP	01/25
Rev	Description	By	Date
	By	Date	
Survey	MAVEN	10/2024	
Design	DP	12/2024	
Drawn	DP	12/2024	
Checked	SB	11/2024	



Project  
**ASHBOURNE  
RETIREMENT VILLAGE  
MATAMATA  
FOR  
UNITY DEVELOPMENT LTD**

Title  
**PROPOSED  
SOAKAGE TRENCH  
CROSS SECTION PLAN**

Project no.	J00606		
Scale	AS SHOWN		
Cad file	C4700 - SW DEVICE DETAILS.DWG		
Drawing no.	C4700	Rev	<b>B</b>

FOR CONSENT

DATE: 06/02/2025

FILE: F:\MAVEN MATAMATA\1. Projects\J00606 UDL - Hemmings Station Rd\6. Drawing\2. CAD\3. Design\C4700 - SW DEVICE DETAILS.dwg

ORIGINAL SIZE: A3  
DATE: 06/06/2025  
FILE: F:\MAVEN MATAMATA\1. Projects\U00606 UDL - Hemmings Station Rd\6. Drawing\2. CAD\3. Design\C4700 - SW DEVICE DETAILS.dwg

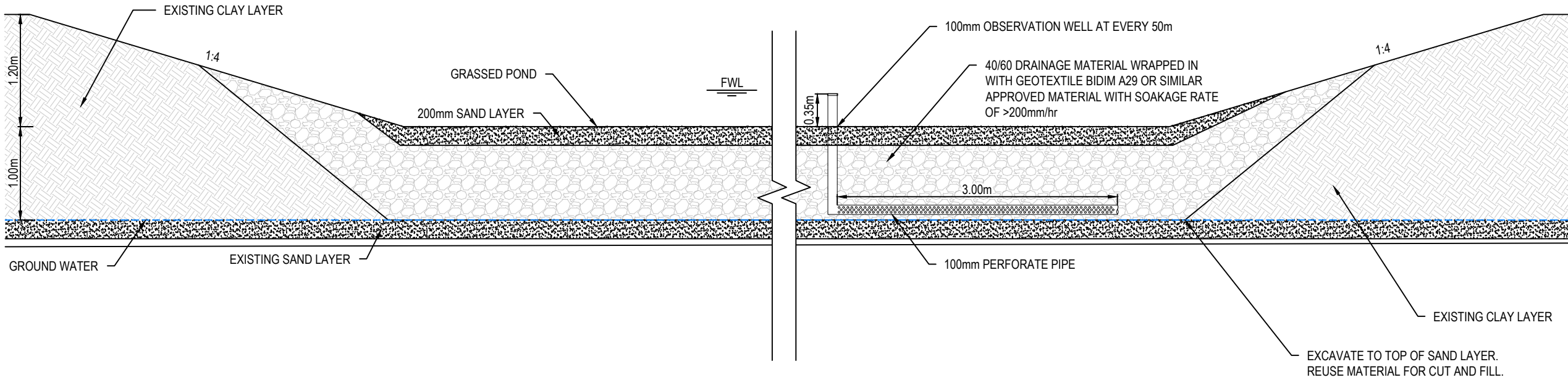

STORMWATER SOAKAGE POND 1 DETAIL  
SCALE: 1:50 @ A3

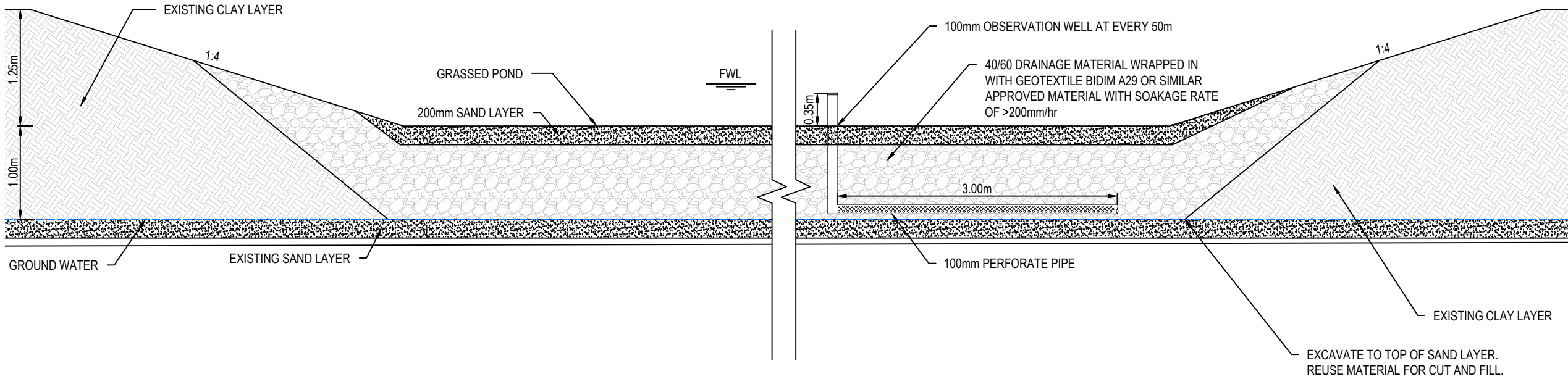

STORMWATER SOAKAGE POND 2 DETAIL  
SCALE: 1:50 @ A3

FROM TR20-7 GUIDELINES

Table 6-4: Infiltration rate for various soil textural classes

Texture Class	Approximate Infiltration Rate in mm/hour
Sand	210
Loamy sand	61
Sandy loam	26
Loam	13
Silt loam	7
Sandy clay loam	4.5
Clay loam	2.5
Silty clay loam	1.5
Sandy clay	1.3
Silty clay	1.0
Clay	0.5

- Notes
- All works to be constructed in accordance with RITS.
  - Reduced Levels are in terms of NZVD 2016.
  - Site specific testing is required at building consent to determine the soakage rate and optimal soakage trench location.
  - Invert of soakage device must be 1m above the winter groundwater table.
  - Sizing is based on an assumed depth of 1m and or inside the sand layer
  - Soakage trench device is sized to cater for the 10year ARI event including climate change.
  - Soakage trench must maintain minimum 3m clearance from building footprint in accordance with NZBC and MPDC.
  - Soakage device to be either a soakage trench, soak hole or an approved alternative.
  - Soakage device must be constructed in accordance with the MPDC and BC requirements.

B	FOR CONSENT	MS	04/25
A	FOR REVIEW	MS	01/25
Rev	Description	By	Date
		By	Date
Survey	MAVEN		10/2024
Design	SB		10/2024
Drawn	MS		11/2024
Checked	NP		11/2024



Project  
**ASHBOURNE  
RETIREMENT VILLAGE  
MATAMATA  
FOR  
UNITY DEVELOPMENT LTD**

Title  
**PROPOSED  
STORMWATER POND  
DETAIL PLAN**

Project no.	J00606
Scale	1:50
Cad file	C4700 - SW DEVICE DETAILS.DWG
Drawing no.	C4701
Rev	B

FOR CONSENT



ORIGINAL SIZE: A3  
150mm  
100  
80  
60  
40  
20  
10  
0

DATE: 06/02/2025

FILE: F:\MAVEN MATAMATA\1. Projects\J00606 UDL - Hemmings Station Rd\6. Drawing\2. CAD\3. Design\C4700 - SW DEVICE DETAILS.dwg

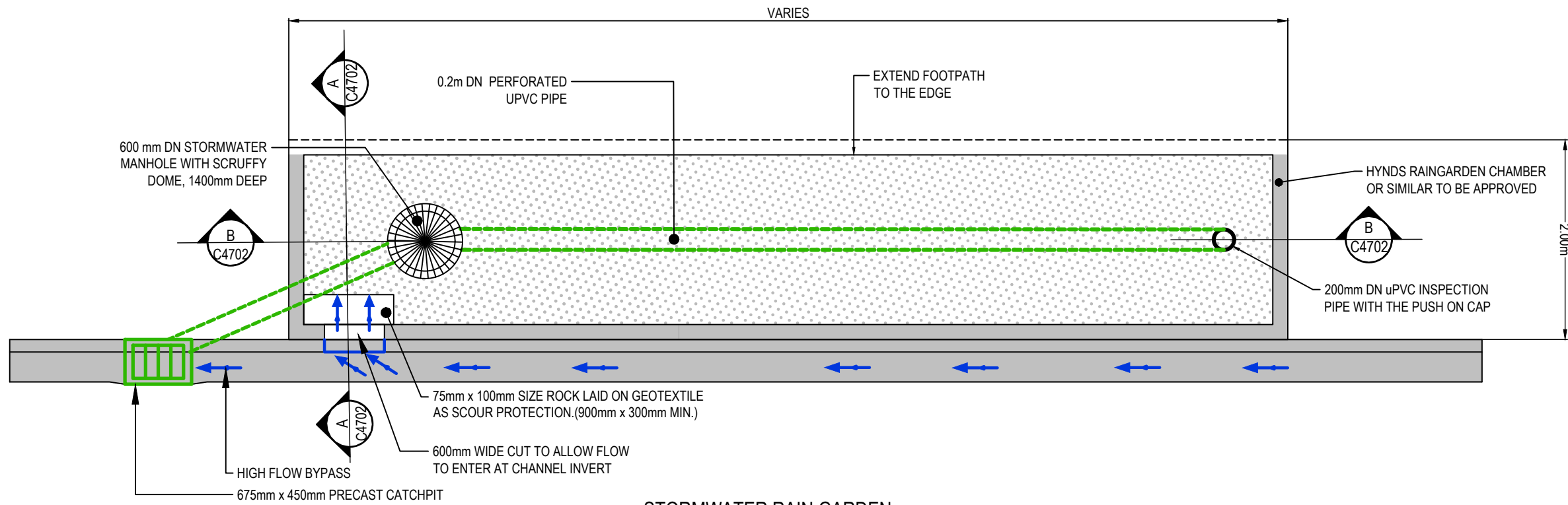

**STORMWATER RAIN GARDEN**  
SCALE: 1:50 @ A3

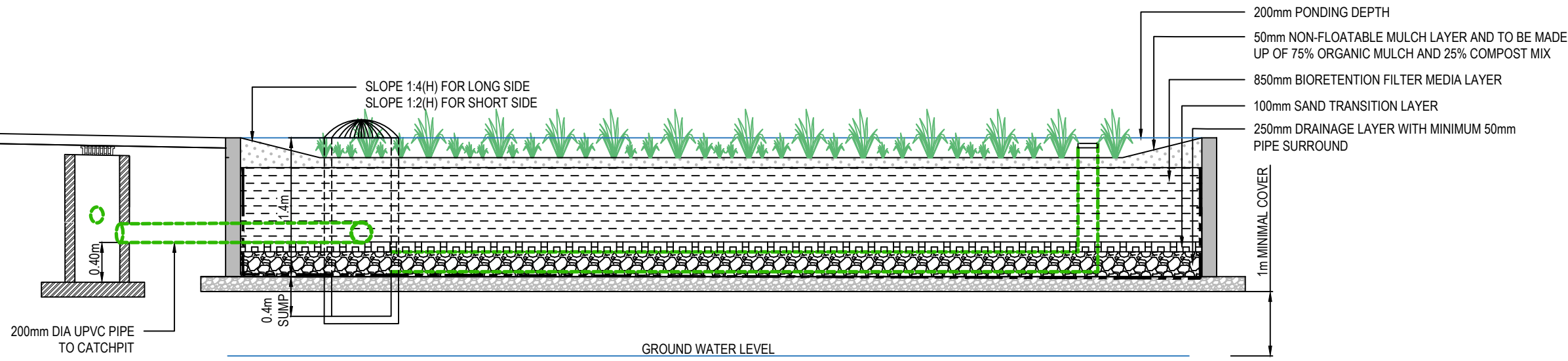

**STORMWATER RAIN GARDEN : SECTION B-B**  
SCALE: 1:50 @ A3

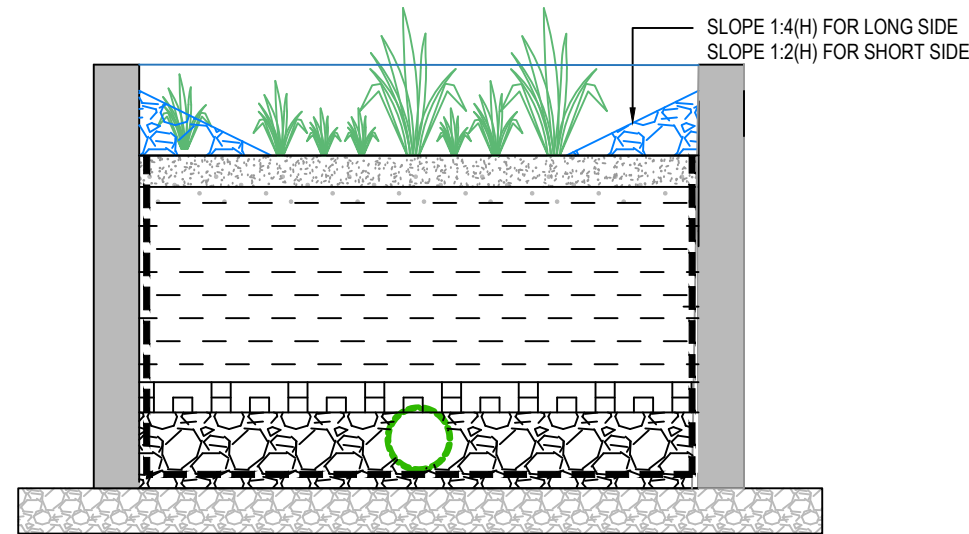

**STORMWATER RAIN GARDEN : SECTION A-A**  
SCALE: 1:50 @ A3

**FOR CONSENT**

- Notes**
1. All works to be constructed in accordance with RITS.
  2. Reduced Levels are in terms of NZVD 2016.
  3. Tank to be Cirtex Rainsmart Modular Tank or a similar approved product subject to Engineers Approval.
  4. Refer to the Rainsmart Installation Guide G015001 for installation requirements.
  5. Site specific testing is required at building consent to determine the soakage rate and optimal soakage trench location.
  6. Invert of soakage device must be 1m above the winter groundwater table.
  7. Sizing is based on an assumed depth of 1m and or inside the sand layer
  8. Soakage trench device is sized to cater for the 10year ARI event including climate change.
  9. Soakage trench must maintain minimum 3m clearance from building footprint in accordance with NZBC and MPDC.
  10. Soakage device to be either a soakage trench, soak hole or an approved alternative.
  11. Soakage device must be constructed in accordance with the MPDC and BC requirements.

B	FOR CONSENT	MS	04/25
A	FOR REVIEW	MS	01/25
Rev	Description	By	Date
		By	Date
Survey	MAVEN		10/2024
Design	SB		10/2024
Drawn	MS		11/2024
Checked	NP		11/2024



Project  
**ASHBOURNE  
RETIREMENT VILLAGE  
MATAMATA  
FOR  
UNITY DEVELOPMENT LTD**

Title  
**PROPOSED  
STORMWATER RAIN  
GARDEN DETAIL PLAN**

Project no.	J00606
Scale	1:50
Cad file	C4700 - SW DEVICE DETAILS.DWG
Drawing no.	C4702
Rev	B





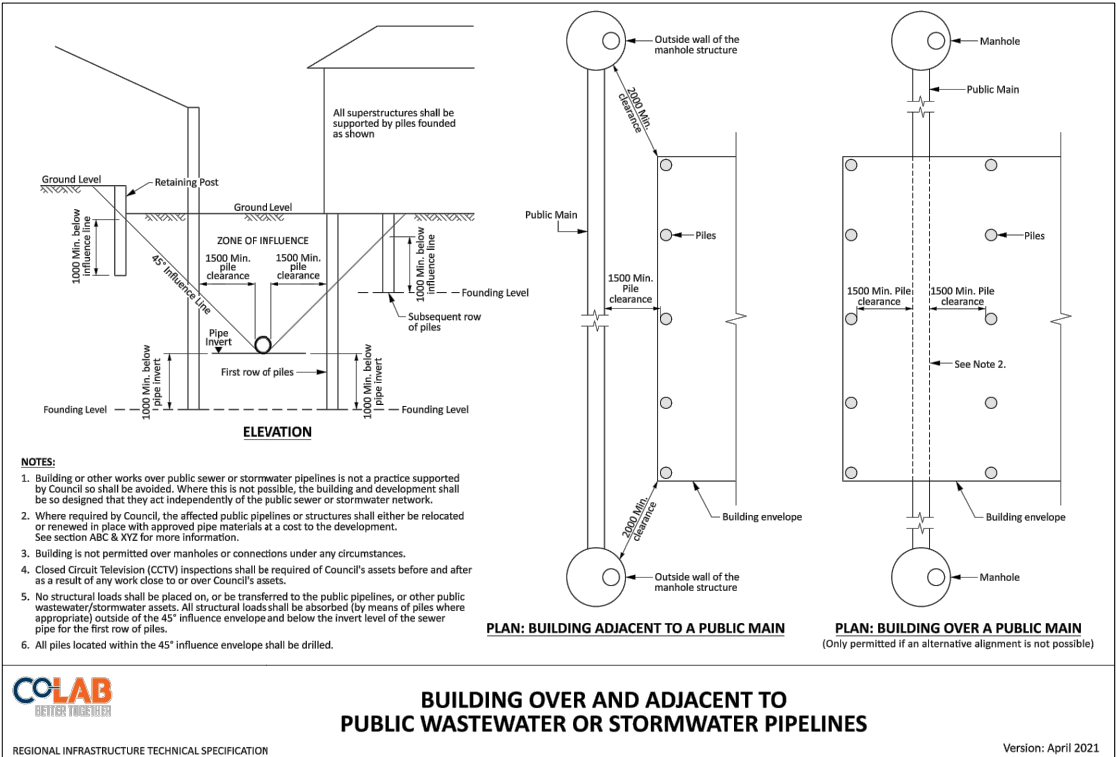
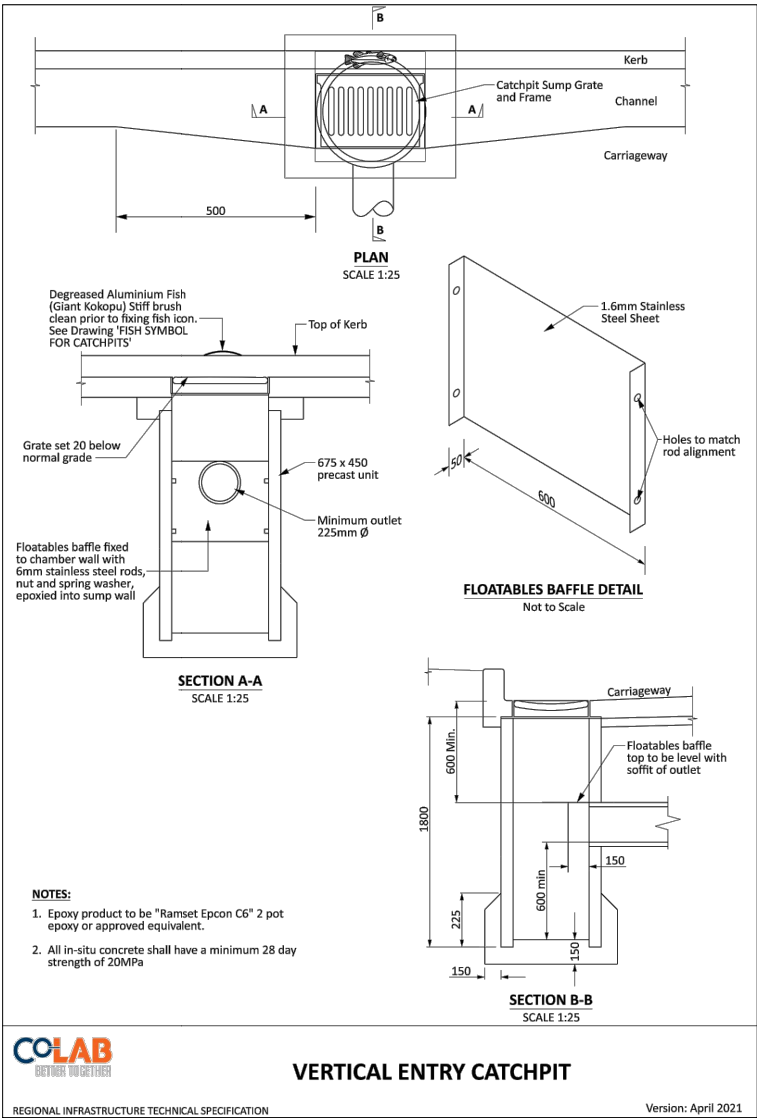
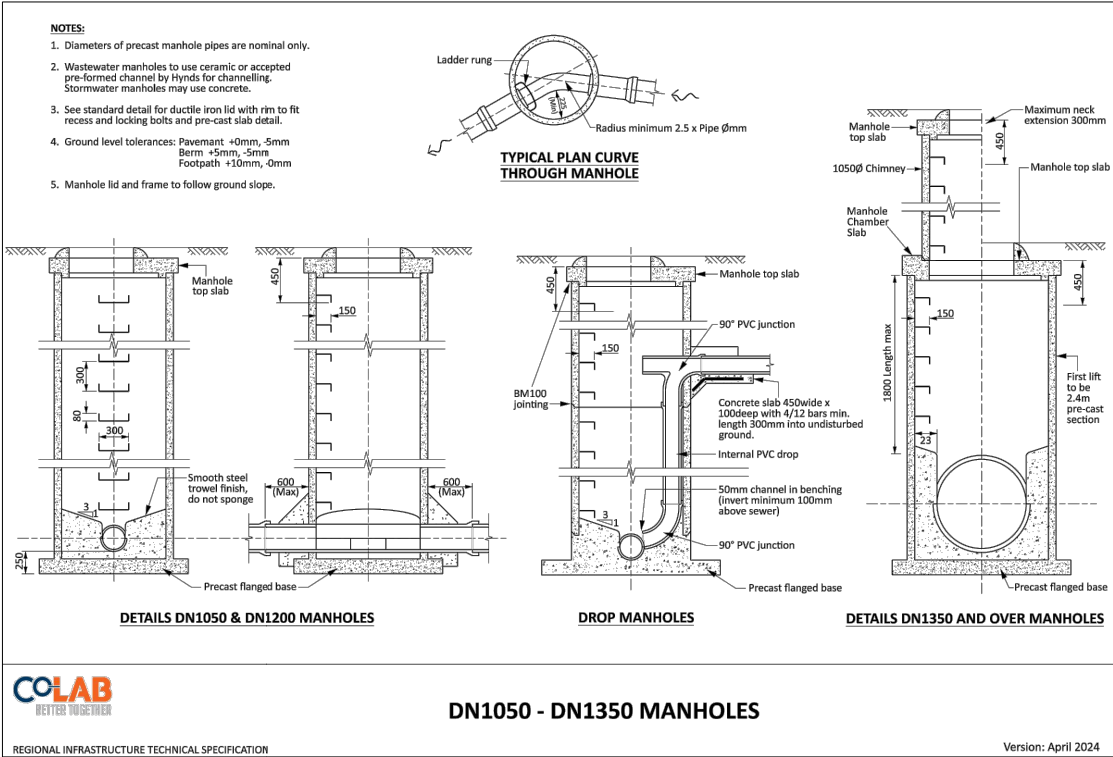

- Notes
- All works to be in accordance WITH RITS standards.
  - All bends and connections to be no more than 45°
  - All connections to existing drains shall be carried out by a licensed Drainlayer/Plumber.
  - Drainage shall comply in full with E1/AS1 building code for storm water.
  - All cesspits shall have half syphons installed.
  - All sanitary waste drains shall be uPVC to AS/NZS 1260.
  - Sewer shall comply in full with AS/NZS 3500.2 - 2003 and/or G13 Building Code
  - Refer to Hydraulic engineers drawings for building plumbing beyond that shown including down pipe sizes.
  - All pipes shall be SN16 grade unless otherwise stated.
  - Drainlayer shall locate and confirm connection invert before starting building works.
  - Plans to be read in conjunction with Hydraulic Engineers and differences shall clarified be before contractor starts.
  - All chamber lids shall have a minimum 200mm maximum 300 throat to provide sufficient cover for landscape and pavement over the top.

B	FOR CONSENT	MS	04/25
A	FOR REVIEW	DP	01/25
Rev	Description	By	Date
		By	Date
Survey	MAVEN		10/2024
Design	DP		10/2024
Drawn	DP		11/2024
Checked	SB		11/2024



Project  
**ASHBOURNE  
RETIREMENT VILLAGE  
MATAMATA  
FOR  
UNITY DEVELOPMENT LTD**

Title  
**PROPOSED  
STORMWATER STANDARD  
DETAIL**

Project no.	J00606		
Scale	1:1000@A3		
Cad file	C4800 - SW SD DETAILS.DWG		
Drawing no.	C4800	Rev	<b>B</b>

FOR CONSENT

ORIGINAL SIZE: A3  
DATE: 05.10.2024  
FILE: F:\MAVEN MATAMATA\1. Projects\J00606 UDL - Hemmings Station Rd\8. Drawing\2. CAD\3. Design\C4900 - SW overland flow path - dwg



- Notes
1. All works to be in accordance with RITS standards.
  2. Co-ordinates in terms of Mount Eden 2000.
  3. Reduced Levels are in terms of NZVD 2016.
  4. It is the contractors responsibility to locate all services that may be affected by his operations.
  5. Pipe bedding: 0 - 10% granular bedding, 10 - 20% weak concrete bedding, greater than 20% weak concrete bedding (7mpa plus anti scour blocks at 6m crs).
  6. Approved hardfill is to be used in backfilling of all road crossings and vehicle crossings to council standards.
  7. Heavy duty manhole lids and frames to be used in trafficked areas.
  8. All cesspit leads shall have min cover 0.9m.
  9. All lines to be abandoned shall be sealed at each end, timing of all sealing to be coordinated with council staff.
  10. Refer to C4700 for Soakage Tank details.

Legend

- EX BDY
- PROP BDY
- OVERLAND FLOW

A	FOR CONSENT	DP	04/25
Rev	Description	By	Date
Survey	MAVEN		10/2024
Design	KQ		12/2024
Drawn	DP		04/2024
Checked	SB		12/2024

**M**  
M A V E N  
Maven Matamata  
matamatainfo@maven.co.nz  
www.maven.co.nz  
8 Tainui Street, Matamata  
New Zealand

Project  
**ASHBOURNE  
RETIREMENT VILLAGE  
MATAMATA  
FOR  
UNITY DEVELOPMENT LTD**

Title  
**PROPOSED  
OVERLAND FLOWPATH  
LAYOUT PLAN**

Project no.	J00606
Scale	AS SHOWN
Cad file	C4900 - SW OVERLAND FLOW PATH - DWG
Drawing no.	C4900
Rev	A



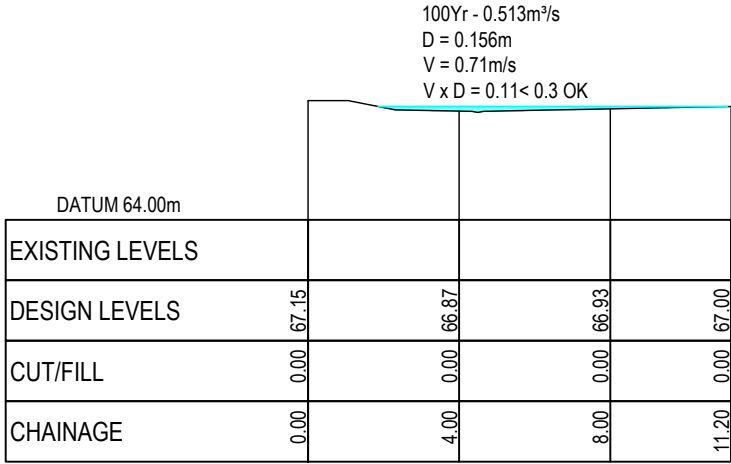

PV - OLF CROSS-SECTION-A  
SCALE: HORI 1:1000 VERT 1:1000

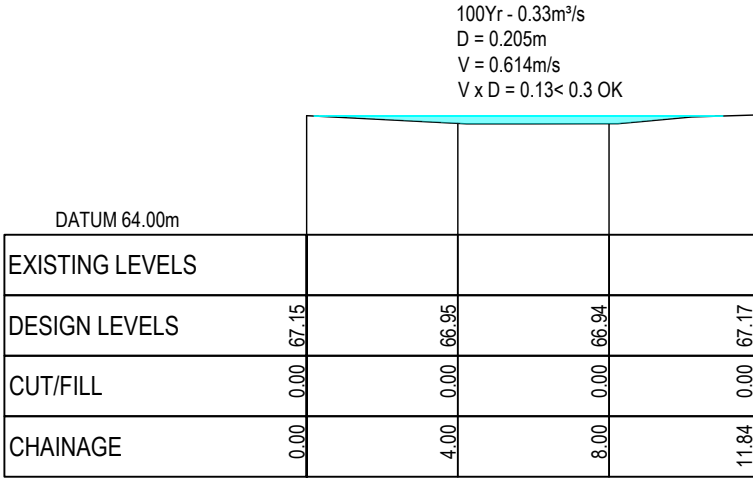

PV - OLF CROSS-SECTION C  
SCALE: HORI 1:1000 VERT 1:1000

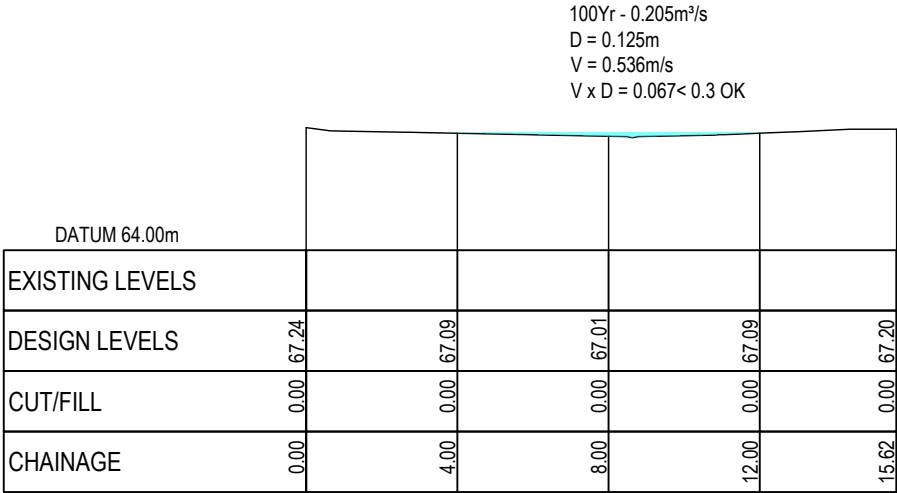

PV - OLF-CROSS-SECTION-E  
SCALE: HORI 1:1000 VERT 1:1000

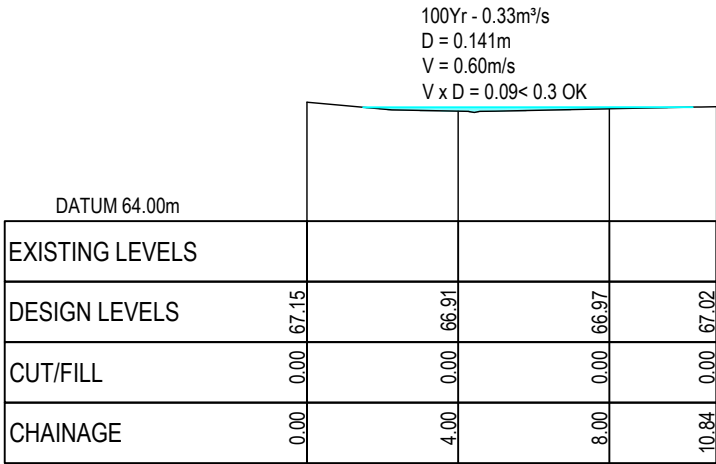

PV - OLF -CROSS-SECTION-B  
SCALE: HORI 1:1000 VERT 1:1000

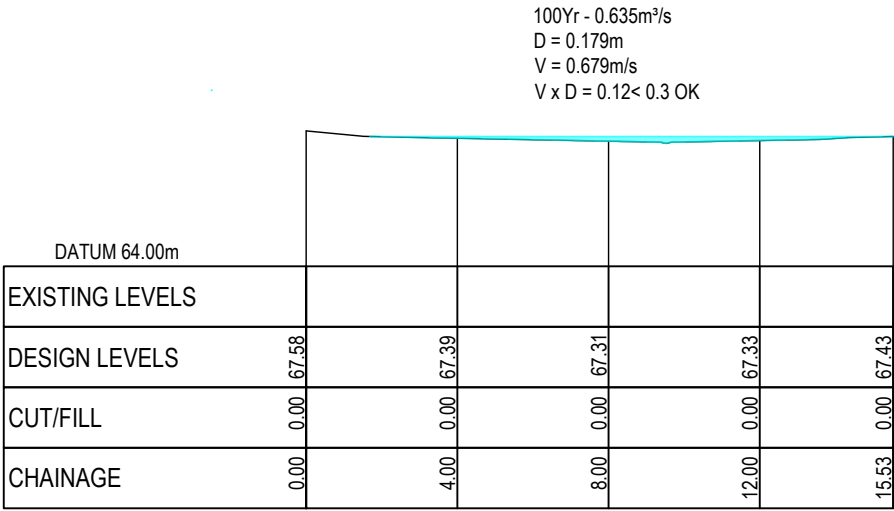

PV - OLF-CROSS-SECTION-D  
SCALE: HORI 1:1000 VERT 1:1000

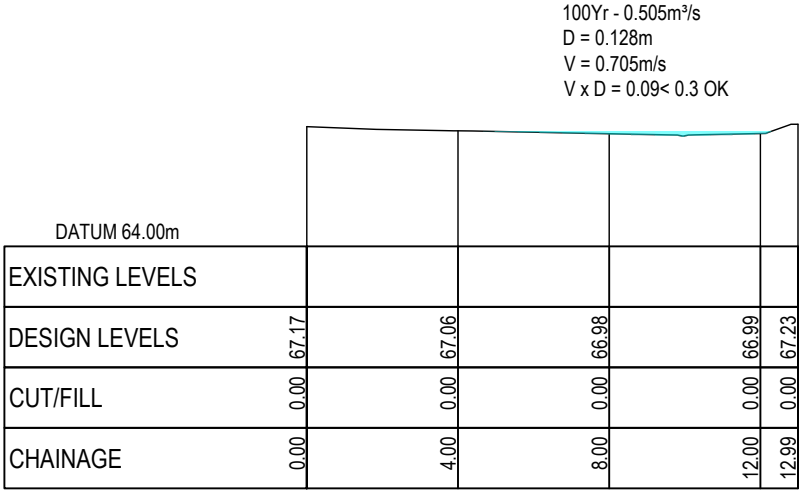

PV - OLF-CROSS-SECTION-F  
SCALE: HORI 1:1000 VERT 1:1000

- Notes
1. All works to be in accordance with RITS standards.
  2. Co-ordinates in terms of Mount Eden 2000.
  3. Reduced Levels are in terms of NZVD 2016.
  4. It is the contractors responsibility to locate all services that may be affected by his operations.
  5. Pipe bedding: 0 - 10% granular bedding,10 - 20% weak concrete bedding.greater than 20% weak concrete bedding (7mpa plus anti scour blocks at 6m crs).
  6. Approved hardfill is to be used in backfilling of all road crossings and vehicle crossings to council standards.
  7. Heavy duty manhole lids and frames to be used in trafficked areas.
  8. All cesspit leads shall have min cover 0.9m.
  9. All lines to be abandoned shall be sealed at each end. timing of all sealing to be coordinated with council staff.
  10. Refer to C4700 for Soakage Tank details.

A	FOR CONSENT	DP	04/25
Rev	Description	By	Date
	By	Date	
Survey	MAVEN	10/2024	
Design	KQ	12/2024	
Drawn	DP	04/2025	
Checked	SB	12/2024	

M

MAVEN

MAVEN

Matamata

matamatainfo@maven.co.nz

www.maven.co.nz

8 Tainui Street, Matamata

New Zealand

Project

ASHBOURNE  
RETIREMENT VILLAGE  
MATAMATA  
FOR  
UNITY DEVELOPMENT LTD

Title			
PROPOSED OVERLAND FLOW CROSS SECTION (1 OF 3)			
Project no.	J00606		
Scale	AS SHOWN		
Cad file	C4900 - SW OVERLAND FLOW PATH -.DWG		
Drawing no.	C4901	Rev	A

DATE: 05.09.2025  
ORIGINAL SIZE: A3  
150mm  
100  
90  
80  
70  
60  
50  
40  
30  
20  
10  
0

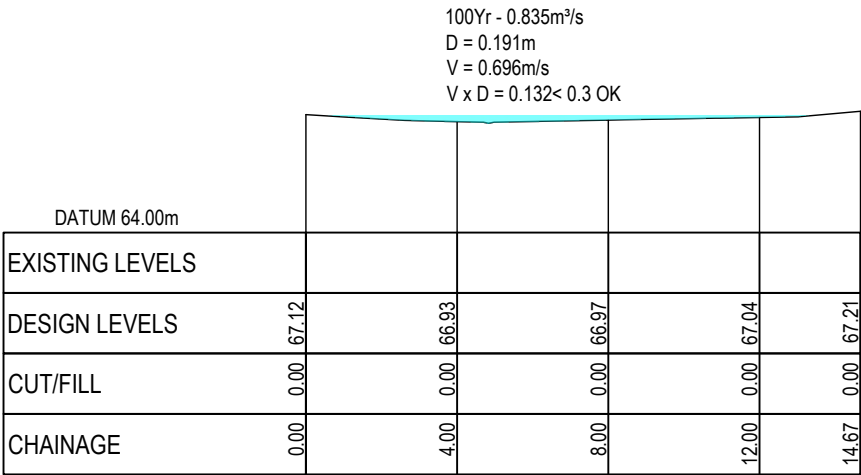

PV - OLF-CROSS-SECTION-G  
SCALE: HORI 1:1000 VERT 1:1000

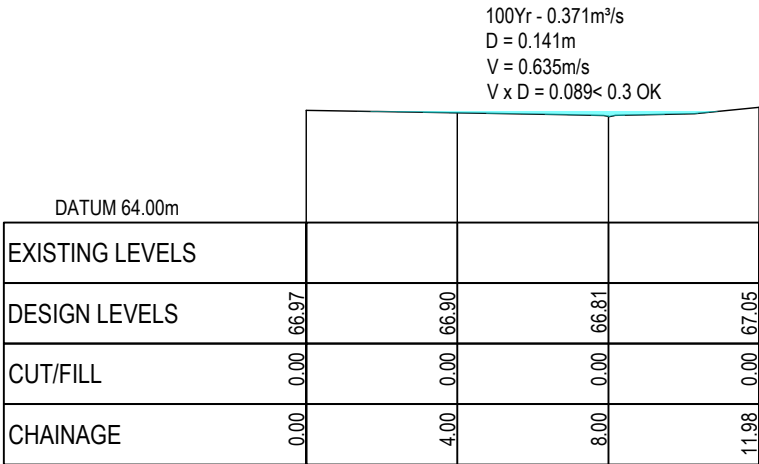

PV - OLF-CROSS-SECTION-I  
SCALE: HORI 1:1000 VERT 1:1000

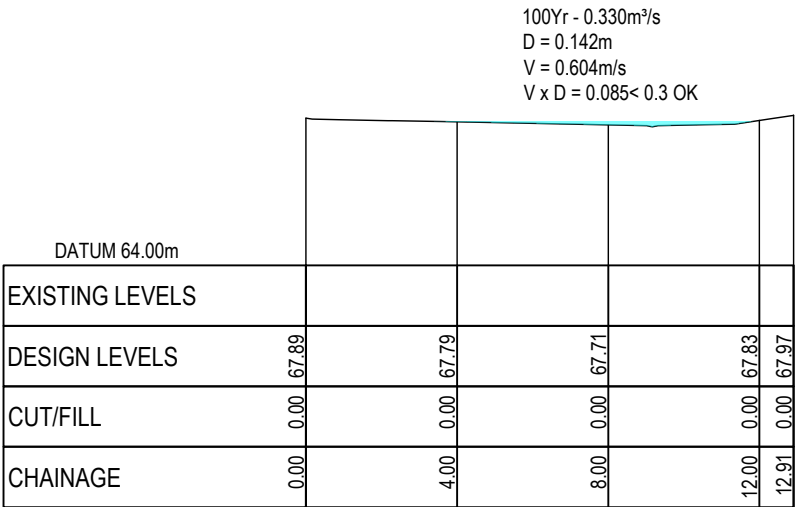

PV - OLF-CROSS-SECTION-K  
SCALE: HORI 1:1000 VERT 1:1000

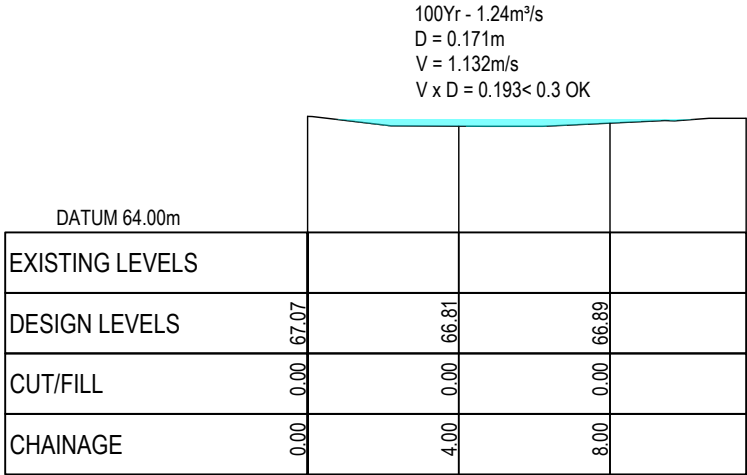

PV - OLF-CROSS-SECTION-H  
SCALE: HORI 1:1000 VERT 1:1000

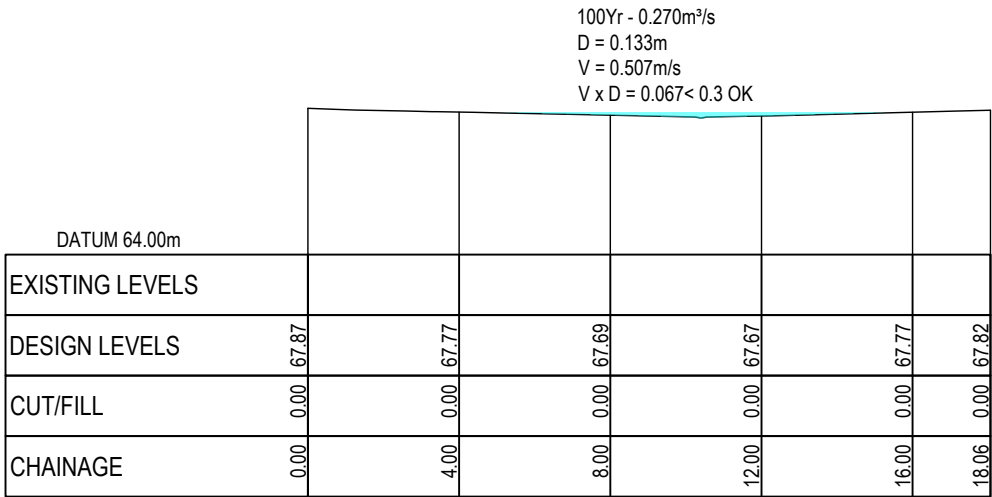

PV - OLF-CROSS-SECTION-J  
SCALE: HORI 1:1000 VERT 1:1000

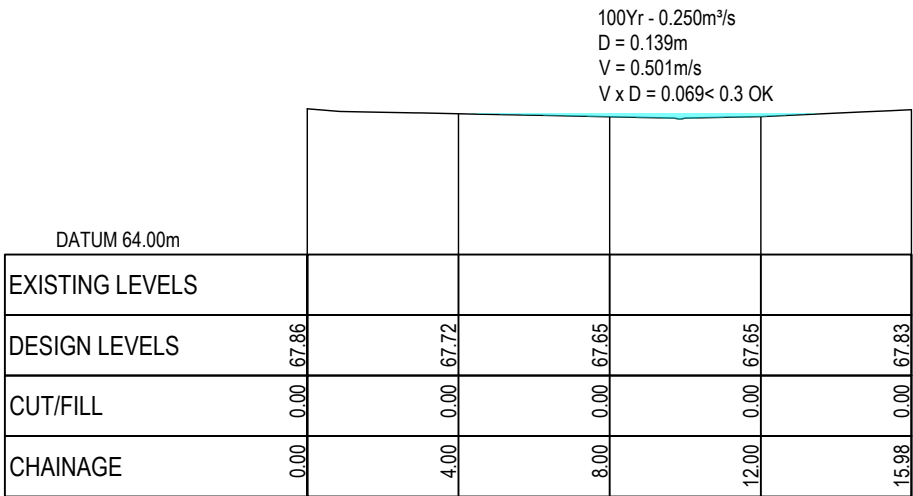

PV - OLF-CROSS-SECTION-L  
SCALE: HORI 1:1000 VERT 1:1000

FOR CONSENT

- Notes
1. All works to be in accordance with RITS standards.
  2. Co-ordinates in terms of Mount Eden 2000.
  3. Reduced Levels are in terms of NZVD 2016.
  4. It is the contractors responsibility to locate all services that may be affected by his operations.
  5. Pipe bedding: 0 - 10% granular bedding, 10 - 20% weak concrete bedding, greater than 20% weak concrete bedding (7mpa plus anti scour blocks at 6m crs).
  6. Approved hardfill is to be used in backfilling of all road crossings and vehicle crossings to council standards.
  7. Heavy duty manhole lids and frames to be used in trafficked areas.
  8. All cesspit leads shall have min cover 0.9m.
  9. All lines to be abandoned shall be sealed at each end, timing of all sealing to be coordinated with council staff.
  10. Refer to C4700 for Soakage Tank details.

A	FOR CONSENT	DP	04/25
Rev	Description	By	Date
	Survey	MAVEN	10/2024
	Design	KQ	11/2024
	Drawn	DP	04/2024
	Checked	SB	12/2024



Project  
**ASHBOURNE  
RETIREMENT VILLAGE  
MATAMATA  
FOR  
UNITY DEVELOPMENT LTD**

Title  
**PROPOSED  
OVERLAND FLOW  
CROSS SECTION (2 OF 3)**

Project no.	J00606		
Scale	AS SHOWN		
Cad file	C4900 - SW OVERLAND FLOW PATH -		
Drawing no.	C4902	Rev	<b>B</b>



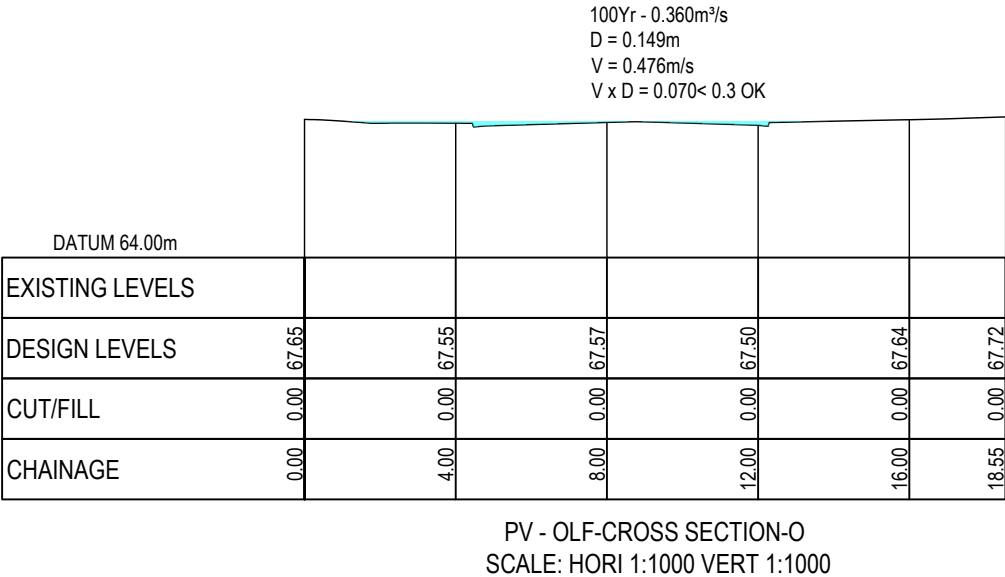
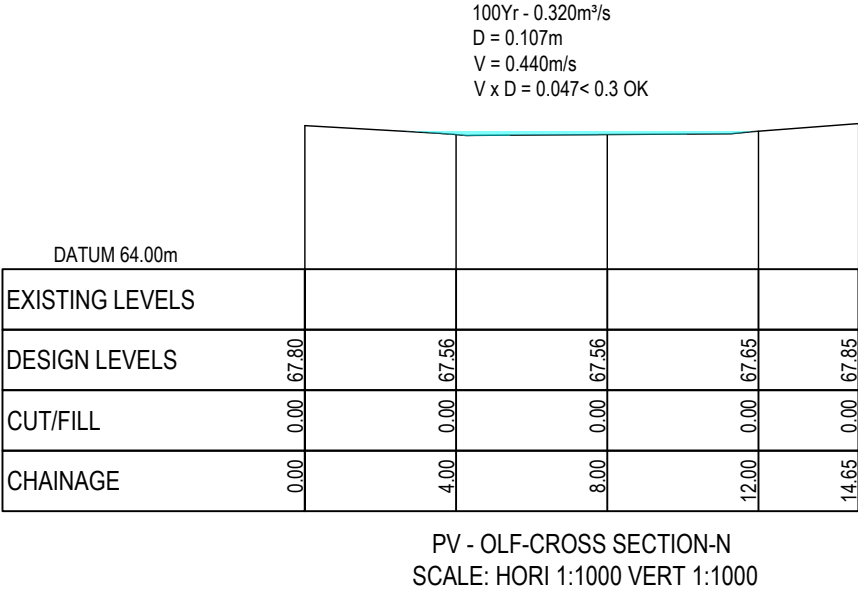
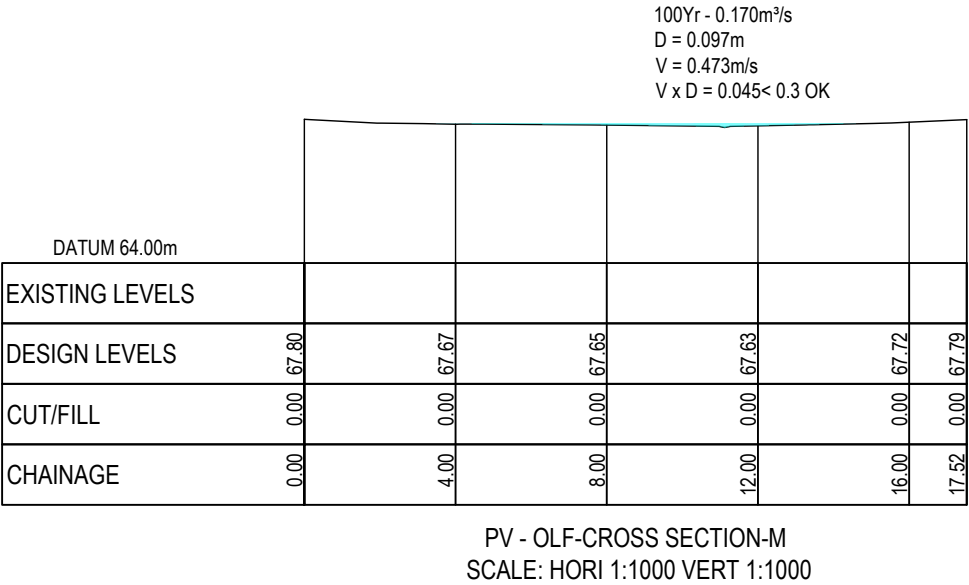

FOR CONSENT

- Notes
1. All works to be in accordance with RITS standards.
  2. Co-ordinates in terms of Mount Eden 2000.
  3. Reduced Levels are in terms of NZVD 2016.
  4. It is the contractors responsibility to locate all services that may be affected by his operations.
  5. Pipe bedding: 0 - 10% granular bedding,10 - 20% weak concrete bedding.greater than 20% weak concrete bedding (7mpa plus anti scour blocks at 6m crs).
  6. Approved hardfill is to be used in backfilling of all road crossings and vehicle crossings to council standards.
  7. Heavy duty manhole lids and frames to be used in trafficked areas.
  8. All cesspit leads shall have min cover 0.9m.
  9. All lines to be abandoned shall be sealed at each end. timing of all sealing to be coordinated with council staff.
  10. Refer to C4700 for Soakage Tank details.

A	FOR COSENT	DP	01/25
Rev	Description	By	Date
	By	Date	
Survey	MAVEN	10/2024	
Design	KQ	11/2024	
Drawn	DP	04/2024	
Checked	SB	12/2024	

M

MAVEN

®

Maven Matamata

matamatainfo@maven.co.nz

www.maven.co.nz

8 Tainui Street, Matamata

New Zealand

Project

ASHBOURNE  
RETIREMENT VILLAGE  
MATAMATA  
FOR  
UNITY DEVELOPMENT LTD

Title			
PROPOSED OVERLAND FLOW CROSS SECTION (3 OF 3)			
Project no.	J00606		
Scale	AS SHOWN		
Cad file	C4900 - SW OVERLAND FLOW PATH -.DWG		
Drawing no.	C4903	Rev	A