

NOTES: 200 - CONTOURS

1.

REFER TO ARCHITECT'S PLANS AND RETAINING WALL PLANS AND LONG SECTIONS FOR LOT LEVELS; ROADING LONG SECTIONS FOR JOAL SURFACE LEVELS. ALL LEVELS ARE IN TERMS OF AUCKLAND VERTICAL DATUM NZVD 2016.
2.

ALL EARTHWORKS SHALL COMPLY WITH THE EROSION AND SEDIMENT CONTROL GUIDELINES FOR LAND DISTURBING ACTIVITIES, AC GD2016/005.
3.

NO EARTHWORKS CAN COMMENCE UNTIL AN AS-BUILT SURVEY OF ALL SEDIMENT AND EROSION CONTROL DEVICES HAS BEEN COMPLETED, AND APPROVAL TO COMMENCE HAS BEEN ISSUED BY AUCKLAND COUNCIL OFFICERS.
4.

UNDER-FILL DRAINAGE IS TO BE INSTALLED AT THE DIRECTION OF THE GEOTECHNICAL ENGINEER. SHOULD THE CONTRACTOR ENCOUNTER SPRINGS OR OTHER SOURCES OF WATER, THEY ARE TO NOTIFY THE GEOTECHNICAL ENGINEER IMMEDIATELY.
5.

ALL UNSUITABLE MATERIALS AS DEFINED IN THE CONTRACT SPECIFICATION IS TO BE REMOVED AND STRIPPED AREAS INSPECTED BY THE GEOTECHNICAL ENGINEER PRIOR TO ANY FILLING TAKING PLACE.
6.

EARTHWORKS SHALL NOT EXTEND PAST THE AREA SHOWN ON THE PLANS WITHOUT PRIOR APPROVAL FROM THE ENGINEER.
7.

EARTHWORKS ARE NOT TO BE EXTENDED INTO ADJOINING LOTS UNLESS THE ENGINEER HAS ISSUED SPECIFIC INSTRUCTIONS TO DO SO.
8.

THE CONTRACTOR IS RESPONSIBLE FOR IDENTIFYING AND PROTECTING EXISTING SERVICES AND DRAINAGE ON SITE.
9.

THE CONTRACTOR SHALL CONFIRM THE LOCATION, LEVELS AND DETAILING OF ALL PROPOSED GEOTECHNICAL WORKS WITH THE GEOTECHNICAL ENGINEERS ON SITE PRIOR TO PROCEEDING WITH THOSE WORKS.

NOTES: 210 - CUT AND FILL

1.

ALL LEVELS ARE IN TERMS OF AUCKLAND VERTICAL DATUM NZVD 2016. THE CONTOUR INTERVAL IS: 1.0m
2.

CUT / FILL BETWEEN EXISTING SURFACE AND FINISHED DESIGN SURFACE.

NOTES: 220 - SITE CLEARING

1.

ALL TREES AND ASSOCIATED FENCING NOT IDENTIFIED FOR CLEARING WITHIN THE WORKS AREA ARE TO BE RETAINED UNLESS DIRECTED BY THE ENGINEER.
2.

ANY TREES THAT ARE NOTED TO BE RETAINED SHALL BE IDENTIFIED ON SITE AND FENCED AROUND THE DRIPLINE FOR PROTECTION.
3.

ANY ASBESTOS OR CONTAMINATED MATERIAL IS TO BE REMOVED FROM SITE IN ACCORDANCE WITH A COUNCIL APPROVED REMEDIATION ACTION PLAN.
4.

NO FIRES ARE PERMITTED UNLESS CONSENT IS OBTAINED FROM THE FIRE SERVICE.

NOTES: 230 - ESC

1.

ALL EROSION AND SEDIMENT CONTROL MEASURES SHALL COMPLY WITH THE EROSION AND SEDIMENT CONTROL GUIDELINES FOR LAND DISTURBING ACTIVITIES, AUCKLAND COUNCIL GD005.
2.

ALL EROSION AND SEDIMENT CONTROL MEASURES MUST BE OPERATIONAL PRIOR TO ANY OTHER WORKS COMMENCING ON SITE. THE CONTRACTOR SHALL ARRANGE FOR AND ATTEND A PRELIMINARY SEDIMENT CONTROL MEETING ONSITE WITH THE ENGINEER AND COUNCIL REPRESENTATIVE.
3.

A COPY OF THE SEDIMENT CONTROL PLAN SHALL BE AVAILABLE ON SITE DURING WORK HOURS. ALL PERSONNEL INVOLVED IN EARTHWORK ACTIVITIES ON THE SITE (INCLUSIVE OF SUB-CONTRACTORS) SHALL BE FAMILIAR WITH THE PLANS REQUIREMENTS.
4.

ALL "CLEAN WATER" RUNOFF FROM STABILIZED SURFACES INCLUDING CATCHMENT AREAS ABOVE THE SITE SHALL BE DIVERTED AWAY FROM THE EARTHWORK AREAS VIA A STABILIZED SYSTEM TO PREVENT EROSION.
5.

THE MAIN SILT CONTROL MEASURES FOR THIS SITE ARE:

a.

REMOVAL OF SEDIMENT FROM SILT LADEN WATERS USING SUPER SILT FENCES AS SHOWN;

b.

STABILISATION OF THE SITE AGAINST EROSION AS SOON AS PRACTICABLE AND IN A PROGRESSIVE MANNER AS EARTHWORKS ARE FINISHED OVER VARIOUS AREAS OF THE SITE;

c.

NEW CESSPITS MUST BE PROTECTED TO PREVENT SILT LADEN RUNOFF ENTERING THE NEW STORMWATER LINES; AND

d.

MAINTENANCE OF ALL SEDIMENT CONTROL MEASURES AS REQUIRED.
7.

FURTHER SEDIMENT CONTROL MEASURES MAY BE REQUIRED BY THE ENGINEER AS THE PROJECT ADVANCES. THESE WILL BE INSTALLED AS AND WHERE DIRECTED BY THE ENGINEER. THE CONTRACTOR IS SOLELY RESPONSIBLE FOR ENSURING THAT THE SITE HAS EFFECTIVE MEASURES OPERATING AT ALL TIMES.

NOTES: 250 - RET WALL PLAN

1.

LEVELS ARE IN TERMS OF AUCKLAND VERTICAL DATUM NZVD 2016.
2.

REFER TO STRUCTURAL ENGINEER'S PLANS AND SECTIONS FOR RETAINING WALL DESIGN DETAIL
3.

ALL RETAINING WALLS FACING THE ROAD FRONTAGE WILL BE KEYSTONE
4.

EARTHWORKS SHALL NOT EXTEND PAST THE AREA SHOWN ON THE PLANS WITHOUT PRIOR APPROVAL FROM THE ENGINEER.
5.

EARTHWORKS ARE NOT TO BE EXTENDED INTO ADJOINING LOTS UNLESS THE ENGINEER HAS ISSUED SPECIFIC INSTRUCTIONS TO DO SO.
6.

THE CONTRACTOR IS RESPONSIBLE FOR IDENTIFYING AND PROTECTING EXISTING SERVICES AND DRAINAGE ON SITE. STRUCTURAL ENGINEER TO DETAIL ANY REQUIRED PIPE BRIDGING.
7.

THE CONTRACTOR SHALL CONFIRM THE LOCATION, LEVELS AND DETAILING OF ALL PROPOSED GEOTECHNICAL WORKS WITH THE GEOTECHNICAL ENGINEERS ON SITE PRIOR TO PROCEEDING WITH THOSE WORKS.

NOTES: 300 - ROADING

1.

ALL WORK AND MATERIALS TO COMPLY WITH AT TRANSPORT DESIGN MANUAL STANDARDS. ANY AMBIGUITY BETWEEN ISSUED DRAWINGS AND CONCIL STANDARDS IS TO BE REPORTED TO THE ENGINEER FOR CLARIFICATION.
2.

THE CONTRACTOR SHALL EXTEND ROAD CONSTRUCTION 2m PAST THE STAGE BOUNDARY FOR FUTURE INTERNAL SUBDIVISION CONNECTIONS.
3.

ROAD SETOUT DATA SHOWN ON 3000 SERIES DRAWINGS IS TO BE PROVIDED ELECTRONICALLY.
4.

ALL ROAD MARKING AND ROAD SIGNAGE IS TO BE CONSTRUCTED AS PER TRANSIT NEW ZEALAND'S MANUAL OF SIGNS AND MARKINGS, AND AT TDM.
5.

VEHICLE ACCESSWAYS FOR JOAL SHALL BE AS PER AT COMMERCIAL VEHICLE STANDARD DRAWINGS VX0201-VX0205. ALL OTHER VEHICILE CROSSINGS SHALL BE AS PER AT DRAWINGS VX0101-VX0105.
6.

REFER TO LANDSCAPE ARCHITECTS PLANS FOR STREET TREE DETAILS. TREES SHOWN ON PLAN ARE INDICATIVE ONLY.
7.

STREET LIGHTS SHOWN ON PLAN ARE INDICATIVE ONLY.

NOTES: 360 - ROAD TYP XS

1.

SUBGRADE CBR ASSUMED AS 4%. SUBGRADE TO BE TESTED BY SCALA PENETROMETER BY CONTRACTOR FOLLOWING BULK EARTHWORKS PRIOR TO FINAL ROAD TRIMMING. RESULTS TO BE PROVIDED TO THE ENGINEER TO CONFIRM PAVEMENT DEPTH.
2.

GRADE 4 MEMBRANE CHIPSEAL TO BE PLACED (AT 1L/m2 OF RESIDUAL BITUMEN) ON BASECOURSE PRIOR TO ASPHALT SURFACING.
3.

SUBSOIL DRAINAGE TO BE IN ACCORDANCE WITH ATCOP DRAWING RD025 HOWEVER THE TRENCH BACKFILL IS TO BE IN ACCORDANCE WITH NZTA F2 SPECIFICATION.
4.

REFER TO STREETLIGHTING PLANS FOR LIGHTING DETAILS. COLUMNS TO BE MINIMUM 1.0m OFFSET FROM FACE OF KERB TO FACE OF POLE UNLESS SPECIFIED.
5.

REFER TO 390 SERIES DRAWINGS FOR KERB DETAILS
6.

REFER TO LANDSCAPING PLANS FOR STREET TREE AND PLANTING DETAILS.
7.

FOR ROAD LAYOUT, REFER TO DRAWING 300
8.

FINAL DEFLECTION ON ROAD PAVEMENT TO BE 1.2mm ON LOCAL ROADS. CONTRACTOR TO UNDEDRTAKE BENKELMAN BEAM AND FWD TESTING PRIOR TO SURFACING FOR APPROVAL BY THE ENGINEER.

NOTES: 380 - RD MARKING

1.

ALL ROAD MARKING AND ROAD SIGNAGE IS TO BE CONSTRUCTED AS PER NZTA MANUAL OF SIGNS AND MARKINGS, AND ATCOP.
2.

PRIOR TO ROAD MARKING BEING UNDERTAKEN, THE CONTRACTOR IS TO CONFIRM WITH THE ENGINEER THAT ALL APPROVALS FOR ROAD MARKING HAVE BEEN OBTAINED.
3.

PRIOR TO ROAD MARKING BEING UNDERTAKEN, THE CONTRACTOR IS TO CONFIRM WITH THE ENGINEER THAT ALL APPROVALS FOR ROAD MARKING HAVE BEEN OBTAINED.
4.

ALL WHITE ROAD MARKINGS SHOULD BE REFLECTORIZED IN CONFORMANCE WITH MOTSAM AND ATCOP REQUIREMENTS.

NOTES: 400 - STORMWATER

1.

ALL WORKS AND MATERIALS TO COMPLY WITH AUCKLAND COUNCIL CODE OF PRACTICE FOR LAND FOR LAND DEVELOPMENT AND SUBDIVISION CHAPTER 4-STORMWATER.
2.

ALL PIPES CROSSING UNDER CARRIAGEWAY/TRAFFIC AREAS TO BE HARDFILL BACKFILLED 1.0m BEYOND THE EXTENT OF CARRIAGEWAY. ALL PIPE CROSS OVERS ARE TO BE HARDFILL BACKFILLED 1.0m EITHER SIDE OF CROSS OVER.
3.

THESE DRAWINGS DO NOT NECESSARILY SHOW ALL EXISTING SERVICES. IT IS THE RESPONSIBILITY OF THE CONTRACTOR TO ACCURATELY LOCATE AND PROJECT ALL EXISTING SERVICES DURING THE CONSTRUCTION PROCESS.

NOTES: 410 - SW LONGS

1.

ALL STORMWATER LINES ARE TO BE CLASS 2 REINFORCED CONCRETE RUBBER RING JOINTS (RCRRJ) UNLESS SPECIFIED OTHERWISE.
2.

ALL MANHOLES ARE TO BE 1050 DIA. WITH HEAVY DUTY LIDS UNLESS SPECIFIED OTHERWISE.
3.

BEDDING FOR STORMWATER TO COMPLY WITH AUCKLAND COUNCIL CODE OF PRACTICE FOR LAND DEVELOPMENT AND SUBDIVISION.
4.

ALL CESSPIT LEADS ARE TO BE CLASS 2 UNLESS OTHERWISE INDICATED.
5.

PIPE GRADES ON THE LONG SECTIONS ARE CALCULATED FROM MANHOLE CENTRE TO MANHOLE CENTRE. THIS MAY RESULT IN CREEP (ON STEEP SIDES PARTICULARLY) AND THE CONTRACTOR IS RESPONSIBLE FOR ENSURING THAT LASER LEVELS ARE SET TO COMPENSATE FOR THIS.

NOTES: 430 - RAINGARDEN

1.

REFER TO 400 SERIES DRAWINGS FOR STORMWATER DRAINAGE DETAILS.
2.

FOR PLANTING DETAILS, REFER LANDSCAPE ARCHITECTS DRAWINGS.
4.

DESIGNED IN ACCORDANCE WITH AUCKLAND COUNCIL GDO1 SECTION C 3.0 -BIORETENTION

NOTES 450 - 10% CATCH

1.

THIS DRAWING IS TO BE READ IN CONJUNCTION WITH THE ENGINEERING INFRASTRUCTURE AND SERVICING REPORT.

NOTES: 460 - 1% OLFP

1.

THIS DRAWING IS TO BE READ IN CONJUNCTION WITH THE ENGINEERING INFRASTRUCTURE AND SERVICING REPORT.
2.

REFER TO DRAWING 400 FOR STORMWATER RETICULATION NETWORK.

NOTES: 500 - WASTEWATER

1.

ALL WORKS AND MATERIALS ARE TO COMPLY WITH WATERCARE SERVICES LIMITED'S CODE OF PRACTICE FOR LAND DEVELOPMENTS AND SUBDIVISION.
2.

ALL WORKS ON EXISTING WASTEWATER LINES TO BE CARRIED OUT BY AN APPROVED LICENSED CONTRACTOR AT THE DEVELOPER'S EXPENSE.
3.

ALL WASTEWATER LINES ARE TO BE 150 mm U-PVC PIPE UNLESS SHOWN OTHERWISE.
4.

ALL MANHOLES ARE TO BE 1050 mm DIAMETER WITH HEAVY DUTY LIDS AND COVERS UNLESS SHOWN OTHERWISE.
5.

BEDDING FOR WASTEWATER PIPES IS TO COMPLY WITH WATERCARE SERVICES LIMITED'S CODE OF PRACTICE FOR LAND DEVELOPMENT AND SUBDIVISION.
6.

ALL PIPE CROSSINGS UNDER CARRIAGEWAYS/TRAFFIC AREAS TO BE HARDFILL BACKFILLED 1.0 m BEYOND THE EXTENT OF THE CARRIAGEWAY.
7.

ALL PIPE CROSSOVERS ARE TO BE HARDFILLED BACKFILLED 1.0 m EITHER SIDE OF THE CROSSOVER.
8.

WHERE CROSSOVERS BETWEEN PIPELINES IS LESS THAN 150 mm, THE GAP IS TO BE POLYSTYRENE PACKED. IN ADDITION TO HARDFILLING CROSSOVERS.
9.

ALL CONNECTIONS ARE TO BE 100 mm DIAMETER U-PVC UNLESS SHOWN OTHERWISE, AND DIMENSIONED FROM THE DOWNSTREAM MANHOLE. ALL LOT CONNECTIONS TO TERMINATE BELOW FINISHED GROUND LEVEL AND STAKED. CONNECTIONS ARE TO BE ASBUILT PRIOR TO TRENCH BACKFILLING.
10.

IT IS THE CONTRACTOR'S RESPONSIBILITY TO LOCATE AND ACCURATELY CONFIRM INVERT AND LID LEVELS OF EXISTING STORMWATER AND WASTEWATER MANHOLES PRIOR TO COMMENCING CONSTRUCTION. WHERE LEVELS DIFFER TO THOSE SHOWN THE CONTRACTOR SHALL ADVISE THE ENGINEER ACCORDINGLY.
11.

THESE DRAWINGS DO NOT NECESSARILY SHOW ALL EXISTING SERVICES. IT IS THE RESPONSIBILITY OF THE CONTRACTOR TO ACCURATELY LOCATE AND PROTECT ALL EXISTING SERVICES DURING THE CONSTRUCTION PERIOD.
12.

ALL LATERAL CONNECTIONS TO 1050Ø MANHOLES SHALL NOT BE DROPPER TYPES, AND SHALL CONNECT TO MANHOLE AT LOWEST POSSIBLE LEVEL.

NOTES: 510 - WW LONGS

1.

PIPE GRADES ON THE LONG SECTIONS ARE CALCULATED FROM MANHOLE CENTRE TO MANHOLE CENTRE. THIS MAY RESULT IN CREEP (ON STEEP SIDES PARTICULARLY) AND THE CONTRACTOR IS RESPONSIBLE FOR ENSURING THAT LASER LEVELS ARE SET TO COMPENSATE FOR THIS.

NOTES: 600 - WATER

1.

ALL WATERMAINS SETOUT DATA SHOWN ON 600 SERIES DRAWINGS IS TO BE PROVIDED ELECTRONICALLY.
2.

BEDDING AND SURROUND FOR ALL PIPES TO BE IN ACCORDANCE WITH WATERCARE CODE OF PRACTICE FOR LAND DEVELOPMENT AND SUBDIVISION.
3.

CONNECTIONS TO EXISTING COUNCIL WATERMAINS ARE TO BE MADE ONLY AFTER TESTING, STERILISATION AND ACCEPTANCE BY WATERCARE AND AUCKLAND COUNCIL.
4.

ALL WORKS AND MATERIALS TO COMPLY WITH WATERCARE CODE OF PRACTICE:

I)

50mmØ (63 OD). MDPE 80B AS/NZS 4130/2003 PN12.5 SDR11 COLOURED BLUE.

II)

100-200mmØ PVC-u AS/NZS 1477:2006 SERIES 1 PN12 COLOURED BLUE.

III)

DUCTILE IRON CLASS K9 OR PN35 AS/NZS2280:2004 CONCRETE LINED.

IV)

PE PIPES WHERE SHOWN SHALL BE PN12.5 PE100
5.

ALL TRENCHES UNDER CARRIAGEWAYS TO BE BACKFILLED WITH HARDFILL.
6.

THESE DRAWINGS DO NOT NECESSARILY SHOW ALL EXISTING SERVICES. IT IS THE RESPONSIBLTY OF THE CONTRACTOR TO ACCURATELY LOCATE AND PROTECT ALL EXISTING SERVICES DURING THE CONSTRUCTION PERIOD.
7.

THE CONTRACTOR IS TO ACCURATELY FIX BY SURVEY ALL CHANGES IN DEPTH AND DIRECTION OF THE PROPOSED WATERMAIN.
8.

ALL TEES, BENDS AND FITTINGS SHALL BE FLANGED DUCTILE IRON MIN PN16 AND PROVIDED WITH ANCHOR BLOCKS (SEE WSL DWG 15-17).
9.

ALL ROAD CROSSINGS SHALL BE PN12.5 PE100 PIPES WITH BUTT WELDED JOINTS (SEE WSL DWG WS 6)
10.

ALL PEAT VALVES AND SLUICE VALVES TO BE RESILIENT SEATED.

NOTES: 800 - UTILITIES

1.

POWER, TELECOM AND GAS LAYOUT ARE SUBJECT TO FINAL LAYOUT ASBUILT TO BE PROVIDED BY UTILITY PROVIDERS.
2.

TRANSFORMERS, SWITCH GEAR, TELECOM CABINETS TO BE LOCATED WITHIN LOTS.
3.

THESE DRAWINGS DO NOT NECESSARILY SHOW ALL EXISTING SERVICES. IT IS THE RESPONSIBILITY OF THE CONTRACTOR TO ACCURATELY LOCATE AND PROTECT ALL EXISTING SERVICES DURING THE CONSTRUCTION.

CLIENT:

PROJECT:

TITLE:

PURPOSE OF ISSUE:



MCKENZIE & CO.

VINEWAY LIMITED

DELMORE  
STAGE 1  
53A, 53B & 55 RUSSELL RD  
OREWA

NOTES  
OVERALL PLAN

FOR RESOURCE CONSENT

SCALE:

NTS

DO NOT SCALE

DRAWING NO:

REV:

3725-1-0000

A



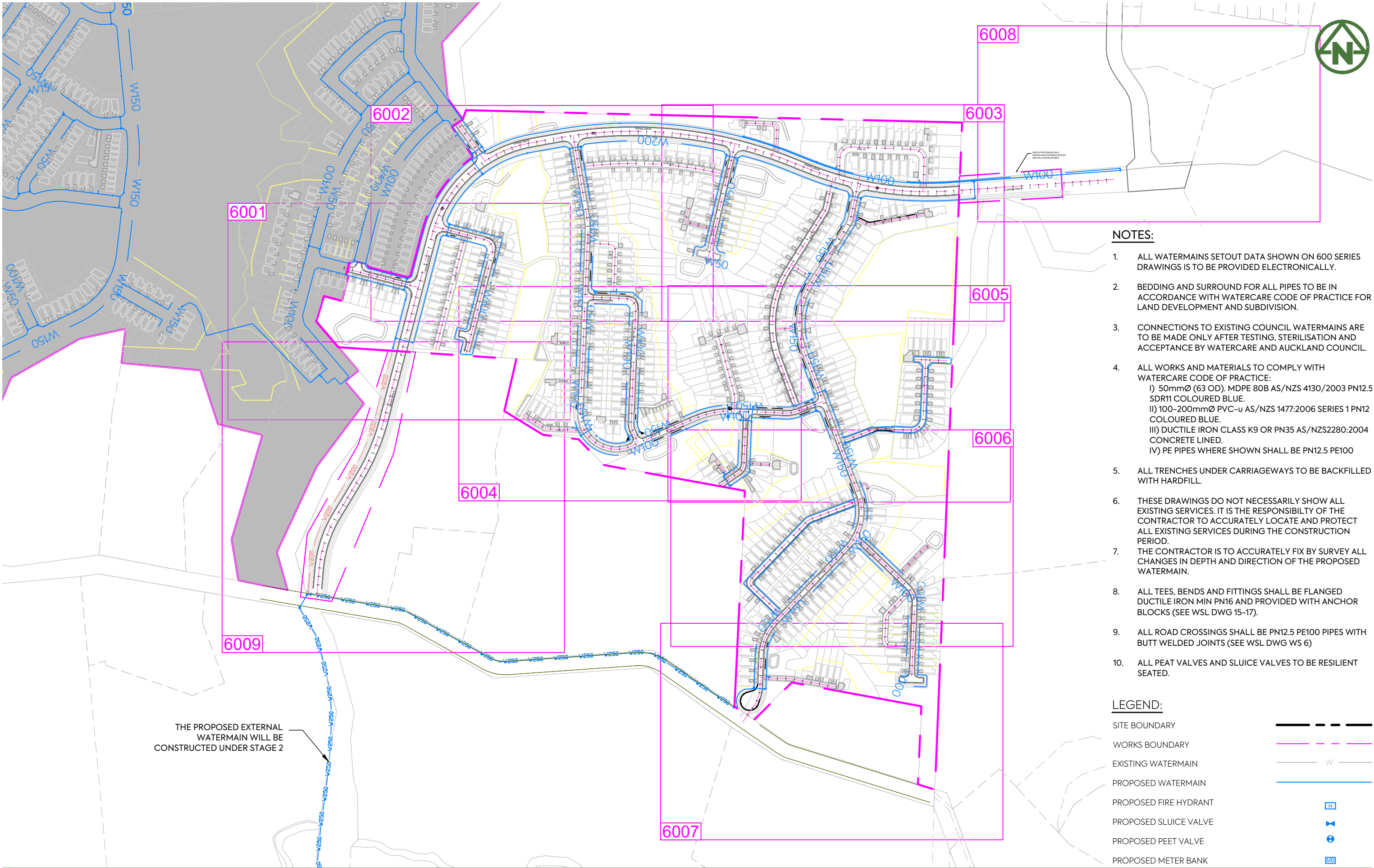

CLIENT:

VINEWAY LIMITED

PROJECT:

DELMORE  
STAGE 1  
53A, 53B & 55 RUSSELL RD  
OREWA

TITLE:

WATERMAIN  
OVERALL PLAN

FOR RESOURCE CONSENT

SCALE:  
1:4000m @ A3

DO NOT SCALE

DRAWING NO:  
3725-1-6000

PURPOSE OF ISSUE:

REV:  
B

B

FOR CONSENT

ZW

JK

31/01/25

A

FIRST ISSUE

REV

DESCRIPTION

DRN BY

CHK BY

APP BY

DATE

MCKENZIE & CO.

VINEWAY LIMITED

DELMORE  
STAGE 1  
53A, 53B & 55 RUSSELL RD  
OREWA

WATERMAIN  
OVERALL PLAN

FOR RESOURCE CONSENT

SCALE:  
1:4000m @ A3

DO NOT SCALE

DRAWING NO:  
3725-1-6000

PURPOSE OF ISSUE:

REV:  
B

PLOT DATE 2025-02-13 10:47:37 WWW.MCKENZIEANDCO.CO.NZ THIS DRAWING IS SOLELY FOR USE BY THE CLIENT ON THIS PROJECT ONLY. NO LIABILITY IS ACCEPTED IN ITS USE BY ANY OTHER ENTITY OR FOR ANY OTHER PURPOSE C:\12DS\DATA\MCKFS01\3725-1 DELMORE STAGE 1\_5231\06000. ENGINEERING DESIGN\6500. DRAWINGS\6000.DWG

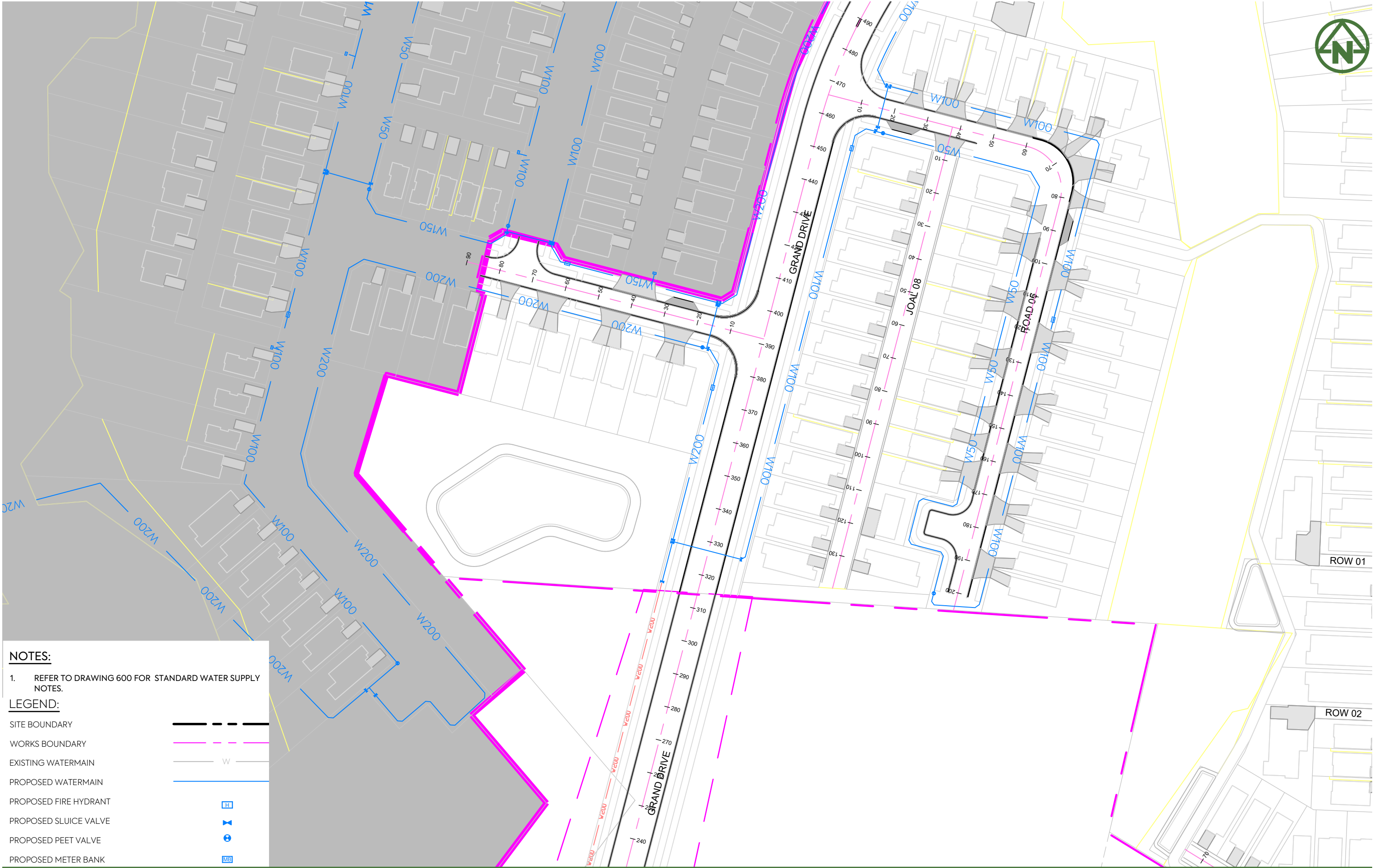

1. REFER TO DRAWING 600 FOR STANDARD WATER SUPPLY NOTES.

LEGEND:

SITE BOUNDARY

WORKS BOUNDARY

EXISTING WATERMAIN

PROPOSED WATERMAIN

PROPOSED FIRE HYDRANT

PROPOSED SLUICE VALVE

PROPOSED PEET VALVE

PROPOSED METER BANK

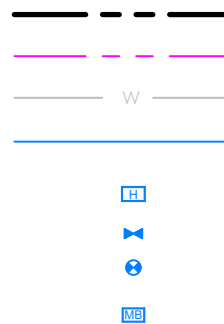

CLIENT:

PROJECT:

TITLE:

PURPOSE OF ISSUE:

FOR RESOURCE CONSENT

SCALE:  
1:1000m @ A3

DO NOT SCALE

DRAWING NO:  
3725-1-6001

EV:

B

**B** FOR CONSENT

ZW JK

31/01/25

A FIRST ISSUE

REV	DESCRIPTION
-----	-------------

DRN BY	CHK BY	APP BY	DATE
--------	--------	--------	------



**MCKENZIE & CO.**

VINEWAY LIMITED

DELMORE  
STAGE 1  
53A, 53B & 55 RUSSELL RD  
OREWA

WATERMAIN  
SHEET 1



NOTES:

1. REFER TO DRAWING 600 FOR STANDARD WATER SUPPLY NOTES.

LEGEND:

SITE BOUNDARY	
WORKS BOUNDARY	
EXISTING WATERMAIN	
PROPOSED WATERMAIN	
PROPOSED FIRE HYDRANT	
PROPOSED SLUICE VALVE	
PROPOSED PEET VALVE	
PROPOSED METER BANK	

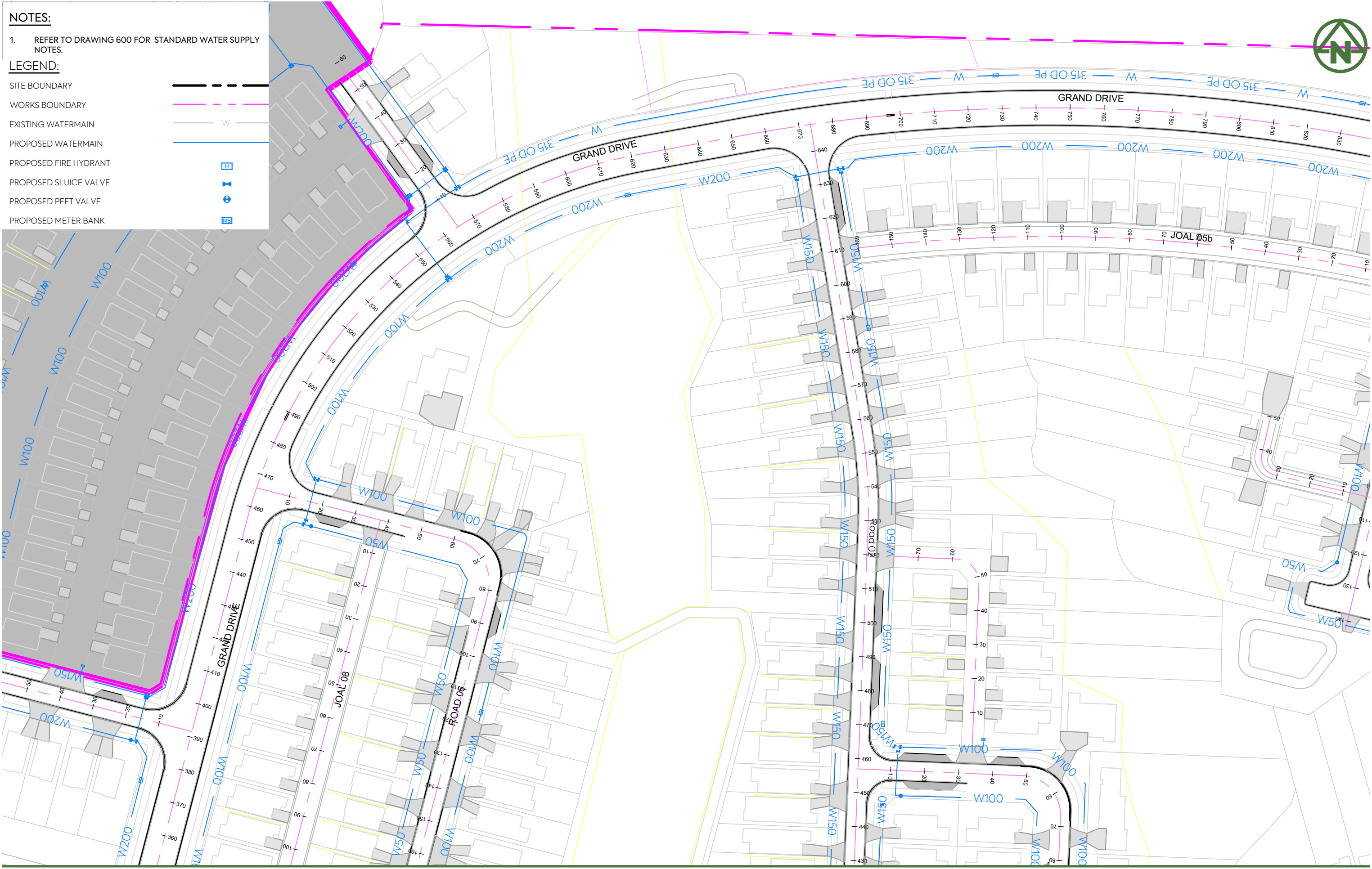

CLIENT:

PROJECT:

TITLE:

PURPOSE OF ISSUE:



MCKENZIE & CO.

VINEWAY LIMITED

DELMORE  
STAGE 1  
53A, 53B & 55 RUSSELL RD  
OREWA

WATERMAIN  
SHEET 2

FOR RESOURCE CONSENT

SCALE:  
1:1000m @ A3

DO NOT SCALE

DRAWING NO:

3725-1-6002

REV:

B

B FOR CONSENT

ZW

JK

31/01/25

A FIRST ISSUE

REV DESCRIPTION

DRN BY CHK BY APP BY DATE

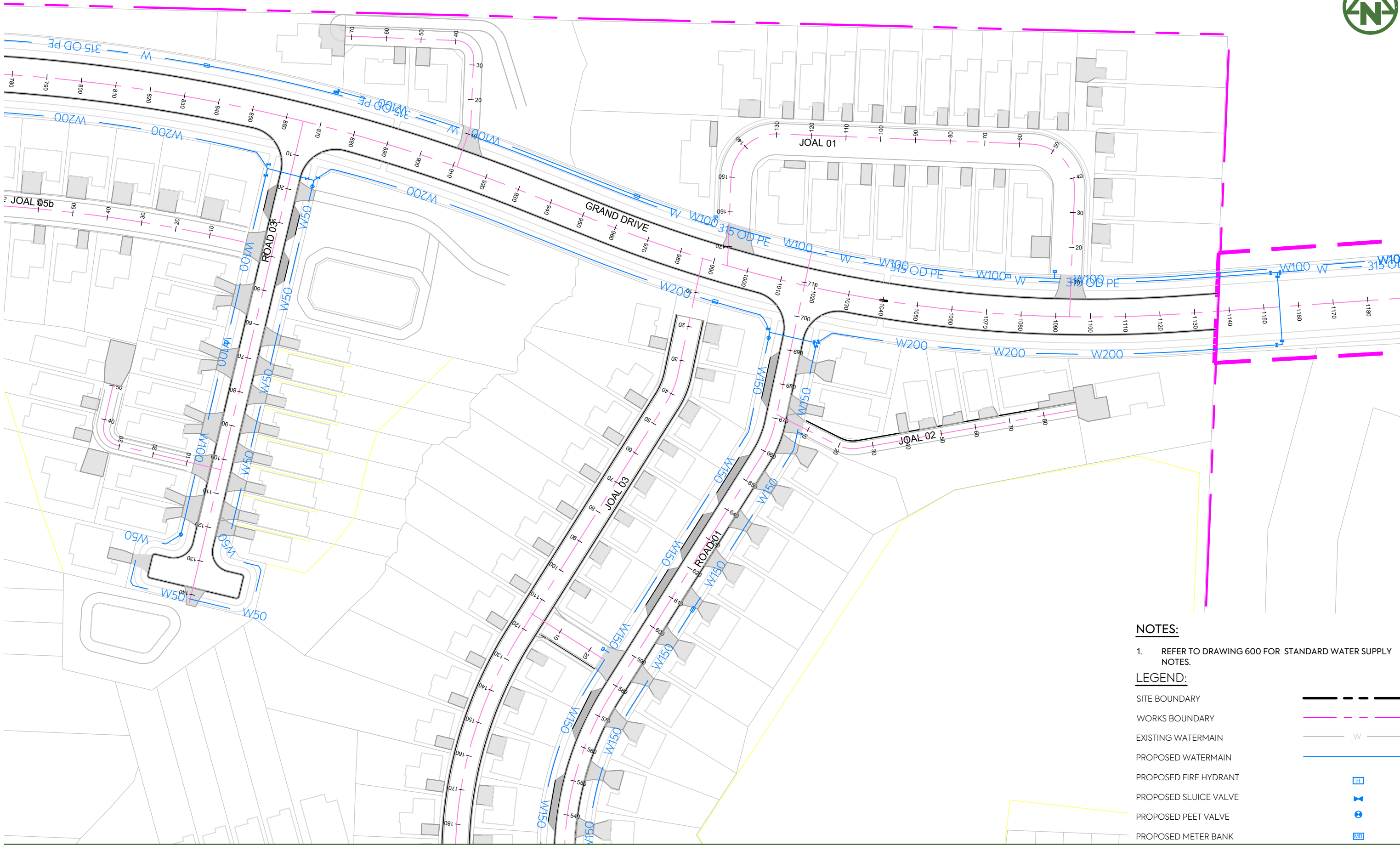

**NOTES:**

- REFER TO DRAWING 600 FOR STANDARD WATER SUPPLY NOTES.

**LEGEND:**

SITE BOUNDARY	---
WORKS BOUNDARY	- - - -
EXISTING WATERMAIN	W
PROPOSED WATERMAIN	W
PROPOSED FIRE HYDRANT	H
PROPOSED SLUICE VALVE	SV
PROPOSED PEET VALVE	PV
PROPOSED METER BANK	MB

CLIENT:

PROJECT:

TITLE:

PURPOSE OF ISSUE:

**FOR RESOURCE CONSENT**

SCALE:  
1:1000m @ A3

DO NOT SCALE

DRAWING NO:

3725-1-6003

REV:

B



**MCKENZIE & CO.**

VINEWAY LIMITED

DELMORE  
STAGE 1  
53A, 53B & 55 RUSSELL RD  
OREWA

WATERMAIN  
SHEET 3

B	FOR CONSENT	ZW	JK	31/01/25	
A	FIRST ISSUE				
REV	DESCRIPTION	DRN BY	CHK BY	APP BY	DATE



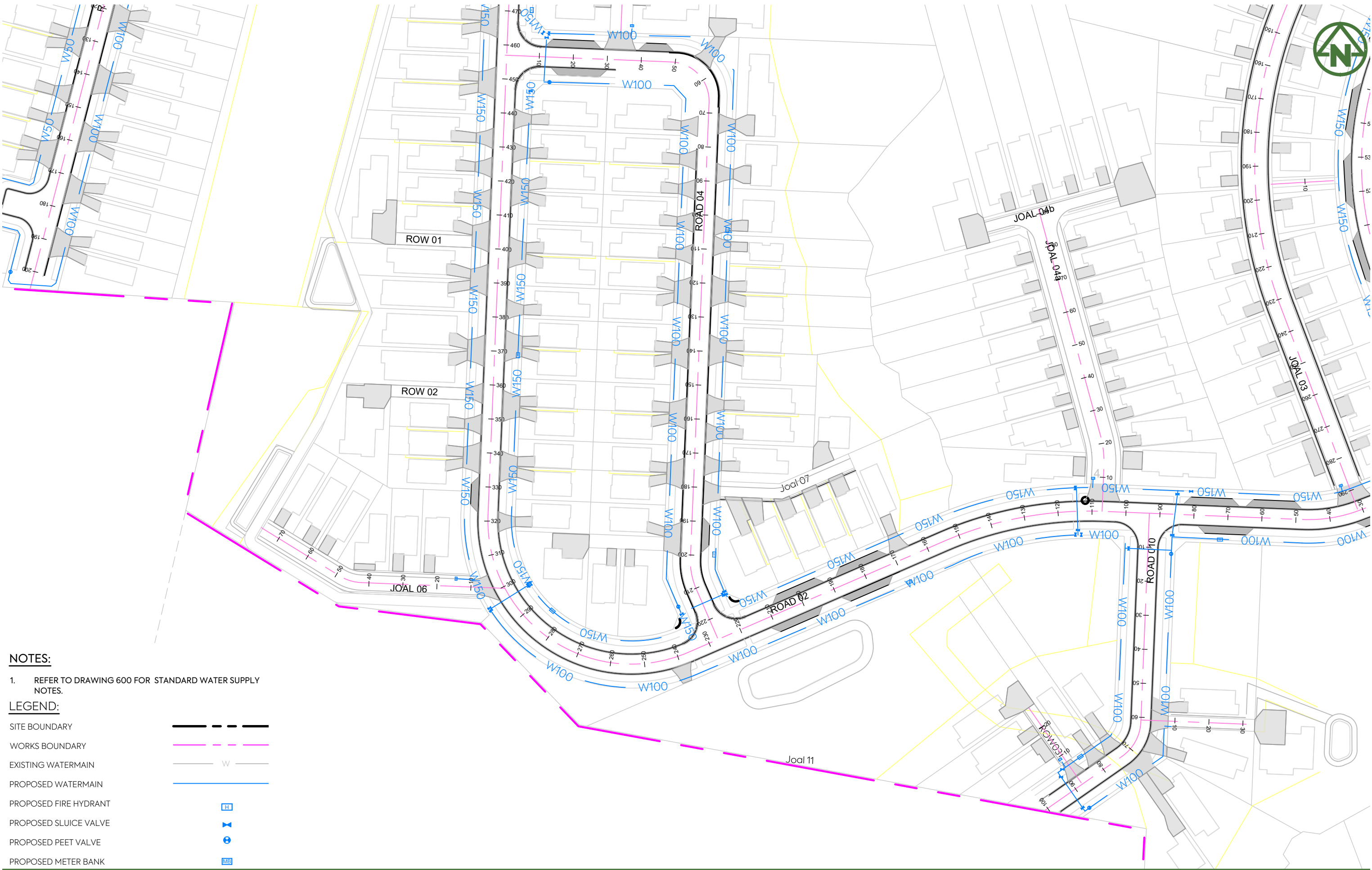

NOTES:

1. REFER TO DRAWING 600 FOR STANDARD WATER SUPPLY NOTES.

LEGEND:

SITE BOUNDARY	---
WORKS BOUNDARY	---
EXISTING WATERMAIN	W
PROPOSED WATERMAIN	---
PROPOSED FIRE HYDRANT	H
PROPOSED SLUICE VALVE	SV
PROPOSED PEET VALVE	P
PROPOSED METER BANK	MB

B	FOR CONSENT	ZW	JK	31/01/25	
A	FIRST ISSUE				
REV	DESCRIPTION	DRN BY	CHK BY	APP BY	DATE



MCKENZIE & CO.

VINEWAY LIMITED

DELMORE  
STAGE 1  
53A, 53B & 55 RUSSELL RD  
OREWA

WATERMAIN  
SHEET 4

PURPOSE OF ISSUE:	FOR RESOURCE CONSENT
SCALE:	1:1000m @ A3
DO NOT SCALE	
DRAWING NO:	3725-1-6004
REV:	B

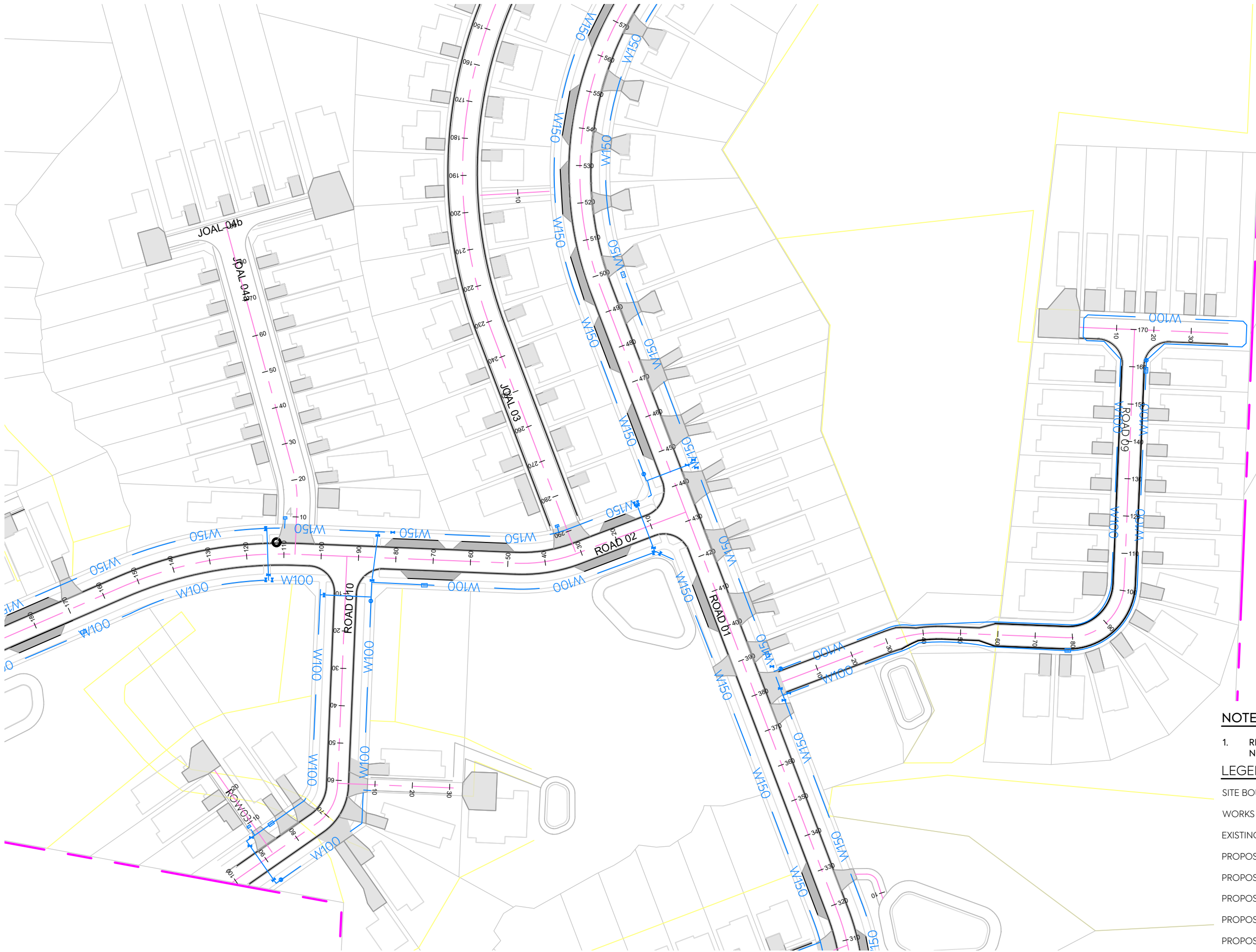

NOTES:

- REFER TO DRAWING 600 FOR STANDARD WATER SUPPLY NOTES.

LEGEND:

SITE BOUNDARY	---
WORKS BOUNDARY	---
EXISTING WATERMAIN	---
PROPOSED WATERMAIN	---
PROPOSED FIRE HYDRANT	□
PROPOSED SLUCE VALVE	×
PROPOSED PEET VALVE	○
PROPOSED METER BANK	□

CLIENT:

PROJECT:

TITLE:

PURPOSE OF ISSUE:

FOR RESOURCE CONSENT

SCALE:  
1:1000m @ A3

DO NOT SCALE

DRAWING NO:

3725-1-6005

REV:

B



MCKENZIE & CO.

VINEWAY LIMITED

DELMORE  
STAGE 1  
53A, 53B & 55 RUSSELL RD  
OREWA

WATERMAIN  
SHEET 5

REV	DESCRIPTION	DRN BY	CHK BY	APP BY	DATE
B	FOR CONSENT	ZW	JK		31/01/25
A	FIRST ISSUE				



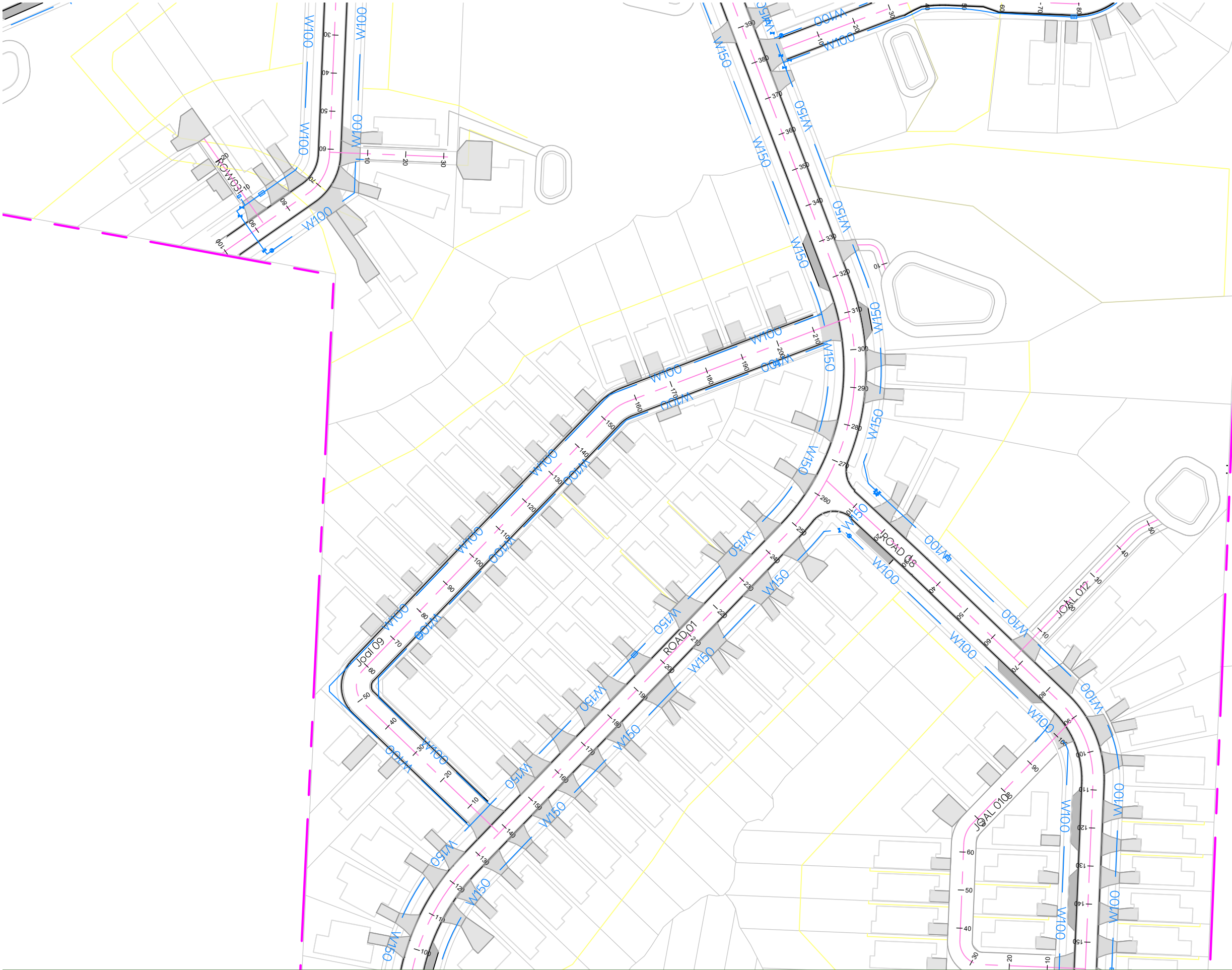

**NOTES:**

1. REFER TO DRAWING 600 FOR STANDARD WATER SUPPLY NOTES.

**LEGEND:**

- SITE BOUNDARY  
WORKS BOUNDARY  
EXISTING WATERMAIN  
PROPOSED WATERMAIN  
PROPOSED FIRE HYDRANT  
PROPOSED SLUICE VALVE  
PROPOSED PEET VALVE  
PROPOSED METER BANK

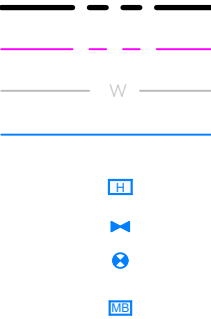

CLIENT:

PROJECT:

TITLE:

PURPOSE OF ISSUE:



**MCKENZIE & CO.**

VINEWAY LIMITED

DELMORE  
STAGE 1  
53A, 53B & 55 RUSSELL RD  
OREWA

WATERMAIN  
SHEET 6

FOR RESOURCE CONSENT

SCALE:  
1:1000m @ A3  
DO NOT SCALE

DRAWING NO:  
3725-1-6006

REV:  
B

REV	DESCRIPTION	DRN BY	CHK BY	APP BY	DATE
B	FOR CONSENT	ZW	JK		31/01/25
A	FIRST ISSUE				



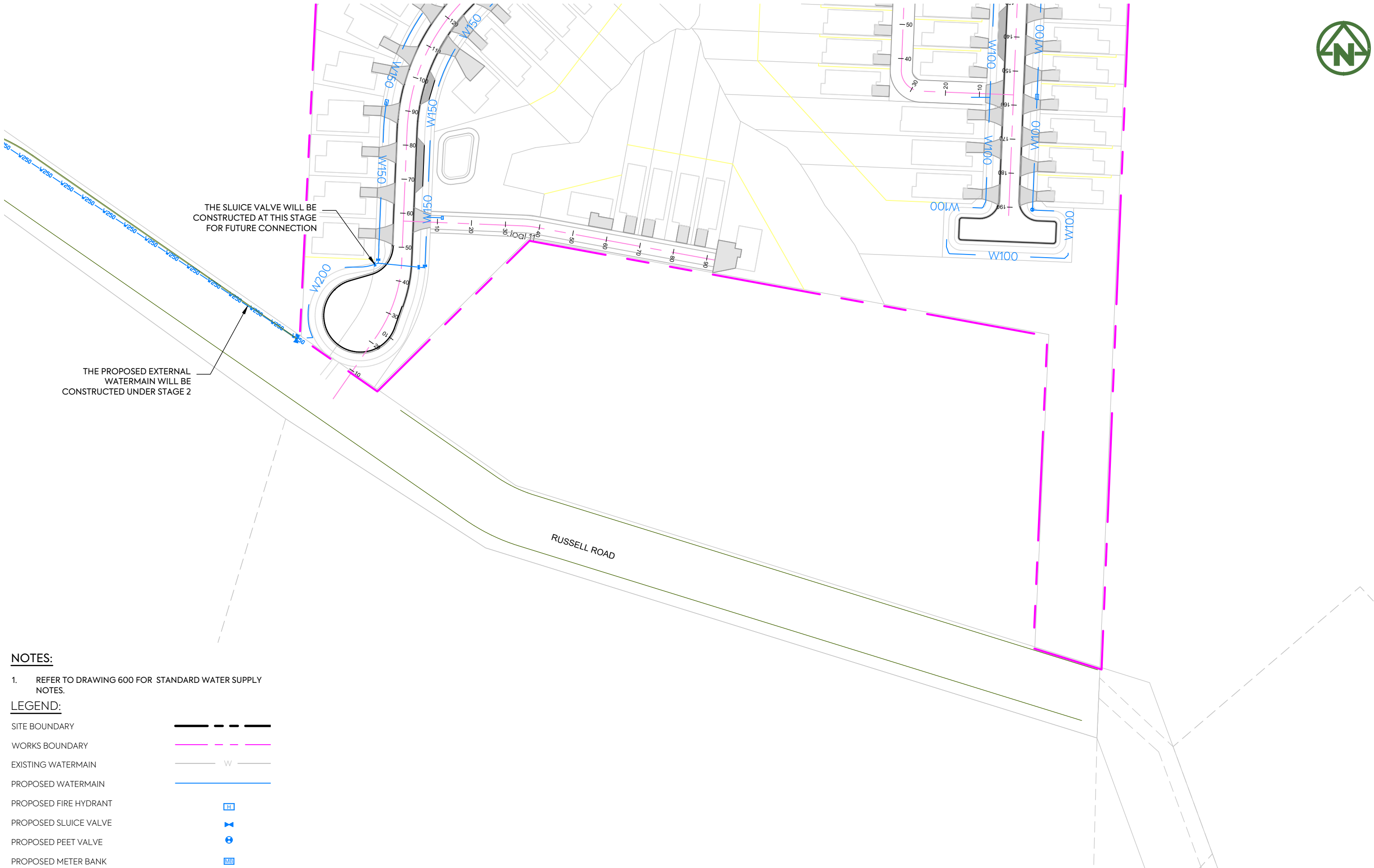

**NOTES:**

1. REFER TO DRAWING 600 FOR STANDARD WATER SUPPLY NOTES.

**LEGEND:**

SITE BOUNDARY	---
WORKS BOUNDARY	---
EXISTING WATERMAIN	W
PROPOSED WATERMAIN	---
PROPOSED FIRE HYDRANT	H
PROPOSED SLUDGE VALVE	SV
PROPOSED PEET VALVE	PV
PROPOSED METER BANK	MB

CLIENT:		PROJECT:		TITLE:		PURPOSE OF ISSUE:	
VINEWAY LIMITED		DELMORE STAGE 1 53A, 53B & 55 RUSSELL RD OREWA		WATERMAIN SHEET 7		FOR RESOURCE CONSENT	
B FOR CONSENT		A FIRST ISSUE		SCALE: 1:1000m @ A3 DO NOT SCALE		DRAWING NO: 3725-1-6007	
REV DESCRIPTION		DRN BY CHK BY APP BY DATE		31/01/25		REV: B	



NOTES:

1. REFER TO DRAWING 600 FOR STANDARD WATER SUPPLY NOTES.

LEGEND:

SITE BOUNDARY	
WORKS BOUNDARY	
EXISTING WATERMAIN	
PROPOSED WATERMAIN	
PROPOSED FIRE HYDRANT	
PROPOSED SLUICE VALVE	
PROPOSED PEET VALVE	
PROPOSED METER BANK	

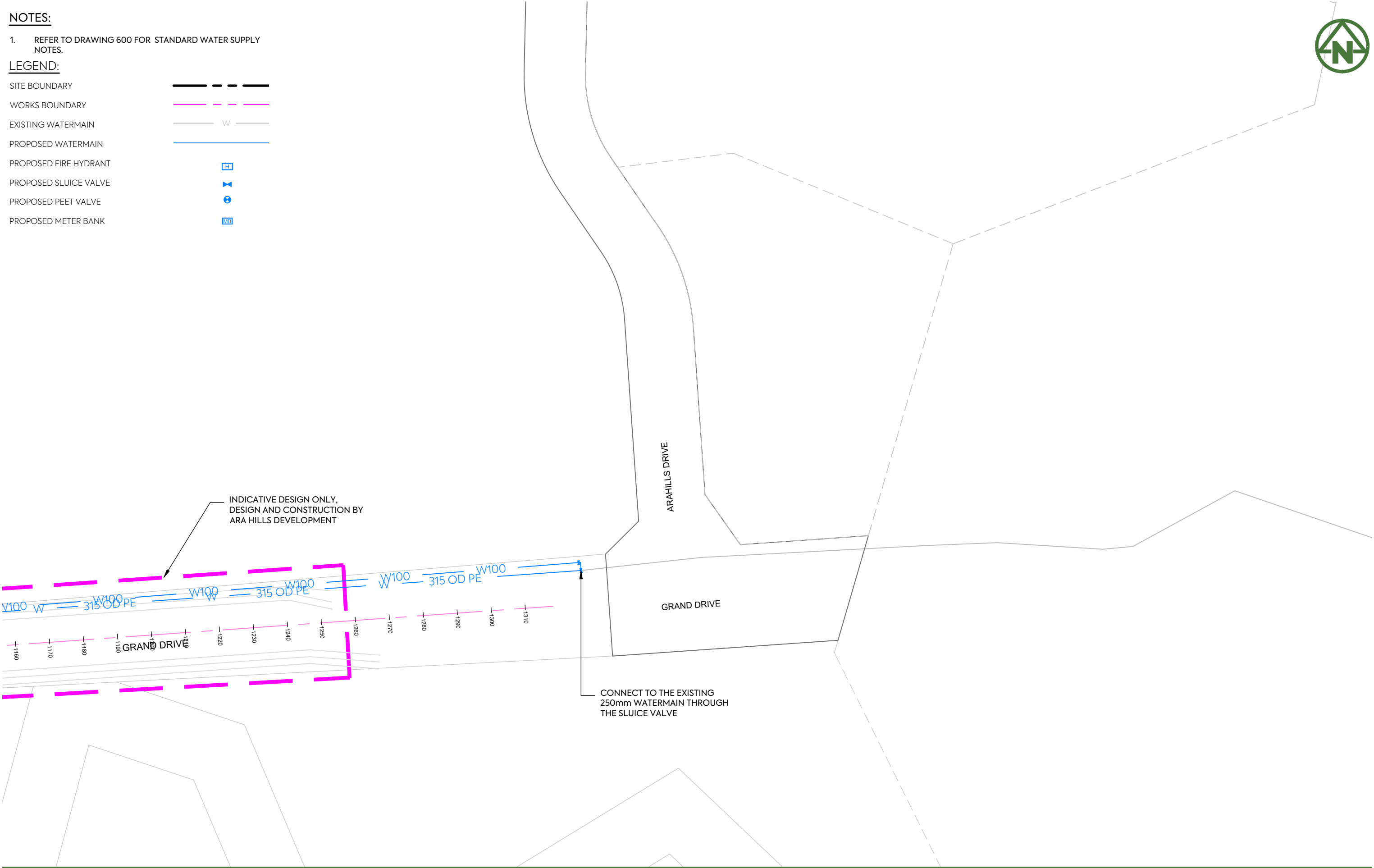

CLIENT:				PROJECT:		TITLE:		PURPOSE OF ISSUE:	
VINEWAY LIMITED				DELMORE STAGE 1 53A, 53B & 55 RUSSELL RD OREWA		WATERMAIN SHEET 8		FOR RESOURCE CONSENT	
B FOR CONSENT				A FIRST ISSUE		SCALE: 1:1000m @ A3 DO NOT SCALE		DRAWING NO:	
ZW JK 31/01/25								REV:	
REV DESCRIPTION				DRN BY CHK BY APP BY DATE				3725-1-6008	
								B	



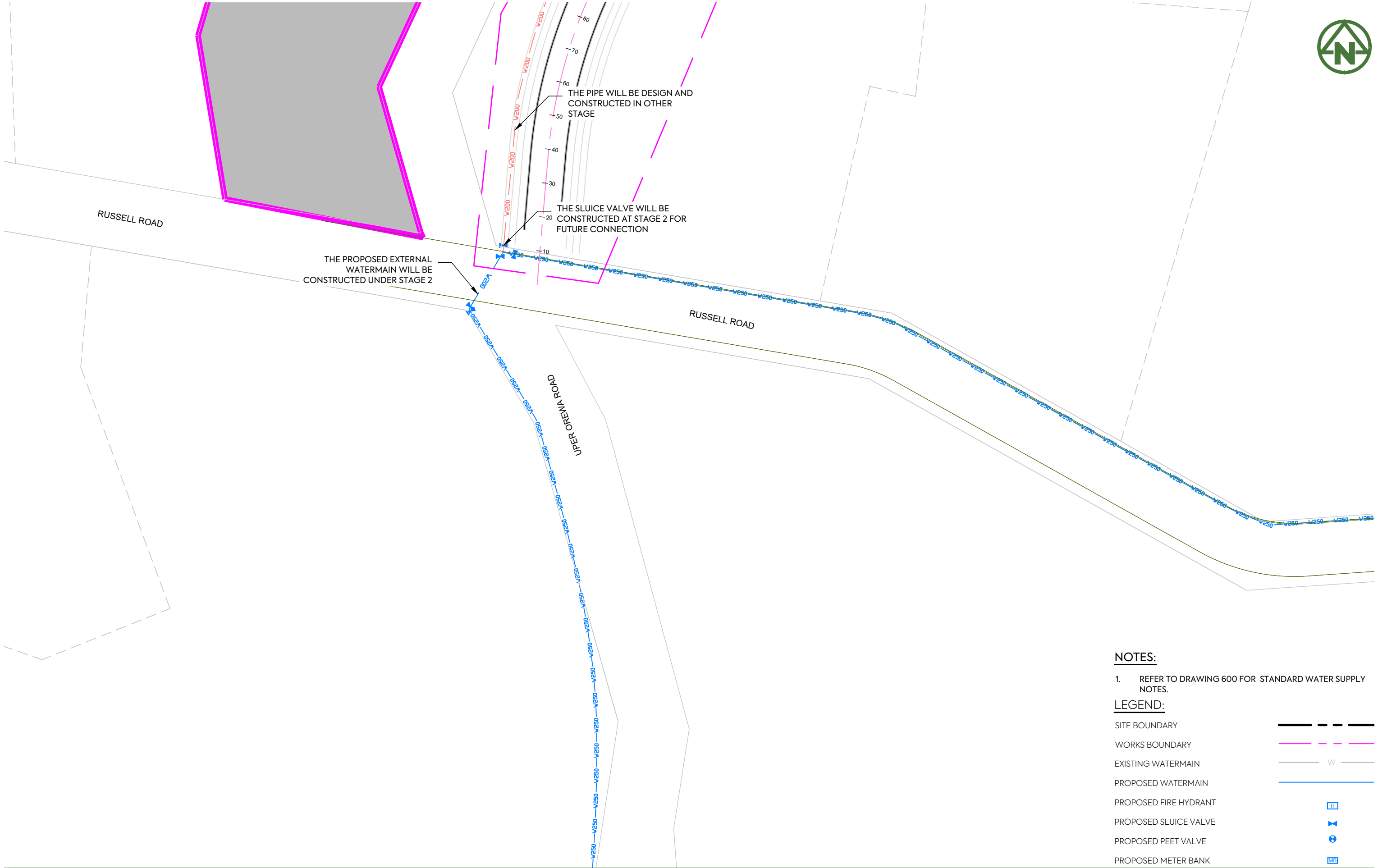

**NOTES:**

1. REFER TO DRAWING 600 FOR STANDARD WATER SUPPLY NOTES.

**LEGEND:**

SITE BOUNDARY	---
WORKS BOUNDARY	---
EXISTING WATERMAIN	— W —
PROPOSED WATERMAIN	— — —
PROPOSED FIRE HYDRANT	[H]
PROPOSED SLUICE VALVE	[X]
PROPOSED PEET VALVE	[+]
PROPOSED METER BANK	[MB]

				CLIENT:			PROJECT:			TITLE:			PURPOSE OF ISSUE:	
				VINEWAY LIMITED		DELMORE STAGE 1 53A, 53B & 55 RUSSELL RD OREWA		WATERMAIN SHEET 9		FOR RESOURCE CONSENT				
				MCKENZIE & CO.								SCALE: 1:1000m @ A3 DO NOT SCALE		
B FOR CONSENT				ZW JK		31/01/25						DRAWING NO:		REV:
A FIRST ISSUE												3725-1-6009		B
REV	DESCRIPTION			DRN BY	CHK BY	APP BY	DATE							