

NATIVE SPECIMEN PALETTE



EXISTING CHARACTER & BUFFER PLANTING

1. HIGHGROVE AVENUE

- The Highgrove Ave development setting still reflects its rural beginnings, with open paddocks, shelterbelts and mature trees shaping how the lots read in the landscape. Within the estate, pasture and established plantings are used to soften boundaries and create a gentle transition between spaces.
- A 3.0-metre buffer is proposed for this area as the existing vegetation already delivers a high level of visual screening through established shelterbelts, edge planting and mature specimen trees. The new planting will operate as supplementary mitigation, reinforcing the current vegetation structure and addressing minor gaps rather than providing primary screening. A 3.0-metre width is therefore considered sufficient and remains consistent with the buffer typology applied across the wider residential development.

2. ELDONWOOD DRIVE

- This is an established residential setting where homes are complemented by significant mature vegetation that contributes to the overall character. Pedestrian pathways run through and around the development, while street trees line the internal roads and strong boundary treatments, including fencing and hedged planting, clearly define individual lots and the development edge.
- A 3.0-metre-wide buffer is proposed for this area because the existing vegetation already provides a high level of visual screening through mature internal and street trees, established edge planting. The new planting will act as supplementary mitigation, enhancing the current vegetation and addressing minor gaps rather than serving as the primary screen. Given the existing vegetation and clearly defined boundaries, a 3.0-metre-wide buffer beyond the site is sufficient to provide additional screening and landscape continuity without compromising functionality of the existing properties.

3. 72A HINUERA ROAD

- The adjoining site is an active organic farming operation, comprising dairy grazing and ongoing pasture management, and is not a residential property.
- A 3.0-metre-wide buffer is proposed along this boundary to provide visual mitigation between the proposed development and the rural working environment. Given the non-residential nature of the neighbouring land use, a wider residential-style setback is not necessary.
- The proposed buffer is consistent with the approach applied along Eldonwood Drive and is considered appropriate to soften views, define the site edge, and maintain a suitable interface with the adjoining farming activity.

LEGEND

 3.0m Wide Buffer Planting



Scale
1:2500@A1
1:5000@A3

Issue Date
20/03/26
Issue
S53

Drawn
SW
Checked
CC



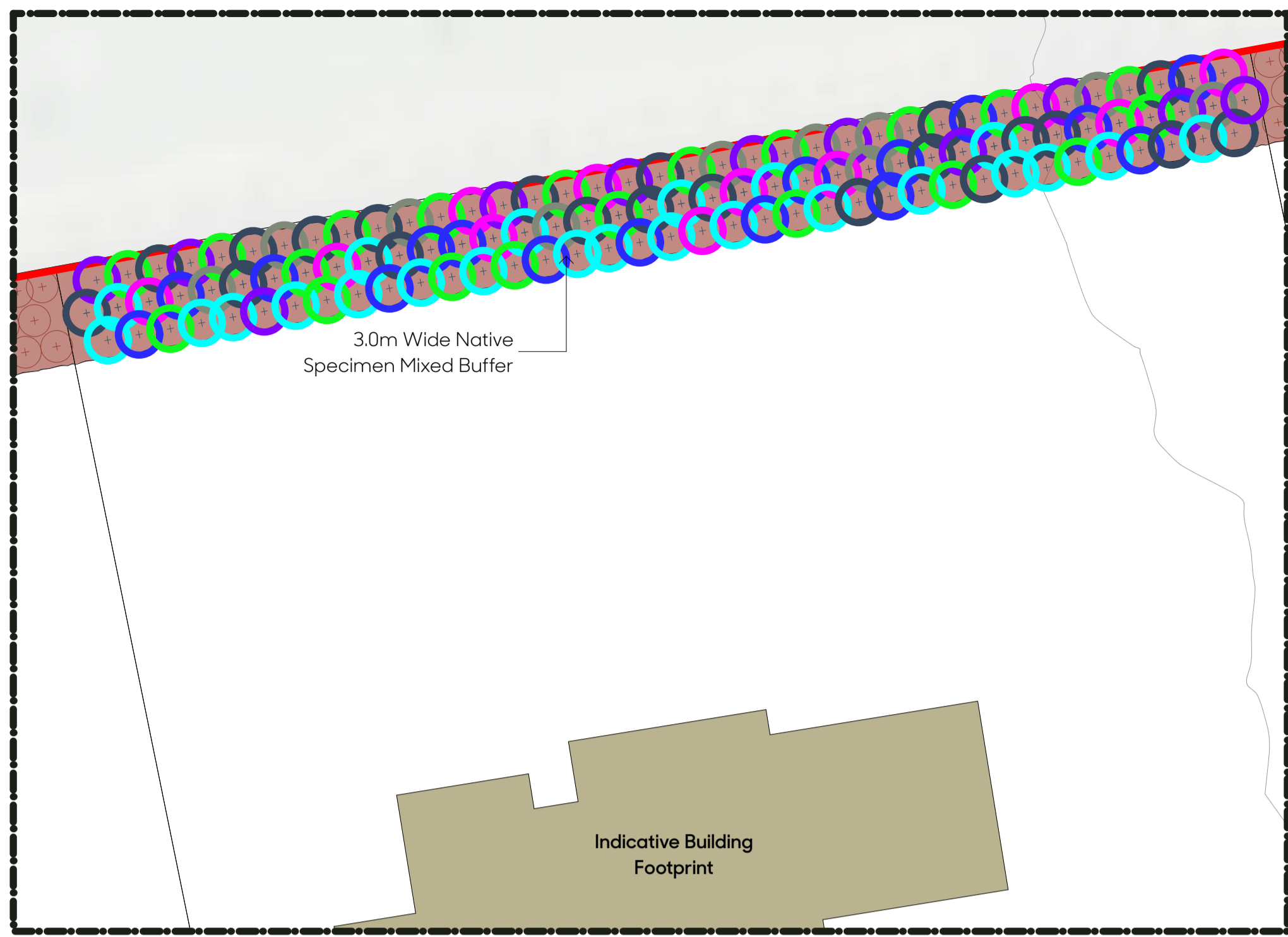

TYPICAL PLAN 01: 3.0m WIDE NATIVE SPECIMEN MIXED BUFFER
OPTION ONE

3.0m Wide Residential Lot Buffer Planting				
Code	Botanical Name	Common Name	Grade	Spacing
Option One - Native Specimen Mixed Buffer				
1	<i>Kunzea ericoides</i>	kānuka	5L	1.2m
2	<i>Leptospermum scoparium</i>	manuka	5L	1.2m
3	<i>Myrsine australis</i>	māpou	5L	1.2m
4	<i>Phormium cookianum</i>	wharariki	5L	1.2m
5	<i>Pittosporum crassifolium</i>	karo	5L	1.2m
6	<i>Knightia excelsa</i>	rewarewa	5L	1.2m
7	<i>Sophora microphylla</i>	kōwhiri	5L	1.2m

Notes:
- Species are to be planted in isolation to create a diverse and natural-looking buffer.
- 0.8 Plants per m² (triangular planting)

NATIVE SPECIMEN PALETTE



OPTION 1 - TYPICAL SECTION: 3.0m WIDE BUFFER 1:25@A1 / 1:50@A3
Note: Planting shown at 10-year maturity (expected maturity to be achieved at 5 - 7 years)

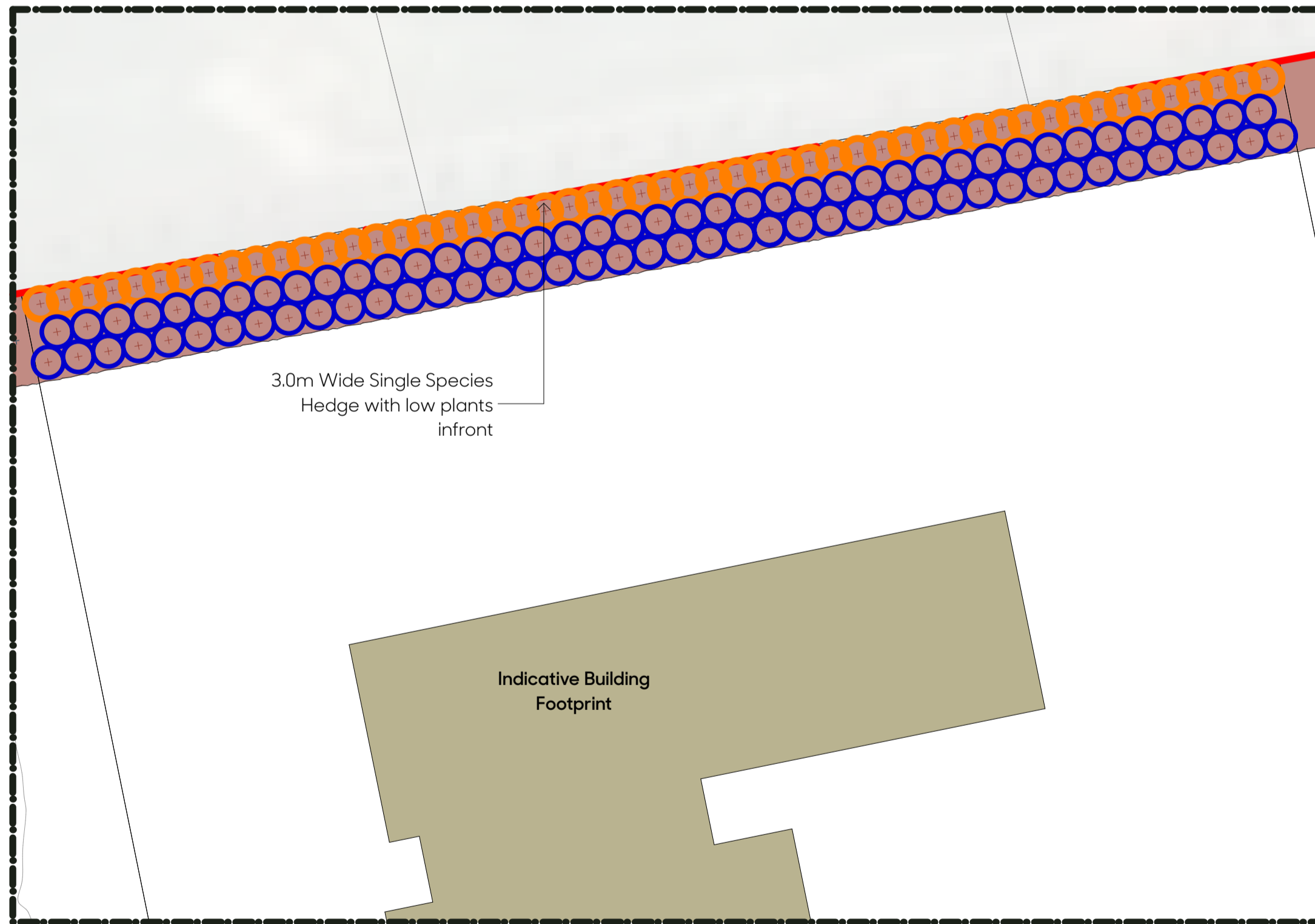

TYPICAL PLAN 02: 3.0m WIDE NATIVE SPECIMEN MIXED BUFFER
OPTION TWO

Option Two - Single Specimen Hedge w/ Front Planting				
Hedge Options (one row)				
1	<i>Camelia Setsugekka</i>	Camelia	15L	0.8m
2	<i>Griselinia 'Broadway Mint'</i>	kapuka	15L	0.8m
3	<i>Pittosporum 'Reverend Green'</i>	kōhōhū	15L	0.8m
4	<i>Photinia 'Red Robin'</i>	Photinia	15L	0.8m
5	<i>Viburnum tinus</i>	Viburnum	15L	0.8m
Front Options (2 rows)				
1	<i>Apodasmia similis</i>	ioi	2L	1.0m
2	<i>Astelia fragrans</i>	busy lily	2L	0.9m
3	<i>Chionochloa flavicans</i>	haumata	2L	1.0m
4	<i>Trachelospermum jasminoides</i>	star jasmine	2L	0.7m
5	<i>Westringia fruticosa 'Mundi'</i>	westringia	2L	0.8m
6	<i>Hebe townsonii</i>	hebe	2L	0.8m
7	<i>Libertia grandiflora</i>	NZ iris	2L	0.6m
8	<i>Phormium 'Emerald Green'</i>	dwarf flax	2L	0.7m

Notes:
Hedge to be maintained at a 2.5m high minimum.
Spacing varies by species; the typical plan illustrates a consistent 1.0 m spacing for the front planting options.

HEDGE OPTIONS

FRONT



OPTION 2 - TYPICAL SECTION: 3.0m WIDE BUFFER 1:25@A1 / 1:50@A3
Note: Planting shown at 10-year maturity (expected maturity to be achieved at 5 - 7 years)