

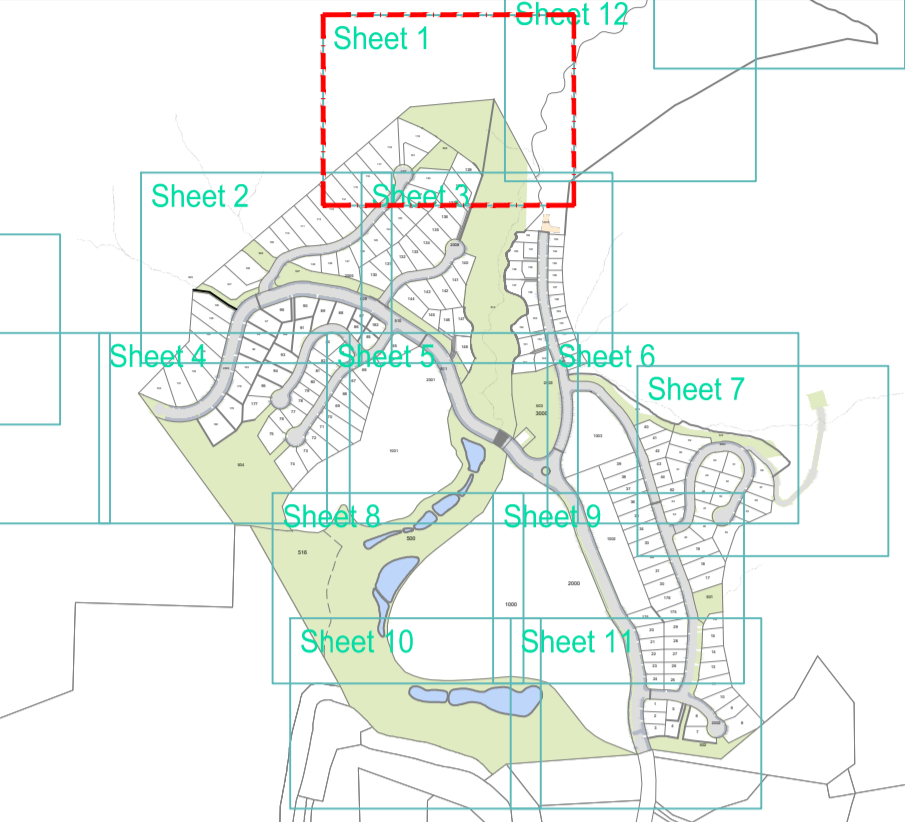

Rev.	Date	Reason	Approved
P1	15/12/23	Issued for Information	DB
P2	5/04/24	Issued for Information	RB
P3	31/01/25	Issued for information	RB
A1	27/06/25	Issued for Resource Consent	RB
A2	9/07/25	Boundaries updated	RB

FOR APPROVAL



GENERAL NOTES:

- This drawing shall only be reproduced in full with approval from a Davis Ogilvie engineer.
- Contractor to locate all existing services & verify all dimensions before commencing works.
- Plans are to be read in conjunction with the Specification, Schedule of Prices and the Nelson Tasman Land Development Manual 2020. Any conflicts are to be brought to the attention of the engineer prior to works proceeding. Engineer to advise contractor accordingly.
- Prior to any works commencing, contractor is to engage a registered professional surveyor and/or licensed cadastral surveyor to supervise all set out & provide asbuilt plans for review.
- Set out is not to be scaled off the plans. The engineer will provide electronic data for the contractor. Any variations are to be approved by the engineer.
- All plan dimensions are in m. All detail dimensions are in mm.
- All plans are in terms of the New Zealand GD 2000 Nelson Circuit, and levels are in terms of the Nelson Vertical Datum 1955.

DRAINAGE NOTES:

- All drainage works shall be carried out in accordance with Davis Ogilvie Specifications, Nelson Tasman Land Development Manual 2020, and specific requirements stipulated within the resource consents.
- All services (power, telecom and water) are to pass over drainage pipes unless specified otherwise.
- All PVC pipes to have minimum 0.75 m cover in trafficable areas. RCRRJ pipes are to be minimum Class 4.
- Pipe bedding is to be as per Section 5.4.4.1 NZS 2566.2 for PVC pipes. Concrete pipe bedding to be Type HS2 as per Table 5 in NZS 3725.
- Stormwater and wastewater laterals to extend a minimum 1.0m into the lot.

LEGEND:

- Stage Boundary
- Proposed Stormwater Pipe
- Proposed Stormwater Manhole
- Sump
- Proposed Wastewater Pipe
- Proposed Wastewater Manhole
- Ex stream
- Proposed swale
- Cut off drain
- Stream Realigned
- Proposed pressure sewer Tonkin + taylor

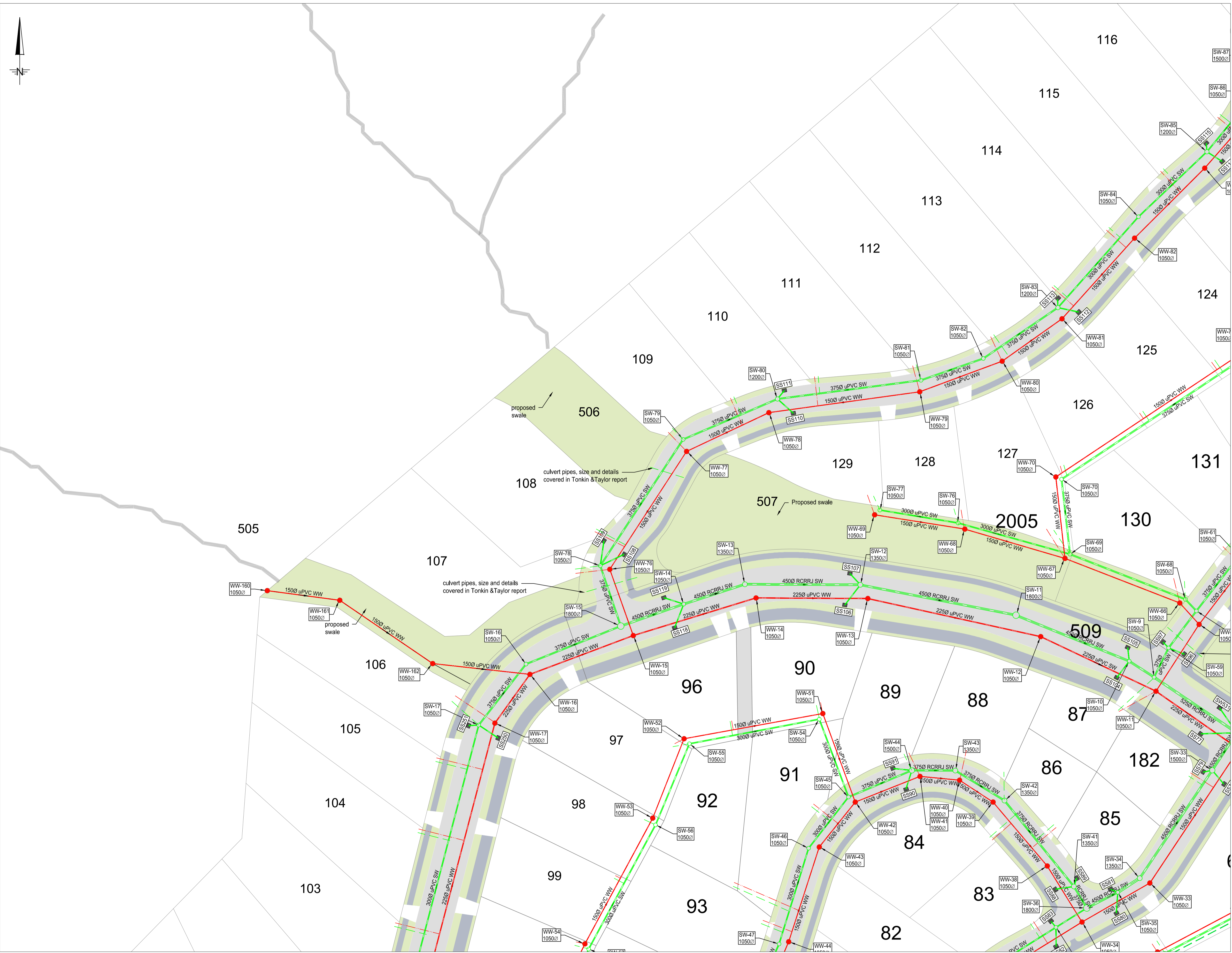

Rev.	Date	Reason	Approved
P1	15/12/23	Issued for Information	DB
P2	5/04/24	Issued for Information	RB
P3	31/01/25	Issued for information	RB
A1	27/06/25	Issued for Resource Consent	RB
A2	9/07/25	Boundaries updated	RB

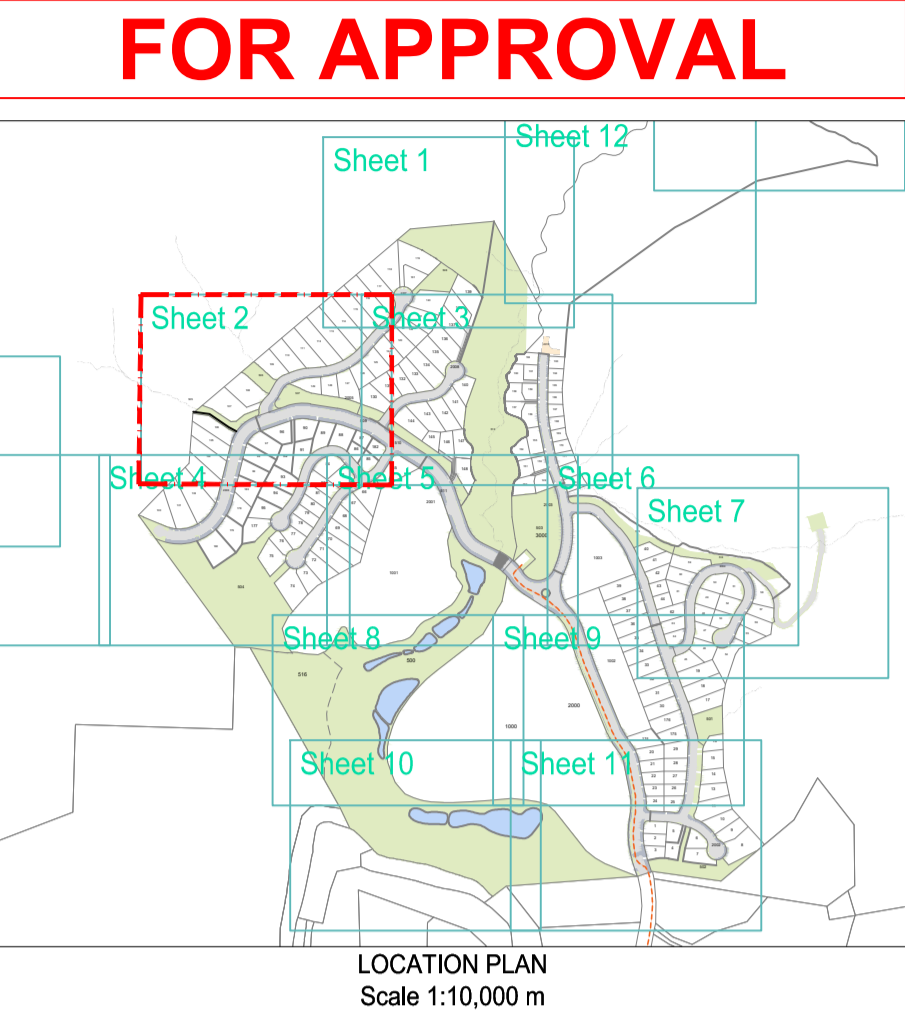

- GENERAL NOTES:
- This drawing shall only be reproduced in full with approval from a Davis Ogilvie engineer.
 - Contractor to locate all existing services & verify all dimensions before commencing works.
 - Plans are to be read in conjunction with the Specification, Schedule of Prices and the Nelson Tasman Land Development Manual 2020. Any conflicts are to be brought to the attention of the engineer prior to works proceeding. Engineer to advise contractor accordingly.
 - Prior to any works commencing, contractor is to engage a registered professional surveyor and/or licensed cadastral surveyor to supervise all set out & provide asbuilt plans for review.
 - Set out is not to be scaled off the plans. The engineer will provide electronic data for the contractor. Any variations are to be approved by the engineer.
 - All plan dimensions are in m. All detail dimensions are in mm.
 - All plans are in terms of the New Zealand GD 2000 Nelson Circuit, and levels are in terms of the Nelson Vertical Datum 1955.
- DRAINAGE NOTES:
- All drainage works shall be carried out in accordance with Davis Ogilvie Specifications, Nelson Tasman Land Development Manual 2020, and specific requirements stipulated within the resource consents.
 - All services (power, telecom and water) are to pass over drainage pipes unless specified otherwise.
 - All PVC pipes to have minimum 0.75 m cover in trafficable areas. RCRRJ pipes are to be minimum Class 4.
 - Pipe bedding is to be as per Section 5.4.4.1 NZS 2566.2 for PVC pipes. Concrete pipe bedding to be Type HS2 as per Table 5 in NZS 3725.
 - Stormwater and wastewater laterals to extend a minimum 1.0m into the lot.

- LEGEND:
- Stage Boundary
 - Proposed Stormwater Pipe
 - Proposed Stormwater Manhole
 - Sump
 - Proposed Wastewater Pipe
 - Proposed Wastewater Manhole
 - Ex stream
 - Proposed swale
 - Cut off drain
 - Stream Realigned
 - Proposed pressure sewer Tonkin + taylor

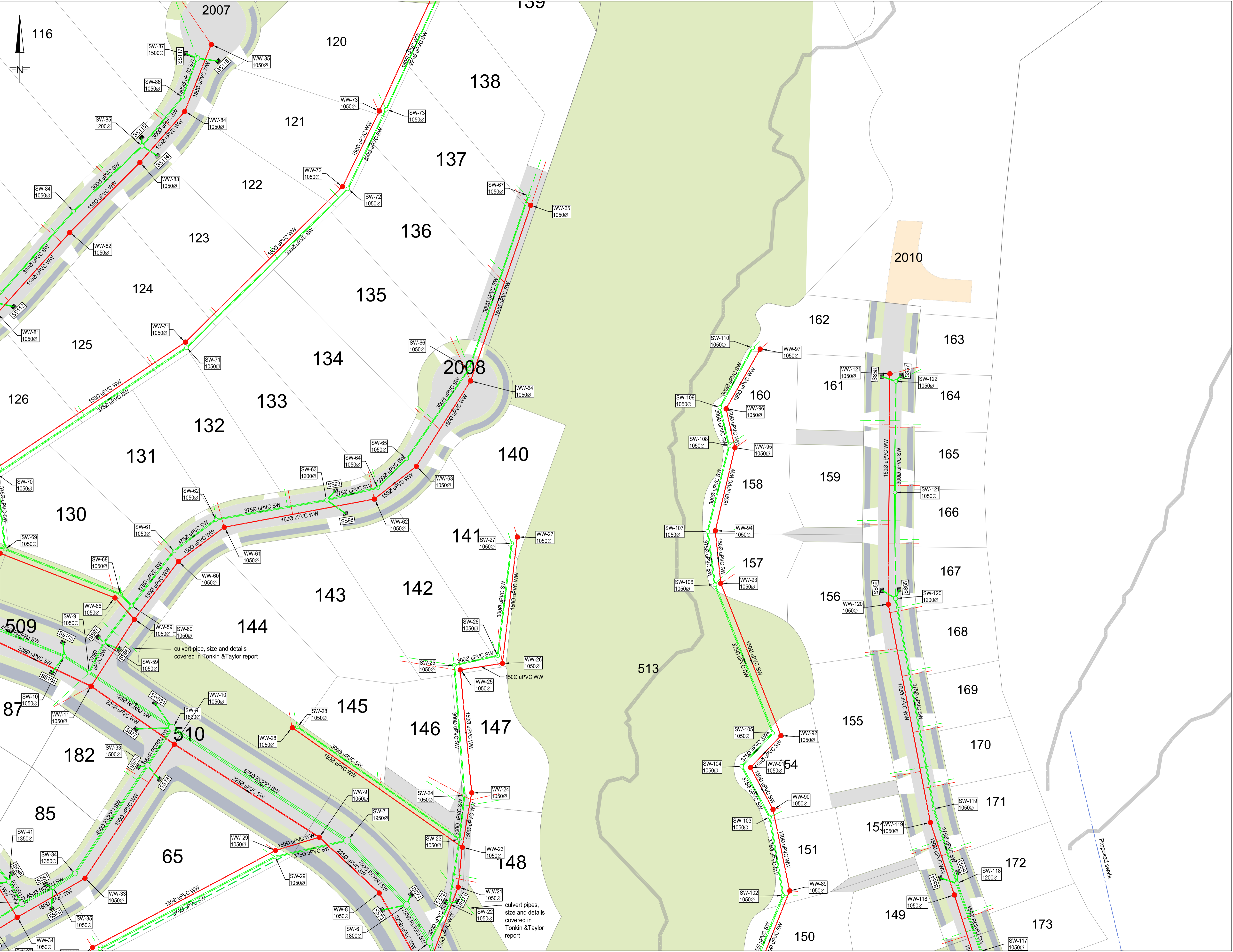

Rev.	Date	Reason	Approved
P1	15/12/23	Issued for Information	DB
P2	5/04/24	Issued for Information	RB
P3	31/01/25	Issued for information	RB
A1	27/06/25	Issued for Resource Consent	RB
A2	9/07/25	Boundaries updated	RB

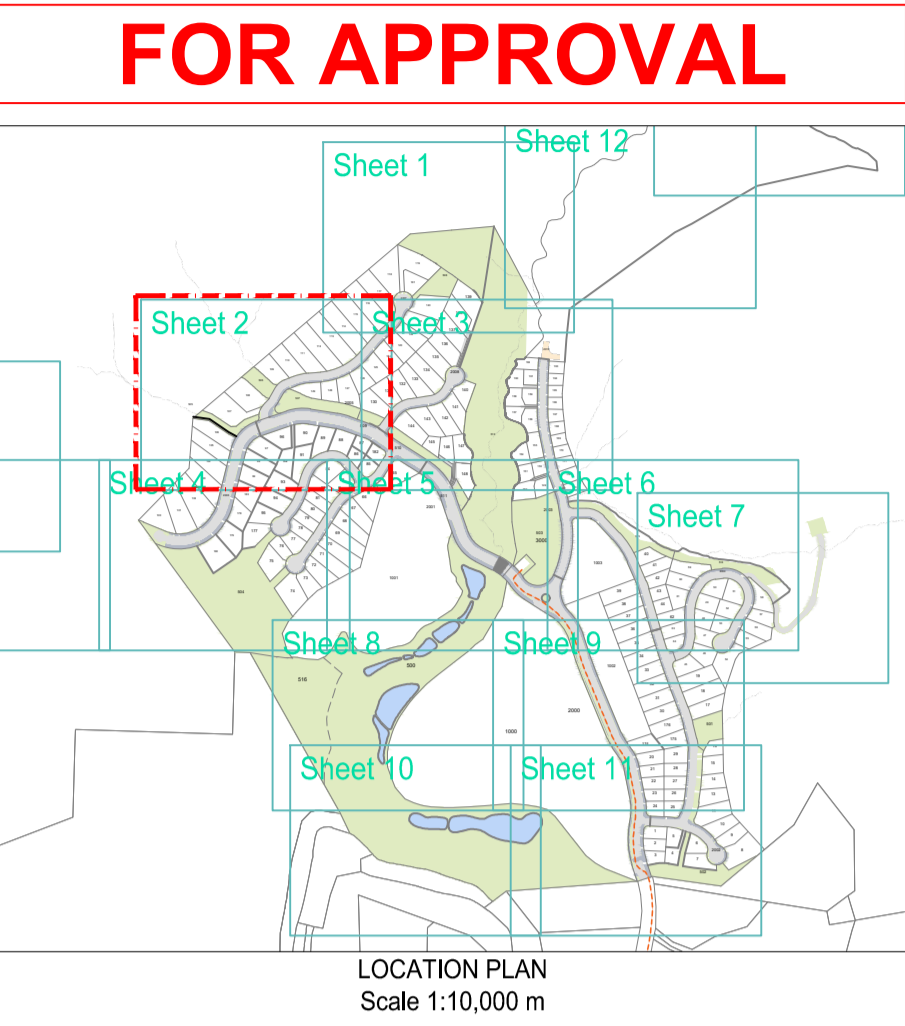

FOR APPROVAL

GENERAL NOTES:

- This drawing shall only be reproduced in full with approval from a Davis Ogilvie engineer.
- Contractor to locate all existing services & verify all dimensions before commencing works.
- Plans are to be read in conjunction with the Specification, Schedule of Prices and the Nelson Tasman Land Development Manual 2020. Any conflicts are to be brought to the attention of the engineer prior to works proceeding. Engineer to advise contractor accordingly.
- Prior to any works commencing, contractor is to engage a registered professional surveyor and/or licensed cadastral surveyor to supervise all set out & provide asbuilt plans for review.
- Set out is not to be scaled off the plans. The engineer will provide electronic data for the contractor. Any variations are to be approved by the engineer.
- All plan dimensions are in m. All detail dimensions are in mm.
- All plans are in terms of the New Zealand GD 2000 Nelson Circuit, and levels are in terms of the Nelson Vertical Datum 1955.

DRAINAGE NOTES:

- All drainage works shall be carried out in accordance with Davis Ogilvie Specifications, Nelson Tasman Land Development Manual 2020, and specific requirements stipulated within the resource consents.
- All services (power, telecom and water) are to pass over drainage pipes unless specified otherwise.
- All PVC pipes to have minimum 0.75 m cover in trafficable areas. RCRRJ pipes are to be minimum Class 4.
- Pipe bedding is to be as per Section 5.4.4.1 NZS 2566.2 for PVC pipes. Concrete pipe bedding to be Type HS2 as per Table 5 in NZS 3725.
- Stormwater and wastewater laterals to extend a minimum 1.0m into the lot.

LEGEND:

- Stage Boundary
- Proposed Stormwater Pipe
- Proposed Stormwater Manhole
- Sump
- Proposed Wastewater Pipe
- Proposed Wastewater Manhole
- Ex stream
- Proposed swale
- Cut off drain
- Stream Realigned
- Proposed pressure sewer Tonkin + Taylor

CAD ref: T:\projects\39s\39470 - Maitahi Development\Civil\39470.Drawing Set 2-Drainage

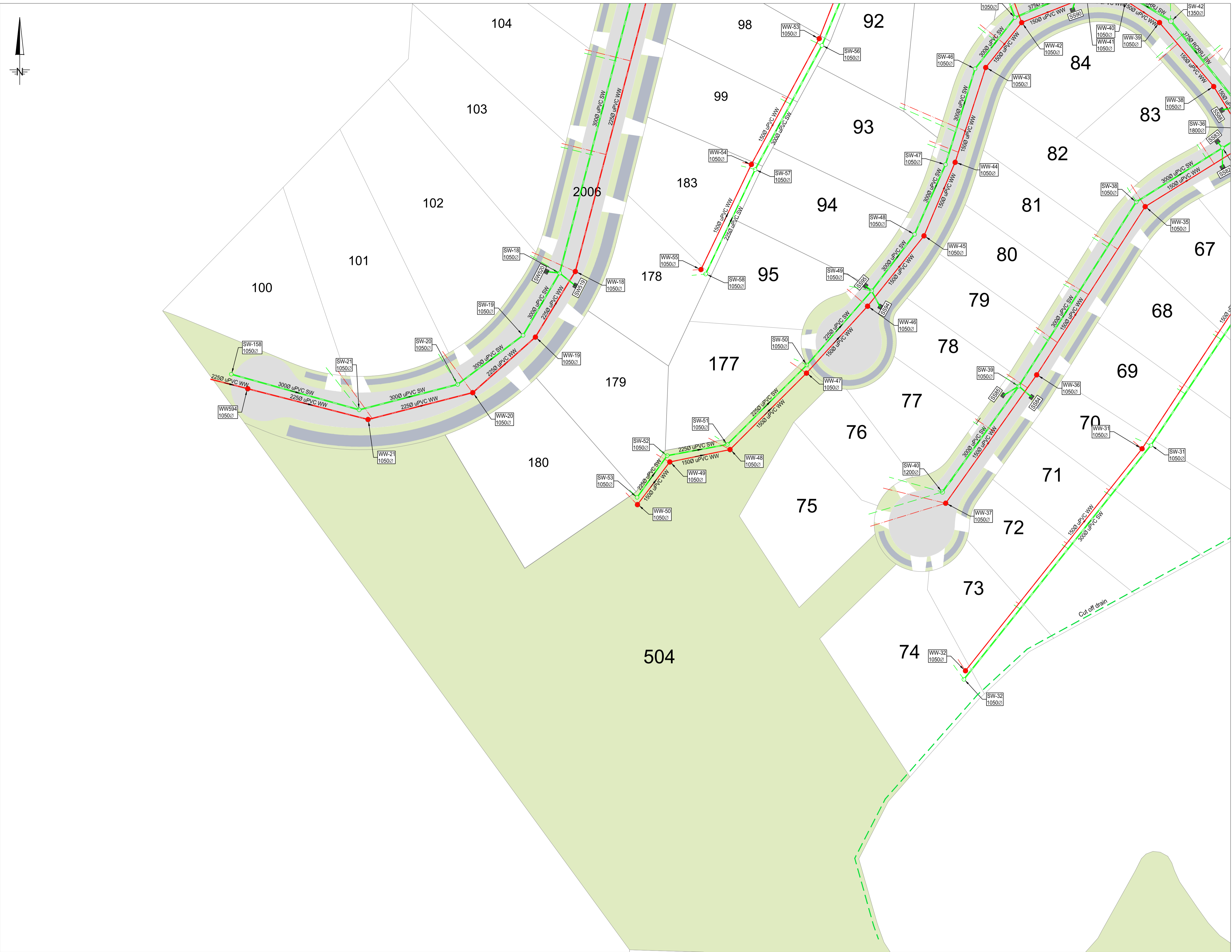

Rev.	Date	Reason	Approved
P1	15/12/23	Issued for Information	DB
P2	5/04/24	Issued for Information	RB
P3	31/01/25	Issued for information	RB
A1	27/06/25	Issued for Resource Consent	RB
A2	9/07/25	Boundaries updated	RB

FOR APPROVAL

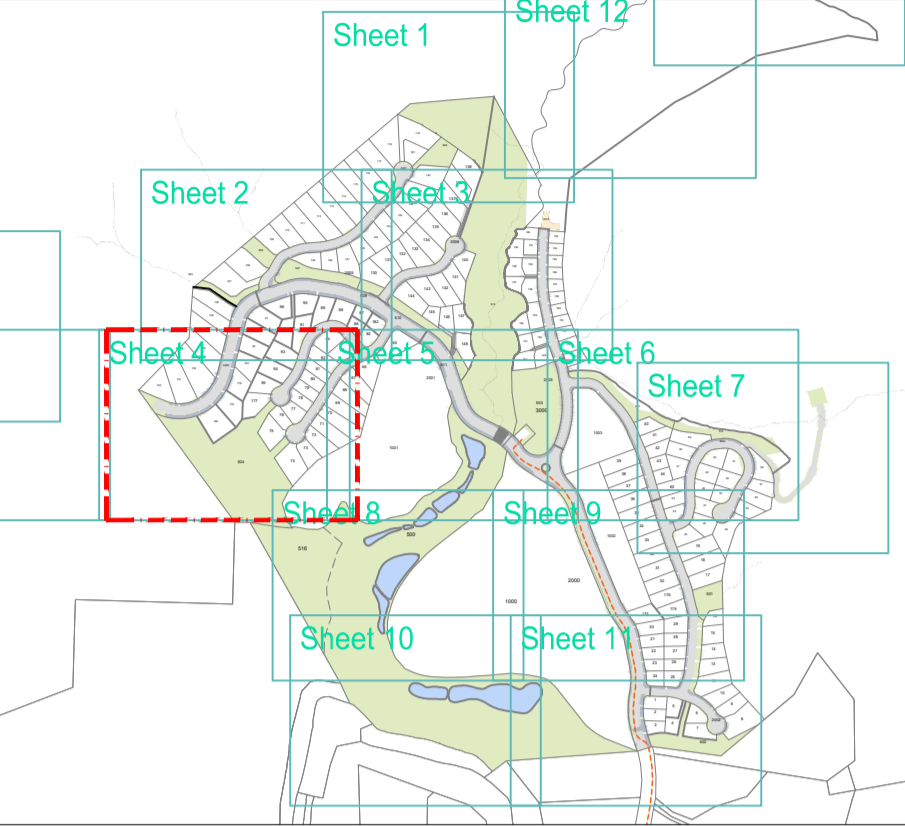

GENERAL NOTES:

- This drawing shall only be reproduced in full with approval from a Davis Ogilvie engineer.
- Contractor to locate all existing services & verify all dimensions before commencing works.
- Plans are to be read in conjunction with the Specification, Schedule of Prices and the Nelson Tasman Land Development Manual 2020. Any conflicts are to be brought to the attention of the engineer prior to works proceeding. Engineer to advise contractor accordingly.
- Prior to any works commencing, contractor is to engage a registered professional surveyor and/or licensed cadastral surveyor to supervise all set out & provide asbuilt plans for review.
- Set out is not to be scaled off the plans. The engineer will provide electronic data for the contractor. Any variations are to be approved by the engineer.
- All plan dimensions are in m. All detail dimensions are in mm.
- All plans are in terms of the New Zealand GD 2000 Nelson Circuit, and levels are in terms of the Nelson Vertical Datum 1955.

DRAINAGE NOTES:

- All drainage works shall be carried out in accordance with Davis Ogilvie Specifications, Nelson Tasman Land Development Manual 2020, and specific requirements stipulated within the resource consents.
- All services (power, telecom and water) are to pass over drainage pipes unless specified otherwise.
- All PVC pipes to have minimum 0.75 m cover in trafficable areas. RCRRJ pipes are to be minimum Class 4.
- Pipe bedding is to be as per Section 5.4.4.1 NZS 2566.2 for PVC pipes. Concrete pipe bedding to be Type HS2 as per Table 5 in NZS 3725.
- Stormwater and wastewater laterals to extend a minimum 1.0m into the lot.

LEGEND:

- Stage Boundary
- Proposed Stormwater Pipe
- Proposed Stormwater Manhole
- Sump
- Proposed Wastewater Pipe
- Proposed Wastewater Manhole
- Ex stream
- Proposed swale
- Cut off drain
- Stream Realigned
- Proposed pressure sewer Tonkin + Taylor



Rev.	Date	Reason	Approved
P1	15/12/23	Issued for Information	DB
P2	5/04/24	Issued for Information	RB
P3	31/01/25	Issued for information	RB
A1	27/06/25	Issued for Resource Consent	RB
A2	9/07/25	Boundaries updated	RB

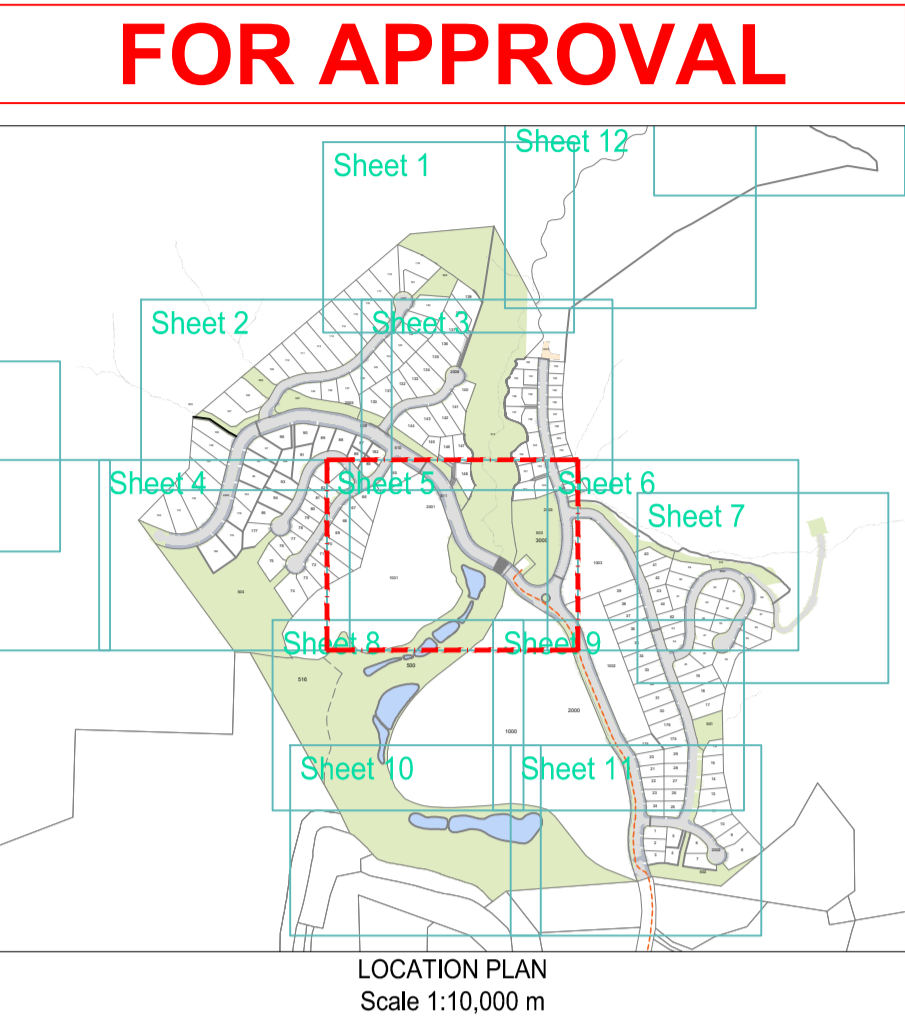

- GENERAL NOTES:**
- This drawing shall only be reproduced in full with approval from a Davis Ogilvie engineer.
 - Contractor to locate all existing services & verify all dimensions before commencing works.
 - Plans are to be read in conjunction with the Specification, Schedule of Prices and the Nelson Tasman Land Development Manual 2020. Any conflicts are to be brought to the attention of the engineer prior to works proceeding. Engineer to advise contractor accordingly.
 - Prior to any works commencing, contractor is to engage a registered professional surveyor and/or licensed cadastral surveyor to supervise all set out & provide asbuilt plans for review.
 - Set out is not to be scaled off the plans. The engineer will provide electronic data for the contractor. Any variations are to be approved by the engineer.
 - All plan dimensions are in m. All detail dimensions are in mm.
 - All plans are in terms of the New Zealand GD 2000 Nelson Circuit, and levels are in terms of the Nelson Vertical Datum 1955.

- DRAINAGE NOTES:**
- All drainage works shall be carried out in accordance with Davis Ogilvie Specifications, Nelson Tasman Land Development Manual 2020, and specific requirements stipulated within the resource consents.
 - All services (power, telecom and water) are to pass over drainage pipes unless specified otherwise.
 - All PVC pipes to have minimum 0.75 m cover in trafficable areas. RCRRU pipes are to be minimum Class 4.
 - Pipe bedding is to be as per Section 5.4.4.1 NZS 2566.2 for PVC pipes. Concrete pipe bedding to be Type HS2 as per Table 5 in NZS 3725.
 - Stormwater and wastewater laterals to extend a minimum 1.0m into the lot.

- LEGEND:**
- Stage Boundary
 - Proposed Stormwater Pipe
 - Proposed Stormwater Manhole
 - Sump
 - Proposed Wastewater Pipe
 - Proposed Wastewater Manhole
 - Ex stream
 - Proposed swale
 - Cut off drain
 - Stream Realigned
 - Proposed pressure sewer Tonkin + taylor



Rev.	Date	Reason	Approved
P1	15/12/23	Issued for Information	DB
P2	5/04/24	Issued for Information	RB
P3	31/01/25	Issued for information	RB
A1	27/06/25	Issued for Resource Consent	RB
A2	9/07/25	Boundaries updated	RB

FOR APPROVAL

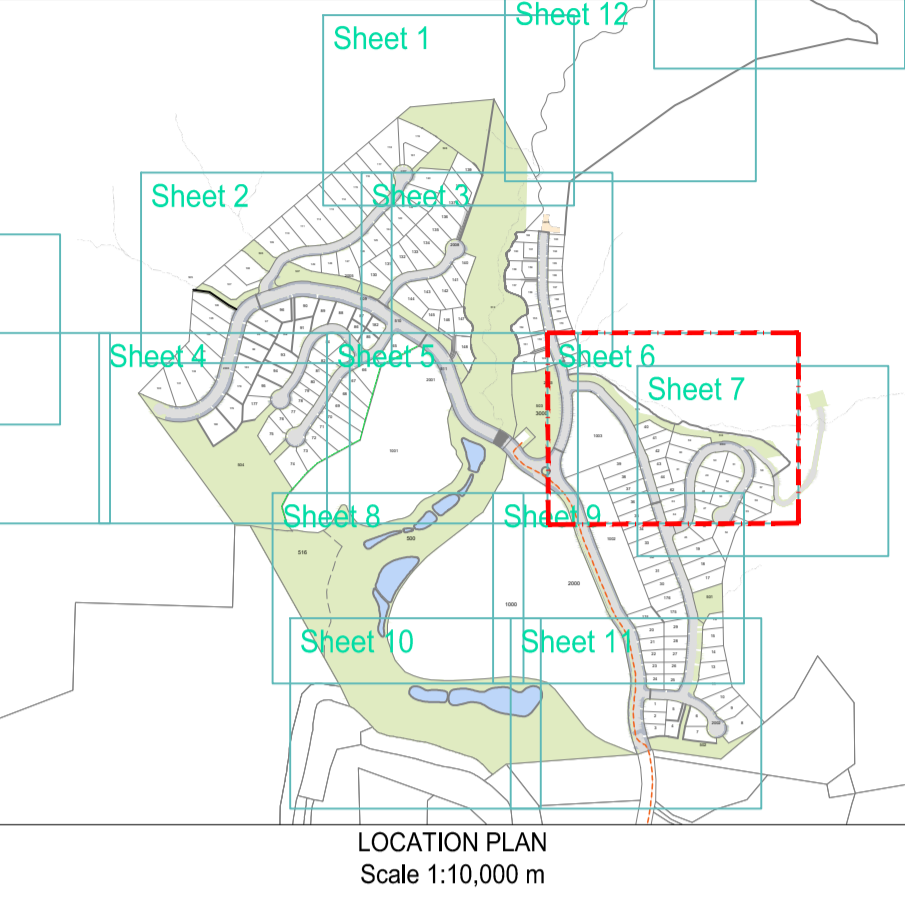

GENERAL NOTES:

- This drawing shall only be reproduced in full with approval from a Davis Ogilvie engineer.
- Contractor to locate all existing services & verify all dimensions before commencing works.
- Plans are to be read in conjunction with the Specification, Schedule of Prices and the Nelson Tasman Land Development Manual 2020. Any conflicts are to be brought to the attention of the engineer prior to works proceeding. Engineer to advise contractor accordingly.
- Prior to any works commencing, contractor is to engage a registered professional surveyor and/or licensed cadastral surveyor to supervise all set out & provide asbuilt plans for review.
- Set out is not to be scaled off the plans. The engineer will provide electronic data for the contractor. Any variations are to be approved by the engineer.
- All plan dimensions are in m. All detail dimensions are in mm.
- All plans are in terms of the New Zealand GD 2000 Nelson Circuit, and levels are in terms of the Nelson Vertical Datum 1955.

DRAINAGE NOTES:

- All drainage works shall be carried out in accordance with Davis Ogilvie Specifications, Nelson Tasman Land Development Manual 2020, and specific requirements stipulated within the resource consents.
- All services (power, telecom and water) are to pass over drainage pipes unless specified otherwise.
- All PVC pipes to have minimum 0.75 m cover in trafficable areas. RCRRJ pipes are to be minimum Class 4.
- Pipe bedding is to be as per Section 5.4.4.1 NZS 2566.2 for PVC pipes. Concrete pipe bedding to be Type HS2 as per Table 5 in NZS 3725.
- Stormwater and wastewater laterals to extend a minimum 1.0m into the lot.

LEGEND:

- Stage Boundary
- Proposed Stormwater Pipe
- Proposed Stormwater Manhole
- Sump
- Proposed Wastewater Pipe
- Proposed Wastewater Manhole
- Ex stream
- Proposed swale
- Cut off drain
- Stream Realigned
- Proposed pressure sewer Tonkin + taylor

CAD ref: T:\projects\39s\39470 - Maitahi Development\Civil\39470.Drawing Set 2-Drainage



Rev.	Date	Reason	Approved
P1	15/12/23	Issued for Information	DB
P2	5/04/24	Issued for Information	RB
P3	31/01/25	Issued for information	RB
A1	27/06/25	Issued for Resource Consent	RB
A2	9/07/25	Boundaries updated	RB

FOR APPROVAL

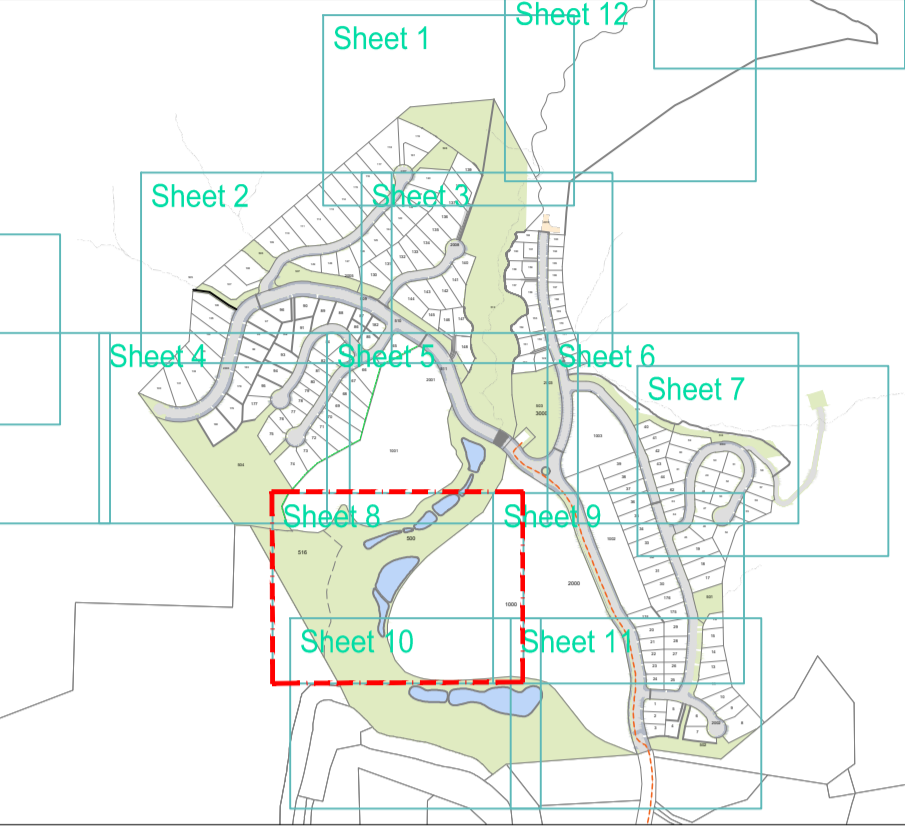

GENERAL NOTES:

1. This drawing shall only be reproduced in full with approval from a Davis Ogilvie engineer.
2. Contractor to locate all existing services & verify all dimensions before commencing works.
3. Plans are to be read in conjunction with the Specification, Schedule of Prices and the Nelson Tasman Land Development Manual 2020. Any conflicts are to be brought to the attention of the engineer prior to works proceeding. Engineer to advise contractor accordingly.
4. Prior to any works commencing, contractor is to engage a registered professional surveyor and/or licensed cadastral surveyor to supervise all set out & provide asbuilt plans for review.
5. Set out is not to be scaled off the plans. The engineer will provide electronic data for the contractor. Any variations are to be approved by the engineer.
6. All plan dimensions are in m. All detail dimensions are in mm.
7. All plans are in terms of the New Zealand GD 2000 Nelson Circuit, and levels are in terms of the Nelson Vertical Datum 1955.

DRAINAGE NOTES:

1. All drainage works shall be carried out in accordance with Davis Ogilvie Specifications, Nelson Tasman Land Development Manual 2020, and specific requirements stipulated within the resource consents.
2. All services (power, telecom and water) are to pass over drainage pipes unless specified otherwise.
3. All PVC pipes to have minimum 0.75 m cover in trafficable areas. RCRRJ pipes are to be minimum Class 4.
4. Pipe bedding is to be as per Section 5.4.4.1 NZS 2566.2 for PVC pipes. Concrete pipe bedding to be Type HS2 as per Table 5 in NZS 3725.
5. Stormwater and wastewater laterals to extend a minimum 1.0m into the lot.

LEGEND:

- Stage Boundary
- Proposed Stormwater Pipe
- Proposed Stormwater Manhole
- Sump
- Proposed Wastewater Pipe
- Proposed Wastewater Manhole
- Ex stream
- Proposed swale
- Cut off drain
- Stream Realigned
- Proposed pressure sewer Tonkin + taylor

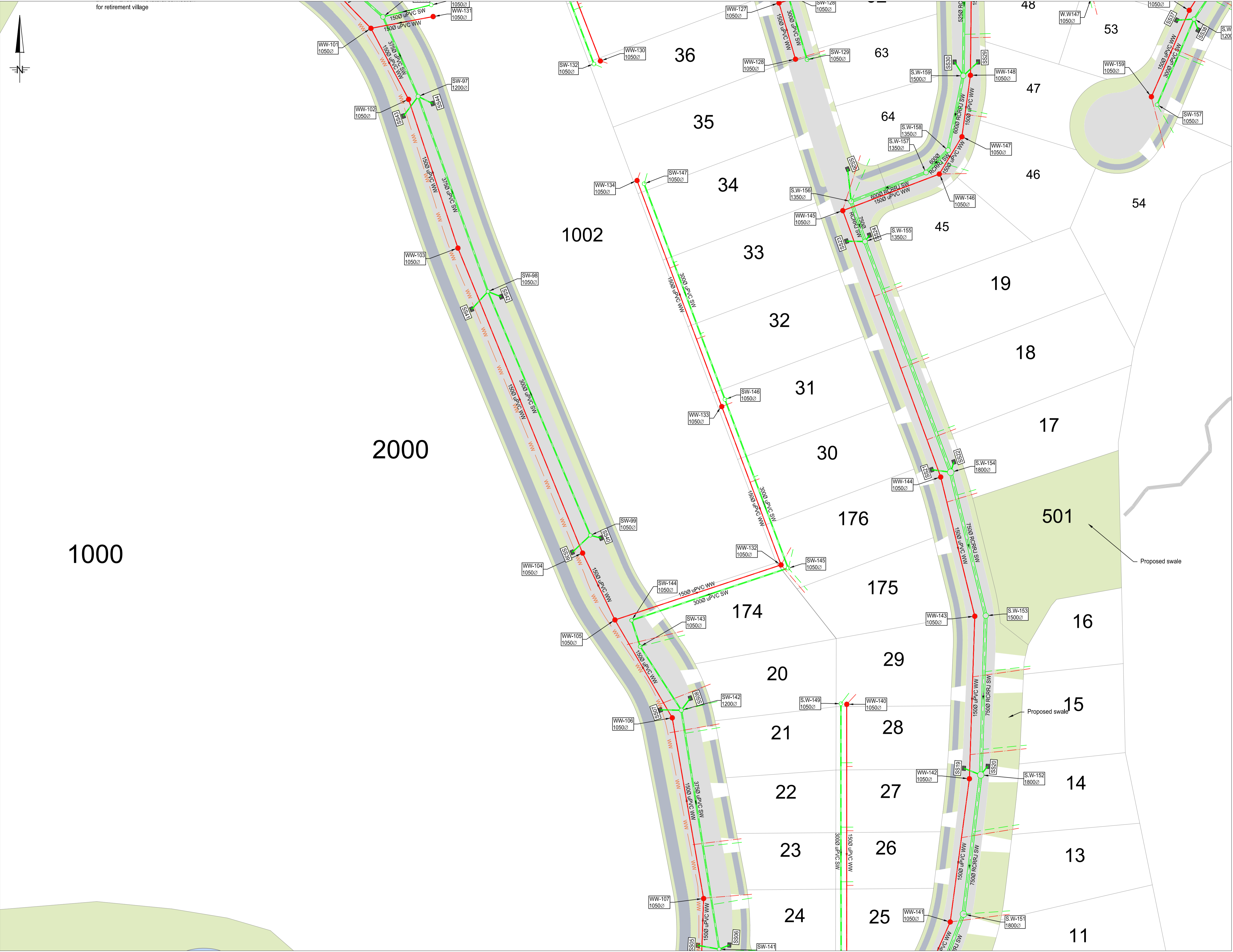

Rev.	Date	Reason	Approved
P1	15/12/23	Issued for Information	DB
P2	5/04/24	Issued for Information	RB
P3	31/01/25	Issued for information	RB
A1	27/06/25	Issued for Resource Consent	RB
A2	9/07/25	Boundaries updated	RB

FOR APPROVAL

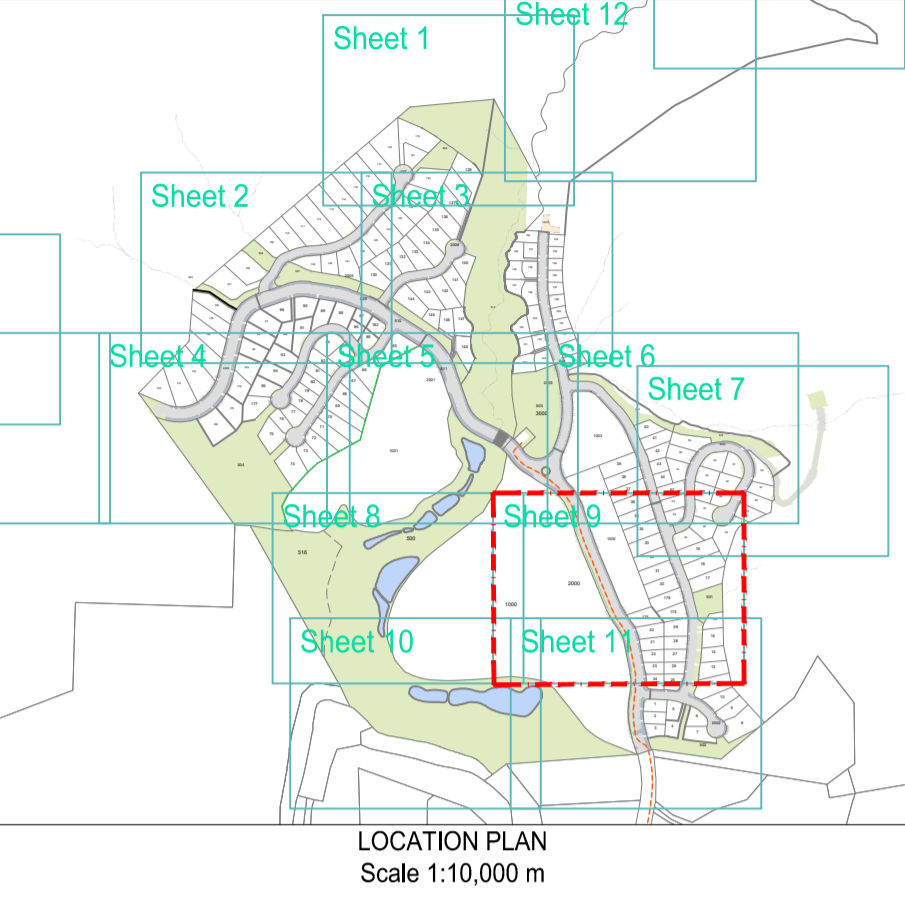

- GENERAL NOTES:
- This drawing shall only be reproduced in full with approval from a Davis Ogilvie engineer.
 - Contractor to locate all existing services & verify all dimensions before commencing works.
 - Plans are to be read in conjunction with the Specification, Schedule of Prices and the Nelson Tasman Land Development Manual 2020. Any conflicts are to be brought to the attention of the engineer prior to works proceeding. Engineer to advise contractor accordingly.
 - Prior to any works commencing, contractor is to engage a registered professional surveyor and/or licensed cadastral surveyor to supervise all set out & provide asbuilt plans for review.
 - Set out is not to be scaled off the plans. The engineer will provide electronic data for the contractor. Any variations are to be approved by the engineer.
 - All plan dimensions are in m. All detail dimensions are in mm.
 - All plans are in terms of the New Zealand GD 2000 Nelson Circuit, and levels are in terms of the Nelson Vertical Datum 1955.

- DRAINAGE NOTES:
- All drainage works shall be carried out in accordance with Davis Ogilvie Specifications, Nelson Tasman Land Development Manual 2020, and specific requirements stipulated within the resource consents.
 - All services (power, telecom and water) are to pass over drainage pipes unless specified otherwise.
 - All PVC pipes to have minimum 0.75 m cover in trafficable areas. RCRRJ pipes are to be minimum Class 4.
 - Pipe bedding is to be as per Section 5.4.4.1 NZS 2566.2 for PVC pipes. Concrete pipe bedding to be Type HS2 as per Table 5 in NZS 3725.
 - Stormwater and wastewater laterals to extend a minimum 1.0m into the lot.

- LEGEND:
- Stage Boundary
 - Proposed Stormwater Pipe
 - Proposed Stormwater Manhole
 - Sump
 - Proposed Wastewater Pipe
 - Proposed Wastewater Manhole
 - Ex stream
 - Proposed swale
 - Cut off drain
 - Stream Realigned
 - Proposed pressure sewer Tonkin + taylor



Rev.	Date	Reason	Approved
P1	15/12/23	Issued for Information	DB
P2	5/04/24	Issued for Information	RB
P3	31/01/25	Issued for information	RB
A1	27/06/25	Issued for Resource Consent	RB
A2	9/07/25	Boundaries updated	RB

FOR APPROVAL

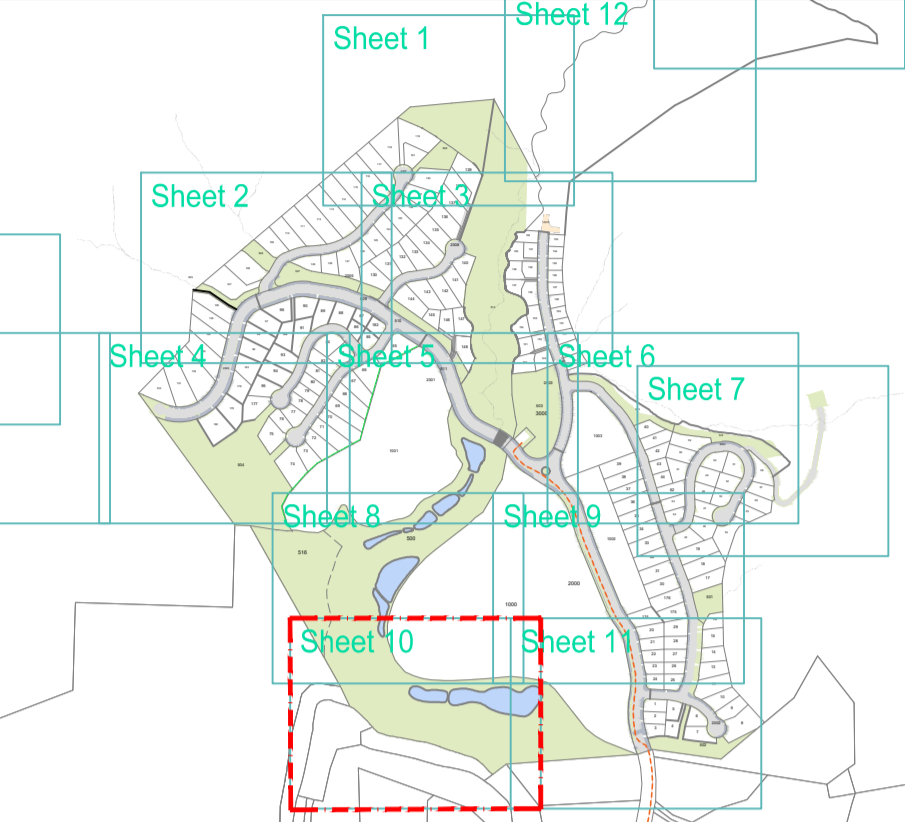

GENERAL NOTES:

- This drawing shall only be reproduced in full with approval from a Davis Ogilvie engineer.
- Contractor to locate all existing services & verify all dimensions before commencing works.
- Plans are to be read in conjunction with the Specification, Schedule of Prices and the Nelson Tasman Land Development Manual 2020. Any conflicts are to be brought to the attention of the engineer prior to works proceeding. Engineer to advise contractor accordingly.
- Prior to any works commencing, contractor is to engage a registered professional surveyor and/or licensed cadastral surveyor to supervise all set out & provide asbuilt plans for review.
- Set out is not to be scaled off the plans. The engineer will provide electronic data for the contractor. Any variations are to be approved by the engineer.
- All plan dimensions are in m. All detail dimensions are in mm.
- All plans are in terms of the New Zealand GD 2000 Nelson Circuit, and levels are in terms of the Nelson Vertical Datum 1955.

DRAINAGE NOTES:

- All drainage works shall be carried out in accordance with Davis Ogilvie Specifications, Nelson Tasman Land Development Manual 2020, and specific requirements stipulated within the resource consents.
- All services (power, telecom and water) are to pass over drainage pipes unless specified otherwise.
- All PVC pipes to have minimum 0.75 m cover in trafficable areas. RCRRJ pipes are to be minimum Class 4.
- Pipe bedding is to be as per Section 5.4.4.1 NZS 2566.2 for PVC pipes. Concrete pipe bedding to be Type HS2 as per Table 5 in NZS 3725.
- Stormwater and wastewater laterals to extend a minimum 1.0m into the lot.

LEGEND:

- Stage Boundary
- Proposed Stormwater Pipe
- Proposed Stormwater Manhole
- Sump
- Proposed Wastewater Pipe
- Proposed Wastewater Manhole
- Ex stream
- Proposed swale
- Cut off drain
- Stream Realigned
- Proposed pressure sewer Tonkin + taylor



Rev.	Date	Reason	Approved
P1	15/12/23	Issued for Information	DB
P2	5/04/24	Issued for Information	RB
P3	31/01/25	Issued for information	RB
A1	27/06/25	Issued for Resource Consent	RB
A2	9/07/25	Boundaries updated	RB

FOR APPROVAL

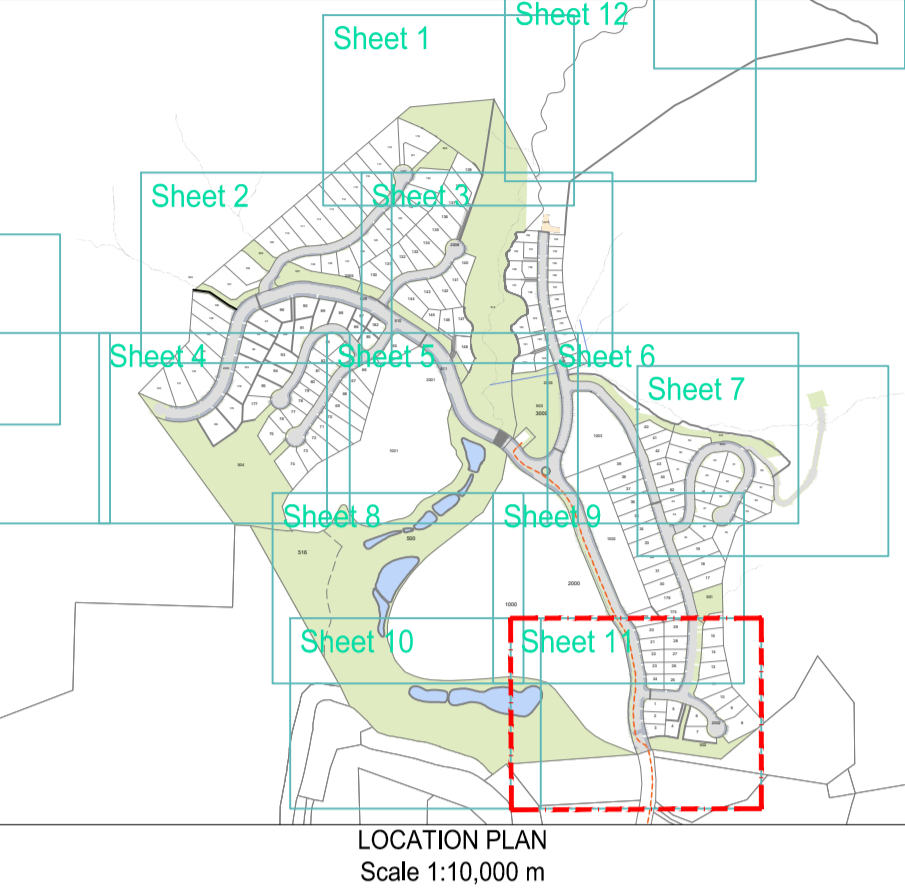

- GENERAL NOTES:
- This drawing shall only be reproduced in full with approval from a Davis Ogilvie engineer.
 - Contractor to locate all existing services & verify all dimensions before commencing works.
 - Plans are to be read in conjunction with the Specification, Schedule of Prices and the Nelson Tasman Land Development Manual 2020. Any conflicts are to be brought to the attention of the engineer prior to works proceeding. Engineer to advise contractor accordingly.
 - Prior to any works commencing, contractor is to engage a registered professional surveyor and/or licensed cadastral surveyor to supervise all set out & provide asbuilt plans for review.
 - Set out is not to be scaled off the plans. The engineer will provide electronic data for the contractor. Any variations are to be approved by the engineer.
 - All plan dimensions are in m. All detail dimensions are in mm.
 - All plans are in terms of the New Zealand GD 2000 Nelson Circuit, and levels are in terms of the Nelson Vertical Datum 1955.

- DRAINAGE NOTES:
- All drainage works shall be carried out in accordance with Davis Ogilvie Specifications, Nelson Tasman Land Development Manual 2020, and specific requirements stipulated within the resource consents.
 - All services (power, telecom and water) are to pass over drainage pipes unless specified otherwise.
 - All PVC pipes to have minimum 0.75 m cover in trafficable areas. RCRRJ pipes are to be minimum Class 4.
 - Pipe bedding is to be as per Section 5.4.4.1 NZS 2566.2 for PVC pipes. Concrete pipe bedding to be Type HS2 as per Table 5 in NZS 3725.
 - Stormwater and wastewater laterals to extend a minimum 1.0m into the lot.

- LEGEND:
- Stage Boundary
 - Proposed Stormwater Pipe
 - Proposed Stormwater Manhole
 - Sump
 - Proposed Wastewater Pipe
 - Proposed Wastewater Manhole
 - Ex stream
 - Proposed swale
 - Cut off drain
 - Stream Realigned
 - Proposed pressure sewer Tonkin + taylor

CAD ref: T:\projects\39s\39470 - Maitahi Development\Civil\39470.Drawing Set 2-Drainage