

- NOTES**
1. ALL WORKS TO BE IN ACCORDANCE WITH WESTERN BAY OF PLENTY DEVELOPMENT CODE.
  2. CO-ORDINATES IN TERMS OF BAY OF PLENTY 2000.
  3. REDUCED LEVELS ARE IN TERMS OF NZVD 2016. IT IS THE CONTRACTORS RESPONSIBILITY TO LOCATE ALL SERVICES THAT MAY BE AFFECTED BY THEIR HEAVY DUTY MANKO FLUIDS AND FRAMES TO BE USED IN TRAFFICED AREAS. ALL MANHOLES SHALL HAVE STAINLESS GRATES INSTALLED.
  4. ALL LINES ARE TO BE RORRI CLASS A UNLESS SHOWN OTHERWISE.



Rev	Description	By	Date
B	FOR CONSENT	MB	03/26
A	FOR REVIEW	MB	12/25

Survey	MAVEN	05/2025
Design	MB	11/25
Drawn	MB	12/25
Checked	CS	12/25



**Project**  
**WAIRAKEI SOUTH FTA090 DEVELOPMENT**  
**BELL ROAD, PAPAMOA**  
**FOR BELL ROAD LIMITED PARTNERSHIP**

**Title**  
**PROPOSED STORMWATER LAYOUT**  
**STAGE 8**

Project no.	BOP0749
Scale	1:2000 @ A3
Card file	SP0195-C000.DWG
Drawing no.	C400-8-1
Rev	B

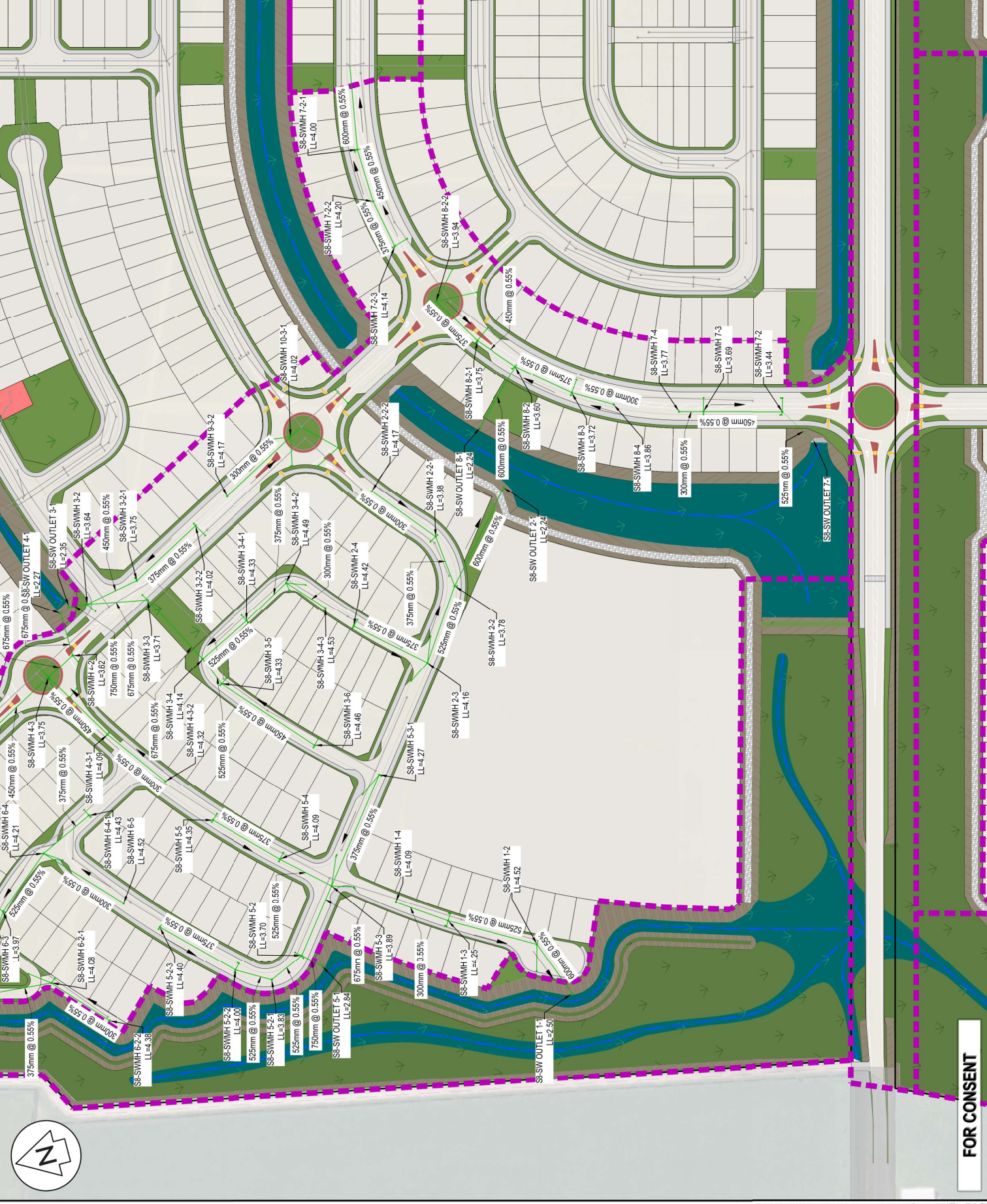

ORIGINAL SIZE: A3

**FOR CONSENT**



- NOTES**
1. ALL WORKS TO BE IN ACCORDANCE WITH WESTERN BAY OF PLENTY DEVELOPMENT CODE.
  2. CO-ORDINATES IN TERMS OF PLENTY 2000.
  3. REDUCED LEVELS ARE IN TERMS OF NZVD 2016. IT IS THE CONTRACTORS RESPONSIBILITY TO LOCATE ALL SERVICES THAT MAY BE AFFECTED BY THEIR EXISTING UTILITIES.
  4. HEAVY DUTY MANKO FLIDS AND FRAMES TO BE USED IN TRAFFICKED AREAS. ALL MANKOES SHALL HAVE STAINLESS GRATES INSTALLED.
  5. ALL LINES ARE TO BE RORRI CLASS 4 UNLESS SHOWN OTHERWISE.



Rev	Description	By	Date
B	FOR CONSENT	MB	03/26
A	FOR REVIEW	MB	12/25

By	Date
MAVEN	05/20/25
MB	11/25
MB	12/25
CS	12/25

**Maven Bay of Plenty**  
 115 Cameron Street, Tauranga  
 www.maven.co.nz

**Project**  
**WAIRAKEI SOUTH FTA090 DEVELOPMENT**  
**BELL ROAD, PAPAMOA**  
**FOR BELL ROAD LIMITED PARTNERSHIP**

**PROPOSED STORMWATER LAYOUT STAGE 9**

Project no.	BOP0749
Scale	1:2000 @ A3
Cell file	spwps-coo.dwg
Drawing no.	C400-9-1
Rev	B

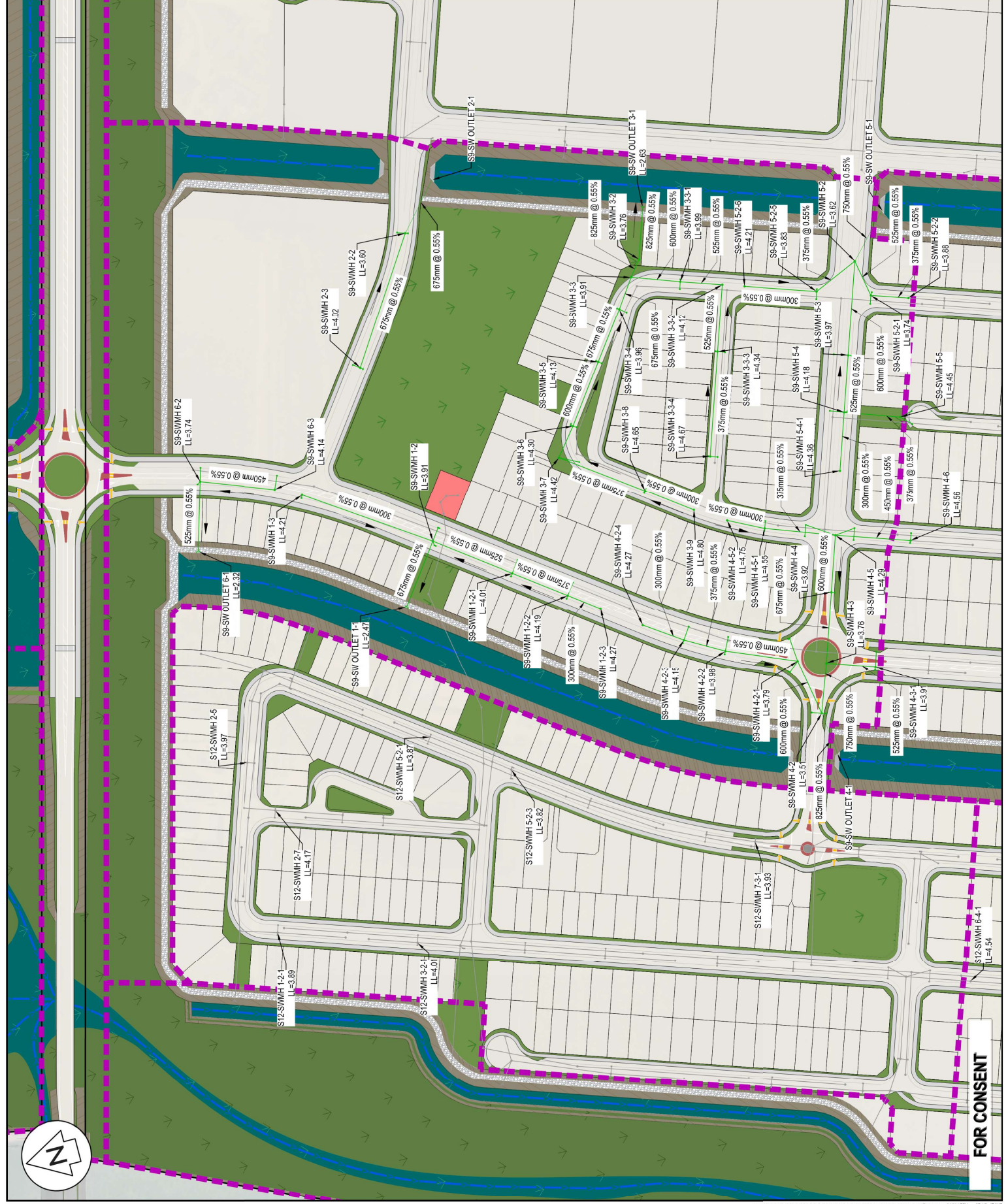

ORIGINAL SIZE: A3

**FOR CONSENT**

- NOTES
1. ALL WORKS TO BE IN ACCORDANCE WITH WESTERN BAY OF PLENTY DEVELOPMENT CODE.
  2. CO-ORDINATES IN TERMS OF BAY OF PLENTY 2000.
  3. REDUCED LEVELS ARE IN TERMS OF NZVD 2016. IT IS THE CONTRACTORS RESPONSIBILITY TO LOCATE ALL SERVICES THAT MAY BE AFFECTED BY THEIR EXISTING UTILITIES.
  4. HEAVY DUTY MANHOLE ELDS AND FRAMES TO BE USED IN TRAFFICKED AREAS. ALL MANHOLES SHALL HAVE STAINLESS GRATES INSTALLED.
  5. ALL LINES ARE TO BE RORRI CLASS 4 UNLESS SHOWN OTHERWISE.



Rev	Description	By	Date
B	FOR CONSENT	MB	03/26
A	FOR REVIEW	MB	12/25

Survey	MAVEN	Date	05/2025
Design	MB		11/25
Drawn	MB		12/25
Checked	CS		12/25

**M A V E N**  
 Naven Bay of Plenty  
 115 Cameron Street, Tauranga  
 New Zealand

**Project**  
**WAIRAKEI SOUTH FTA090 DEVELOPMENT**  
**BELL ROAD, PAPAMOA**  
**FOR BELL ROAD LIMITED PARTNERSHIP**

**Title**  
**PROPOSED STORMWATER LAYOUT**  
**STAGE 10**

Project no.	BOP0749
Scale	1:2000 @ A3
Cell file	spwps-cv00.dwg
Drawing no.	C400-10-1
Rev	B

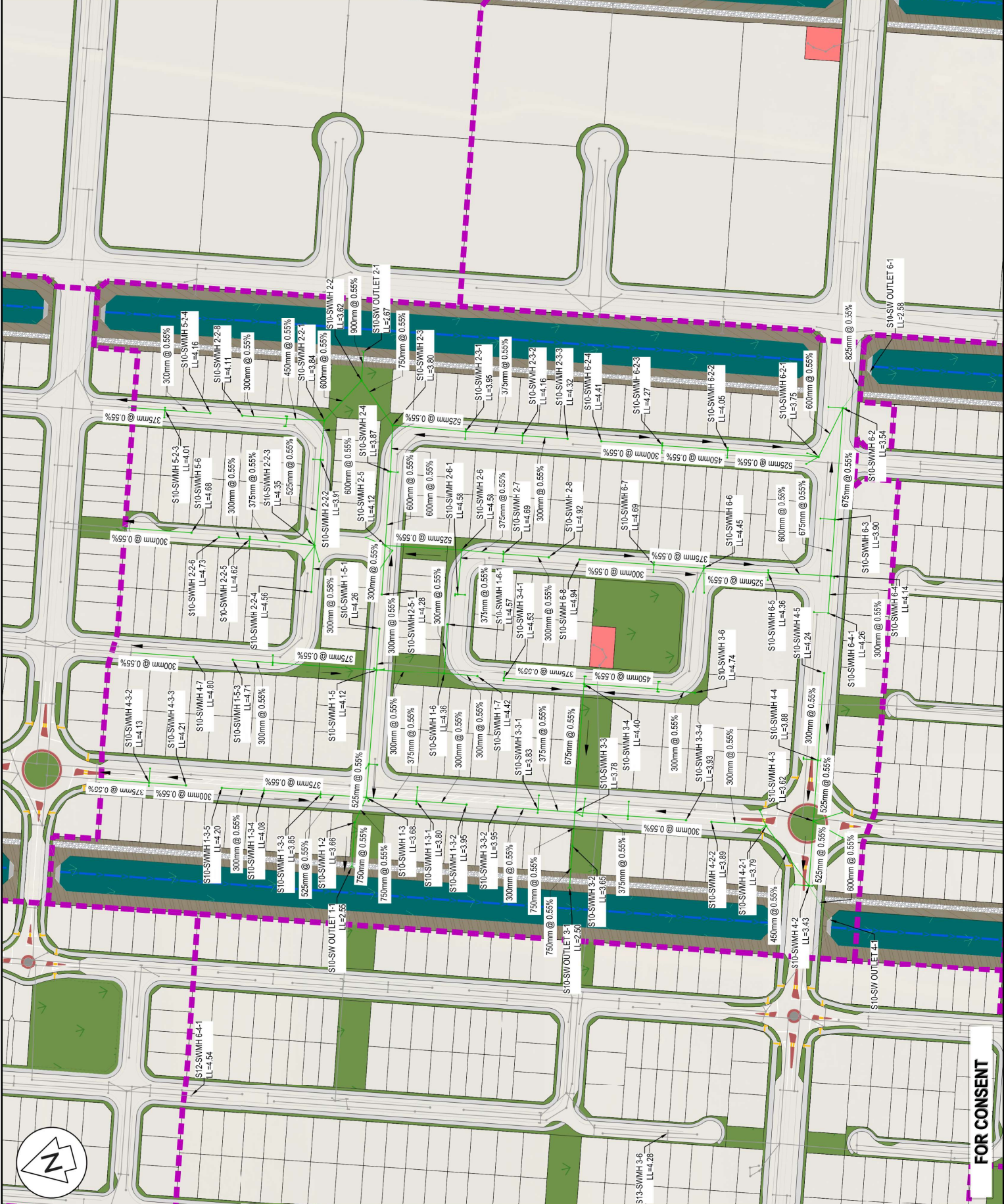

ORIGINAL SIZE: A3

**FOR CONSENT**

- NOTES**
1. ALL WORKS TO BE IN ACCORDANCE WITH WESTERN BAY OF PLENTY DEVELOPMENT CODE.
  2. CO-ORDINATES IN TERMS OF BAY OF PLENTY 2000.
  3. REDUCED LEVELS ARE IN TERMS OF NZVD 2016. IT IS THE CONTRACTORS RESPONSIBILITY TO LOCATE ALL SERVICES THAT MAY BE AFFECTED BY THEIR PROPOSED DEVELOPMENT.
  4. HEAVY DUTY MANHOLE FRAMES AND FRAMES TO BE USED IN TRAFFICKED AREAS. ALL MANHOLES SHALL HAVE STAINLESS GRATES INSTALLED.
  5. ALL LINES ARE TO BE RORRI CLASS 4 UNLESS SHOWN OTHERWISE.

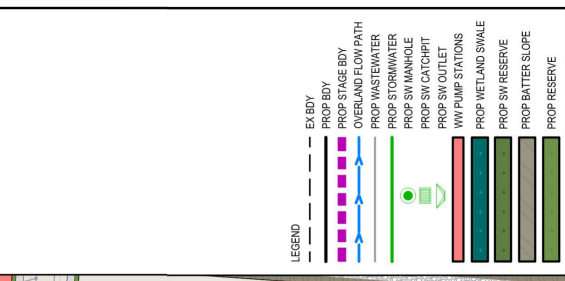

Rev	Description	By	Date
B	FOR CONSENT	MB	03/26
A	FOR REVIEW	MB	12/25

Survey	MAVEN	05/20/25
Design	MB	11/25
Drawn	MB	12/25
Checked	CS	12/25

**M A V E N**  
 Naven Bay of Plenty  
 115 Cameron Street, Tauranga  
 New Zealand

**Project**  
**WAIRAKEI SOUTH FTA090 DEVELOPMENT**  
**BELL ROAD, PAPAMOA**  
**FOR BELL ROAD LIMITED PARTNERSHIP**

**Title**  
**PROPOSED STORMWATER LAYOUT**  
**STAGE 11**

Project no.	BOP0749
Scale	1:2000 @ A3
Card file	sbpwpv-cso-dwg
Drawing no.	C400-11-1
Rev	B



ORIGINAL SIZE: A3

**FOR CONSENT**

- NOTES**
- ALL WORKS TO BE IN ACCORDANCE WITH WESTERN BAY OF PLENTY DEVELOPMENT CODE.
  - CO-ORDINATES IN TERMS OF BAY OF PLENTY 2000.
  - REDUCED LEVELS ARE IN TERMS OF NZGD 2016. IT IS THE CONTRACTORS RESPONSIBILITY TO LOCATE ALL SERVICES THAT MAY BE AFFECTED BY THEIR HEAVY DUTY MANKO FLUIDS AND FRAMES TO BE USED IN TRAFFICKED AREAS. ALL MANHOLES SHALL HAVE STAINLESS GRATES INSTALLED.
  - ALL LINES ARE TO BE RORRI CLASS 4 UNLESS SHOWN OTHERWISE.



Rev	Description	By	Date
B	FOR CONSENT	MB	03/26
A	FOR REVIEW	MB	12/25

Survey	MAVEN	05/2025
Design	MB	11/25
Drawn	MB	12/25
Checked	CS	12/25

**M A V E N**

Naven Bay of Plenty  
 115 Cameron Street, Tauranga  
 New Zealand

**Project**  
**WAIRAKEI SOUTH FTA090 DEVELOPMENT**  
**BELL ROAD, PAPAMOA**  
**FOR BELL ROAD LIMITED PARTNERSHIP**

**Title**  
**PROPOSED STORMWATER LAYOUT**  
**STAGE 12**

Project no.	BOP0749
Scale	1:2000 @ A3
Client	spwps.co.nz
Drawing no.	C400-12-1
Rev	B

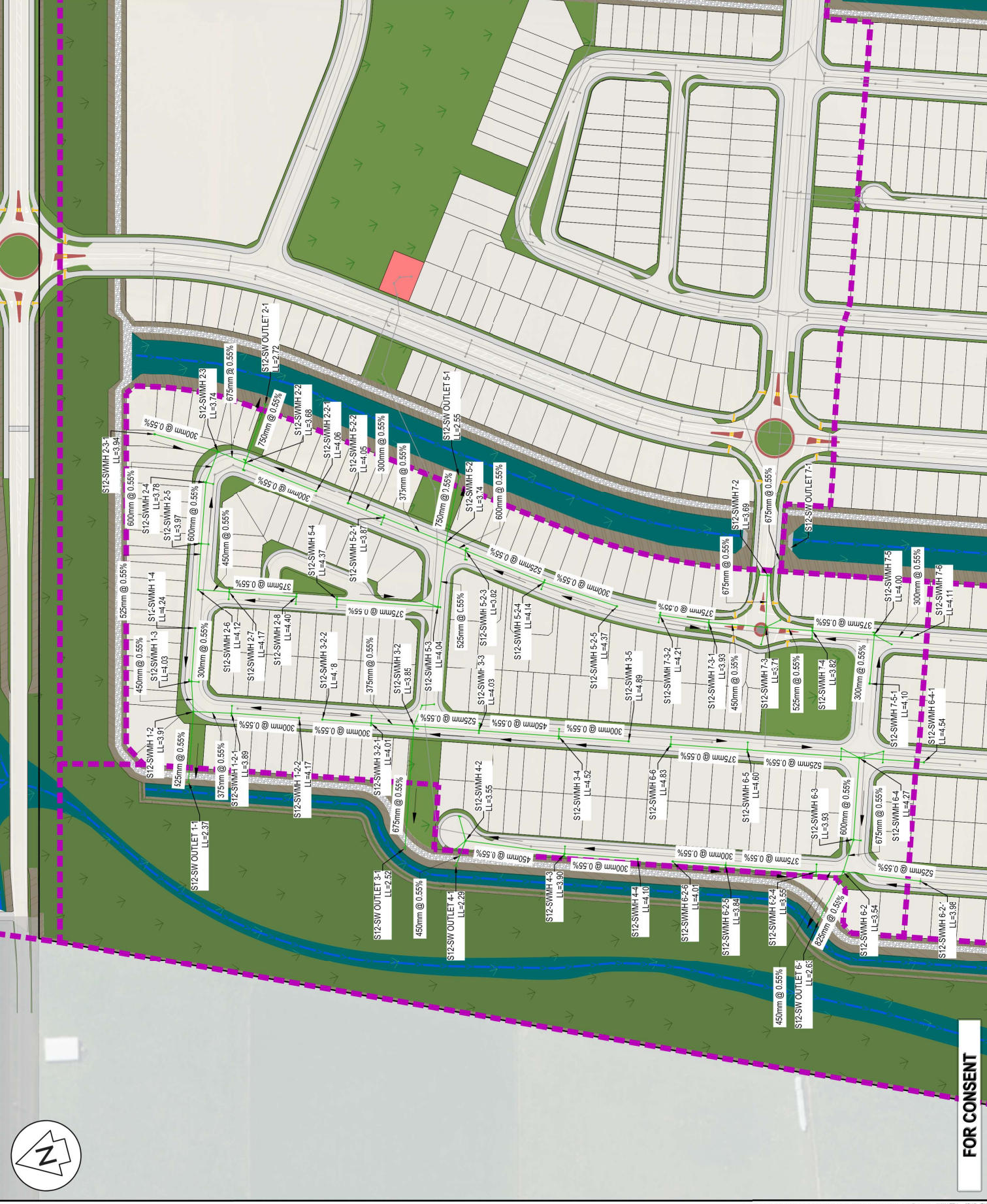

ORIGINAL SIZE: A3

**FOR CONSENT**

- NOTES**
- ALL WORKS TO BE IN ACCORDANCE WITH WESTERN BAY OF PLENTY DEVELOPMENT CODE.
  - CO-ORDINATES IN TERMS OF BAY OF PLENTY 2000.
  - REDUCED LEVELS ARE IN TERMS OF NZGD 2016. IT IS THE CONTRACTOR'S RESPONSIBILITY TO LOCATE ALL SERVICES THAT MAY BE AFFECTED BY THEIR PROPOSED WORKS.
  - HEAVY DUTY MANHOLE FLIDS AND FRAMES TO BE USED IN TRAFFICKED AREAS. ALL MANHOLES SHALL HAVE STAINLESS GRATES INSTALLED.
  - ALL LINES ARE TO BE RORRI CLASS 4 UNLESS SHOWN OTHERWISE.



Rev.	Description	By	Date
B	FOR CONSENT	MB	03/26
A	FOR REVIEW	MB	12/25

Survey	MAVEN	05/2025
Design	MB	11/25
Drawn	MB	12/25
Checked	CS	12/25

**M A V E N**

Naven Bay of Plenty  
 115 Cameron Street, Tauranga  
 New Zealand

**Project**  
**WAIRAKEI SOUTH FTA090 DEVELOPMENT**  
**BELL ROAD, PAPAMOA**  
**FOR BELL ROAD LIMITED PARTNERSHIP**

**Title**  
**PROPOSED STORMWATER LAYOUT**  
**STAGE 13**

**Project no.** BOP0749  
**Scale** 1:2000 @ A3  
**Call file** sponres-cad.dwg

**Drawing no.** C400-13-1  
**Rev** B

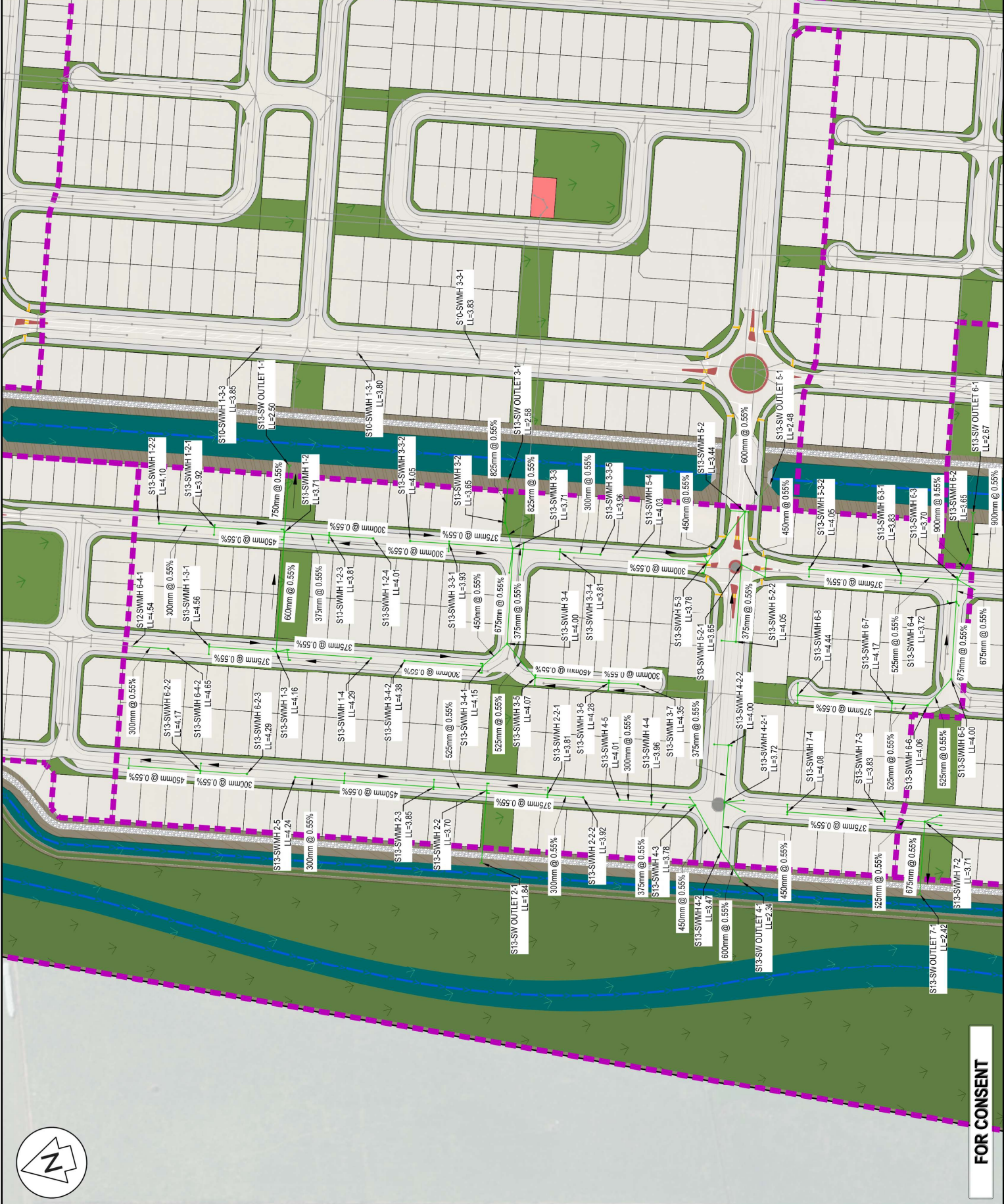

ORIGINAL SIZE: A3

**FOR CONSENT**