

NOTES

1. ALL WORKS TO BE IN ACCORDANCE WITH THE DISTRICT COUNCIL STANDARDS.
2. THE INTERSECTION MARKUPS WERE PROVIDED AS PART OF THE PROVISIONAL INTERSECTION MODEL ARRANGEMENTS SKETCHES.

LEGEND

- PROP ARTERIAL ROADS
- PROP COLLECTOR ROADS
- PROP RESIDENTIAL ROADS
- PROP INDUSTRIAL ROADS

Rev	Description	By	Date
B	FOR CONSENT	KM	03/26
A	DRAF FOR REVIEW	KM	02/26

Survey	Design	Drawn	Checked
HAVEN	PM	PM	JK
15/02/25	02/26	02/26	03/26



Project
WAIRAKEI SOUTH FTA090 DEVELOPMENT
BELL ROAD, PAPAMOA FOR BELL ROAD LIMITED PARTNERSHIP

Title
PROPOSED ROADING INTERSECTION 8 PLAN

Project no.	BOP0749
Scale	1:500 @ A3
Card file	BOP0749-C350-3-RWG
Drawing no.	C350-3-8
Rev	B

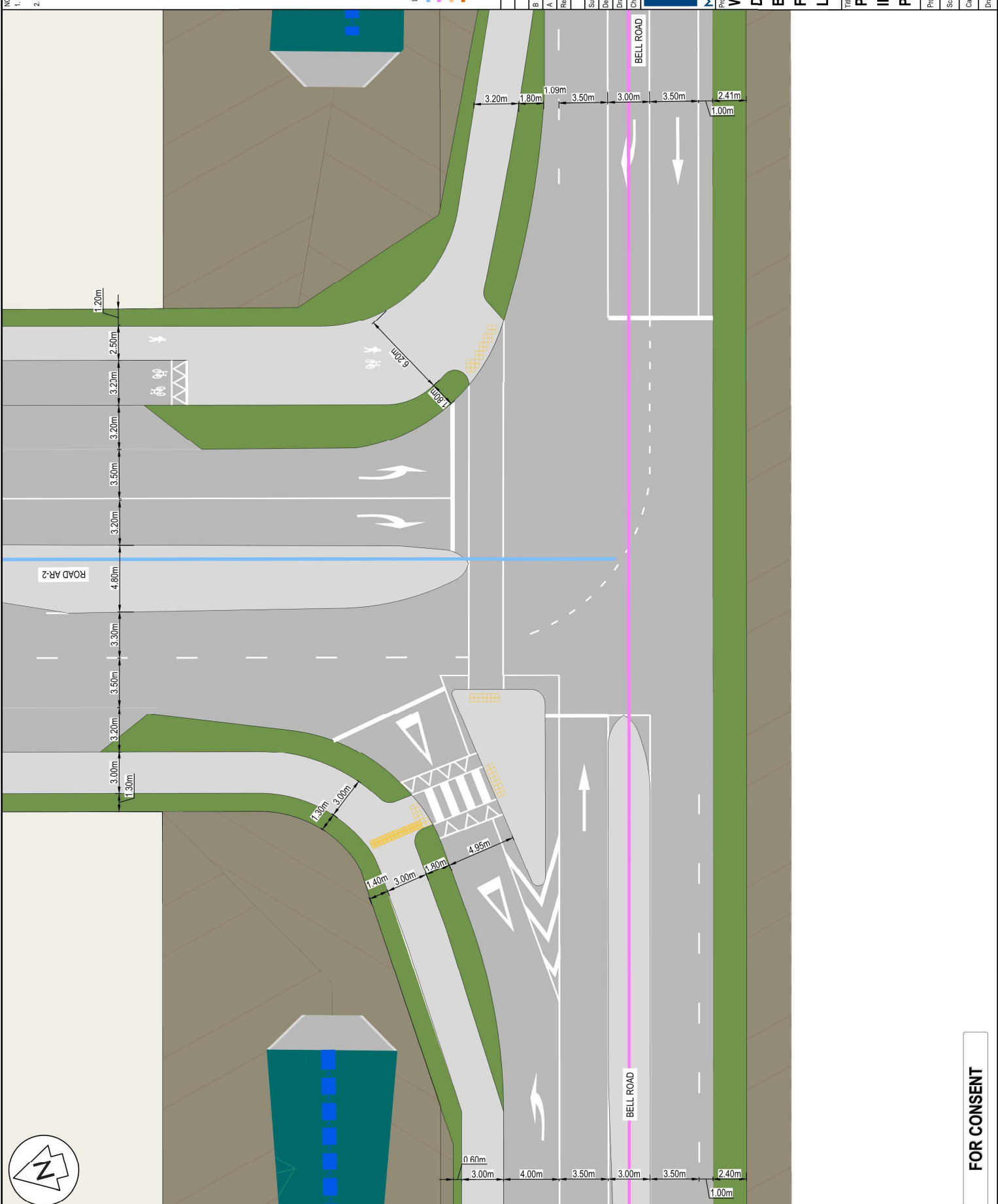

FOR CONSENT

NOTES
 1. ALL WORKS TO BE IN ACCORDANCE WITH THE DISTRICT COUNCIL STANDARDS.
 2. THE INTERSECTION MARKUPS WERE PROVIDED AS PART OF THE PROVISIONAL INTERSECTION MODEL ARRANGEMENTS SKETCHES.

LEGEND

—	PROP ARTERIAL ROADS
—	PROP COLLECTOR ROADS
—	PROP RESIDENTIAL ROADS
—	PROP INDUSTRIAL ROADS

Rev	Description	By	Date
B	FOR CONSENT	KM	03/25
A	DRAFT FOR REVIEW	KM	02/25
Survey			
By	HAIVEN		05/2025
Design			
By	KM		02/26
Drawn			
By	KM		02/26
Checked			
By	JKK		03/25

M Maiven Bay of Plenty
 Limited Partnership
 116 Cameron Street, Tauranga
 www.maiven.co.nz
 New Zealand

Project
WAIRAKEI SOUTH FTA090 DEVELOPMENT
BELL ROAD, PAPAMOA
FOR BELL ROAD LIMITED PARTNERSHIP

Title
PROPOSED ROADING INTERSECTION 10 PLAN

Project no.	BOF0749
Scale	1:500 @ A3
Cad file	BOF0749-C350-3.DWG
Drawing no.	C350-3-10
Rev	B

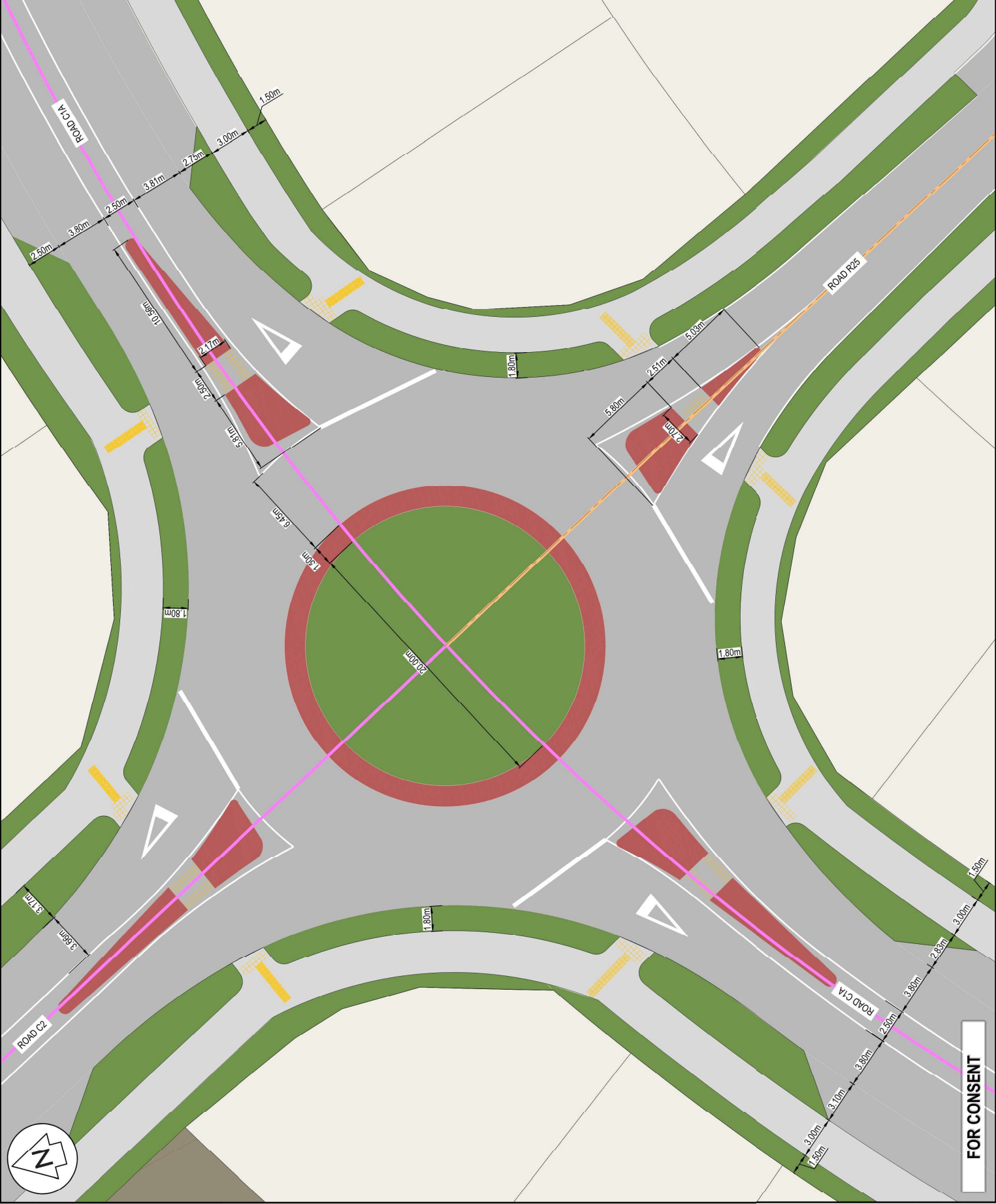

NOTES
 1. ALL WORKS TO BE IN ACCORDANCE WITH THE DISTRICT COUNCIL STANDARDS.
 2. THE INTERSECTION MARKUPS WERE PROVIDED AS PART OF THE PROVISIONAL INTERSECTION MODEL ARRANGEMENTS SHEETS.

LEGEND

—	PROP ARTERIAL ROADS
—	PROP COLLECTOR ROADS
—	PROP RESIDENTIAL ROADS
—	PROP INDUSTRIAL ROADS

Rev	Description	By	Date
B	FOR CONSENT	KM	03/26
A	DRAF FOR REVIEW	KM	02/26

Survey	HAIVEN	Date	05/2025
Design	RM	Drawn	02/26
Checked	JK		03/26



Project: **WAIRAKEI SOUTH FTA090 DEVELOPMENT**
BELL ROAD, PAPAMOA
FOR BELL ROAD LIMITED PARTNERSHIP

Title: **PROPOSED ROADING INTERSECTION 14 PLAN**

Project no.	BOP0749
Scale	1:500 @ A3
Card file	BOP0749-C350-3-WG
Drawing no.	C350-3-14
Rev	B

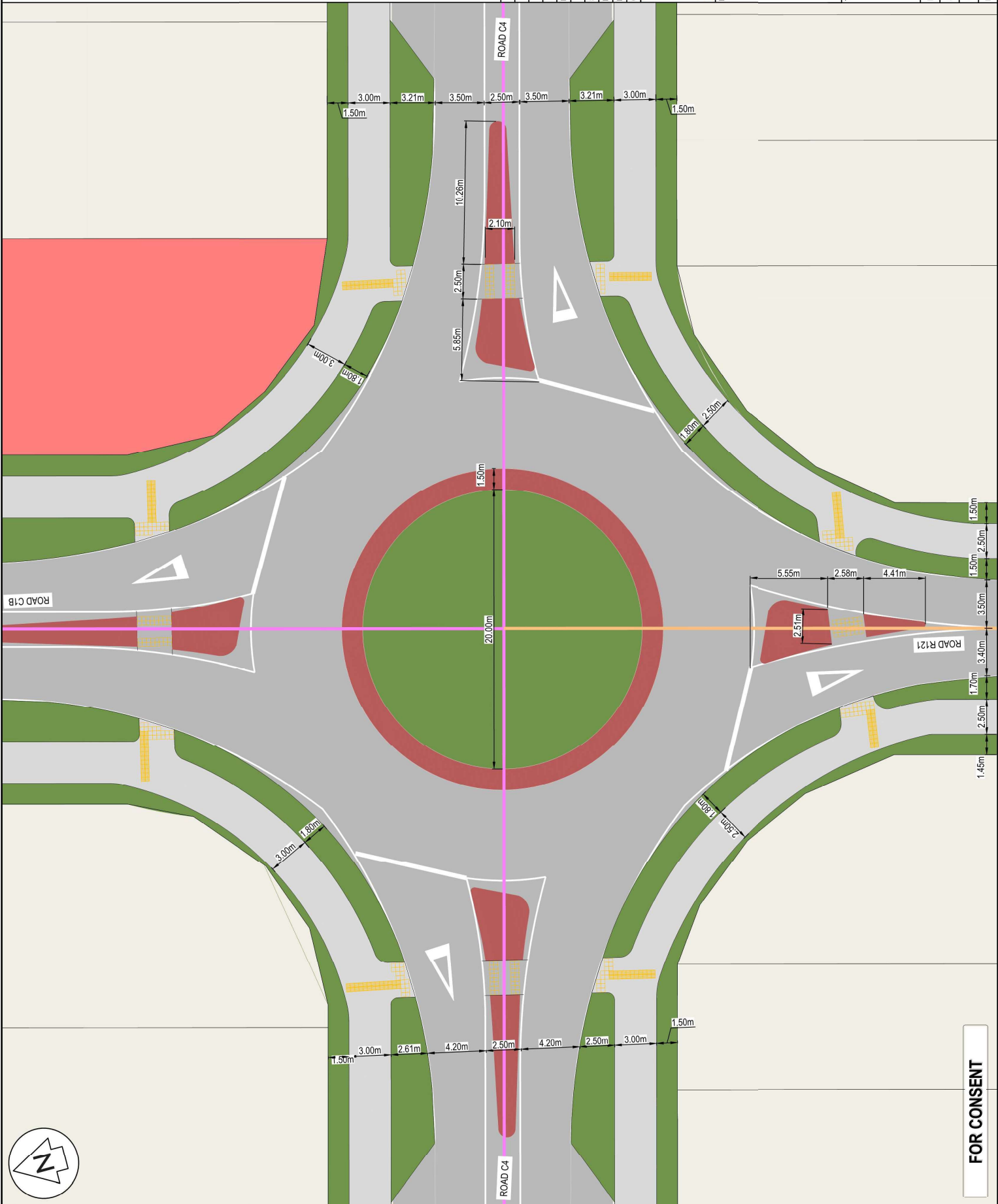

FOR CONSENT

NOTES

1. ALL WORKS TO BE IN ACCORDANCE WITH THE DISTRICT COUNCIL STANDARDS.
2. THE INTERSECTION MARKUPS WERE PROVIDED AS PART OF THE PROVISIONAL INTERSECTION MODEL ARRANGEMENTS SHEETS.

LEGEND

—	PROP ARTERIAL ROADS
—	PROP COLLECTOR ROADS
—	PROP RESIDENTIAL ROADS
—	PROP INDUSTRIAL ROADS

Rev	Description	By	Date
B	FOR CONSENT	KM	03/25
A	DRAFT FOR REVIEW	KM	02/25

Survey	HAVEN	05/2025
Design	KM	02/26
Drawn	KM	02/26
Checked	MK	03/25



Maven Bay of Plenty
 116 Cameron Street, Tauranga
 www.maven.co.nz
 New Zealand

Project
WAIRAKEI SOUTH FTA090 DEVELOPMENT
BELL ROAD, PAPAMOA FOR BELL ROAD LIMITED PARTNERSHIP

Title
PROPOSED ROADING INTERSECTION 15 PLAN

Project no.	BOF0749
Scale	1:500 @ A3
Cad file	BOF0749-C350-3.DWG
Drawing no.	C350-3-15
Rev	B

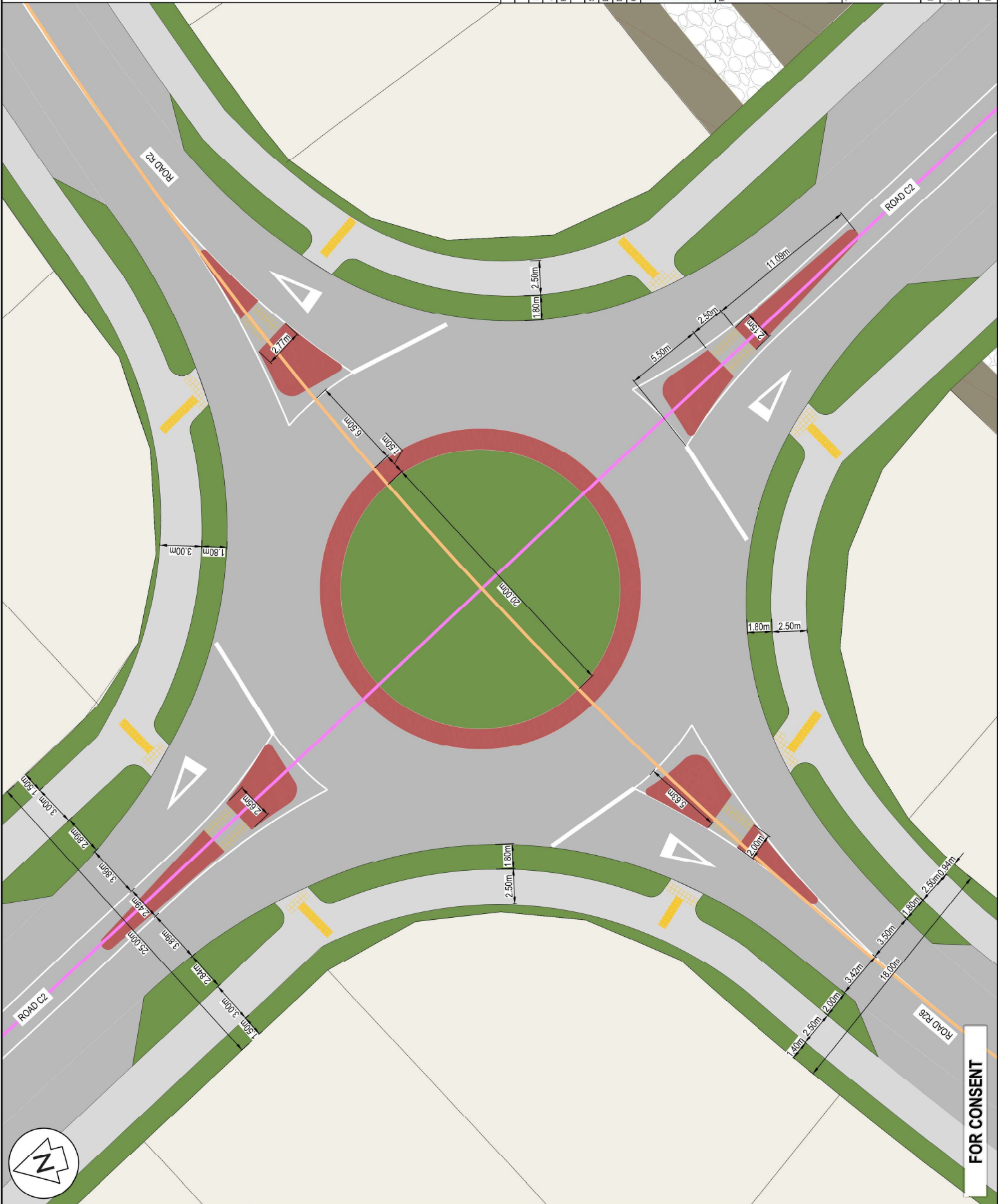

NOTES

1. ALL WORKS TO BE IN ACCORDANCE WITH THE DISTRICT COUNCIL STANDARDS.
2. THE INTERSECTION MARKERS WERE PROVIDED AS PART OF THE PROVISIONAL INTERSECTION MODEL ARRANGEMENTS SKETCHES.



FOR CONSENT	KM	03/26	
DRAFT FOR REVIEW	KM	02/26	
Rev	Description	By	Date
Survey	MAVEN	05/2025	
Design	KM	02/26	
Drawn	KM	02/26	
Checked	JKK	03/26	

M **Maven Bay of Plenty**
 116 Cameron Street, Tauranga
 www.maven.co.nz
 New Zealand

Project: WAIRAKEI SOUTH FTA090 DEVELOPMENT
BELL ROAD, PAPAMOA FOR BELL ROAD LIMITED PARTNERSHIP

Title: PROPOSED ROADING TYPICAL MINI ROUNDABOUTS ABOUTS PLAN

Project no.	BOP0749
Scale	1:500 @ A3
Card file	BOP0749-C350-3-WG
Drawing no.	C350-3-17
Rev	B

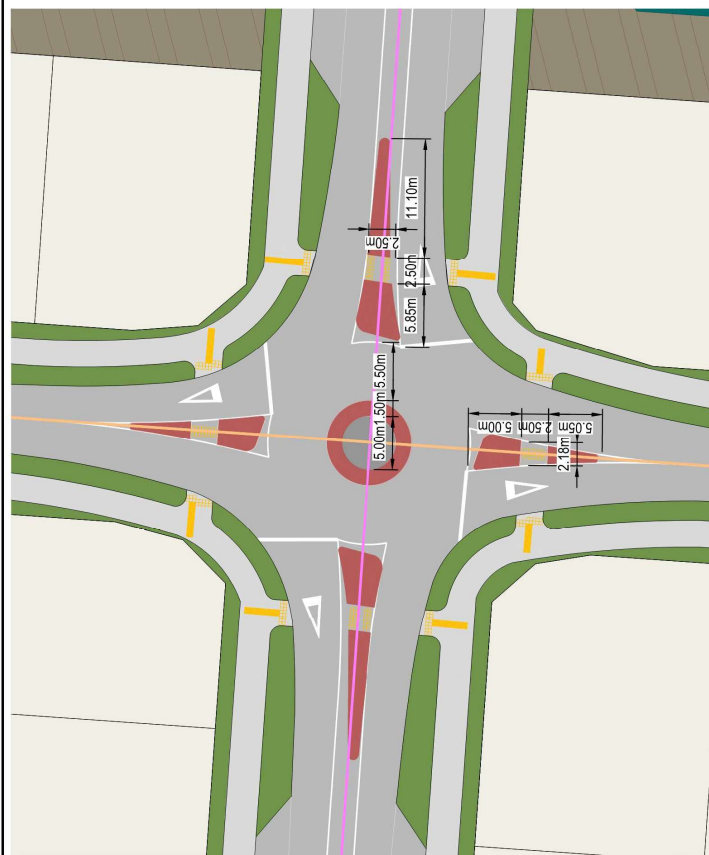

4-ARM MINI ROUNDABOUT TYPICAL DETAIL

Collector Residential (25m ROAD RESERVE)

FLUSH MEDIAN / TURNING LANE	CARRIAGEWAY	PARKING	SHARED PATH	BERM
2.5m	3.5m	2.5m	3.0m	1.5m

Local Residential (18m ROAD RESERVE)

CARRIAGEWAY	PARKING	SHARED P	BERM
2.85m	2.2m	2.5m	1.45m

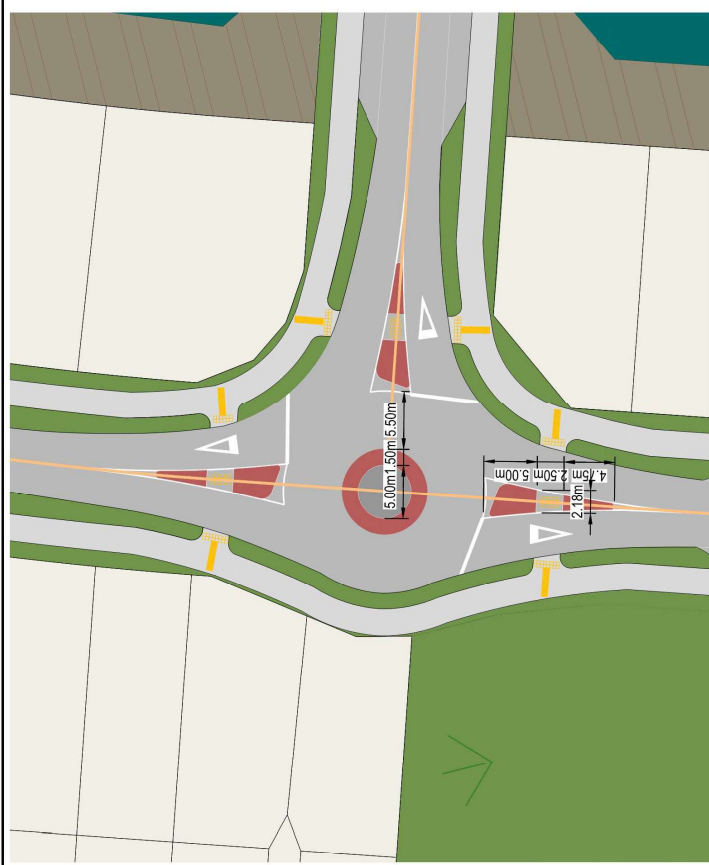

3-ARM MINI ROUNDABOUT TYPICAL DETAIL

Collector Residential (25m ROAD RESERVE)

FLUSH MEDIAN / TURNING LANE	CARRIAGEWAY	PARKING	SHARED PATH	BERM
2.5m	3.5m	2.5m	3.0m	1.5m

Local Residential (18m ROAD RESERVE)

CARRIAGEWAY	PARKING	SHARED P	BERM
2.85m	2.2m	2.5m	1.45m

FOR CONSENT

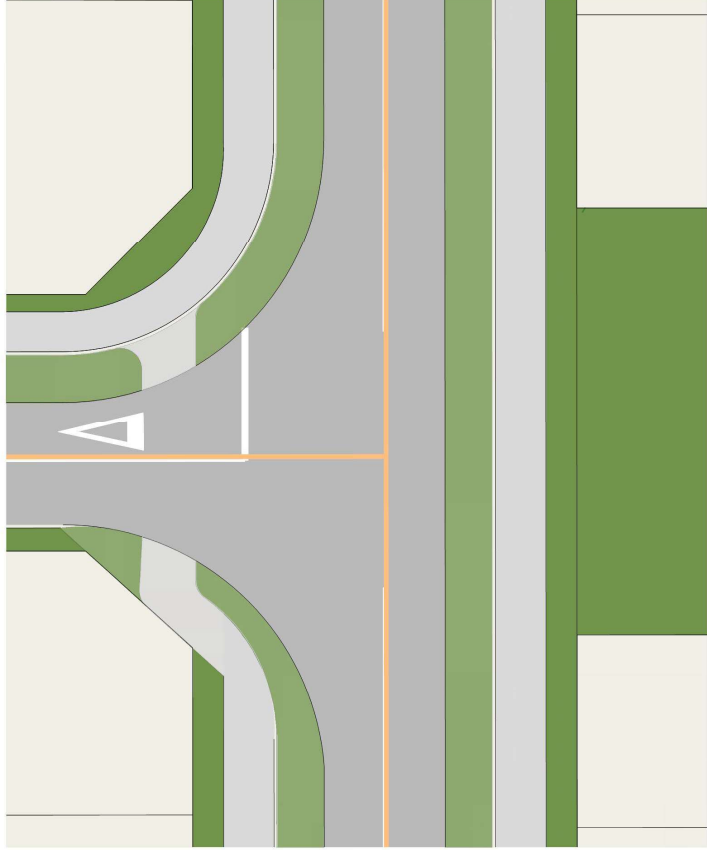

TEE INTERSECTION TYPICAL DETAIL

Collector Residential (25m ROAD RESERVE)

FLUSH-MEDIAN/ TURNING LANE	CARRIAGEWAY	PARKING	SHARED PATH	BERM
2.5m	3.5m	2.5m	3.0m	1.5m

Local Residential (18m ROAD RESERVE)

CARRIAGEWAY	PARKING	SHARED PATH	BERM
2.85m	2.2m	2.5m	1.45m

FOR CONSENT

NOTES

1. ALL WORKS TO BE IN ACCORDANCE WITH THE DISTRICT COUNCIL STANDARDS.
2. THE INTERSECTION MARKUPS WERE PROVIDED AS PART OF THE PROVISIONAL INTERSECTION MODEL ARRANGEMENTS SKETCHES.

LEGEND

—	PROP ARTERIAL ROADS
—	PROP COLLECTOR ROADS
—	PROP RESIDENTIAL ROADS
—	PROP INDUSTRIAL ROADS

Rev	Description	By	Date
B	FOR CONSENT	KM	03/26
A	DRAFT FOR REVIEW	KM	02/26

Rev	Description	By	Date
	Survey	MAYEN	05/2025
	Design	KM	02/26
	Drawn	KM	02/26
	Checked	MK	03/26

M M A E N
 Mavlen Bay of Plenty
 116 Cameron Street, Tauranga
 www.mavlen.co.nz

Project: **WAIRAKEI SOUTH FTA090 DEVELOPMENT**
BELL ROAD, PAPAMOA FOR BELL ROAD LIMITED PARTNERSHIP

Title: **PROPOSED ROADING TYPICAL T-INTERSECTION PLAN**

Project no.	BOP0749
Scale	1:500 @ A3
Card file	BOP0749-C350-3-WG
Drawing no.	C350-3-18
Rev	B

NOTES

1. ALL WORKS TO BE IN ACCORDANCE WITH THE DISTRICT COUNCIL STANDARDS.
2. THE INTERSECTION MARKERS WERE PROVIDED AS PART OF THE PROVISIONAL INTERSECTION MODEL ARRANGEMENTS SKETCHES.



Rev	Description	By	Date
B	FOR CONSENT	AJS	04/26
A	DRAFT FOR REVIEW	AJS	03/26

Survey	By	Date
HAIVEN	HAIVEN	05/2025
Design	AJS	03/26
Drawn	AJS	03/26
Checked	MK	04/26



Project
WAIRAKEI SOUTH FTA090 DEVELOPMENT
BELL ROAD, PAPAMOA FOR BELL ROAD LIMITED PARTNERSHIP

Title
PROPOSED ROADING PARTON RD - BELL RD INTERSECTION PLAN

Project no.	BOP0749
Scale	1:500 @ A3
Card file	BOP0749-C350-4-JWG
Drawing no.	C350-4-3

Rev	B
-----	---

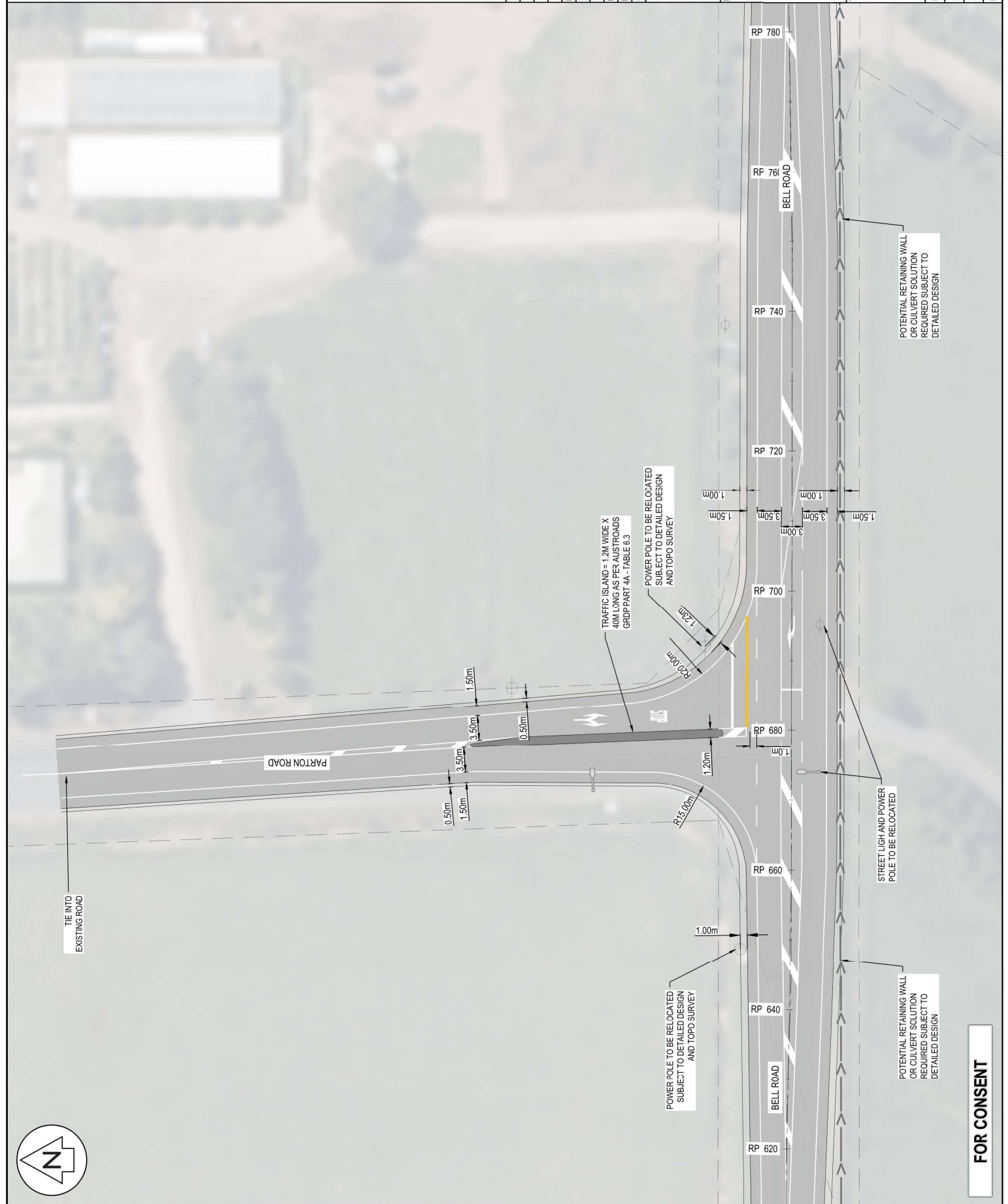

FOR CONSENT



TITLE: PARTON RD - BELL RD INTERSECTION PLAN
 PROJECT: WAIRAKEI SOUTH FTA090 DEVELOPMENT
 CLIENT: BELL ROAD LIMITED PARTNERSHIP
 DATE: 04/26
 SCALE: 1:500 @ A3
 DRAWING NO: C350-4-3

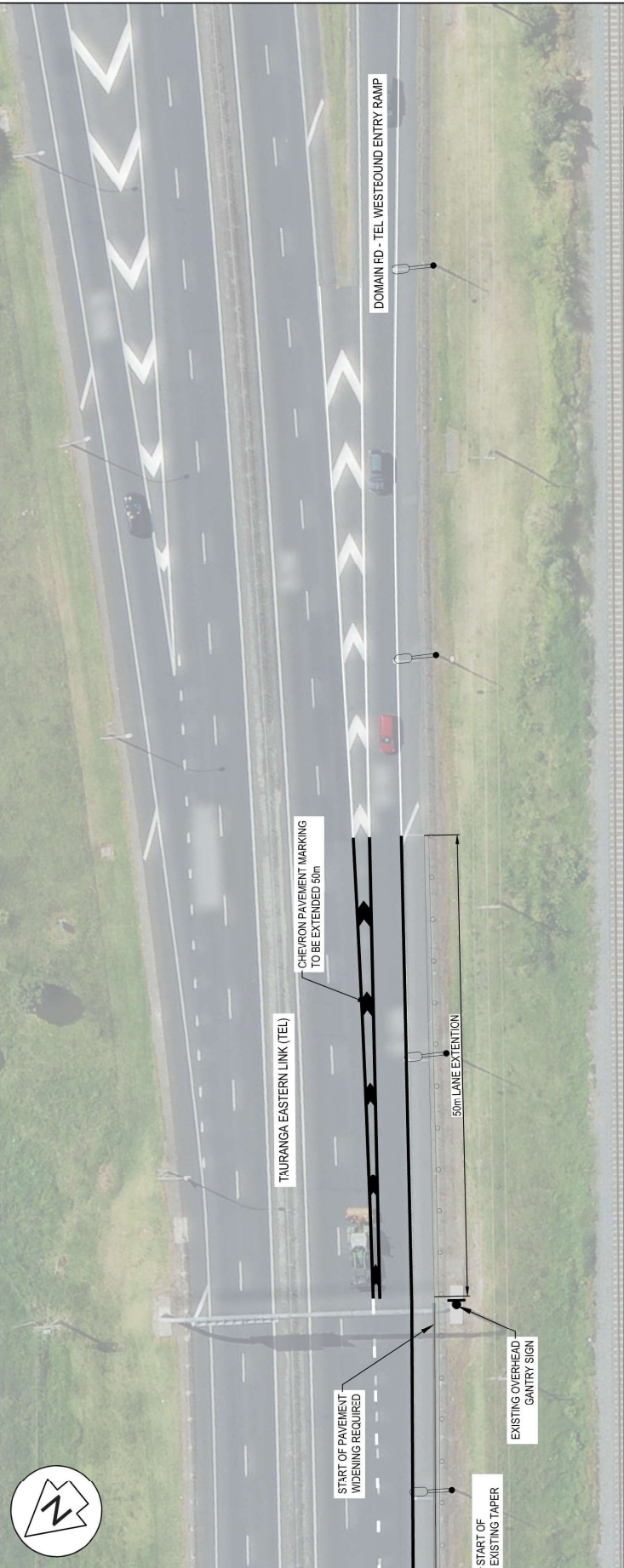

NOTES

1. ALL WORKS TO BE IN ACCORDANCE WITH THE DISTRICT COUNCIL STANDARDS.
2. THE INTERSECTION MARKUPS WERE PROVIDED AS PART OF THE PROVISIONAL INTERSECTION MODEL ARRANGEMENTS SKETCHES.

LEGEND

	EX 3DY
	EX ROAD SAFETY BARRIER
	PR ROAD SAFETY BARRIER
	PAVEMENT MARKING
	PR PAVEMENT

Rev	Description	By	Date
B	FOR CONSENT	AJS	04/26
A	DRAFT FOR REVIEW	AJS	03/26

By	Date	
Survey	MANEN	05/2025
Design	AJS	04/26
Drawn	RF	04/26
Checked	HK	04/26

Maven Bay of Plenty
 100 Rangitoto Street, Tauranga
 3116 Cameron Street, Tauranga
 New Zealand

Project:
WAIRAKEI SOUTH FTA090
DEVELOPMENT
BELL ROAD, PAPAMOA
FOR BELL ROAD
LIMITED PARTNERSHIP

Title

PROPOSED ROADING
DOMAIN RD - TEL ENTRY
RAMP EXTENSION PLAN

Project no.	BOP0749
Scale	1:500 @ A3
Cad file	BOP0749-C350-4-2WG
Drawing no.	C350-4-5
Rev	B

FOR CONSENT